

SITE PLAN OF
LIAM'S CORNER
 A PART OF THE SOUTHEAST QUARTER OF SECTION 36,
 T 9 N, R 3 W, I.M., NORMAN, CLEVELAND COUNTY, OKLAHOMA

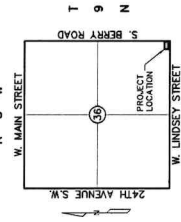
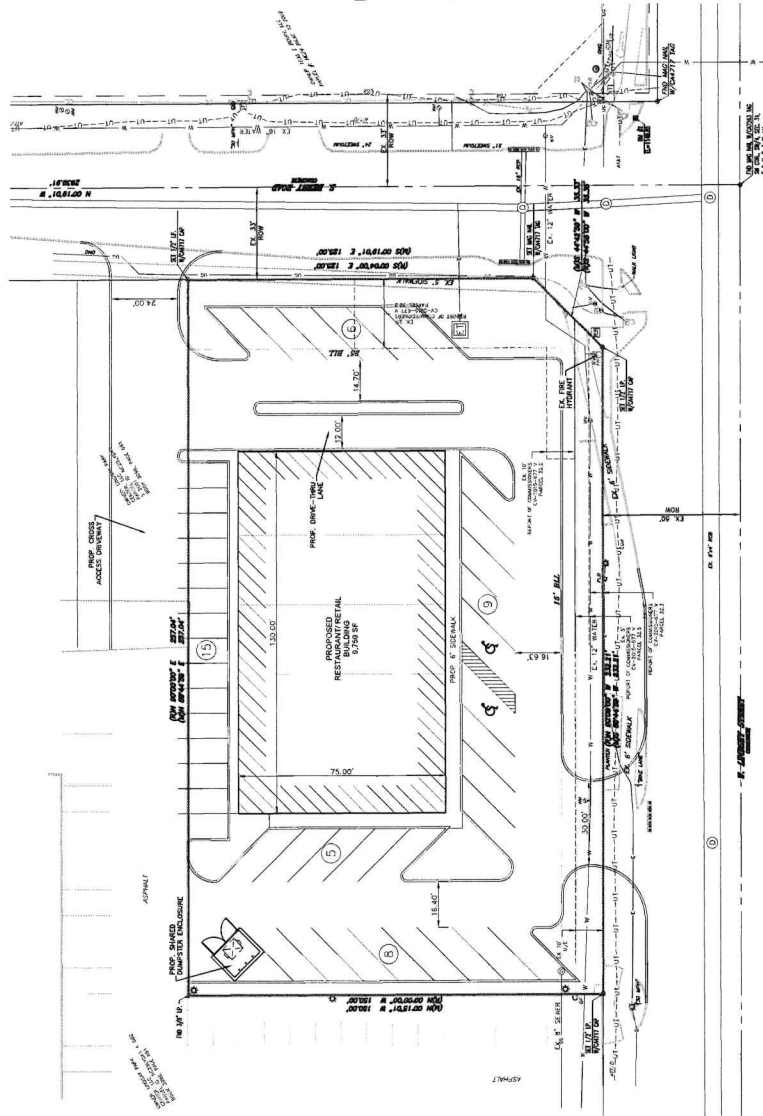

LOCATION MAP
 SCALE: 1"=2000'

LEGAL DESCRIPTION
 A part of Block Six (6), of VICTORY FIRST ADDITION, in Norman, Cleveland County, Oklahoma, according to the recorded plat thereof, as more fully described as follows: 1/4 Sec. 36, T. 9 N., R. 3 W., I.M., containing 15.5 acres, more or less, being Tracts from 1501-1515, Tract 1501, Tract 1502, Tract 1503, Tract 1504, Tract 1505, Tract 1506, Tract 1507, Tract 1508, Tract 1509, Tract 1510, Tract 1511, Tract 1512, Tract 1513, Tract 1514, Tract 1515, all as shown on the recorded plat thereof, and

GENERAL NOTES
 1. ALL EXISTING STRUCTURES AND DRIVES TO BE REMOVED.

SUBJECT PROPERTY
 0.88± AC.
 CURRENTLY ZONED C-1 & C-2

OWNER/DEVELOPER:
 LIAM'S CORNER, LLC
 2721 W. LINDESEY ST., STE. 201
 NORMAN, OK 73069

ENGINEER:
 ARC ENGINEERING
 CONSULTANTS, LLC
 STEVE ROLLINS, P.E.
 135 DEER CREEK ROAD
 EDMOND, OK 73012

SURVEYOR:
 OKLAHOMA SURVEY COMPANY
 RYAN DOUDICAN, P.L.S.
 3121 E. SOPPHUM MILL ROAD
 EDMOND, OK 73034

ARC
 Arc Engineering Consultants, LLC
 CIVIL ENGINEERING
 LAND PLANNING
 133 BETA ROAD
 EDMOND, OK 73034
 PHONE (405) 208-0322 FAX (405) 208-0348
 DEDICATED TO EXCELLENCE SINCE 1978

LIAM'S CORNER
 W. LINDESEY STREET & S. BERRY ROAD
 NORMAN, CLEVELAND CO., OKLAHOMA
 SITE PLAN

NO.	DESCRIPTION	DATE

DRWN BY	
CHKD BY	
APPROVED BY	
SDR	

PROJECT NUMBER:	24-024
DATE:	02-06-25
SCALE:	(HORIZ.) 1"=20' (VERT.) N/A

SHEET NUMBER
1 of 1