

DATE: 03/22/2024  
JOB NO: 26874  
DRAWN: STAFF  
CHECKED: CM



711 N. FIELDER RD.  
ARLINGTON, TX 76012  
PH: (817) 635 - 5696  
FAX: (817) 635 - 5699



wallace design collective, pc  
structural-civil-landscape survey  
410 westwood drive, suite 200  
oklahoma city, oklahoma 73104  
405.256.8868  
oklahoma co #C400344  
www.wallacedesign.com

**P.F. CHANG'S**  
BISTRO  
UNIVERSITY TOWN CENTER  
1651 24TH AVE. • NORMAN, OK 73069

Bryant VanFossen Reviewed  
for Code Compliance  
05/21/2024 8:47:51 AM



REVISIONS  
'A' PERMIT SET 12/21/2023  
'B' CITY COMMENTS, REV 01 05/10/2024

Title:

SITE PLAN

SHEET NUMBER

C400

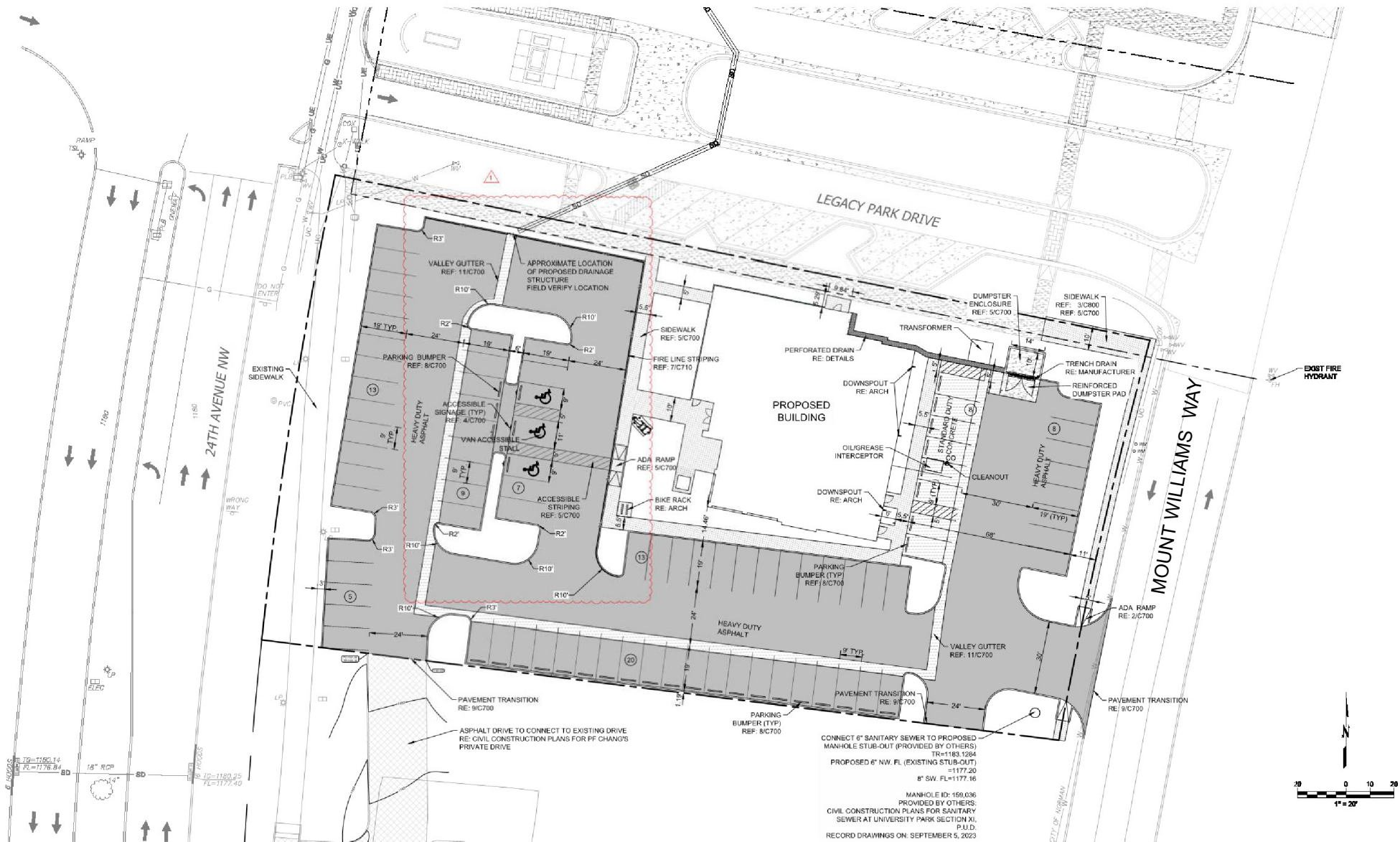

LEGEND	
	PROPERTY LINE
	STANDARD DUTY PAVEMENT REF: 10/C800
	STANDARD DUTY CONCRETE REF: 10/C800
	SIDEWALK, REF: 3/C800
	DUMPSTER PAVEMENT REF: 5/C810
	PERFORATED DRAIN REF: 5/C810
	PARKING SPACE TOTAL

PARKING SUMMARY	
ACCESSIBLE	3
STANDARD PARKING - 8'	80
TOTAL PARKING PROVIDED	83
TOTAL PARKING REQUIRED PER OKLAHOMA ZONING	6
MINIMUM BIKE RACK REQUIRED	2

\*SIDEWALK ALONG NORTH BOUNDARY AND PUBLIC SANITARY SEWER ALONG EAST BOUNDARY WERE CONSTRUCTED AFTER FIELD SURVEY WAS COMPLETED. LOCATIONS AND ELEVATIONS SHOWN ON PLANS ARE BASED ON PLAN DRAWINGS. CONTRACTOR SHALL VERIFY AS-BUILT CONDITIONS AND NOTIFY ENGINEER OF ANY DISCREPANCIES PRIOR TO COMMENCING CONSTRUCTION.\*



**CAUTION**  
NOTICE TO CONTRACTOR  
THE CONTRACTOR IS SPECIFICALLY CAUTIONED THE LOCATION AND ELEVATION OF EXISTING UTILITIES AS SHOWN ON THESE PLANS ARE BASED ON RECORDS OF THE VARIOUS UTILITY COMPANIES AND MEASUREMENTS TAKEN IN THE FIELD. THE INFORMATION IS NOT TO BE RELIED ON AS BEING EXACT OR COMPLETE. THE CONTRACTOR MUST CALL THE LOCAL UTILITY LOCATION CENTER AT LEAST 72 HOURS BEFORE ANY EXCAVATION TO REQUEST EXACT FIELD LOCATIONS OF THE UTILITIES.