

City of New Meadows Short Term RV Use Permit Application

Permit Type: Emergency Transitional Displacement Vacation

Applicant Information:

Property Owner Information:

Applicant Name: Kazia Dreyer

Same as applicant

Applicant Mailing Address: P.O. Box 122 NM

Name: William Brown

Physical Address for RV: 501 S. Heigho St.

Mailing Address: P.O. Box 530

Applicant Phone Number: (208)

Physical Address: 501 S. Heigho St.

RV License #: 2A2732R

Phone Number: (208)

RV License Expiration Date: 12/31/2021

Property Zone: R-1

Complete the section below that pertains to the permit you are applying for.

E Emergency Permit: due to: Fire Flood Wind Earthquake Other: _____

RV Location: My Property The Property of: _____

Please Initial:

____ I have provided proof of the emergency (photos, contracts for repair, maintenance, etc.)

____ I have provided written permission to place RV on a property other than my own.

____ I understand the permit is valid for 30-90 days with one extension, if necessary.

____ My RV will be occupied only by myself and immediate family.

____ My RV will not be parked on any street.

____ My RV will not be parked in any easement from November 1st - April 30th.

T Transitional Permit: (residing in RV while building a home)

Please Initial:

____ I have provided a copy of my building permit.

____ I have provided a copy of my building contract or manufactured home purchase agreement.

____ I understand the permit is valid for 180 days with one 90-day extension, if necessary.

____ My RV will be occupied only by myself and immediate family.

____ My RV will not be parked on any street.

____ My RV will not be parked in any easement from November 1st - April 30th.

V Vacation Permit: (family / friends residing in RV on my property for up to 14 days per visit)

Please Initial:

- ___ I have read, understand, and will comply with city code regarding RVs in the city limits.
- ___ This permit shall allow for up to 30 days of vacation RV use on my property in a 1-year period.
- ___ Visitors shall not remain for more than 14 consecutive days.
- ___ My property is set up for RV vacation use as per the zoning code.
- ___ The RV will not be parked on any street or easement.
- ___ The RV will not be connected to the City sewer system.
- ___ I will acquire an updated vacation permit each time an RV is occupied on my property.

D Displacement Permit: (unable to find adequate housing)

Please Initial:

- ___ My RV design and plan was approved by Planning & Zoning.
- WPB My RV will be placed in a residential zone.
- WPB My RV is fully operational & will be tied to the City's water and sewer system.
- WPB My RV will comply with setbacks on the property.
- WPB My RV will be placed on a level pad of concrete or gravel.
- WPB I understand this permit is to be renewed every 180 days.

Please provide a diagram showing where on the property the RV will be placed. Include current structures, cross roads, setbacks, and any other pertinent information: separate sheet provided

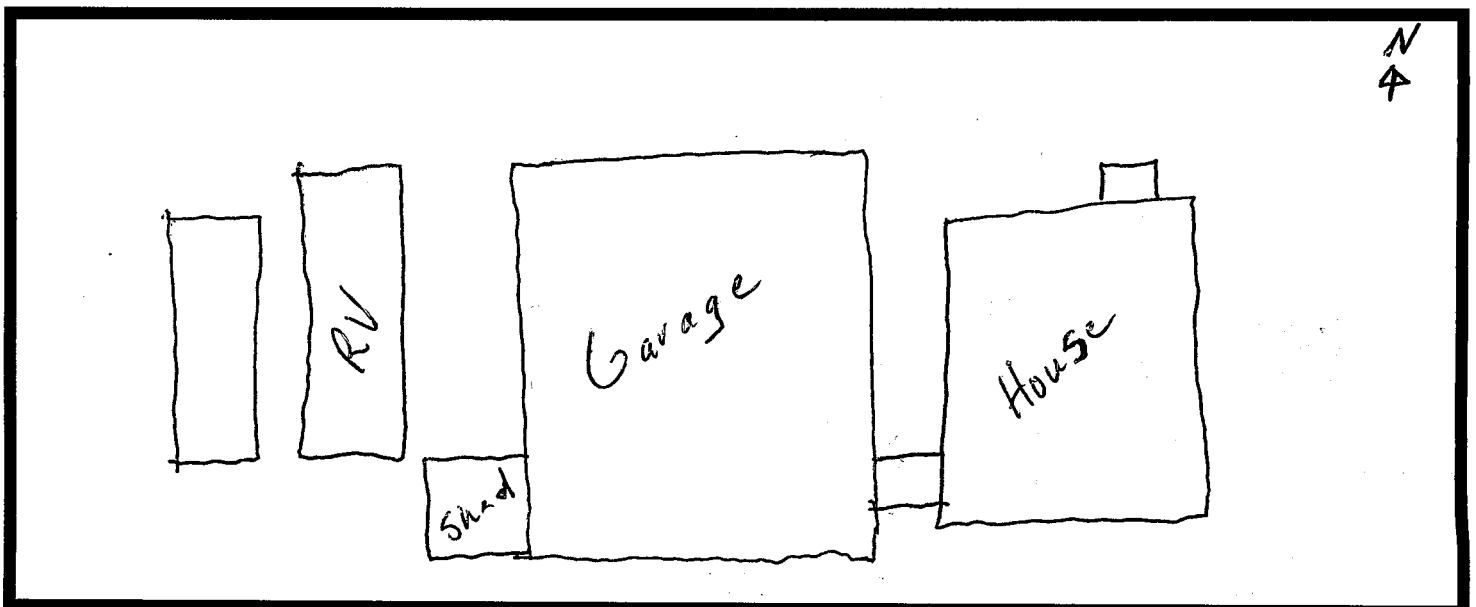

City of New Meadows Short Term RV Use Permit Application

AFFIDAVIT OF LEGAL INTEREST

(If required)

STATE OF IDAHO,)
) ss.
County of Adams.)

I, William Brown, residing at 501 S. Heigho St.,
(name) (street address)
New Meadows, ID 83654, being first duly
(city) (state) (zip code)

sworn upon oath, depose and say:

1. That I am the record owner of the property described on the attached, or have provided a purchase contract, and I grant my permission to:

Kazia Dreyer, 501 S. Heigho to place an RV on
(name) (address)

my property per the terms of this application and the Short Term RV Use Ordinance.

2. I agree to indemnify, defend and hold the City of New Meadows and its employees harmless from any claim or liability resulting from any dispute as to the statements contained herein or as to the ownership of the property which is the subject of the application.

DATED this 3rd day of Nov., 2021

Willy Brown
(signature)

SUBSCRIBED AND SWORN to before me the day and year first above written.

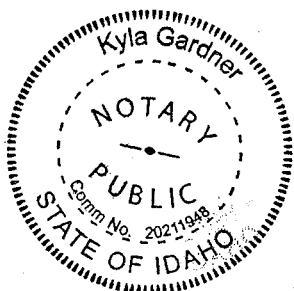

Kyla Gardner
Notary Public of Idaho
Residing at: New Meadows
My commission expires: 4/30/27

Receipt # _____

City of New Meadows Short Term RV Use Permit Application

An RV Short Term Use Permit may be issued subject to the regulations contained in the New Meadows City Code and is hereby agreed that the use of RVs on private property be in accordance with the specifications stated in the City code and this application.

Applicant Signature: Willy Brown Property Owner Signature: Willy Brown

Office Use Only

Date Received: _____ Staff Initials: _____ Application Complete: Yes No
 Application Approved Denied Permit # Issued: _____
 Fee Paid _____ No Fee Receipt #: _____ Permit Expiration Date: _____

Emergency 30-90 days (one 30-90 day extension)

Date of initial Permit Issuance: _____ Date of Extension: _____
 Expiration Date of Permit: _____ Expiration of Extension: _____

Transitional 90-180 days (one 90 day extension)

Date of initial Permit Issuance: _____ Date of Extension: _____
 Expiration Date of Permit: _____ Expiration of Extension: _____

Vacation 30 days annually - \$100 annually or \$5 per visitor non-refundable

Date of initial Permit Issuance: _____	Dates of use: _____	Dates of use: _____
Expiration Date of Permit: _____	Dates of use: _____	Dates of use: _____

1 2 3 4 5 6 7 8 9 10 11 12 13 14 15 16 17 18 19 20 21 22 23 24 25 26 27 28 29 30

Displacement 180 days (180 day extension) Sunsets 2023

Date of Council Approval: _____	Date of Council Approval: _____	Date of Council Approval: _____
Date of initial Permit Issuance: _____	Date of Extension: _____	Date of Extension: _____
Expiration Date of Permit: _____	Expiration of Extension: _____	Expiration of Extension: _____