



Snider Recreation Inc.

10139 Royalton Road, Suite K
North Royalton, OH 44133

Invoice

Date	Invoice #
6/30/2025	7537

www.cvsnyder.com

Ph (440)877-9151 Fx (440)877-9159

info@cvsnyder.com

Bill To
New Haven, Village of Brian Meissen 57775 Main Street New Haven, MI 48048

Ship To
Community Park 59450 Haven Ridge Rd New Haven, MI 48048 Mitch Burley 810-577-4728

Terms	Rep	Customer Phone	P.O. Number
Due on Receipt	VC	586-749-5301 x 7	

Rep	County
VC	Macomb-MI

Item Code	Description	Quantity	Price Each	Amount
Design	BCI Burke Design127-185726-1 NEW PLAYGROUND 5-12, 2-5 and freestanding 4 seat swing, Aro spinner, welcome signs, benches zip venture, big burke chair, orb rocker, music	1	169,470.00	169,470.00
Discount Recreation	Program Discount		-26,500.00	-26,500.00
Freight	Shipping Charges - 3 Trucks	1	7,500.00	7,500.00
Installation	Installation of Equipment Listed	1	56,000.00	56,000.00
Surfacing	Engineered wood fiber surfacing for zip venture and swing areas,7000 sf (+/-) NOTE: includes mats under swings & plastic borders	1	15,500.00	15,500.00
Installation	Site Prep for EWF Surfacing	1	6,500.00	6,500.00
Surfacing	Materials and labor to install Perfect Turf Surface in area bounded by sidewalk - 8000 sf +/-)	1	110,000.00	110,000.00
Installation	Site Prep for Turf Surfacing, including excavation, crushed stone base and fabric	1	9,650.00	9,650.00
Discount Recreation	Snider Discount		-3,500.00	-3,500.00
	Subtotal			344,620.00
Installation	Remove & Dispose of the existing equipment	1	3,500.00	3,500.00

**Freight subject to Fuel Charge. Payment via Credit
Card will incur an additional 3% administrative fee.**

**1.5% Monthly Finance Charge will be applied after 30
days.**

Subtotal	\$348,120.00
Sales Tax (6.0%)	\$0.00
Total	\$348,120.00
Payments/Credits	-\$90,000.00
Balance Due	\$258,120.00

FEIN 46-5631661

59450 Haven Ridge Rd | New Haven, MI 48048

May 21, 2024

Brian Meissen
New Haven, Village of
57775 Main St
New Haven, MI 48048-2627
Phone: 2484312796

Dear Brian Meissen:

Snider Recreation, Inc. is delighted to provide New Haven, Village of with this playground equipment proposal.

This design was developed with your specific needs in mind, and we look forward to discussing this project further with you to ensure your complete satisfaction. Snider Recreation, Inc. is confident that this proposal will satisfy New Haven, Village of's functional, environmental, and safety requirements -- and most importantly -- bring joy and excitement to the children and families directly benefiting from your new playground.

You have our personal commitment to support this project and your organization in every manner possible, and we look forward to developing a long-standing relationship with New Haven, Village of. We appreciate your consideration and value this opportunity to earn your business.

Sincerely,

Vicki Crawford
Sales Representative

Snider Recreation, Inc.
10139 Royalton Road Suite K
North Royalton, OH 44133
www.cvsnider.com
www.bciburke.com

Phone: 440-877-9151
Fax: 440-877-9159
vcrawford@cvsnider.com



DESIGN SUMMARY

Snider Recreation, Inc. is very pleased to present this Proposal for consideration for the New Haven Community Park located in New Haven. BCI Burke Company, LLC has been providing recreational playground equipment for over 100 years and has developed the right mix of world-class capabilities to meet the initial and continuing needs of New Haven, Village of. We believe our proposal will meet or exceed your project's requirements and will deliver the greatest value to you.

The following is a summary of some of the key elements of our Proposal:

- Project Name: New Haven Community Park
- Project Number: 127-185726-1
- User Capacity: 153
- Age Groups: 5 to 12
- Dimensions: 235' 9"x160' 5"
- Designer Name: Kailee Hendrickson

Snider Recreation, Inc. has developed a custom playground configuration based on the requirements as they have been presented for the New Haven Community Park playground project. Our custom design will provide a safe and affordable playground environment that is aesthetically pleasing, full of fun for all users and uniquely satisfies your specific requirements. In addition, proposal # 127-185726-1 has been designed with a focus on safety, and is fully compliant with ASTM F1487 and CPSC playground safety standards.

We invite you to review this proposal for the New Haven Community Park playground project and to contact us with any questions that you may have.

Thank you in advance for giving us the opportunity to make this project a success.



10139 Royalton Rd Suite K
N. Royalton, OH 44133
800-888-2889
www.cvsnyder.com

Date	Estimate #
7/29/2024	Q 072924-1
NEW HAVEN	

Name / Address
Village of New Haven Brian Meissen Village of New Haven 57775 Main Street New Haven, MI 48048

PROJECT - SHIP TO
PROJECT: Havenridge Park - Playground
SHIP TO: TBD

Terms	Rep	Customer Phone	Customer Email	County
Due On Receipt	VC	586-749-5301 x 7	bmeissen@newhavenmi.org	Macomb

Item	Description	Qty	Rate	Total
127-185726-1	EQUIPMENT NEW PLAYGROUND 5-12, 2-5 and freestanding 4 seat swing, aro spinner, welcome signs, benches zip venture, big burke chair, orb rocker, music		\$169,470	\$169,470
DISCOUNT	PROGRAM DISCOUNT		-\$26,500	-\$26,500
FREIGHT	Shipping Charges - 3 truckloads		\$7,500	\$7,500
MBE/Labor	Labor to install all equipment listed		\$52,500	\$56,000
EWf	SURFACING Engineered wood fiber surfacing for zip venture and swing areas, 7000 sf (+/-) (includes mats under swings & plastic borders)		\$15,500	\$15,500
MBE/Labor	to prep for ewf surface		\$6,600	\$6,600
Pturf	Materials and labor to install Perfect Turf Surface in area bounded by sidewalk - 8000 sf +/-		\$110,000	\$110,000
MBE/Labor	To prep for turf including excavation, crushed stone base and fabric		\$9,650	\$9,650
DISCOUNT	SNIDER DISCOUNT		-\$3,500	-\$3,500
	EXCAVATED SPOILS TO BE SPREAD ON SITE.			
	Quoting a price for installation/labor does not guarantee that installation will occur within the current season (April - November). Our goal is to complete all projects in order and in a timely fashion but labor, freight and supply chain issues continue to have a major impact on scheduling and completion. We apologize and ask that you factor this in when making a decision regarding labor/installation.			

6500

1/2 down with order, balance upon completion with approved credit.
If tax exempt certificate is not provided, appropriate sales
tax will be charged. Quote valid for 30 days.
Acceptance of this quote assumes acceptance of Snider insurance.
Freight subject to fuel charge. Payment via credit card will
incur an additional 3% administrative fee.

Subtotal	\$344,620
Sales Tax (6.0%)	N/A
Total	\$344,620

Signed _____ Date _____
Name/Title _____

Quoted By: *add* **3500.00**
V. Crawford Snider Recreation, Inc.

NEW HAVEN COMMUNITY PARK - OPTION #4

PROPOSAL #: 127-185726-1-R2

COLOR KEY	
●	AQUA
●	FUCHSIA
●	YELLOW
●	LIME
●	ORANGE
●	OCEAN
●	YELLOW/BLACK
●	LIME/BLACK
●	ORANGE/BLACK

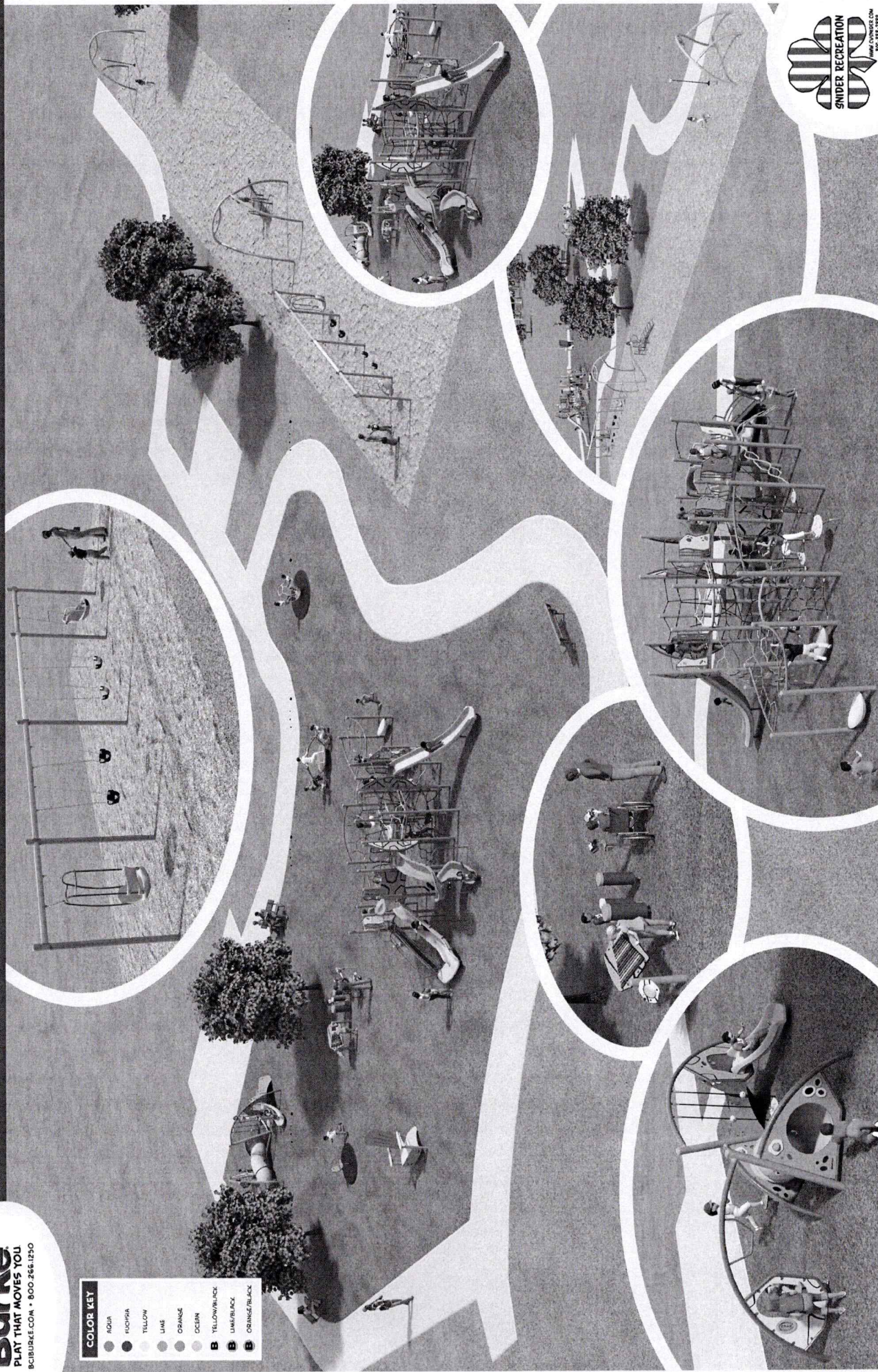

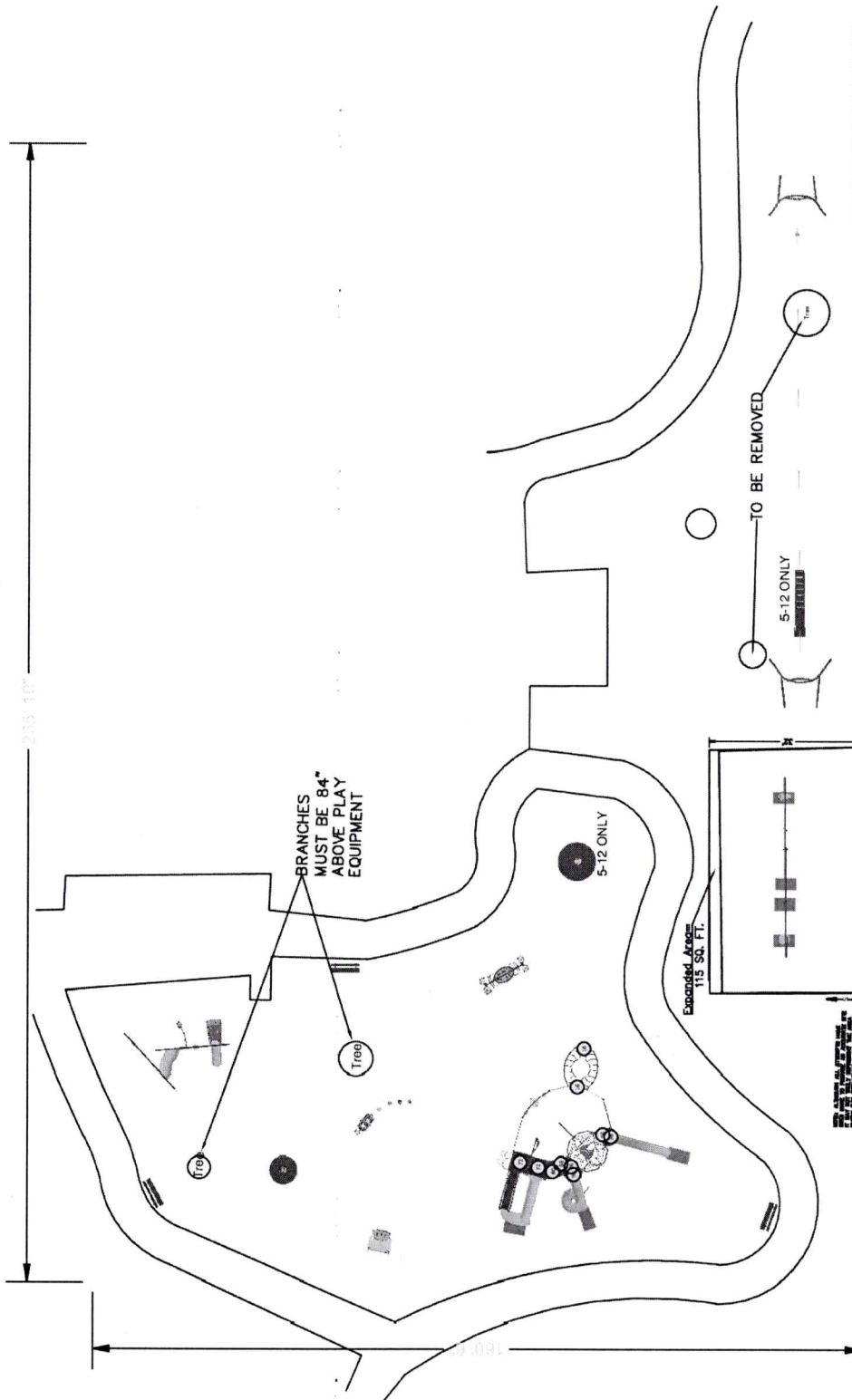

The use and layout of play components identified in this plan conform to the CPSC guidelines. U.S. CPSC recommends the separation of age groups in playground layouts.

PLAYGROUND ACCESSIBILITY (Provided/Required)				
TOTAL ELEVATED EVENTS	TRANSFER ACCESSIBLE EVENTS	RAMP ACCESSIBLE EVENTS	GROUND EVENTS	TYPES OF GROUND EVENTS
37	11 / 6	8 / 0	28 / 4	10 / 3

OVERALL BOUNDING OF USE ZONES **The space requirements shown here are to ASTM standards. Requirements for other standards may be different.

Area: 37832.1 sq.ft.
Perimeter: 792.5 ft.

STRUCTURE SIZE 6' x 235' 10"

POST SIZE (Sq)

Warning: Accessible safety surfacing material is required beneath and around this equipment that is compliant with ASTM, CPSC, and ADAAG requirements.

SERIES Nucleus | Intensity | Burke Basics

SITE PLAN VIEW

GROUP:
Structure|PlayEnsemble|Freestanding

New Haven Community Park
New Haven, MI 48048

05/21/2024

DESIGNED FOR AGES:
5 to 12

Burke
PLAY THAT MOVES YOU

Snider Recreation, Inc.
127-185726-1

Designer: Kailee Hendrickson

BCI BURKE COMPANY, LLC | PO BOX 549 FOND DU LAC, WI 54936-0549 | 920.921.9220 | BCI BURKE.COM

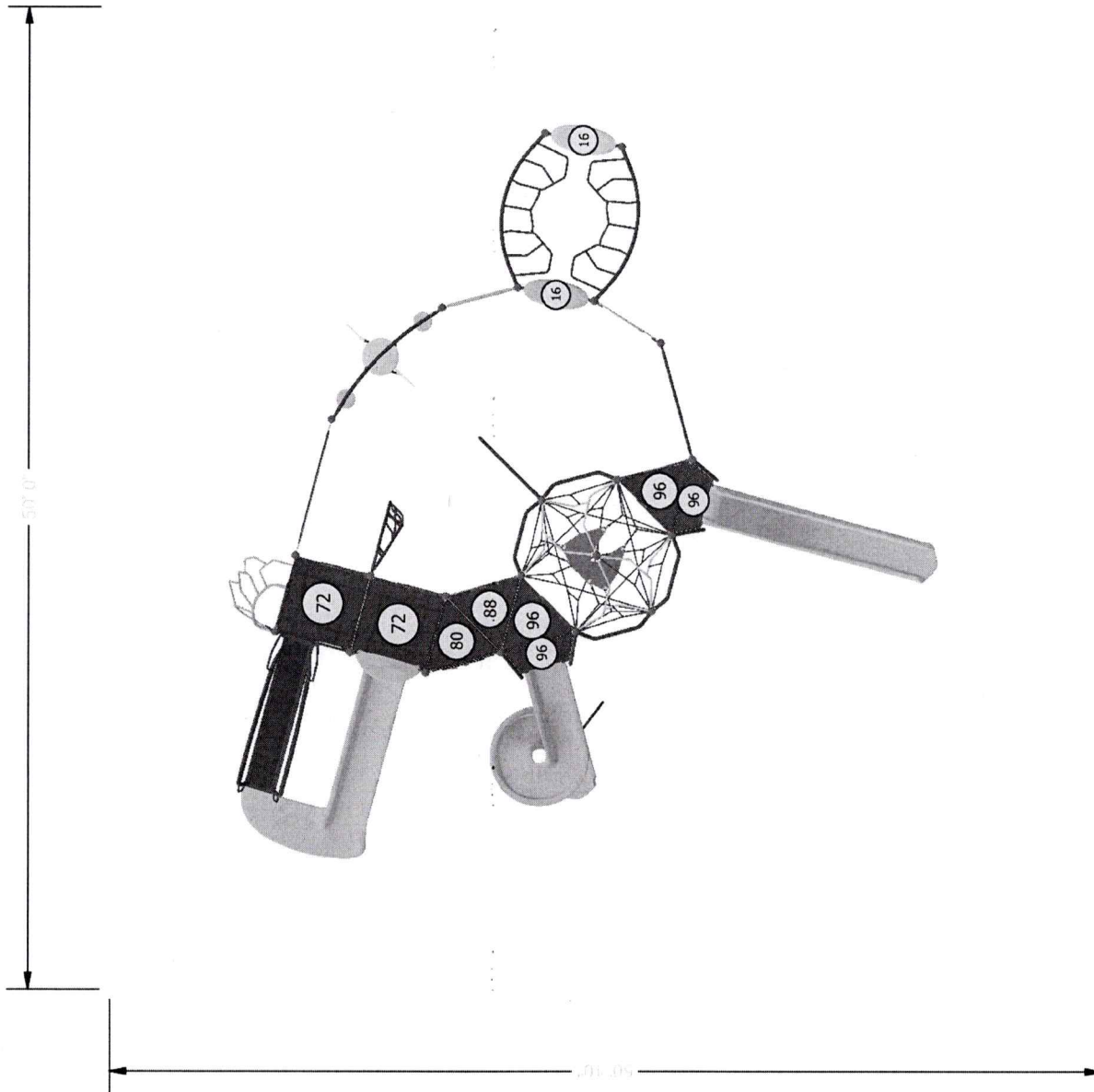

The use and layout of play components identified in this plan conform to the CPSC guidelines. U.S. CPSC recommends the separation of age groups in playground layouts.

PLAYGROUND ACCESSIBILITY (Provided/Required)				
TOTAL EVENTS	ELEVATED EVENTS	TRANSFER ACCESSIBLE EVENTS	RAMP ACCESSIBLE EVENTS	TYPES OF GROUND EVENTS
37	11 / 6	8 / 0	0 / 0	28 / 4 10 / 3

OVERALL BOUNDING OF USE ZONES **The space requirements shown here are to ASTM standards. Requirements for other standards may be different.

Area: 37832.1 sq.ft.
Perimeter: 792.5 ft.

STRUCTURE SIZE: 6"x23'x10"

POST SIZE(S):

Warning: Accessible safety surfacing material is required beneath and around this equipment that is compliant with ASTM, CPSC, and ADAAG requirements.

SERIES Nucleus | Intensity

SITE PLAN VIEW

GROUP:
Structure

New Haven Community Park
New Haven, MI 48048

05/21/2024

DESIGNED FOR AGES:
5 to 12

Burke
PLAY THAT MOVES YOU

Snider Recreation, Inc.
127-185726-1

Designer: Kailee Hendrickson

BCI BURKE COMPANY, LLC | PO BOX 549 FOND DU LAC, WI 54936-0549 | 920.921.9220 | BCI.BURKE.COM



10139 Royalton Rd Suite K
N. Royalton, OH 44133
800-888-2889
www.cvsnyder.com

Date	Estimate #
8/4/2022	Q 08422-1 NEW HAVEN

Name / Address
Village of New Haven Ann Pridemore, President Village of New Haven 57775 Main Street New Haven, MI 48048

PROJECT - SHIP TO
PROJECT: Haven Ridge Park - Splash Pad 57775 Main Street New Haven, MI 48048
SHIP TO: SITE

Terms	Rep	Customer Phone	Customer Email	Tax Exempt Number	County
Due On Receipt	VC	586-749-5301 x 7	apridemore@newhavenmi.org	TBD	MACOMB

Item	Description	Qty	Rate	Total
SPLASH PAD	FEATURES LISTED ON ATTACHED SHEET	1	\$90,000.00	\$90,000.00
MBE INSTALL	LABOR AND MATERIALS TO INSTALL WATER FEATURES LISTED (INCLUDES 4" CONCRETE PAD)	1	\$90,000.00	\$90,000.00
<p>PRICES ARE FOR BUDGETING PURPOSES AND MAY VARY AT TIME OF PURCHASE PLEASE REFER TO ATTACHED LISTING AND DOCUMENTS FOR SPECIFICS.</p> <p>BY OTHERS: Waterline with backflow preventer run to the manifold location... Electric run to the manifold (SIMPLE OUTLET) Drainage line provided within 10' of pad</p>				

1/2 down with order, balance upon completion with approved credit.
If tax exempt certificate is not provided, appropriate sales tax will be charged. Quote valid for 30 days.
Acceptance of this quote assumes acceptance of Snider insurance.
Freight subject to fuel charge. Payment via credit card will incur an additional 3% administrative fee.

Subtotal	\$180,000.00
Sales Tax (6.0%)	N/A
Total	\$180,000.00

Signed _____ Date _____
Name/Title _____

Quoted By:
V. Crawford Snider Recreation, Inc.

\$ 90,000.00 Deposit
approved 11-8-22

101-336-970

5302

Sandra Cazel

From: Sandra Cazel
Sent: Friday, September 27, 2024 9:26 AM
To: Brian Meissen; Marcuz Dilbert
Subject: RE: Playground

That's fine.

Respectfully,

Mrs. Sandra Cazel
Village of New Haven
Accountant/Office Manager
(586) 749-5301 x212 Work

SCazel@NewHavenMi.Org

CONFIDENTIALITY NOTICE: This e-mail transmission, including attachments, if any, is intended for use only by the addressee(s) named herein and contains confidential and/or privileged information. Any unauthorized review, use, disclosure or distribution is strictly prohibited. If you are not the intended recipient, please notify the sender immediately by reply e-mail or telephone and delete the original and destroy all electronic and other copies of this message.

From: Brian Meissen <bmeissen@newhavenmi.org>
Sent: Friday, September 27, 2024 8:15 AM
To: Sandra Cazel <scazel@newhavenmi.org>; Marcuz Dilbert <mdilbert@newhavenmi.org>
Subject: Fw: Playground

The \$3,500 is within my spending limit, do we want to have her team move forward with the removal of the equipment as well?

Thank you,

Brian Meissen
Village President
Village of New Haven, Michigan
57775 Main Street, New Haven MI 48048
Cell: (586) 246-1007
www.newhavenmi.org

From: Vicki Crawford <vcrawford@cvsnyder.com>
Sent: Thursday, September 26, 2024 8:34 AM
To: Brian Meissen <bmeissen@newhavenmi.org>
Cc: Sandra Cazel <scazel@newhavenmi.org>; Marcuz Dilbert <mdilbert@newhavenmi.org>
Subject: RE: Playground