

1 DECIDUOUS TREE PLANTING
NOT TO SCALE DCS-PL-01

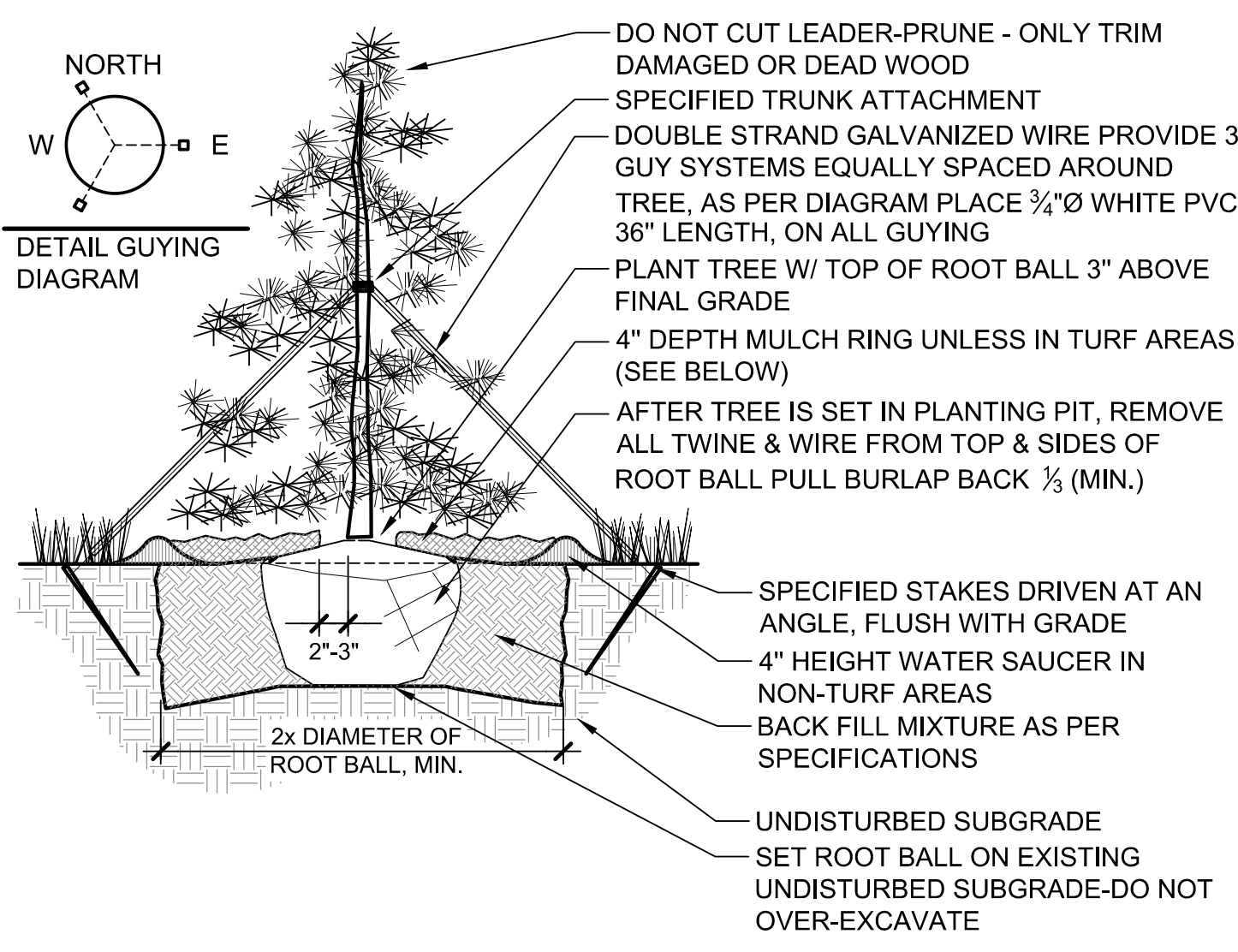

2 EVERGREEN TREE PLANTING
NOT TO SCALE DCS-PL-02

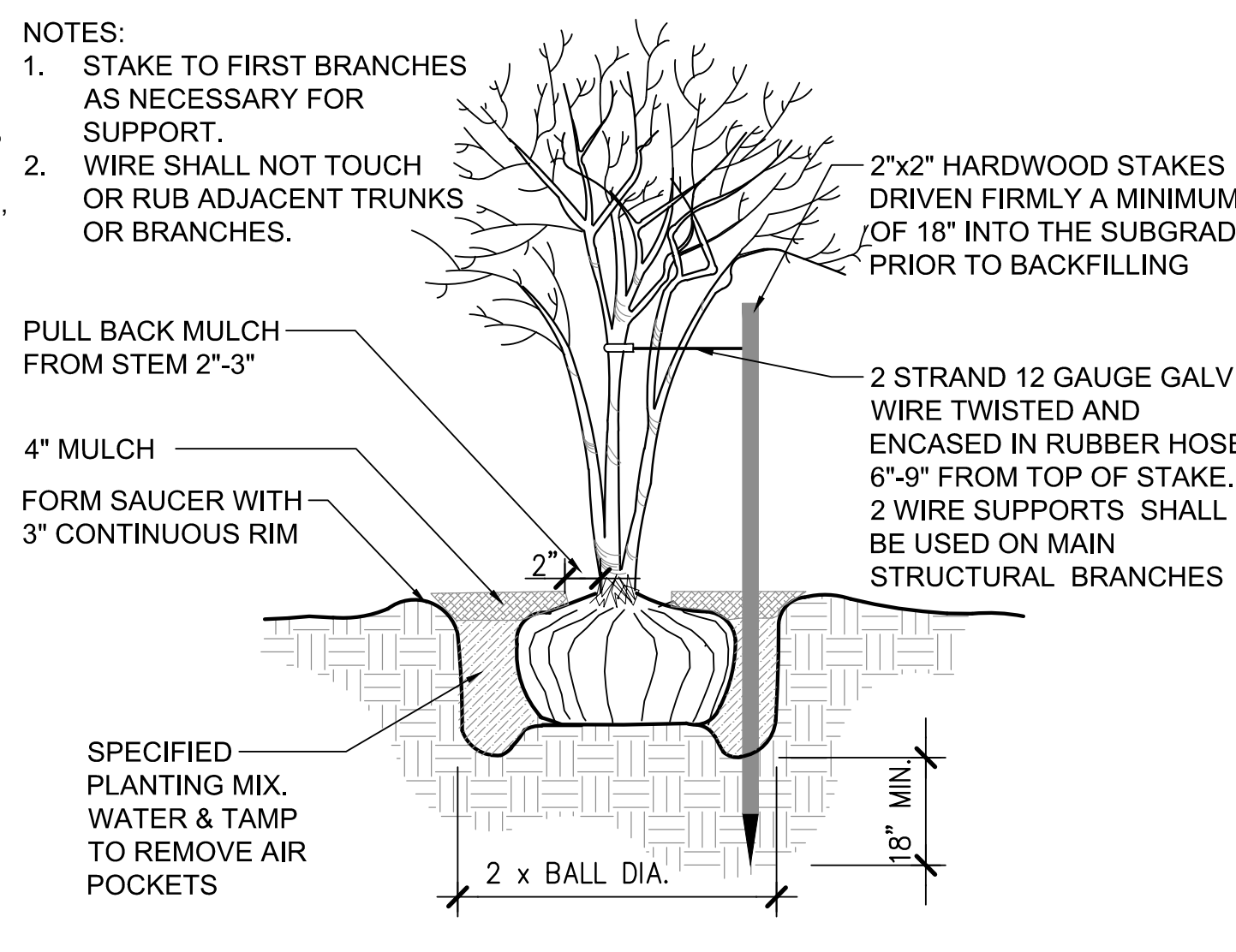

3 MULTI-TRUNK TREE STAKING
1" = 1" DCS-PL-04

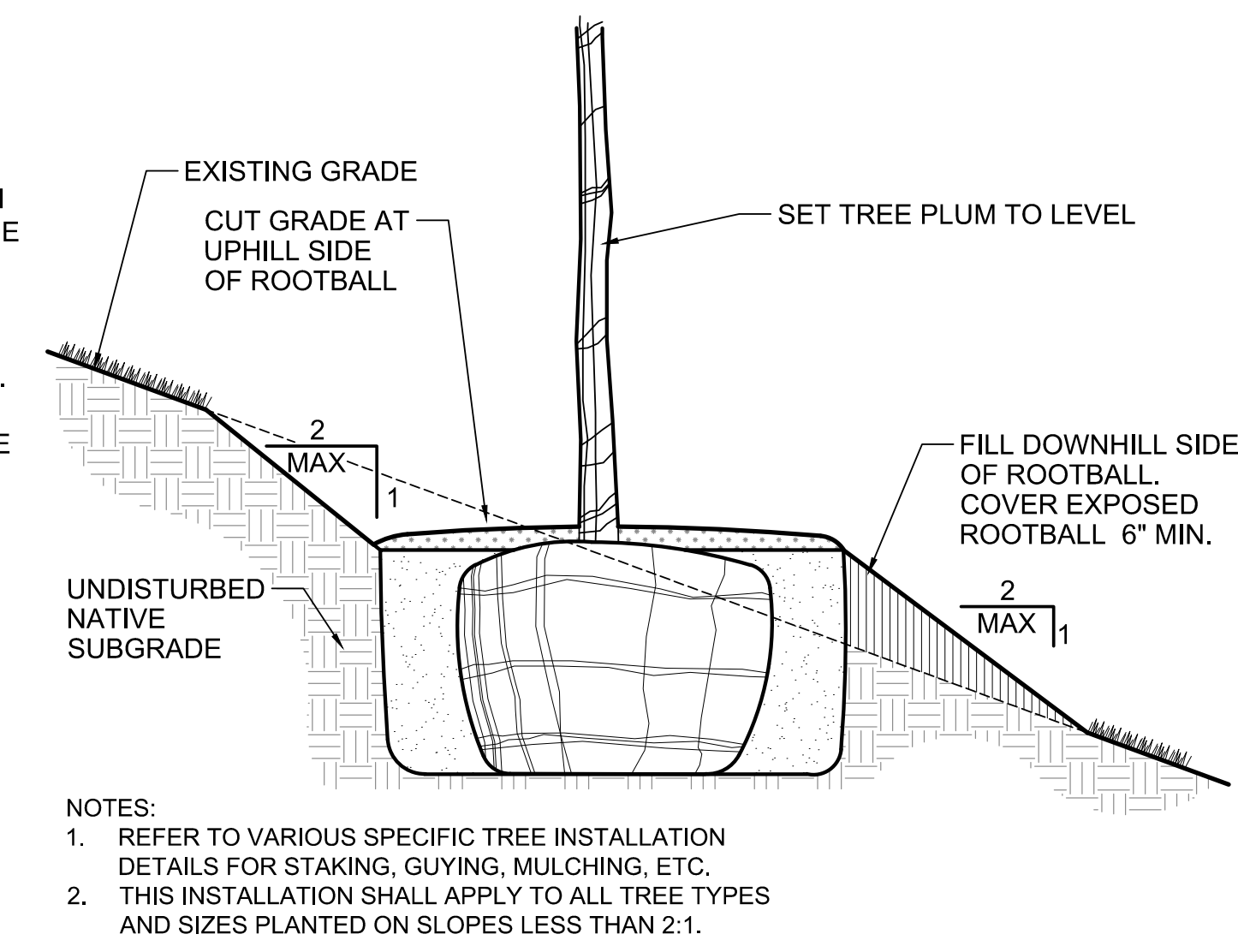

4 TREE PLANTING ON SLOPE
NOT TO SCALE DCS-PL-03

NOTES

- LANDSCAPING WITHIN THE PUBLIC RIGHT-OF-WAY AND ALL REVEGETATION SHALL CONFORM TO THE TOWN OF NEW CASTLE PUBLIC WORKS MANUAL, SPECIFICALLY SECTIONS 2710 - FINISH GRADING AND RESTORATION, 2720 - SEEDING, SODDING AND TOPSOIL, 2730 REVEGETATION-SEEDING, SODDING, HYDROSEEDING, AND 2740 - TREES, PLANTS AND GROUND COVER, SEE EXCEPTION, BELOW.
- ALL SEED MIXES AND APPLICATION RATES WITHIN THE PUBLIC WORKS MANUAL ARE HEREBY REPLACED WITH THOSE LISTED ON THESE LANDSCAPE PLANS.

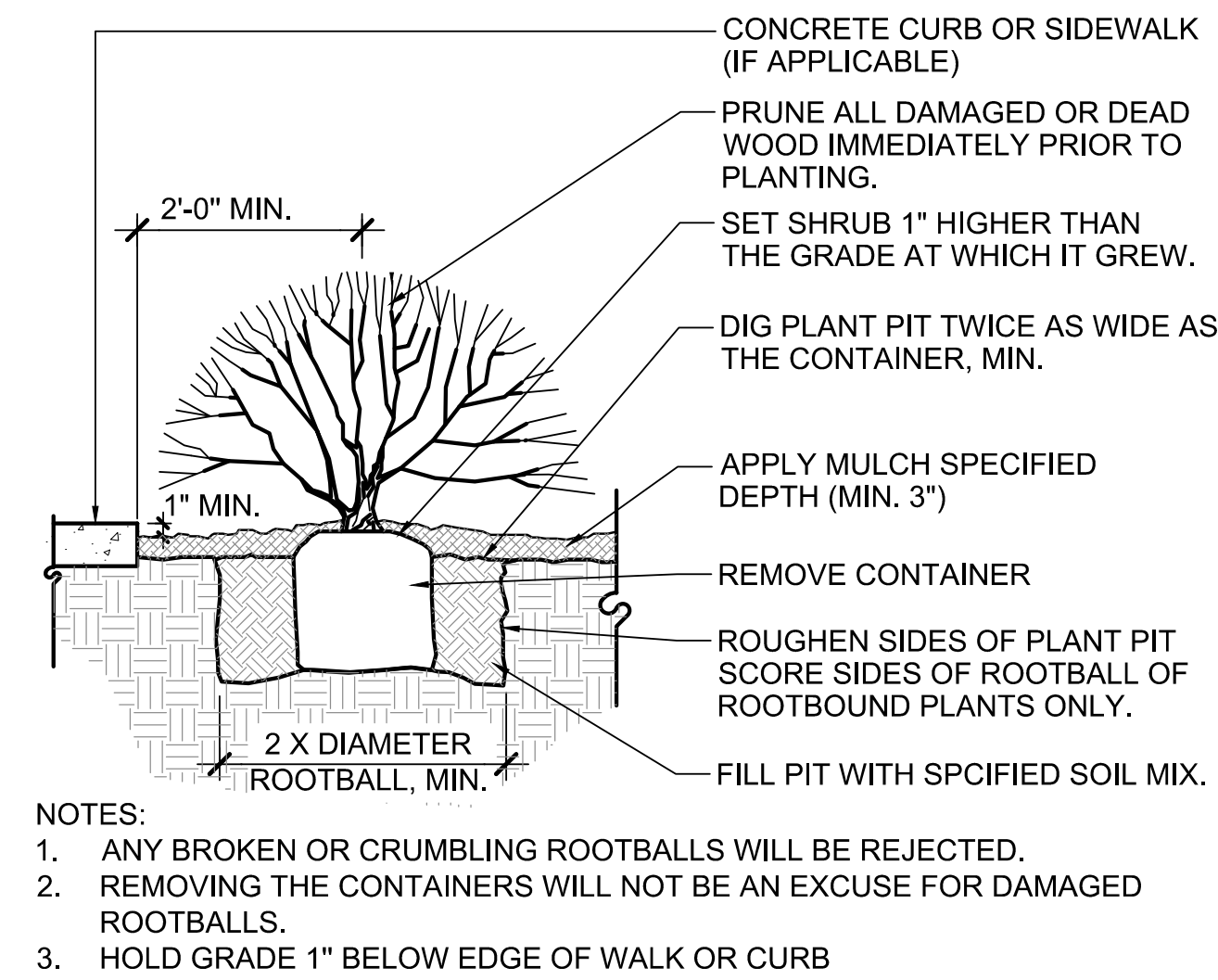

5 SHRUB PLANTING
NOT TO SCALE DCS-PL-05

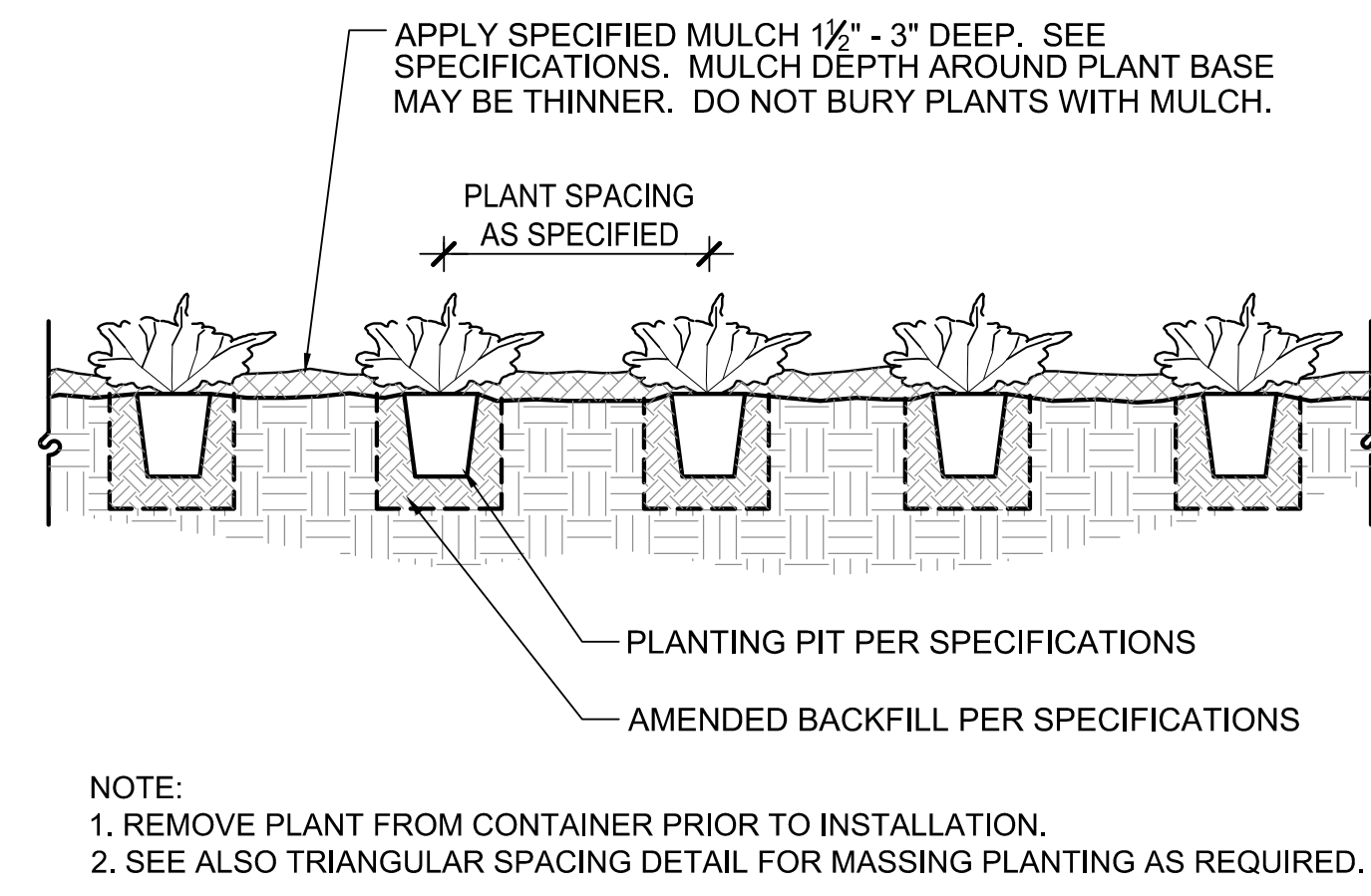

6 GROUNDCOVER AND PERENNIAL PLANTING
NOT TO SCALE DCS-PL-06

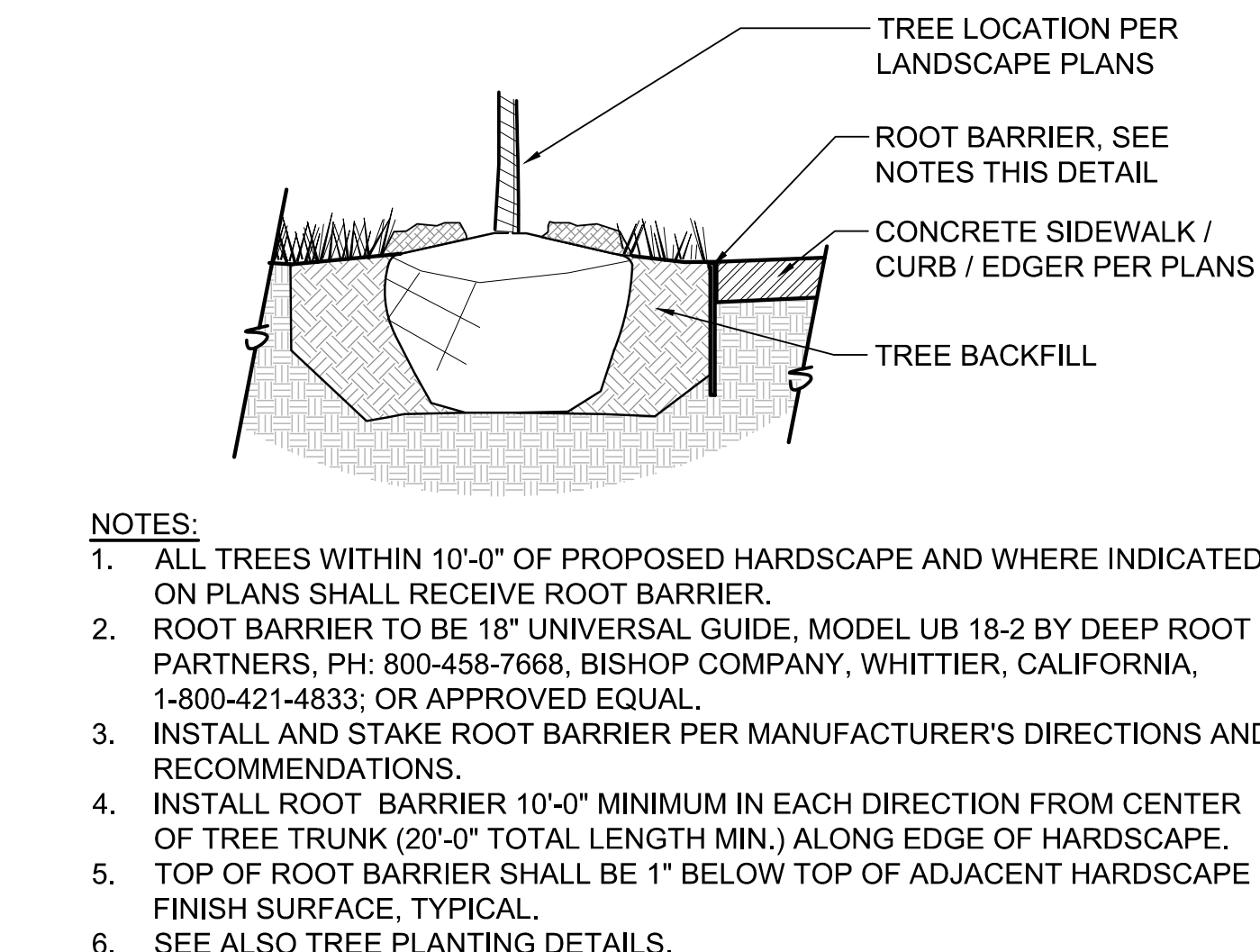

7 ROOT BARRIER INSTALLATION
NOT TO SCALE DCS-PL-11

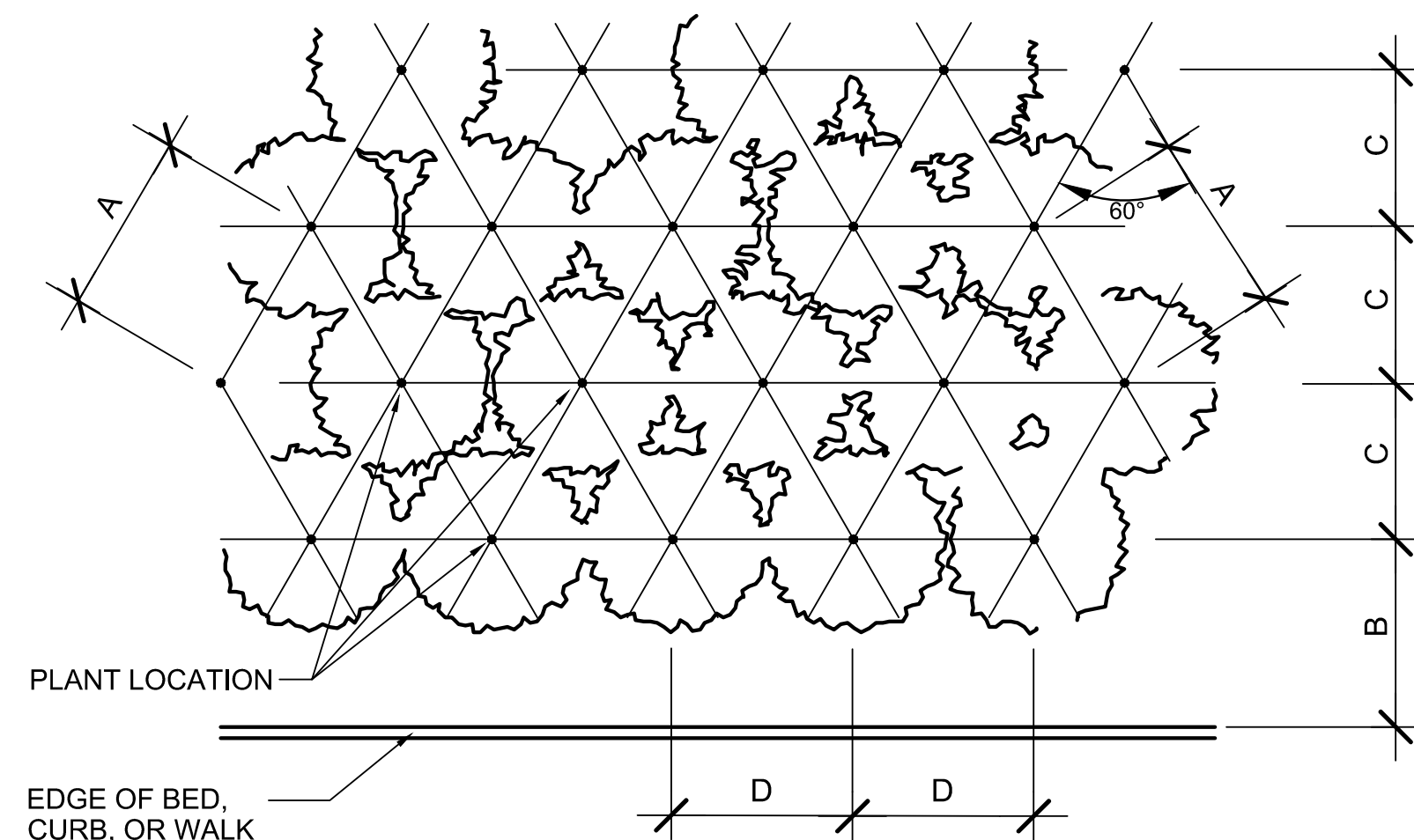

PLANT SPACING	A	B	C	D
6"	6"	6"	5"	6"
8"	8"	6"	7"	8"
12"	12"	8"	10"	12"
18"	18"	9"	15"	18"
24"	24"	18"	21"	24"
30"	30"	15"	26"	30"
36"	36"	30"	31"	36"
48"	48"	30"	42"	48"
60"	60"	36"	52"	60"

NOTE: ALIGN FRONT ROW PARALLEL TO BED LINE

8 TRIANGULAR SPACING LAYOUT FOR SHRUBS / GROUNDCOVER / FLOWERS
NOT TO SCALE DCS-PL-08

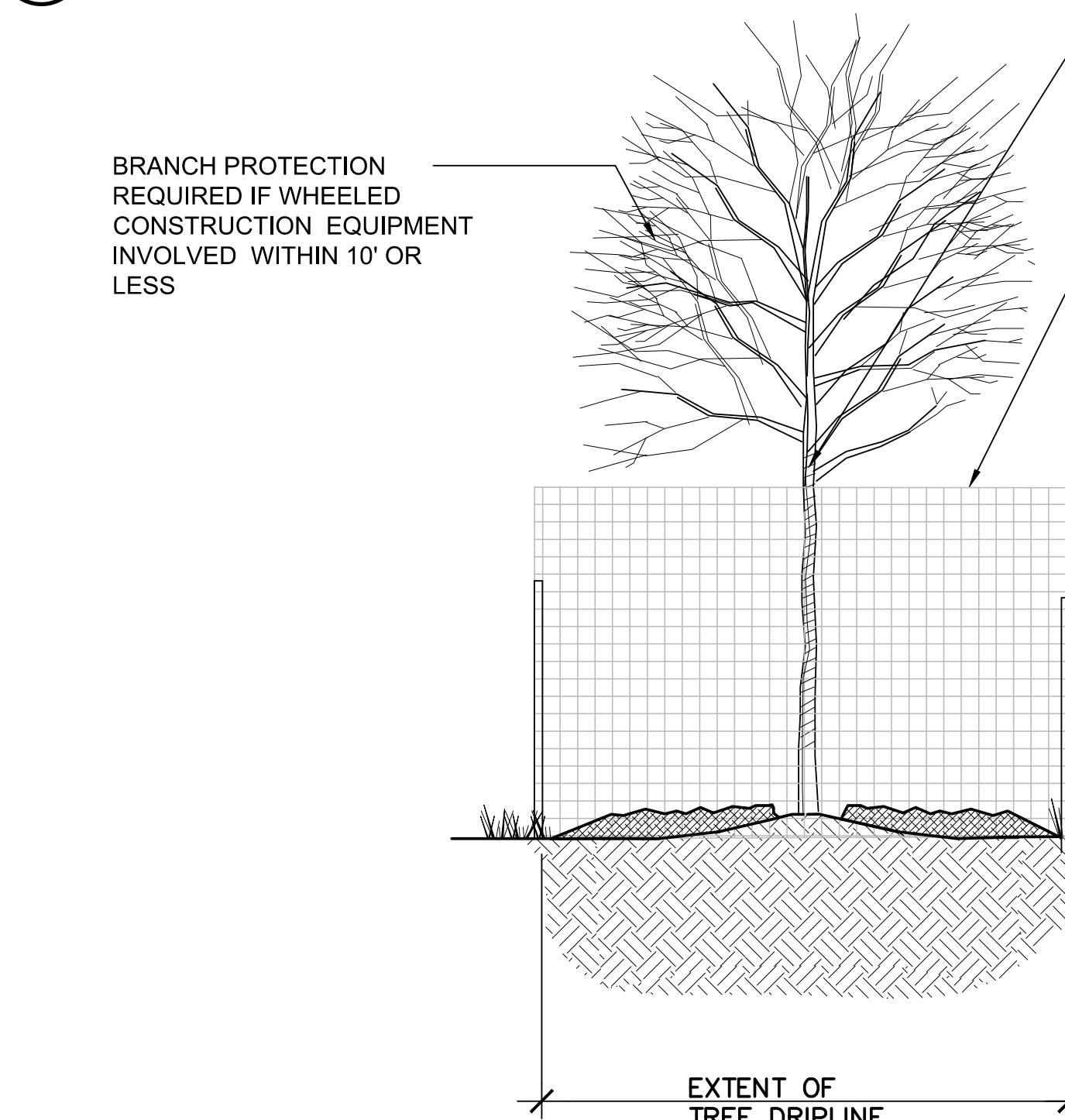

9 TREE PROTECTION DETAIL
NOT TO SCALE

- NOTES
- CONTRACTOR WILL PRESERVE & PROTECT EXISTING TREES ON SITE, DURING DEMOLITION AND CONSTRUCTION OPERATIONS AS NECESSARY, INCLUDING CANOPIES, TRUNKS, AND ROOT SYSTEMS.
 - TREES THAT ARE IN PERIL OF DAMAGE, OR TREES WITHIN 10' OF DEMOLITION OF CONSTRUCTION ACTIVITIES, OR TREES IDENTIFIED SPECIFICALLY BY OWNER, SHALL RECEIVE TREE PROTECTION.
 - CONTRACTOR SHALL CONTACT OWNER IF FIELD CONDITIONS ARE SIGNIFICANTLY DIFFERENT THAT WHAT IS SHOWN ON THE PLANS.
 - IT IS ACKNOWLEDGED THAT CONSTRUCTION AND DEMOLITION ACTIVITIES WILL OCCUR CLOSE TO TRUNKS AND OVER CRITICAL ROOT ZONES. HOWEVER, THE CONTRACTOR WILL AVOID ALL UNNECESSARY DAMAGE TO TREES.
 - IN AREAS WHERE FENCING WILL INTERFERE WITH TRAIL CONSTRUCTION, OR WHERE FENCING CANNOT BE INSTALLED, WRAP TRUNK WITH BURLAP AS PER DETAIL. CONSULT WITH OWNER PRIOR TO APPLYING PROTECTIVE WRAP TO VERIFY CONDITIONS.
 - ALL DISTURBED ROOTS SHALL BE TRIMMED TO BE CLEAN CUTS. DO NOT LEAVE BARE ROOTS EXPOSED. COVER WITH A BREATHABLE TEMPORARY COVER SUCH AS GEOTECH FABRIC AND A 1" LAYER OF SOIL IF ROOTS ARE TO BE UNCOVERED FOR MORE THAN ONE DAY. WATER AS NECESSARY TO KEEP ROOTS ALIVE.
 - TREES TO BE REMOVED WITHIN EXISTING GROUPS OF TREES IDENTIFIED AS TO REMAIN ARE TO BE REMOVED BY HAND EQUIPMENT ONLY. FOOT TRAFFIC ONLY ALLOWED IN ROOT PROTECTION ZONE, AND ONLY DURING THE TREE REMOVAL PHASE. FELL TREES DIRECTLY TO AVOID DAMAGE TO EXISTING TREES TO REMAIN.
 - IRRIGATION OF EXISTING TREES IS REQUIRED THROUGHOUT THE ENTIRE LENGTH OF THE PROJECT.

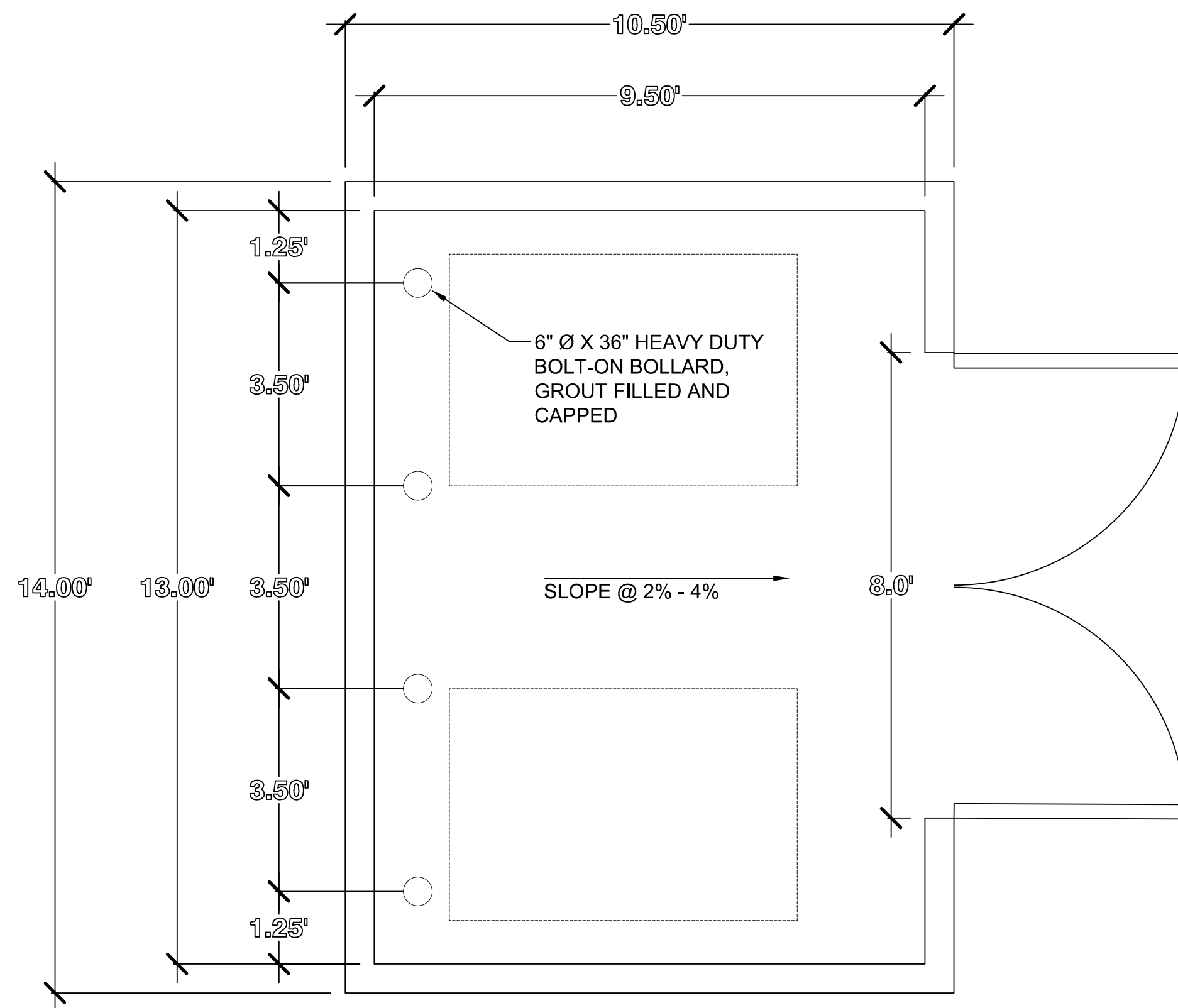
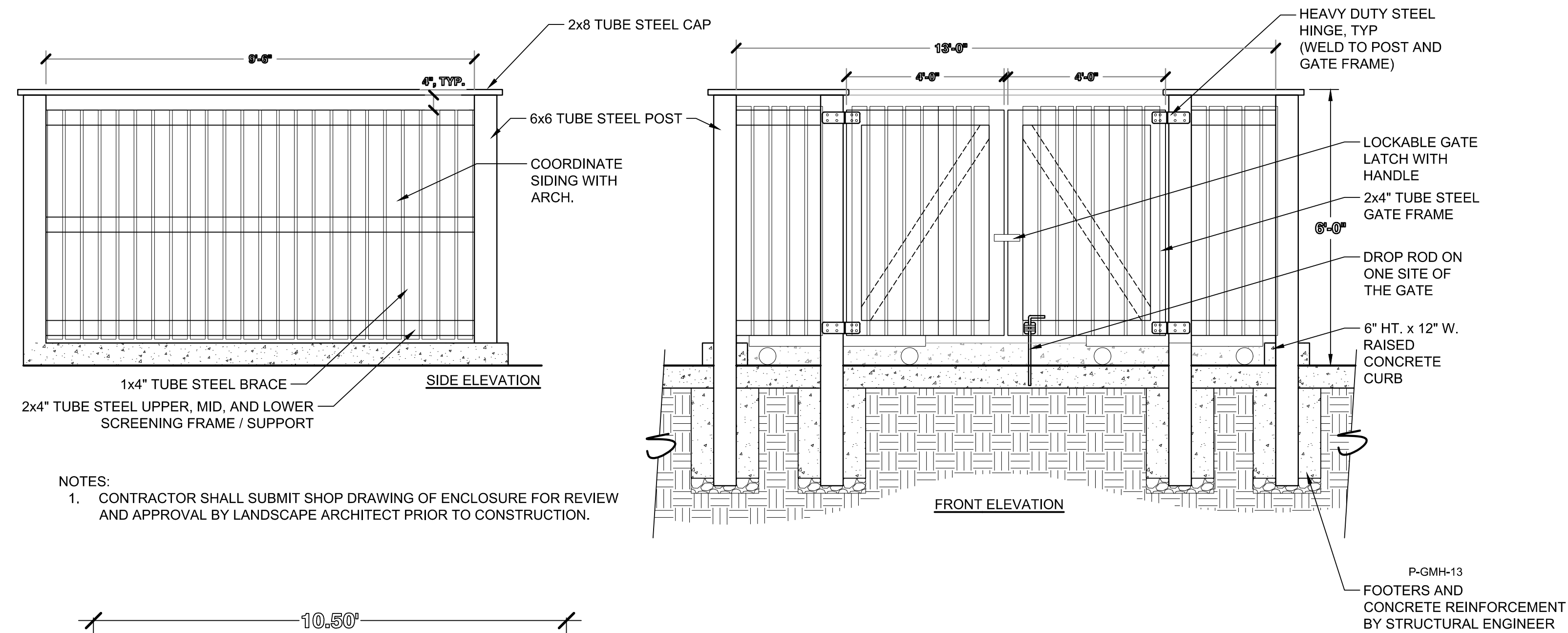

1 TRASH ENCLOSURE
1/2" = 1'-0"

9 NORTH WILD HORSE
New Castle, Colorado

PROJECT NUMBER: Project #23100
DATE: 09/09/2024
DESIGNED:
DRAWN:
CHECKED:
REVISIONS:
Revision 12/20/2024

JOB DESCRIPTION:

SHEET TITLE:
TRASH
ENCLOSURE

SCALE:
SHEET NUMBER:

L-2.1

SHEET OF

DHM DESIGN



Land+Shelter
ARCHITECTURE AND PLANNING

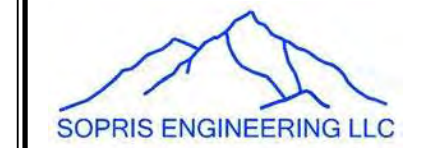

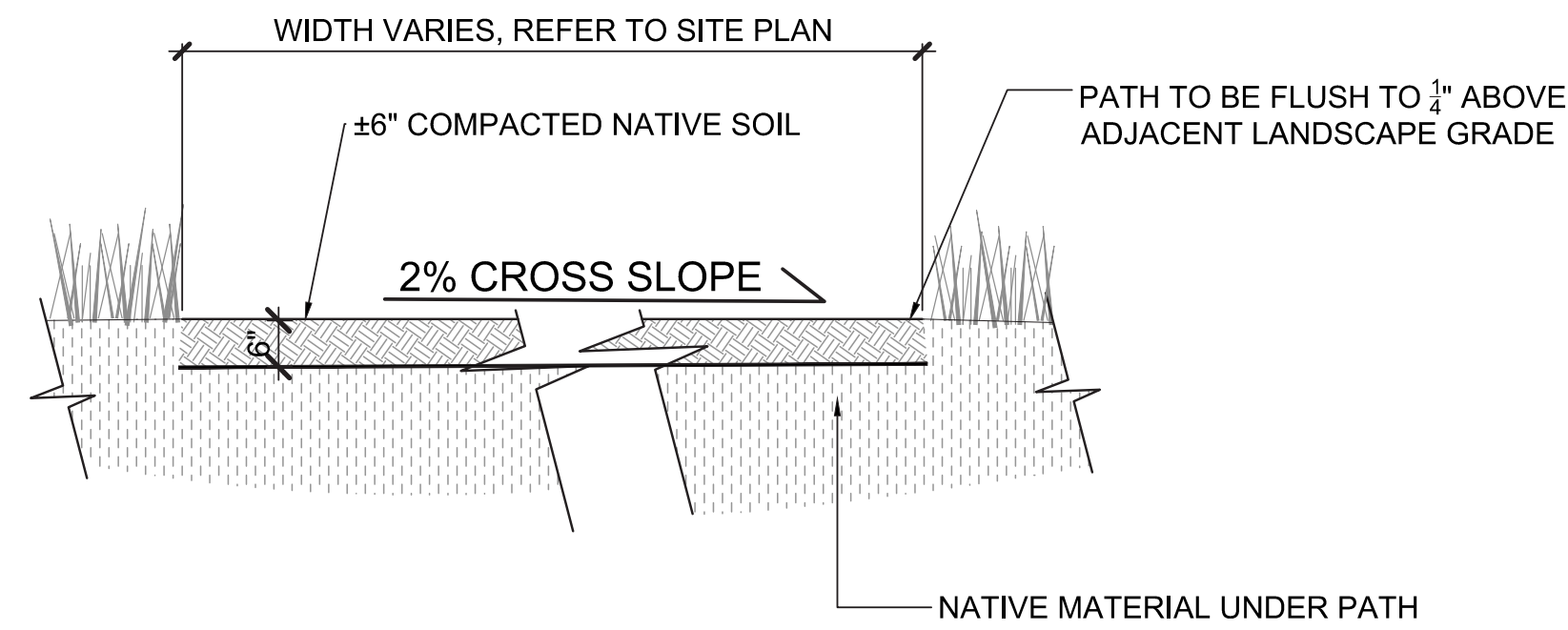

NOTES:

1. TRAILS ARE TO BE 24-36 INCHES WIDE, OF COMPACTED NATIVE SOIL.
2. PREPARE TRAIL BED BY REMOVING EXISTING VEGETATION, SURFACE ROOTS AND ROCKS, AND SUBSURFACE ROOTS TO A DEPTH OF 6 INCHES. LOOSEN AND RAKE SOIL TO ACHIEVE A CONSISTENT TRAIL BED. COMPACT WITH PLATE, JUMPING JACK, OR HAND TAMP.
3. WIDTH OF PATH VARIES, SEE SITE PLANS.
4. CROSS SLOPE DIRECTION TO BE DETERMINED IN FIELD.

1 NATURAL SURFACE TRAIL
1/2" = 1'-0"

PLAN VIEW

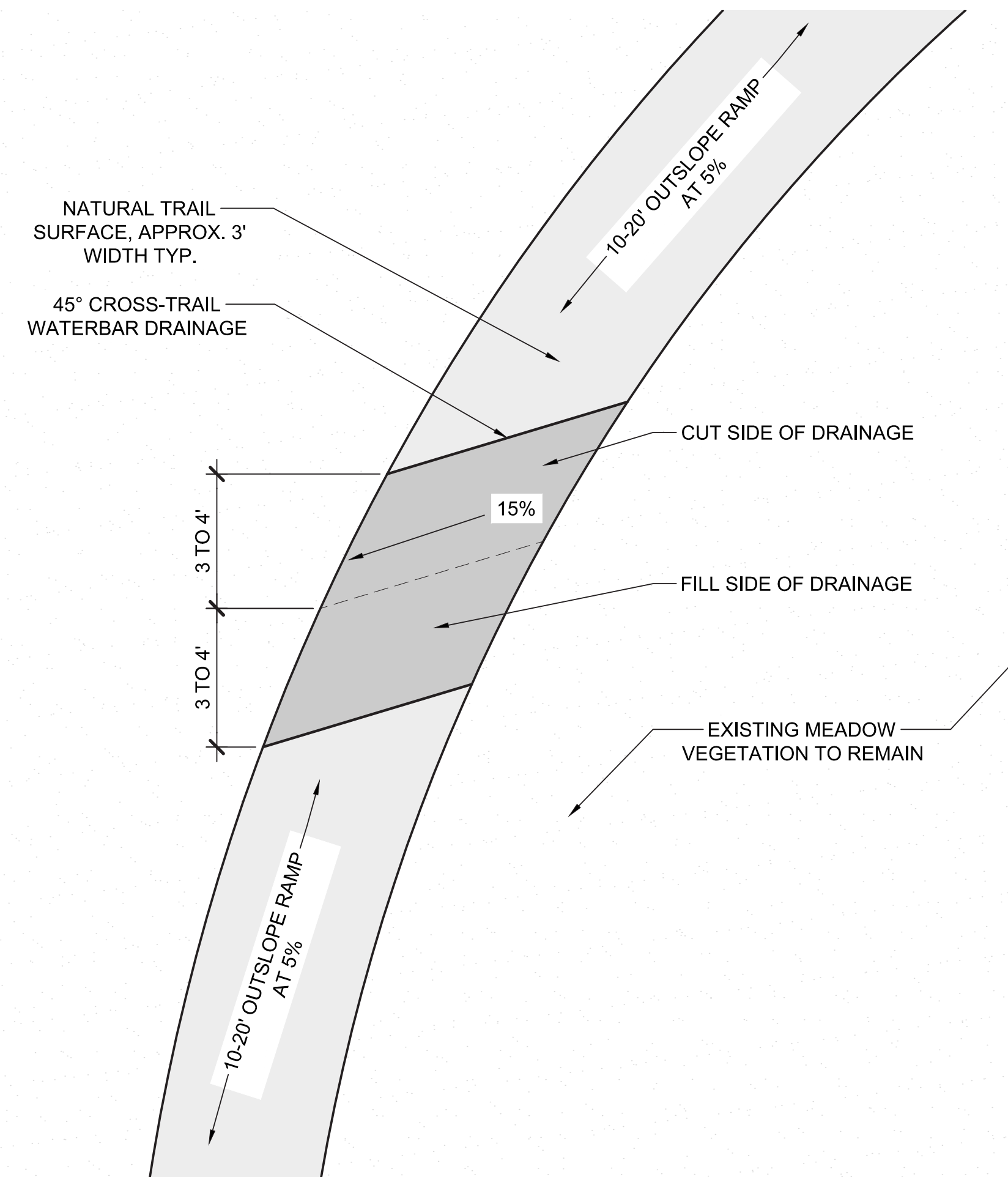

CROSS SECTION

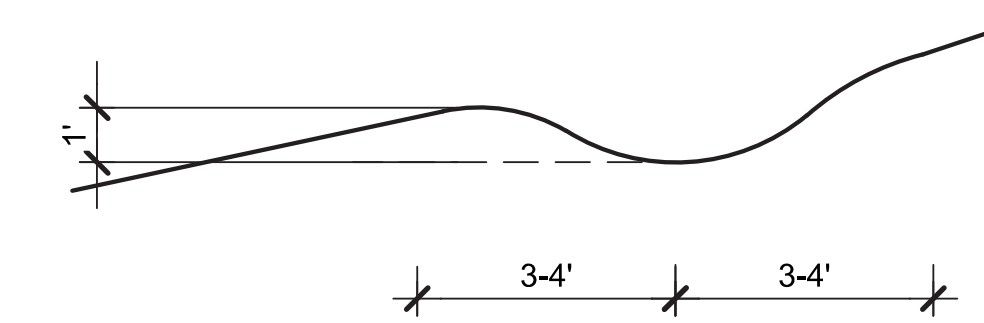

NOTES:

1. WATERBAR DRAINAGE TO BE LOCATED ON SITE, AT APPROXIMATELY EVERY 10 FEET OF GRADE CHANGE ALONG THE TRAIL.

2 NATURAL SURFACE TRAIL DRAINAGE
1" = 2'-0"

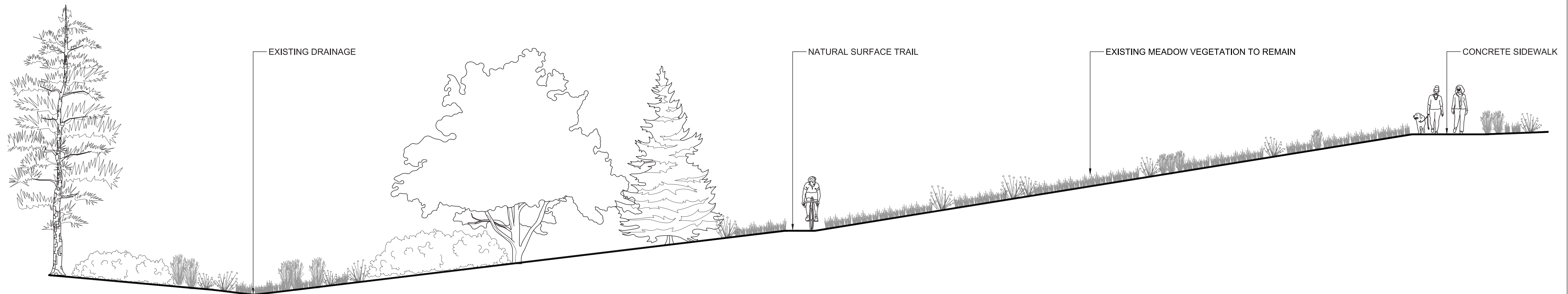

3 NATURAL SURFACE TRAIL SECTION
1" = 5'-0"

DHM DESIGN



Land+Shelter
ARCHITECTURE AND PLANNING



9 NORTH WILD HORSE
New Castle, Colorado

PROJECT NUMBER: DATE
Project #23100 09/09/2024

DESIGNED:
DRAWN:
CHECKED:

REVISIONS:
Revision 12/20/2024

JOB DESCRIPTION:

SHEET TITLE:
TRAIL DETAILS

SCALE:
SHEET NUMBER:

L-2.2

SHEET OF

GENERAL NOTES		LIGHTING		SWITCHING & CONTROLS	
<p>1. THE CONTRACTOR SHALL PROVIDE ALL LABOR AND MATERIAL NECESSARY FOR A COMPLETE AND FUNCTIONING LIGHTING SYSTEM.</p> <p>2. THE GENERAL CONTRACTOR, ELECTRICAL CONTRACTOR(S), AND LOW VOLTAGE CONTRACTOR(S) SHALL REFER TO THE LIGHTING PLANS, SCHEDULES, AND DETAILS HEREIN, INCLUDING ANY ATTACHED LIGHTING SPECIFICATIONS AND PRODUCT CUTSHEETS FOR ADDITIONAL INFORMATION.</p> <p>3. THE CONTRACTOR SHALL LAY OUT ALL LIGHT FIXTURE LOCATIONS AND TRANSFORMER LOCATIONS PRIOR TO INSTALLATION FOR APPROVAL BY ALPENGLOW LIGHTING DESIGN, INC., ARCHITECT, INTERIOR DESIGNER, ENGINEER(S), AND OWNER.</p> <p>4. MATERIALS AND INSTALLATION SHALL COMPLY WITH CODES, LAWS, AND ORDINANCES OF FEDERAL, STATE AND LOCAL GOVERNING BODIES HAVING JURISDICTION.</p> <p>5. MATERIALS AND EQUIPMENT SHALL BE LISTED AND/OR LABELED BY UL., ETL, GSA OR ANOTHER RECOGNIZED TESTING LAB.</p> <p>6. THE CONTRACTOR SHALL SECURE AND PAY FOR ALL PERMITS, GOVERNMENTAL FEES, TAXES AND LICENSES NECESSARY FOR THE PROPER EXECUTION AND COMPLETION OF THE ELECTRICAL WORK.</p> <p>7. THE CONTRACTOR SHALL PREPARE AND SUBMIT TO GOVERNMENTAL AGENCIES AND UTILITY COMPANIES ANY SHOP DRAWINGS AS REQUIRED BY THESE AGENCIES FOR THEIR APPROVAL.</p> <p>8. THE CONTRACTOR SHALL NOTIFY THE ARCHITECT, OWNER, AND LIGHTING DESIGNER OF ANY MATERIALS OR APPARATUS BELIEVED TO BE INADEQUATE, UNSUITABLE, IN VIOLATION OF LAWS, ORDINANCES, RULES OR REGULATIONS OF AUTHORITIES HAVING JURISDICTION.</p> <p>9. THE CONTRACTOR SHALL CAREFULLY EXAMINE THE CONTRACT DOCUMENTS, VISIT THE SITE, AND THOROUGHLY BECOME FAMILIAR WITH THE BUILDING AND STANDARDS AND LOCAL CONDITIONS RELATING TO THE WORK. FAILURE TO DO SO WILL NOT RELIEVE THE CONTRACTOR OF THE OBLIGATIONS OF THE CONTRACT.</p> <p>10. ALL MATERIALS, AND EQUIPMENT SHALL BE ERECTED, INSTALLED, CONNECTED, CLEANED, ADJUSTED, TESTED, CONDITIONED, AND PLACED IN SERVICE IN ACCORDANCE WITH THE MANUFACTURER'S DIRECTIONS AND RECOMMENDATIONS.</p> <p>11. ALL CUTTING, DRILLING, AND PATCHING OF MASONRY, STEEL OR IRON WORK BELONGING TO THE BUILDING MUST BE DONE BY THIS CONTRACTOR IN ORDER THAT HIS WORK MAY BE PROPERLY INSTALLED, BUT UNDER NO CONDITIONS MAY STRUCTURAL WORK BE CUT, EXCEPT AT THE DIRECTION OF THE ARCHITECT, ENGINEER, OR THEIR REPRESENTATIVE.</p> <p>12. ALL MATERIAL, EQUIPMENT, WIRING DEVICES, ETC. SHALL BE NEW UNLESS SPECIFICALLY INDICATED AS EXISTING TO BE REUSED.</p> <p>13. EXCEPT AS NOTED OTHERWISE, ALL WORK REQUIRED FOR THE INSTALLATION AS SHOWN ON DRAWINGS INCLUDING LABOR, EQUIPMENT, AND MATERIALS SHALL BE IN STRICT COMPLIANCE WITH THE BUILDING STANDARDS.</p> <p>14. COMMERCIAL APPLICATIONS: THE CONTRACTOR MAY PROVIDE COMPLETE METAL RACEWAY SYSTEMS AND ENCLOSURES FOR ALL WIRING THROUGHOUT THE EXTENT OF THE REQUIRED SYSTEM. RESIDENTIAL APPLICATIONS MAY USE NON METALLIC WIRE (ROMEX).</p> <p>15. MC CABLE MAY BE USED FOR ALL BRANCH CIRCUITING. MC CABLE SHALL NOT ENTER INTO PANELBOARDS. ELECTRICAL CONTRACTOR SHALL UTILIZE EMT OUT OF THE PANELBOARD INTO A FULL BOX, GUTTER, OR SIMILAR DEVICE, AND THEN RUN MC CABLE FOR THE REMAINDER OF BRANCH CIRCUITING RUN. MINIMUM RACEWAY SIZE SHALL BE 1/2" UNLESS OTHERWISE INDICATED. MC CABLE MAY ONLY BE USED IN CONCEALED LOCATIONS.</p> <p>16. FLEXIBLE CONDUIT CONNECTIONS TO RECESSED LIGHTING FIXTURES SHALL BE MADE WITH FLEXIBLE STEEL CONDUIT, 3/4" MINIMUM.</p> <p>17. ALL NEW CIRCUITS SHALL HAVE A GROUND WIRE INSTALLED.</p> <p>18. ALL WIRE NOT INSTALLED IN CONDUIT AND IN THE CEILING SHALL BE PLENUM RATED.</p> <p>19. REMOTE POWER SUPPLIES AND TRANSFORMERS SHALL BE CONCEALED IN ATTICS, CRAWL SPACES, OR SIMILAR ACCESSIBLE LOCATIONS. MAXIMUM WIRE RUN TO THE END OF THE FIXTURE SHALL NOT EXCEED 75 FEET.</p> <p>20. IN SUSPENDED CEILINGS, SUPPORT CONDUIT AND JUNCTION BOXES DIRECTLY FROM THE STRUCTURAL SLAB, DECK, OR FRAMING PROVIDED FOR THAT PURPOSE. LIGHTING BRANCH CIRCUIT CONDUITS SHALL NOT BE CLIPPED TO THE CEILING SUPPORT WIRES OR SPLINE UNLESS THE CEILING HAS BEEN SPECIFICALLY DESIGNED FOR THAT PURPOSE.</p> <p>21. SHOULD ACTUAL FIELD CONDITIONS REQUIRE INDICATED CIRCUIT DESIGNATIONS TO VARY, INDICATE THE CIRCUIT NUMBER USED ON THE AS-BUILT DRAWINGS.</p> <p>22. ALL FACE PLATE AND DEVICE COLORS SHALL BE APPROVED BY ARCHITECT, INTERIOR DESIGNER, AND OWNER.</p> <p>23. ALL BATTERY BACKUP EMERGENCY LIGHTING AND EXIT LIGHTS SHALL BE WIRED AHEAD OF ANY LOCAL SWITCHING, UNLESS OTHERWISE NOTED.</p> <p>24. THE CONTRACTOR SHALL VERIFY THE CEILING TYPE BEFORE ORDERING LIGHTING FIXTURES.</p> <p>25. THE CONTRACTOR IS TO REFER TO ARCHITECTURAL PLANS AND SPECIFICATIONS FOR ALL FIRE-RATED PENETRATION INSTALLATION REQUIREMENTS.</p> <p>26. THE CONTRACTOR IS TO NOTIFY THE ARCHITECT PRIOR TO INSTALLING ANY FIXTURES WITHIN A FIRE RATED CEILING OR WALL. FIRE RATING MUST BE MAINTAINED FOR THIS TYPE OF INSTALLATION WITH DRYWALL TENTING OR LISTED FIREBOX ASSEMBLY.</p> <p>27. BIDS SHALL HAVE LINE-ITEM PRICING. BIDS WHICH SHOW LOT PRICING FOR LIGHTING FIXTURES AND/OR LIGHTING CONTROLS SHALL BE REJECTED WITHOUT CONSIDERATION. BIDDER SHALL HAVE FIVE (5) BUSINESS DAYS TO RESUBMIT LINE-ITEM PRICING. AFTER FIVE (5) BUSINESS DAYS, BID SHALL BE CONSIDERED TO BE NULL AND VOID AND WILL BE REJECTED. BIDDERS WARRANT THEIR COMPLIANCE WITH THE ROBINSON-PATMAN AND CLAYTON ACTS.</p> <p>28. SUBMIT PRODUCT DATA DESCRIBING FIXTURES, LAMPS, BALLASTS, AND EMERGENCY LIGHTING UNITS WITHIN 30 DAYS OF DIRECTION TO PROCEED FROM THE OWNER. ALL NOTATIONS SHALL BE .PDF FORMAT OR LASER PRINTED. ARRANGE PRODUCT DATA FOR FIXTURES IN ORDER OF FIXTURE DESIGNATION. AFTER 30 DAYS, A MINIMUM OF EIGHT HOURS OF PROFESSIONAL TIME TO CONSIDER ANY SUBMITTAL SHALL BE PAID FOR BY THE CONTRACTOR. SUCH PAYMENT DOES NOT GUARANTEE APPROVAL. COSTS INCURRED TO THE PROJECT DUE TO PROBLEMS ARISING FROM LATE SUBMITTALS ARE TO BE PAID BY THE CONTRACTOR. TWO (2) RESUBMITTALS SHALL BE ALLOWED PER PROJECT. AFTER TWO (2) RESUBMITTALS, A MINIMUM OF EIGHT HOURS OF PROFESSIONAL TIME TO CONSIDER ANY RESUBMITTALS SHALL BE PAID FOR BY THE CONTRACTOR. SUCH PAYMENT DOES NOT GUARANTEE APPROVAL. COSTS INCURRED TO THE PROJECT DUE TO PROBLEMS ARISING FROM MULTIPLE RESUBMITTALS ARE TO BE PAID FOR BY THE CONTRACTOR.</p> <p>29. THE EXPRESSION "...OR AS APPROVED" OR "...OR APPROVED EQUAL" OR "...OR EQUAL" MEANS THAT COMPETING PRODUCTS OF A SIMILAR NATURE ARE THOUGHT TO EXIST. THE CONTRACTOR IS ENCOURAGED TO PROPOSE SUBSTITUTION REQUESTS OF SUCH EQUIVALENT PRODUCTS AS LONG AS THE PRODUCT CONFORMS TO ALL PARTS OF THIS SPECIFICATION. WHERE THE ABOVE NOTED EXPRESSIONS ARE OMITTED OR EXPRESSION SUCH AS "NO SUBSTITUTIONS" APPEARS THE CONTRACTOR SHALL PROVIDE ONLY THE PRODUCT INDICATED.</p> <p>30. SUBSTITUTION REQUESTS AND VALUE ENGINEERING RECOMMENDATIONS FROM THE CONTRACTOR WILL BE CONSIDERED IF SUBMITTED WITHIN 30 DAYS OF DIRECTION TO PROCEED FROM THE OWNER. EACH LUMINAIRE SUBSTITUTION REQUEST SHALL INDICATE THE ESTIMATED OR POTENTIAL SAVINGS TO THE OWNER FOR THAT LUMINAIRE FROM THE SPECIFIED DESIGN. THE PROFESSIONAL TIME TO CONSIDER ANY SUBSTITUTION REQUEST OR V.E. REQUEST SHALL BE PAID FOR BY THE</p>		<p>CONTRACTOR, AT A MINIMUM OF EIGHT HOURS. SUCH PAYMENT DOES NOT GUARANTEE APPROVAL. AFTER 30 DAYS, A MINIMUM OF EIGHT HOURS OF PROFESSIONAL TIME TO CONSIDER ANY SUCH REQUEST SHALL BE PAID FOR BY THE CONTRACTOR. SUBMITTAL OF ANY SUBSTITUTION REQUEST OR VALUE ENGINEERING RECOMMENDATION SHALL NOT BE CONSTRUED AS APPROVAL IN ANY WAY. THE OWNER, ARCHITECT AND LIGHTING DESIGNER RESERVE THE RIGHT TO REJECT ANY SUBSTITUTION OR VALUE ENGINEERING RECOMMENDATION WITHOUT EXPLANATION.</p> <p>31. CONTRACTOR MAY BE REQUIRED TO PROVIDE TABLE TOP SAMPLES AND/OR A FAIR MOCKUP OF SPECIFIED FIXTURE AND PROPOSED ALTERNATE. THIS REQUIREMENT SHALL BE EXERCISED AT THE OPTION OF OWNER, ARCHITECT, OR LIGHTING DESIGNER. CONTRACTOR SHALL BE SOLELY RESPONSIBLE FOR ALL COSTS INCURRED BY SUBSTITUTION REQUEST SAMPLE AND/OR MOCKUP PRODUCTION AND REVIEW INCLUDING PROFESSIONAL TIME AND TRAVEL EXPENSES.</p> <p>32. SUBSTITUTIONS OR VALUE ENGINEERING RECOMMENDATIONS SHALL ACCOMMODATE THE IMPACT ON OTHER SPECIFIED SYSTEMS OR PRODUCTS, SUCH AS BALLASTS, DRIVERS, AND DIMMING SYSTEMS. THE LIGHTING SYSTEMS ARE DESIGNED AS COMPLETE AND IT IS THE CONTRACTOR'S RESPONSIBILITY FOR ANY IMPACTS OF ANY CHANGE RECOMMENDED. CONTRACTOR SHALL SUBMIT PRODUCTS WHICH RESULT IN A FULLY FUNCTIONING LIGHTING SYSTEM WHICH OPERATES AS ORIGINALLY DESIGNED.</p> <p>33. SUBSTITUTION REQUESTS AND VALUE ENGINEERING RECOMMENDATIONS SHALL BE DESCRIBED ON CSI STANDARD FORMS AND SHALL INCLUDE PRODUCT CUTSHEET. PRODUCTS SUBMITTED WITHOUT PROPER CSI FORMS SHALL NOT BE APPROVED.</p> <p>34. WHEN REQUESTING A SUBSTITUTION, CONTRACTOR SHALL PROVIDE UNIT AND EXTENDED PRICING FOR SPECIFIED LIGHT FIXTURE, UNIT AND EXTENDED PRICING FOR PROPOSED ALTERNATE, AND UNIT AND EXTENDED DELTA SAVINGS TO OWNER TO BE REALIZED BY USING PROPOSED ALTERNATE. CONTRACTOR SHALL PROVIDE UNIT PRICING FOR EACH FIXTURE TYPE SPECIFIED TO PROVIDE BASELINE COMPARISON FOR SUBSTITUTION REQUEST. CONTRACTOR SHALL GUARANTEE PRICING ON ALL FIXTURE TYPES FOR WHICH A SUBSTITUTION REQUEST HAS BEEN GRANTED. THIS PRICE GUARANTEED SHALL BE PER UNIT AND SHALL BE MAINTAINED THROUGH THE END OF CONSTRUCTION REGARDLESS OF QUANTITY PURCHASED. LIGHTING FIXTURE SUBSTITUTION REQUESTS FOR PRODUCTS USED AS EGRESS OR EMERGENCY LIGHTING SYSTEMS OR EXTERIOR SITE AND ROADWAY LIGHTING SHALL INCLUDE LIGHTING CALCULATION DATA DEMONSTRATING COMPLIANCE WITH RELEVANT CODES AND ORDINANCES. PROVIDE HARDCOPY CALCULATIONS AND DATAFILE IN DIALUX (.evo) FORMAT. SUBSTITUTION REQUESTS WITHOUT SUCH DATA WILL BE REJECTED WITHOUT CONSIDERATION. VE REVIEW TIME SHALL BE PAID FOR BY THE CONTRACTOR.</p> <p>35. EQUIPMENT DELIVERY LEAD-TIME SHALL NOT BE HELD AS A VALID REASON FOR REQUESTING FIXTURE SUBSTITUTION UNLESS FIXTURE LEAD-TIME FROM SPECIFIED MANUFACTURER IS IN EXCESS OF 14 WEEKS. IT SHALL BE THE SOLE RESPONSIBILITY OF THE CONTRACTOR TO DETERMINE NECESSARY EQUIPMENT LEAD TIMES, DELIVER SUBMITTALS FOR REVIEW IN A TIMELY FASHION, AND PLACE ORDERS ACCORDINGLY TO ENSURE TIMELY DELIVERY.</p> <p>36. CONTRACTOR SHALL ADJUST AIMABLE LUMINAIRES AS DIRECTED BY LIGHTING DESIGNER. CONTRACTOR SHALL PROVIDE MANPOWER AND EQUIPMENT, INCLUDING LADDERS, LIFTS, TOOLS, ETC., AND ALLOW FOR THIS ACTIVITY TO OCCUR DURING PREMIUM NIGHT AND/OR WEEKEND TIME. CONTRACTOR SHALL INCLUDE A MINIMUM OF 20 HOURS IN HIS BID FOR THIS EFFORT.</p> <p>37. THE GENERAL CONTRACTOR, ELECTRICAL CONTRACTOR(S), AND LOW VOLTAGE CONTRACTOR(S) SHALL ASK QUESTIONS VIA TELEPHONE, EMAIL, OR WRITTEN CORRESPONDENCE PRIOR TO MAKING A COMPLETE MESS OF THINGS. CONTRACTORS WHO FAIL TO ASK QUESTIONS SHALL BE FED TO THE RAVENOUS BUGBLATTER BEAST OF TRAAL.</p> <p>38. THE GENERAL CONTRACTOR SHALL CONFIRM THAT ALL BIDDERS AND SUBCONTRACTORS HAVE READ THE PRECEDING THIRTY-EIGHT NOTES BY SUBMITTING A SCAN OR PHOTOGRAPH OF THIS NOTE, SIGNED BY THE BIDDER(S). BIDDERS WHO FAIL TO SUBMIT THIS NOTE SHALL HAVE THEIR BIDS REJECTED WITHOUT CONSIDERATION.</p> <p>39. THE GENERAL CONTRACTOR SHALL PROVIDE A MINIMUM OF TWELVE (12) PERFORATED PASTRY UNITS AND COFFEE AT ALL CONSTRUCTION MEETINGS. DECAFFEINATED COFFEE SHALL BE REJECTED WITHOUT CONSIDERATION. THE CONTRACTOR SHALL PROTECT THE CONSTRUCTION DOCUMENTS FROM DIRECT CONTACT WITH THE PERFORATED PASTRY UNITS.</p>			
POWER DEVICES					
SYMBOL	DESCRIPTION	SYMBOL	DESCRIPTION	SYMBOL	DESCRIPTION
	SIMPLEX RECEPTACLE - WALL, CEILING, ON ALT.		RECESSED LENSED TROFFER (SIZE/SHAPE VARIES)		SINGLE POLE SWITCH (SUPERScript DENOTES SIMILARLY MARKED LUMINAIRES CONTROLLED TOGETHER. NO SUBSCRIPT INDICATES SWITCH TO CONTROL ALL LIGHTING WITHIN ROOM, U.O.N.).
	DUPLEX RECEPTACLE - WALL, CEILING, ON ALT.		RECESSED PARABOLIC TROFFER (SIZE/SHAPE VARIES)		TWO POLE SWITCH
	DOUBLE DUPLEX RECEPTACLE - WALL, CLG, ON ALT.		SURFACE LENSED LUMINAIRE (SIZE/SHAPE VARIES)		THREE WAY SWITCH
	RECEPTACLE TYPE SHOWN -WALL -ABOVE COUNTER BACKSPLASH. SEE ARCHITECTURAL DRAWINGS.		SURFACE PARABOLIC TROFFER (SIZE/SHAPE VARIES)		FOUR WAY SWITCH
	SHADED RECEPTACLES NOTED "ON ALT." ABOVE ARE CONNECTED TO ALTERNATE POWER SOURCE (EMERG., STANDBY, UPS, ETC.) PER CIRCUITING INDICATED		SHADING OF ANY LUMINAIRE INDICATES CONNECTION TO ALTERNATE POWER SOURCE (EMERGENCY, UPS, STANDBY, ETC.) PER CIRCUITING INDICATED		KEY OPERATED SWITCH
	DUPLEX RECEPTACLE - WALL - HALF SWITCHED		SUSPENDED LINEAR PENDANT (SIZE/SHAPE VARIES)		DIMMER SWITCH. NUMBER INDICATES WATTAGE RATING. IF NOT SHOWN THEN EQUAL TO LOAD.
	COMBINATION SWITCH/DUPLEX RECEPTACLE		NON LINEAR PENDANT (SIZE, SHAPE VARIES)		JAMB SWITCH
	DUPLEX RECEPTACLE - WALL - WITH INTEGRAL GROUND FAULT CIRCUIT INTERRUPTER		DOWNLIGHT OR POINT SOURCE - SURFACE, RECESSED CEILING MTD.		TIMER SWITCH
	RECEPT. TYPE SHOWN W/ WEATHERPROOF COVER		DIRECTIONAL OR WALLWASH - SURFACE, RECESSED CEILING MTD.		EXPLOSION PROOF SWITCH
	RECEPT. TYPE SHOWN AT SPECIAL HEIGHT		RECESSED BATH FAN OR FAN/LIGHT		WEATHERPROOF SWITCH
	CLOCK HANGER RECEPTACLE		SURFACE OR PENDANT CEILING FAN - PROVIDE APPROPRIATE BRACED JUNCTION BOX		LINE VOLTAGE, VARIABLE SPEED FAN CONTROL LOCATE ADJACENT TO ADJACENT TO LIGHT SWITCHES
	MOTORIZED SHADE. VERIFY MOTOR LOCATIONS WITH SHADE VENDOR AND INSTALLER.		LINEAR LOW VOLTAGE COVE OR UNDERCABINET		MULTI-BUTTON LIGHTING CONTROL SWITCH INDIVIDUAL SWITCH CONFIGURATION VARIES.
	FLUSH FLOOR BOX DEVICE - DEVICE TYPE PER SYMBOLS ABOVE		TRACK OR LOW VOLTAGE LIGHTING WITH HEADS		PHOTOCELL
	PEDESTAL FLOOR DEVICE - DEVICE TYPE PER SYMBOLS ABOVE		STRIPLIGHT		TIME CLOCK
	IN RAISED FLOOR - SEE ARCH DWGS; WITH MULTI-SERVICE FLOOR BOX CAST IN CONC. OR RECEPTACLES & SIGNAL OUTLETS AS NOTED.		STRIPLIGHT WITH REFLECTOR OR LENS		OCCUPANCY SENSOR - WALL MOUNTED
	JUNCTION BOX PROVIDE BLANK COVER U.N.O.		SCONCE, "FOOT" INDICATES WALL MOUNTING. VERIFY HEIGHT WITH ARCHITECT, INTERIOR DESIGNER.		360 DEGREE OCCUPANCY SENSOR - CEILING MTD.
			WALL MOUNTED LINEAR (SIZES VARY)		180 DEGREE OCCUPANCY SENSOR - CEILING MTD.
			RECESSED STEPLIGHT		CORRIDOR/AISLE OCCUPANCY SENSOR - CEILING MOUNTED
			BATTERY POWER EMERGENCY UNIT EQUIPMENT (SEE LUMINAIRE SCHEDULE FOR QUANTITY OF HEADS) - WALL, CEILING MOUNTED.		OCCUPANCY SENSOR & SWITCH GANGED UNDER A COMMON COVER PLATE. OCCUPANY SENSOR TO CONTROL ALL LIGHT FIXTURES IN ROOM WITH 1/2 LIGHT REDUCTION CONTROLLED BY SWITCH, DESIGNATED BY LETTER.
			ILLUMINATED EXIT SIGN, SHADED QUADRANT INDICATES FACES, ARROWS AS SHOWN		LIGHTING CONTROL PANEL AND ASSOCIATED COMPONENTS. PROVIDE 120V OR 277V CONTROL POWER AS REQUIRED OR AS INDICATED.
			FLOOR OR GRADE MOUNTED BOLLARD		REMOTE MOUNTED LINE TO LOW-VOLTAGE FUSED TRANSFORMER OR POWER SUPPLY. CONCEAL FROM VIEW.
			FLUSH GRADE POINT SOURCE		
			POLE MOUNTED LUMINAIRE- SINGLE OR DUAL HEAD ARROW INDICATES OPTICAL ORIENTATION		
			POLE TOP MOUNTED LUMINAIRE		
			LUMINAIRE MARKING CONVENTIONS: LETTER DESIGNATION FOLLOWED BY SEQUENTIAL NUMBER		
			L# = LED		
			D# = DECORATIVE		
			S# = SITE SPECIFIC		
			X# = EXIT SIGN		
			E# = EMERGENCY SPECIFIC		
			CIRCUITING CONVENTION: 107# = ARCHITECTURAL ROOM NUMBER ###1 = SEQUENTIAL CIRCUIT IN ROOM. ####DC = 0-10VDC CONTROL CIRCUIT		

LIGHTING REFERENCES	
1. IESNA HANDBOOK 9TH EDITION, 2010 2. NATIONAL ELECTRIC CODE VERSION 2023 3. IECC 2021 4.	
LIGHTING SHEET INDEX	
LIGHT-000	LIGHTING LEGEND
LIGHT-100	SITE LIGHTING
LIGHT-101	SITE LIGHTING CALCULATIONS
LIGHT-102	SITE LIGHTING CUTSHEETS

LIGHTING LEGEND	
LIGHT-000	

9 NORTH WILDHORSE

NEW CASTLE, COLORADO

ALPENGLOW LIGHTING DESIGN, INC.
4341 county road 113, carbondale, colorado 81623
(970) 948-2657 aaron@alpenglowinc.com

Lighting design, arrangements, plans, specifications, and ideas presented by these drawings are the sole property and copyright of Alpenglow Lighting Design, Inc. and shall not be used without written permission.

LIGHTING LEGEND

LIGHT-000

FINAL PLAN

original issue dates:
8/26/24

revision dates:

9 NORTH WILDHORSE

NEW CASTLE, COLORADO

ALPENGLOW Lighting Design, Inc.
4341 County Road 115, Canonville, Colorado 86237
(970) 548-2457 | info@alpenglow.com

LIGHTING LEGEND

LIGHT-000

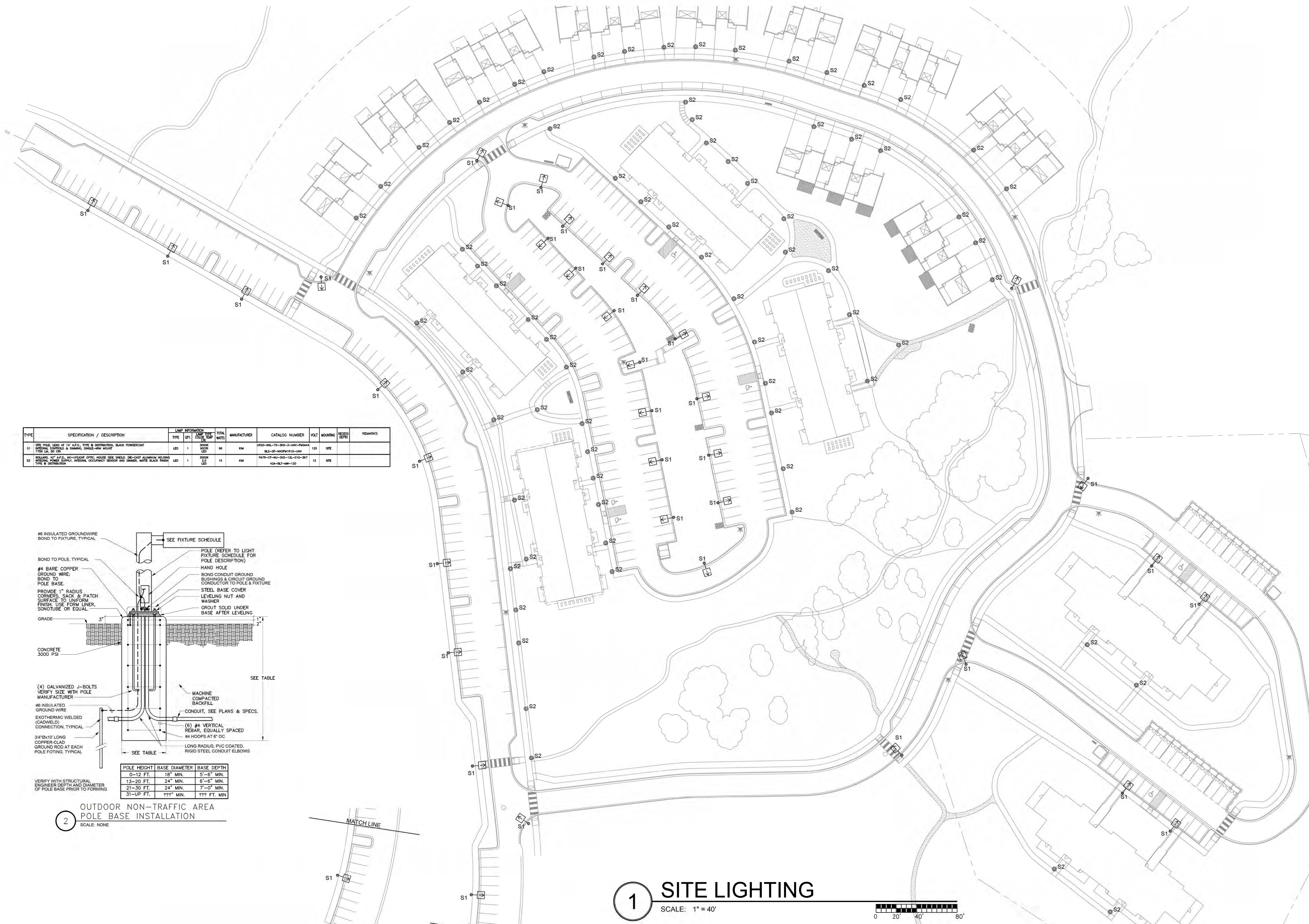

TYPE	SPECIFICATION / DESCRIPTION	LAMP INFORMATION	TYPE	QTY	WATTAGE	MANUFACTURER	CATALOG NUMBER	VOLT	MOUNTING	REMARKS
S1	SITE POLE, LENS AT 14' A.F.S., TYPE II DISTRIBUTION, BLACK POWDERCOAT FINISH, 10' L.S. 10' H.	LED	1	3000K	95	RM	US20-M6-70-309-3-UN-FM44	120	SITE	
S2	S2 POLE, LENS AT 14' A.F.S., TYPE II DISTRIBUTION, BLACK POWDERCOAT FINISH, 10' L.S. 10' H.	LED	1	3000K	15	RM	US20-M6-70-309-3-UN-FM44	120	SITE	

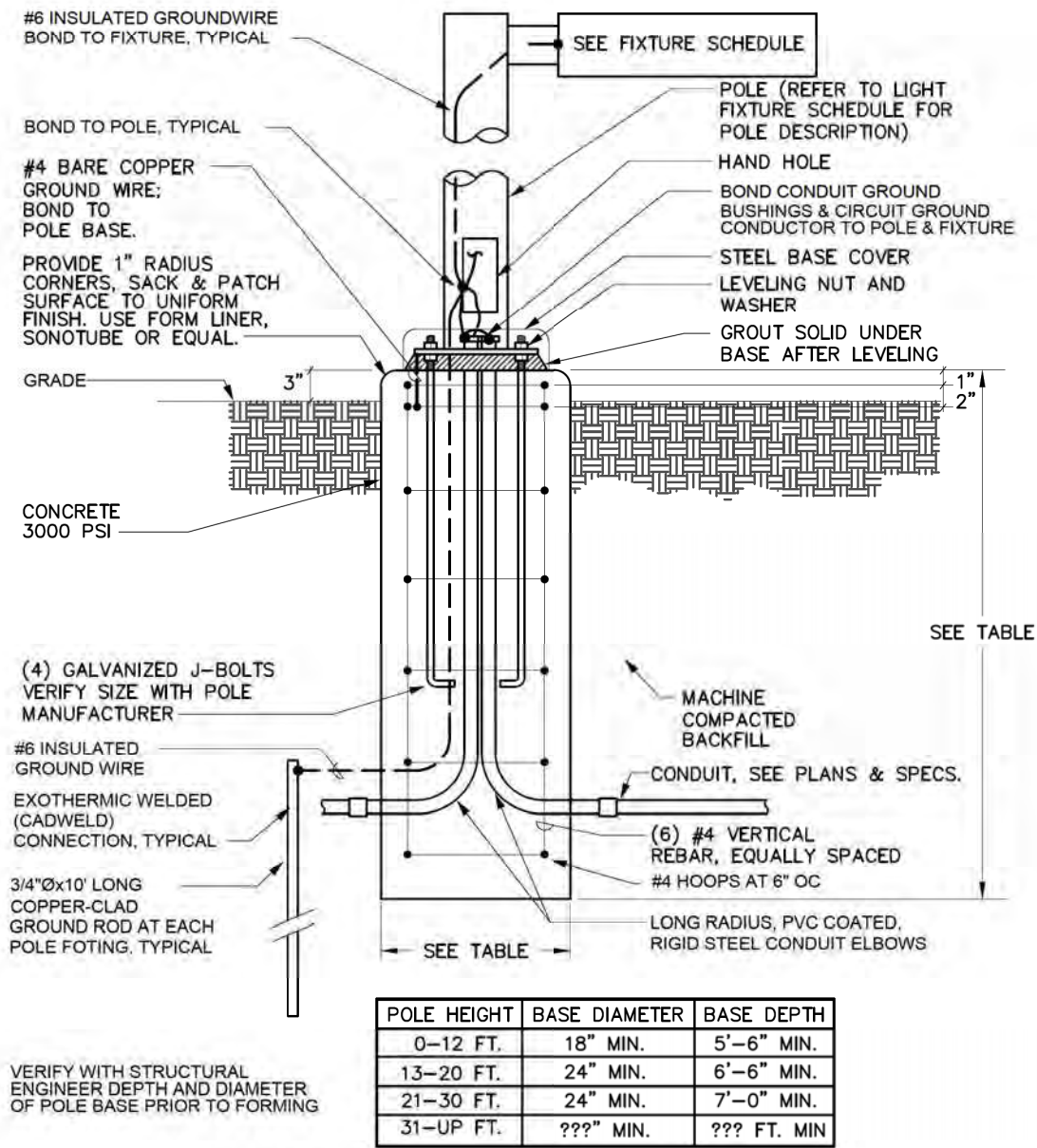

2 OUTDOOR NON-TRAFFIC AREA
POLE BASE INSTALLATION
SCALE: NONE

1 SITE LIGHTING
SCALE: 1" = 40'



FINAL PLAN
original issue date:
8/26/24
revision dates:

9 NORTH WILDHORSE
NEW CASTLE, COLORADO



Lighting design, arrangements, plans,
specifications, and ideas presented by these
drawings are the sole property and copyright of
Alpenglow Lighting Design, Inc. and shall not be
used without written permission.

SITE LIGHTING
PLAN

LIGHT-
100



#	Name	Parameter	Min	Max	Average	Min/Average	Min/Max
1	SITE	Perpendicular Illuminance	0.00 fc	5.2 fc	0.40 fc	0.00	0.00

1

SITE LIGHTING CALCULATIONS

SCALE: 1" = 40'

0 20' 40' 80'

FINAL PLAN
original issue date:
8/26/24
revision dates:

9 NORTH WILDHORSE
NEW CASTLE, COLORADO



Lighting design, arrangements, plans, specifications, and data presented by these drawings are the sole property and copyright of Alpenglow Lighting Design, Inc. and shall not be used without written permission.

SITE LIGHTING CALCULATIONS

LIGHT-101

