

# NBU Headquarters

## Quarterly Update

**Quarter Three 2024**  
*May 30, 2024*



**Meet the Team**

**Building Value & Principles**

**Progress Update**

**Looking Ahead**

# Meet the Team

Architect

**MarmonMok**  
ARCHITECTURE

Owner's  
Representative

 **FREEESE  
AND  
NICHOLS**

Construction  
Manager at Risk

**SpawGlass**

## Mission

Strengthening our community by providing resilient essential services

+

## Vision

Be a trusted community partner dedicated to excellence in service

+

## Core Values

Safety, Team, Integrity, Culture, and Stewardship

**NBU** NEW BRAUNFELS  
UTILITIES

# Meet the Vision Team



## Mission

Strengthening our community by providing resilient essential services

+

## Vision

Be a trusted community partner dedicated to excellence in service

+

## Core Values

Safety, Team, Integrity, Culture, and Stewardship

# Executive Steering Committee



## Mission

Strengthening our community by providing resilient essential services

+

## Vision

Be a trusted community partner dedicated to excellence in service

+

## Core Values

Safety, Team, Integrity, Culture, and Stewardship

# Building Guiding Principles

## DESIGN PRINCIPLES

NBU HQ | VISION TEAM & STAKEHOLDER MEETING SUMMARY | DEC 05 2023

### MISSION

Strengthening our community by providing resilient essential services.

### VISION

Be a trusted community partner dedicated to excellence in service.

### GUIDING PRINCIPLES

- 1 Being a good neighbor by incorporating NBU Guiding principles and values.
- 2 Providing a campus for NBU customers and employees that is safe and inviting.
- 3 A campus that is sustainable and incorporates energy and water saving concepts that can be used to educate the community.
- 4 A campus that supports, unites, and celebrates the hard-working employees NBU and their families.
- 5 A project that uses funds in a responsible way, while meeting the current and future needs of NBU.
- 6 An innovative building that supports resilience for the community.
- 7 A campus that improves efficiency by promoting collaboration with all NBU departments.



3

## Mission

Strengthening our community by providing resilient essential services



## Vision

Be a trusted community partner dedicated to excellence in service



## Core Values

Safety, Team, Integrity, Culture, and Stewardship

# Site Plan

## Legend Key

- ① Training and Testing Field
- ② Equipment Building
- ③ Recycle/Trash Dumpsters
- ④ Dock
- ⑤ Warehouse
- ⑥ Administration Bldg.
- ⑦ Indoor Storage
- ⑧ Wire Storage
- ⑨ Pipe Storage
- ⑩ Wood Pole Storage
- ⑪ Transformer Storage
- ⑫ Steel Pole Storage
- ⑬ Maintenance Bldg.
- ⑭ Protection Area
- ⑮ Creek
- ⑯ Paved Yard
- ⑰ Oversized Parking
- ⑱ Fleet Parking
- ⑲ Employee Parking
- ⑳ Public Parking
- ㉑ Walking Trail
- ㉒ Crew Ops
- ㉓ Dock Parking
- ㉔ Bulk Storage
- ㉕ Employee Courtyard
- ㉖ Ground Storage Tank
- ㉗ Site Fencing
- ㉘ Monument Sign
- ㉙ Executive Parking
- ㉚ Covered Walkway



NOT FOR REGULATORY APPROVAL, PERMITTING, OR CONSTRUCTION | BRIAN HARKENRICH - ARCHITECT - REGISTRATION NUMBER 12688

## Mission

Strengthening our community by providing resilient essential services



## Vision

Be a trusted community partner dedicated to excellence in service



## Core Values

Safety, Team, Integrity, Culture, and Stewardship

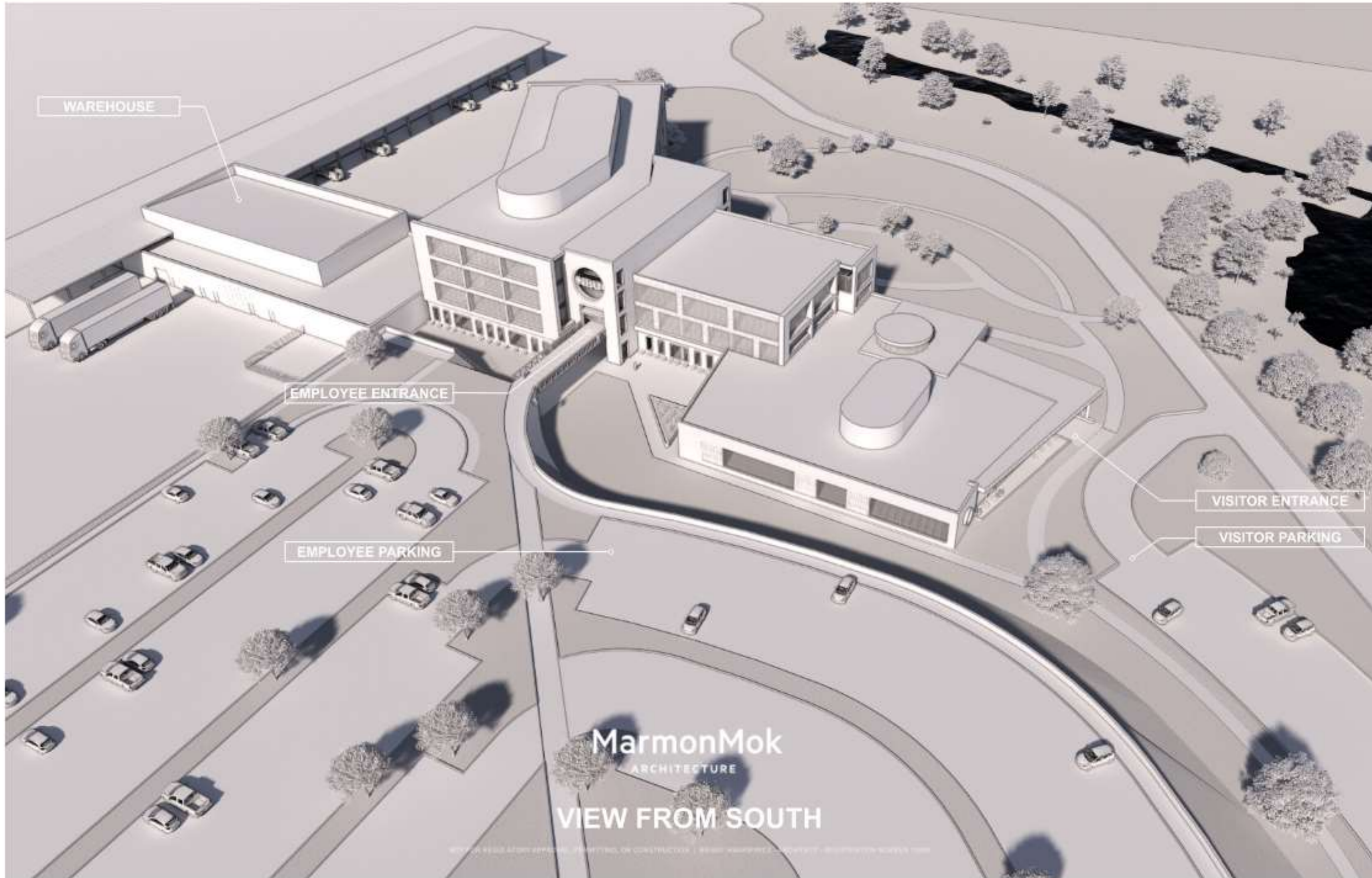

**Mission**

Strengthening our community by providing resilient essential services

**+ Vision**

Be a trusted community partner dedicated to excellence in service

**+ Core Values**

Safety, Team, Integrity, Culture, and Stewardship





**Mission**

Strengthening our community by providing resilient essential services

**+ Vision**

Be a trusted community partner dedicated to excellence in service

**+ Core Values**

Safety, Team, Integrity, Culture, and Stewardship

# Anticipated Schedule

## Design



October 2023 - December 2024

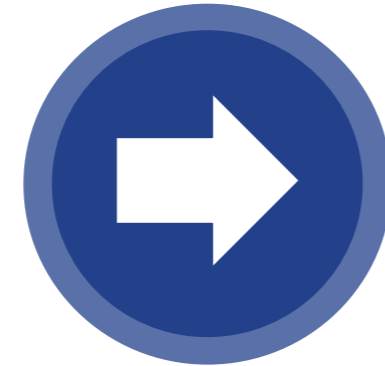

## Construction



December 2024 – Mid 2027

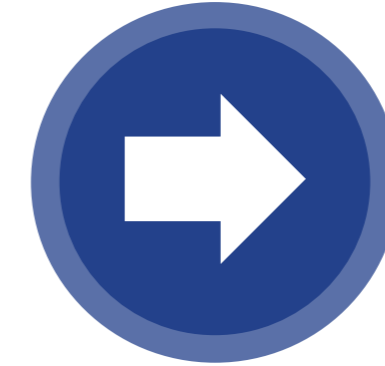

## Move-In



Mid 2027

### Mission

Strengthening our community by providing resilient essential services

+

### Vision

Be a trusted community partner dedicated to excellence in service

+

### Core Values

Safety, Team, Integrity, Culture, and Stewardship



**Mission**

Strengthening our community by providing resilient essential services

+

**Vision**

Be a trusted community partner dedicated to excellence in service

+

**Core Values**

Safety, Team, Integrity, Culture, and Stewardship