

TRANSMITTAL

TO: City of Desert Hot Springs
11999 Palm Drive
Desert Hot Springs, CA 92240

DATE: September 30, 2024

PROJECT: TRACT MAP No. 38816
FM - 24 - 1

ATTN: Daniel Lopez
Engineering Technician

NV5 JOB No.: 227022-0001534.56

The Following Items Are Being Forwarded:

Attached
Via e-mail - dlopez@cityofdhs.org

Item	Quantity	For Your Use	As Requested	For Your Review
4 th Plan Check: Comments spreadsheet, for final Tract Map No. 38816 (PDF version 6 pages)	1	<input checked="" type="checkbox"/>	<input type="checkbox"/>	<input checked="" type="checkbox"/>
		<input type="checkbox"/>	<input type="checkbox"/>	<input type="checkbox"/>
		<input type="checkbox"/>	<input type="checkbox"/>	<input type="checkbox"/>

Remarks:

Daniel,
The attached 4th Plan Check for the subject Tract Map has been found to be satisfactory for approval by the City Surveyor and signed mylars may be submitted to the City for further processing.

Contact me should you have any questions or need any additional information.

cc: Jay Fahrion, PLS

From: Doug Boyle, PLS
760-404-1975



PLAN CHECK COMMENTS
City of Desert Hot Springs

Documents: **TRACT MAP No. 38816**
Milestone: **4th Plan Check**
Review Data: 3rd Plan Check

Prepared By: DOUG BOYLE, PLS
Received Date: Sept. 23, 2024
City File Number: **FM-24-1**

Please make your remarks in the "Response to Comments" column. **Return this form and the redlined Map markup** along with the revised map with your next submittal.

Comment ID Number	Dwg/Spec General	Location	Review Comments	Response to Comments	Complete
PLAN CHECK No. 4					
	ECS SHEET		The Environmental Constraint Sheet has been reviewed and found to be satisfactory for approval.		
	FINAL TRACT MAP		The Map has been reviewed and found to be technically correct and satisfactory for approval by the Acting City Surveyor.		
	COMMENT		Signed mylars may be submitted to the City for the final Tract Map and ECS for final processing and approval.		

I hereby certify that this Plan Check No. 4 was prepared by me or under my direction on September 30, 2024.

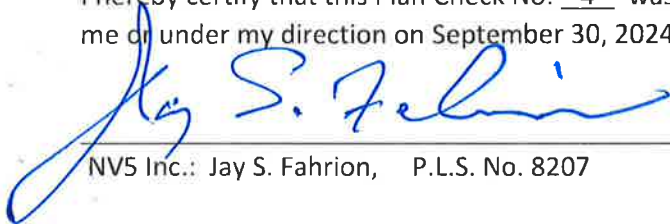

NV5 Inc.: Jay S. Fahrion, P.L.S. No. 8207



IN THE CITY OF DESERT HOT SPRINGS, COUNTY OF RIVERSIDE, STATE OF CALIFORNIA

TRACT NO. 38816

BEING A SUBDIVISION OF PARCEL "B" AND "C" OF LLA 21-1, PER INSTRUMENT NO. 2021-0636911, RECORDED 10/27/21, OFFICIAL RECORDS OF RIVERSIDE COUNTY, CALIFORNIA, TOGETHER WITH LOT 'R' OF TRACT 38200, M.B. 494/24-27, INCLUSIVE, AND LOTS 34-41, INCLUSIVE, LOT "G", AND A PORTION OF LOTS "A", "F", AND "J" OF TRACT 22287-1, M.B. 234/4-7, INCLUSIVE, RECORDS OF RIVERSIDE COUNTY, CALIFORNIA



FEBRUARY 2024

RECORDER'S STATEMENT

FILED THIS ____ DAY OF _____ 2024, AT _____.M.
IN BOOK _____ OF MAPS, AT PAGES _____, AT THE
REQUEST OF THE CITY OF DESERT HOT SPRINGS.
NO. _____
FEE: _____

PETER ALDANA, ASSESSOR – COUNTY CLERK – RECORDER

BY: _____, DEPUTY
SUBDIVISION GUARANTEE: FIRST AMERICAN TITLE COMPANY

OWNERS' STATEMENT

WE HEREBY STATE THAT WE ARE THE OWNERS OF THE LAND INCLUDED WITHIN THE SUBDIVISION SHOWN HEREON; THAT WE ARE THE ONLY PERSONS WHOSE CONSENT IS NECESSARY TO PASS A CLEAR TITLE TO SAID LAND; THAT WE CONSENT TO THE MAKING AND RECORDING OF THIS SUBDIVISION MAP AS SHOWN WITHIN THE DISTINCTIVE BORDERLINE.

THE REAL PROPERTY DESCRIBED BELOW IS DEDICATED AS AN EASEMENT TO THE CITY OF DESERT HOT SPRINGS FOR THE RIGHT OF INGRESS AND EGRESS FOR SERVICE AND EMERGENCY VEHICLES AND PERSONNEL, OVER LOT "D" SHOWN AS PRIVATE STREET WITHIN THIS MAP.

THE REAL PROPERTY DESCRIBED BELOW IS DEDICATED AS AN EASEMENT FOR PUBLIC PURPOSES: DOMESTIC WATER EASEMENT OVER LOT "D" SHOWN AS "PRIVATE STREET" AND THE EASEMENT SHOWN AS "5' P.U.E.". THE DEDICATION IS FOR DOMESTIC WATER PURPOSES IN FAVOR OF MISSION SPRINGS WATER DISTRICT. THE EASEMENTS SO DEDICATED INCLUDE THE RIGHT TO ENTER UPON SAID LANDS, TO SURVEY, CONSTRUCT, RECONSTRUCT, LAY, RELAY, MAINTAIN, OPERATE, CONTROL, USE AND REMOVE PIPELINES, FIXTURES AND APPURTENANCES, AND TO REMOVE OBJECTS INTERFERING WITH THE CONSTRUCTION, OPERATION AND MAINTENANCE THEREOF. MISSION SPRINGS WATER DISTRICT WILL NOT BE RESPONSIBLE FOR ANY IMPROVEMENTS WITHIN SAID EASEMENT(S) IN THE EVENT THAT OPERATION AND MAINTENANCE ACTIVITIES RESULT IN DAMAGE OR REMOVAL OF SAID IMPROVEMENTS.

THE REAL PROPERTY DESCRIBED BELOW IS DEDICATED AS AN EASEMENT SHOWN AS "5' P.U.E." FOR PUBLIC UTILITY PURPOSES.

WE HEREBY RETAIN LOT "D", INDICATED AS "PRIVATE STREETS", AS SHOWN HEREON FOR THE PRIVATE USE FOR THE SOLE BENEFIT OF OURSELVES, OUR SUCCESSORS, ASSIGNS AND RESIDENTIAL LOT OWNERS WITHIN THIS MAP.

WE HEREBY RETAIN LOT "A" INDICATED AS "LANDSCAPE AREA", AS SHOWN HEREON FOR PRIVATE USE FOR THE SOLE BENEFIT OF OURSELVES, OUR SUCCESSORS, ASSIGNS AND RESIDENTIAL LOT OWNERS WITHIN THIS MAP.

WE HEREBY RETAIN LOT 'B' AND LOT 'C' FOR PRIVATE USE FOR THE SOLE BENEFIT OF OURSELVES, OUR SUCCESSORS, ASSIGNEES AND LOT OWNERS WITHIN THIS MAP.

GH A PALOMA GROUP VIII, LLC
A CALIFORNIA LIMITED LIABILITY COMPANY

AVENTURA PALMS HOMEOWNERS
ASSOCIATION, A CALIFORNIA
NON-PROFIT MUTUAL BENEFIT
CORPORATION

BY: _____ BY: _____

PRINT NAME: _____ PRINT NAME: _____

IT'S: _____ IT'S: _____

NOTARY ACKNOWLEDGEMENT

SEE SHEET 2

SIGNATURE OMISSIONS

SEE SHEET 2

TAX BOND CERTIFICATE

I HEREBY CERTIFY THAT A BOND IN THE SUM OF \$ _____ HAS BEEN EXECUTED AND FILED WITH THE BOARD OF SUPERVISORS OF THE COUNTY OF RIVERSIDE, STATE OF CALIFORNIA, CONDITIONED UPON THE PAYMENT OF ALL THE TAXES, STATE, COUNTY, MUNICIPAL, OR LOCAL AND ALL SPECIAL ASSESSMENTS COLLECTED AS TAXES, WHICH AT THE TIME OF FILING OF THIS MAP WITH THE COUNTY RECORDER ARE A LIEN AGAINST SAID PROPERTY BUT NOT YET PAYABLE AND SAID BOND HAS BEEN DULY APPROVED BY SAID BOARD OF SUPERVISORS.

DATED: _____, 2024

CASH OR SURETY BOND
MATTHEW JENNINGS
COUNTY TAX COLLECTOR

BY: _____, DEPUTY

TAX COLLECTOR'S CERTIFICATE

I HEREBY CERTIFY THAT ACCORDING TO THE RECORDS OF THIS OFFICE, AS OF THIS DATE, THERE ARE NO LIENS AGAINST THE PROPERTY SHOWN ON THE WITHIN MAP FOR UNPAID STATE, COUNTY, MUNICIPAL OR LOCAL TAXES OR SPECIAL ASSESSMENTS COLLECTED AS TAXES, EXCEPT TAXES OR SPECIAL ASSESSMENTS COLLECTED AS TAXES NOW A LIEN BUT NOT YET PAYABLE, WHICH ARE ESTIMATED TO BE \$ _____.

DATED: _____, 2024

MATTHEW JENNINGS
COUNTY TAX COLLECTOR

BY: _____, DEPUTY

CITY CLERK'S STATEMENT

I, JERRY L SORIANO, CITY CLERK OF THE CITY OF DESERT HOT SPRINGS, CALIFORNIA, DO HEREBY STATE THAT SAID CITY COUNCIL AT ITS REGULAR MEETING HELD ON THE ____ DAY OF _____, 2024, DULY APPROVED THE FINAL MAP OF TRACT NO. 38816 AND ACCEPTED THE EASEMENT OFFER LOT 'D' THE RIGHT OF INGRESS AND EGRESS FOR SERVICE AND EMERGENCY VEHICLES AND PERSONNEL AS DEDICATED AND SHOWN WITHIN THIS MAP.

DATED: _____, 2024 BY: _____
CITY CLERK, CITY COUNCIL OF
THE CITY OF DESERT HOT SPRINGS

CERTIFICATE OF ACCEPTANCE

I HEREBY CERTIFY THAT UNDER AUTHORITY GRANTED TO ME BY MINUTE MOTION NO. _____ DATED _____, I ACCEPT ON BEHALF OF MISSION SPRINGS WATER DISTRICT THE DEDICATION OF EASEMENTS FOR DOMESTIC WATER AND SANITARY SEWER FACILITIES PURPOSES AS OFFERED HEREON.

DISTRICT MANAGER
MISSION SPRINGS WATER DISTRICT

ENVIRONMENTAL CONSTRAINT NOTE

ENVIRONMENTAL CONSTRAINT SHEET AFFECTING THIS MAP IS ON FILE IN THE OFFICE OF THE RIVERSIDE COUNTY SURVEYOR IN E.C.S. BOOK _____, PAGE _____. THIS AFFECTS ALL PARCELS.

SURVEYOR'S STATEMENT

THIS MAP WAS PREPARED BY ME OR UNDER MY DIRECTION AND IS BASED UPON A FIELD SURVEY IN CONFORMANCE WITH THE REQUIREMENTS OF THE SUBDIVISION MAP ACT AND LOCAL ORDINANCE AT THE REQUEST OF GH A PALOMA GROUP VIII, LLC IN FEBRUARY, 2024.

I HEREBY STATE THAT ALL MONUMENTS ARE OF THE CHARACTER AND OCCUPY THE POSITIONS INDICATED OR THAT WILL BE SET IN ACCORDANCE WITH TERMS OF THE SUBDIVISION IMPROVEMENT AGREEMENT FOR THE MAP AND THAT THE MONUMENTS ARE, OR WILL BE SUFFICIENT TO ENABLE THE SURVEY TO BE RETRACED, AND THAT THIS FINAL MAP SUBSTANTIALLY CONFORMS TO THE CONDITIONALLY APPROVED TENTATIVE MAP. THIS SURVEY IS TRUE AND COMPLETE AS SHOWN.

DATED: _____, 2024

FOR REVIEW
DAVID HACKER, PLS NO. 5128



CITY ENGINEER'S STATEMENT

I HEREBY STATE THAT I HAVE EXAMINED THE WITHIN FINAL MAP OF TRACT NO. 38816, CONSISTING OF FOUR (4) SHEETS, THAT THE SUBDIVISION SHOWN HEREON IS SUBSTANTIALLY THE SAME AS IT APPEARED ON THE TENTATIVE MAP OR ANY APPROVED ALTERATIONS THEREOF; THAT ALL PROVISIONS OF THE STATE SUBDIVISION MAP ACT AND ANY LOCAL ORDINANCES APPLICABLE AT THE TIME OF APPROVAL OF THE TENTATIVE MAP HAVE BEEN COMPLIED WITH.

DATE: _____, 2024

CITY ENGINEER

CITY SURVEYOR'S STATEMENT

I HEREBY STATE THAT I HAVE EXAMINED THE WITHIN FINAL MAP OF TRACT NO. 38816, CONSISTING OF FOUR (4) SHEETS AND I AM SATISFIED THAT SAID MAP IS TECHNICALLY CORRECT.

DATE: _____, 2024

JAY S. FAHRION, P.L.S. 8207
ACTING CITY SURVEYOR



IN THE CITY OF DESERT HOT SPRINGS, COUNTY OF RIVERSIDE, STATE OF CALIFORNIA

NO FURTHER COMMENTS SHEET 2 OF 4 SHEETS

TRACT NO. 38816

BEING A SUBDIVISION OF PARCEL "B" AND "C" OF LLA 21-1, PER INSTRUMENT NO. 2021-0636911, RECORDED 10/27/21, OFFICIAL RECORDS OF RIVERSIDE COUNTY, CALIFORNIA, TOGETHER WITH LOT 'R' OF TRACT 38200, M.B. 494/24-27, INCLUSIVE, AND LOTS 34-41, INCLUSIVE, LOT "G", AND A PORTION OF LOTS "A", "F", AND "J" OF TRACT 22287-1, M.B. 234/4-7, INCLUSIVE, RECORDS OF RIVERSIDE COUNTY, CALIFORNIA



FEBRUARY 2024

SIGNATURE OMISSIONS

AN EASEMENT FOR UNDERGROUND ELECTRIC SUPPLY SYSTEMS, COMMUNICATION SYSTEMS AND INCIDENTAL PURPOSES IN FAVOR OF SOUTHERN CALIFORNIA EDISON CO. RECORDED NOVEMBER 29, 1983 AS INSTRUMENT NO. 83-247651, OFFICIAL RECORDS.

EASEMENT FOR EITHER POLE OR BOTH POLE LINES, CONDUITS OR UNDERGROUND FACILITIES AND INCIDENTAL PURPOSES IN FAVOR OF SOUTHERN CALIFORNIA EDISON CO. RECORDED MARCH 13, 1978 AS INSTRUMENT NO. 46777, OFFICIAL RECORDS.

50' WIDE EASEMENT FOR EITHER OR BOTH POLE LINES, CONDUITS OR UNDERGROUND FACILITIES AND INCIDENTAL PURPOSES IN FAVOR OF IMPERIAL IRRIGATION DISTRICT AFFECTING LOTS A AND F OF PARCEL 7, RECORDED MAY 28, 1956 AS BOOK 1919, PAGE 17, OFFICIAL RECORDS. CONVEYED TO SOUTHERN CALIFORNIA EDISON CO. IN DOCUMENT RECORDED MARCH 6, 1986 AS INSTRUMENT NO. 52240, OFFICIAL RECORDS.

EASEMENT FOR RIGHT OF WAY TO LAY CONSTRUCT, MAINTAIN, OPERATE, REPAIR, RENEW, CHANGE THE SIZE OF AND REMOVE ONE OR MORE PIPELINES, WITH THE RIGHT OF INGRESS AND EGRESS TO AND FROM AND INCIDENTAL PURPOSES, IN FAVOR OF SOUTHERN CALIFORNIA GAS COMPANY, RECORDED APRIL 27, 1993 AS INSTRUMENT NO. 153415, OFFICIAL RECORDS. BLANKET IN NATURE.

EASEMENT CONTAINED IN THE DOCUMENT ENTITLED "CABLE TELEVISION CONSTRUCTION WIRING AGREEMENT AND EASEMENT", AFFECTING PARCEL 1 AND LOT 42 OF PARCEL 2, RECORDED APRIL 13, 1994 AS INSTRUMENT NO. 154045, OFFICIAL RECORDS. LOCATION OF EASEMENT CANNOT BE DETERMINED.

EASEMENT FOR PUBLIC UTILITIES AND ACCESS AND INCIDENTAL PURPOSES RECORDED MAY 23, 1994 AS INSTRUMENT NO. 209657, OFFICIAL RECORDS. BLANKET IN NATURE.

NOTARY ACKNOWLEDGEMENT

A NOTARY PUBLIC OR OTHER OFFICER COMPLETING THIS CERTIFICATE VERIFIES ONLY THE IDENTITY OF THE INDIVIDUAL WHO SIGNED THE DOCUMENT TO WHICH THIS CERTIFICATE IS ATTACHED, AND NOT THE TRUTHFULNESS, ACCURACY, OR VALIDITY OF THAT DOCUMENT.

STATE OF CALIFORNIA) S.S.
COUNTY OF RIVERSIDE)

ON _____, 2024, BEFORE ME, _____, A

NOTARY PUBLIC, IN AND FOR SAID STATE, PERSONALLY APPEARED _____ WHO PROVED TO ME ON THE BASIS OF SATISFACTORY EVIDENCE TO BE THE PERSON(S) WHOSE NAME(S) IS/ARE SUBSCRIBED TO THE WITHIN INSTRUMENT AND ACKNOWLEDGED TO ME THAT HE/SHE/THEY EXECUTED THE SAME IN HIS/HER/THEIR AUTHORIZED CAPACITY(IES), AND THAT BY HIS/HER/THEIR SIGNATURE(S) ON THE INSTRUMENT THE PERSON(S), OR THE ENTITY UPON BEHALF OF WHICH THE PERSON(S) ACTED, EXECUTED THE INSTRUMENT.

I CERTIFY UNDER PENALTY OF PERJURY UNDER THE LAWS OF THE STATE OF CALIFORNIA THAT THE FOREGOING PARAGRAPH IS TRUE AND CORRECT.

WITNESS MY HAND:

SIGNATURE: _____ PRINT NAME: _____
NOTARY PUBLIC IN AND FOR SAID STATE
MY COMMISSION EXPIRES _____
MY COMMISSION # _____
MY PRINCIPAL PLACE OF BUSINESS IS IN _____ COUNTY

NOTARY ACKNOWLEDGEMENT

A NOTARY PUBLIC OR OTHER OFFICER COMPLETING THIS CERTIFICATE VERIFIES ONLY THE IDENTITY OF THE INDIVIDUAL WHO SIGNED THE DOCUMENT TO WHICH THIS CERTIFICATE IS ATTACHED, AND NOT THE TRUTHFULNESS, ACCURACY, OR VALIDITY OF THAT DOCUMENT.

STATE OF CALIFORNIA) S.S.
COUNTY OF RIVERSIDE)

ON _____, 2024, BEFORE ME, _____, A

NOTARY PUBLIC, IN AND FOR SAID STATE, PERSONALLY APPEARED _____ WHO PROVED TO ME ON THE BASIS OF SATISFACTORY EVIDENCE TO BE THE PERSON(S) WHOSE NAME(S) IS/ARE SUBSCRIBED TO THE WITHIN INSTRUMENT AND ACKNOWLEDGED TO ME THAT HE/SHE/THEY EXECUTED THE SAME IN HIS/HER/THEIR AUTHORIZED CAPACITY(IES), AND THAT BY HIS/HER/THEIR SIGNATURE(S) ON THE INSTRUMENT THE PERSON(S), OR THE ENTITY UPON BEHALF OF WHICH THE PERSON(S) ACTED, EXECUTED THE INSTRUMENT.

I CERTIFY UNDER PENALTY OF PERJURY UNDER THE LAWS OF THE STATE OF CALIFORNIA THAT THE FOREGOING PARAGRAPH IS TRUE AND CORRECT.

WITNESS MY HAND:

SIGNATURE: _____ PRINT NAME: _____
NOTARY PUBLIC IN AND FOR SAID STATE
MY COMMISSION EXPIRES _____
MY COMMISSION # _____
MY PRINCIPAL PLACE OF BUSINESS IS IN _____ COUNTY

IN THE CITY OF DESERT HOT SPRINGS, COUNTY OF RIVERSIDE, STATE OF CALIFORNIA

TRACT NO. 38816

BEING A SUBDIVISION OF PARCEL "B" AND "C" OF LLA 21-1, PER INSTRUMENT NO. 2021-0636911, RECORDED 10/27/21, OFFICIAL RECORDS OF RIVERSIDE COUNTY, CALIFORNIA, TOGETHER WITH LOT 'R' OF TRACT 38200, M.B. 494/24-27, INCLUSIVE, AND LOTS 34-41, INCLUSIVE, LOT "G", AND A PORTION OF LOTS "A", "F", AND "J" OF TRACT 22287-1, M.B. 234/4-7, INCLUSIVE, RECORDS OF RIVERSIDE COUNTY, CALIFORNIA



FEBRUARY 2024

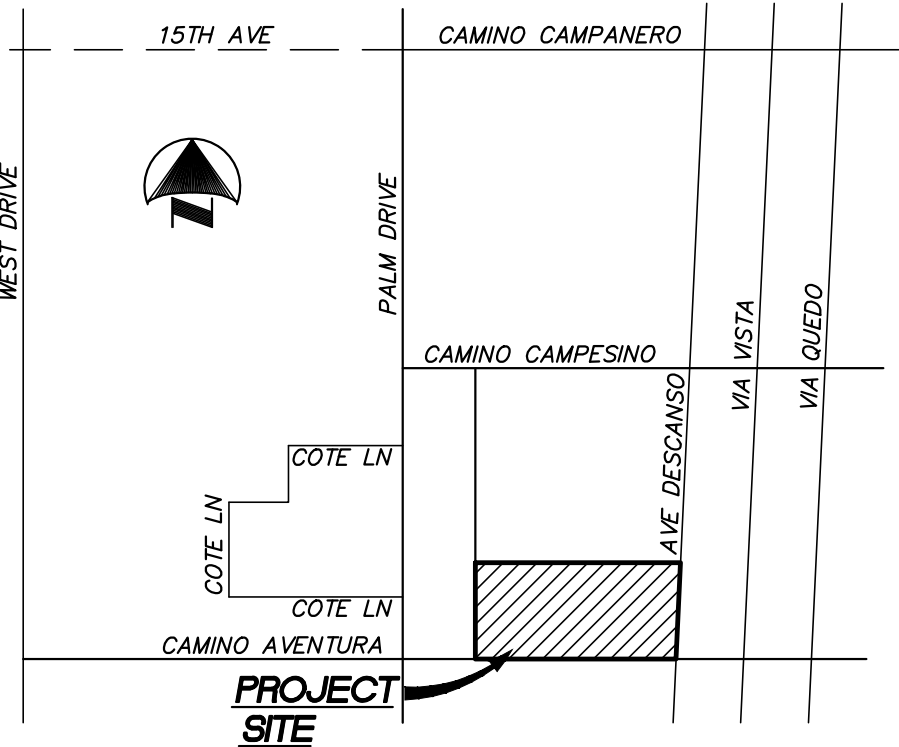

BASIS OF BEARINGS

THE CENTERLINE OF CAMINO AVENTURA
PER M.B. 494/24-27,
BEING **N89°23'35"W**.

SURVEYOR'S NOTES:

- SET 1" I.P. WITH TAG "L.S. 5128", FLUSH AT ALL LOT CORNERS, CENTERLINE, UNLESS NOTED OTHERWISE.
- SET NAIL & TAG "L.S. 5128" IN TOP OF CURB AT THE PROLONGATION OF THE SIDE LOT LINES IN LIEU OF FRONT LOT CORNERS.
- SET NAIL & TAG "L.S." 5128" IN TOP OF BLOCK WALLS OR IN THE FOOTING AT ALL REAR LOT CORNERS WHERE BLOCK WALLS ARE CONSTRUCTED.
- INDICATES MONUMENT FOUND AS NOTED.
- INDICATES FOUND 1" I.P. TAGGED "L.S. 5128", FLUSH PER M.B. 494/24-27
- ▲ INDICATES FOUND NAIL & TAG "L.S." 5128", IN TOP OF BLOCK WALL OR IN THE FOOTING AT REAR LOT CORNERS PER M.B. 494/24-27
- { } INDICATES MEASURED AND RECORD DATA PER M.B. 494/24-27, UNLESS NOTED OTHERWISE.
- [] INDICATES MEASURED RECORD DATA PER M.B. 234/4-7, UNLESS NOTED OTHERWISE.
- () INDICATES MEASURED AND RECORD DATA PER M.B. 307/64-71. UNLESS NOTED OTHERWISE.
- X FOUND NAIL & TAG "L.S. 4396" IN TOP OF CURB AT RECORD LOCATION FOR THE PROLONGATION OF THE SIDE LOT LINES PER M.B. 234/4-7.
- ⊙ FOUND 1" I.P. PLASTIC PLUG "L.S. 4396, FLUSH, PER M.B. 234/4-7.
- ℄ INDICATES CENTERLINE
- AC. INDICATES ACRES
- INT. INDICATES INTERSECTION
- N.A.P. INDICATES NOT A PART
- O.R. INDICATES OFFICIAL RECORDS
- P.U.E. INDICATES PUBLIC UTILITY EASEMENT
- EX. R/W INDICATES EXISTING STREET RIGHT OF WAY
- (R) INDICATES RADIAL BEARING
- P.U.E. INDICATES PUBLIC UTILITY EASEMENT

THIS TRACT CONTAINS LOTS 1-19,
LETTERED LOTS "A" THROUGH "D".

THIS TRACT CONTAINS **3.90 ACRES** GROSS.

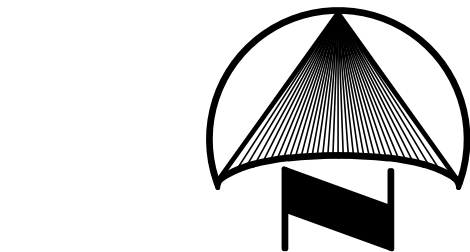

EASEMENT NOTES

- ① AN EASEMENT FOR UNDERGROUND ELECTRIC SUPPLY SYSTEMS, COMMUNICATION SYSTEMS AND INCIDENTAL PURPOSES IN FAVOR OF SOUTHERN CALIFORNIA EDISON CO. RECORDED NOVEMBER 29, 1983 AS INSTRUMENT NO. 83-247651, OFFICIAL RECORDS.
- ② EASEMENT FOR EITHER POLE OR BOTH POLE LINES, CONDUITS OR UNDERGROUND FACILITIES AND INCIDENTAL PURPOSES IN FAVOR OF SOUTHERN CALIFORNIA EDISON CO. RECORDED MARCH 13, 1978 AS INSTRUMENT NO. 46777, OFFICIAL RECORDS.
- ③ 50' WIDE EASEMENT FOR EITHER OR BOTH POLE LINES, CONDUITS OR UNDERGROUND FACILITIES AND INCIDENTAL PURPOSES IN FAVOR OF IMPERIAL IRRIGATION DISTRICT AFFECTING LOTS A AND F OF PARCEL 7, RECORDED MAY 28, 1956 AS BOOK 1919, PAGE 17, OFFICIAL RECORDS. CONVEYED TO SOUTHERN CALIFORNIA EDISON CO. IN DOCUMENT RECORDED MARCH 6, 1986 AS INSTRUMENT NO. 52240, OFFICIAL RECORDS.

TRACT NO. 38200
M.B. 494/24-27

DOS PALMAS TRACT NO. 5
M.B. 29/89-90

DOS PALMAS TRACT NO. 3
M.B. 27/77-78

BOUNDARY CONTROL MAP AND SHEET INDEX

IN THE CITY OF DESERT HOT SPRINGS, COUNTY OF RIVERSIDE, STATE OF CALIFORNIA

TRACT NO. 38816

BEING A SUBDIVISION OF PARCEL "B" AND "C" OF LLA 21-1, PER INSTRUMENT NO. 2021-0636911, RECORDED 10/27/21, OFFICIAL RECORDS OF RIVERSIDE COUNTY, CALIFORNIA, TOGETHER WITH LOT 'R' OF TRACT 38200, M.B. 494/24-27, INCLUSIVE, AND LOTS 34-41, INCLUSIVE, LOT "G", AND A PORTION OF LOTS "A", "F", AND "J" OF TRACT 22287-1, M.B. 234/4-7, INCLUSIVE, RECORDS OF RIVERSIDE COUNTY, CALIFORNIA



FEBRUARY 2024

NOTES:

SEE SHEET 2 FOR EASEMENTS, SURVEY NOTES, VICINITY MAP, BASIS OF BEARINGS AND LEGEND.
THIS TRACT CONTAINS LOTS 1-19,
LETTERED LOT "A" THROUGH "D".

THIS TRACT CONTAINS 3.90 ACRES.

LINE TABLE		
LINE #	LENGTH	BEARING
[L2]	10.55'	N00°09'05"E
[L3]	18.00'	N00°36'25"E
[L8]	13.00'	S00°36'25"W
[L9]	16.00'	S00°36'25"W
[L10]	17.38'	N02°56'10"E
[L11]	13.85'	N46°46'17"E
L1	15.30'	N89°50'55"W
L4	54.00'	N00°36'25"E
L5	12.98'	S89°11'37"E
L6	13.79'	S89°11'37"E
L7	7.33'	N89°23'35"W

CURVE DATA			
CURVE #	LENGTH	RADIUS	DELTA
[C1]	31.75'	20.00'	90°56'39"
[C2]	31.42'	20.00'	90°00'00"
[C3]	45.97'	170.00'	15°29'31"
[C4]	33.96'	170.00'	11°26'46"
[C5]	19.80'	130.00'	8°43'33"
[C6]	42.36'	130.00'	18°40'04"
[C7]	31.42'	20.00'	90°00'00"
[C8]	16.09'	25.00'	36°52'12"
[C9]	31.42'	20.00'	90°00'00"
[C10]	42.66'	170.00'	14°22'40"
[C11]	38.62'	170.00'	13°00'57"
[C12]	15.03'	130.00'	6°37'25"
[C13]	46.09'	130.00'	20°18'52"
[C14]	71.72'	150.00'	27°23'37"
[C16]	70.52'	150.00'	26°56'17"
[C17]	61.12'	130.00'	26°56'17"
[C18]	81.28'	170.00'	27°23'37"
[C19]	62.15'	130.00'	27°23'37"
[C20]	32.39'	20.00'	92°47'05"
[C21]	30.60'	20.00'	87°40'15"
[C24]	21.99'	7.00'	180°00'00"
[C25]	79.93'	170.00'	26°56'17"
C22	18.42'	52.00'	20°17'53"
C23	61.15'	52.00'	67°22'22"
C26	61.16'	52.00'	67°23'12"

