

OWNER'S NAME/CONTACT: BERKELEY COUNTY AGRICULTURAL EXHIBITION  
 FARMBOX  
 MUCKS CORNER  
 SC 294610729

ZONING: C-2  
 TOTAL ACRES: 4.592 A.C.  
 TIME: 143004004  
 REVISIONS/REVISED: DISCOVERY 2.0 & BY PASS COMMERCIAL / RESIDENTIAL  
 CONCISE OBJECT: C1  
 FILE OBJECT: F15  
 TALK OBJECT: T16  
 TR ZONE: 0  
 JURISDICTION: 09  
 LOTS: 0

**SITE PLAN NOTES:**

- A. PROVIDE A LISTED NON-REMOVABLE BACK FLOW PREVENTION DEVICE AT ALL HOSE BIBBS OR A LISTED ATMOSPHERIC VACUUM BREAKER PER APPLICABLE CODE.
- B. REFERENCE THE CIVIL PLANS FOR ALL GRADING, ON-SITE CONSTRUCTION, WHICH MAY REQUIRE BUILDING PERMIT.
- C. ALL EXTERIOR WALLS NOT ATTACHED TO THE PRIMARY STRUCTURE SHALL REQUIRE A SEPARATE BUILDING PERMIT.
- D. SIDEWALKS, DRIVEWAYS AND OTHER FLAT WORK SHALL BE CONSTRUCTED IN ACCORDANCE WITH THE SOILS REPORT.
- E. STRUCTURES SHALL BE LOCATED BY A QUALIFIED SURVEYOR ONLY, AND SHALL FURNISH PAD CERTIFICATION REPORT TO DESIGNER PRIOR TO PLACING OF FOUNDATION.
- F. PROPERTY LINE DIMENSIONS ARE PREPARED WITH INFORMATION FURNISHED BY THE OWNER AND SHALL NOT BE CONSTRUED TO BE A SURVEY OF THE PROPERTY. FINAL STRUCTURE PLACEMENTS IN RELATION TO THE PROPERTY LINES SHALL BE DESIGNATED ON THE CIVIL DRAWINGS AND SHALL CONFORM TO ALL LOCAL ZONING & BUILDING CODES, AMENDMENTS AND/OR APPROVED VARIANCES.
- G. BUILDER SHALL LOCATE ALL STRUCTURES AND CERTIFY COMPLIANCE WITH SETBACKS PRIOR TO ANY WORK.

**ZONING REQUIREMENTS:**

- CURRENT ZONING: C-2
- MINIMUM FRONT YARD DEPTH: 25'
- SIDE SETBACK: 10'
- REAR SETBACK: 10'
- MIN LOT AREA: N/A
- MAX LOT COVERAGE: N/A%
- MAX BUILDING HEIGHT: 40FT

**AREA CALCULATION:**

- PROPOSED BUILDING: 40,000.00 SQ.FT
- BOAT / RV PARK: 7056.00 SF
- WALK WAY: 12726.43 SQ.FT
- TOTAL BUILT UP AREA: 79,782.43 SQ.FT.
- NO. OF PARKING LOT: 9
- ADA PARKING LOT: 1
- TOTAL LOT AREA: 200,012.00 SQ.FT.
- UNUSED LOT AREA: 120,229.57 SQ.FT.
- PERCENTAGE LOT COVERAGE: 39.8%

**SITE DATA TABLE**

TAX MAP INFORMATION: 143-00-00-004

SUBJECT PARCEL ZONING: GENERAL COMMERCIAL

SUBJECT PARCEL(S) AREA: 4.592 A.C / 200,012.00 S.F

BUILDING AREA-PROPOSED:  
 BUILDING A+ 10,000 S.F  
 BUILDING B+ 11,000 S.F  
 BUILDING C+ 10,000 S.F  
 BUILDING D+ 11,000 S.F  
 BUILDING E+ 11,000 S.F  
 TOTAL: 43,000 S.F

SITE BUFFER REQUIREMENTS:  
 FRONT: 15' TYPE B1 (STREET)  
 REAR: 50' TYPE D1 (RESIDENTIAL)  
 SIDE: NONE

BUILDING HEIGHT LIMITS: 40'

ADDRESS: 350 REMBER, C DENNIS, BLVD  
 MUCKS CORNER, SC

**FLOOD ZONE INFORMATION**

THE GRAPHICALLY DEPICTED BUILDINGS SHOWN ON THIS MAP OF SURVEY IS WITHIN LAND OUTSIDE OF THE SPECIAL FLOOD HAZARD AREA

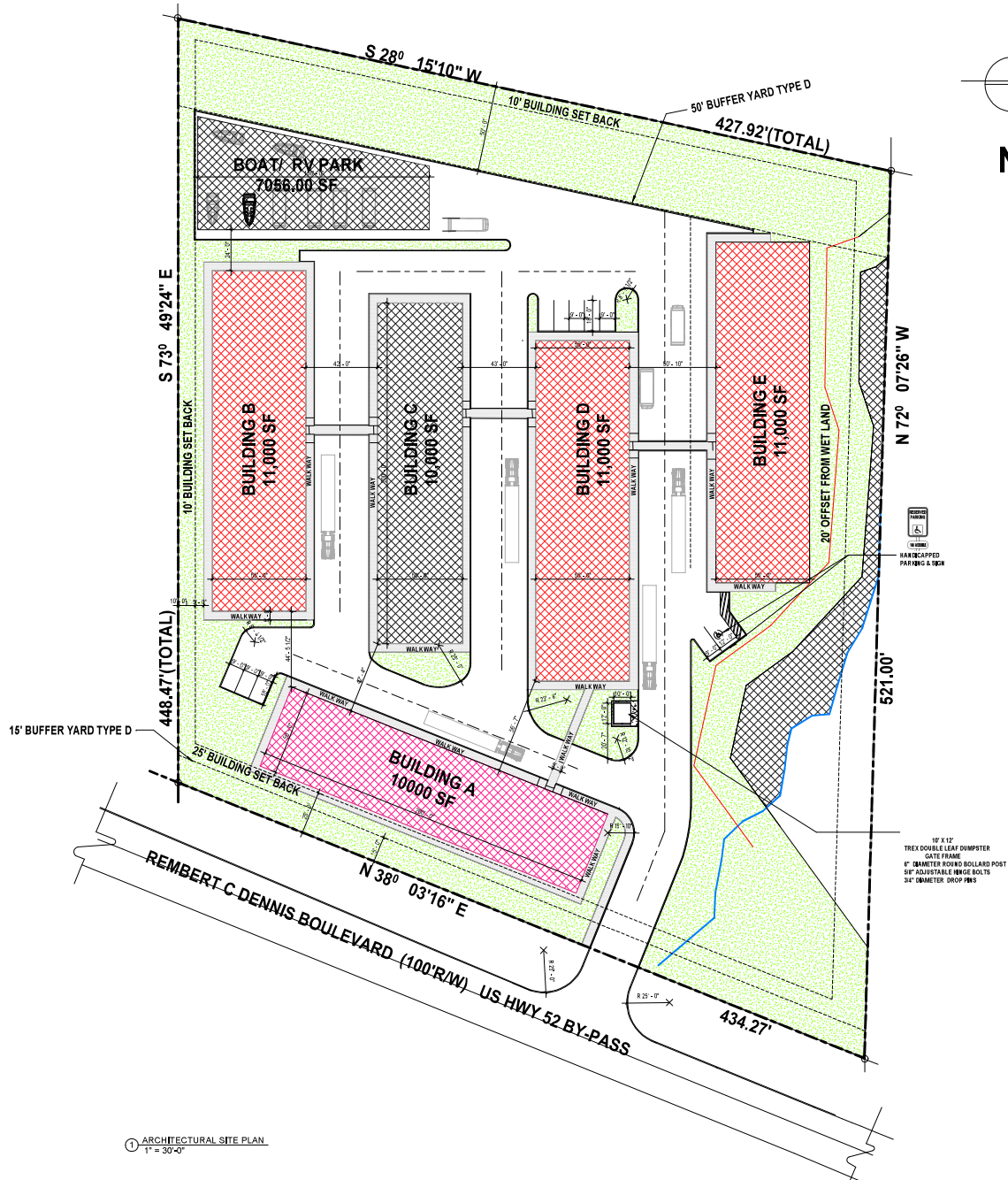

ARCHITECTURAL SITE PLAN  
 1" = 30'-0"

PROFESSIONAL SEAL:

DATE:  
 01/30/24

REVISION:

PROJECT TITLE:  
 STORAGE UNITS

PROJECT ADDRESS:  
 350 REMBER, C DENNIS, BLVD MUCKS CORNER, SC

SHEET TITLE:  
 Unnamed

E.O.R: BARRET CROOK (21786)  
 DRAWN BY

SHEET NUMBER

A101

SHEET SCALE:

1" = 30'-0"