



6700 Stephens Station Road, Suite 101
Columbia, Missouri 65202
P (573) 214-2677
Terracon.com

July 19, 2024

City of Moberly
101 West Reed Street
Moberly, Missouri 65270

Attn: Mr. Michael Bugalski

RE: Proposal for Geotechnical Engineering Services
Moberly Fire Department – Station 1
1445 South Morley Street
Moberly, Missouri
Terracon Proposal No. P09245048

Dear Mr. Bugalski:

We appreciate the opportunity to submit this proposal to City of Moberly to provide Geotechnical Engineering services for the above referenced project. The following are exhibits to the attached Agreement for Services.

Exhibit A	Project Understanding
Exhibit B	Scope of Services
Exhibit C	Compensation and Project Schedule
Exhibit D	Site Location and Nearby Geotechnical Data
Exhibit E	Anticipated Exploration Plan

Terracon will perform the Scope of Services described in this proposal for a lump sum fee of \$8,850. Exhibit C includes details of our fees, consideration of additional services, and a general breakdown of our anticipated schedule.

To authorize Terracon to proceed in accordance with this proposal, please sign and return a copy of the attached Agreement for Services via email (kaylee.cannon@terracon.com) or mail.

Sincerely,
Terracon

Kaylee N. Cannon, E. I.
Geotechnical Engineer

Jamie M. Klein, P.E.
Senior Engineer

AGREEMENT FOR SERVICES

This **AGREEMENT** is between City of Moberly MO ("Client") and Terracon Consultants, Inc. ("Consultant") for Services to be provided by Consultant for Client on the Moberly Fire Department - Station 1 project ("Project"), as described in Consultant's Proposal dated 07/19/2024 ("Proposal"), including but not limited to the Project Information section, unless the Project is otherwise described in Exhibit A to this Agreement (which section or Exhibit is incorporated into this Agreement).

- 1. Scope of Services.** The scope of Consultant's services is described in the Proposal, including but not limited to the Scope of Services section ("Services"), unless Services are otherwise described in Exhibit B to this Agreement (which section or exhibit is incorporated into this Agreement). Portions of the Services may be subcontracted. Consultant's Services do not include the investigation or detection of, nor do recommendations in Consultant's reports address the presence or prevention of biological pollutants (e.g., mold, fungi, bacteria, viruses, or their byproducts) or occupant safety issues, such as vulnerability to natural disasters, terrorism, or violence. If Services include purchase of software, Client will execute a separate software license agreement. Consultant's findings, opinions, and recommendations are based solely upon data and information obtained by and furnished to Consultant at the time of the Services.
- 2. Acceptance/ Termination.** Client agrees that execution of this Agreement is a material element of the consideration Consultant requires to execute the Services, and if Services are initiated by Consultant prior to execution of this Agreement as an accommodation for Client at Client's request, both parties shall consider that commencement of Services constitutes formal acceptance of all terms and conditions of this Agreement. Additional terms and conditions may be added or changed only by written amendment to this Agreement signed by both parties. In the event Client uses a purchase order or other form to administer this Agreement, the use of such form shall be for convenience purposes only and any additional or conflicting terms it contains are stricken. This Agreement shall not be assigned by either party without prior written consent of the other party. Either party may terminate this Agreement or the Services upon written notice to the other. In such case, Consultant shall be paid costs incurred and fees earned to the date of termination plus reasonable costs of closing the Project.
- 3. Change Orders.** Client may request changes to the scope of Services by altering or adding to the Services to be performed. If Client so requests, Consultant will return to Client a statement (or supplemental proposal) of the change setting forth an adjustment to the Services and fees for the requested changes. Following Client's review, Client shall provide written acceptance. If Client does not follow these procedures, but instead directs, authorizes, or permits Consultant to perform changed or additional work, the Services are changed accordingly and Consultant will be paid for this work according to the fees stated or its current fee schedule. If project conditions change materially from those observed at the site or described to Consultant at the time of proposal, Consultant is entitled to a change order equitably adjusting its Services and fee.
- 4. Compensation and Terms of Payment.** Client shall pay compensation for the Services performed at the fees stated in the Proposal, including but not limited to the Compensation section, unless fees are otherwise stated in Exhibit C to this Agreement (which section or Exhibit is incorporated into this Agreement). If not stated in either, fees will be according to Consultant's current fee schedule. Fee schedules are valid for the calendar year in which they are issued. Fees do not include sales tax. Client will pay applicable sales tax as required by law. Consultant may invoice Client at least monthly and payment is due upon receipt of invoice. Client shall notify Consultant in writing, at the address below, within 15 days of the date of the invoice if Client objects to any portion of the charges on the invoice, and shall promptly pay the undisputed portion. Client shall pay a finance fee of 1.5% per month, but not exceeding the maximum rate allowed by law, for all unpaid amounts 30 days or older. Client agrees to pay all collection-related costs that Consultant incurs, including attorney fees. Consultant may suspend Services for lack of timely payment. It is the responsibility of Client to determine whether federal, state, or local prevailing wage requirements apply and to notify Consultant if prevailing wages apply. If it is later determined that prevailing wages apply, and Consultant was not previously notified by Client, Client agrees to pay the prevailing wage from that point forward, as well as a retroactive payment adjustment to bring previously paid amounts in line with prevailing wages. Client also agrees to defend, indemnify, and hold harmless Consultant from any alleged violations made by any governmental agency regulating prevailing wage activity for failing to pay prevailing wages, including the payment of any fines or penalties.
- 5. Third Party Reliance.** This Agreement and the Services provided are for Consultant and Client's sole benefit and exclusive use with no third party beneficiaries intended. Reliance upon the Services and any work product is limited to Client, and is not intended for third parties other than those who have executed Consultant's reliance agreement, subject to the prior approval of Consultant and Client.
- 6. LIMITATION OF LIABILITY. CLIENT AND CONSULTANT HAVE EVALUATED THE RISKS AND REWARDS ASSOCIATED WITH THIS PROJECT, INCLUDING CONSULTANT'S FEE RELATIVE TO THE RISKS ASSUMED, AND AGREE TO ALLOCATE CERTAIN OF THE ASSOCIATED RISKS. TO THE FULLEST EXTENT PERMITTED BY LAW, THE TOTAL AGGREGATE LIABILITY OF CONSULTANT (AND ITS RELATED CORPORATIONS AND EMPLOYEES) TO CLIENT AND THIRD PARTIES GRANTED RELIANCE IS LIMITED TO THE GREATER OF \$50,000 OR CONSULTANT'S FEE, FOR ANY AND ALL INJURIES, DAMAGES, CLAIMS, LOSSES, OR EXPENSES (INCLUDING ATTORNEY AND EXPERT FEES) ARISING OUT OF CONSULTANT'S SERVICES OR THIS AGREEMENT. PRIOR TO ACCEPTANCE OF THIS AGREEMENT AND UPON WRITTEN REQUEST FROM CLIENT, CONSULTANT MAY NEGOTIATE A HIGHER LIMITATION FOR ADDITIONAL CONSIDERATION IN THE FORM OF A SURCHARGE TO BE ADDED TO THE AMOUNT STATED IN THE COMPENSATION SECTION OF THE PROPOSAL. THIS LIMITATION SHALL APPLY REGARDLESS OF AVAILABLE PROFESSIONAL LIABILITY INSURANCE COVERAGE, CAUSE(S), OR THE THEORY OF LIABILITY, INCLUDING NEGLIGENCE, INDEMNITY, OR OTHER RECOVERY. THIS LIMITATION SHALL NOT APPLY TO THE EXTENT THE DAMAGE IS PAID UNDER CONSULTANT'S COMMERCIAL GENERAL LIABILITY POLICY.**
- 7. Indemnity/Statute of Limitations.** Consultant and Client shall indemnify and hold harmless the other and their respective employees from and against legal liability for claims, losses, damages, and expenses to the extent such claims, losses, damages, or expenses are legally determined to be caused by their negligent acts, errors, or omissions. In the event such claims, losses, damages, or expenses are legally determined to be caused by the joint or concurrent negligence of Consultant and Client, they shall be borne by each party in proportion to its own negligence under comparative fault principles. Neither party shall have a duty to defend the other party, and no duty to defend is hereby created by this indemnity provision and such duty is explicitly waived under this Agreement. Causes of action arising out of Consultant's Services or this Agreement regardless of cause(s) or the theory of liability, including negligence, indemnity or other recovery shall be deemed to have accrued and the applicable statute of limitations shall commence to run not later than the date of Consultant's substantial completion of Services on the project.
- 8. Warranty.** Consultant will perform the Services in a manner consistent with that level of care and skill ordinarily exercised by members of the profession currently practicing under similar conditions in the same locale. **EXCEPT FOR THE STANDARD OF CARE PREVIOUSLY STATED, CONSULTANT MAKES NO WARRANTIES OR GUARANTEES, EXPRESS OR IMPLIED, RELATING TO CONSULTANT'S SERVICES AND CONSULTANT DISCLAIMS ANY IMPLIED WARRANTIES OR WARRANTIES IMPOSED BY LAW, INCLUDING WARRANTIES OF MERCHANTABILITY AND FITNESS FOR A PARTICULAR PURPOSE.**
- 9. Insurance.** Consultant represents that it now carries, and will continue to carry: (i) workers' compensation insurance in accordance with the laws of the states having jurisdiction over Consultant's employees who are engaged in the Services, and employer's liability insurance (\$1,000,000); (ii) commercial general liability insurance (\$2,000,000 occ / \$4,000,000 agg); (iii) automobile liability insurance (\$2,000,000 B.I. and P.D. combined single limit); (iv) umbrella liability (\$5,000,000 occ / agg); and (v) professional liability insurance (\$1,000,000 claim / agg). Certificates of insurance will be provided upon request. Client and Consultant shall waive subrogation against the other party on all general liability and property coverage.

- 10. CONSEQUENTIAL DAMAGES. NEITHER PARTY SHALL BE LIABLE TO THE OTHER FOR LOSS OF PROFITS OR REVENUE; LOSS OF USE OR OPPORTUNITY; LOSS OF GOOD WILL; COST OF SUBSTITUTE FACILITIES, GOODS, OR SERVICES; COST OF CAPITAL; OR FOR ANY SPECIAL, CONSEQUENTIAL, INDIRECT, PUNITIVE, OR EXEMPLARY DAMAGES.**
- 11. Dispute Resolution.** Client shall not be entitled to assert a Claim against Consultant based on any theory of professional negligence unless and until Client has obtained the written opinion from a registered, independent, and reputable engineer, architect, or geologist that Consultant has violated the standard of care applicable to Consultant's performance of the Services. Client shall provide this opinion to Consultant and the parties shall endeavor to resolve the dispute within 30 days, after which Client may pursue its remedies at law. This Agreement shall be governed by and construed according to Kansas law.
- 12. Subsurface Explorations.** Subsurface conditions throughout the site may vary from those depicted on logs of discrete borings, test pits, or other exploratory services. Client understands Consultant's layout of boring and test locations is approximate and that Consultant may deviate a reasonable distance from those locations. Consultant will take reasonable precautions to reduce damage to the site when performing Services; however, Client accepts that invasive services such as drilling or sampling may damage or alter the site. Site restoration is not provided unless specifically included in the Services.
- 13. Testing and Observations.** Client understands that testing and observation are discrete sampling procedures, and that such procedures indicate conditions only at the depths, locations, and times the procedures were performed. Consultant will provide test results and opinions based on tests and field observations only for the work tested. Client understands that testing and observation are not continuous or exhaustive, and are conducted to reduce - not eliminate - project risk. Client shall cause all tests and inspections of the site, materials, and Services performed by Consultant to be timely and properly scheduled in order for the Services to be performed in accordance with the plans, specifications, contract documents, and Consultant's recommendations. No claims for loss or damage or injury shall be brought against Consultant by Client or any third party unless all tests and inspections have been so performed and Consultant's recommendations have been followed. Unless otherwise stated in the Proposal, Client assumes sole responsibility for determining whether the quantity and the nature of Services ordered by Client is adequate and sufficient for Client's intended purpose. Client is responsible (even if delegated to contractor) for requesting services, and notifying and scheduling Consultant so Consultant can perform these Services. Consultant is not responsible for damages caused by Services not performed due to a failure to request or schedule Consultant's Services. Consultant shall not be responsible for the quality and completeness of Client's contractor's work or their adherence to the project documents, and Consultant's performance of testing and observation services shall not relieve Client's contractor in any way from its responsibility for defects discovered in its work, or create a warranty or guarantee. Consultant will not supervise or direct the work performed by Client's contractor or its subcontractors and is not responsible for their means and methods. The extension of unit prices with quantities to establish a total estimated cost does not guarantee a maximum cost to complete the Services. The quantities, when given, are estimates based on contract documents and schedules made available at the time of the Proposal. Since schedule, performance, production, and charges are directed and/or controlled by others, any quantity extensions must be considered as estimated and not a guarantee of maximum cost.
- 14. Sample Disposition, Affected Materials, and Indemnity.** Samples are consumed in testing or disposed of upon completion of the testing procedures (unless stated otherwise in the Services). Client shall furnish or cause to be furnished to Consultant all documents and information known or available to Client that relate to the identity, location, quantity, nature, or characteristic of any hazardous waste, toxic, radioactive, or contaminated materials ("Affected Materials") at or near the site, and shall immediately transmit new, updated, or revised information as it becomes available. Client agrees that Consultant is not responsible for the disposition of Affected Materials unless specifically provided in the Services, and that Client is responsible for directing such disposition. In no event shall Consultant be required to sign a hazardous waste manifest or take title to any Affected Materials. Client shall have the obligation to make all spill or release notifications to appropriate governmental agencies. The Client agrees that Consultant neither created nor contributed to the creation or existence of any Affected Materials conditions at the site and Consultant shall not be responsible for any claims, losses, or damages allegedly arising out of Consultant's performance of Services hereunder, or for any claims against Consultant as a generator, disposer, or arranger of Affected Materials under federal, state, or local law or ordinance.
- 15. Ownership of Documents.** Work product, such as reports, logs, data, notes, or calculations, prepared by Consultant shall remain Consultant's property. Proprietary concepts, systems, and ideas developed during performance of the Services shall remain the sole property of Consultant. Files shall be maintained in general accordance with Consultant's document retention policies and practices.
- 16. Utilities.** Unless otherwise stated in the Proposal, Client shall provide the location and/or arrange for the marking of private utilities and subterranean structures. Consultant shall take reasonable precautions to avoid damage or injury to subterranean structures or utilities. Consultant shall not be responsible for damage to subterranean structures or utilities that are not called to Consultant's attention, are not correctly marked, including by a utility locate service, or are incorrectly shown on the plans furnished to Consultant.
- 17. Site Access and Safety.** Client shall secure all necessary site related approvals, permits, licenses, and consents necessary to commence and complete the Services and will execute any necessary site access agreement. Consultant will be responsible for supervision and site safety measures for its own employees, but shall not be responsible for the supervision or health and safety precautions for any third parties, including Client's contractors, subcontractors, or other parties present at the site. In addition, Consultant retains the right to stop work without penalty at any time Consultant believes it is in the best interests of Consultant's employees or subcontractors to do so in order to reduce the risk of exposure to unsafe site conditions. Client agrees it will respond quickly to all requests for information made by Consultant related to Consultant's pre-task planning and risk assessment processes.

Consultant: **Terracon Consultants, Inc.**
By:  Date: **7/19/2024**
Name/Title: **Jamie M. Klein, P.E. / Principal**
Address: **6700 Stephens Station Rd Ste 101**
Columbia, MO 65202-0069
Phone: **(573) 214-2677** Fax: **(573) 214-2714**
Email: **Jamie.Klein@terracon.com**

Client: **City of Moberly MO**
By: _____ Date: _____
Name/Title: **Michael Bugalski**
Address: **101 West Reed**
Moberly, MO 65270
Phone: _____ Fax: _____
Email: **mbugalski@cityofmoberly.com**

Exhibit A – Project Understanding

Our Scope of Services is based on our understanding of the project as described by City of Moberly and the expected subsurface conditions as described below. We have not visited the project site to confirm the information provided. We request City of Moberly and/or the design team verify this information before we mobilize to perform the field exploration.

Planned Construction

Item	Description
Information Provided	Moberly Fire Dept – Station 1 Site Plan prepared by WSKF Architects
Project Description	The project consists of a single-story, pre-engineered building with a footprint of approximately 7,700 square feet. The building will be slab-on-grade (non-basement). A separate fire training structure is planned approximately 650 feet west of the proposed building. Pavements and drive lanes will be constructed to the west, east, and south of the planned building.
Maximum Loads	<p>Anticipated structural loads were not provided. We have assumed the following maximum loads based on our experience with similar projects.</p> <ul style="list-style-type: none"> ■ Columns: 75 kips ■ Walls: 3 kips per linear foot (klf) ■ Slabs: 100 pounds per square foot (psf) <p>We request that updated loading information be provided by the design team for use our analyses.</p>
Grading	A site grading plan was not provided. We have considered no more than 3 feet of cut/fill will be required to develop final grades.
Below-Grade Structures	No basement level or other below-grade areas are planned.
Free-Standing Retaining Walls	No free-standing retaining walls are planned.

Item	Description
Pavements	Anticipated traffic is as follows: <ul style="list-style-type: none"> ■ Autos/light trucks: 100 vehicles per day ■ Light delivery and trash collection vehicles: 10 vehicles per week ■ Fire trucks: 3 vehicles per day ■ Tractor-trailer trucks: <1 vehicle per week The pavement design period is 20 years.

Site Location and Anticipated Conditions

Item	Description
Project Location	The project is located at 1445 South Morley Street in Moberly, Missouri. Latitude: 39.4005°N, Longitude: 92.4353°W (See Exhibit D)
Existing Improvements	The site is currently undeveloped with only a single lane, asphalt drive lane on the eastern portion of the site; however, based on historical aerials, multiple buildings occupied the site previously. It appears the buildings were demolished between 2010 and 2012.
Current Ground Cover	Grass, asphalt, gravel
Existing Topography	Based on Google Earth, the site is relatively flat.
Site Access	We expect the site, and all exploration locations, are accessible with our ATV-mounted or track-mounted drilling equipment.
Expected Subsurface Conditions	Based on our experience in the site vicinity and our review of publicly available information, we anticipate subsurface conditions to consist of existing fill overlying clay soils within our planned boring depths.

Exhibit B - Scope of Services

Our proposed Scope of Services consists of field exploration, laboratory testing, and engineering/project delivery. These services are described in the following sections.

Field Exploration

Based on input provided by City of Moberly, and our experience with similar projects in the vicinity of the project site, we propose the following field exploration program.

Number of Borings	Planned Boring Depth (feet) ¹	Planned Location ²
4	20	Fire station building area
1	15	Training tower / pavements
3	5	Pavement areas

1. Borings will be advanced to the proposed depths unless practical auger refusal occurs at shallower depths. No rock coring will be performed.
2. The planned boring locations are shown on the attached **Anticipated Exploration Plan**.

Boring Layout and Elevations: We will use handheld GPS equipment to locate borings with an estimated horizontal accuracy of ± 20 feet. Approximate elevations will be estimated from an online mapping application or obtained by interpolation from a site specific, surveyed topographic map (if available). Alternatively, we can coordinate with your Project Surveyor to include locations and surface elevations in project information if so requested.

Subsurface Exploration Procedures: We will advance the borings with an ATV-mounted drill rig using continuous flight augers (solid stem and/or hollow stem, as necessary, depending on soil conditions). Four samples will generally be obtained in the upper 10 feet of each boring, and samples will be obtained at depth intervals of about 5 feet thereafter. Two samples will generally be obtained from each pavement-area boring. Soil sampling will be performed split-barrel sampling procedures. The split-barrel sampler will be driven in accordance with standard penetration test (SPT) procedures. We will transport the samples to our laboratory for observation, testing, and classification.

Our exploration team will prepare field boring logs to record sampling depths, penetration distances, other relevant sampling information, visual classifications of materials observed during drilling, and our interpretation of subsurface conditions between samples. In addition, we will observe and record groundwater levels in the boreholes.

Property Disturbance: Terracon will take reasonable efforts to reduce damage to the property as a result of our exploration activities. However, in the normal course of our services, some disturbance (such as rutting of the ground surface and damage to pavements or landscaping) could occur.

We will backfill the borings with auger cuttings after completion of drilling. Excess auger cuttings will be disposed of on the site by spreading in the area of the boreholes. Because backfill material often settles below the surface after a period, the site owner should observe the boreholes periodically checked and backfill them, if necessary. We can provide this service or grout the boreholes for additional fees at your request. Terracon's scope of services does not include any responsibility for future maintenance or backfilling of the boreholes.

Safety

Terracon is not aware of environmental concerns at this project site that would create health or safety hazards associated with our exploration program; thus, our Scope considers standard OSHA Level D Personal Protection Equipment (PPE) appropriate. Our Scope of Services does not include environmental site assessment services.

Terracon will contact the Missouri one-call system to locate utilities in public easements. Location of private lines is not included in the one-call locate. The site owner should locate and mark all private utilities before we mobilize to perform the field exploration. Terracon is not responsible for damage to any utilities (public or private) incorrectly marked or not marked by others.

Since the site was previously developed, Terracon will also perform a private utility locate using our geophysical equipment before we begin drilling. Fees associated with this service are included in our Scope of Services.

The detection of underground utilities is dependent upon the composition and construction of the utility line; some utilities are comprised of non-electrically conductive materials and may not be readily detected. Terracon's performance of a private utility locate using geophysical equipment would not relieve the landowner/client of their responsibilities in identifying private underground utilities.

Site Access: Terracon must be granted access to the site by the property owner. If the client accepts this proposal, we will consider that the client has obtained authorization from the owner for Terracon to access the property and conduct the field exploration. Our proposed fees do not include negotiation and coordination of access with landowners or tenants. Terracon will conduct field services during normal business hours (Monday through Friday between 7:00am and 5:00pm). If our exploration must take place over a weekend or at night, please contact us so we can adjust our schedule and fee.

Laboratory Testing

The project engineer will review the field data and assign laboratory tests. Exact types and number of tests cannot be defined until completion of fieldwork, but we anticipate the following laboratory testing may be performed:

- Water content
- Atterberg limits

Our laboratory testing program will include examination of soil samples by an engineer or geologist. Based on the results of our field and laboratory programs, we will describe and classify soil samples in general accordance with the Unified Soil Classification System (USCS).

Engineering and Project Delivery

The results of our field and laboratory programs will be evaluated, and a geotechnical engineering report will be prepared under the supervision of a licensed professional engineer. The geotechnical engineering report will provide the following:

- Boring logs with field and laboratory data
- Stratification based on visual soil classification
- Groundwater levels observed during and after the completion of drilling
- Site Location Plan and Exploration Plan
- Subsurface exploration procedures
- Description of subsurface conditions
- Earthwork considerations including site preparation, fill materials, and compaction requirements
- Design and construction considerations for shallow foundations, including allowable bearing pressure, estimated settlement, and minimum frost depth
- Seismic site class according to the International Building Code (IBC)
- Subgrade preparation recommendations for grade-supported floor slabs and pavements
- Opinions of minimum pavement section thicknesses

In addition to an emailed report, your project will also be delivered using **Compass** (Terracon's online client collaboration portal). Upon initiation, we will provide you and your design team the necessary link and password to access the website. Each project includes a calendar to track the schedule, an interactive site map, a listing of team members, access to the project documents as they are uploaded to the site, and a collaboration portal. We welcome the opportunity to have project kickoff conversations

with the team to discuss key elements of the project and demonstrate features of the portal. The typical delivery process includes the following:

- Project Planning – Proposal information, schedule, and anticipated exploration plan
- Site Characterization – Findings of the site exploration and laboratory results
- Geotechnical Engineering Report

When our services are complete, we will upload a printable version of our completed report. Previous submittals, collaboration, and the report will be maintained in our system. This will allow future reference and integration into subsequent aspects of our services as the project goes through final design and construction.

Additional Services

In addition to the services noted above, the following are often associated with geotechnical engineering services. Fees for services noted above do not include the following:

Review of Plans and Specifications: Our geotechnical report and associated verbal and written communications will be used by others in the design team to develop plans and specifications for construction. Review of project plans and specifications is a vital part of our geotechnical engineering services. This consists of review of project plans and specifications related to site preparation, earthwork, foundations, grade-supported slabs, and pavements. Our review will include a written statement conveying our opinions relating to the consistency of the plans and specifications with respect to our geotechnical engineering recommendations.

Observation and Testing of Pertinent Construction Materials: Development of our geotechnical engineering recommendations and report relies on an interpretation of subsurface conditions. Our assessment is based on widely spaced exploration locations and the assumption that construction methods will be performed in a manner sufficient to meet our expectations and consistent with recommendations made at the time the geotechnical engineering report is issued. We should be retained to conduct construction observations and perform/document associated materials testing during site preparation, earthwork, and construction of foundations, slabs, and pavements. These services allow a more comprehensive understanding of subsurface conditions and necessary documentation of construction to confirm and/or modify (when necessary) the assumptions and recommendations made by our engineers.

Exhibit C - Compensation and Project Schedule

Compensation

Based upon our understanding of the site, the project as summarized in Exhibit A, and our planned Scope of Services outlined in Exhibit B, our base fee is shown in the following table:

Task	Lump Sum Fee ²
Subsurface Exploration ¹ , Private Utility Locate, Laboratory Testing, and Geotechnical Report	\$8,850

1. The lump sum fee considers one drill rig mobilization and no unexpected onsite delays. If additional drill rig mobilizations are required, an additional fee of \$2,500 would be invoiced. A drill crew standby rate of \$325 per hour would be invoiced for unexpected delays.
2. Proposed fees noted above are effective for 90 days from the date of the proposal.

Our Scope of Services does not include services associated with site clearing, wet ground conditions, tree or shrub clearing, repair of damage to existing landscape, or pavement damage. If such services are desired by the owner/client, we should be notified so we can adjust our Scope of Services and fee.

If we encounter conditions that will require a revision to our scope of services or will result in higher fees, we will contact you and obtain your approval prior to initiating these services. If we are authorized to proceed and the client subsequently postpones or cancels the work, we will invoice the client for the costs of project set up and mobilization incurred prior to notice of cancellation.

We are available to confer with the client after submittal of our report. Consultation is beyond the scope of this proposal and would be charged at \$125 per hour for a Staff Engineer, \$160 per hour for a Project Engineer, and \$225 per hour for a Senior Engineering Consultant.

Project Schedule

We developed a schedule to complete the Scope of Services based upon our existing availability and understanding of your project schedule. However, our schedule does not account for delays in field exploration beyond our control, such as weather conditions,

delays resulting from utility clearance, or lack of permission to access the boring locations. In the event the schedule provided is inconsistent with your needs, please contact us so we may consider alternatives.

Delivery on Compass	Schedule ^{1, 2, 3}
Utility Locates	2 business days after notice to proceed
Completion of Field Program	4 weeks
Geotechnical Engineering Report	6 weeks

1. Upon receipt of your notice to proceed we will activate the schedule component on **Compass** with specific, anticipated dates for the delivery points noted above as well as other pertinent events.
2. We will maintain an activities calendar within **Compass**. The schedule will be updated to maintain a current awareness of our plans for delivery.
3. The schedule for public utility locates is not controlled by Terracon. Although most statewide one-call systems are required to locate/mark public utilities within 2 business days after receipt of a locate request, it has been our experience that up to 7 business days may be required to complete these locates.

Proposal for Geotechnical Engineering Services

Moberly Fire Department - Station 1 | Moberly, Missouri

July 19, 2024 | Terracon Proposal No. P09245048



Exhibit D - Site Location



DIAGRAM IS FOR GENERAL LOCATION ONLY, AND IS NOT INTENDED FOR CONSTRUCTION PURPOSES

MAP PROVIDED BY MICROSOFT BING MAPS

Proposal for Geotechnical Engineering Services

Moberly Fire Department - Station 1 | Moberly, Missouri

July 19, 2024 | Terracon Proposal No. P09245048



Exhibit E - Anticipated Exploration Plan

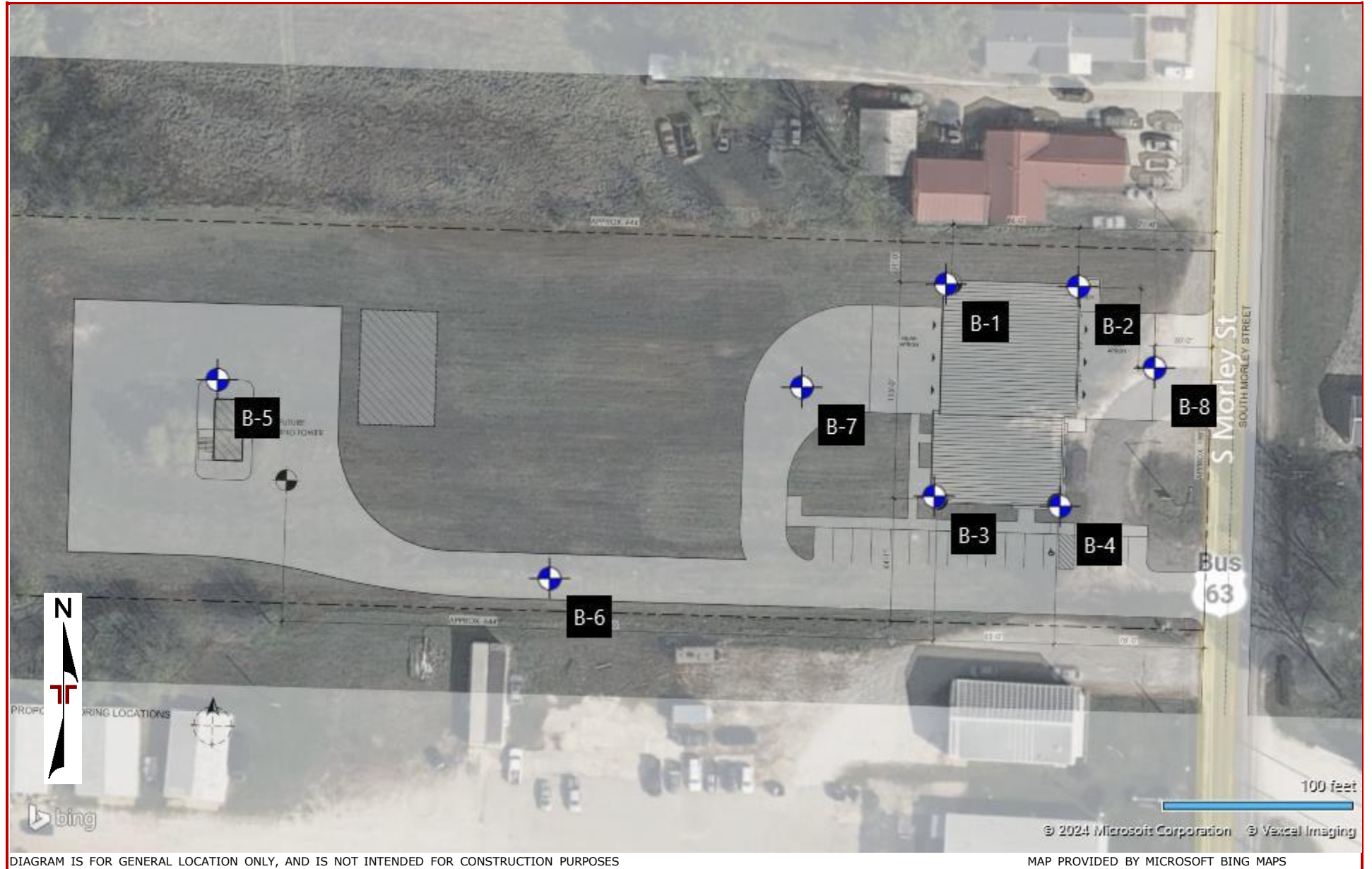

DIAGRAM IS FOR GENERAL LOCATION ONLY, AND IS NOT INTENDED FOR CONSTRUCTION PURPOSES

MAP PROVIDED BY MICROSOFT BING MAPS