

| | |
|---|----------------------------------|
| Date of Issuance: May 20, 2025 | Effective Date: May 20, 2025 |
| Owner: City of Mount Pleasant | Owner's Contract No.: - |
| Contractor: B.H. Craig Construction Co., Inc. | Contractor's Project No.: - |
| Engineer: Barge Design Solutions, Inc. | Engineer's Project No.: 34808-60 |
| Project: 2021 WWTP Improvements | Contract Name: |

The Contract is modified as follows upon execution of this Change Order:

Description: Following a site visit by the membrane manufacturer's representative, samples indicated the quality of the City's mixed liquor was not in alignment with the membrane manufacturer's standards. Additional piping was required to be installed, and critical path activities were delayed. The delay continued until samples indicated the mixed liquor was within the acceptable parameters. This change order is to compensate the contractor for costs and delay due to rescreening.

| CHANGE IN CONTRACT PRICE | CHANGE IN CONTRACT TIMES |
|--|---|
| Original Contract Price: \$ <u>12,731,400.00</u> | Original Contract Times: Substantial Completion: <u>545 – 11/25/2023</u> Ready for Final Payment: <u>605 – 1/24/2024</u> days or dates |
| Increase from previously approved Change Orders No. <u>1</u> to No. <u>4</u> : \$ <u>571,910.00</u> | Increase from previously approved Change Order No. 1 to No. 4: Substantial Completion: <u>182</u> Ready for Final Payment: <u>182</u> days |
| Contract Price prior to this Change Order: \$ <u>13,303,310.00</u> | Contract Times prior to this Change Order: Substantial Completion: <u>776 – 7/13/24</u> Ready for Final Payment: <u>836 – 9/11/24</u> days - dates |
| Increase of this Change Order: \$ <u>36,305</u> | Increase of this Change Order: Substantial Completion: <u>158</u> Ready for Final Payment: <u>158</u> days |
| Contract Price incorporating this Change Order: \$ <u>13,434,333.00</u> | Contract Times with all approved Change Orders: Substantial Completion: <u>934 – 12/18/2024</u> Ready for Final Payment: <u>994 – 2/16/2025</u> days - dates |

| RECOMMENDED: | | ACCEPTED: | | ACCEPTED: | |
|------------------------|------------------------------|-----------------------------------|-----------|-----------|-----------|
| By: _____ | By: _____ | By: _____ | By: _____ | By: _____ | By: _____ |
| Engineer (if required) | Owner (Authorized Signature) | Contractor (Authorized Signature) | | | |
| Title: _____ | Title _____ | Title _____ | | | |
| Date: _____ | Date _____ | Date _____ | | | |

Approved by Funding Agency (if applicable)

By: _____ Date: _____
 Title: _____

Date of Issuance: 4/3/2025 Effective Date: 4/3/2025
 Owner: City of Mount Pleasant Owner's Contract No.: -
 Contractor: BH Craig Construction Contractor's Project No.: -
 Engineer: Barge Design Solutions Engineer's Project No.: 34808-60
 Project: 2021 WWTP Improvements Contract Name: -

Contractor is directed to proceed promptly with the following change(s):

Description: Install piping from the existing IMLR 12" DIP at the northern side of Treatment Basin 1 to the existing 12" Influent DIP north of the Headworks. Temporary piping to be 8" in diameter and installed with approximately 30" of cover and no intermediate high points. The connection to the existing IMLR pipe shall be coordinated with the City and the shutdown of the IMLR system shall be less than 8 hours. See attached sketch for additional details.

Additional contract days will be added via Work Change Directive No. 2.

The Contractor claims the following costs:

Pipe Line Installation

| | |
|---------------|------------------------|
| Labor | \$14,850 |
| Materials | \$10,720 |
| Equipment | <u>\$6,000</u> |
| Craig Total | \$31,570 |
| 15% OHP | <u>\$ 4,735</u> |
| Totals | <u>\$36,305</u> |

Attachments: *Request for Contract Change #8*

Purpose for Work Change Directive:

Directive to proceed promptly with the Work described herein, prior to agreeing to changes on Contract Price and Contract Time, is issued due to:

- ☐ Non-agreement on pricing of proposed change.
☒ Necessity to proceed for schedule or other Project reasons.

Estimated Change in Contract Price and Contract Times (non-binding, preliminary):

Contract Price \$ 36,305 increase.
 Contract Time days increase.

Basis of estimated change in Contract Price:

- ☒ Lump Sum ☐ Unit Price
☐ Cost of the Work ☐ Other

RECOMMENDED:

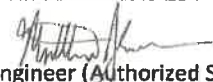
By: 
 Engineer (Authorized Signature)

Title: Project Manager
 Date: 4/3/25

AUTHORIZED BY:

By: 
 Owner (Authorized Signature)

Title: Mayor
 Date: 4/3/25

RECEIVED:

By: 
 Contractor (Authorized Signature)

Title: Vice President
 Date: 4/7/25

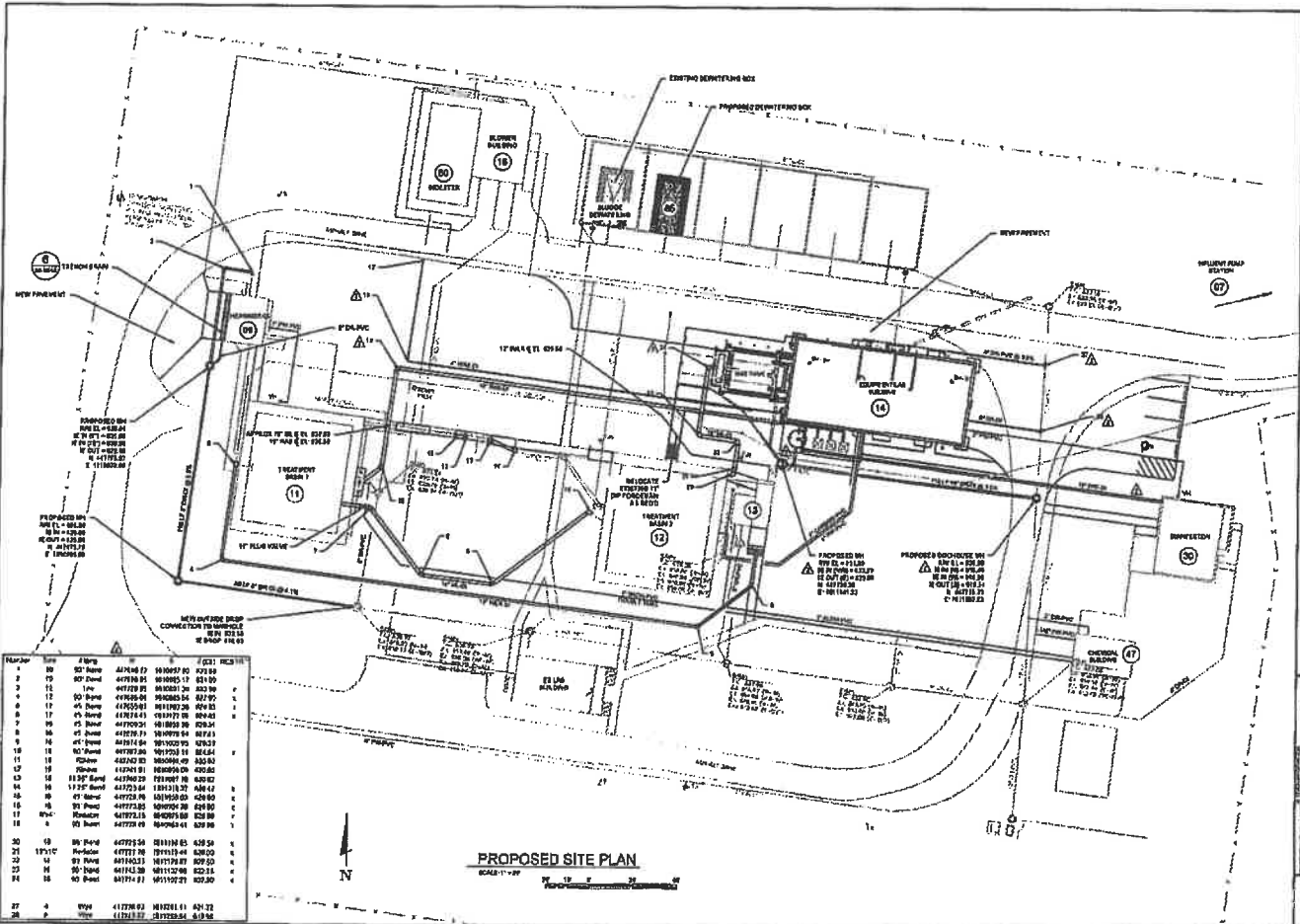

| Number | Size | Material | Start Station | End Station | Notes |
|--------|------|----------|---------------|-------------|-------|
| 1 | 30" | HDPE | 40+00.00 | 40+00.00 | NEW |
| 2 | 30" | HDPE | 40+00.00 | 40+00.00 | NEW |
| 3 | 12" | HDPE | 40+00.00 | 40+00.00 | NEW |
| 4 | 12" | HDPE | 40+00.00 | 40+00.00 | NEW |
| 5 | 12" | HDPE | 40+00.00 | 40+00.00 | NEW |
| 6 | 12" | HDPE | 40+00.00 | 40+00.00 | NEW |
| 7 | 12" | HDPE | 40+00.00 | 40+00.00 | NEW |
| 8 | 12" | HDPE | 40+00.00 | 40+00.00 | NEW |
| 9 | 12" | HDPE | 40+00.00 | 40+00.00 | NEW |
| 10 | 12" | HDPE | 40+00.00 | 40+00.00 | NEW |
| 11 | 12" | HDPE | 40+00.00 | 40+00.00 | NEW |
| 12 | 12" | HDPE | 40+00.00 | 40+00.00 | NEW |
| 13 | 12" | HDPE | 40+00.00 | 40+00.00 | NEW |
| 14 | 12" | HDPE | 40+00.00 | 40+00.00 | NEW |
| 15 | 12" | HDPE | 40+00.00 | 40+00.00 | NEW |
| 16 | 12" | HDPE | 40+00.00 | 40+00.00 | NEW |
| 17 | 12" | HDPE | 40+00.00 | 40+00.00 | NEW |
| 18 | 12" | HDPE | 40+00.00 | 40+00.00 | NEW |
| 19 | 12" | HDPE | 40+00.00 | 40+00.00 | NEW |
| 20 | 12" | HDPE | 40+00.00 | 40+00.00 | NEW |
| 21 | 12" | HDPE | 40+00.00 | 40+00.00 | NEW |
| 22 | 12" | HDPE | 40+00.00 | 40+00.00 | NEW |
| 23 | 12" | HDPE | 40+00.00 | 40+00.00 | NEW |
| 24 | 12" | HDPE | 40+00.00 | 40+00.00 | NEW |
| 25 | 12" | HDPE | 40+00.00 | 40+00.00 | NEW |
| 26 | 12" | HDPE | 40+00.00 | 40+00.00 | NEW |
| 27 | 12" | HDPE | 40+00.00 | 40+00.00 | NEW |
| 28 | 12" | HDPE | 40+00.00 | 40+00.00 | NEW |

PROPOSED SITE PLAN

SCALE: 1"=20'

01-C102
FILE NO. 34804-00

01-C102
FILE NO. 34804-00