



Special Use Permit

City of Montgomery
101 Old Plantersville Road
Montgomery, Texas 77316
(936) 597-6434

Applicant Information

Owner/leaseholder Name: H-E-B, LP

Address: 646 South Flores Street, San Antonio, Texas 78204

Email: klein.lance@heb.com Phone: 210-938-4076

Name of owner (if different): _____

Contact person (if different): Benjamin R. Scott

Address: 646 South Flores Street, San Antonio, Texas 78204

Email: klein.lance@heb.com Phone: 210-938-4076

Parcel Information

Type of Business: HEB Grocery Store

Legal Description: 31.97 Acre Tract of Land Situated in the J. Corner Survey, Abstract No. 8 of Montgomery County, Texas

Street Address or Location: Intersection of FM 2854 & Hwy 105 W

Special Use Permit Request

Description of request:

Applying for a SUP of a drive-thru for the restaurant that will be part of the HEB Grocery development.

Applicant's Signature  Date 07/24/2025

Submission Information

Submit the completed application with supporting documentation to:

City of Montgomery
Planning/Zoning Administrator
101 Old Plantersville Road
Montgomery, Texas 77316

Or via email: ctilley@ci.montgomery.tx.us

Additional Information

Date Application received by the City of Montgomery: _____

Owner(s) of record for the above described parcel: H-E-B, LP

Owner(s) of record for the above described parcel:

Signature: BS Date: 07/24/2025

Signature: _____ Date: _____

Signature: _____ Date: _____

*Note : Signatures are required for all owners of record for the property proposed for Special Use Permit.
Attach additional signatures on a separate sheet of paper.*

Date Received

Office Use

**HEB MONTGOMERY
MONTGOMERY, TEXAS**



NTGOMERY **ERY, TEXAS**

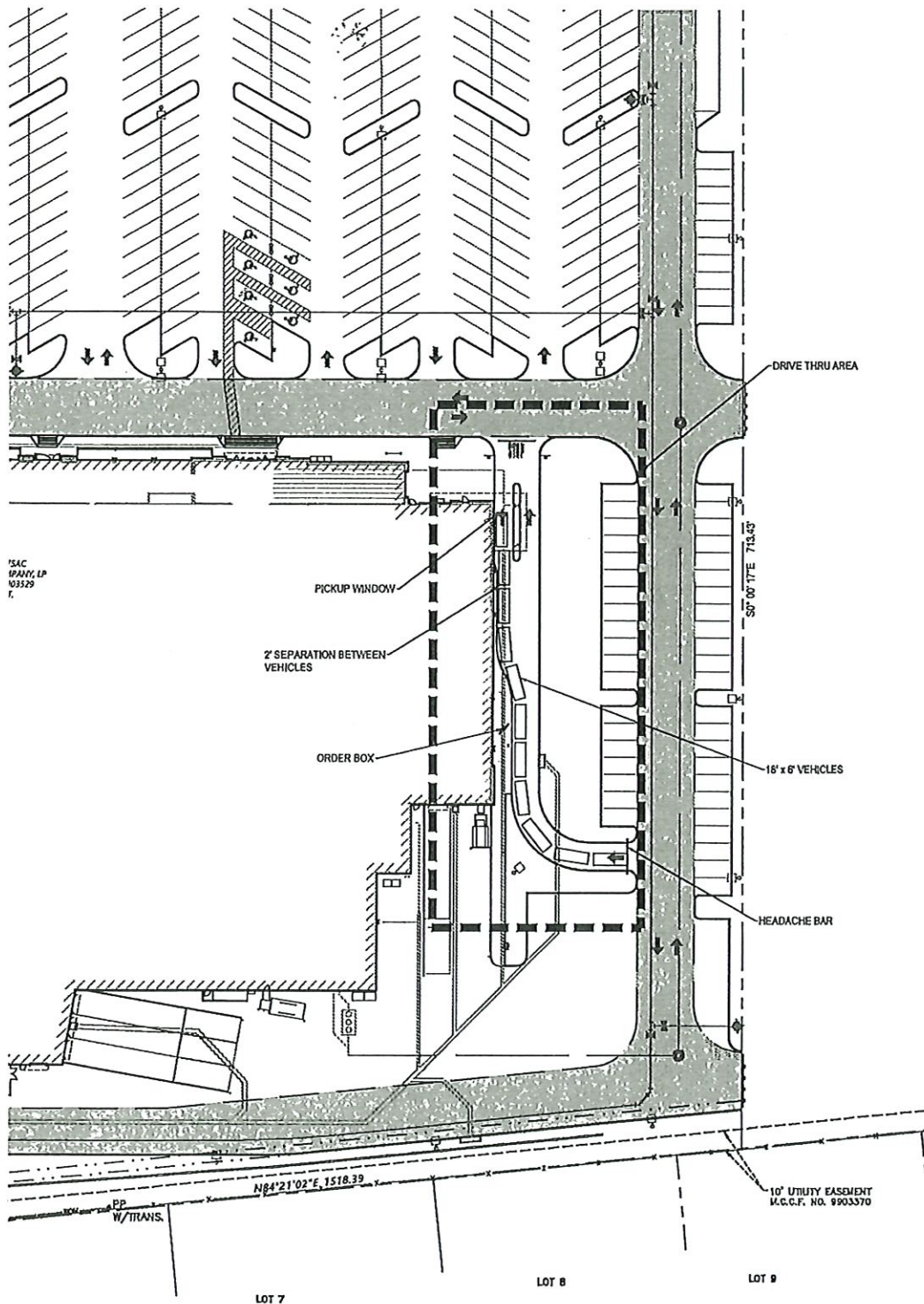

NO IMPACTS OR SAFETY
 CONCERNS WITH
 PEDESTRIAN TRAFFIC AS NO
 PEDESTRIAN CONNECTIVITY
 CROSSES DRIVE THRU