

DWHT - Construction trailer



Special Use Permit

City of Montgomery
101 Old Plantersville Road
Montgomery, Texas 77316
(936) 597-6434

Applicant Information

Owner/leaseholder Name: Wachley Homes
Address: 14444 Northwest Freeway Houston TX 77040
Email: norman@wachleyhomes.com Phone: 281/249-7769
Name of owner (if different): Johnson Dev.
Contact person (if different): Matt Banks
Address: 5005 Riverway Suite 500 Houston TX 77056
Email: matt@johnsondev.com Phone: 281/797-4426

Parcel Information

Type of Business: Home builder
Legal Description: 1-2-1 Briarley
Street Address or Location: 703 Runner Court

Special Use Permit Request

Description of request:

Temporary location for our construction team to office. We intend to occupy this space until the developer deems we need to move to a new section. At this time 2 years / 24 months is my estimated time need. Trailer will be removed and a home will be built when deemed appropriate by developer.

Applicant's Signature

Norman

Date

7/17/25

→ All builders are in Cuddosac to mitigate disruption to community + residents.

Submission Information

Submit the completed application with supporting documentation to:

City of Montgomery
Planning/Zoning Administrator
101 Old Plantersville Road
Montgomery, Texas 77316

Or via email: cfilley@ci.montgomery.tx.us

Additional Information

Date Application received by the City of Montgomery: _____

Owner(s) of record for the above described parcel: _____

Owner(s) of record for the above described parcel:

Signature: _____ Date: _____

Signature: _____ Date: _____

Signature: _____ Date: _____

*Note : Signatures are required for all owners of record for the property proposed for Special Use Permit.
Attach additional signatures on a separate sheet of paper.*

Date Received

Office Use



www.montgomerytexas.gov
101 Old Plantersville Road
Montgomery, TX 77316
Phone: 936-597-6434
Fax: 936-597-6437

permits@ci.montgomery.tx.us

COMMERCIAL BUILDING PERMIT APPLICATION

For the erection of buildings, accessories, repairs, demolition, moving, etc. Expires in 6 months. (180 days); Non-Transferable.

Building Permit # _____

Application Date: _____

911 Designated Jobsite Address: 703 Gunner Court - Trailer Temp.

Legal Property Description: Brigley Lot: 1 Block: 2 Section: 1

Property Owner: Weekley Home Phone: 281/249-7769 Email: nyomano@dwhomes.com

Property Owner Mailing Address: 14444 Northwest Freeway Houston 77040

Contractor: Same Company Email: _____

Company Address: _____

Field Supervisor Name: Steven Speer Email: SSpeer@dwhomes.com

Cell Phone: 713/299-8820

Construction Type(s): ☒ New ☐ Addition

☒ Exterior ☒ Interior

Gross Square Foot (sf) of Structure: 896 ☐ Proof of Ownership / Deed Attached

\$0.00 - \$1,000 = \$60.00 Flat Fee
\$1,001 - \$50,000 = \$15.00 for first \$1,000 + \$5.00 for each additional \$1,000 or fraction thereof
\$50,001 - \$100,000 = \$260.00 for first \$50,000 + \$4.00 for each additional \$1,000 or fraction thereof
\$100,001 - \$500,000 = \$460.00 FOR FIRST \$100,000 + \$3.00 for each additional \$1,000 or fraction thereof
OVER \$500,001 = \$1,660.00 FOR FIRST \$500,000 + \$2.00 for each additional \$1,000 or fraction thereof

PLAN REVIEW FEE IS HALF OF PERMIT FEE - DUE UPON SUBMITTAL

Separate Permits are required for Public Utilities; Electrical; Plumbing; Mechanical; Heating, Ventilation & Air Conditioning; Grading; Alarms; Roofing; Landscaping; Fire Sprinklers and Lawn Sprinklers. I hereby attest that I am the legal owner or authorized agent of the property described on this document. I certify that I am an authorized signer with the authority to submit this application. I certify that I have read and examined this application and attest that the information I am providing is correct. I understand that it is against the law to make a false statement on a government document and that incomplete applications will be denied. I agree to comply with all provisions of laws and ordinances governing this type of work, whether specified herein or not. The approval of this application does not presume to give authority to violate or cancel the provisions of any state or local law regulating construction or the performance of construction.

Applicant Signature: _____ Printed Name: _____ Date: _____

OFFICE USE ONLY

☐ Received for Review by: _____ Date: _____

☐ Approved by: _____ Date: _____

Re-inspections=\$75 each.

Additional Inspections required during project=\$100 each.

☐ Fire Marshall Notification

| | |
|---------------------------|-----------|
| Base Application Fee: | \$ 300.00 |
| + Fee Based on Valuation: | \$ |
| Total Fees Due: | \$ |
| Receipt #: | |

Revision: 1/9/2025

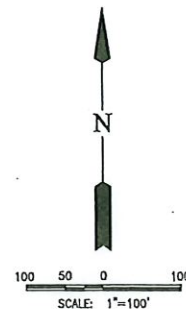
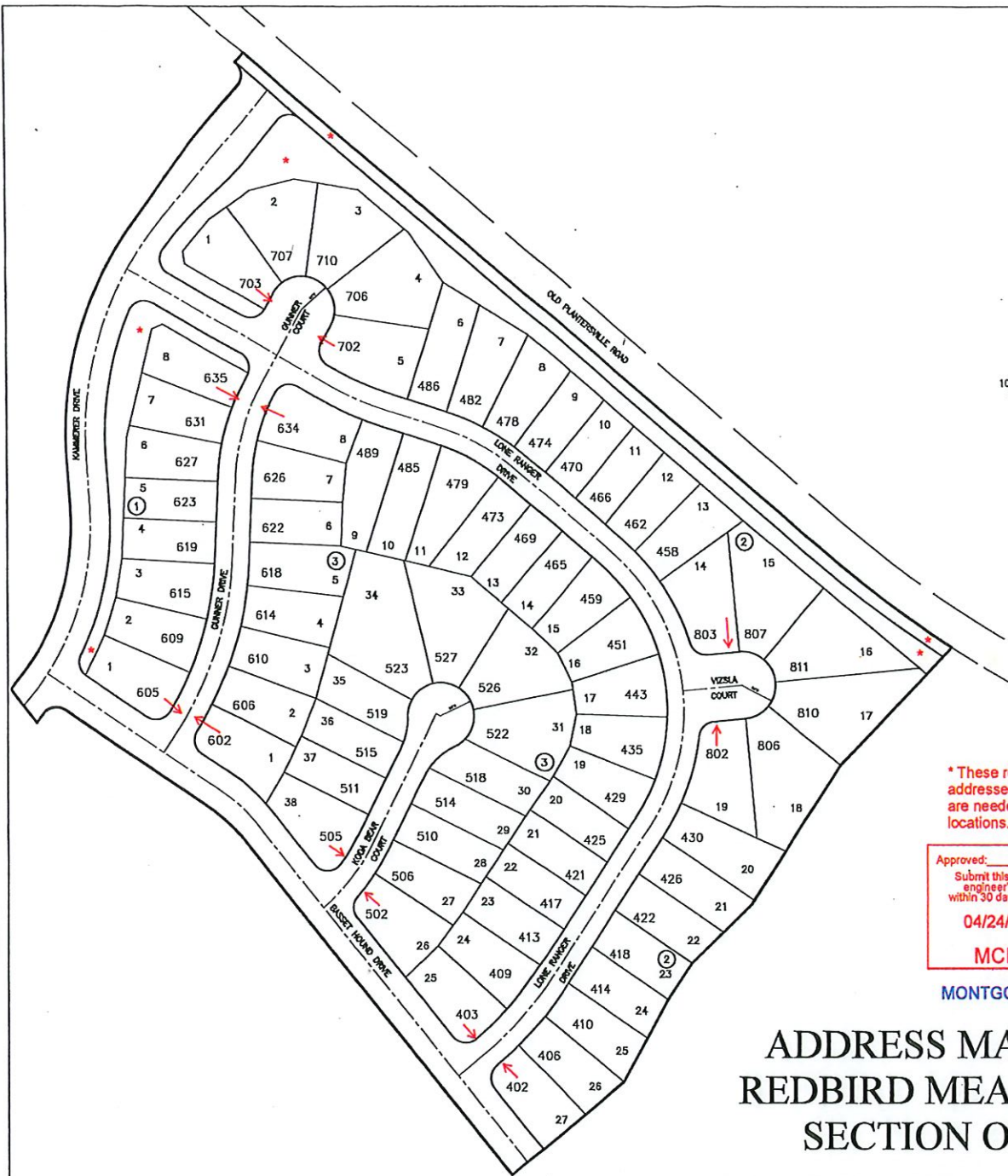

* These reserves will be addressed as utilities are needed at specific locations.

Approved: TD
Submit this address plat to the engineer's office for review within 30 days of the date below.
04/24/2024 10:31
MCECD - 911

MONTGOMERY, 77316

ADDRESS MAP OF REDBIRD MEADOWS SECTION ONE

A SUBDIVISION OF 27.18 ACRES OF LAND SITUATED IN THE
ZACHARIAH LANDRUM SURVEY, ABSTRACT A-22
MONTGOMERY COUNTY, TEXAS.

OWNERS: REDBIRD MEADOW DEVELOPMENT, LLC
A TEXAS LIMITED LIABILITY COMPANY
5910 FM 2920 RD, SUITE B
SPRING, TX 77388
(281) 350-6262

DEVELOPER: REDBIRD MEADOW DEVELOPMENT, LLC
A TEXAS LIMITED LIABILITY COMPANY
5910 FM 2920 RD, SUITE B
SPRING, TX 77388
(281) 350-6262

SURVEYOR:
LJA SURVEYING, INC.
3500 W Sam Houston Parkway S
Suite 175
Houston, Texas 77042
Phone 713.553.5200
Fax 713.553.5026
TSP/ELS Firm No. 10194352

ENGINEER:
LJA Engineering, Inc.
3500 W Sam Houston Parkway S
Suite 600
Houston, Texas 77042
Phone 713.553.5200
Fax 713.553.5028
FRN - F-1335

| Block | Lot No. | Size | Area |
|---------|---------|------|------|
| BLOCK 3 | 1 | 0.00 | 0.00 |
| | 2 | 0.00 | 0.00 |
| | 3 | 0.00 | 0.00 |
| | 4 | 0.00 | 0.00 |
| | 5 | 0.00 | 0.00 |
| | 6 | 0.00 | 0.00 |
| | 7 | 0.00 | 0.00 |
| | 8 | 0.00 | 0.00 |
| | 9 | 0.00 | 0.00 |
| | 10 | 0.00 | 0.00 |

| BLOCK 3 | | UNIT NO. 1001, HOUSES | |
|---------|-------|-----------------------|-------|
| | Area | Area | Area |
| 1 | 0.000 | 0.000 | 0.000 |
| 2 | 0.000 | 0.000 | 0.000 |
| 3 | 0.000 | 0.000 | 0.000 |
| 4 | 0.000 | 0.000 | 0.000 |
| 5 | 0.000 | 0.000 | 0.000 |
| 6 | 0.000 | 0.000 | 0.000 |
| 7 | 0.000 | 0.000 | 0.000 |
| 8 | 0.000 | 0.000 | 0.000 |
| 9 | 0.000 | 0.000 | 0.000 |
| 10 | 0.000 | 0.000 | 0.000 |
| 11 | 0.000 | 0.000 | 0.000 |
| 12 | 0.000 | 0.000 | 0.000 |
| 13 | 0.000 | 0.000 | 0.000 |
| 14 | 0.000 | 0.000 | 0.000 |
| 15 | 0.000 | 0.000 | 0.000 |
| 16 | 0.000 | 0.000 | 0.000 |
| 17 | 0.000 | 0.000 | 0.000 |
| 18 | 0.000 | 0.000 | 0.000 |
| 19 | 0.000 | 0.000 | 0.000 |
| 20 | 0.000 | 0.000 | 0.000 |

| BLOCK 2 | | | | |
|----------|-----|------|-------|-------|
| LINE NO. | QTY | UNIT | PRICE | TOTAL |
| 1 | 1 | EA | 10.00 | 10.00 |
| 2 | 1 | EA | 10.00 | 10.00 |
| 3 | 1 | EA | 10.00 | 10.00 |
| 4 | 1 | EA | 10.00 | 10.00 |
| 5 | 1 | EA | 10.00 | 10.00 |
| 6 | 1 | EA | 10.00 | 10.00 |
| 7 | 1 | EA | 10.00 | 10.00 |
| 8 | 1 | EA | 10.00 | 10.00 |
| 9 | 1 | EA | 10.00 | 10.00 |
| 10 | 1 | EA | 10.00 | 10.00 |
| 11 | 1 | EA | 10.00 | 10.00 |
| 12 | 1 | EA | 10.00 | 10.00 |
| 13 | 1 | EA | 10.00 | 10.00 |
| 14 | 1 | EA | 10.00 | 10.00 |
| 15 | 1 | EA | 10.00 | 10.00 |
| 16 | 1 | EA | 10.00 | 10.00 |
| 17 | 1 | EA | 10.00 | 10.00 |
| 18 | 1 | EA | 10.00 | 10.00 |
| 19 | 1 | EA | 10.00 | 10.00 |
| 20 | 1 | EA | 10.00 | 10.00 |
| 21 | 1 | EA | 10.00 | 10.00 |
| 22 | 1 | EA | 10.00 | 10.00 |
| 23 | 1 | EA | 10.00 | 10.00 |
| 24 | 1 | EA | 10.00 | 10.00 |
| 25 | 1 | EA | 10.00 | 10.00 |
| 26 | 1 | EA | 10.00 | 10.00 |
| 27 | 1 | EA | 10.00 | 10.00 |
| 28 | 1 | EA | 10.00 | 10.00 |
| 29 | 1 | EA | 10.00 | 10.00 |
| 30 | 1 | EA | 10.00 | 10.00 |
| 31 | 1 | EA | 10.00 | 10.00 |
| 32 | 1 | EA | 10.00 | 10.00 |
| 33 | 1 | EA | 10.00 | 10.00 |
| 34 | 1 | EA | 10.00 | 10.00 |
| 35 | 1 | EA | 10.00 | 10.00 |
| 36 | 1 | EA | 10.00 | 10.00 |
| 37 | 1 | EA | 10.00 | 10.00 |
| 38 | 1 | EA | 10.00 | 10.00 |
| 39 | 1 | EA | 10.00 | 10.00 |
| 40 | 1 | EA | 10.00 | 10.00 |
| 41 | 1 | EA | 10.00 | 10.00 |
| 42 | 1 | EA | 10.00 | 10.00 |
| 43 | 1 | EA | 10.00 | 10.00 |
| 44 | 1 | EA | 10.00 | 10.00 |
| 45 | 1 | EA | 10.00 | 10.00 |
| 46 | 1 | EA | 10.00 | 10.00 |
| 47 | 1 | EA | 10.00 | 10.00 |
| 48 | 1 | EA | 10.00 | 10.00 |
| 49 | 1 | EA | 10.00 | 10.00 |
| 50 | 1 | EA | 10.00 | 10.00 |
| 51 | 1 | EA | 10.00 | 10.00 |
| 52 | 1 | EA | 10.00 | 10.00 |
| 53 | 1 | EA | 10.00 | 10.00 |
| 54 | 1 | EA | 10.00 | 10.00 |
| 55 | 1 | EA | 10.00 | 10.00 |
| 56 | 1 | EA | 10.00 | 10.00 |
| 57 | 1 | EA | 10.00 | 10.00 |
| 58 | 1 | EA | 10.00 | 10.00 |
| 59 | 1 | EA | 10.00 | 10.00 |
| 60 | 1 | EA | 10.00 | 10.00 |
| 61 | 1 | EA | 10.00 | 10.00 |
| 62 | 1 | EA | 10.00 | 10.00 |
| 63 | 1 | EA | 10.00 | 10.00 |
| 64 | 1 | EA | 10.00 | 10.00 |
| 65 | 1 | EA | 10.00 | 10.00 |
| 66 | 1 | EA | 10.00 | 10.00 |
| 67 | 1 | EA | 10.00 | 10.00 |
| 68 | 1 | EA | 10.00 | 10.00 |
| 69 | 1 | EA | 10.00 | 10.00 |
| 70 | 1 | EA | 10.00 | 10.00 |
| 71 | 1 | EA | 10.00 | 10.00 |
| 72 | 1 | EA | 10.00 | 10.00 |
| 73 | 1 | EA | 10.00 | 10.00 |
| 74 | 1 | EA | 10.00 | 10.00 |
| 75 | 1 | EA | 10.00 | 10.00 |
| 76 | 1 | EA | 10.00 | 10.00 |
| 77 | 1 | EA | 10.00 | 10.00 |
| 78 | 1 | EA | 10.00 | 10.00 |
| 79 | 1 | EA | 10.00 | 10.00 |

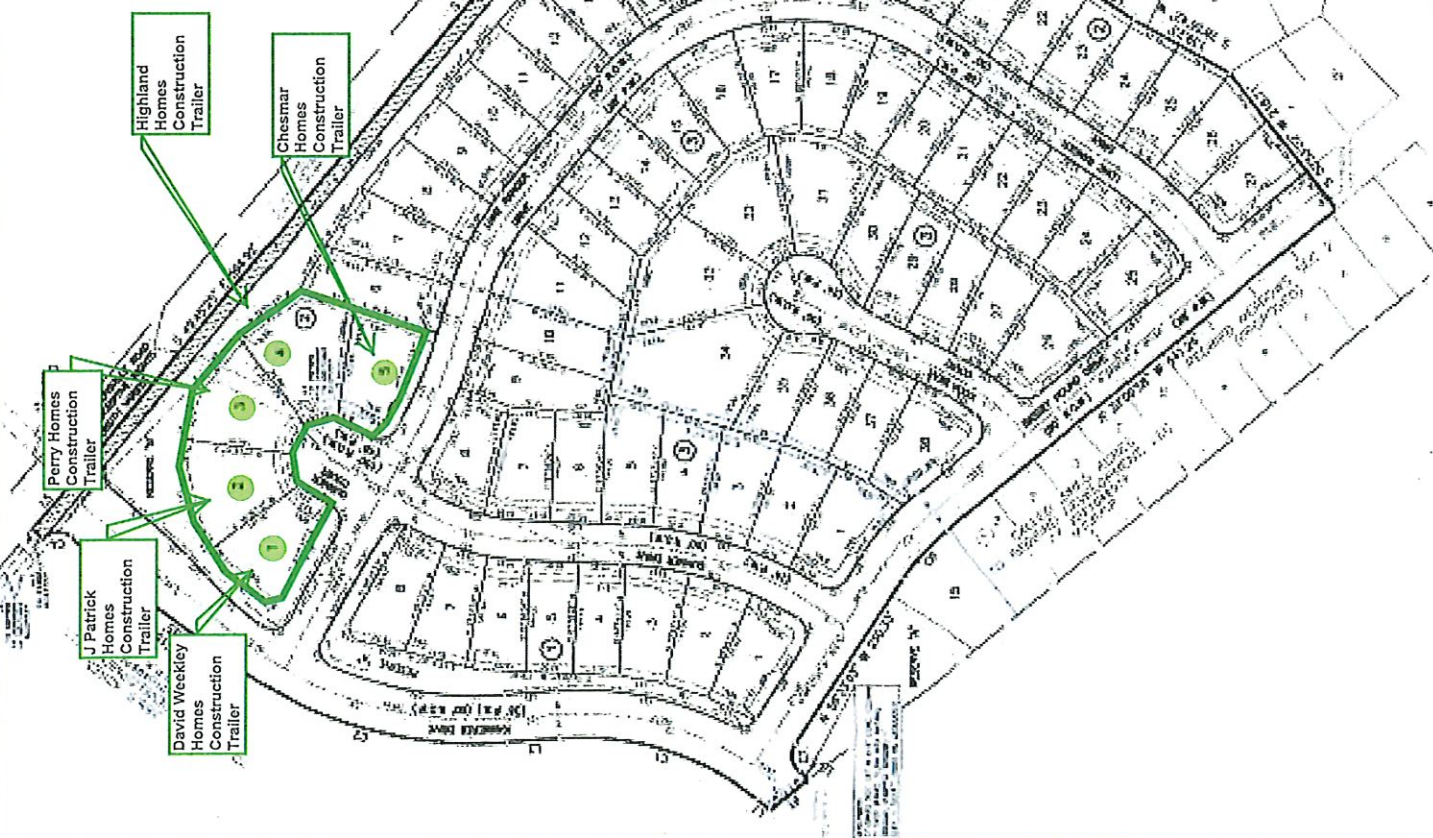
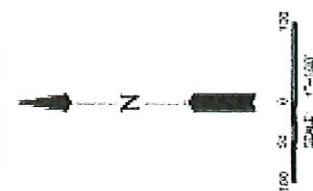
[illegible]

| RESERVE TABLE | | |
|---------------|---------|------------------------------|
| RESERVE | ADDRESS | TYPE |
| 0 | 2 000 | RESERVED TO OPERATING SYSTEM |
| 10 | 1 000 | RESERVED TO OPERATING SYSTEM |
| 200 | 1 000 | RESERVED |

- [illegible]



| | | | | | | |
|---|------------------|---|-------------------------------------|------------------------------|---|--|
| <div>PLT PLAN</div> <div>TRAILER</div> <div>HOUSTON</div> | <div>NORTH</div> | <div>BRIARLEY</div> <div>703 GUNNER COURT</div> <div>MONTGOMERY, TX</div> | <div>Proj No:</div> <div>7034</div> | <div>Lot:</div> <div>1</div> | <div>David Weekley Homes</div> | <div>© Weekley Homes LP, 2015</div> <div>The measurements, description, and other specifications, when on documents, are a guideline for construction use only. The actual specifications of the finished structure may vary. This document may not be relied on as a representation of what the completed structure will look like.</div> |
| | | | <div>Job No:</div> <div>0000</div> | <div>Bk:</div> <div>2</div> | | |
| | | | <div>Sect:</div> <div>1</div> | <div>JLH</div> | <div>Date:</div> <div>Rev: 01/09/24 JLH</div> | |