

MONTGOMERY TX
Wayfinding & Signage Program

PROGRAMMING:
Sign Location Plans_FINAL-V1

V_1 July 13, 2023

V_2 September 13, 2023

V_3 August 16, 2024

merJE

MERJE | ENVIRONMENTS & EXPERIENCES

5 W. Gay Street

West Chester, PA 19380

T 484.266.0648

www.merjedesign.com

SECTION 1 | Sign Location Plans

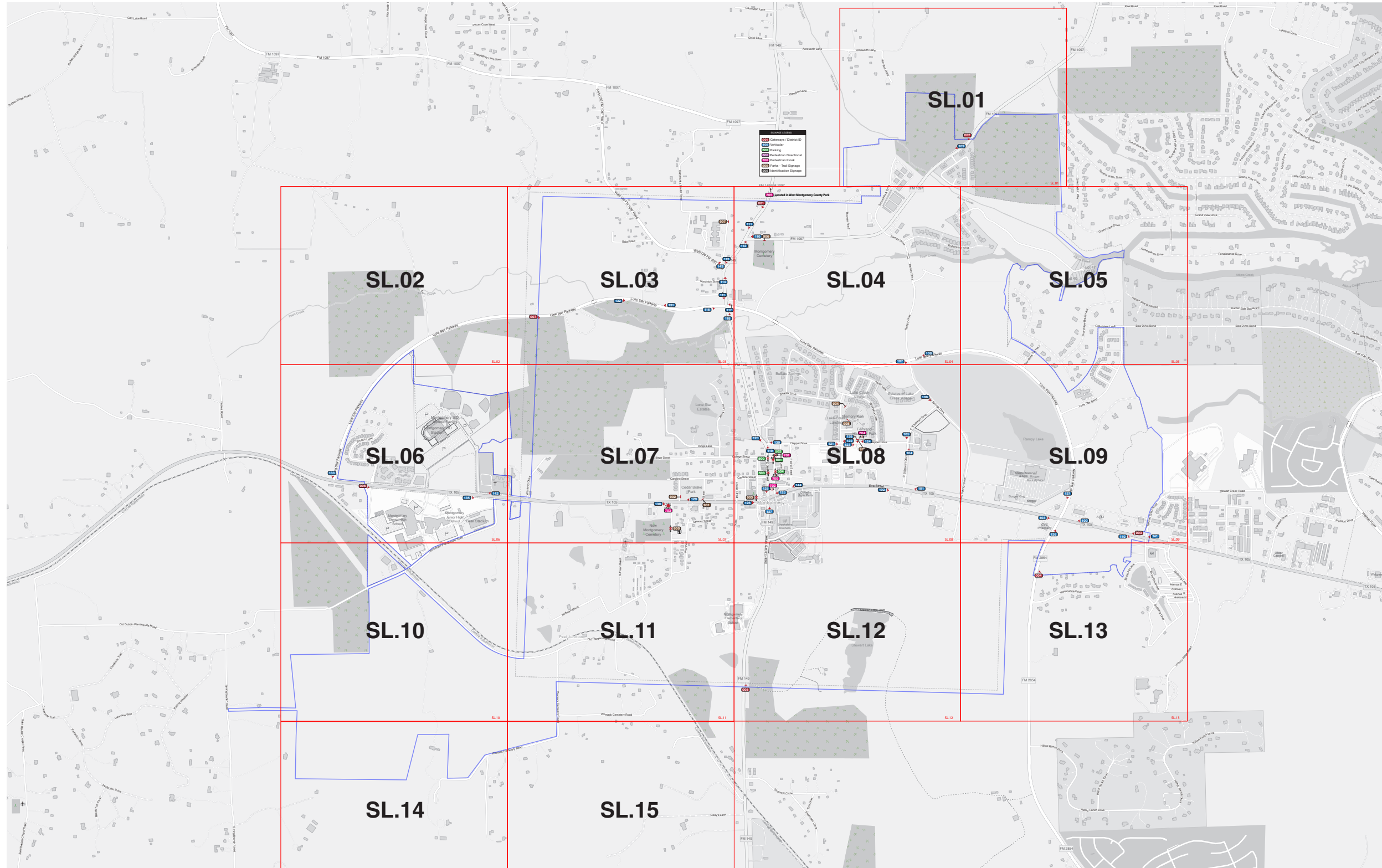

SPECIFICATIONS

Refer to the Wayfinding and Signage System design intent documentation for sign type drawings, material call-outs and installation methods.

Refer to the Wayfinding and Signage System message schedule for all sign type messages, location numbers, quantities, and specific location details.

SIGNAGE LEGEND

- 001 Gateways / District ID
- 100 Vehicular
- 500 Parking
- 600 Pedestrian Directional
- 700 Pedestrian Kiosk
- 900 Parks - Trail Signage
- 900 Identification Signage

- NOTES:**
- General sign locations are provided on these plan sheets.
 - The Message Schedule provides more detailed guidance of sign location in the Remarks column.
 - Refer to the Message Schedule for the final messages of each sign.
 - Utilize the above Legend to help determine sign types, and other details of location.

ENVIRONMENTS & EXPERIENCES

merJe

120 North Church Street
Suite 208
West Chester, PA 19380
T 484.266.0648
www.merjedesign.com

| | | |
|---|----------|---|
| DATE | 07/13/23 | CLIENT / PROJECT |
| DRAWN BY: | GS | |
| <p>These drawings are meant for DESIGN INTENT ONLY and are not for construction. Contractor shall verify and be responsible for all dimensions and conditions of the job. Contractor shall be familiar with the site and conditions it presents. This office must be notified of any variations from the dimensions and conditions shown on this drawing. Shop drawings and details must be submitted to this office for approval prior to proceeding with fabrication. All copy shall be proofread by client and legal requirements checked by legal department.</p> | | <p>Montgomery TX Wayfinding and Signage System</p> |
| REVISIONS | | PROJECT NO. |
| V2_09/13/23 | | SHEET TITLE |
| V3_08/16/24 | | |
| | | <p>KEY</p> |
| | | SHEET NO. |
| | | <p>KEY</p> |

A | Citywide Locations

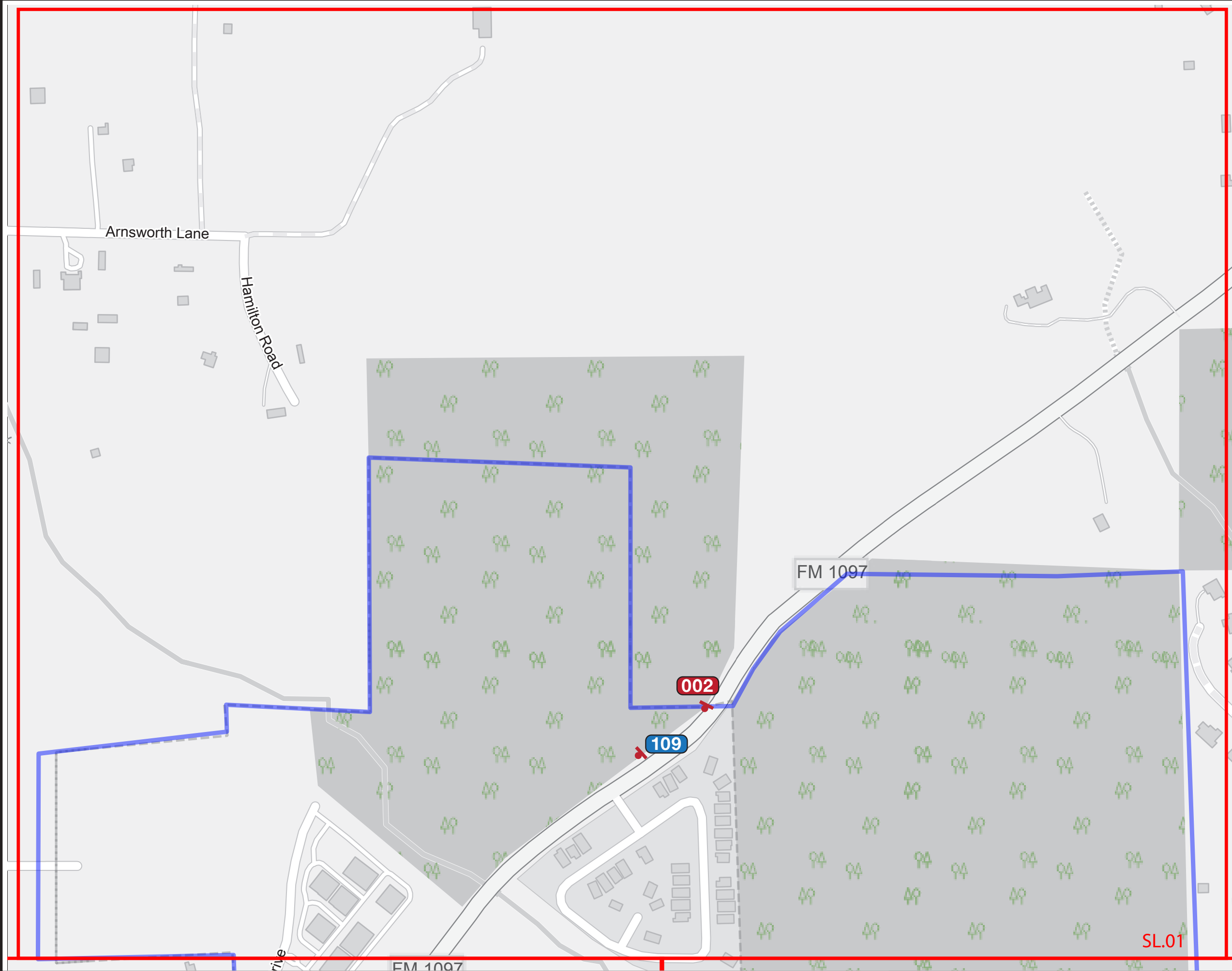

SPECIFICATIONS

Refer to the Wayfinding and Signage System design intent documentation for sign type drawings, material call-outs and installation methods.

Refer to the Wayfinding and Signage System message schedule for all sign type messages, location numbers, quantities, and specific location details.

| SIGNAGE LEGEND | |
|----------------|------------------------|
| 001 | Gateways / District ID |
| 100 | Vehicular |
| 500 | Parking |
| 600 | Pedestrian Directional |
| 700 | Pedestrian Kiosk |
| 900 | Parks - Trail Signage |
| 900 | Identification Signage |

- NOTES:**
1. General sign locations are provided on these plan sheets.
 2. The Message Schedule provides more detailed guidance of sign location in the Remarks column.
 3. Refer to the Message Schedule for the final messages of each sign.
 4. Utilize the above Legend to help determine sign types, and other details of location.

ENVIRONMENTS & EXPERIENCES

merJe

120 North Church Street
Suite 208
West Chester, PA 19380
T 484.266.0648
www.merjedesign.com

| | | |
|---|----------|---|
| DATE | 07/13/23 | CLIENT / PROJECT |
| DRAWN BY: | GS | |
| <p>These drawings are meant for DESIGN INTENT ONLY and are not for construction. Contractor shall verify and be responsible for all dimensions and conditions of the job. Contractor shall be familiar with the site and conditions it presents. This office must be notified of any variations from the dimensions and conditions shown on this drawing. Shop drawings and details must be submitted to this office for approval prior to proceeding with fabrication. All copy shall be proofread by client and legal requirements checked by legal department.</p> | | <p>Montgomery TX Wayfinding and Signage System</p> |
| REVISIONS | | PROJECT NO. |
| V2_09/13/23 | | SHEET TITLE |
| V3_08/16/24 | | |
| | | SHEET NO. |
| | | SL.01 |

SL.01

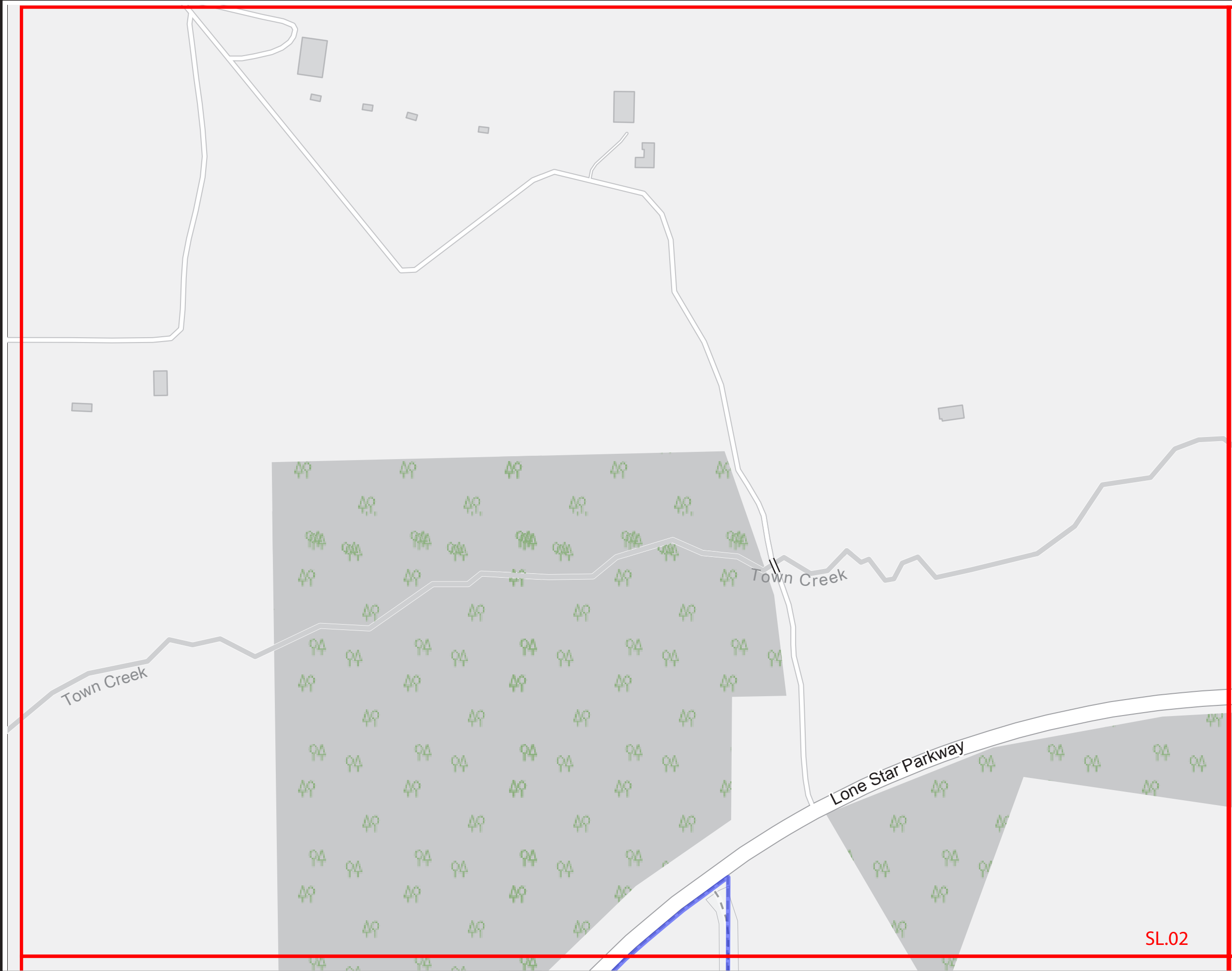

SPECIFICATIONS

Refer to the Wayfinding and Signage System design intent documentation for sign type drawings, material call-outs and installation methods.

Refer to the Wayfinding and Signage System message schedule for all sign type messages, location numbers, quantities, and specific location details.

| SIGNAGE LEGEND | |
|----------------|------------------------|
| 001 | Gateways / District ID |
| 100 | Vehicular |
| 500 | Parking |
| 600 | Pedestrian Directional |
| 700 | Pedestrian Kiosk |
| 900 | Parks - Trail Signage |
| 900 | Identification Signage |

- NOTES:**
1. General sign locations are provided on these plan sheets.
 2. The Message Schedule provides more detailed guidance of sign location in the Remarks column.
 3. Refer to the Message Schedule for the final messages of each sign.
 4. Utilize the above Legend to help determine sign types, and other details of location.

ENVIRONMENTS & EXPERIENCES

merJe

120 North Church Street
Suite 208
West Chester, PA 19380
T 484.266.0648
www.merjedesign.com

DATE 07/13/23

CLIENT / PROJECT

DRAWN BY: GS

Montgomery TX
Wayfinding and Signage System

These drawings are meant for DESIGN INTENT ONLY and are not for construction. Contractor shall verify and be responsible for all dimensions and conditions of the job. Contractor shall be familiar with the site and conditions it presents. This office must be notified of any variations from the dimensions and conditions shown on this drawing. Shop drawings and details must be submitted to this office for approval prior to proceeding with fabrication. All copy shall be proofread by client and legal requirements checked by legal department.

PROJECT NO.

SHEET TITLE

Sign Location Plans

REVISIONS

V2_09/13/23

SHEET NO.

V3_08/16/24

SL.02

SL.02

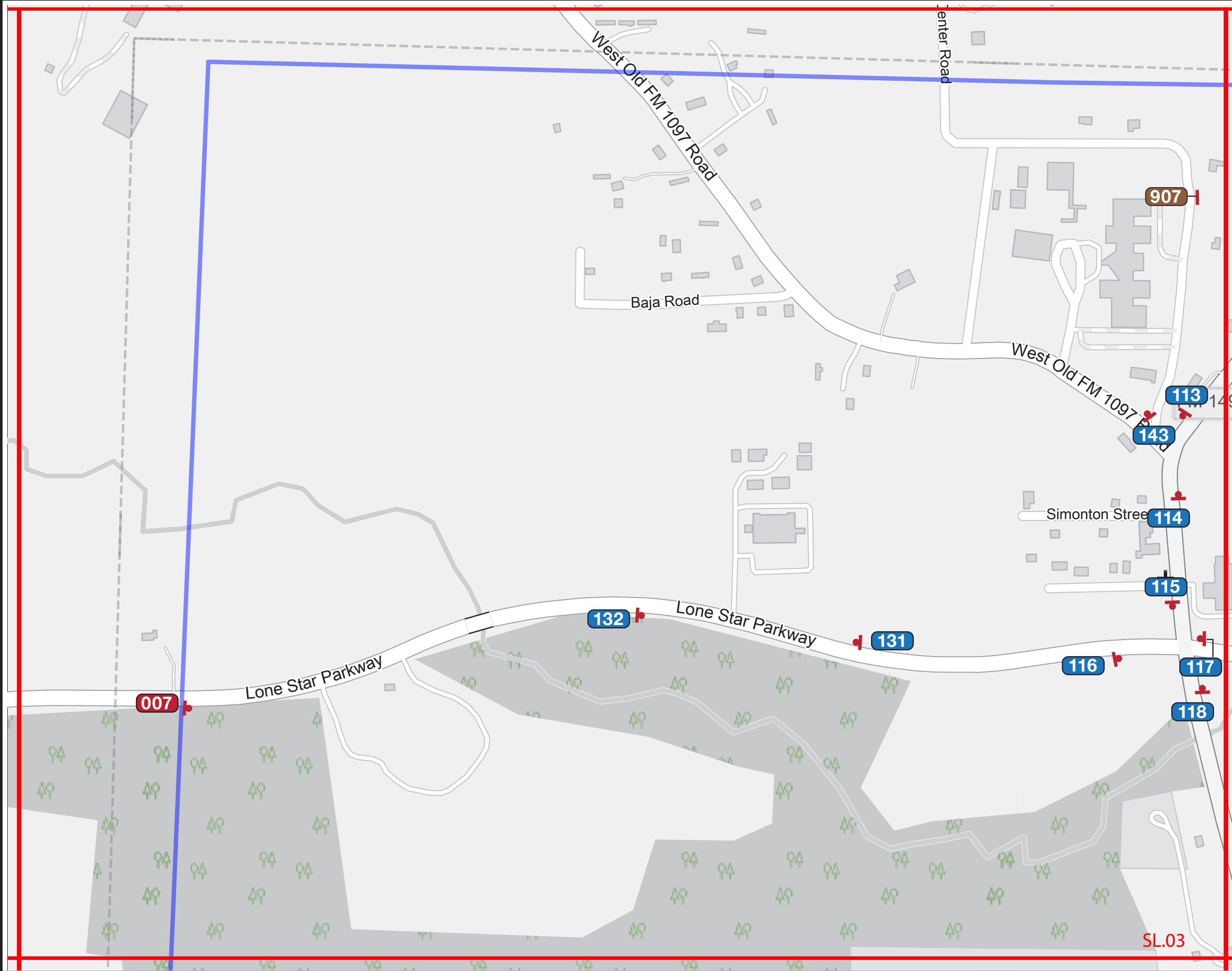

SPECIFICATIONS

Refer to the Wayfinding and Signage System design intent documentation for sign type drawings, material call-outs and installation methods.

Refer to the Wayfinding and Signage System message schedule for all sign type messages, location numbers, quantities, and specific location details.

| SIGNAGE LEGEND | |
|----------------|------------------------|
| 001 | Gateways / District ID |
| 100 | Vehicular |
| 500 | Parking |
| 600 | Pedestrian Directional |
| 700 | Pedestrian Kiosk |
| 900 | Parks - Trail Signage |
| 900 | Identification Signage |

- NOTES:**
1. General sign locations are provided on these plan sheets.
 2. The Message Schedule provides more detailed guidance of sign location in the Remarks column.
 3. Refer to the Message Schedule for the final messages of each sign.
 4. Utilize the above Legend to help determine sign types, and other details of location.

ENVIRONMENTS & EXPERIENCES

merJe

120 North Church Street
Suite 208
West Chester, PA 19380
T 484.266.0648
www.merjedesign.com

| | |
|--|----------|
| DATE | 07/13/23 |
| DRAWN BY: | GS |
| These drawings are meant for DESIGN INTENT ONLY and are not for construction. Contractor shall verify and be responsible for all dimensions and conditions of the job. Contractor shall be familiar with the site and conditions it presents. This office must be notified of any variations from the dimensions and conditions shown on this drawing. Shop drawings and details must be submitted to this office for approval prior to proceeding with fabrication. All copy shall be proofread by client and legal requirements checked by legal department. | |
| REVISIONS | |
| V2_09/13/23 | |
| V3_08/16/24 | |

| | |
|------------------|---|
| CLIENT / PROJECT | Montgomery TX Wayfinding and Signage System |
| PROJECT NO. | |
| SHEET TITLE | Sign Location Plans |
| SHEET NO. | SL.03 |

SL.03

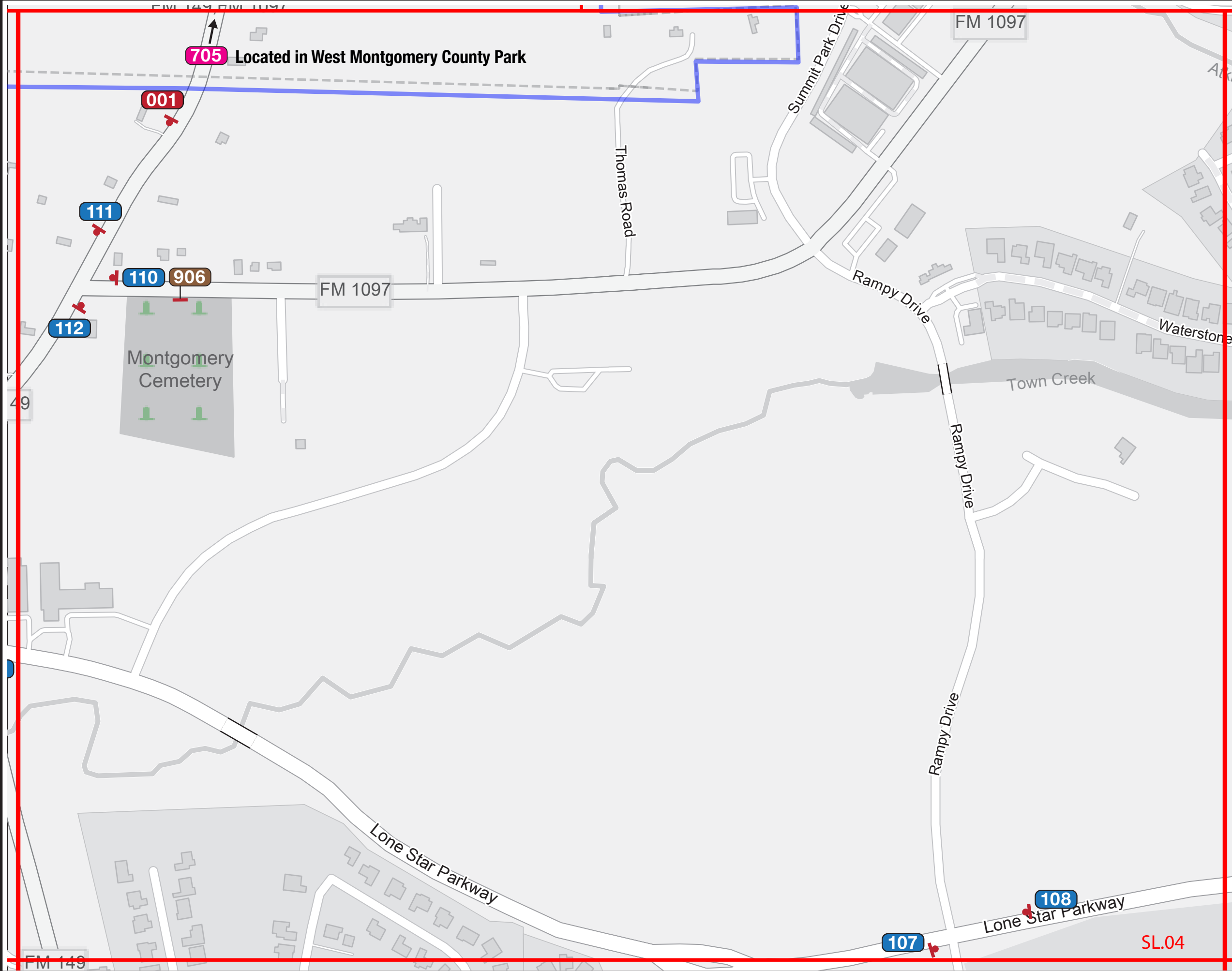

705 Located in West Montgomery County Park

SPECIFICATIONS

Refer to the Wayfinding and Signage System design intent documentation for sign type drawings, material call-outs and installation methods.

Refer to the Wayfinding and Signage System message schedule for all sign type messages, location numbers, quantities, and specific location details.

| SIGNAGE LEGEND | |
|--|------------------------|
| 001 | Gateways / District ID |
| 100 | Vehicular |
| 500 | Parking |
| 600 | Pedestrian Directional |
| 700 | Pedestrian Kiosk |
| 900 | Parks - Trail Signage |
| 900 | Identification Signage |

- NOTES:**
- General sign locations are provided on these plan sheets.
 - The Message Schedule provides more detailed guidance of sign location in the Remarks column.
 - Refer to the Message Schedule for the final messages of each sign.
 - Utilize the above Legend to help determine sign types, and other details of location.

ENVIRONMENTS & EXPERIENCES

merJe

120 North Church Street
Suite 208
West Chester, PA 19380
T 484.266.0648
www.merjedesign.com

| | | |
|---|----------|--|
| DATE | 07/13/23 | CLIENT / PROJECT |
| DRAWN BY: | GS | |
| <p>These drawings are meant for DESIGN INTENT ONLY and are not for construction. Contractor shall verify and be responsible for all dimensions and conditions of the job. Contractor shall be familiar with the site and conditions it presents. This office must be notified of any variations from the dimensions and conditions shown on this drawing. Shop drawings and details must be submitted to this office for approval prior to proceeding with fabrication. All copy shall be proofread by client and legal requirements checked by legal department.</p> | | <p>Montgomery TX</p> <p>Wayfinding and Signage System</p> |
| REVISIONS | | PROJECT NO. |
| V2_09/13/23 | | SHEET TITLE |
| V3_08/16/24 | | Sign Location Plans |
| | | SHEET NO. |
| | | SL.04 |

SL.04

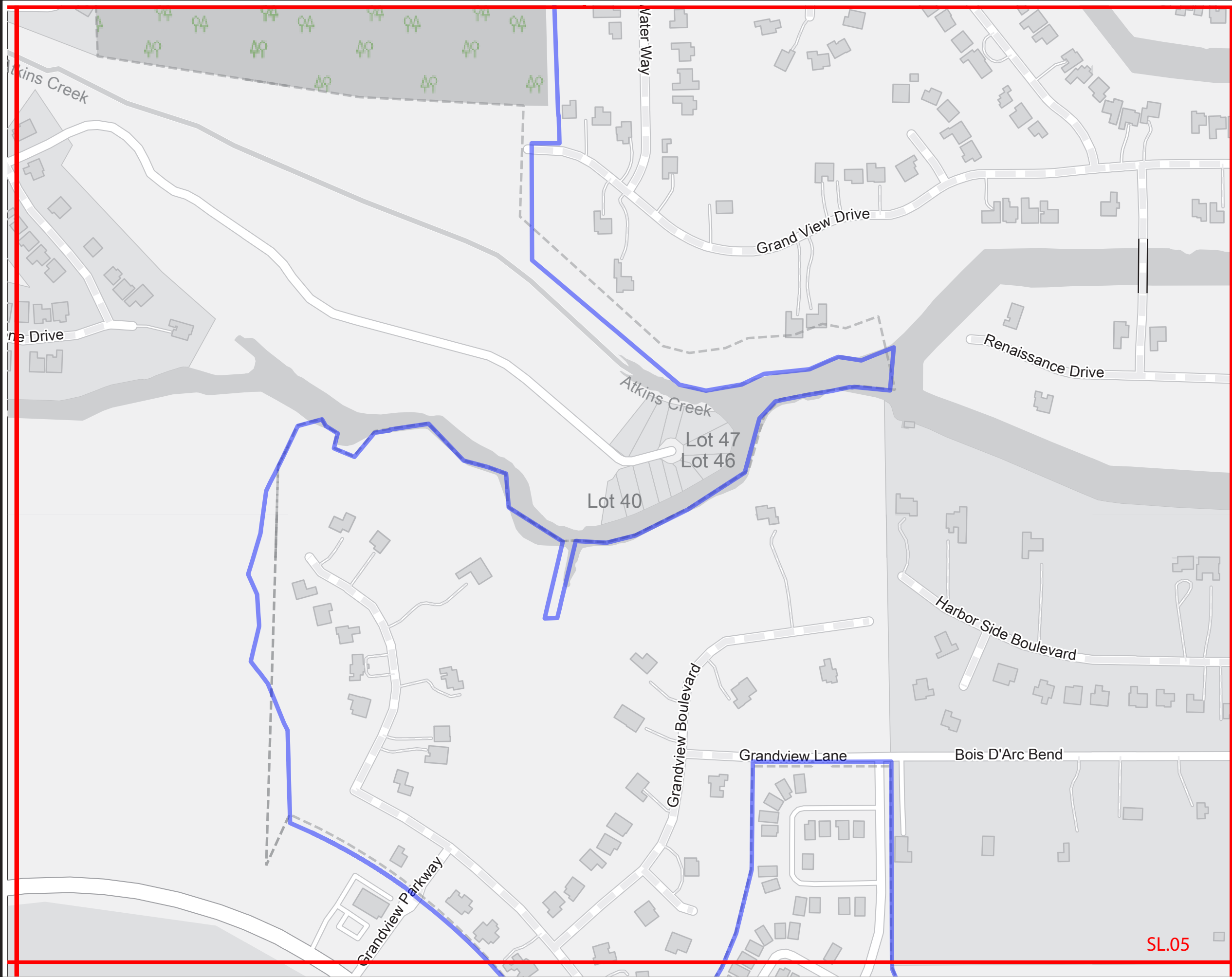

SPECIFICATIONS

Refer to the Wayfinding and Signage System design intent documentation for sign type drawings, material call-outs and installation methods.

Refer to the Wayfinding and Signage System message schedule for all sign type messages, location numbers, quantities, and specific location details.

| SIGNAGE LEGEND | |
|----------------|------------------------|
| 001 | Gateways / District ID |
| 100 | Vehicular |
| 500 | Parking |
| 600 | Pedestrian Directional |
| 700 | Pedestrian Kiosk |
| 900 | Parks - Trail Signage |
| 900 | Identification Signage |

- NOTES:**
1. General sign locations are provided on these plan sheets.
 2. The Message Schedule provides more detailed guidance of sign location in the Remarks column.
 3. Refer to the Message Schedule for the final messages of each sign.
 4. Utilize the above Legend to help determine sign types, and other details of location.

ENVIRONMENTS & EXPERIENCES

merJe

120 North Church Street
Suite 208
West Chester, PA 19380
T 484.266.0648
www.merjedesign.com

DATE 07/13/23

CLIENT / PROJECT

DRAWN BY: GS

Montgomery TX

These drawings are meant for DESIGN INTENT ONLY and are not for construction. Contractor shall verify and be responsible for all dimensions and conditions of the job. Contractor shall be familiar with the site and conditions it presents. This office must be notified of any variations from the dimensions and conditions shown on this drawing. Shop drawings and details must be submitted to this office for approval prior to proceeding with fabrication. All copy shall be proofread by client and legal requirements checked by legal department.

Wayfinding and Signage System

REVISIONS

PROJECT NO.

V2_09/13/23

SHEET TITLE

V3_08/16/24

Sign Location Plans

SHEET NO.

SL.05

SL.05

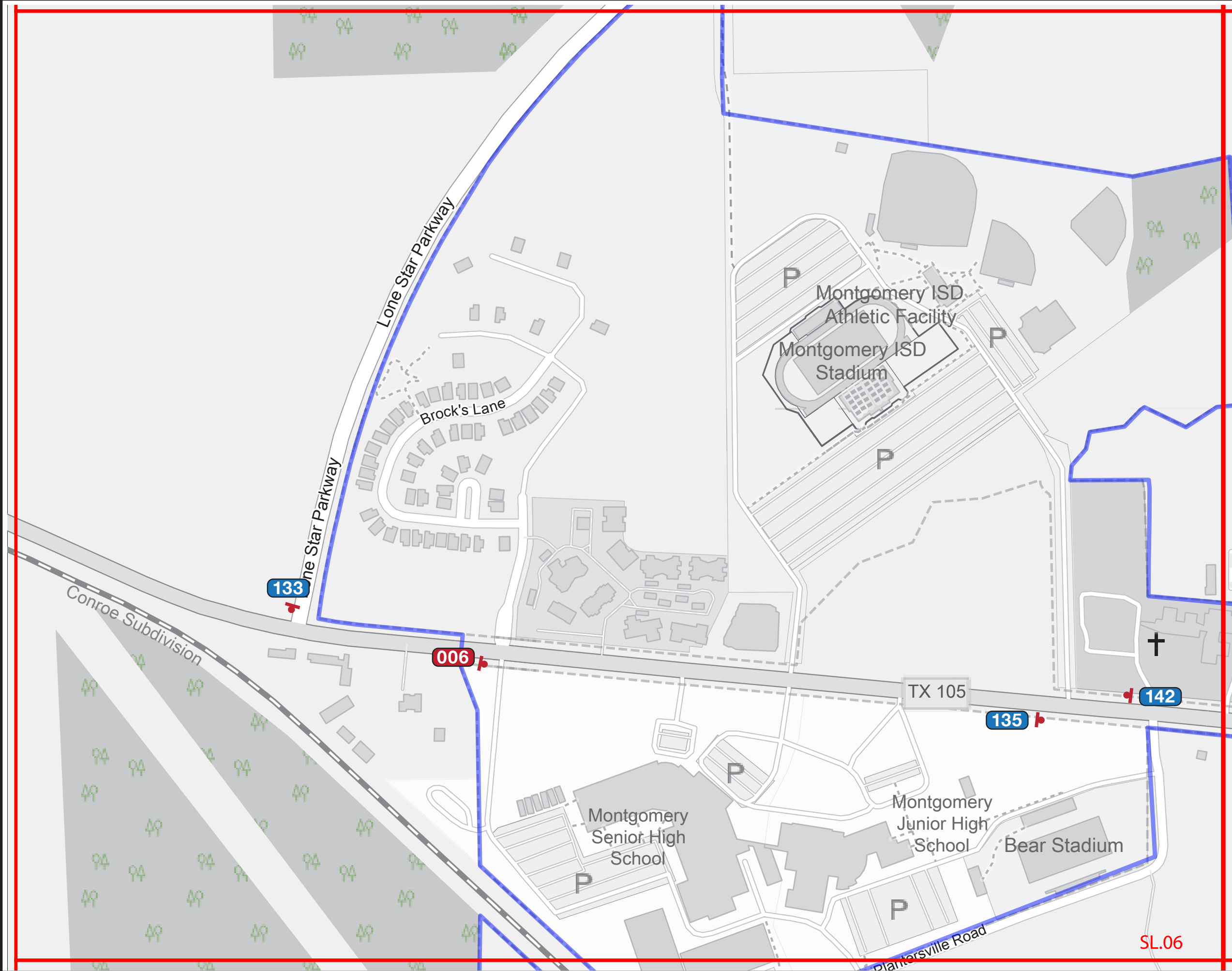

SPECIFICATIONS

Refer to the Wayfinding and Signage System design intent documentation for sign type drawings, material call-outs and installation methods.

Refer to the Wayfinding and Signage System message schedule for all sign type messages, location numbers, quantities, and specific location details.

| SIGNAGE LEGEND | |
|----------------|------------------------|
| 001 | Gateways / District ID |
| 100 | Vehicular |
| 500 | Parking |
| 600 | Pedestrian Directional |
| 700 | Pedestrian Kiosk |
| 900 | Parks - Trail Signage |
| 900 | Identification Signage |

- NOTES:**
1. General sign locations are provided on these plan sheets.
 2. The Message Schedule provides more detailed guidance of sign location in the Remarks column.
 3. Refer to the Message Schedule for the final messages of each sign.
 4. Utilize the above Legend to help determine sign types, and other details of location.

ENVIRONMENTS & EXPERIENCES

merje

120 North Church Street
Suite 208
West Chester, PA 19380
T 484.266.0648
www.merjedesign.com

DATE 07/13/23

DRAWN BY: GS

These drawings are meant for DESIGN INTENT ONLY and are not for construction. Contractor shall verify and be responsible for all dimensions and conditions of the job. Contractor shall be familiar with the site and conditions it presents. This office must be notified of any variations from the dimensions and conditions shown on this drawing. Shop drawings and details must be submitted to this office for approval prior to proceeding with fabrication. All copy shall be proofread by client and legal requirements checked by legal department.

REVISIONS

V2_09/13/23

V3_08/16/24

CLIENT / PROJECT

Montgomery TX
Wayfinding and Signage System

PROJECT NO.

SHEET TITLE

Sign Location Plans

SHEET NO.

SL.06

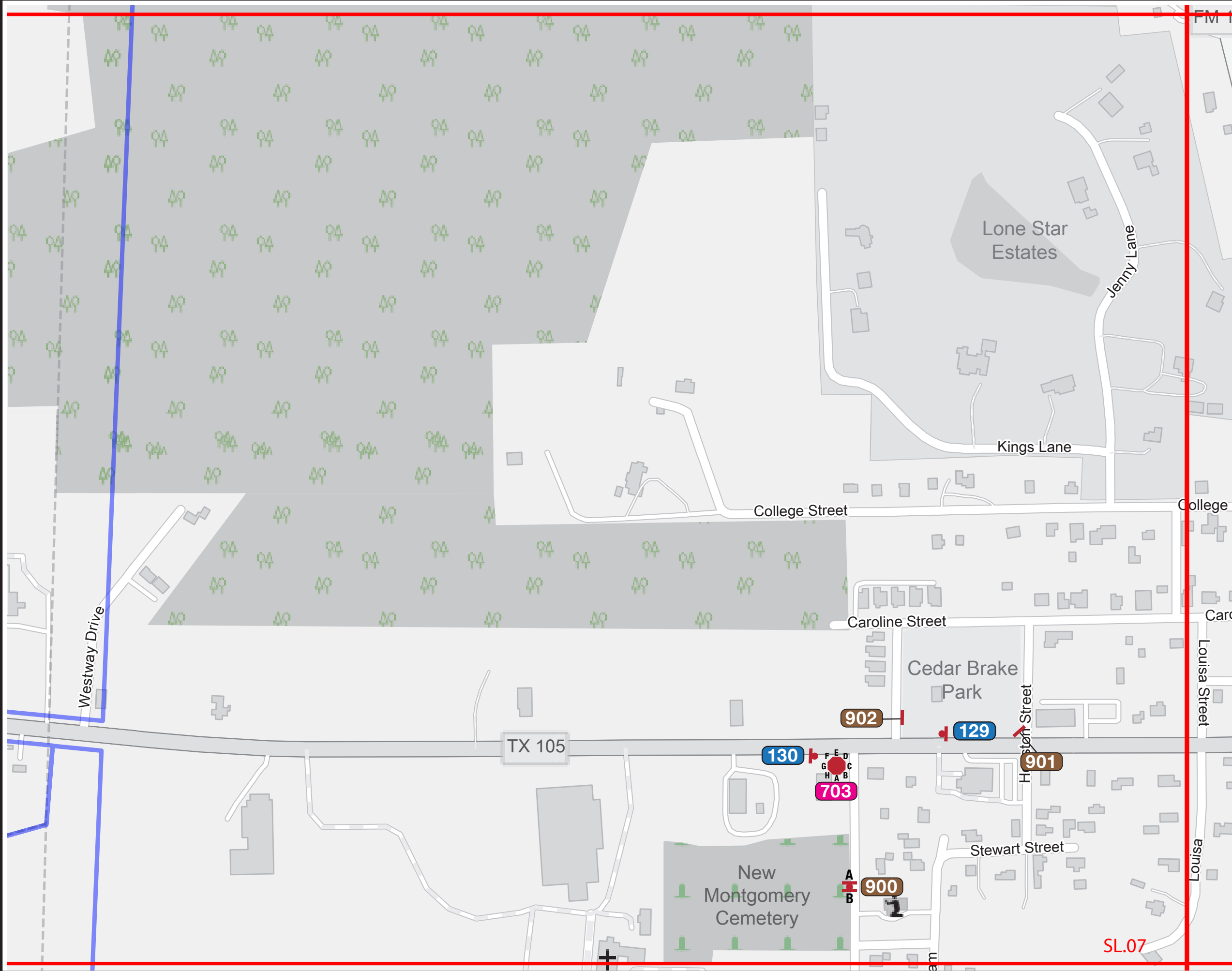

SPECIFICATIONS

Refer to the Wayfinding and Signage System design intent documentation for sign type drawings, material call-outs and installation methods.

Refer to the Wayfinding and Signage System message schedule for all sign type messages, location numbers, quantities, and specific location details.

SIGNAGE LEGEND

- 001 Gateways / District ID
- 100 Vehicular
- 500 Parking
- 600 Pedestrian Directional
- 700 Pedestrian Kiosk
- 900 Parks - Trail Signage
- 900 Identification Signage

- NOTES:**
1. General sign locations are provided on these plan sheets.
 2. The Message Schedule provides more detailed guidance of sign location in the Remarks column.
 3. Refer to the Message Schedule for the final messages of each sign.
 4. Utilize the above Legend to help determine sign types, and other details of location.

ENVIRONMENTS & EXPERIENCES

merJe

120 North Church Street
Suite 208
West Chester, PA 19380
T 484.266.0648
www.merjedesign.com

DATE 07/13/23

CLIENT / PROJECT

DRAWN BY: GS

Montgomery TX
Wayfinding and Signage System

These drawings are meant for DESIGN INTENT ONLY and are not for construction. Contractor shall verify and be responsible for all dimensions and conditions of the job. Contractor shall be familiar with the site and conditions it presents. This office must be notified of any variations from the dimensions and conditions shown on this drawing. Shop drawings and details must be submitted to this office for approval prior to proceeding with fabrication. All copy shall be proofread by client and legal requirements checked by legal department.

PROJECT NO.

SHEET TITLE

Sign Location Plans

REVISIONS

V2_09/13/23

SHEET NO.

V3_08/16/24

SL.07

SL.07

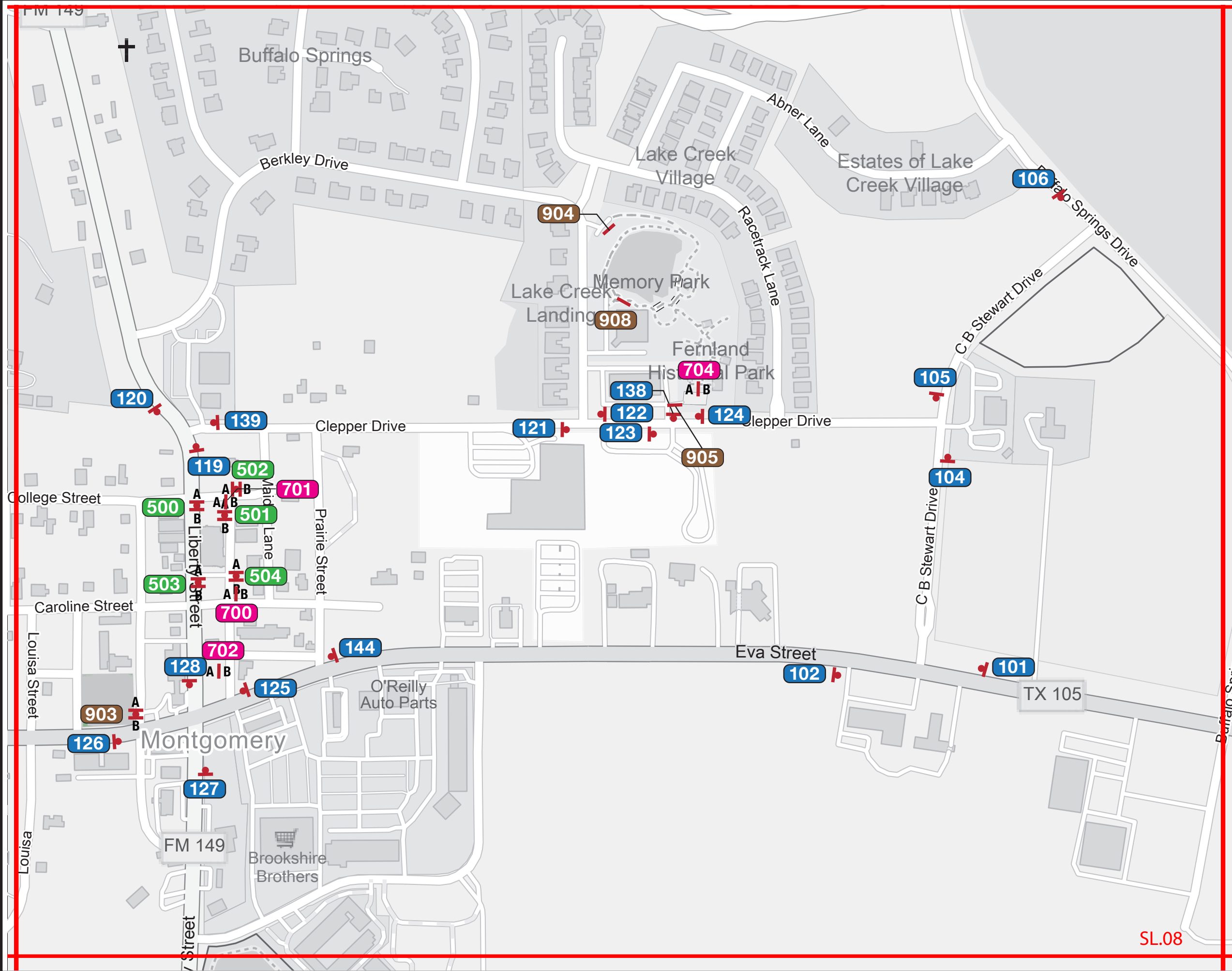

SPECIFICATIONS

Refer to the Wayfinding and Signage System design intent documentation for sign type drawings, material call-outs and installation methods.

Refer to the Wayfinding and Signage System message schedule for all sign type messages, location numbers, quantities, and specific location details.

| SIGNAGE LEGEND | |
|----------------|------------------------|
| 001 | Gateways / District ID |
| 100 | Vehicular |
| 500 | Parking |
| 600 | Pedestrian Directional |
| 700 | Pedestrian Kiosk |
| 900 | Parks - Trail Signage |
| 900 | Identification Signage |

- NOTES:**
1. General sign locations are provided on these plan sheets.
 2. The Message Schedule provides more detailed guidance of sign location in the Remarks column.
 3. Refer to the Message Schedule for the final messages of each sign.
 4. Utilize the above Legend to help determine sign types, and other details of location.

ENVIRONMENTS & EXPERIENCES

merje

120 North Church Street
Suite 208
West Chester, PA 19380
T 484.266.0648
www.merjedesign.com

| | | | |
|---|----------|------------------|--|
| DATE | 07/13/23 | CLIENT / PROJECT | Montgomery TX Wayfinding and Signage System |
| DRAWN BY: | GS | PROJECT NO. | |
| <p>These drawings are meant for DESIGN INTENT ONLY and are not for construction. Contractor shall verify and be responsible for all dimensions and conditions of the job. Contractor shall be familiar with the site and conditions it presents. This office must be notified of any variations from the dimensions and conditions shown on this drawing. Shop drawings and details must be submitted to this office for approval prior to proceeding with fabrication. All copy shall be proofread by client and legal requirements checked by legal department.</p> | | SHEET TITLE | Sign Location Plans |
| REVISIONS | | SHEET NO. | SL.08 |
| V2_09/13/23 | | | |
| V3_08/16/24 | | | |

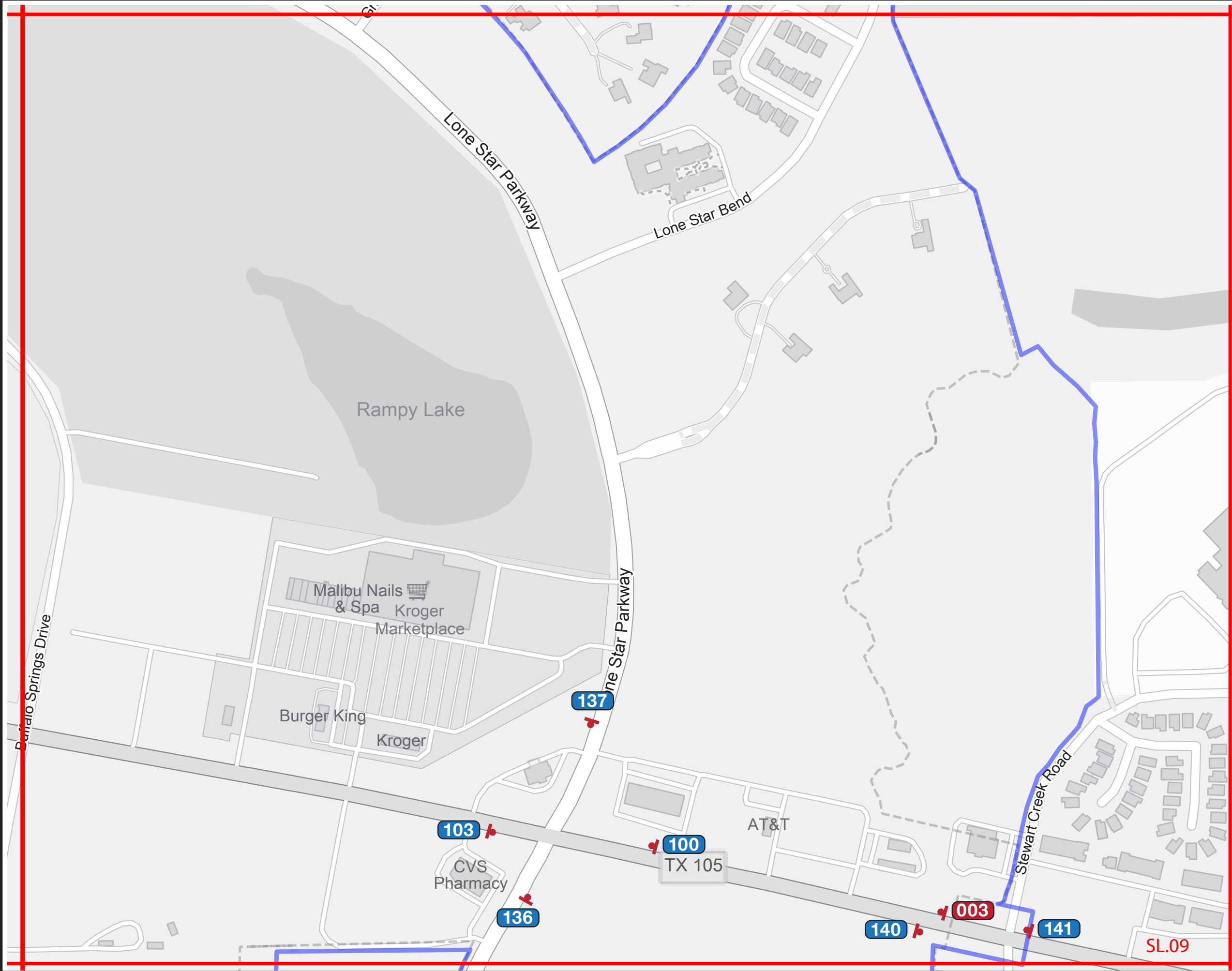

SPECIFICATIONS

Refer to the Wayfinding and Signage System design intent documentation for sign type drawings, material call-outs and installation methods.

Refer to the Wayfinding and Signage System message schedule for all sign type messages, location numbers, quantities, and specific location details.

| SIGNAGE LEGEND | |
|----------------|------------------------|
| 001 | Gateways / District ID |
| 100 | Vehicular |
| 500 | Parking |
| 600 | Pedestrian Directional |
| 700 | Pedestrian Kiosk |
| 900 | Parks - Trail Signage |
| 900 | Identification Signage |

- NOTES:**
1. General sign locations are provided on these plan sheets.
 2. The Message Schedule provides more detailed guidance of sign location in the Remarks column.
 3. Refer to the Message Schedule for the final messages of each sign.
 4. Utilize the above Legend to help determine sign types, and other details of location.

ENVIRONMENTS & EXPERIENCES

merJe

120 North Church Street
Suite 208
West Chester, PA 19380
T 484.266.0648
www.merjedesign.com

DATE 07/13/23

CLIENT / PROJECT

DRAWN BY: GS

Montgomery TX

These drawings are meant for DESIGN INTENT ONLY and are not for construction. Contractor shall verify and be responsible for all dimensions and conditions of the job. Contractor shall be familiar with the site and conditions it presents. This office must be notified of any variations from the dimensions and conditions shown on this drawing. Shop drawings and details must be submitted to this office for approval prior to proceeding with fabrication. All copy shall be proofread by client and legal requirements checked by legal department.

Wayfinding and Signage System

REVISIONS

PROJECT NO.

V2_09/13/23

SHEET TITLE

V3_08/16/24

Sign Location Plans

SHEET NO.

SL.09

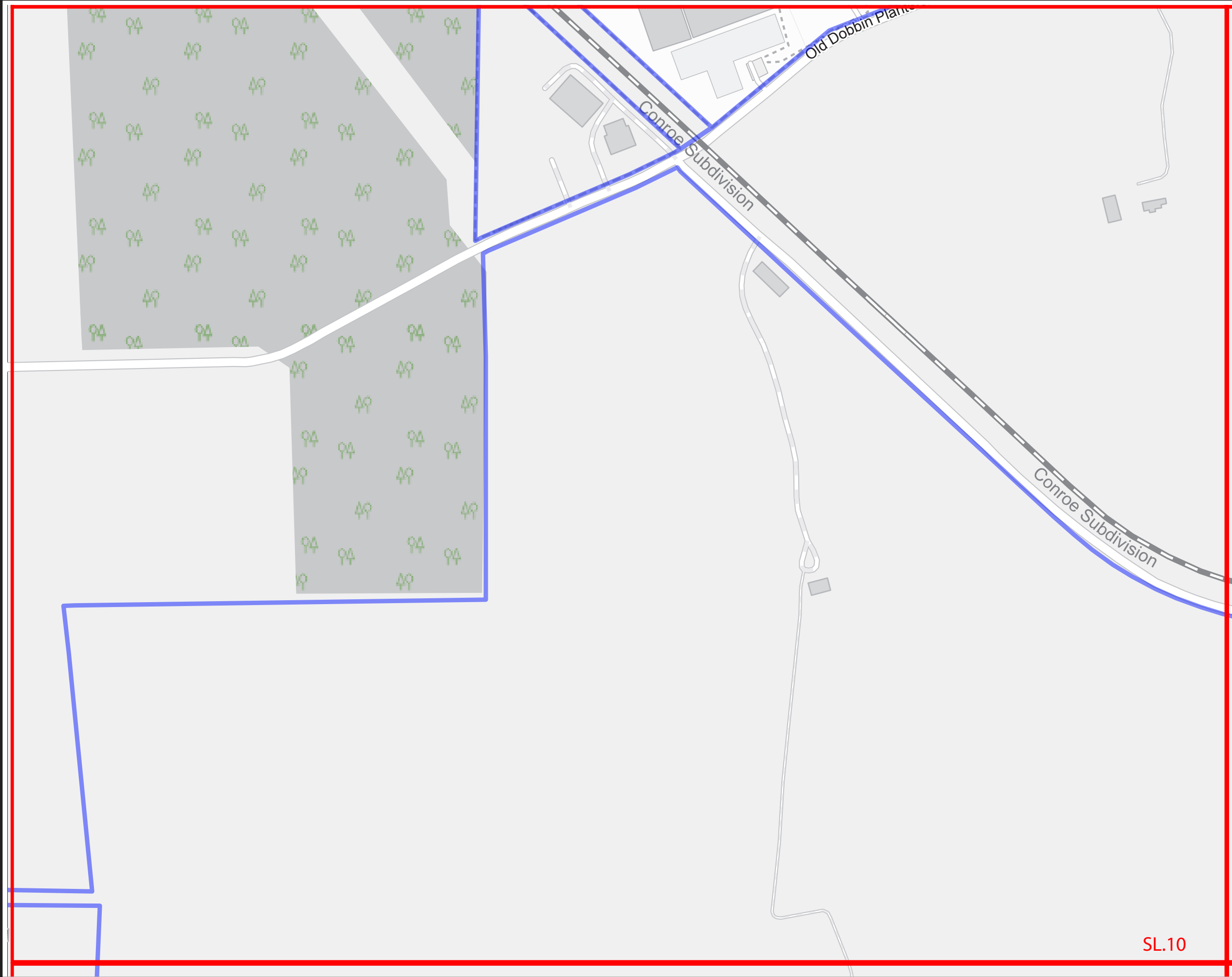

SPECIFICATIONS

Refer to the Wayfinding and Signage System design intent documentation for sign type drawings, material call-outs and installation methods.

Refer to the Wayfinding and Signage System message schedule for all sign type messages, location numbers, quantities, and specific location details.

| SIGNAGE LEGEND | |
|----------------|------------------------|
| 001 | Gateways / District ID |
| 100 | Vehicular |
| 500 | Parking |
| 600 | Pedestrian Directional |
| 700 | Pedestrian Kiosk |
| 900 | Parks - Trail Signage |
| 900 | Identification Signage |

- NOTES:**
1. General sign locations are provided on these plan sheets.
 2. The Message Schedule provides more detailed guidance of sign location in the Remarks column.
 3. Refer to the Message Schedule for the final messages of each sign.
 4. Utilize the above Legend to help determine sign types, and other details of location.

ENVIRONMENTS & EXPERIENCES

merJe

120 North Church Street
Suite 208
West Chester, PA 19380
T 484.266.0648
www.merjedesign.com

| | | |
|---|----------|---|
| DATE | 07/13/23 | CLIENT / PROJECT |
| DRAWN BY: | GS | |
| <p>These drawings are meant for DESIGN INTENT ONLY and are not for construction. Contractor shall verify and be responsible for all dimensions and conditions of the job. Contractor shall be familiar with the site and conditions it presents. This office must be notified of any variations from the dimensions and conditions shown on this drawing. Shop drawings and details must be submitted to this office for approval prior to proceeding with fabrication. All copy shall be proofread by client and legal requirements checked by legal department.</p> | | <p>Montgomery TX Wayfinding and Signage System</p> |
| REVISIONS | | PROJECT NO. |
| V2_09/13/23 | | SHEET TITLE |
| V3_08/16/24 | | |
| | | SHEET NO. |
| | | SL.10 |

SL.10

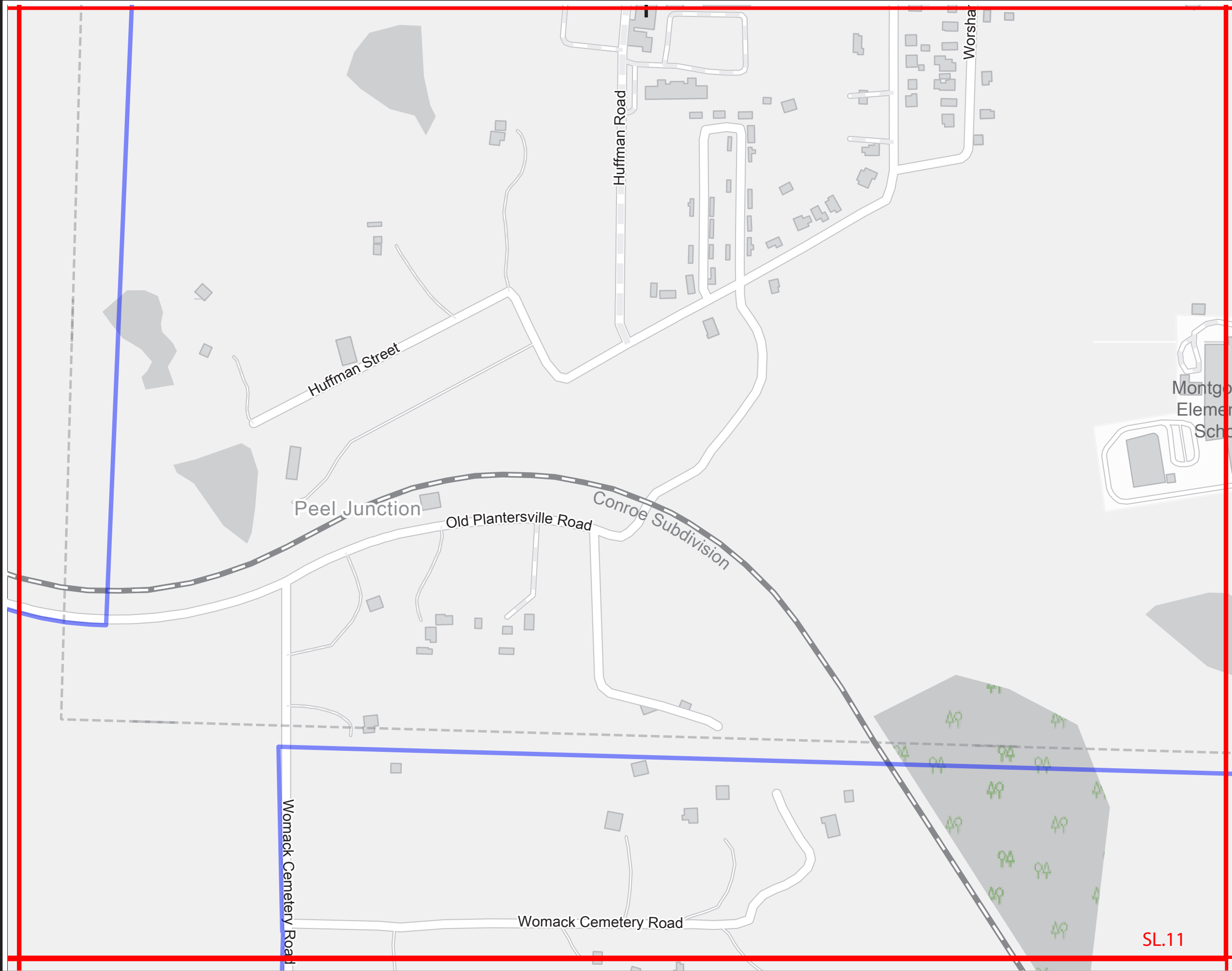

SPECIFICATIONS

Refer to the Wayfinding and Signage System design intent documentation for sign type drawings, material call-outs and installation methods.

Refer to the Wayfinding and Signage System message schedule for all sign type messages, location numbers, quantities, and specific location details.

| SIGNAGE LEGEND | |
|----------------|------------------------|
| 001 | Gateways / District ID |
| 100 | Vehicular |
| 500 | Parking |
| 600 | Pedestrian Directional |
| 700 | Pedestrian Kiosk |
| 900 | Parks - Trail Signage |
| 900 | Identification Signage |

- NOTES:**
1. General sign locations are provided on these plan sheets.
 2. The Message Schedule provides more detailed guidance of sign location in the Remarks column.
 3. Refer to the Message Schedule for the final messages of each sign.
 4. Utilize the above Legend to help determine sign types, and other details of location.

ENVIRONMENTS & EXPERIENCES

merJe

120 North Church Street
Suite 208
West Chester, PA 19380
T 484.266.0648
www.merjedesign.com

DATE 07/13/23

CLIENT / PROJECT

DRAWN BY: GS

Montgomery TX

These drawings are meant for DESIGN INTENT ONLY and are not for construction. Contractor shall verify and be responsible for all dimensions and conditions of the job. Contractor shall be familiar with the site and conditions it presents. This office must be notified of any variations from the dimensions and conditions shown on this drawing. Shop drawings and details must be submitted to this office for approval prior to proceeding with fabrication. All copy shall be proofread by client and legal requirements checked by legal department.

Wayfinding and Signage System

REVISIONS

PROJECT NO.

V2_09/13/23

SHEET TITLE

V3_08/16/24

Sign Location Plans

SHEET NO.

SL.11

SL.11

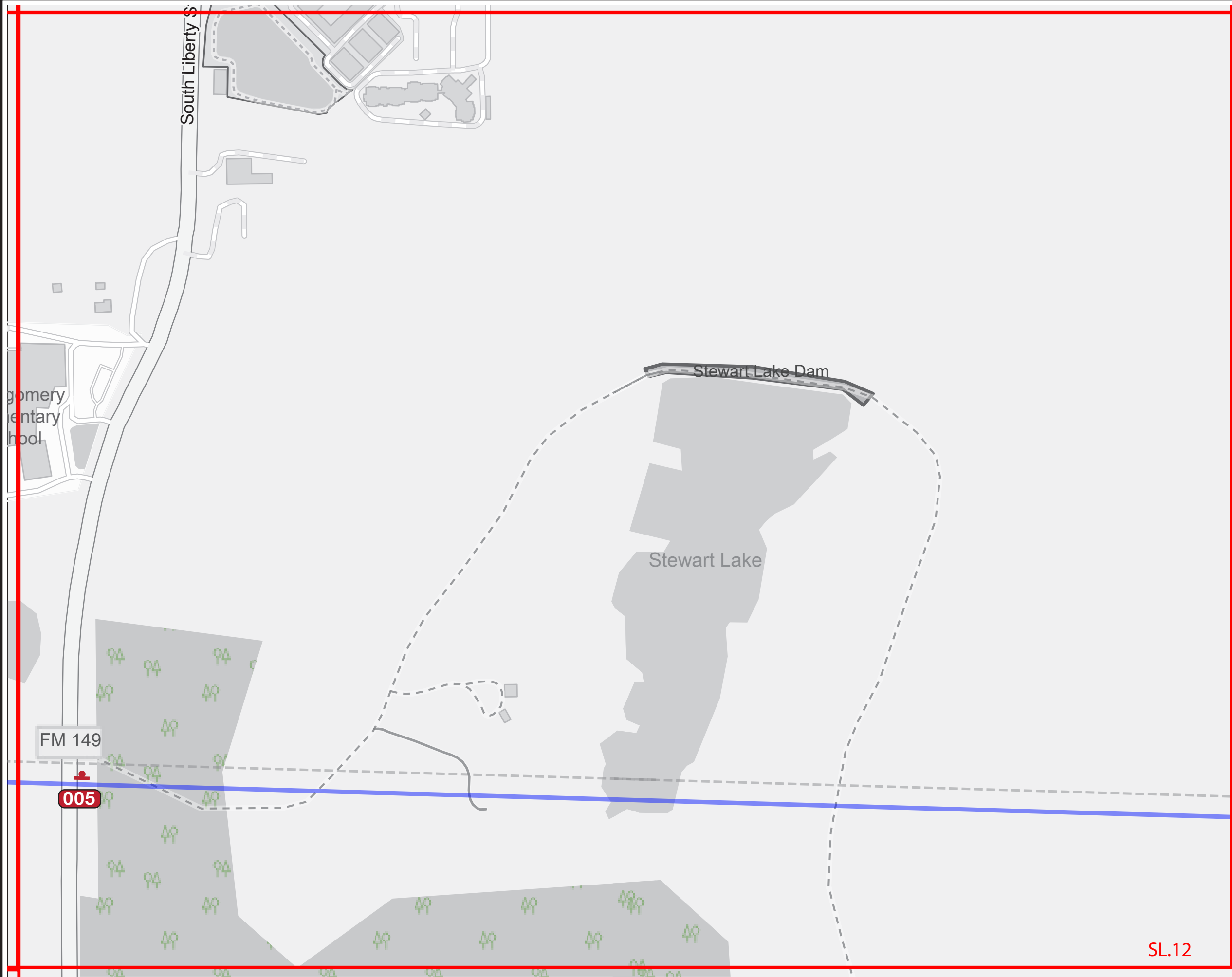

SPECIFICATIONS

Refer to the Wayfinding and Signage System design intent documentation for sign type drawings, material call-outs and installation methods.

Refer to the Wayfinding and Signage System message schedule for all sign type messages, location numbers, quantities, and specific location details.

| SIGNAGE LEGEND | |
|----------------|------------------------|
| 001 | Gateways / District ID |
| 100 | Vehicular |
| 500 | Parking |
| 600 | Pedestrian Directional |
| 700 | Pedestrian Kiosk |
| 900 | Parks - Trail Signage |
| 900 | Identification Signage |

- NOTES:**
1. General sign locations are provided on these plan sheets.
 2. The Message Schedule provides more detailed guidance of sign location in the Remarks column.
 3. Refer to the Message Schedule for the final messages of each sign.
 4. Utilize the above Legend to help determine sign types, and other details of location.

ENVIRONMENTS & EXPERIENCES



120 North Church Street
Suite 208
West Chester, PA 19380
T 484.266.0648
www.merjedesign.com

| | | |
|---|----------|---|
| DATE | 07/13/23 | CLIENT / PROJECT |
| DRAWN BY: | GS | |
| <p>These drawings are meant for DESIGN INTENT ONLY and are not for construction. Contractor shall verify and be responsible for all dimensions and conditions of the job. Contractor shall be familiar with the site and conditions it presents. This office must be notified of any variations from the dimensions and conditions shown on this drawing. Shop drawings and details must be submitted to this office for approval prior to proceeding with fabrication. All copy shall be proofread by client and legal requirements checked by legal department.</p> | | <p>Montgomery TX Wayfinding and Signage System</p> |
| REVISIONS | | PROJECT NO. |
| V2_09/13/23 | | SHEET TITLE |
| V3_08/16/24 | | |
| | | <p style="text-align: center;">Sign Location Plans</p> |
| | | SHEET NO. |
| | | SL.12 |

SL.12

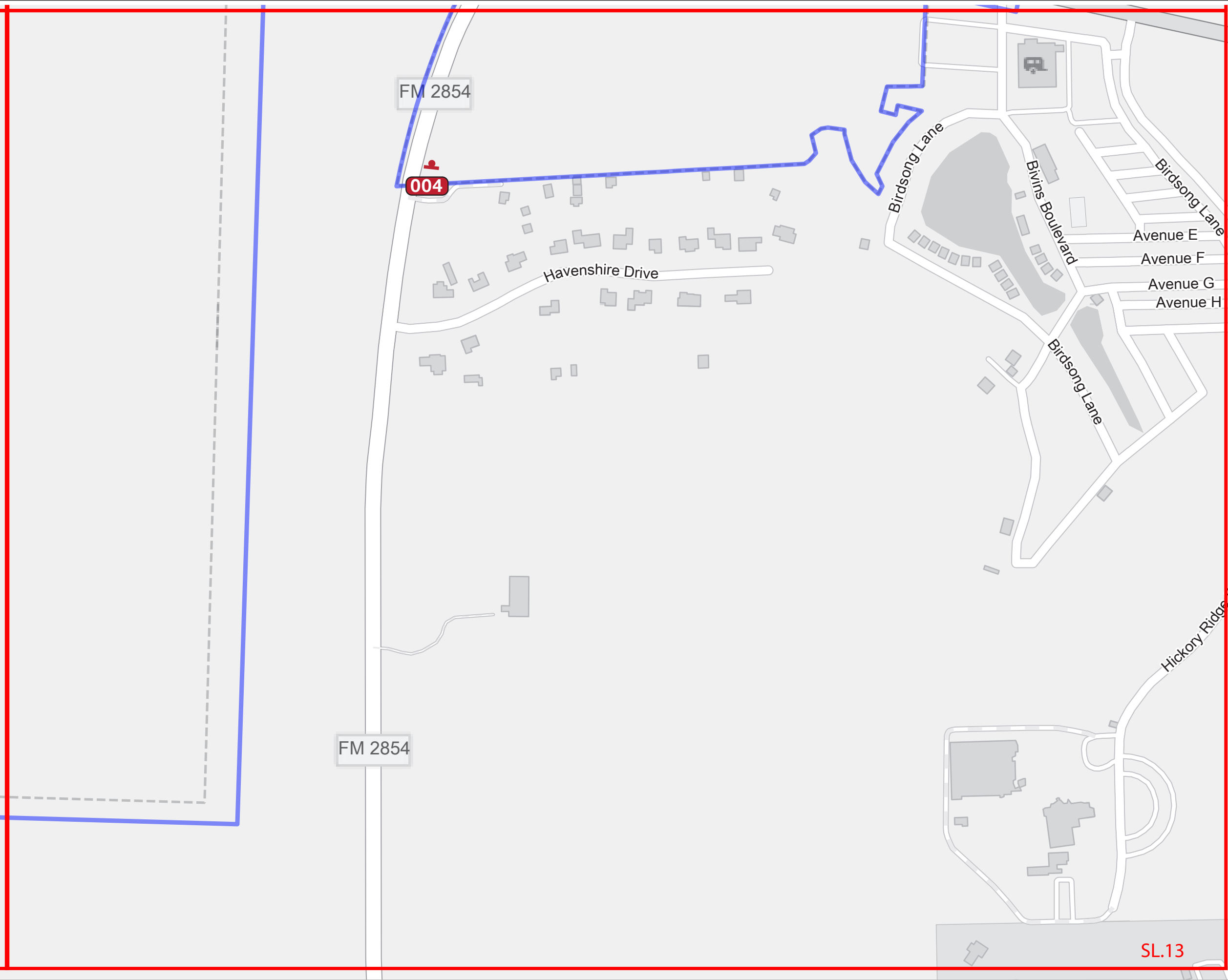

SPECIFICATIONS

Refer to the Wayfinding and Signage System design intent documentation for sign type drawings, material call-outs and installation methods.

Refer to the Wayfinding and Signage System message schedule for all sign type messages, location numbers, quantities, and specific location details.

| SIGNAGE LEGEND | |
|----------------|------------------------|
| 001 | Gateways / District ID |
| 100 | Vehicular |
| 500 | Parking |
| 600 | Pedestrian Directional |
| 700 | Pedestrian Kiosk |
| 900 | Parks - Trail Signage |
| 900 | Identification Signage |

- NOTES:**
1. General sign locations are provided on these plan sheets.
 2. The Message Schedule provides more detailed guidance of sign location in the Remarks column.
 3. Refer to the Message Schedule for the final messages of each sign.
 4. Utilize the above Legend to help determine sign types, and other details of location.

ENVIRONMENTS & EXPERIENCES

merJe

120 North Church Street
Suite 208
West Chester, PA 19380
T 484.266.0648
www.merjedesign.com

| | | |
|---|----------|---|
| DATE | 07/13/23 | CLIENT / PROJECT |
| DRAWN BY: | GS | |
| <p>These drawings are meant for DESIGN INTENT ONLY and are not for construction. Contractor shall verify and be responsible for all dimensions and conditions of the job. Contractor shall be familiar with the site and conditions it presents. This office must be notified of any variations from the dimensions and conditions shown on this drawing. Shop drawings and details must be submitted to this office for approval prior to proceeding with fabrication. All copy shall be proofread by client and legal requirements checked by legal department.</p> | | <p>Montgomery TX Wayfinding and Signage System</p> |
| REVISIONS | | PROJECT NO. |
| V2_09/13/23 | | SHEET TITLE |
| V3_08/16/24 | | |
| | | SHEET NO. |
| | | SL.13 |

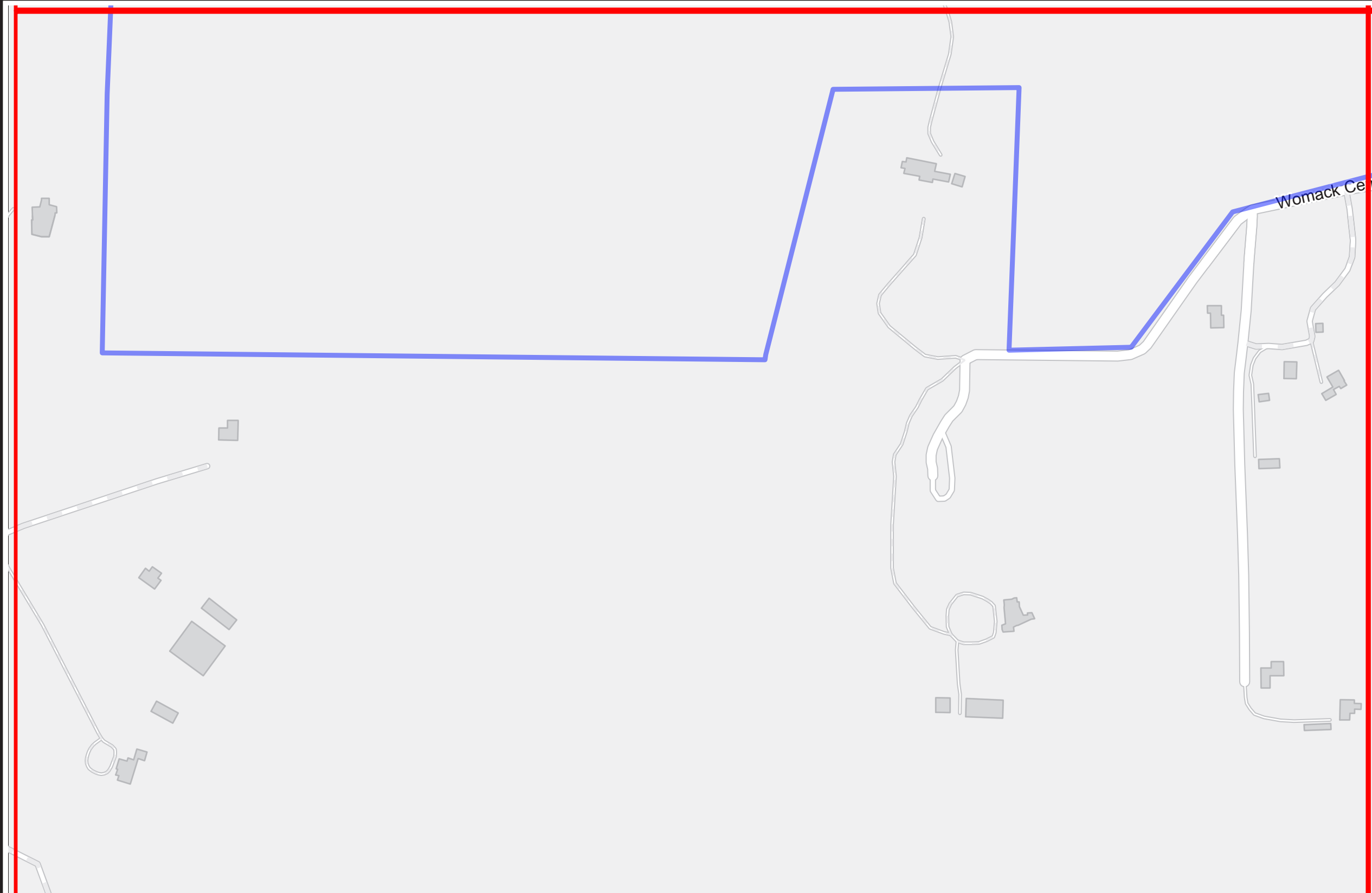

SPECIFICATIONS

Refer to the Wayfinding and Signage System design intent documentation for sign type drawings, material call-outs and installation methods.

Refer to the Wayfinding and Signage System message schedule for all sign type messages, location numbers, quantities, and specific location details.

| SIGNAGE LEGEND | |
|----------------|------------------------|
| 001 | Gateways / District ID |
| 100 | Vehicular |
| 500 | Parking |
| 600 | Pedestrian Directional |
| 700 | Pedestrian Kiosk |
| 900 | Parks - Trail Signage |
| 900 | Identification Signage |

- NOTES:**
1. General sign locations are provided on these plan sheets.
 2. The Message Schedule provides more detailed guidance of sign location in the Remarks column.
 3. Refer to the Message Schedule for the final messages of each sign.
 4. Utilize the above Legend to help determine sign types, and other details of location.

ENVIRONMENTS & EXPERIENCES

merJe

120 North Church Street
Suite 208
West Chester, PA 19380
T 484.266.0648
www.merjedesign.com

DATE 07/13/23

CLIENT / PROJECT

DRAWN BY: GS

Montgomery TX

These drawings are meant for DESIGN INTENT ONLY and are not for construction. Contractor shall verify and be responsible for all dimensions and conditions of the job. Contractor shall be familiar with the site and conditions it presents. This office must be notified of any variations from the dimensions and conditions shown on this drawing. Shop drawings and details must be submitted to this office for approval prior to proceeding with fabrication. All copy shall be proofread by client and legal requirements checked by legal department.

Wayfinding and Signage System

REVISIONS

PROJECT NO.

V2_09/13/23

SHEET TITLE

V3_08/16/24

Sign Location Plans

SHEET NO.

SL.14

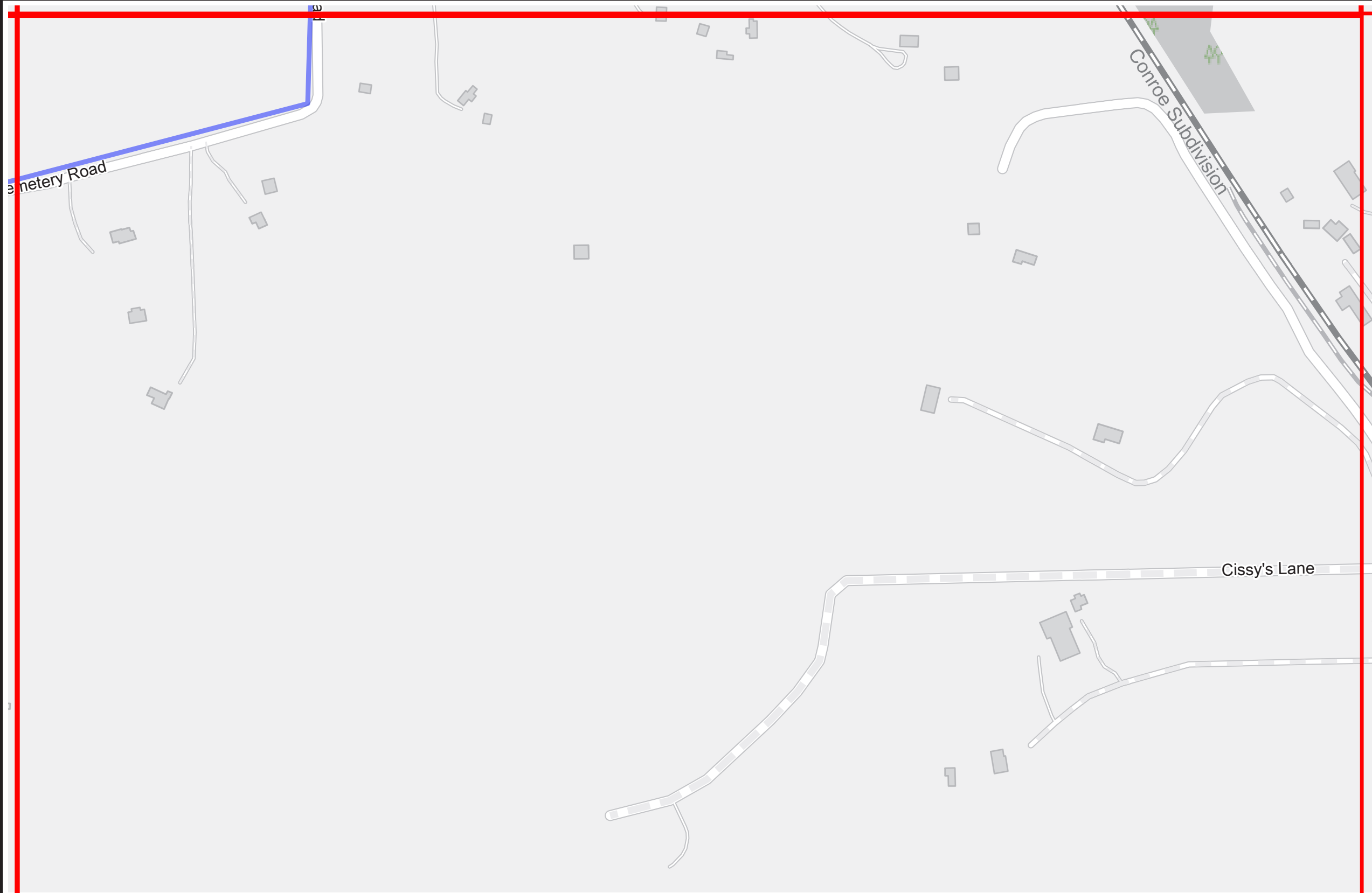

SPECIFICATIONS

Refer to the Wayfinding and Signage System design intent documentation for sign type drawings, material call-outs and installation methods.

Refer to the Wayfinding and Signage System message schedule for all sign type messages, location numbers, quantities, and specific location details.

| SIGNAGE LEGEND | |
|----------------|------------------------|
| 001 | Gateways / District ID |
| 100 | Vehicular |
| 500 | Parking |
| 600 | Pedestrian Directional |
| 700 | Pedestrian Kiosk |
| 900 | Parks - Trail Signage |
| 900 | Identification Signage |

- NOTES:**
1. General sign locations are provided on these plan sheets.
 2. The Message Schedule provides more detailed guidance of sign location in the Remarks column.
 3. Refer to the Message Schedule for the final messages of each sign.
 4. Utilize the above Legend to help determine sign types, and other details of location.

ENVIRONMENTS & EXPERIENCES

merJe

120 North Church Street
Suite 208
West Chester, PA 19380
T 484.266.0648
www.merjedesign.com

| | | |
|---|----------|---|
| DATE | 07/13/23 | CLIENT / PROJECT |
| DRAWN BY: | GS | |
| <p>These drawings are meant for DESIGN INTENT ONLY and are not for construction. Contractor shall verify and be responsible for all dimensions and conditions of the job. Contractor shall be familiar with the site and conditions it presents. This office must be notified of any variations from the dimensions and conditions shown on this drawing. Shop drawings and details must be submitted to this office for approval prior to proceeding with fabrication. All copy shall be proofread by client and legal requirements checked by legal department.</p> | | <p>Montgomery TX Wayfinding and Signage System</p> |
| REVISIONS | | PROJECT NO. |
| V2_09/13/23 | | SHEET TITLE |
| V3_08/16/24 | | |
| | | SHEET NO. |
| | | SL.15 |

SECTION 2 | Location Photos



PHASE: 1
 LOCATION NO. 001
 SIGN TYPE: GATE.2
 PLAN SHEET: SL.04

COMMENTS:
 Client to review and confirm graphic layout and location prior to fabrication.



PHASE: 1
 LOCATION NO. 002
 SIGN TYPE: GATE.2
 PLAN SHEET: SL.01

COMMENTS:
 Client to review and confirm graphic layout and location prior to fabrication.



PHASE: 1
 LOCATION NO. 003
 SIGN TYPE: GATE.1
 PLAN SHEET: SL.09

COMMENTS:
 Replace Existing Green/White Sign.
 Client to review and confirm graphic layout and location prior to fabrication.



PHASE: 1
 LOCATION NO. 004
 SIGN TYPE: GATE.2
 PLAN SHEET: SL.13

COMMENTS:
 Remove/Replace Green TXDOT Sign. Move No Engine Brake Sign to Separate Location/Pole.
 Client to review and confirm graphic layout and location prior to fabrication.



PHASE: 1
 LOCATION NO. 005
 SIGN TYPE: GATE.2
 PLAN SHEET: SL.12

COMMENTS:
 Remove/Replace Green TXDOT Sign Move Historical Marker to Post or Separate Location/Pole. Move No Engine Brake Sign to Separate Location/Pole.
 Client to review and confirm graphic layout and location prior to fabrication.



PHASE: 1
 LOCATION NO. 006
 SIGN TYPE: GATE.2
 PLAN SHEET: SL.06

COMMENTS:
 Remove/Replace Green TXDOT Sign. Move Historical Marker to Post or Separate Location/Pole. Move No Engine Brake Sign to Separate Location/Pole. Alternate GATE.1
 Client to review and confirm graphic layout and location prior to fabrication.



PHASE: 1
 LOCATION NO. 006 Alt.
 SIGN TYPE: GATE.2
 PLAN SHEET:

COMMENTS:
 Client to review and confirm graphic layout and location prior to fabrication.



PHASE: 1
 LOCATION NO. 007
 SIGN TYPE: GATE.2
 PLAN SHEET: SL.03

COMMENTS:
 Remove/Replace Green TXDOT Sign. Move No Engine Brake Sign to Separate Location/Pole.
 Client to review and confirm graphic layout and location prior to fabrication.

| REVISIONS | | |
|-----------|----|-------------|
| DATE | BY | DESCRIPTION |
| | | |

ENVIRONMENTS & EXPERIENCES

merJe

5 W. Gay Street
 West Chester, PA 19380
 T 484.266.0648
www.merjedesign.com

SHEET TITLE

Photo Details

CLIENT / PROJECT

Montgomery, TX
 Wayfinding & Signage Program

DATE: August 16, 2024

DRAWN BY: MP

SHEET NO. **LP.1**



PHASE:
LOCATION NO.
SIGN TYPE:
PLAN SHEET:

COMMENTS:

PHASE:
LOCATION NO.
SIGN TYPE:
PLAN SHEET:

COMMENTS:

PHASE:
LOCATION NO.
SIGN TYPE:
PLAN SHEET:

COMMENTS:

PHASE: 1
LOCATION NO. 100
SIGN TYPE: VDIR.6.TXDOT
PLAN SHEET: SL.09

COMMENTS:
Client to review and confirm graphic layout and location prior to fabrication.



PHASE: 1
LOCATION NO. 101
SIGN TYPE: VDIR.6.TXDOT
PLAN SHEET: SL.08

COMMENTS:
Client to review and confirm graphic layout and location prior to fabrication.

PHASE: 1
LOCATION NO. 102
SIGN TYPE: VDIR.6.TXDOT
PLAN SHEET: SL.08

COMMENTS:
Client to review and confirm graphic layout and location prior to fabrication.

PHASE: 1
LOCATION NO. 103
SIGN TYPE: VDIR.6.TXDOT
PLAN SHEET: SL.09

COMMENTS:
Client to review and confirm graphic layout and location prior to fabrication.

PHASE: 1
LOCATION NO. 104
SIGN TYPE: VDIR.3
PLAN SHEET: SL.08

COMMENTS:
Remove/Replace Green TXDOT Sign. Move No Engine Brake Sign to Separate Location/Pole.
Client to review and confirm graphic layout and location prior to fabrication.

| REVISIONS | | |
|-----------|----|-------------|
| DATE | BY | DESCRIPTION |
| | | |

ENVIRONMENTS & EXPERIENCES

merJe

5 W. Gay Street
West Chester, PA 19380
T 484.266.0648
www.merjedesign.com

SHEET TITLE

Photo Details

CLIENT / PROJECT

Montgomery, TX
Wayfinding & Signage Program

DATE: August 16, 2024
DRAWN BY: MP
SHEET NO.

LP.2



PHASE: 1
 LOCATION NO. 105
 SIGN TYPE: VDIR.3
 PLAN SHEET: SL.08

COMMENTS:
 Client to review and confirm graphic layout and location prior to fabrication.



PHASE: 1
 LOCATION NO. 106
 SIGN TYPE: VDIR.3
 PLAN SHEET: SL.08

COMMENTS:
 Client to review and confirm graphic layout and location prior to fabrication.



PHASE: 1
 LOCATION NO. 107
 SIGN TYPE: VDIR.3
 PLAN SHEET: SL.04

COMMENTS:



PHASE: 1
 LOCATION NO. 108
 SIGN TYPE: VDIR.3
 PLAN SHEET: SL.04

COMMENTS:
 Client to review and confirm graphic layout and location prior to fabrication.



PHASE: 1
 LOCATION NO. 109
 SIGN TYPE: VDIR.6
 PLAN SHEET: SL.01

COMMENTS:
 Client to review and confirm graphic layout and location prior to fabrication.



PHASE: 1
 LOCATION NO. 110
 SIGN TYPE: VDIR.3
 PLAN SHEET: SL.04

COMMENTS:
 Client to review and confirm graphic layout and location prior to fabrication.



PHASE: 1
 LOCATION NO. 111
 SIGN TYPE: VDIR.3
 PLAN SHEET: SL.04

COMMENTS:
 Client to review and confirm graphic layout and location prior to fabrication.



PHASE: 1
 LOCATION NO. 112
 SIGN TYPE: VDIR.3
 PLAN SHEET: SL.04

COMMENTS:
 Client to review and confirm graphic layout and location prior to fabrication.

| REVISIONS | | |
|-----------|----|-------------|
| DATE | BY | DESCRIPTION |
| | | |

ENVIRONMENTS & EXPERIENCES

merJe

5 W. Gay Street
 West Chester, PA 19380
 T 484.266.0648
www.merjedesign.com

SHEET TITLE

Photo Details

CLIENT / PROJECT

Montgomery, TX
 Wayfinding & Signage Program

DATE: August 16, 2024
 DRAWN BY: MP
 SHEET NO.

LP.3



PHASE: 1
 LOCATION NO. 113
 SIGN TYPE: VDIR.2
 PLAN SHEET: SL.03

COMMENTS:
 Client to review and confirm graphic layout and location prior to fabrication.



PHASE: 1
 LOCATION NO. 114
 SIGN TYPE: VDIR.2
 PLAN SHEET: SL.03

COMMENTS:
 Client to review and confirm graphic layout and location prior to fabrication.



PHASE: 1
 LOCATION NO. 115
 SIGN TYPE: VDIR.3
 PLAN SHEET: SL.03

COMMENTS:
 Client to review and confirm graphic layout and location prior to fabrication.



PHASE: 1
 LOCATION NO. 116
 SIGN TYPE: VDIR.3
 PLAN SHEET: SL.03

COMMENTS:
 Client to review and confirm graphic layout and location prior to fabrication.



PHASE: 1
 LOCATION NO. 117
 SIGN TYPE: VDIR.3
 PLAN SHEET: SL.03

COMMENTS:
 Client to review and confirm graphic layout and location prior to fabrication.



PHASE: 1
 LOCATION NO. 118
 SIGN TYPE: VDIR.3
 PLAN SHEET: SL.03

COMMENTS:
 Client to review and confirm graphic layout and location prior to fabrication.



PHASE: 1
 LOCATION NO. 119
 SIGN TYPE: VDIR.3
 PLAN SHEET: SL.08

COMMENTS:
 Client to review and confirm graphic layout and location prior to fabrication.



PHASE: 1
 LOCATION NO. 120
 SIGN TYPE: VDIR.3
 PLAN SHEET: SL.08

COMMENTS:
 Client to review and confirm graphic layout and location prior to fabrication.

| REVISIONS | | |
|-----------|----|-------------|
| DATE | BY | DESCRIPTION |
| | | |

ENVIRONMENTS & EXPERIENCES

merJe

5 W. Gay Street
 West Chester, PA 19380
 T 484.266.0648
www.merjedesign.com

SHEET TITLE

Photo Details

CLIENT / PROJECT

Montgomery, TX
 Wayfinding & Signage Program

DATE: August 16, 2024

DRAWN BY: MP

SHEET NO. **LP.4**



PHASE: 1
 LOCATION NO. 121
 SIGN TYPE: VDIR.3
 PLAN SHEET: SL.08

COMMENTS:
 Client to review and confirm graphic layout and location prior to fabrication.



PHASE: 1
 LOCATION NO. 122
 SIGN TYPE: VDIR.3
 PLAN SHEET: SL.08

COMMENTS:
 Client to review and confirm graphic layout and location prior to fabrication.



PHASE: 1
 LOCATION NO. 123
 SIGN TYPE: RES.1
 PLAN SHEET: SL.08

COMMENTS:
 Client to review and confirm graphic layout and location prior to fabrication.



PHASE: 1
 LOCATION NO. 124
 SIGN TYPE: RES.1
 PLAN SHEET: SL.08

COMMENTS:
 Client to review and confirm graphic layout and location prior to fabrication.



PHASE: 1
 LOCATION NO. 125
 SIGN TYPE: VDIR.3.TXDOT
 PLAN SHEET: SL.08

COMMENTS:
 Replace Existing Texas Forest Trail Sign
 Client to review and confirm graphic layout and location prior to fabrication.



PHASE: 1
 LOCATION NO. 126
 SIGN TYPE: VDIR.3.TXDOT
 PLAN SHEET: SL.08

COMMENTS:
 Replace Existing Texas Forest Trail Sign
 Client to review and confirm graphic layout and location prior to fabrication.



PHASE: 1
 LOCATION NO. 127
 SIGN TYPE: VDIR.3
 PLAN SHEET: SL.08

COMMENTS:
 Client to review and confirm graphic layout and location prior to fabrication.



PHASE: 1
 LOCATION NO. 128
 SIGN TYPE: VDIR.3
 PLAN SHEET: SL.08

COMMENTS:
 Client to review and confirm graphic layout and location prior to fabrication.

| REVISIONS | | |
|-----------|----|-------------|
| DATE | BY | DESCRIPTION |
| | | |

ENVIRONMENTS & EXPERIENCES

merJe

5 W. Gay Street
 West Chester, PA 19380
 T 484.266.0648
www.merjedesign.com

SHEET TITLE

Photo Details

CLIENT / PROJECT

Montgomery, TX
 Wayfinding & Signage Program

DATE: August 16, 2024
 DRAWN BY: MP
 SHEET NO.

LP.5



PHASE: 1
 LOCATION NO. 129
 SIGN TYPE: VDIR.6.TXDOT
 PLAN SHEET: SL.07

COMMENTS:
 Client to review and confirm graphic layout and location prior to fabrication.



PHASE: 1
 LOCATION NO. 130
 SIGN TYPE: VDIR.6.TXDOT
 PLAN SHEET: SL.07

COMMENTS:
 Client to review and confirm graphic layout and location prior to fabrication.
 Client to review and confirm graphic layout and location prior to fabrication.



PHASE: 1
 LOCATION NO. 131
 SIGN TYPE: VDIR.1
 PLAN SHEET: SL.03

COMMENTS:
 Client to review and confirm graphic layout and location prior to fabrication.



PHASE: 1
 LOCATION NO. 132
 SIGN TYPE: VDIR.1
 PLAN SHEET: SL.03

COMMENTS:
 Client to review and confirm graphic layout and location prior to fabrication.



PHASE: 1
 LOCATION NO. 133
 SIGN TYPE: VDIR.2
 PLAN SHEET: SL.06

COMMENTS:
 Client to review and confirm graphic layout and location prior to fabrication.



PHASE: 1
 LOCATION NO. 135
 SIGN TYPE: VDIR.6.TXDOT
 PLAN SHEET: SL.06

COMMENTS:
 Client to review and confirm graphic layout and location prior to fabrication.



PHASE: 1
 LOCATION NO. 136
 SIGN TYPE: VDIR.6
 PLAN SHEET: SL.09

COMMENTS:
 Client to review and confirm graphic layout and location prior to fabrication.



PHASE: 1
 LOCATION NO. 137
 SIGN TYPE: VDIR.6
 PLAN SHEET: SL.09

COMMENTS:
 Client to review and confirm graphic layout and location prior to fabrication.

| REVISIONS | | |
|-----------|----|-------------|
| DATE | BY | DESCRIPTION |
| | | |

ENVIRONMENTS & EXPERIENCES

merJe

5 W. Gay Street
 West Chester, PA 19380
 T 484.266.0648
www.merjedesign.com

SHEET TITLE

Photo Details

CLIENT / PROJECT

Montgomery, TX
 Wayfinding & Signage Program

DATE: August 16, 2024

DRAWN BY: MP

SHEET NO. **LP.6**



PHASE: 1
 LOCATION NO. 138
 SIGN TYPE: RES.1
 PLAN SHEET: SL.08

COMMENTS:
 Client to review and confirm graphic layout and location prior to fabrication.



PHASE: 1
 LOCATION NO. 139
 SIGN TYPE: VDIR.3
 PLAN SHEET: SL.08

COMMENTS:
 Client to review and confirm graphic layout and location prior to fabrication.



PHASE: 1
 LOCATION NO. 140
 SIGN TYPE: VDIR.5.TXDOT
 PLAN SHEET: SL.09

COMMENTS:
 Client to review and confirm graphic layout and location prior to fabrication.



PHASE: 1
 LOCATION NO. 141
 SIGN TYPE: VDIR.5.TXDOT
 PLAN SHEET: SL.09

COMMENTS:
 Client to review and confirm graphic layout and location prior to fabrication.



PHASE: 1
 LOCATION NO. 142
 SIGN TYPE: VDIR.5.TXDOT
 PLAN SHEET: SL.06

COMMENTS:
 Client to review and confirm graphic layout and location prior to fabrication.



PHASE: 1
 LOCATION NO. 143
 SIGN TYPE: RES.1
 PLAN SHEET: SL.03

COMMENTS:
 Client to review and confirm graphic layout and location prior to fabrication.



PHASE: 1
 LOCATION NO. 144
 SIGN TYPE: VDIR.2.TXDOT
 PLAN SHEET: SL.08

COMMENTS:
 Client to review and confirm graphic layout and location prior to fabrication.



PHASE: 1
 LOCATION NO. 500
 SIGN TYPE: PARK.2
 PLAN SHEET: SL.08

COMMENTS:
 Client to review and confirm graphic layout and location prior to fabrication.

| REVISIONS | | |
|-----------|----|-------------|
| DATE | BY | DESCRIPTION |
| | | |

ENVIRONMENTS & EXPERIENCES

merJe

5 W. Gay Street
 West Chester, PA 19380
 T 484.266.0648
www.merjedesign.com

SHEET TITLE

Photo Details

CLIENT / PROJECT

Montgomery, TX
 Wayfinding & Signage Program

DATE: August 16, 2024
 DRAWN BY: MP
 SHEET NO.

LP.7



PHASE: 1
 LOCATION NO. 501
 SIGN TYPE: PARK.2
 PLAN SHEET: SL.08

COMMENTS:
 Client to review and confirm graphic layout and location prior to fabrication.



PHASE: 1
 LOCATION NO. 502
 SIGN TYPE: PARK.2
 PLAN SHEET: SL.08

COMMENTS:
 Client to review and confirm graphic layout and location prior to fabrication.



PHASE: 1
 LOCATION NO. 503
 SIGN TYPE: PARK.2
 PLAN SHEET: SL.08

COMMENTS:
 Client to review and confirm graphic layout and location prior to fabrication.



PHASE: 1
 LOCATION NO. 504
 SIGN TYPE: PARK.2
 PLAN SHEET: SL.08

COMMENTS:
 Client to review and confirm graphic layout and location prior to fabrication.



PHASE: 1
 LOCATION NO. 700
 SIGN TYPE: KIOSK.1
 PLAN SHEET: SL.08

COMMENTS:
 Client to review and confirm graphic layout and location prior to fabrication.



PHASE: 1
 LOCATION NO. 701
 SIGN TYPE: KIOSK.1
 PLAN SHEET: SL.08

COMMENTS:
 Client to review and confirm graphic layout and location prior to fabrication.



PHASE: 2
 LOCATION NO. 702
 SIGN TYPE: KIOSK.2
 PLAN SHEET: SL.08

COMMENTS:
 Client to review and confirm graphic layout and location prior to fabrication.



PHASE: 2
 LOCATION NO. 703
 SIGN TYPE: KIOSK.3
 PLAN SHEET: SL.07

COMMENTS:
 Client to review and confirm graphic layout and location prior to fabrication.

| REVISIONS | | |
|-----------|----|-------------|
| DATE | BY | DESCRIPTION |
| | | |

ENVIRONMENTS & EXPERIENCES

merJe

5 W. Gay Street
 West Chester, PA 19380
 T 484.266.0648
www.merjedesign.com

SHEET TITLE

Photo Details

CLIENT / PROJECT

Montgomery, TX
 Wayfinding & Signage Program

DATE: August 16, 2024
 DRAWN BY: MP
 SHEET NO.

LP.8



PHASE: 1
 LOCATION NO. 704
 SIGN TYPE: KIOSK.1
 PLAN SHEET: SL.08

COMMENTS:
 Client to review and confirm graphic layout and location prior to fabrication.



PHASE: 1
 LOCATION NO. 705
 SIGN TYPE: KIOSK.1
 PLAN SHEET: SL.04

COMMENTS:
 Client to review and confirm graphic layout and location prior to fabrication.



PHASE: 1
 LOCATION NO. 900
 SIGN TYPE: PARK_ID.2
 PLAN SHEET: SL.07

COMMENTS:
 Client to review and confirm graphic layout and location prior to fabrication.



PHASE: 1
 LOCATION NO. 901
 SIGN TYPE: PARK_ID.1
 PLAN SHEET: SL.07

COMMENTS:
 Client to review and confirm graphic layout and location prior to fabrication.



PHASE: 1
 LOCATION NO. 902
 SIGN TYPE: PARK_ID.1
 PLAN SHEET: SL.07

COMMENTS:
 Client to review and confirm graphic layout and location prior to fabrication.



PHASE: 1
 LOCATION NO. 903
 SIGN TYPE: PARK_ID.2
 PLAN SHEET: SL.08

COMMENTS:
 Client to review and confirm graphic layout and location prior to fabrication.



PHASE: 1
 LOCATION NO. 904
 SIGN TYPE: PARK_ID.1
 PLAN SHEET: SL.08

COMMENTS:
 Client to review and confirm graphic layout and location prior to fabrication.



PHASE: 1
 LOCATION NO. 905
 SIGN TYPE: PARK_ID.1
 PLAN SHEET: SL.08

COMMENTS:
 Client to review and confirm graphic layout and location prior to fabrication.

| REVISIONS | | |
|-----------|----|-------------|
| DATE | BY | DESCRIPTION |
| | | |

ENVIRONMENTS & EXPERIENCES

merJe

5 W. Gay Street
 West Chester, PA 19380
 T 484.266.0648
www.merjedesign.com

SHEET TITLE

Photo Details

CLIENT / PROJECT

Montgomery, TX
 Wayfinding & Signage Program

DATE: August 16, 2024
 DRAWN BY: MP
 SHEET NO.

LP.9



PHASE: 1
 LOCATION NO. 906
 SIGN TYPE: PARK_ID.2
 PLAN SHEET: SL.04

COMMENTS:
 Client to review and confirm graphic layout and location prior to fabrication.

PHASE: 1
 LOCATION NO. 907
 SIGN TYPE: PARK_ID.1
 PLAN SHEET: SL.03

COMMENTS:
 Client to review and confirm graphic layout and location prior to fabrication.

PHASE: 1
 LOCATION NO. 908
 SIGN TYPE: PARK_ID.1
 PLAN SHEET: SL.08

COMMENTS:
 Client to review and confirm graphic layout and location prior to fabrication.

PHASE:
 LOCATION NO.
 SIGN TYPE:
 PLAN SHEET:

COMMENTS:



PHASE:
 LOCATION NO.
 SIGN TYPE:
 PLAN SHEET:

COMMENTS:

PHASE:
 LOCATION NO.
 SIGN TYPE:
 PLAN SHEET:

COMMENTS:

PHASE:
 LOCATION NO.
 SIGN TYPE:
 PLAN SHEET:

COMMENTS:

PHASE:
 LOCATION NO.
 SIGN TYPE:
 PLAN SHEET:

COMMENTS:

| REVISIONS | | |
|-----------|----|-------------|
| DATE | BY | DESCRIPTION |
| | | |

ENVIRONMENTS & EXPERIENCES

merJe

5 W. Gay Street
 West Chester, PA 19380
 T 484.266.0648
www.merjedesign.com

SHEET TITLE

Photo Details

CLIENT / PROJECT

Montgomery, TX
 Wayfinding & Signage Program

DATE: August 16, 2024
 DRAWN BY: MP
 SHEET NO.

LP.10