

LEGAL NOTICE MAP

SCOBAR / RIOS
MENTARY SCHOOL

THOMPSON RD.

14 13 12 11 10
1 2 3 4 5 6

GILBERTO GUT

29-4

5 4 3 2 1
LAS CUMBRES

MOUNTAIN RD.

TROSPER RD.

1 OJEDA
2 SUBD.

43

1 2 3 4

6 7 8 9 10 11 12
11 10 9 8 7 6 5 4 3 2 1
TROSPER FAIR HTS.
RAMIREZ ST.

**SITE
LOCATION**

GODINA

44

W. 2 MILE RD.

SPEEDY TRAI

100 99 98 97 96 95 94

101

W. SANDSTOI

200' RADIUS MAILOUT



CITY OF MISSION
HIDALGO COUNTY, TEXAS

1201 E. 8th Street
MISSION, TX 78572

PH: (956) 580-8672
FAX: (956) 580-8680

No.

ZONING MAP

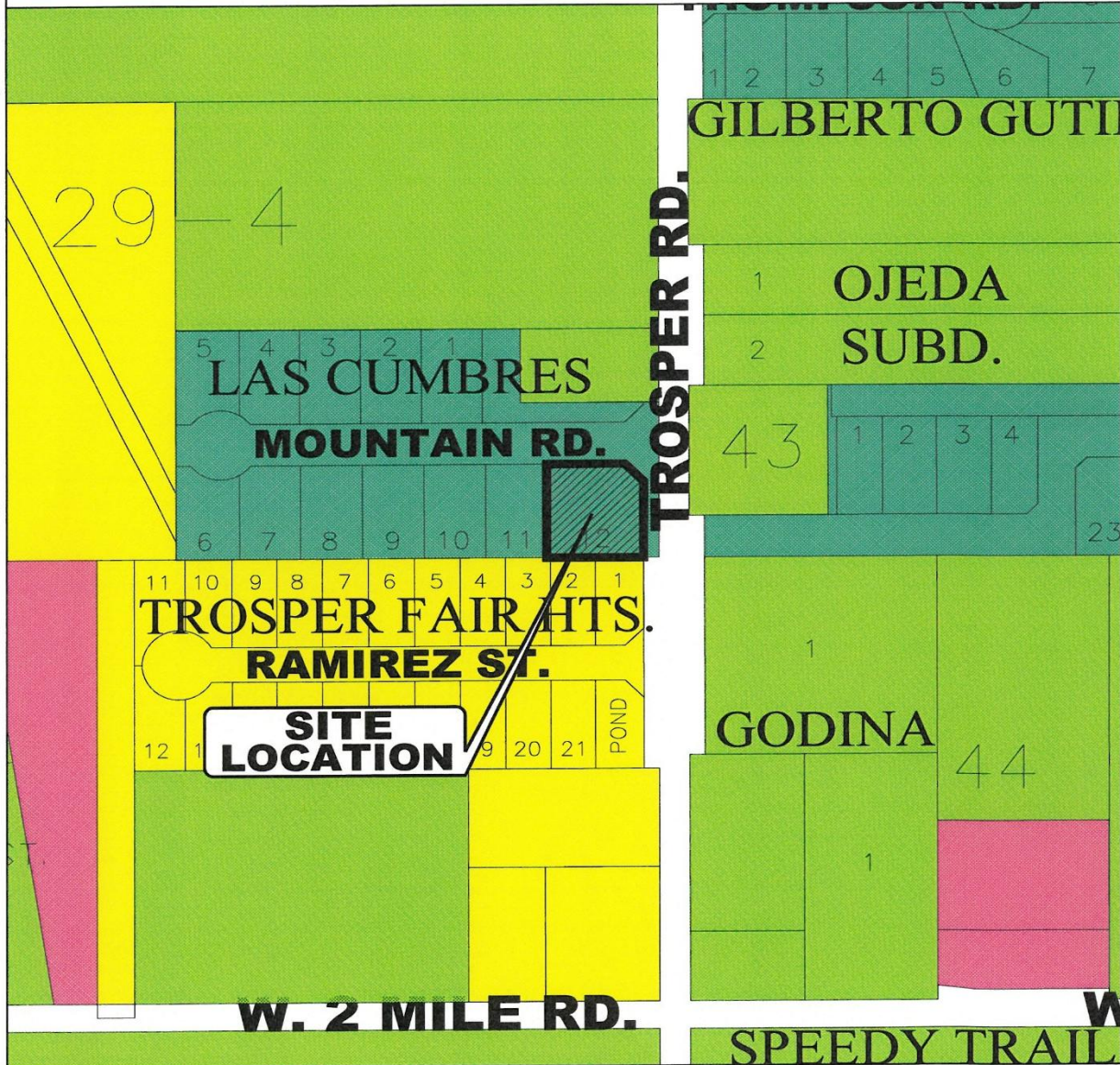

ZONING LEGEND

■ A0-I AGRICULTURAL OPEN INTERIM	■ R-3 MULTI-FAMILY RESIDENTIAL	■ C-4 HEAVY COMMERCIAL
■ AO-P AGRICULTURAL OPEN PERMANENT	■ R-4 MOBILE & MODULAR HOME	■ C-5 ADAPTIVE COMMERCIAL
■ R-1A LARGE LOT SINGLE FAMILY	■ R-5 HIGH DENSITY MFCT'D HOUSING	■ I-1 LIGHT INDUSTRIAL
■ R-1T TOWNHOUSE RESIDENTIAL	■ C-1 OFFICE BUILDING	■ I-2 HEAVY INDUSTRIAL
■ R-1 SINGLE FAMILY RESIDENTIAL	■ C-2 NEIGHBORHOOD COMMERCIAL	■ PUD PLANNED UNIT DEVELOPMENT
■ R-2 DUPLEX-FOURPLEX RESIDENTIAL	■ C-3 GENERAL BUSINESS	■ P PUBLIC

AERIAL



**LOCATION
SITE**

MOUNTAIN RD.

N. TROSPER RD.

LOT 12 FROM THE RECORDED PLAT

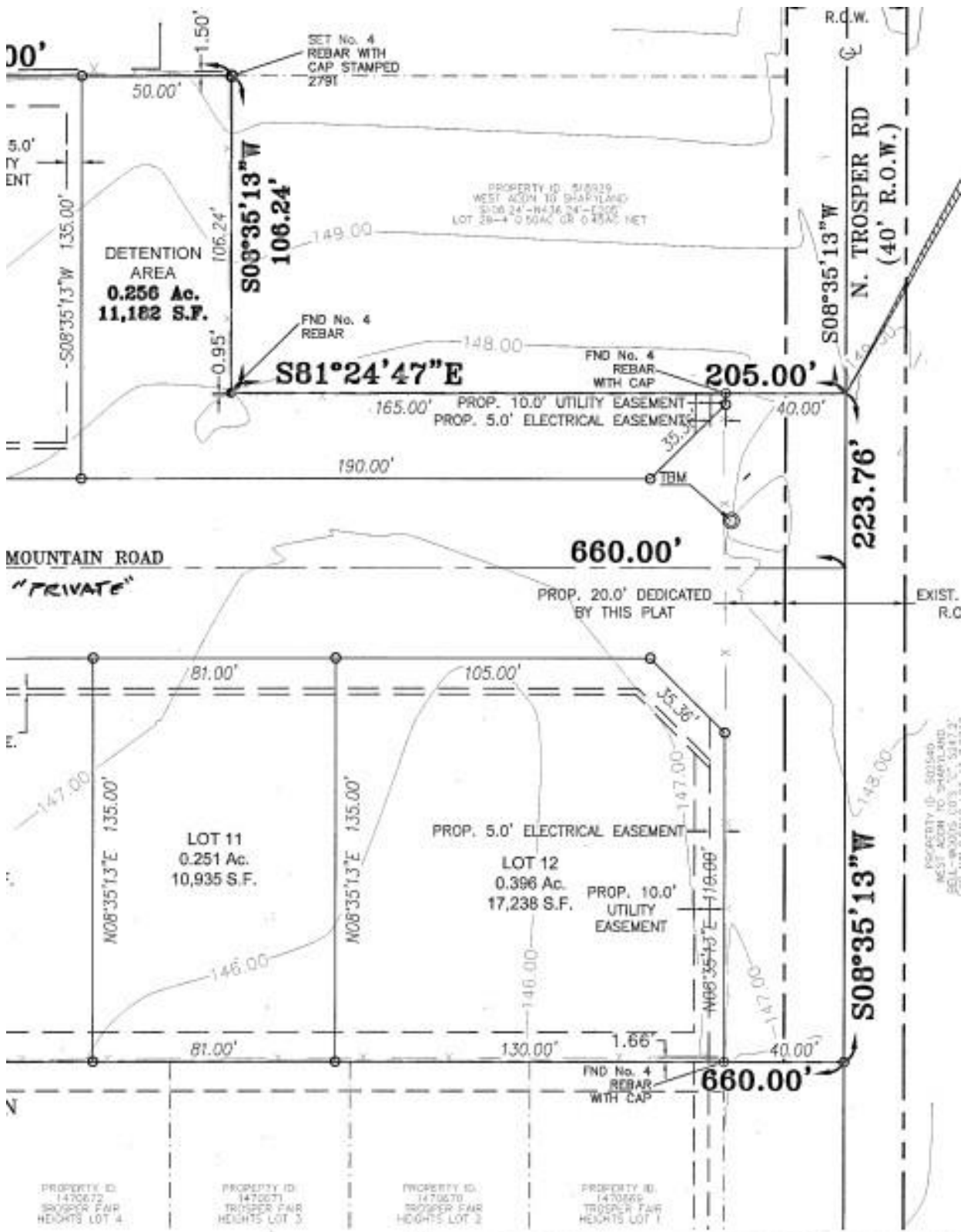

PHOTO OF THE PROPERTY FROM N. TROSPER ROAD



PHOTO OF THE PROPERTY FROM MOUNTAIN ROAD









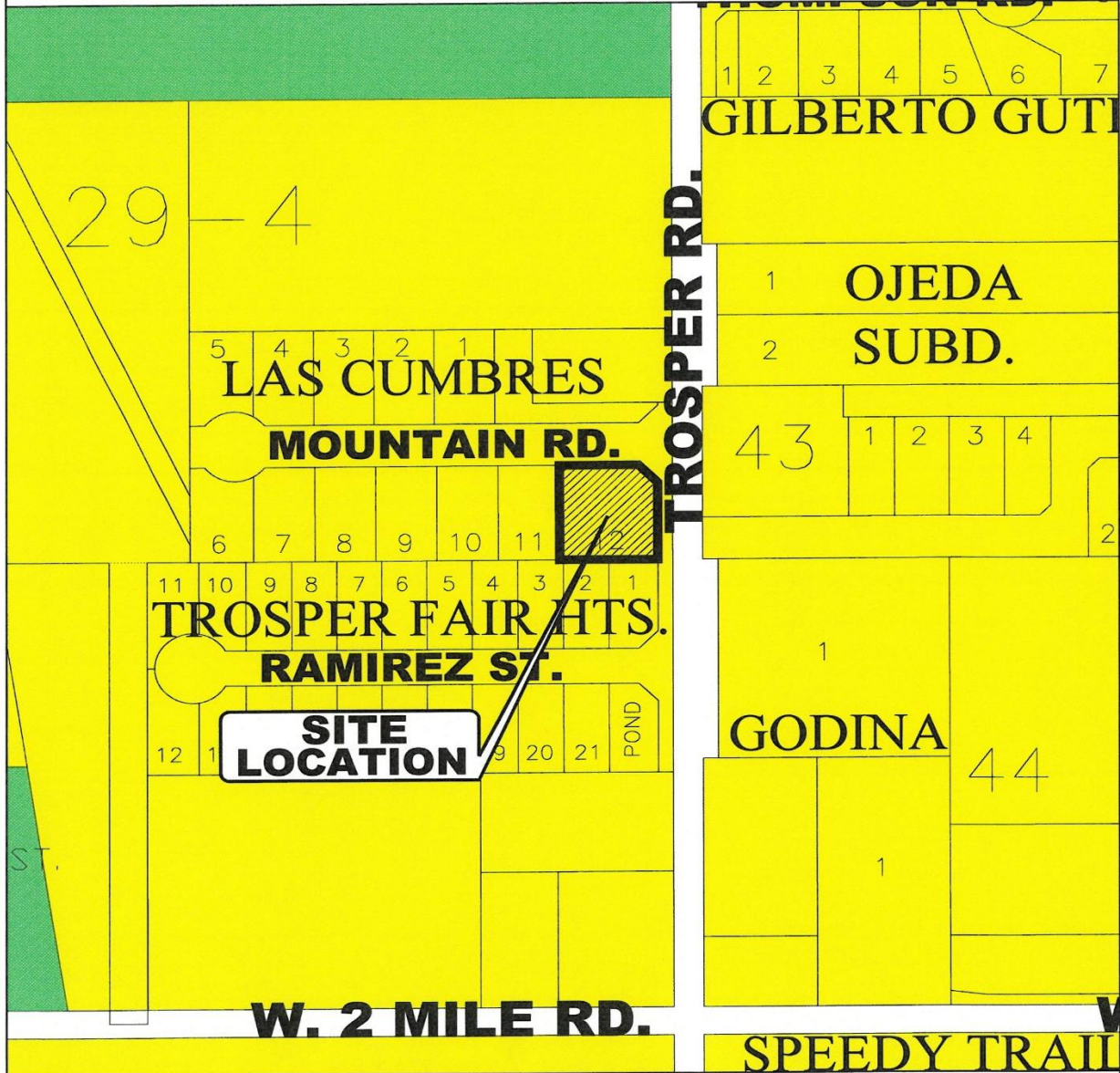



PHOTO OF THE SUBDIVISION'S ENTRANCE GATE



FUTURE LAND USE MAP



FUTURE LAND USE MAP

- | | |
|--|--|
|  - LD - Low Density Res. |  - GC - General Commercial |
|  - LDA - Lower Density Res. |  - HC - Heavy Commercial |
|  - MD - Moderate Density Res. |  - I - Industrial |
|  - HD - High Density Res. |  - P - Public |
|  - Neighborhood Commercial |  - PUD - Planned Unit Development |

MAILOUT LIST

PROP_ID	name	addrDelive	addrCity	addrState	addrZip
674224	NINO RAMIRO & SANDRA A	3300 N TROSPER RD	MISSION	TX	78573-1495
513180	TOBIAS FERNANDO GABRIEL & LAURA DIANA	513 RAMIREZ LN	MISSION	TX	78573-8708
317249	GOMEZ LUIS MARCOS	3421 N TROSPER RD	MISSION	TX	78573-1381
518929	SANCHEZ PEDRO PADRON	3413 N TROSPER RD	MISSION	TX	78573
317251	REDLINE DEVELOPMENT LLC	1618 E GRIFFIN PKWY	MISSION	TX	78572-3180
123528	SANCHEZ EDUARDO & MARIA G	3406 N TROSPER RD	MISSION	TX	78573-1381
1470687	BELANI CONSTRUCTION LLC	2712 CHESTERFIELD AVE	EDINBURG	TX	78539
1470688	BELANI CONSTRUCTION LLC	2712 CHESTERFIELD AVE	EDINBURG	TX	78539
1470689	BORA CONSTRUCTION LLC	2210 WAGNER LN	MISSION	TX	78572-1983
1470668	HORIZON SKY DEVELOPMENT LLC	1712 E GRIFFIN PKWY	MISSION	TX	78572-3104
1470669	BELANI CONSTRUCTION LLC	2712 CHESTERFIELD AVE	EDINBURG	TX	78539
1470670	BELANI CONSTRUCTION LLC	2712 CHESTERFIELD AVE	EDINBURG	TX	78539
1470671	EXCLUSIVE PLATINUM HOME BUILDERS LLC	1611 STONEGATE DR	MISSION	TX	78574-2764
1470672	BARRERA BRITTANY JANID	4205 WALNUT AVE	MCALLEN	TX	78501
1470673	GARCIA LUIS ALONSO JR & GIOVANNA CRISTELL SOLIS	808 RAMIREZ LN	MISSION	TX	78573
1470674	EXCLUSIVE PLATINUM HOME BUILDERS LLC	1611 STONEGATE DR	MISSION	TX	78574-2764
502540	SANCHEZ EDUARDO & MARIA G	3406 N TROSPER RD	MISSION	TX	78573-1381
351749	REDLINE DEVELOPMENT LLC	1618 E GRIFFIN PKWY	MISSION	TX	78572-3180
351737	MEZA HOMES INC	1618 E GRIFFIN PKWY	MISSION	TX	78572-3180
351738	MEZA HOMES INC	1618 E GRIFFIN PKWY	MISSION	TX	78572-3180
351750	REDLINE DEVELOPMENT LLC	1618 E GRIFFIN PKWY	MISSION	TX	78572-3180
351745	GUZMAN CONSTRUCTION LLC	2003 S DANA DR	PHARR	TX	78577
351746	GUZMAN CONSTRUCTION LLC	2003 S DANA DR	PHARR	TX	78577
351747	GUZMAN CONSTRUCTION LLC	2003 S DANA DR	PHARR	TX	78577
351748	M2 EXPRESS LLC	1810 E GRIFFIN PKWY	MISSION	TX	78572