

**CONSTRUCTION CONTRACT CHANGE ORDER NUMBER: 01**

1. CONTRACTOR: Texas Cordia Construction, LLC
2. Change Order Work Limits: Sta. 106+93 to Sta. 106+93
3. Type of Change (on federal-aid non-exempt projects): Minor (Major/Minor)
4. Describe the change and the reason for the change order. When necessary, include exceptions to this agreement.

While excavating to remove/replace existing pipe from irrigation crossing at STA 106+93, Contractor encountered a concrete casing around the irrigation pipe. The plans does not reflect actual existing conditions, therefore this item was not accounted on the proposed work. This change order will compensate contractor for the removal of concrete slab around the irrigation pipe and increase contract days due to activity identified as a critical path activity.

CCSJ:	<u>0921-02-327</u>
Project:	<u>Taylor Rd Phase 1</u>
Highway:	<u>Taylor Rd</u>
County:	<u>Hidalgo</u>
District:	<u>21- Pharr</u>
Contract Number:	<u>22-472-09-12</u>

5. New or revised plan sheet(s) are attached and numbered: N/A

Each signatory hereby warrants that each has the authority to execute this Change Order.

<p>By signing this change order, the contractor agrees to waive any and all claims for additional compensation due to any and all other expenses; additional charges for time, overhead and profit; or loss of compensation as a result of this change. Further, the contractor agrees that this agreement is made in accordance with Item 4 and the Contract. Exceptions should be noted in the response for #5 above.</p>	<p>The following information must be provided</p> <p>Time Ext. #: <u>1</u> Days added on this C.O.: <u>2</u></p> <p>Amt. added by this change order: <u>\$5,835.21</u></p>
	<p>For TxDOT use only:</p> <p>Days participating: _____</p> <p>Amount participating: _____</p> <p>Signature _____ Date _____</p> <p>Name/Title _____</p>
<p>THE CONTRACTOR</p> <p>By <u>[Signature]</u> Date <u>5/12/23</u></p> <p>Typed/Printed Name <u>Yara M. Corbitt, PE, CEO</u></p> <p>Typed/Printed Title <u>Yara M. Corbitt, PE, CEO</u></p>	

**RECOMMENDED FOR EXECUTION:**

Juan Pablo Terrazas, PE 5/12/2023  
 Name/Title Assistant City Manager Date

Name/Title \_\_\_\_\_ Date \_\_\_\_\_  
 APPROVED  REQUEST APPROVAL

Name/Title \_\_\_\_\_ Date \_\_\_\_\_

Name/Title \_\_\_\_\_ Date \_\_\_\_\_  
 APPROVED  REQUEST APPROVAL

Name/Title \_\_\_\_\_ Date \_\_\_\_\_

Name/Title \_\_\_\_\_ Date \_\_\_\_\_  
 APPROVED  REQUEST APPROVAL

Name/Title \_\_\_\_\_ Date \_\_\_\_\_

Name/Title \_\_\_\_\_ Date \_\_\_\_\_  
 APPROVED

Engineer's Seal:



Change Order #1

**Taylor Road Project – City of Mission**

TO: Texas Cordia Construction, LLC  
3149-A Center Pointe Drive  
Edinburg, TX, 78539

From Owner: City of Mission

And: SAM-CS

Project: Taylor Road

Contract: 22-472-09-12

CSJ: 0921-02-327

Limits: From I-5 (US 83) To BUS 83

Change Order #1 – in the amount of **\$5,835.21** has been reviewed and approved by City of Mission to make the following contract changes.

**Purpose:**

Change Order #1 introduces UNIQUE CHANGE ORDER ITEM 1 – Removal of Irrigation concrete slab not the contract and adjust contract days due to additional work required.

City of Mission has reviewed Change Order #1 and approves the changes provided herein.

**Description:**

While excavating to remove/replace existing pipe from irrigation crossing at STA 106+93, Contractor encountered a concrete casing around the irrigation pipe. The plans does not reflect actual existing conditions, therefore this item was not accounted on the proposed work. This change order will compensate contractor for the removal of concrete slab around the irrigation pipe and increase contract days due to activity identified as a critical path activity.

The City of Mission reviewed proposal submitted by the contractor and found prices to be fair and reasonable for the amount of work to be performed. This item is crucial for the completion of Taylor Road project since it directly impacts Critical Path activities on the project as reflected under Contract Schedule.

This Change Order is within the scope of the original environmental assessments and reviews.

**ADDITIONAL TIME: 2 DAYS**

Modified Sheet No. included: N/A

CHANGE IN CONTRACT PRICE:	CHANGE IN CONTRACT TIME:
Original Contract Price <u>\$6,212,300.31</u>	Original Contract Time <u>215 Working Days</u>
Previous Change Orders <u>\$0.00</u>	Previous Change Orders <u>0 Working Days</u>

Contract Price prior to this Change Order <u>\$6,212,300.31</u>	Contract Time prior to this Change Order <u>215 Working Days</u>
Net increase/decrease of the Change Order <u>\$5,835.21</u>	Net increase/decrease of the Change Order <u>2 Working Days</u>
Contract Price with all approved Change Orders <u>\$6,218,135.52</u>	Contract Time with all approved Change Orders <u>217 Working Days</u>



CHANGE ORDER SUBMITTAL

**PROJECT** Taylor Raod Improvements  
**COUNTY:** Hidalgo  
**C.O. NO:** 001  
**TCC NO:** 1119

**CSJ:** 0921-02-327  
**HWY:** Taylor Road  
**DATED:** 04/26/23  
**QUANTITY:** 1.00 LS

CHANGE ORDER DESCRIPTION

Removal for the concrete slab on irrigation crossing

CHANGE ORDER TOTALS

<b>LABOR</b>	\$	880.00	+	25% compensation	\$	220.00	
			+	55% premium	\$	484.00	
				<b>TOTAL LABOR</b>	\$		1,584.00
<b>EQUIPMENT</b>	\$	2,413.86	+	15% compensation	\$	362.08	
				<b>TOTAL EQUIPMENT</b>	\$		2,775.94
<b>MATERIAL</b>	\$	-	+	25% compensation	\$	-	
				<b>TOTAL MATERIAL</b>	\$		-
<b>SUBCONTRACT</b>	\$	1,350.00	+	5% administrative	\$	67.50	
				<b>TOTAL SUBCONTRACT</b>	\$		1,417.50
<b>BOND</b>				1% of sub total	\$		57.77
<b>TOTAL</b>					\$		5,835.21
				<b>UNIT PRICE</b>		5,835.21	/LS
				<b>TOTAL PAYMENT</b>	\$		5,835.21

I hereby certify that the above is a true and correct statement of the amounts payable to **Texas Cordia Construction, LLC**, which are just charges as contingency expenditures incurred on this project.

*Michael Luna*

Authorized Signer

4/26/2023

Date

THE PRICES QUOTED FOR THE REFERENCED PROJECT ARE VALID FOR A PERIOD OF THIRTY (30) DAYS.

CONTROL NO: 22-472-09-12  
 PROJECT NAME: Taylor Raod Improvements  
 TCC NO: 1119  
 C.O. NO: 001  
 DATE: 04/26/23



CHANGE ORDER DESCRIPTION

Removal for the concrete slab on irrigation crossing

Labor	Pieces	HR	Rate	Base Total	Taxes/insur 55%	Markup 25%	Total Cost
Common Labors	2	10	\$ 13.50	\$ 270.00	\$ 148.50	\$ 67.50	\$ 486.00
Excavtor operator	1	10	\$ 19.00	\$ 190.00	\$ 104.50	\$ 47.50	\$ 342.00
Loader operator	1	10	\$ 15.00	\$ 150.00	\$ 82.50	\$ 37.50	\$ 270.00
Forman	1	6	\$ 45.00	\$ 270.00	\$ 148.50	\$ 67.50	\$ 486.00
	0	0	\$ -	\$ -	\$ -	\$ -	\$ -
				<b>\$ 880.00</b>	<b>\$ 484.00</b>	<b>\$ 220.00</b>	<b>\$ 1,584.00</b>

Equipment	Pieces	HR	Rate	Base Total	Markup 15%	Total Cost
238 Komatsu	1	10	\$ 135.46	\$ 1,354.60	\$ 203.19	\$ 1,557.79
938M Loader	1	10	\$ 80.00	\$ 800.00	\$ 120.00	\$ 920.00
Forman pick up	1	6	\$ 43.21	\$ 259.26	\$ 38.89	\$ 298.15
	0	0	\$ -	\$ -	\$ -	\$ -
	0	0	\$ -	\$ -	\$ -	\$ -
				<b>\$ 2,413.86</b>	<b>\$ 362.08</b>	<b>\$ 2,775.94</b>

Subcontractor	Unit	Quantity	Unit Price	Sub Cost	Markup 5%	Total Cost
Debris Removal	LDS	3	\$ 450.00	\$ 1,350.00	\$ 67.50	\$ 1,417.50
	EA	0	\$ -	\$ -	\$ -	\$ -
	EA	0	\$ -	\$ -	\$ -	\$ -
	EA	0	\$ -	\$ -	\$ -	\$ -
	EA	0	\$ -	\$ -	\$ -	\$ -
	EA	0	\$ -	\$ -	\$ -	\$ -
				<b>\$ 1,350.00</b>	<b>\$ 67.50</b>	<b>\$ 1,417.50</b>

Subtotal \$ 5,777.44  
 1% Bond Cost \$ 57.77  
**Total \$ 5,835.21**

**Rental Rate Blue Book®**

April 14, 2023

**Caterpillar 938M**  
 4-Wd Articulated Wheel Loaders

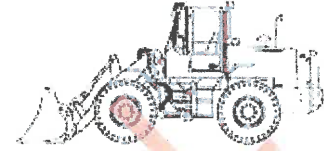
 Size Class:  
 175 - 199 hp  
 Weight:  
 N/A

**Configuration for 938M**

Operator Protection                      ROPS/FOPS                      Power Mode                      Diesel

**Blue Book Rates**

\*\* FHWA Rate is equal to the monthly ownership cost divided by 176 plus the hourly estimated operating cost.

	Ownership Costs				Estimated Operating Costs Hourly	FHWA Rate** Hourly
	Monthly	Weekly	Daily	Hourly		
Published Rates	USD \$8,540.00	USD \$2,390.00	USD \$600.00	USD \$90.00	USD \$31.48	USD \$80.00
<b>Adjustments</b>						
Region ( 100%)	-	-	-	-		
Model Year (2023: 100%)	-	-	-	-		
Adjusted Hourly Ownership Cost (100%)	-	-	-	-		
Hourly Operating Cost (100%)						
<b>Total:</b>	<b>USD \$8,540.00</b>	<b>USD \$2,390.00</b>	<b>USD \$600.00</b>	<b>USD \$90.00</b>	<b>USD \$31.48</b>	<b>USD \$80.00</b>

**Non-Active Use Rates**

	Hourly
Standby Rate	USD \$32.51
Idling Rate	USD \$61.80

**Rate Element Allocation**

Element	Percentage	Value
Depreciation (ownership)	39%	USD \$3,330.60/mo
Overhaul (ownership)	33%	USD \$2,818.20/mo
CFC (ownership)	16%	USD \$1,366.40/mo
Indirect (ownership)	12%	USD \$1,024.80/mo
Fuel (operating) @ USD 4.25	42%	USD \$13.28/hr

Revised Date: 2nd quarter 2023

These are the most accurate rates for the selected Revision Date(s). However, due to more frequent online updates, these rates may not match Rental Rate Blue Book Print. Visit the Cost Recovery Product Guide on our Help page for more information.

 The equipment represented in this report has been exclusively prepared for YARA CORBITT  
 (yara@texascordia.com)

**Rental Rate Blue Book®**

April 14, 2023

**Ford F-150 XLT 4x4 Gas**  
 Light Duty Trucks

 Size Class:  
 2  
 Weight:  
 N/A

**Configuration for F-150 XLT 4x4 Gas**

Power Mode	Gasoline	Wheelbase	122.8 Inches
Model Trim	XLT	Gross Vehicle Weight Rating	6050 Pounds

**Blue Book Rates**

\*\* FHWA Rate is equal to the monthly ownership cost divided by 176 plus the hourly estimated operating cost.

	Ownership Costs				Estimated Operating Costs Hourly	FHWA Rate** Hourly
	Monthly	Weekly	Daily	Hourly		
Published Rates	USD \$2,755.00	USD \$770.00	USD \$195.00	USD \$29.00	USD \$27.56	USD \$43.21
<b>Adjustments</b>						
Region ( 100%)	-	-	-	-		
Model Year (2023: 100%)	-	-	-	-		
Adjusted Hourly Ownership Cost (100%)	-	-	-	-		
Hourly Operating Cost (100%)						
<b>Total:</b>	<b>USD \$2,755.00</b>	<b>USD \$770.00</b>	<b>USD \$195.00</b>	<b>USD \$29.00</b>	<b>USD \$27.56</b>	<b>USD \$43.21</b>

**Non-Active Use Rates**

Standby Rate	Hourly	USD \$8.92
Idling Rate		USD \$34.17

**Rate Element Allocation**

Element	Percentage	Value
Depreciation (ownership)	25%	USD \$688.75/mo
Overhaul (ownership)	43%	USD \$1,184.65/mo
CFC (ownership)	15%	USD \$413.25/mo
Indirect (ownership)	17%	USD \$468.35/mo
Fuel (operating) @ USD 3.46	67%	USD \$18.52/hr

Revised Date: 2nd quarter 2023

These are the most accurate rates for the selected Revision Date(s). However, due to more frequent online updates, these rates may not match Rental Rate Blue Book Print. Visit the Cost Recovery Product Guide on our Help page for more information.

 The equipment represented in this report has been exclusively prepared for YARA CORBITT  
 (yara@texascordia.com)

**Rental Rate Blue Book®**

April 14, 2023

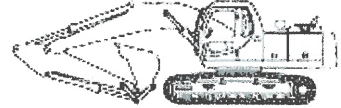
**Komatsu PC238USLC-11**  
 Crawler Mounted Hydraulic Excavators

 Size Class:  
 24.5 - 28.4 mt  
 Weight:  
 N/A

**Configuration for PC238USLC-11**

 Operating Weight **54230.0 lbs** Power Mode **Diesel**
**Blue Book Rates**

\*\* FHWA Rate is equal to the monthly ownership cost divided by 176 plus the hourly estimated operating cost.

	Ownership Costs				Estimated Operating Costs Hourly USD \$53.58	FHWA Rate** Hourly USD \$135.46
	Monthly	Weekly	Daily	Hourly		
Published Rates	USD \$14,410.00	USD \$4,035.00	USD \$1,010.00	USD \$150.00		
<b>Adjustments</b>						
Region ( 100%)	-	-	-	-		
Model Year (2023: 100%)	-	-	-	-		
Adjusted Hourly Ownership Cost (100%)	-	-	-	-		
Hourly Operating Cost (100%)					-	
<b>Total:</b>	<b>USD \$14,410.00</b>	<b>USD \$4,035.00</b>	<b>USD \$1,010.00</b>	<b>USD \$150.00</b>	<b>USD \$53.58</b>	<b>USD \$135.46</b>

**Non-Active Use Rates**

	Hourly
Standby Rate	USD \$46.67
Idling Rate	USD \$95.26

**Rate Element Allocation**

Element	Percentage	Value
Depreciation (ownership)	33%	USD \$4,755.30/mo
Overhaul (ownership)	43%	USD \$6,196.30/mo
CFC (ownership)	14%	USD \$2,017.40/mo
Indirect (ownership)	10%	USD \$1,441.00/mo
Fuel (operating) @ USD 4.25	25%	USD \$13.39/hr

Revised Date: 2nd quarter 2023

These are the most accurate rates for the selected Revision Date(s). However, due to more frequent online updates, these rates may not match Rental Rate Blue Book Print. Visit the Cost Recovery Product Guide on our Help page for more information.

 The equipment represented in this report has been exclusively prepared for YARA CORBITT  
 (yara@texascordia.com)

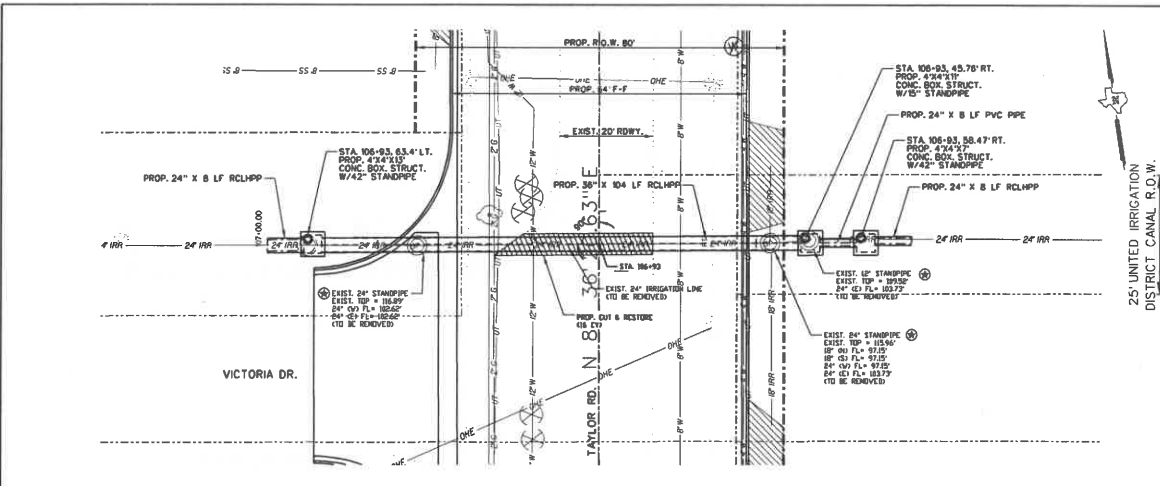

SHEET SUMMARY		
ITEM	DESCRIPTION	UNIT QUANTITY
400	STRUCTURAL EXCAVATION	SF 432
402	STRUCTURAL EXCAVATION (SPL)	CF 14
400	CONC. BOX STRUCT.	2'x 15'
402	CEMENT STABILIZED BACKFILL	CF 50
402	TRENCH PROTECTION	LF 104
406	REMOVE STRUCTURE (DPE)	LF 137
1007	CONC. BOX WELL (24")	EA 3
4024	RCLHPP (CL. 11) (24")	LF 136

- LEGEND:**
- Ⓜ NON-PAY, SUBSIDIARY TO PERTINENT BID ITEMS.
  - Ⓜ TO BE REMOVED UNDER ITEM 406 INCLUDES PAYMENT FOR REMOVAL OF ALL APPURTENANCES.
  - Ⓜ NON-PAY ITEM FOR CONTRACTORS INFORMATION ONLY.
  - Ⓜ THE CONTRACTOR SHALL CONFIRM THAT THE TOP ELEVATION ON THE PROPOSED STANDPIPE IS AT THE SAME ELEVATION AS THE EXISTING STANDPIPE.
  - Ⓜ ROCK FILTER DAM TYP 2
  - Ⓜ TOP OF STRUCTURE

- NOTES:**
1. THE CONTRACTOR WILL COORDINATE AND CONTACT UNITED IRRIGATION DISTRICT, THE CITY OF MISSION, THE CITY OF McALLEN AND L&G ENGINEERING 48 HOURS PRIOR TO ANY WORK DONE ON OR NEAR THE IRRIGATION STRUCTURES.
  2. PRIOR TO WORKING OUTSIDE THE ROW, THE CONTRACTOR SHALL NOTIFY PROPERTY OWNERS. CAUTION SHALL BE TAKEN NOT TO DAMAGE EXISTING FENCES, TREES, ETC. ANY DAMAGES DONE TO THEIR PROPERTY SHALL BE REPAIRED AT CONTRACTORS EXPENSE.
  3. THE CONTRACTOR SHALL CONFIRM THAT CONFLICTS WITH EXISTING UTILITIES HAVE BEEN RESOLVED IN ADVANCE OF CONSTRUCTION. DAMAGES CAUSED BY OR TO EXISTING UTILITIES ARE THE RESPONSIBILITY OF THE CONTRACTOR.
  4. ALL PVC ELBOWS AND CONNECTIONS SHALL BE SUBSIDIARY TO PERTINENT BID ITEMS.
  5. DURING CUT & RESTORE OPERATIONS, CONTRACTOR SHALL UTILIZE ADEQUATE TRAFFIC CONTROL MEASURES INCLUDING A FLAG PERSON.

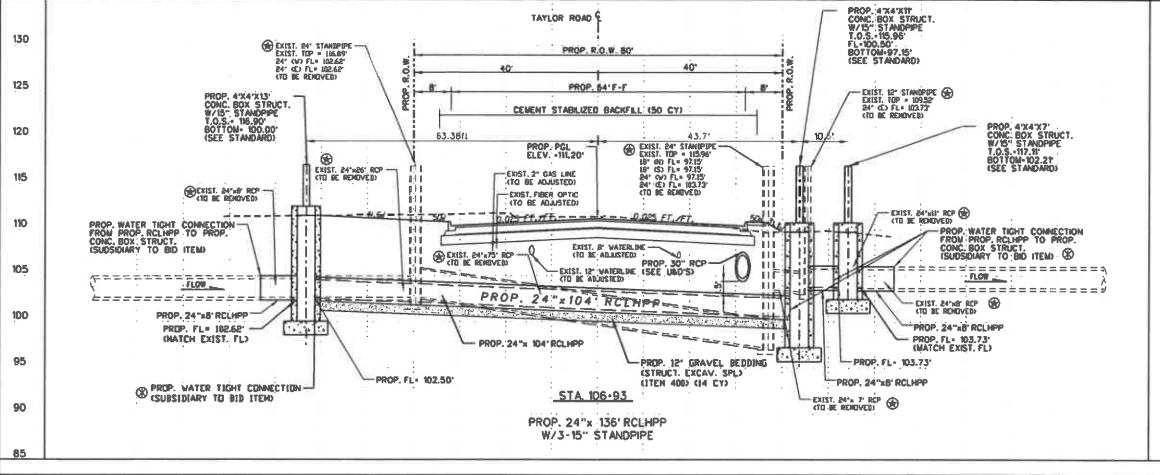

3/30/2022

**CITY OF MISSION**

**CITY OF McALLEN**

**L & G Engineering**  
Highway / Civil  
Structural / Bridge  
Environmental  
Firm No.: F-4105

**TAYLOR RD.  
IRRIGATION CROSSING LAYOUT  
(UNITED IRRIGATION DISTRICT)  
STA. 106-93**

SCALE:  
HOR: 1" = 20'  
VER: 1" = 10'

DATE: 3/30/2022

DESIGNER	DATE	REVISED	JOB
CHK'D BY	02	22	TAYLOR RD.
APP'D BY	PRF		COUNTY
			SHEET NO.
			162

SHEET 1 OF 1









Task — Summary — Progress — Contingency

Milestone • Critical

Project: Taylor Rd February & March Schedule  
 Date: 3/31/2022

NOTE: This schedule update has not been approved by City of Mission as of 5/10/2023.