

ITEM# 1.1

REZONING: A 0.33 acre tract of land out of the East 100' of the West 880' of the South 143' of Lot 29-8, West Addition to Sharyland Subdivision AO-I to C-3
Juan Reyes

REVIEW DATA

The subject site is located near Mayberry Road and E. Mile 2 Road intersection along the north side of E. Mile 2 Road. – see vicinity map.

SURROUNDING ZONES:

N:	R-1	- Single Family Residential
E:	AO-I	- Agricultural Open Interim
W:	R-1	- Single Family Residential
S:	P	- Public

EXISTING LAND USES:

N:	Single Family Residential
E:	Open Acreage
W:	Single Family Home
S:	Veterans Memorial High School
Site:	Vacant

FLUM: Low Density Residential (LD)

REVIEW COMMENTS: The proposed zone does not comply with the City's Future Land Use Map nor surrounding land uses. Approving a C-3 zone in this location would be detrimental to the surrounding single-family residential properties.

RECOMMENDATION: Staff recommends Denial.

0-7

29-9

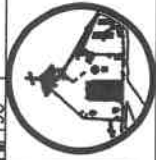
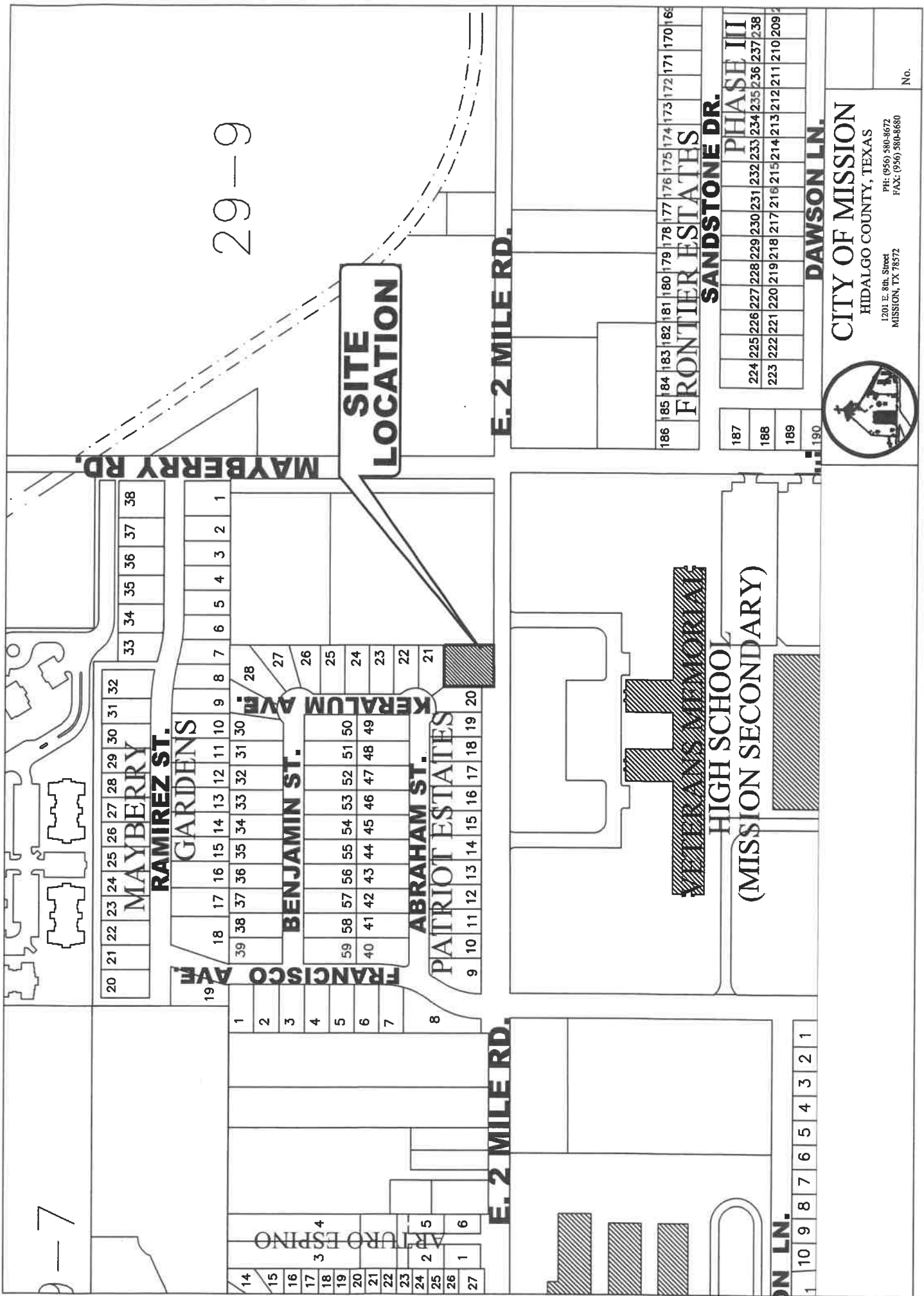

CITY OF MISSION
 HIDALGO COUNTY, TEXAS
 1201 E. 8th Street
 MISSION, TX 78572
 PH: (956) 580-8672
 FAX: (956) 380-8680

No.

**SITE
LOCATION**

E. MILE 2 ROAD



M5235-00-000-0001-00 (550720)
MISSION CONSOLIDATED ISD
1116 N CONWAY AVE
MISSION TX 78572

W0100-00-029-0008-06 (317276)
REYES JUAN RAMON
521 E MILE 2 ROAD
MISSION TX 78574

W0100-00-029-0008-10 (657721)
PENA ROSA MARIA
PO BOX 1771
DONNA TX 78537

P4654-00-000-0017-00 (693127)
RESENDEZ JEANETTE MARIE
606 ABRAHAM ST
MISSION TX 78573

P4654-00-000-0018-00 (693128)
SOLIS DAGOBERTO & MELISSA
DAGOBERTO SOLIS JR
608 ABRAHAM ST
MISSION TX 78573

P4654-00-000-0019-00 (693129)
CRUZ JESUS & HELEN DIANA
610 ABRAHAM ST
MISSION TX 78573

P4654-00-000-0020-00 (693130)
MEDINA JUAN ANTONIO & AMALIA MEDINA
612 ABRAHAM ST
MISSION TX 78573

P4654-00-000-0021-00 (693131)
EKORTARH YANICK
102 BELAIRE DR APT NO 1
LAREDO TX 78041

P4654-00-000-0022-00 (693132)
STEVENS HENRY & CECILE TRSTS
STEVENS FAMILY TRUST
3202 KERALUM AVE
MISSION TX 78573

P4654-00-000-0023-00 (693133)
FLORES AARON JR & ALICIA A
3204 KERALUM AVE
MISSION TX 78573

P4654-00-000-0024-00 (693134)
SIERRA MARISOL
3206 KERALUM AVE
MISSION TX 78573

P4654-00-000-0048-00 (693158)
ADAME SILVIA O
607 ABRAHAM ST
MISSION TX 78573

P4654-00-000-0049-00 (693159)
MEYER SCOTT WADE II & BIANCA LIZETTE
609 ABRAHAM STREET
MISSION TX 78573