

ITEM# 2.0

CONDITIONAL USE PERMIT RENEWAL: Drive-Thru Service Window
- Panaderia Donato
3003 N. Conway Avenue
Lot 1, Husain Subdivision
C-3
Jorge A. Melesio

REVIEW DATA

SITE: The subject site is located approximately ¼ of a mile south of W. Mile 2 Road along the west side of Conway Avenue—see vicinity map. The applicant has a bakery and would like to continue utilizing the existing drive-thru service window. Access to the site is off of a 22’ driveway cut along Conway on the south side of the property. Entrance to the 10’ x 98’ drive-thru lane is off of the west side of the property.

- **Hours of Operation:** Monday to Sunday from 7:00 a.m. to 9:00 p.m.
- **Staff:** 4 employees
- **Parking & Landscaping:** Based on the square footage of the building, a total of 22 parking spaces are required for the commercial plaza. The commercial plaza has a total of 32 parking spaces that are held in common and are shared with the other businesses. Staff notes that the applicant will need to install landscaping to meet code.

REVIEW COMMENTS: Staff mailed out 16 notices to property owners within 200’ radius and staff has not received any comments in favor or against this request

RECOMMENDATION: Staff recommends approval subject to:

- 1.) 2 yr. re-evaluation in order to assess this business;
- 2.) Must comply with all City Codes (Building, Fire, etc.)
- 3.) CUP not to be transferable to others.

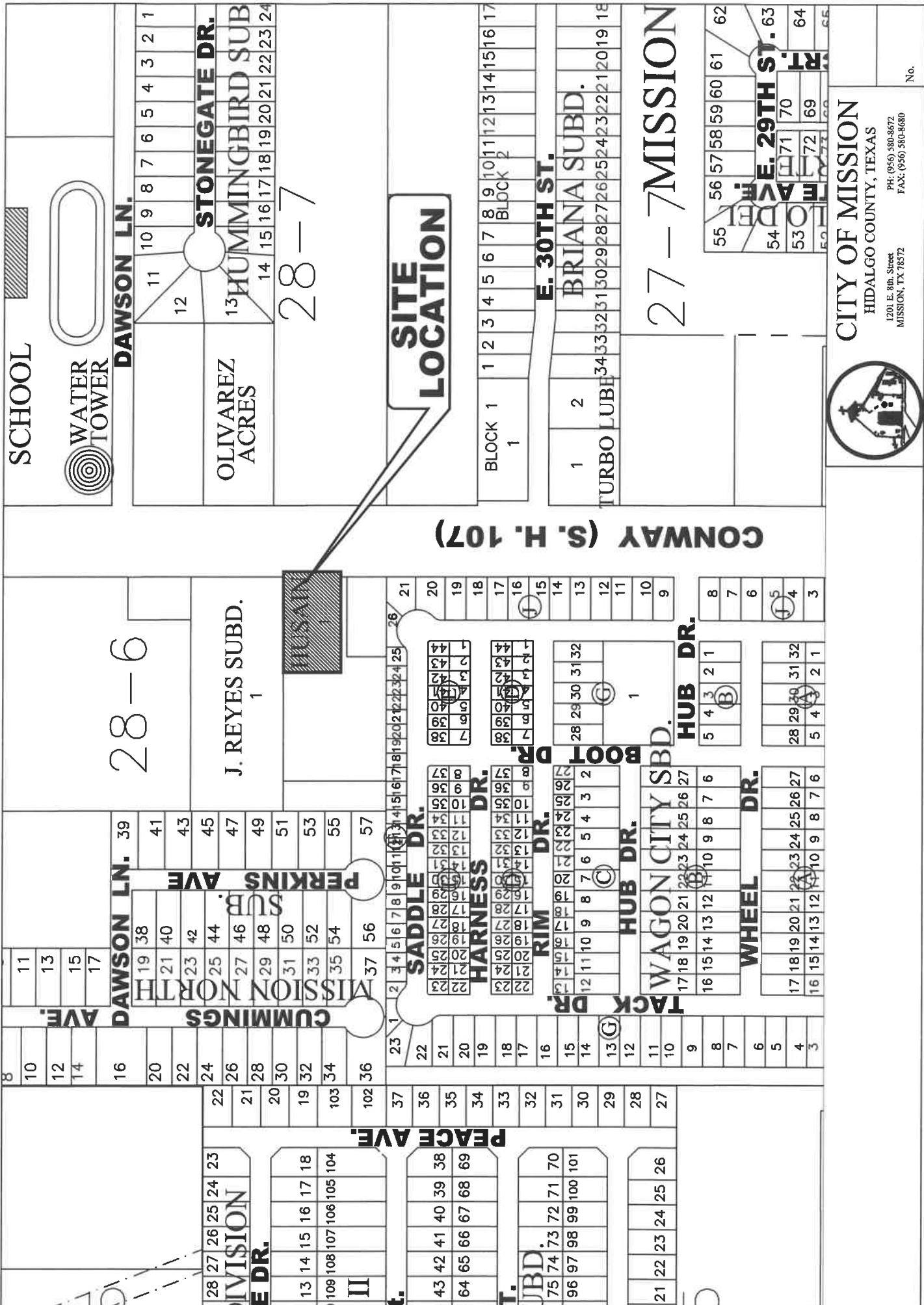

SCHOOL



DAWSON LN.

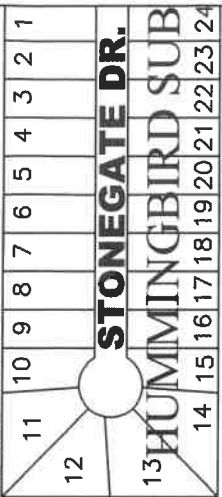

STONEGATE DR.



HUMMINGBIRD SUB

28-7

OLIVAREZ ACRES

SITE LOCATION

CONWAY (S. H. 107)

28-6

J. REYES SUBD.

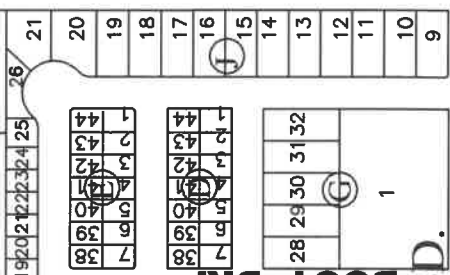

HUSAIN

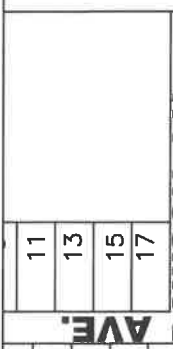

DAWSON LN.

PERKINS AVE

MISSION NORTH SUB

CUMMINGS



SADDLE DR.

HARNES DR.

RIM DR.

HUB DR.

WAGON CITY SBD.

WHEEL DR.



TAK DR.

HUB DR.

WAGON CITY SBD.

HUB DR.

WHEEL DR.

WAGON CITY SBD.

HUB DR.

WHEEL DR.

WAGON CITY SBD.

HUB DR.

WHEEL DR.

WAGON CITY SBD.

HUB DR.

WHEEL DR.

WAGON CITY SBD.

HUB DR.

WHEEL DR.

WAGON CITY SBD.

HUB DR.

WHEEL DR.

WAGON CITY SBD.

HUB DR.

WHEEL DR.

WAGON CITY SBD.

HUB DR.

WHEEL DR.

WAGON CITY SBD.

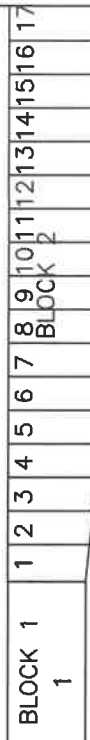

BLOCK 1



E. 30TH ST.

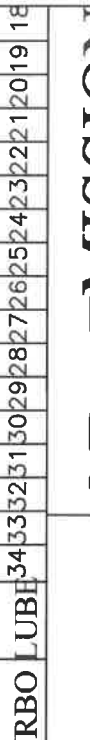

BRIANA SUBD.



TURBO LUBE

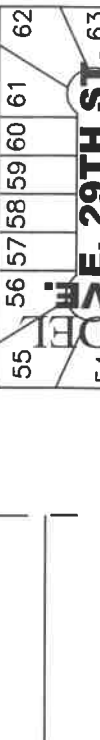

E. 29TH ST.



27-7 MISSION

CITY OF MISSION
 HIDALGO COUNTY, TEXAS
 1201 E. 8th Street
 MISSION, TX 78572
 PH: (956) 580-8672
 FAX: (956) 580-8680
 No.



**SITE
LOCATION**

CONWAY AVE. (S.H. 107)



DONATO PANADERÍA

NOVA

3003

RESERVED PARKING  PEN

3003 N CONWAY
7:00AM - 6:00PM
(956) 374 4377

NO DOGS
OR OTHER
ANIMALS
ALLOWED



DONATO PANADERÍA

NOW

3003

NOW
OPEN



OPEN

3003 N. CONWAY
DONATO PANADERIA
2500 S. W. 10TH ST
DALLAS, TX 75216-4377
TEL: 972-251-4377





DONATO PANADERIA

NOW OPEN

DRIVE THRU

3003



O3200-00-000-0001-00 (587214)
CAVAZOS BEN A
915 W BUSINESS HIGHWAY 83
MISSION TX 78572

W0100-00-027-0007-07 (317110)
HEITSHUSEN GARTH
1935 TRIWAY LN
HOUSTON TX 77043

W0100-00-028-0006-00 (317181)
SYED HUSAIN FAMILY LP
7020 N 1ST ST
MCALLEN TX 78504

W0100-00-028-0007-04 (317193)
HEITSHUSEN ELMER
JANNA L HEITSHUSEN ET AL
1935 TRIWAY LN
HOUSTON TX 77043

W0200-02-00F-0019-00 (319979)
TOBEY BRUCE D & CATHY A
46364 COUNTY ROAD 45
LAPORTE MN 56461

W0200-02-00F-0020-00 (319980)
LYTLE JOHN O MD & ALICE R
919 E MAIN ST
BATESVILLE AR 72501

W0200-02-00F-0021-00 (319981)
LYTLE JIM & ALICE
919 E MAIN ST
BATESVILLE AR 72501

W0200-02-00F-0022-00 (319982)
MCADAMS VAN & PHYLLIS
13127 ELDRIGE RD
HARRISON TN 37341

W0200-02-00F-0023-00 (319983)
SNYDER HARRY L & KATHLEEN Y
2905 N CONWAY AVENUE #246
MISSION TX 78574

W0200-02-00F-0024-00 (319984)
FRY KEITH W & ANNA MARIE
1108 RUTH PLACE
PAWNEE IL 62558

W0200-02-00F-0025-00 (319985)
LANDSOM RICK
20426 BLACK HAMMER DR
SPRING GROVE MN 55974

W0200-02-00F-0026-00 (319986)
THOEN DAVID E & DARLENE J
FAMILY REVOCABLE LIVING TRUST
2905 N CONWAY AVE UNIT 126
MISSION TX 78574

W0200-02-00J-0020-00 (320047)
SPAANS JAMES L & RENEE E
2905 N CONWAY AVE UNIT 55
MISSION TX 78574

W0200-02-00J-0021-00 (320048)
HOFSTRA WILBERT A OR LEILA M
OR PEGGY LOVE
2905 N CONWAY AVE UNIT 155
MISSION TX 78574

F3901-00-000-0002-00 (895250)
SYED HUSAIN FAMILY LP
7020 N 1ST ST
MCALLEN TX 78504

J1845-00-000-0001-00 (1238657)
REYES JUAN RAMON
705 SINATRA DR
EDINBURG TX 78542