

EXHIBIT A

Project No: 230739
Date: November 18, 2024
Page 1 of 1

ZONE R-15 DESCRIPTION

A parcel of land being a portion of the SW1/4 of the NE1/4 of Section 15, Township 3 North, Range 1 West, Boise Meridian, City of Meridian, Ada County, Idaho, more particularly described as follows:

BEGINNING at an aluminum cap monument marking the Center North One-Sixteenth corner of said Section 15; thence along the north line of the SW1/4 of the NE1/4 of said Section 15,

- 1) S.89°15'15"E., 1299.70 feet; thence,
- 2) S.00°44'48"W., 60.36 feet to the beginning of a tangent curve; thence,
- 3) Southwesterly along said curve to the right having a radius of 200.00 feet, an arc length of 97.97 feet, through a central angle of 28°03'57", of which the long chord bears S.14°46'46"W., 96.99 feet; thence, tangent from said curve,
- 4) S.28°48'45"W., 569.42 feet to the beginning of a tangent curve; thence,
- 5) Southwesterly along said curve to the right having a radius of 120.00 feet, an arc length of 20.41 feet, through a central angle of 9°44'39", of which the long chord bears S.33°41'04"W., 20.38 feet; thence, non-tangent from said curve,
- 6) S.05°05'18"E., 658.53 feet to the south line of the SW1/4 of the SE1/4 of said Section 15; thence, along said south line,
- 7) N.89°14'39"W., 1060.98 feet to the Center One-Quarter corner of said Section 15; thence, leaving said south line, along the west line of the SW1/4 of the SE1/4 of said Section 15,
- 8) N.00°36'37"E., 1328.96 feet to the **POINT OF BEGINNING**.

CONTAINING: 33.61 Ac. more or less

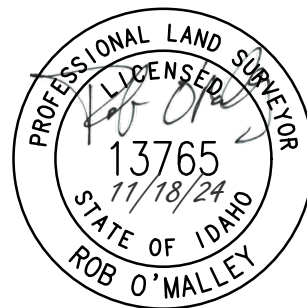

Project No: 230739
Date: November 18, 2024
Page 1 of 2

ZONE C-G DESCRIPTION

A parcel of land being a portion of Section 15, Township 3 North, Range 1 West, Boise Meridian, City of Meridian, Ada County, Idaho, more particularly described as follows:

BEGINNING at an aluminum cap monument marking the East One-Quarter corner of said Section 15; thence along the east boundary of the NE1/4 of the SE1/4 of said Section,

- 1) S.00°30'02"W., 1472.05 feet to center line of interstate 84; thence, along said center line the following three courses:
- 2) N.89°34'10"W., 1318.06 feet to the beginning of tangent curve; thence,
- 3) Northwesterly along said curve to the right having a radius of 11459.16 feet, an arc length of 1804.33 feet, through a central angle of 9°01'18", of which the long chord bears N.85°03'31"W., 1802.47 feet; thence, tangent from said curve,
- 4) N.80°32'52"W., 93.52 feet; thence, leaving said center line,
- 5) N.00°45'12"E., 1333.63 feet to the Center East-West line of said Section 15; thence, along said Center East-West line,
- 6) S.89°14'48"E., 558.49 feet to the Center One-Quarter corner of said Section 15; thence, continuing along said Center East-West line,
- 7) S.89°14'39"E., 1060.98 feet; thence, leaving said Center East-West line,
- 8) N.05°05'18"W., 658.53 feet to the beginning of a non-tangent curve; thence,
- 9) Northeasterly along said curve to the left having a radius of 120.00 feet, an arc length of 20.41 feet, through a central angle of 9°44'39", of which the long chord bears N.33°41'04"E., 20.38 feet; thence, tangent from said curve,
- 10) N. 28°48'45"E., 569.42 feet to the beginning of a tangent curve; thence,
- 11) Northeasterly along said curve to the left having a radius of 200.00 feet, an arc length of 97.97 feet, through a central angle of 28°03'57", of which the long chord bears N.14°46'46"E., 96.99 feet; thence, tangent from said curve,
- 12) N.00°44'48"E., 60.36 feet to the north line of the S1/2 of the NE1/4, also being the north right-of-way of W. Cobalt Dr.; thence, along said north line,
- 13) S.89°15'15"E., 21.07 feet to the Northeast One-Sixteenth corner of said Section 15; thence, continuing along said north line,
- 14) S.89°14'59"E., 808.92 feet to beginning of a non-tangent curve, also being the center line of W. Cobalt Dr; thence, leaving said north line, along said center line the following four courses:

Project No: 230739
Date: November 18, 2024
Page 2 of 2

- 15) Northeasterly along said curve to the left having a radius of 300.00 feet, an arc length of 9.35 feet, through a central angle of $01^{\circ}47'07''$, of which the long chord bears $N.60^{\circ}20'03''E.$, 9.35 feet; thence, tangent from said curve,
- 16) $N.59^{\circ}26'28''E.$, 214.64 feet to the beginning of a tangent curve; thence,
- 17) Northeasterly along said curve to the right having a radius of 300.00 feet, an arc length of 178.74 feet, through a central angle of $34^{\circ}08'14''$, of which the long chord bears $N.76^{\circ}30'37''E.$, 176.11 feet; thence, tangent from said curve,
- 18) $S.86^{\circ}25'14''E.$, 149.83 feet to the east line of the NE1/4 of said Section 15; thence, leaving said center line, along said east line,
- 19) $S.00^{\circ}33'33''W.$, 1481.35 feet to the **POINT OF BEGINNING**.

CONTAINING: 155.09 Ac. more or less

