

# CITY OF MERIDIAN UTILITY IMPROVEMENTS

TO BE CONSTRUCTED IN CONJUNCTION WITH

## ADA COUNTY HIGHWAY DISTRICT TEN MILE RD AND VICTORY RD

### ACHD PROJECT NO. 319038 CITY PROJECT NO. 10975

#### LEGEND

(See Standards For Specifics)

	12" W New Potable Water Main
	8" SS New Sanitary Sewer Main
	FO New Fiber Optic Line
	2 3 C.L. of Roadway
	EP EG Existing Edge of Pavement or Gravel
	12" GMP SD Existing Drain or Irrigation Pipe
	Existing Ditch or Flow line
	Existing Property Line
	R/W New Right-Of-Way
	New Easement Line
	Existing Fence and Gate
	P or W or C or T or TV or UP or S Existing Utility Line With Initial
	Existing Concrete Sidewalk
	Existing Curb, Gutter, and Sidewalk
	New Curb, Gutter, and Sidewalk
	Existing and New Water Valve
	Existing and New Water Meter
	Fire Hydrant
	Light Pole
	Utility Pole With Anchor
	Sign
	Existing and New Manholes
	Existing and New Catch Basin
	Deciduous And Evergreen Tree
	Deciduous And Evergreen Bushes
	Existing Building
	Revision Note
	Asphalt Repair
	Gravel Repair
	Concrete Repair
	Lawn Sod Repair



#### SHEET INDEX

1. TITLE SHEET
2. CONSTRUCTION NOTES AND DETAILS
- 3-8. UTILITY IMPROVEMENTS

- NOTES: 1. REFER TO ACHD PROJECT #319038 PLANS AND SPECIFICATIONS FOR PROPOSED ROADWAY IMPROVEMENTS AND PROJECT HORIZONTAL AND VERTICAL CONTROL.
2. COORDINATE ALL WORK RELATED TO CITY OF MERIDIAN UTILITY IMPROVEMENTS WITH ROADWAY IMPROVEMENTS.
3. INFORMATION SHOWN ON THIS PLAN SET IS ACCURATE ONLY FOR CITY OF MERIDIAN UTILITY IMPROVEMENTS.

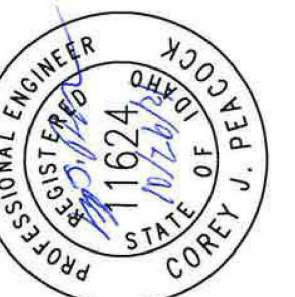

PROJECT NO.	19044			
	DESIGNED	CIP	DRAWN	CIP
NO.	DATE			
	REVISIONS	ITEM		
			CHECKED	CIP
				APPROVED

**CIVIL SURVEY CONSULTANTS, INC.**  
 CONSULTING ENGINEERS AND LAND SURVEYORS

2893 S. MERIDIAN ROAD  
 MERIDIAN, IDAHO 83642  
 (208)988-4312

**CITY OF MERIDIAN**

**TEN MILE ROAD AND VICTORY ROAD**

**UTILITY IMPROVEMENTS**



**APPROVED FOR CONSTRUCTION**

These plans and/or specifications have been reviewed for compliance with Meridian City Standards and Specifications. This review does not relieve the owner, engineer, or contractor of the responsibility to design and/or construct those facilities in compliance with all current applicable federal, state, and local laws, rules, regulations, ordinances, development agreements, specifications, orders of approvals, all of which the City retains the right to enforce. Inconsistencies not noted by City staff shall not be construed as approved unless specifically addressed in writing by the City. Any proposed revision to these plans must be submitted for review and compliance with the Meridian City Standards and Specifications before said revision is constructed.

Name       Codie Krausch        
 Date       11/02/2021        
 Permit Number       LD-CAP-2021-0003      

**APPROVED FOR CONSTRUCTION**

These plans and/or specifications have been reviewed for compliance with Meridian City Standards and Specifications. This review does not relieve the owner, engineer, or contractor of the responsibility to design and/or construct these facilities in compliance with all current applicable federal, state and local laws, rules, regulations, ordinances, development agreements, specifications, orders or approvals, all of which the City retains the right to enforce. Inconsistencies not noted by City staff shall not be construed as approved unless specifically addressed in writing by the City. Any proposed revision to these plans must be submitted for review and compliance with the Meridian City Standards and Specifications before said revision is constructed.

Name \_\_\_\_\_ Date \_\_\_\_\_



DATE: AUGUST 2021  
 DRAWING: SHT01.DWG  
 JOB NO: 19044

**CITY OF MERIDIAN STANDARD NOTES:**

**GENERAL CONSTRUCTION**

- All construction work shall be done in accordance with the current version of the Idaho Standards for Public Works Construction (ISPWC), the City of Meridian Supplemental Specifications to the ISPWC (and any addendums), Meridian Design Standards, the requirements of the Ada County Highway District (ACHD) and/or the requirements of the Idaho Transportation Department (ITD). The more stringent of any of these standards shall be the controlling standards or specifications.
- The Contractor shall have a copy of the latest City of Meridian Standard Specifications and Drawings on site or readily accessible at all times during construction (available on the website). Failure to have access to a current copy of the Standard Specifications on site could be grounds for a stop work order until the situation is resolved.
- The Contractor shall have plans stamped "Approved for Construction" by the City of Meridian on site at all times.
- All Contractors, Subcontractors and Utility Contractors shall attend a pre-construction conference prior to start of work.
- Contractors shall notify the appropriate agency when materials are on site or inspection of the work is required. No work may begin on any project without Twenty Four (24) hour prior notice.
- Contractor shall notify the Public Works Inspector 48 hours prior to the required testing. The Contractor may not open or close water valves.
- All material furnished on, or for the project must meet the minimum requirements of the approving agencies. At the request of the approving agency or the Design Engineer, Contractors shall furnish proof that all materials installed on this project meet the specification requirements set forth in General Construction Note No. 1.
- Work subject to approval by any governmental agency must be approved prior to (A) backfilling trenches for pipe; (B) placing of aggregate base; (C) placing of concrete; (D) placing of asphalt paving.
- Inspection, approval and final acceptance of all water and sewer construction shall be by the Public Works Department, and their decision shall be final. Such inspections shall not relieve the contractor from the responsibility of performing the work in an acceptable manner in accordance with the DEQ/QLPE approved construction plans.
- Any deviation from the approved plans and specifications must have the applicable agency approval in writing prior to construction.
- Prior to beginning installation of street lights, the electrical contractor shall obtain an Electrical Permit from the Building Division of the Meridian Public Works Department. Any deviation in street light locations from the approved plans must be approved in writing from the City Engineer.

**ROADWAY**

- ACHD or ITD will inspect all work within the public right-of-way to include utility trenches above the pipe zone.
- Traffic control beyond that provided under the prime roadway contract may be required for these utility improvements. All required traffic control shall conform to the requirements of ACHD, and the Manual on Uniform Traffic Control Devices. All required traffic control shall be considered incidental to the project and no separate payment will be made.
- When utility work occurs prior to the prime roadway construction, all utility trenches located within the limits of the prime roadway project that must be kept open to two way traffic and within existing paved surfaces shall be restored with Type "P" trench restoration. Trench restoration is considered temporary and will be maintained under the prime roadway contract following the initial installation. The initial trench repair must be accepted by ACHD and the prime contractor before maintenance responsibility is transferred to the prime contractor. All temporary trench restoration shall be considered incidental to the project and no separate payment shall be made.

**WATER**

- Construction of the water system shall conform to the standards in the "Idaho Rules for Public Drinking Water Systems (IDAPA 58.01.08)" as well as the standards and specifications referred to in General Construction Note No. 1.
- The horizontal separation of potable water mains and non-potable water mains (sanitary sewer, storm drain, and irrigation) shall be a minimum of ten (10) feet. Where it is necessary for a potable water main and non-potable water main to cross with less than eighteen (18) inches of vertical separation, the crossing shall be constructed in accordance with Section 542.07 of the Idaho Rules for Public Drinking Water Systems (IDAPA 58.01.08) and Section 430.02 of the Wastewater Rules (IDAPA 58.01.16).
- The horizontal separation of non-potable services and potable water services or potable water mains shall be a minimum of six (6) feet. Where it is necessary for a potable water main and non-potable water main to cross with less than eighteen (18) inches of vertical separation, the crossing shall be constructed in accordance with Section 542.07 of the Idaho Rules for Public Drinking Water Systems (IDAPA 58.01.08) and Section 430.02 of the Wastewater Rules (IDAPA 58.01.16).
- Place water service lines in a two (2) inch diameter pipe wherever the service line crosses a storm water treatment facility (i.e. seepage beds, drainage swales).
- The Contractor shall be responsible for providing continuous water service to all existing water users affected by construction. If water service must be interrupted, the Contractor shall coordinate with the Public Works Inspector.
- It is the intent of this project that all new water line work be performed in conjunction with ACHD's roadway reconstruction project. All water line work shall be closely coordinated with the prime contract to minimize the amount of trench work in the paved areas that must remain open to traffic. When utility construction must occur prior to the roadway work trenches shall be repaired with Temporary Type "P" surface restoration. See Roadway Note #3.
- Trench dewatering may be required to complete construction activities. Contractor is required to obtain necessary permits and approvals prior to starting dewatering.
- All products used to construct a public drinking water system and will be in contact with potable water must be certified by an accredited ANSI certification body to meet applicable ANSI/NSF standards.

**SEWER**

- Construction of the sewer system shall conform to the standards in the Wastewater Rules (IDAPA 58.01.16) as well as the standards and specifications referred to in General Construction Note No. 1.
- The horizontal separation of potable water mains and non-potable water mains (sanitary sewer, storm drain, and irrigation) shall be a minimum of ten (10) feet. Where it is necessary for a potable water main and non-potable water main to cross with less than eighteen (18) inches of vertical separation, the crossing shall be constructed in accordance with Section 542.07 of the Idaho Rules for Public Drinking Water Systems (IDAPA 58.01.08) and Section 430.02 of the Wastewater Rules (IDAPA 58.01.16).
- The horizontal separation of non-potable services and potable water services or potable water mains shall be a minimum of six (6) feet. Where it is necessary for a potable water main and non-potable water main to cross with less than eighteen (18) inches of vertical separation, the crossing shall be constructed in accordance with Section 542.07 of the Idaho Rules for Public Drinking Water Systems (IDAPA 58.01.08) and Section 430.02 of the Wastewater Rules (IDAPA 58.01.16).
- Place sewer service lines in a six (6) inch diameter water class pipe wherever the service line crosses a stormwater treatment facility (i.e., seepage beds, drainage swales).
- It is the intent of this project that all new sewer line work be performed in conjunction with ACHD's roadway reconstruction project. All sewer line work shall be closely coordinated with the prime contract to minimize the amount of trench work in the paved areas that must remain open to traffic. When utility construction must occur prior to the roadway work trenches shall be repaired with Temporary Type "P" surface restoration. See Roadway Note #3.
- Trench dewatering may be required to complete construction activities. Contractor is required to obtain necessary permits and approvals prior to starting dewatering.

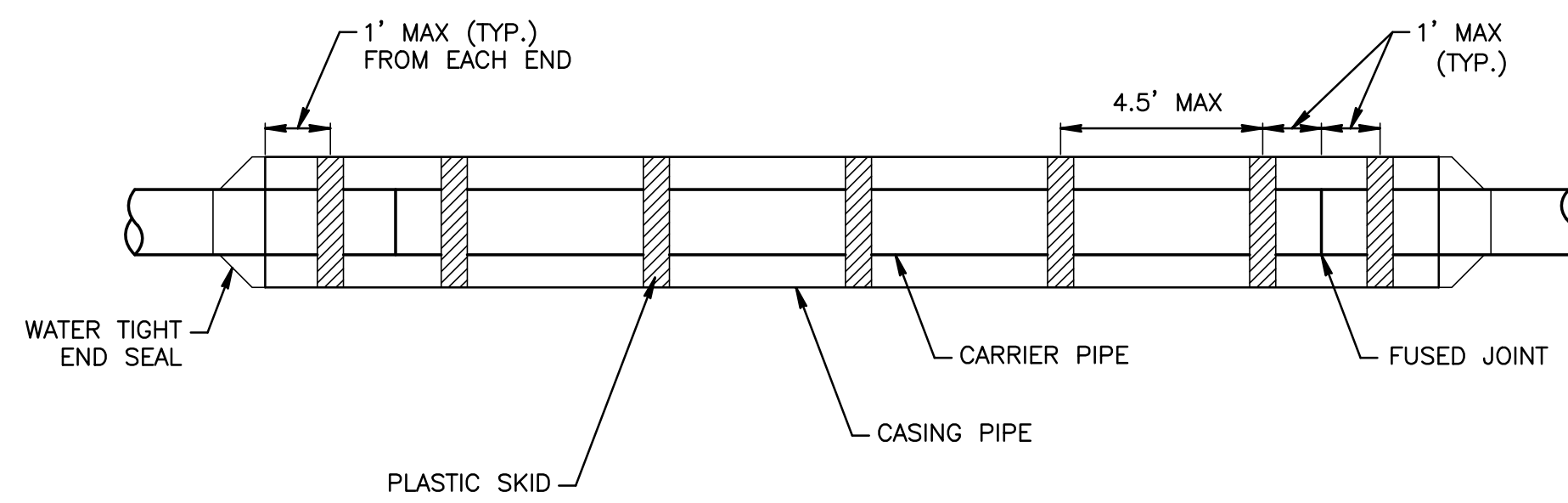

**WATER MAIN CASING DETAIL**

N.T.S.

- NOTES:
- CASING PIPE SHALL BE INSTALLED AT THE SAME SLOPE AS THE CARRIER PIPE AND THE CARRIER PIPE SHALL BE CENTERED INSIDE THE CASING PIPE.
  - THE ENTIRE ANNULAR SPACE BETWEEN THE CASING AND CARRIER PIPES SPACE SHALL BE FILLED IN ACCORDANCE WITH THE ISPWC AND CITY OF MERIDIAN SUPPLEMENTAL SPECIFICATIONS.

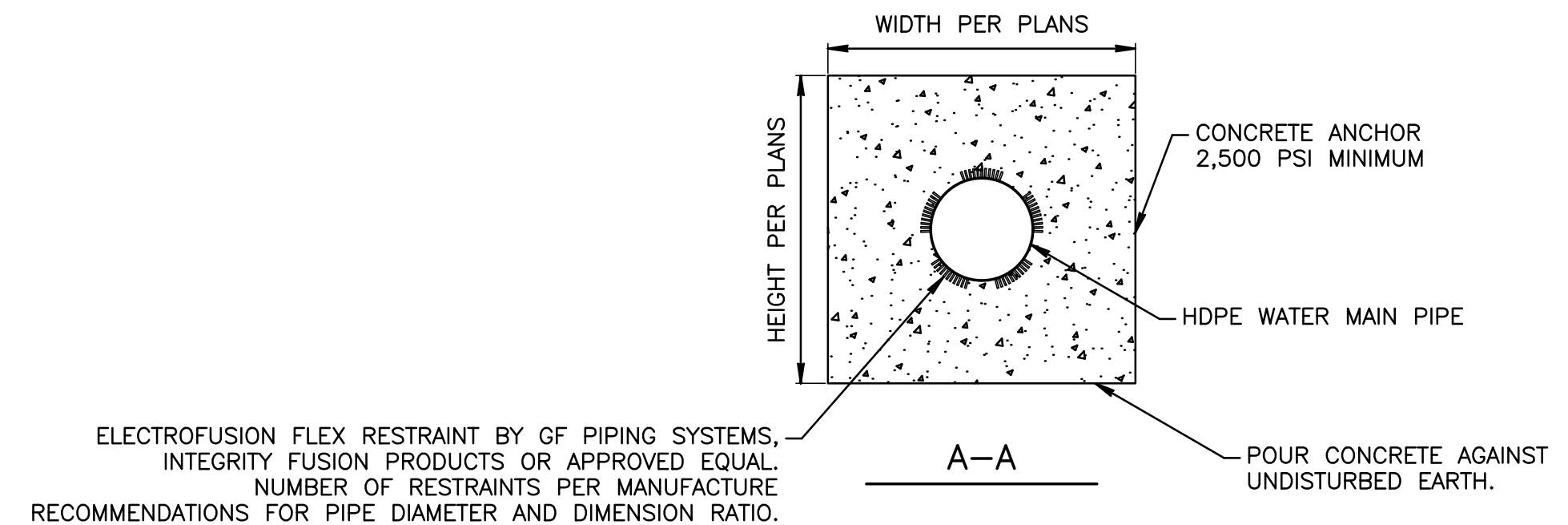

ELECTROFUSION FLEX RESTRAINT BY OF PIPING SYSTEMS, INTEGRITY FUSION PRODUCTS OR APPROVED EQUAL. NUMBER OF RESTRAINTS PER MANUFACTURE RECOMMENDATIONS FOR PIPE DIAMETER AND DIMENSION RATIO.

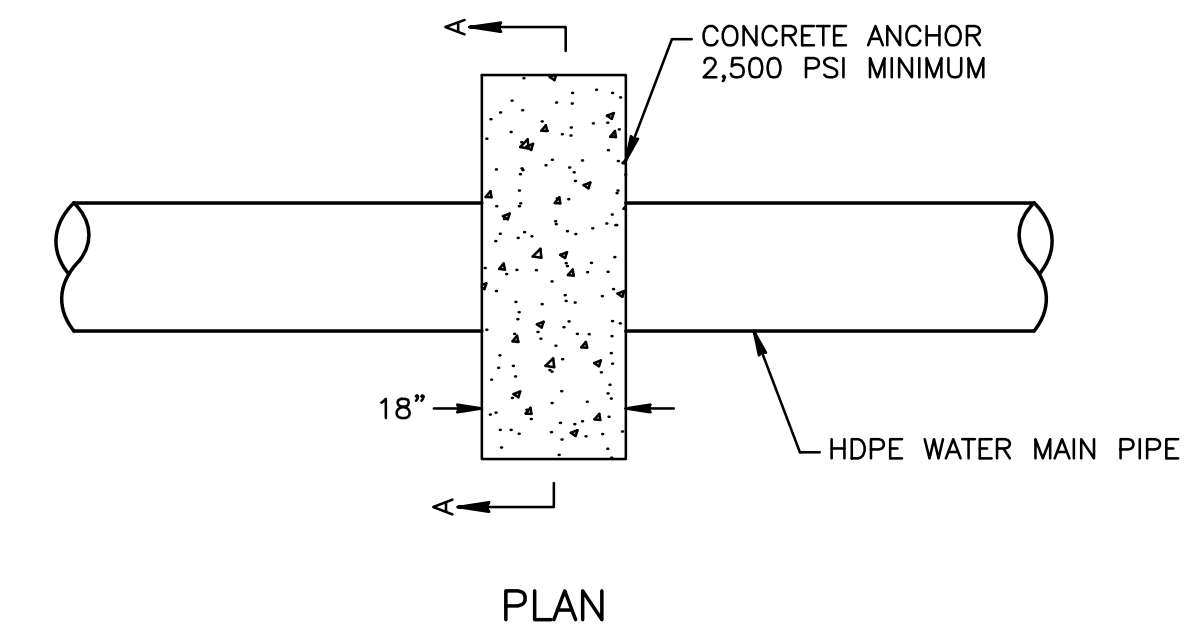

**HDPE PIPE CONCRETE ANCHOR**

N.T.S.

**MERIDIAN IDAHO** APPROVED FOR CONSTRUCTION

These plans and/or specifications have been reviewed for compliance with Meridian City Standards and Specifications. This review does not relieve the owner, engineer, or contractor of the responsibility to design and/or construct those facilities in compliance with all current applicable federal, state, and local laws, rules, regulations, ordinances, development agreements, specifications, orders of approvals, all of which the City retains the right to enforce. Inconsistencies not noted by City staff shall not be construed as approved unless specifically addressed in writing by the City. Any proposed revision to these plans must be submitted for review and compliance with the Meridian City Standards and Specifications before said revision is constructed.

Name: Codee Krausch  
Date: 11/02/2021  
Permit Number: LD-CAP-2021-0003

**MERIDIAN IDAHO** APPROVED FOR CONSTRUCTION

These plans and/or specifications have been reviewed for compliance with Meridian City Standards and Specifications. This review does not relieve the owner, engineer, or contractor of the responsibility to design and/or construct those facilities in compliance with all current applicable federal, state and local laws, rules, regulations, ordinances, development agreements, specifications, orders or approvals, all of which the City retains the right to enforce. Inconsistencies not noted by City staff shall not be construed as approved unless specifically addressed in writing by the City. Any proposed revision to these plans must be submitted for review and compliance with the Meridian City Standards and Specifications before said revision is constructed.

Name: \_\_\_\_\_ Date: \_\_\_\_\_



PROJECT NO.	DESIGNED	DRAWN	CHECKED	APPROVED
19044	CJP	CJP	CJP	CJP
DATE				
REVISIONS				
ITEM				
NO.				

**CIVIL SURVEY CONSULTANTS, INC.**  
CONSULTING ENGINEERS AND LAND SURVEYORS

2893 S. MERIDIAN ROAD  
MERIDIAN, IDAHO 83642  
(208)868-4312

**CITY OF MERIDIAN**

**TEN MILE ROAD AND VICTORY ROAD**

**UTILITY IMPROVEMENTS**

DATE: JULY 2021  
DRAWING: SHT02.DWG  
JOB NO: 19044

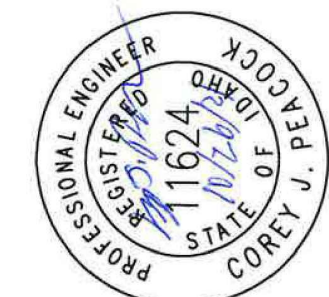

PROJECT NO.	DESIGNED	DRAWN	CHECKED	APPROVED
19044	CJP	CJP	CJP	CJP

**CIVIL SURVEY CONSULTANTS, INC.**  
**CONSULTING ENGINEERS AND LAND SURVEYORS**  
 2893 S. MERIDIAN ROAD  
 MERIDIAN, IDAHO 83642  
 (208)868-4312

**CITY OF MERIDIAN**  
**TEN MILE ROAD AND VICTORY ROAD**  
**UTILITY IMPROVEMENTS**

DATE: AUGUST 2021  
 DRAWING: DESIGN(ROUNDABOUT)  
 JOB NO: 19044  
**SHEET 3 OF 8**

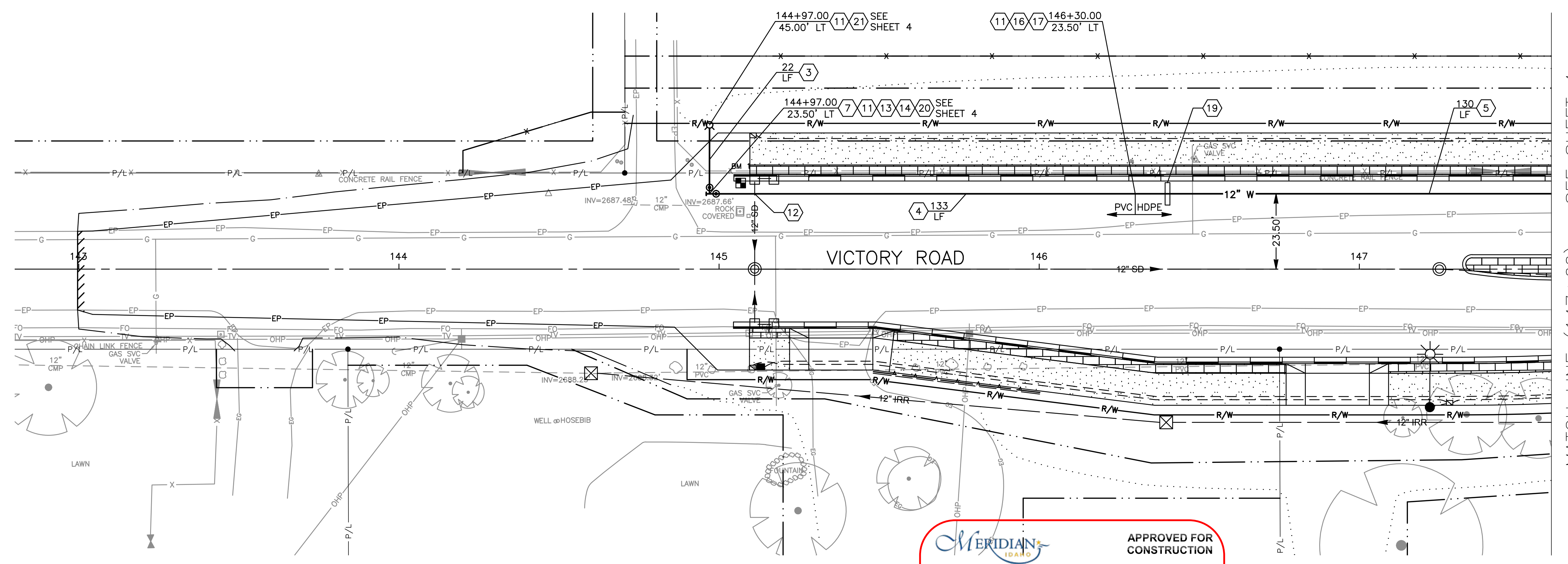

MATCH LINE (147+60) — SEE SHEET 4

- NOTES**
- |    |   |    |   |
|----|---|----|---|
| 3  | 6" PVC, AWWA C900, DR18, WATER MAIN, ITEM 401.4.1.A.1.                | 14 | 12" DUCTILE IRON BLIND FLANGE, INCIDENTAL TO PIPE ITEM.   |
| 4  | 12" PVC, AWWA C900, DR18, WATER MAIN, ITEM 401.4.1.A.1.               | 16 | 16"x12" DUCTILE IRON REDUCER, FLXMJ, INCIDENTAL TO PIPE ITEM.   |
| 5  | 16" (IPS) HDPE, AWWA C906, PE4710, DR7, WATER MAIN, ITEM 401.4.1.A.1. | 17 | 16" (IPS) HDPE, AWWA C906, PE4710, DR7, FLANGE ADAPTER, INCIDENTAL TO PIPE ITEM.                            |
| 7  | 12" GATE VALVE, FLXMJ, ITEM 402.4.1.A.1.                              | 19 | HDPE PIPE CONCRETE ANCHOR, 60" WIDE X 60" HIGH X 18" THICK, SEE DETAIL ON SHEET 2, INCIDENTAL TO PIPE ITEM. |
| 11 | CONCRETE THRUST BLOCK, INCIDENTAL TO PROJECT.                         | 20 | RELOCATE EXISTING 6" GATE VALVE, FLXMJ, ITEM 402.4.1.A.1.   |
| 12 | NON-POTABLE PIPE CROSSING, SEE WATER NOTES ON SHEET 2.                | 21 | RELOCATE EXISTING FIRE HYDRANT ASSEMBLY AND LOCATE STATION, ITEM 403.4.1.A.1.                               |
| 13 | 12"x12"x6" DUCTILE IRON TEE, FLXFLXL, INCIDENTAL TO PIPE ITEM.        |    |   |

**APPROVED FOR CONSTRUCTION**

These plans and/or specifications have been reviewed for compliance with Meridian City Standards and Specifications. This review does not relieve the owner, engineer, or contractor of the responsibility to design and/or construct those facilities in compliance with all current applicable federal, state, and local laws, rules, regulations, ordinances, development agreements, specifications, orders of approvals, all of which the City retains the right to enforce. Inconsistencies not noted by City staff shall not be construed as approved unless specifically addressed in writing by the City. Any proposed revision to these plans must be submitted for review and compliance with the Meridian City Standards and Specifications before said revision is constructed.

Name: Codee Krausch  
 Date: 11/02/2021  
 Permit Number: LD-CAP-2021-0003

**BENCHMARKS**

TBM #1 - 5/8" PIN  
 STA. 145+06.78, 26.87' LT  
 ELEV=2689.47  
 N=696606.40  
 E=2443415.09

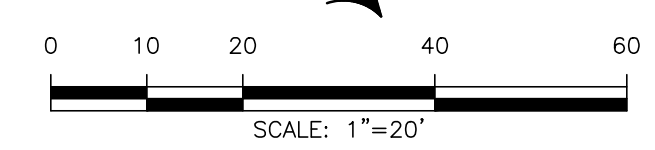

SCALE: HORIZ. 1"=20'  
 VERT. 1"=2'

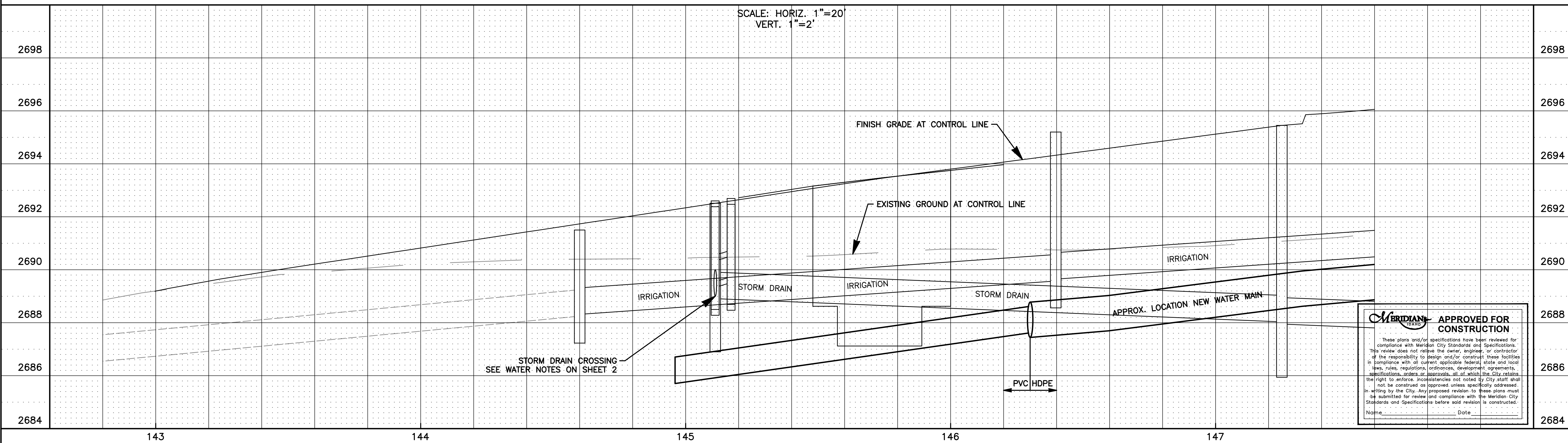

**APPROVED FOR CONSTRUCTION**

These plans and/or specifications have been reviewed for compliance with Meridian City Standards and Specifications. This review does not relieve the owner, engineer, or contractor of the responsibility to design and/or construct those facilities in compliance with all current applicable federal, state, and local laws, rules, regulations, ordinances, development agreements, specifications, orders of approvals, all of which the City retains the right to enforce. Inconsistencies not noted by City staff shall not be construed as approved unless specifically addressed in writing by the City. Any proposed revision to these plans must be submitted for review and compliance with the Meridian City Standards and Specifications before said revision is constructed.

Name: \_\_\_\_\_ Date: \_\_\_\_\_

**APPROVED FOR CONSTRUCTION**

These plans and/or specifications have been reviewed for compliance with Meridian City Standards and Specifications. This review does not relieve the owner, engineer, or contractor of the responsibility to design and/or construct those facilities in compliance with all current applicable federal, state, and local laws, rules, regulations, ordinances, development agreements, specifications, orders of approvals, all of which the City retains the right to enforce. Inconsistencies not noted by City staff shall not be construed as approved unless specifically addressed in writing by the City. Any proposed revision to these plans must be submitted for review and compliance with the Meridian City Standards and Specifications before said revision is constructed.

Name: Codee Krausch  
 Date: 11/02/2021  
 Permit Number: LD-CAP-2021-0003

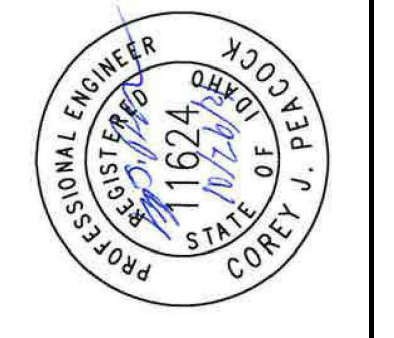

MATCH LINE (147+60) - SEE SHEET 3

MATCH LINE (152+40) - SEE SHEET 4

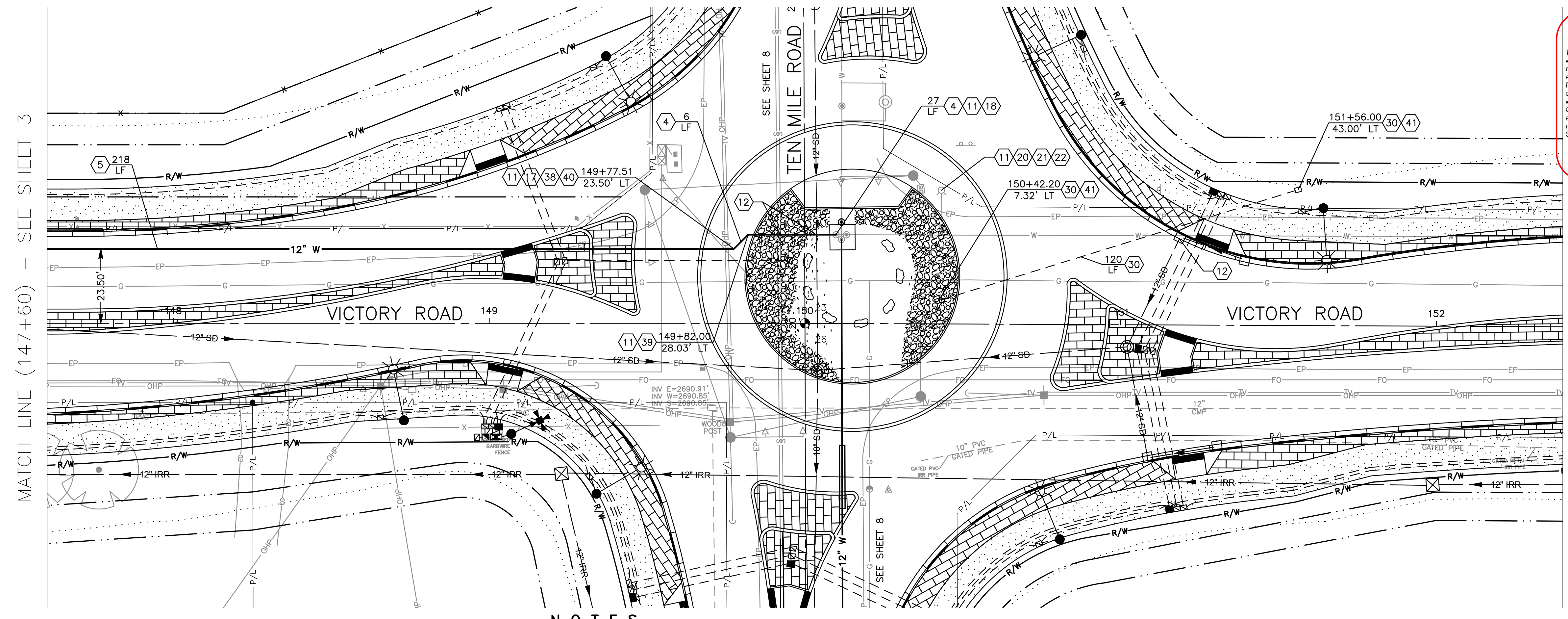

**NOTES**

- |    |  |    |  |    |   |
|----|--|----|--|----|---|
| 4  | 12" PVC, AWWA C900, DR18, WATER MAIN, ITEM 401.4.1.A.1.                          | 20 | RELOCATE EXISTING 6" GATE VALVE, FLxMJ, ITEM 402.4.1.A.1.  | 38 | 12" DUCTILE IRON 45° BEND, FLxMJ, INCIDENTAL TO PIPE ITEM.    |
| 5  | 16" (IPS) HDPE, AWWA C906, PE4710, DR7, WATER MAIN, ITEM 401.4.1.A.1.            | 21 | RELOCATE EXISTING FIRE HYDRANT ASSEMBLY AND LOCATE STATION, ITEM 403.4.1.A.1.  | 39 | 12" DUCTILE IRON 45° BEND, MJxMJ, INCIDENTAL TO PIPE ITEM.    |
| 11 | CONCRETE THRUST BLOCK, INCIDENTAL TO PROJECT.                                    | 22 | 6" DUCTILE IRON BLIND FLANGE, INCIDENTAL TO HYDRANT RELOCATE ITEM.   | 40 | 16"x12" DUCTILE IRON REDUCER, FLxFL, INCIDENTAL TO PIPE ITEM. |
| 12 | NON-POTABLE PIPE CROSSING, SEE WATER NOTES ON SHEET 2.                           | 30 | 2(EA)-4" SCHEDULE 40 RIGID PLASTIC CONDUIT (IRRIGATION & ELECTRICAL SERVICE SLEEVE) WITH LOCATE WIRE AND PULL WIRE, ITEM 1102.4.1.E.1. | 41 | JUNCTION BOX, S40T/ADA, ITEM 1102.4.1.A.1.                    |
| 17 | 16" (IPS) HDPE, AWWA C906, PE4710, DR7, FLANGE ADAPTER, INCIDENTAL TO PIPE ITEM. |    |  |    |   |
| 18 | CONNECT TO EXISTING 12" MJ GATE VALVE, INCIDENTAL TO PIPE ITEM.                  |    |  |    |   |

**BENCHMARKS**

TBM #2 - 5/8" PIN  
 STA. 148+98.43, 102.67' LT  
 ELEV=2690.58  
 N=696472.75  
 E=2443805.35

\*\*REFER TO ACHD PROJECT #319038 PLANS AND SPECIFICATIONS FOR PROPOSED ROADWAY IMPROVEMENTS AND PROJECT HORIZONTAL AND VERTICAL CONTROL.

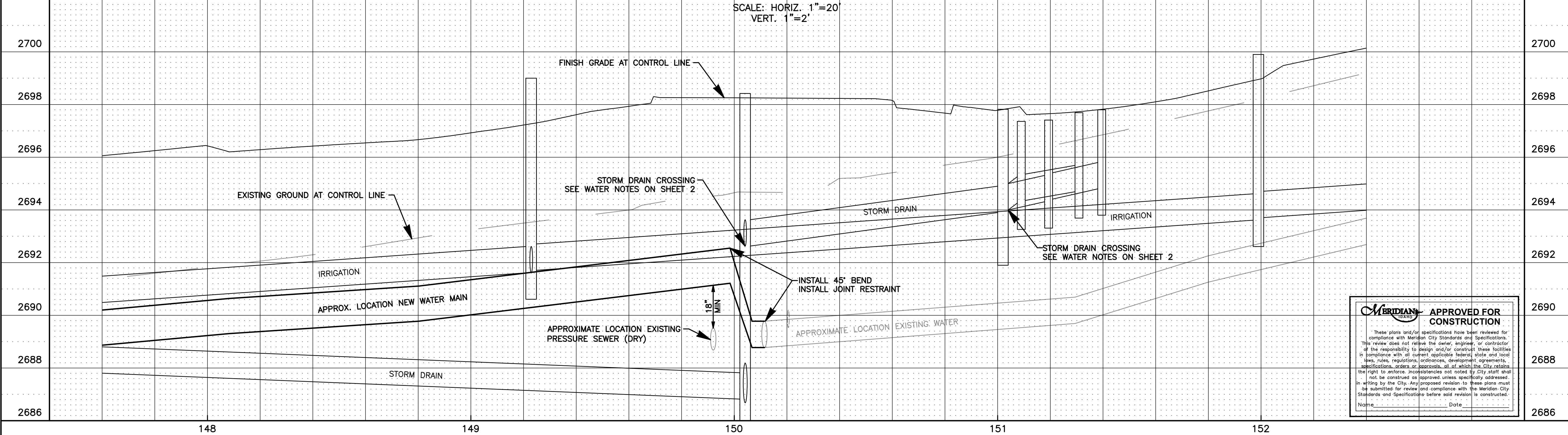
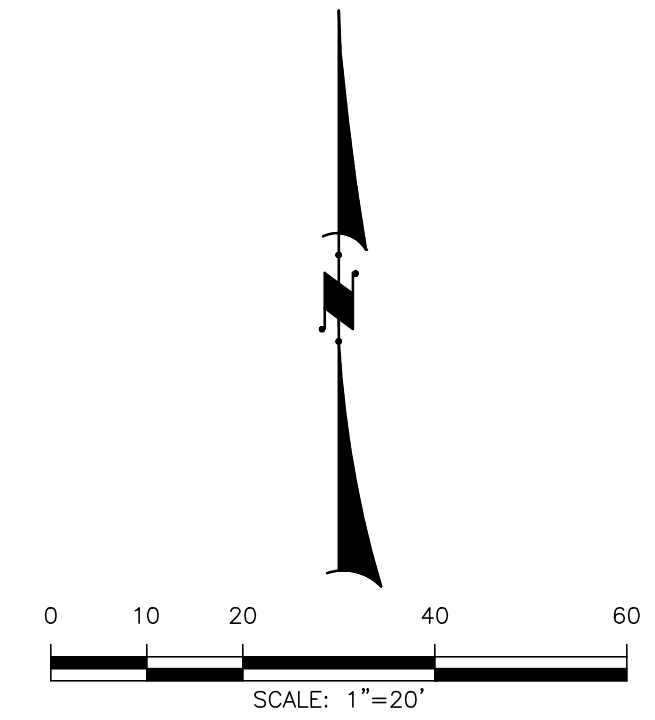

**APPROVED FOR CONSTRUCTION**

These plans and/or specifications have been reviewed for compliance with Meridian City Standards and Specifications. This review does not relieve the owner, engineer, or contractor of the responsibility to design and/or construct those facilities in compliance with all current applicable federal, state, and local laws, rules, regulations, ordinances, development agreements, specifications, orders of approvals, all of which the City retains the right to enforce. Inconsistencies not noted by City staff shall not be construed as approved unless specifically addressed in writing by the City. Any proposed revision to these plans must be submitted for review and compliance with the Meridian City Standards and Specifications before said revision is constructed.

Name: \_\_\_\_\_ Date: \_\_\_\_\_

PROJECT NO.	DESIGNED	DRAWN	CHECKED	APPROVED
19044	CJP	CJP	CJP	CJP

**CIVIL SURVEY CONSULTANTS, INC.**  
 CONSULTING ENGINEERS AND LAND SURVEYORS

2893 S. MERIDIAN ROAD  
 MERIDIAN, IDAHO 83642  
 (208)868-4312

**CITY OF MERIDIAN**  
**TEN MILE ROAD AND VICTORY ROAD**  
**UTILITY IMPROVEMENTS**

DATE: AUGUST 2021  
 DRAWING: DESIGN(ROUNDABOUT)  
 JOB NO: 19044  
**SHEET 4 OF 8**

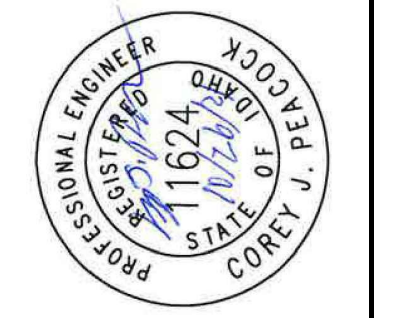

MATCH LINE (152+40) - SEE SHEET 4

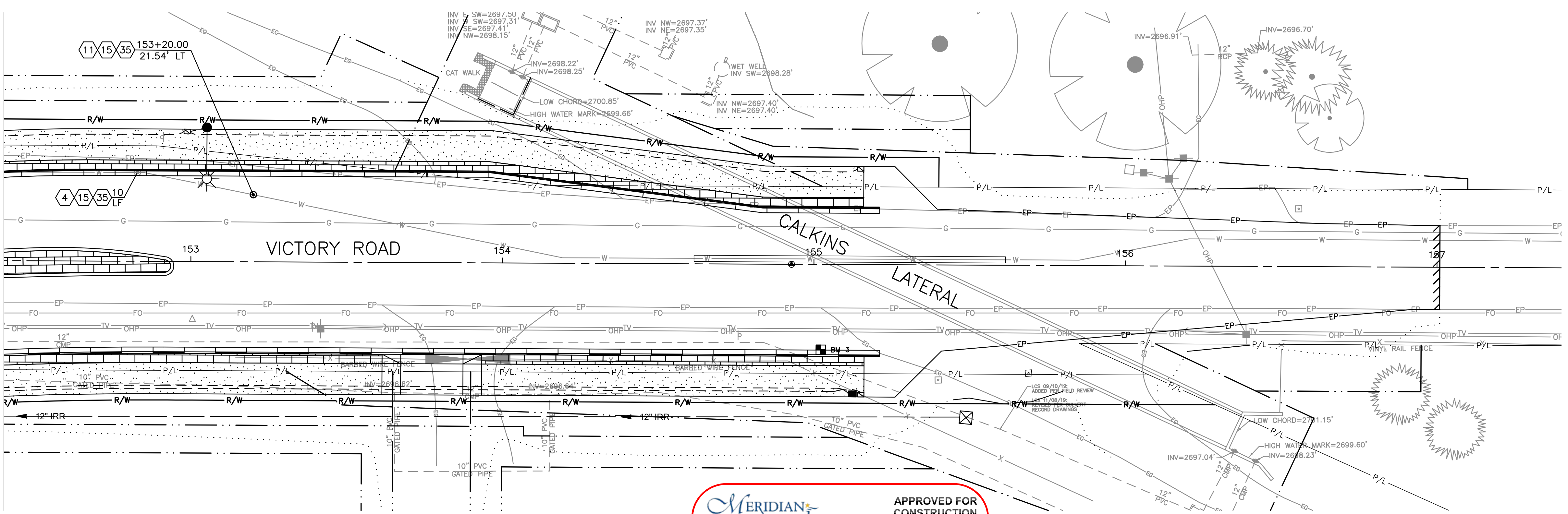

- NOTES**
- 4 12" PVC, AWWA C900, DR18, WATER MAIN, ITEM 401.4.1.A.1.
  - 11 CONCRETE THRUST BLOCK, INCIDENTAL TO PROJECT.
  - 15 12" DUCTILE IRON ADAPTER, MJXFL, INCIDENTAL TO PIPE ITEM.
  - 35 RELOCATE EXISTING 12" GATE VALVE, MJxFL, ITEM 402.4.1.A.1.

**APPROVED FOR CONSTRUCTION**

These plans and/or specifications have been reviewed for compliance with Meridian City Standards and Specifications. This review does not relieve the owner, engineer, or contractor of the responsibility to design and/or construct these facilities in compliance with all current applicable federal, state, and local laws, rules, regulations, ordinances, development agreements, specifications, orders of approvals, all of which the City retains the right to enforce. Inconsistencies not noted by City staff shall not be construed as approved unless specifically addressed in writing by the City. Any proposed revision to these plans must be submitted for review and compliance with the Meridian City Standards and Specifications before said revision is constructed.

Name: Codee Krausch  
 Date: 11/02/2021  
 Permit Number: LD-CAP-2021-0003

**BENCHMARKS**

TBM #3 - 5/8" PIN  
 STA. 155+02.31, 27.40' RT  
 ELEV=2702.53  
 N=696539.34  
 E=2444409.84

\*\*REFER TO ACHD PROJECT #319038 PLANS AND SPECIFICATIONS FOR PROPOSED ROADWAY IMPROVEMENTS AND PROJECT HORIZONTAL AND VERTICAL CONTROL.

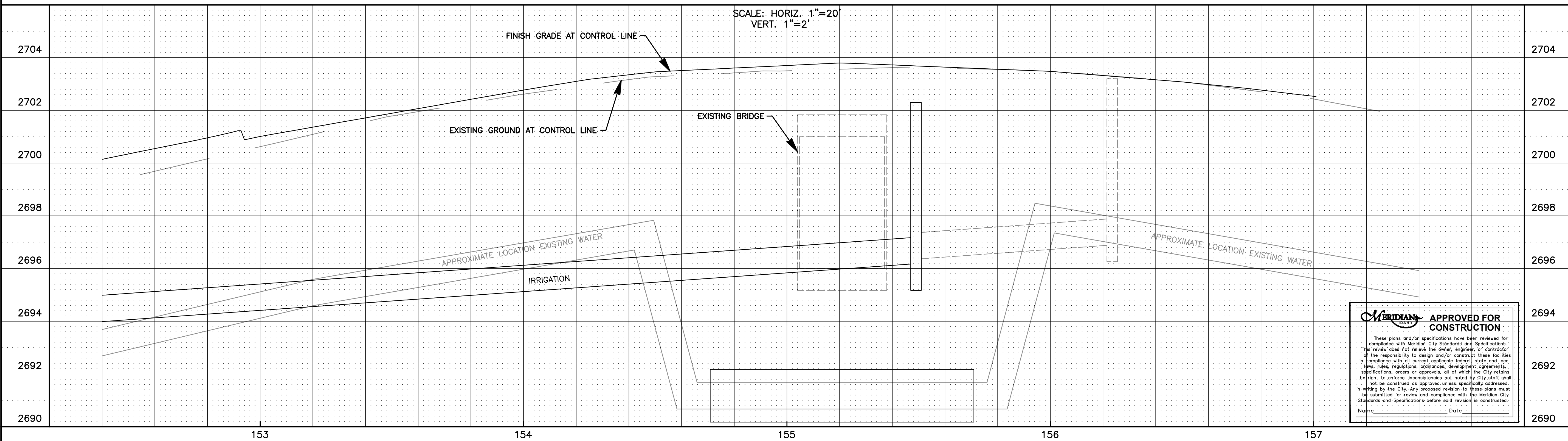
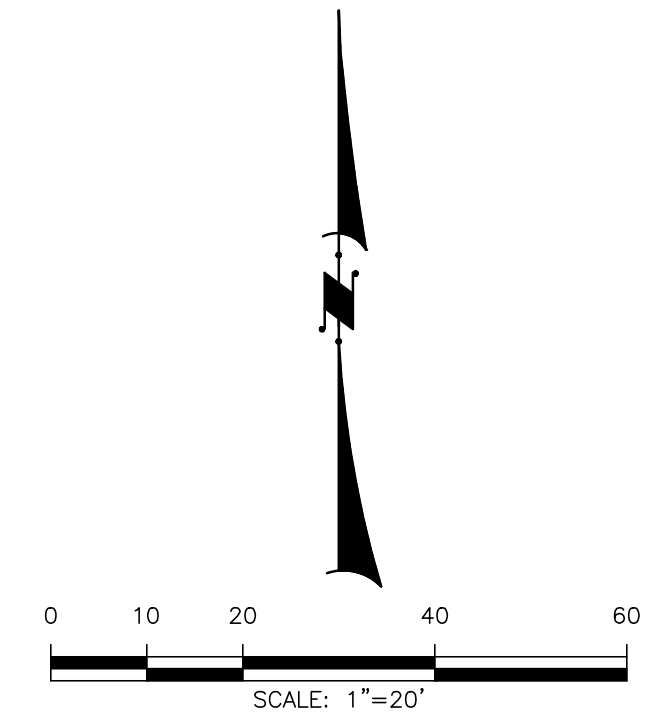

**APPROVED FOR CONSTRUCTION**

These plans and/or specifications have been reviewed for compliance with Meridian City Standards and Specifications. This review does not relieve the owner, engineer, or contractor of the responsibility to design and/or construct these facilities in compliance with all current applicable federal, state and local laws, rules, regulations, ordinances, development agreements, specifications, orders of approvals, all of which the City retains the right to enforce. Inconsistencies not noted by City staff shall not be construed as approved unless specifically addressed in writing by the City. Any proposed revision to these plans must be submitted for review and compliance with the Meridian City Standards and Specifications before said revision is constructed.

Name: \_\_\_\_\_ Date: \_\_\_\_\_

PROJECT NO.	DESIGNED	DRAWN	CHECKED	APPROVED
19044	CJP	CJP	CJP	CJP

**CIVIL SURVEY CONSULTANTS, INC.**  
 CONSULTING ENGINEERS AND LAND SURVEYORS

2893 S. MERIDIAN ROAD  
 MERIDIAN, IDAHO 83642  
 (208)868-4312

**CITY OF MERIDIAN**

**TEN MILE ROAD AND VICTORY ROAD**

**UTILITY IMPROVEMENTS**

DATE: AUGUST 2021  
 DRAWING: DESIGN (ROUNDABOUT)  
 JOB NO: 19044

**SHEET 5 OF 8**

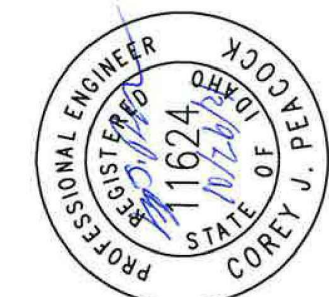

PROJECT NO.	DESIGNED	DRAWN	CHECKED	APPROVED
19044	CJP	CJP	CJP	CJP

**CIVIL SURVEY CONSULTANTS, INC.**  
CONSULTING ENGINEERS AND LAND SURVEYORS

**CITY OF MERIDIAN**  
**TEN MILE ROAD AND VICTORY ROAD**  
**UTILITY IMPROVEMENTS**

DATE: AUGUST 2021  
DRAWING: DESIGN(ROUNDABOUT)  
JOB NO: 19044  
**SHEET 6 OF 8**

\*\*INSTALL A T-TYPE CLEANOUT ON EACH PRESSURE SEWER LINE. CLEANOUT TO BE INSTALLED AFTER TESTING OF PRESSURE SEWER LINES IS COMPLETED. TRANSITION FROM HDPE MAIN TO PVC CLEANOUT, PROVIDE FLEX COUPLER, PVC PIPE AND ANY OTHER REQUIRED FITTINGS TO MAKE THE TRANSITION. THE CLEANOUTS ARE TO BE REMOVED IN THE FUTURE PRIOR TO EXTENDING THE DUAL PRESSURE SEWER MAIN SOUTH TO THE FUTURE LIFT STATION.

MATCH LINE (13+60) - SEE SHEET 7

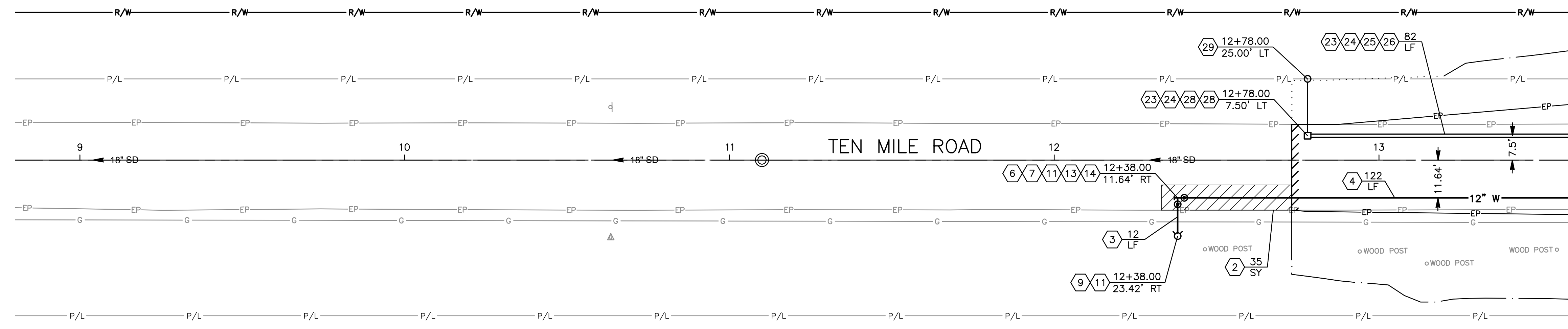

**NOTES**

- 2 TYPE P SURFACE RESTORATION, MATCH EXISTING SECTION, ITEM 307.4.1.G.1.
- 3 6" PVC, AWWA C900, DR18, WATER MAIN, ITEM 401.4.1.A.1.
- 4 12" PVC, AWWA C900, DR18, WATER MAIN, ITEM 401.4.1.A.1.
- 6 6" GATE VALVE, FLxMJ, ITEM 402.4.1.A.1.
- 7 12" GATE VALVE, FLxMJ, ITEM 402.4.1.A.1.
- 9 FIRE HYDRANT ASSEMBLY WITH LOCATE STATION, ITEM 403.4.1.A.1.
- 11 CONCRETE THRUST BLOCK, INCIDENTAL TO PROJECT.
- 13 12"x12"x6" DUCTILE IRON TEE, FLXFLXFL, INCIDENTAL TO PIPE ITEM.
- 14 12" DUCTILE IRON BLIND FLANGE, INCIDENTAL TO PIPE ITEM.
- 23 6" (IPS) HDPE, AWWA C906, PE4710, DR17, PRESSURE SEWER MAIN, ITEM 505.4.1.B.1.
- 24 10" (IPS) HDPE, AWWA C906, PE4710, DR17, PRESSURE SEWER MAIN, ITEM 505.4.1.B.1.
- 25 DUAL PRESSURE SEWER MAIN, PROVIDE 12" HORIZONTAL CLEARANCE BETWEEN PIPES.
- 26 CONFIRM EXISTING PRESSURE SEWER MAIN PIPE SIZE AND MATERIAL PRIOR TO ORDERING NEW PIPE. NEW PRESSURE SEWER MAIN PIPE TO MATCH EXISTING PIPE.
- 28 8" T-TYPE CLEANOUT PER MERIDIAN SD-S1, ITEM 503.4.1.A.1.
- 29 LOCATE STATION PER MERIDIAN SD-G5, ITEM 401.4.1.C.1.

**APPROVED FOR CONSTRUCTION**

These plans and/or specifications have been reviewed for compliance with Meridian City Standards and Specifications. This review does not relieve the owner, engineer, or contractor of the responsibility to design and/or construct those facilities in compliance with all current applicable federal, state, and local laws, rules, regulations, ordinances, development agreements, specifications, orders of approvals, all of which the City retains the right to enforce. Inconsistencies not noted by City staff shall not be construed as approved unless specifically addressed in writing by the City. Any proposed revision to these plans must be submitted for review and compliance with the Meridian City Standards and Specifications before said revision is constructed.

Name: Cadee Krausch  
Date: 11/02/2021  
Permit Number: LD-CAP-2021-0003

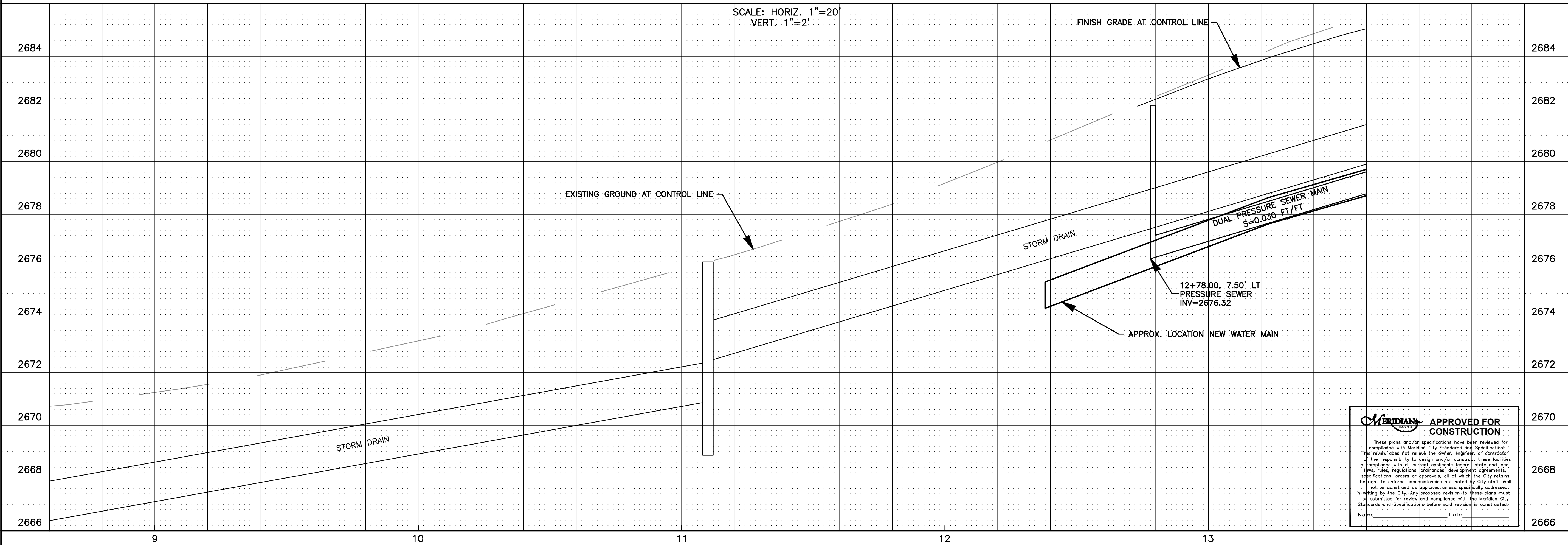
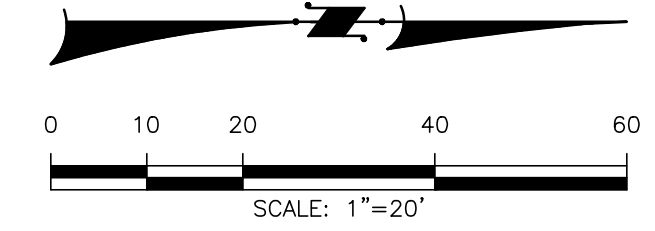

**APPROVED FOR CONSTRUCTION**

These plans and/or specifications have been reviewed for compliance with Meridian City Standards and Specifications. This review does not relieve the owner, engineer, or contractor of the responsibility to design and/or construct these facilities in compliance with all current applicable federal, state and local laws, rules, regulations, ordinances, development agreements, specifications, orders of approvals, all of which the City retains the right to enforce. Inconsistencies not noted by City staff shall not be construed as approved unless specifically addressed in writing by the City. Any proposed revision to these plans must be submitted for review and compliance with the Meridian City Standards and Specifications before said revision is constructed.

Name: \_\_\_\_\_ Date: \_\_\_\_\_

MATCH LINE (13+60) - SEE SHEET 6

MATCH LINE (18+40) - SEE SHEET 8

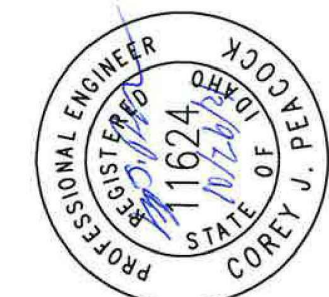

PROJECT NO.	DESIGNED	DRAWN	CHECKED	APPROVED
19044	CJP	CJP	CJP	CJP

**CIVIL SURVEY CONSULTANTS, INC.**  
CONSULTING ENGINEERS AND LAND SURVEYORS

**CITY OF MERIDIAN**  
**TEN MILE ROAD AND VICTORY ROAD**  
**UTILITY IMPROVEMENTS**

DATE: AUGUST 2021  
DRAWING: DESIGN (ROUNDABOUT)  
JOB NO: 19044

SHEET 7 OF 8

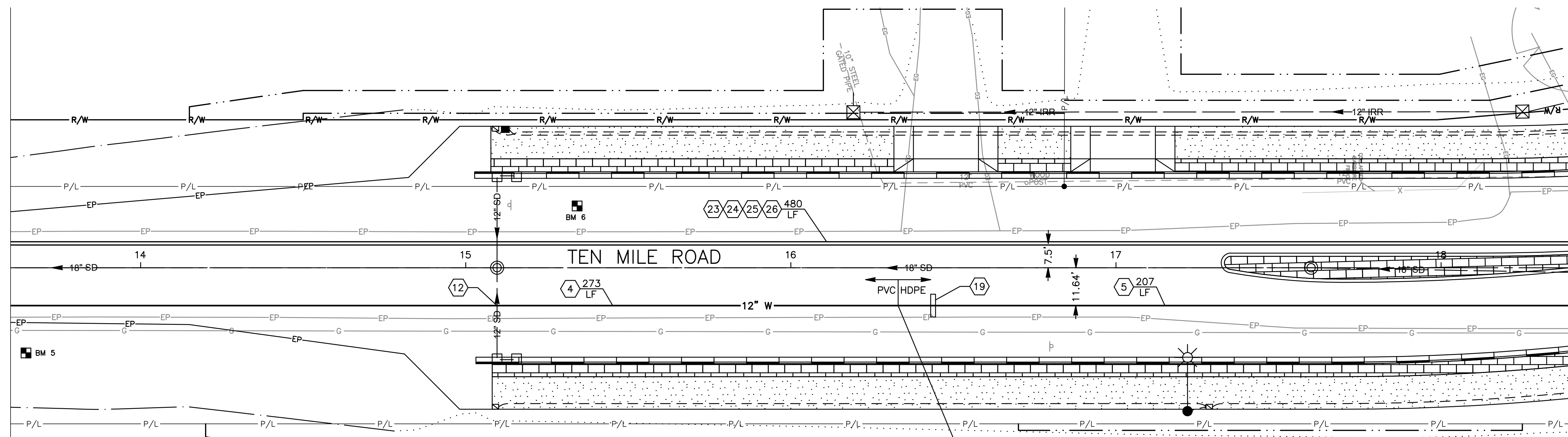

**NOTES**

- 4 12" PVC, AWWA C900, DR18, WATER MAIN, ITEM 401.4.1.A.1.
- 5 16" (IPS) HDPE, AWWA C906, PE4710, DR7, WATER MAIN, ITEM 401.4.1.A.1.
- 11 CONCRETE THRUST BLOCK, INCIDENTAL TO PROJECT.
- 12 NON-POTABLE PIPE CROSSING, SEE WATER NOTES ON SHEET 2.
- 16 16"x12" DUCTILE IRON REDUCER, FLXJM, INCIDENTAL TO PIPE ITEM.
- 17 16" (IPS) HDPE, AWWA C906, PE4710, DR7, FLANGE ADAPTER, INCIDENTAL TO PIPE ITEM.
- 19 HDPE PIPE CONCRETE ANCHOR, 60" WIDE X 60" HIGH X 18" THICK, SEE DETAIL ON SHEET 2, INCIDENTAL TO PIPE ITEM.
- 23 6" (IPS) HDPE, AWWA C906, PE4710, DR17, PRESSURE SEWER MAIN, ITEM 505.4.1.B.1.
- 24 10" (IPS) HDPE, AWWA C906, PE4710, DR17, PRESSURE SEWER MAIN, ITEM 505.4.1.B.1.
- 25 DUAL PRESSURE SEWER MAIN, PROVIDE 12" HORIZONTAL CLEARANCE BETWEEN PIPES.
- 26 CONFIRM EXISTING PRESSURE SEWER MAIN PIPE SIZE AND MATERIAL PRIOR TO ORDERING NEW PIPE. NEW PRESSURE SEWER MAIN PIPE TO MATCH EXISTING PIPE.

**APPROVED FOR CONSTRUCTION**

These plans and/or specifications have been reviewed for compliance with Meridian City Standards and Specifications. This review does not relieve the owner, engineer, or contractor of the responsibility to design and/or construct those facilities in compliance with all current applicable federal, state, and local laws, rules, regulations, ordinances, development agreements, specifications, orders of approvals, all of which the City retains the right to enforce. Inconsistencies not noted by City staff shall not be construed as approved unless specifically addressed in writing by the City. Any proposed revision to these plans must be submitted for review and compliance with the Meridian City Standards and Specifications before said revision is constructed.

Name: Cody Krauch  
Date: 11/02/2021  
Permit Number: LD-CAP-2021-0003

**BENCHMARKS**

TBM #5 - 5/8" PIN STA. 13+64.75, 26.21' RT ELEV=2685.49 N=695938.91 E=2443929.39
TBM #6 - 5/8" PIN STA. 15+34.27, 19.01' LT ELEV=2689.27 N=696108.78 E=2443885.46

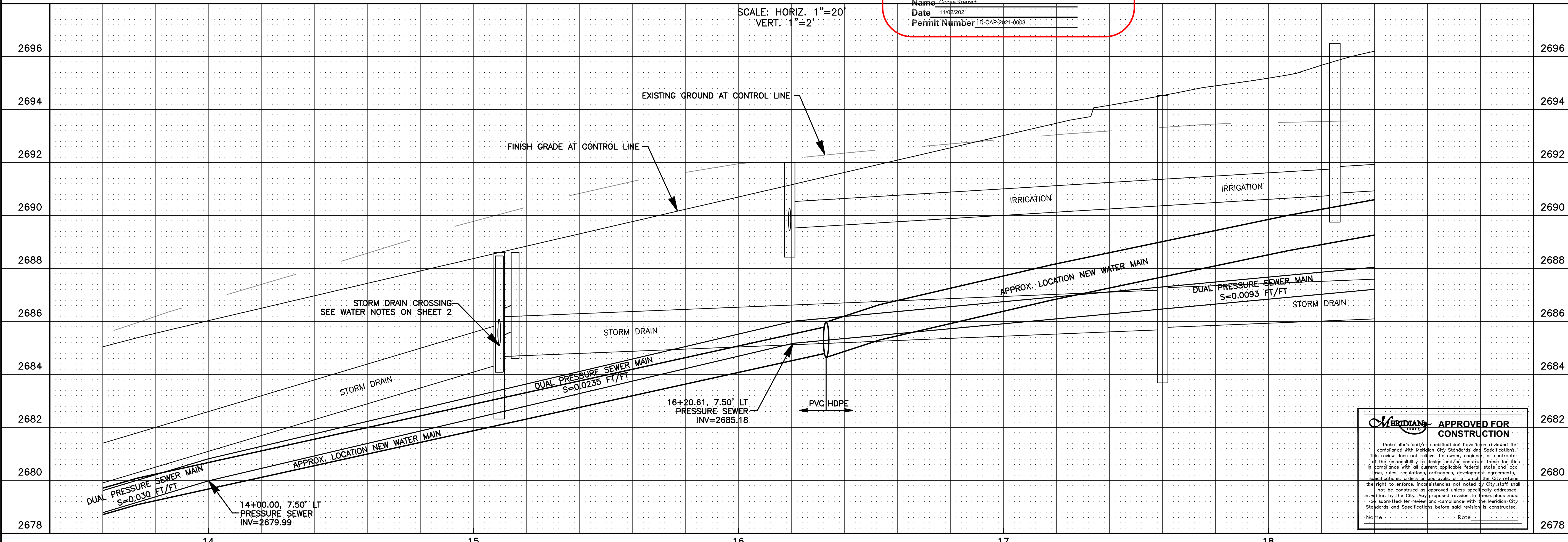
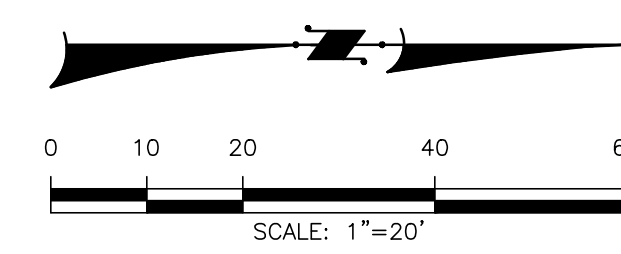

**APPROVED FOR CONSTRUCTION**

These plans and/or specifications have been reviewed for compliance with Meridian City Standards and Specifications. This review does not relieve the owner, engineer, or contractor of the responsibility to design and/or construct these facilities in compliance with all current applicable federal, state and local laws, rules, regulations, ordinances, development agreements, specifications, orders of approvals, all of which the City retains the right to enforce. Inconsistencies not noted by City staff shall not be construed as approved unless specifically addressed in writing by the City. Any proposed revision to these plans must be submitted for review and compliance with the Meridian City Standards and Specifications before said revision is constructed.

Name: \_\_\_\_\_ Date: \_\_\_\_\_

NOTE: THE ACTUAL LOCATION OF THE END OF THE EXISTING DUAL PRESSURE SEWER MAIN IS UNKNOWN. COORDINATE EXPLORATORY EXCAVATION WITH THE CITY TO LOCATE THE END OF THE LINE AND TO DETERMINE IF MORE OR LESS PRESSURE SEWER MAIN PIPE WILL BE NECESSARY. CONFIRM THIS PRIOR TO ORDERING PRESSURE SEWER MAIN PIPE.

MATCH LINE (18+40) - SEE SHEET 7

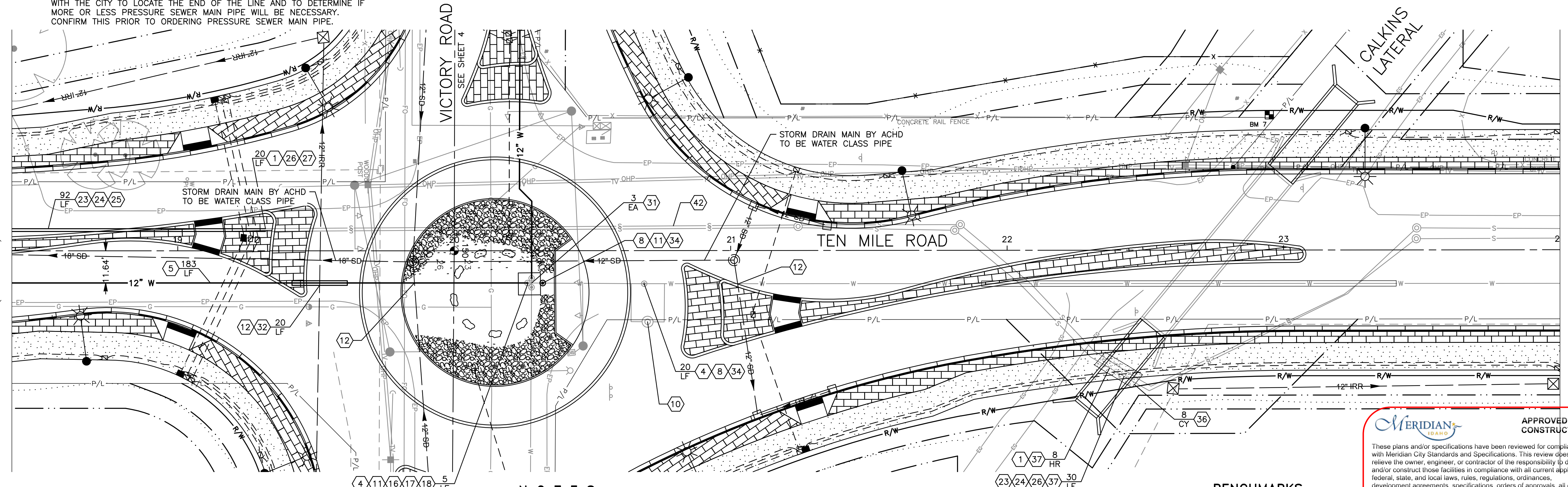

MATCH LINE (24+00) - SEE ROADWAY PROJECT

**NOTES**

- 1 EXPLORATORY EXCAVATION, ITEM 303.4.1.A.3.
- 4 12" PVC, AWWA C900, DR18, WATER MAIN, ITEM 401.4.1.A.1.
- 5 16" (IPS) HDPE, AWWA C906, PE4710, DR7, WATER MAIN, ITEM 401.4.1.A.1.
- 8 RELOCATE EXISTING 12" GATE VALVE, MJX MJ, ITEM 402.4.1.A.1.
- 10 EXISTING LEAK DETECTION STATION TO BE RELOCATED AS PART OF MERIDIAN'S CONSTRUCTION PLANS FOR THE ACHD TEN MILE ROAD (VICTORY TO OVERLAND) PROJECT. REPLACE EXISTING WATER MAIN AS NEEDED TO ELIMINATE EXISTING SERVICE TAPS.
- 11 CONCRETE THRUST BLOCK, INCIDENTAL TO PROJECT.
- 12 NON-POTABLE PIPE CROSSING, SEE WATER NOTES ON SHEET 2.
- 16 16"x12" DUCTILE IRON REDUCER, FLX MJ, INCIDENTAL TO PIPE ITEM.
- 17 16" (IPS) HDPE, AWWA C906, PE4710, DR7, FLANGE ADAPTER, INCIDENTAL TO PIPE ITEM.
- 18 CONNECT TO EXISTING 12" MJ GATE VALVE, INCIDENTAL TO PIPE ITEM.
- 23 6" (IPS) HDPE, AWWA C906, PE4710, DR17, PRESSURE SEWER MAIN, ITEM 505.4.1.B.1.
- 24 10" (IPS) HDPE, AWWA C906, PE4710, DR17, PRESSURE SEWER MAIN, ITEM 505.4.1.B.1.
- 25 DUAL PRESSURE SEWER MAIN, PROVIDE 12" HORIZONTAL CLEARANCE BETWEEN PIPES.
- 26 CONFIRM EXISTING PRESSURE SEWER MAIN PIPE SIZE AND MATERIAL PRIOR TO ORDERING NEW PIPE. NEW PRESSURE SEWER MAIN PIPE TO MATCH EXISTING PIPE.
- 27 CONNECT TO EXISTING DUAL PRESSURE SEWER MAIN, INCIDENTAL TO PIPE ITEM.
- 31 ADJUST EXISTING VALVE BOX TO GRADE, ITEM 2030.4.1.C.1.
- 32 20"Ø, 3/8" THICK STEEL CASING PIPE, PER MERIDIAN SD-SW1, SD-SW2, AND DETAIL ON SHEET 2, ITEM 310.4.1.A.1.
- 34 CONNECT TO EXISTING 12" PVC WATER MAIN, INCIDENTAL TO PROJECT.
- 36 CULVERT CROSSING CDF (FLOWABLE) BACKFILL, ITEM 306.4.1.G.1.
- 37 CONFIRM LOCATION AND DEPTH OF EXISTING DUAL PRESSURE SEWER MAINS. IF 12" OR GREATER OF VERTICAL CLEARANCE WILL EXIST BETWEEN MAINS AND NEW BOX CULVERT THEN LEAVE MAINS IN PLACE. IF LESS THAN 12" OF VERTICAL CLEARANCE WILL EXIST BETWEEN MAINS AND NEW BOX CULVERT THEN LOWER PRESSURE SEWER MAINS TO PROVIDE A MINIMUM OF 24" OF VERTICAL CLEARANCE BETWEEN MAINS AND BOTTOM OF BOX CULVERT.
- 42 LOW PRESSURE AIR TEST EXISTING DUAL PRESSURE SEWER MAIN PER ISPCW SECTION 501.3.4.C. PRIOR TO INSTALLING NEW PRESSURE SEWER MAIN, ITEM 505.4.1.D.1.

**BENCHMARKS**

- TBM #7 - 5/8" PIN  
STA. 22+94.88, 48.93' LT  
ELEV=2697.27  
N=696869.54  
E=2443861.02
- TBM #8 - 5/8" PIN  
STA. 25+28.91, 19.68' RT  
ELEV=2698.39  
N=697103.11  
E=2443931.17

\*\*REFER TO ACHD PROJECT #319038 PLANS AND SPECIFICATIONS FOR PROPOSED ROADWAY IMPROVEMENTS AND PROJECT HORIZONTAL AND VERTICAL CONTROL.

**APPROVED FOR CONSTRUCTION**

These plans and/or specifications have been reviewed for compliance with Meridian City Standards and Specifications. This review does not relieve the owner, engineer, or contractor of the responsibility to design and/or construct those facilities in compliance with all current applicable federal, state, and local laws, rules, regulations, ordinances, development agreements, specifications, orders of approvals, all of which the City retains the right to enforce. Inconsistencies not noted by City staff shall not be construed as approved unless specifically addressed in writing by the City. Any proposed revision to these plans must be submitted for review and compliance with the Meridian City Standards and Specifications before said revision is constructed.

Name: Code: Krausch  
Date: 11/02/2021  
Permit Number: LD-CAP-2021-0003

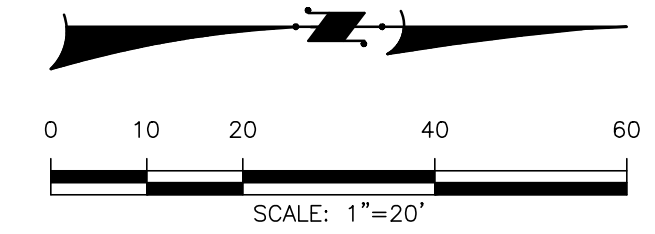

SCALE: HORIZ. 1"=20'  
VERT. 1"=2'

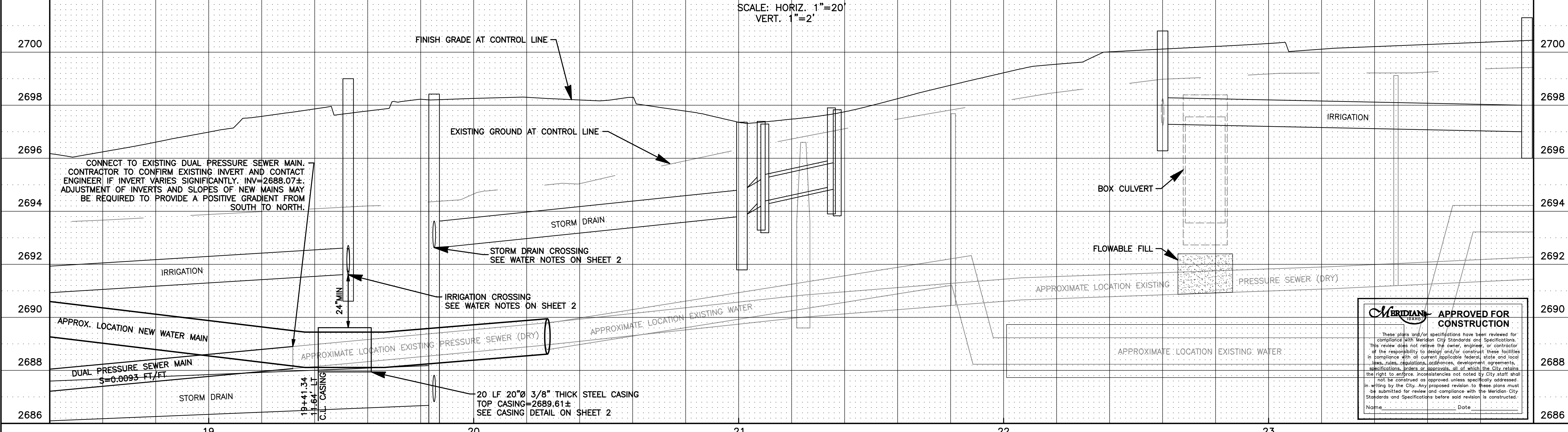

**APPROVED FOR CONSTRUCTION**

These plans and/or specifications have been reviewed for compliance with Meridian City Standards and Specifications. This review does not relieve the owner, engineer, or contractor of the responsibility to design and/or construct those facilities in compliance with all current applicable federal, state, and local laws, rules, regulations, ordinances, development agreements, specifications, orders of approvals, all of which the City retains the right to enforce. Inconsistencies not noted by City staff shall not be construed as approved unless specifically addressed in writing by the City. Any proposed revision to these plans must be submitted for review and compliance with the Meridian City Standards and Specifications before said revision is constructed.

Name: \_\_\_\_\_ Date: \_\_\_\_\_

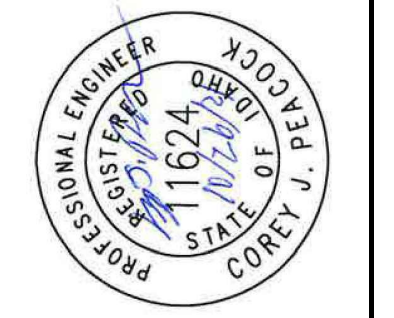

PROJECT NO.	DESIGNED	DRAWN	CHECKED	APPROVED
19044	CJP	CJP	CJP	CJP

**CIVIL SURVEY CONSULTANTS, INC.**  
CONSULTING ENGINEERS AND LAND SURVEYORS

2893 S. MERIDIAN ROAD  
MERIDIAN, IDAHO 83642  
(208)868-4312

**CITY OF MERIDIAN**  
**TEN MILE ROAD AND VICTORY ROAD**  
**UTILITY IMPROVEMENTS**