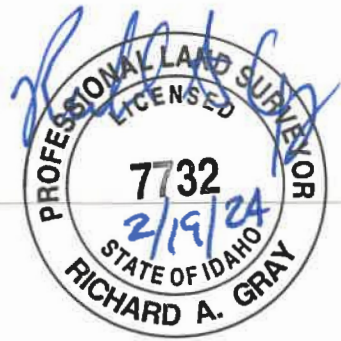

EXHIBIT A



Client: Kimley Horn
Date: February 15, 2024
Job No.: 9519

ANNEXATION PROPERTY DESCRIPTION

A parcel of land being the W 1/2 NE 1/4 and a portion of the SE 1/4 NE 1/4 and a portion of the NE 1/4 NE 1/4 and all of Lots 1, 2 and 3 of Basslin Ridge Estates as on file in Book 64 of Plats at Page 6469 in the Office of the Recorder of Ada County, Idaho, all located in Section 26, Township 3 North, Range 1 West, Boise Meridian, Ada County Idaho, more particularly described as follows:

BEGINNING at a found Brass Cap marking the NW corner of said NE 1/4, (North 1/4 corner), from which a found Aluminum cap stamped "PLS 17665" marking the NE corner of said NE 1/4, (Section corner common to Sections 23, 24, 25 and 26) bears S. 89° 06' 38" E., a distance of 2655.71 feet;

Thence along the Northerly boundary of said W 1/2 NE 1/4, S. 89° 06' 38" E., a distance of 1328.23 feet to the NE corner of said W 1/2 NE 1/4, (East 1/16 corner common to sections 23 and 26);

Thence along the Easterly boundary of said W 1/2 NE 1/4, S. 00° 33' 37" W., a distance of 1326.54 feet to a found 5/8-inch diameter iron pin with illegible cap marking the Northwest corner of said Basslin Ridge Estates;

Thence along the Northerly boundary of said Basslin Ridge Estates, S. 89° 08' 36" E., a distance of 798.19 feet;

Thence leaving the Northerly boundary of said Basslin Ridge Estates, N. 00° 37' 19" E., a distance of 165.10 feet;

Thence S. 89° 03' 39" E., a distance of 527.88 feet to the east boundary of said NE 1/4 NE 1/4;

Thence along the east boundary of said NE 1/4 NE 1/4, S. 00° 37' 17" W., a distance of 164.34 feet to the NE corner of said SE 1/4 NE 1/4, (North 1/16 corner common to sections 25 and 26);

Thence along the Easterly boundary line of said SE 1/4 NE 1/4, S. 00° 37' 17" W., a distance of 1325.84 feet to the SE corner of said SE 1/4 NE 1/4, (East 1/4 corner);

Thence along the Southerly boundary of said SE 1/4 NE 1/4, N. 89° 11' 36" W., a distance of 1325.93 feet to the Southeast corner of said of said SE 1/4 NE 1/4, (Center east 1/16 corner);

Thence along the Southerly boundary of the W 1/2 NE 1/4, N. 89° 10' 56" W., a distance of 1326.91 feet to a found 5/8-inch diameter iron pin with cap stamped "PLS 6901" marking the Southwest corner of said W 1/2 NE 1/4, (Center 1/4 corner);

Thence along the Westerly boundary of said W 1/2 NE 1/4, N. 00° 33' 35" E., a distance of 2655.21 feet to the POINT OF BEGINNING.

This parcel contains 123.28 acres more or less.



Client: Kimley Horn
Job No.: 9519
Rev. Date: February 16, 2024
Re: Jackson Ridge Estates

REZONE R-4 HOLDING AREA
PROPERTY DESCRIPTION

A parcel of land being a portion of the S 1/2 NE 1/4, located in Section 26, Township 3 North, Range 1 West, Boise Meridian, Ada County Idaho, more particularly described as follows:

Commencing at a found Brass Cap marking the NW corner of said NE 1/4, (North 1/4 corner), from which a found Aluminum cap stamped "PLS 17665" marking the NE corner of said NE 1/4, (Section corner common to Sections 23, 24, 25 and 26) bears S. 89° 06' 38" E., a distance of 2655.71 feet;

Thence along the Westerly boundary of said NE 1/4, S. 00° 33' 35" W., a distance of 1794.43 feet;

Thence leaving said Westerly boundary line, S. 89° 26' 25" E., a distance of 155.00 feet;

Thence S. 0° 33' 35" W., a distance of 76.67 feet;

Thence S. 89° 26' 25" E., a distance of 30.00 feet to the POINT OF BEGINNING;

Thence continuing S. 89° 26' 25" E., a distance of 136.95 feet;

Thence a distance of 3.01 feet along the arc of said curve right, having a radius of 4.50 feet, a central angle of 38° 21' 38", the long chord of which bears N. 71° 22' 46" E., a distance of 2.96 feet;

Thence a distance of 119.79 feet along the arc of said curve right, having a radius of 68.50 feet, a central angle of 100° 12' 00", the long chord of which bears S. 77° 42' 03" E., a distance of 105.10 feet;

Thence N. 62° 23' 57" E., a distance of 10.00 feet;

Thence S. 89° 26' 25" E., a distance of 112.67 feet;

Thence S. 83° 35' 26" E., a distance of 100.00 feet;

Thence a distance of 79.16 feet along the arc of said curve right, having a radius of 694.00 feet, a central angle of 06° 32' 08", the long chord of which bears S. 03° 08' 30" W., a distance of 79.12 feet;

Thence S. 77° 50' 01" E., a distance of 350.90 feet;

Thence a distance of 1.82 feet along the arc of said curve right, having a radius of 3.00 feet, a central angle of 34° 48' 07", the long chord of which bears S. 60° 25' 58" E., a distance of 1.79 feet;

Thence S. 43° 01' 54" E., a distance of 779.48 feet;

Thence S. $00^{\circ} 48' 24''$ W., a distance of 50.00 feet to a point on the Southerly boundary line of the SE1/4 NE1/4 of said Section 26;

Thence along said Southerly boundary line, N. $89^{\circ} 11' 36''$ W., a distance of 200.69 feet, to the Center East 1/16 Corner of said Section 26;

Thence leaving said Center East 1/16 Corner and along the Southerly Boundary of the SW1/4 NE 1/4 of said Section 26, N. $89^{\circ} 10' 56''$ W., a distance of 974.20 feet to the beginning of a curve right;

Thence leaving the Southerly Boundary of the SW1/4 NE 1/4 of said Section 26, a distance of 139.36 feet along the arc of said curve right, having a radius of 250.00 feet, a central angle of $31^{\circ} 56' 21''$, the long chord of which bears N. $73^{\circ} 12' 45''$ W., a distance of 137.56 feet to the beginning of a reverse curve left;

Thence a distance of 65.99 feet along the arc of said curve left, having a radius of 250.00 feet, a central angle of $15^{\circ} 07' 28''$, the long chord of which bears N. $64^{\circ} 48' 19''$ W., a distance of 65.80 feet;

Thence non tangent to said curve, N. $11^{\circ} 11' 16''$ E., a distance of 112.50 feet to the beginning of a curve left;

Thence a distance of 37.10 feet along the arc of said curve left, having a radius of 200.00 feet, a central angle of $10^{\circ} 37' 41''$, the long chord of which bears N. $05^{\circ} 52' 26''$ E., a distance of 37.05 feet;

Thence N. $0^{\circ} 33' 35''$ E., a distance of 572.36 feet to the POINT OF BEGINNING.

This parcel contains 17.41 acres more or less.





Client: Kimley Horn
Job No.: 9519
Date: February 16, 2024
Re: Jackson Ridge Estates

REZONE R-4 PART 2
PROPERTY DESCRIPTION

A parcel of land being a portion of the NE 1/4 and a portion of Lot 1, 2 and 3 of Basslin Ridge Estates as on file in Book 64 of Plats at Page 6469 in the Office of the Recorder of Ada County, Idaho, all located in Section 26, Township 3 North, Range 1 West, Boise Meridian, Ada County Idaho, more particularly described as follows:

Commencing at a found Brass Cap marking the NW corner of said NE 1/4, (North 1/4 corner), from which a found Aluminum cap stamped "PLS 17665" marking the NE corner of said NE 1/4, (Section corner common to Sections 23, 24, 25 and 26) bears S. 89° 06' 38" E., a distance of 2655.71 feet;

Thence along the Northerly boundary of said NW 1/4 NE 1/4, S. 89° 06' 38" E., a distance of 1328.23 feet to the NE corner of said NW 1/4 NE 1/4, (East 1/16 corner common to Sections 23 and 26);

Thence along the Easterly boundary of said NW 1/4 NE 1/4, S. 00° 33' 37" W., a distance of 1326.54 feet to a found 5/8 inch diameter iron pin with illegible cap marking the Northwest corner of said Basslin Ridge Estates;

Thence along the Northerly boundary of said Basslin Ridge Estates, S. 89° 08' 36" E., a distance of 70.00 feet to the POINT OF BEGINNING;

Thence Continuing along the Northerly boundary of said Basslin Ridge Estates, S. 89° 08' 36" E., a distance of 728.19 feet;

Thence leaving said Northerly boundary of said Basslin Ridge Estates, N. 00° 37' 19" E., a distance of 165.10 feet;

Thence S. 89° 03' 39" E., a distance of 527.88 feet to a point on the Easterly line of the E1/2 NE1/4 of said Section 26 (Common line to sections 25 and 26);

Thence along the Easterly boundary line of said E 1/2 NE 1/4, S. 00° 37' 17" W., a distance of 1490.18 feet to the SE corner of said SE 1/4 NE 1/4, (East 1/4 corner);

Thence along the Southerly boundary of said SE 1/4 NE 1/4, N. 89° 11' 36" W., a distance of 1125.24 feet;

Thence leaving said Southerly boundary line N. 00° 48' 24" E., a distance of 50.00 feet;

Thence N. 43° 01' 54" W., a distance of 3.59 feet;

Thence N. 46° 58' 06" E., a distance of 166.00 feet;

Thence S. $43^{\circ} 01' 54''$ E., a distance of 29.90 feet to the beginning of a tangent curve right;

Thence a distance of 57.78 feet along the arc of said curve right, having a radius of 150.00 feet, a central angle of $22^{\circ} 04' 14''$, the long chord of which bears S. $31^{\circ} 59' 47''$ E., a distance of 57.42 feet;

Thence N. $69^{\circ} 02' 20''$ E., a distance of 30.00 feet;

Thence N. $65^{\circ} 34' 19''$ E., a distance of 156.36 feet;

Thence N. $63^{\circ} 40' 01''$ E., a distance of 57.42 feet;

Thence N. $46^{\circ} 58' 06''$ E., a distance of 122.00 feet;

Thence N. $41^{\circ} 18' 40''$ E., a distance of 60.29 feet;

Thence S. $89^{\circ} 07' 53''$ E., a distance of 230.00 feet;

Thence N. $00^{\circ} 52' 07''$ E., a distance of 155.00 feet;

Thence N. $89^{\circ} 07' 53''$ W., a distance of 272.61 feet to the beginning of a tangent curve to the left;

Thence a distance of 76.62 feet along the arc of said curve left, having a radius of 100.00 feet, a central angle of $43^{\circ} 54' 01''$, the long chord of which bears S. $68^{\circ} 55' 06''$ W., a distance of 74.76 feet;

Thence, S. $46^{\circ} 58' 06''$ w., a distance of 37.44 feet;

Thence N. $43^{\circ} 01' 54''$ W., a distance of 698.49 feet to the beginning of a tangent curve to the right;

Thence a distance of 142.21 feet along the arc of said curve right, having a radius of 750.00 feet, a central angle of $10^{\circ} 48' 53''$, the long chord of which bears N. $37^{\circ} 35' 59''$ W., a distance of 142.00 feet;

Thence N. $32^{\circ} 10' 04''$ W., a distance of 101.09 feet to the beginning of a tangent curve to the left;

Thence a distance of 3.79 feet along the arc of said curve left, having a radius of 750.00 feet, a central angle of $00^{\circ} 17' 24''$, the long chord of which bears N. $32^{\circ} 18' 46''$ W., a distance of 3.79 feet;

Thence N. $57^{\circ} 49' 56''$ E., a distance of 54.42 feet to the beginning of a tangent curve to the right;

Thence a distance of 74.45 feet along the arc of said curve right, having a radius of 130.00 feet, a central angle of $32^{\circ} 48' 53''$, the long chord of which bears N. $74^{\circ} 14' 23''$ E., a distance of 73.44 feet;

Thence N. $00^{\circ} 51' 24''$ E., a distance of 140.00 feet to the POINT OF BEGINNING.

This parcel contains 32.03 acres more or less.





Client: Kimley Horn
Job No.: 9519
Date: February 16, 2024
Re: Jackson Ridge Estates

REZONE R-4
PROPERTY DESCRIPTION

A parcel of land being a portion of the W 1/2 NE 1/4, Section 26, Township 3 North, Range 1 West, Boise Meridian, Ada County Idaho, more particularly described as follows:

Commencing at a found Brass Cap marking the NW corner of said NE 1/4, (North 1/4 corner), from which a found Aluminum cap stamped "PLS 17665" marking the NE corner of said NE 1/4, (Section corner common to Sections 23, 24, 25 and 26) bears S. 89° 06' 38" E., a distance of 2655.71 feet;

Thence along the Northerly boundary of said W 1/2 NE 1/4 , S. 89° 06' 38" E., a distance of 116.02 feet to the POINT OF BEGINNING;

Thence continuing along the Northerly boundary of said W 1/2 NE 1/4 , S. 89° 06' 38" E., a distance of 1212.21 feet to the NE corner of said W 1/2 NE 1/4, (East 1/16 corner common to Sections 23 and 26);

Thence along the Easterly boundary of said W 1/2 NE 1/4, S. 00° 33' 37" W., a distance of 1323.58 feet;

Thence leaving said Easterly boundary N. 42° 06' 23" W., a distance of 209.48 feet;

Thence N. 53° 16' 20" W., a distance of 50.43 feet to the beginning of a non-tangent curve right;

Thence a distance of 282.75 feet along the arc of said curve right, having a radius of 756.00 feet, a central angle of 21° 25' 45", the long chord of which bears S. 47° 26' 33" W., a distance of 281.10 feet to a point on a compound curve left;

Thence a distance of 671.95 feet along the arc of said curve left, having a radius of 744.00 feet, a central angle of 51° 44' 51", the long chord of which bears S. 32° 17' 00" W., a distance of 649.35 feet;

Thence N. 83° 35' 26" W., a distance of 50.00 feet;

Thence N. 89° 26' 25" W., a distance of 112.67 feet;

Thence, S. 62° 23' 57" W., a distance of 10.00 feet to the beginning of a non-tangent curve left;

Thence a distance of 119.79 feet along the arc of said curve left, having a radius of 68.50 feet, a central angle of 100° 12' 00", the long chord of which bears N. 77° 42' 03" W., a distance of 105.10 feet to a point on a compound curve right;

Thence a distance of 3.01 feet along the arc of said curve right, having a radius of 4.50 feet, a central angle of $38^{\circ} 21' 38''$, the long chord of which bears S. $71^{\circ} 22' 46''$ W., a distance of 2.96 feet;

Thence N. $89^{\circ} 26' 25''$ W., a distance of 166.95 feet;

Thence N. $00^{\circ} 33' 35''$ E., a distance of 161.98 feet to the beginning of a tangent curve right;

Thence a distance of 187.58 feet along the arc of said curve right, having a radius of 130.00 feet, a central angle of $82^{\circ} 40' 31''$, the long chord of which bears N. $41^{\circ} 53' 51''$ E., a distance of 171.73 feet;

Thence N. $06^{\circ} 45' 54''$ W., a distance of 254.12 feet;

Thence N. $23^{\circ} 41' 08''$ E., a distance of 55.03 feet;

Thence N. $22^{\circ} 05' 29''$ E., a distance of 177.00 feet to the beginning of a non-tangent curve left;

Thence from a tangent which bears N $67^{\circ} 54' 31''$ W, along curve to the left with a radius of 456.00 feet, and having a central angle of $01^{\circ} 13' 12''$ an arc length of 9.71 feet with a chord bearing of N $68^{\circ} 31' 07''$ W, and a chord distance of 9.71 feet to the beginning of a reverse curve right;

Thence a distance of 246.91 feet along the arc of said reverse curve right, having a radius of 203.00 feet, a central angle of $69^{\circ} 41' 18''$, the long chord of which bears N. $34^{\circ} 17' 04''$ W., a distance of 231.97 feet;

Thence N. $00^{\circ} 33' 35''$ E., a distance of 709.53 feet;

Thence N. $23^{\circ} 43' 26''$ W., a distance of 158.91 feet;

Thence N. $00^{\circ} 53' 22''$ E., a distance of 64.00 feet to the POINT OF BEGINNING.

This parcel contains 40.11 acres more or less.





Client: Kimley Horn
Date: January 24, 2024
Job No.: 9519
Re: Jackson Ridge Estates

REZONE R2
PROPERTY DESCRIPTION

A parcel of land being a portion of the W 1/2 NE 1/4, Section 26, Township 3 North, Range 1 West, Boise Meridian, Ada County Idaho, more particularly described as follows:

BEGINNING at a found Brass Cap marking the NW corner of said NE 1/4, (North 1/4 corner), from which a found Aluminum cap stamped "PLS 17665" marking the NE corner of said NE 1/4, (Section corner common to Sections 23, 24, 25 and 26) bears S. 89° 06' 38" E., a distance of 2655.71 feet;

Thence along the Northerly boundary of said W 1/2 NE 1/4, S. 89° 06' 38" E., a distance of 116.02 feet;

Thence leaving said Northerly boundary, S. 00° 53' 22" W., a distance of 64.00 feet;

Thence S. 23° 43' 26" E., a distance of 158.91 feet;

Thence S. 00° 33' 35" W., a distance of 709.53 feet to the beginning of a tangent curve left;

Thence a distance of 246.91 feet along the arc of said curve left, having a radius of 203.00 feet, a central angle of 69° 41' 18", the long chord of which bears S. 34° 17' 04" E., a distance of 231.97 feet to a point on a reverse curve to the right;

Thence along said reverse curve to the right, with a radius of 456.00 feet and a central angle of 01° 13' 12", an arc length of 9.71 feet with a chord bearing of S 68° 31' 07" E and a chord distance of 9.71 feet;

Thence S. 22° 05' 29" W., a distance of 177.00 feet;

Thence S. 23° 41' 08" W., a distance of 55.03 feet;

Thence S. 06° 45' 54" E., a distance of 254.12 feet to the beginning of a non tangent curve left;

Thence a distance of 187.58 feet along the arc of said curve left, having a radius of 130.00 feet, a central angle of 82° 40' 31", the long chord of which bears S. 41° 53' 51" W., a distance of 171.73 feet;

Thence S. 00° 33' 35" W., a distance of 85.31 feet;

Thence N. 89° 26' 25" W., a distance of 155.00 feet to the Westerly boundary of said W 1/2 NE 1/4;

Thence along the Westerly boundary of said W 1/2 NE 1/4, N. 00° 33' 35" E., a distance of 1794.43 feet to the POINT OF BEGINNING.

This parcel contains 8.27 acres more or less.





Client: Kimley Horn
Job No.: 9519

Date: January 24, 2024
Re: Jackson Ridge Estates

REZONE R-2 HOLDING AREA
PROPERTY DESCRIPTION

A parcel of land being a portion of the SW 1/4 NE 1/4, located in Section 26, Township 3 North, Range 1 West, Boise Meridian, Ada County Idaho, more particularly described as follows:

Commencing at a found Brass Cap marking the NW corner of said NE 1/4, (North 1/4 corner), from which a found Aluminum cap stamped "PLS 17665" marking the NE corner of said NE 1/4, (Section corner common to Sections 23, 24, 25 and 26) bears S. 89° 06' 38" E., a distance of 2655.71 feet;

Thence along the Westerly boundary of said NE 1/4, S. 00° 33' 35" W., a distance of 1794.43 feet to the POINT OF BEGINNING;

Thence leaving said Westerly boundary line, S. 89° 26' 25" E., a distance of 155.00 feet;

Thence S. 0° 33' 35" W., a distance of 76.67 feet;

Thence S. 89° 26' 25" E., a distance of 30.00 feet;

Thence S. 0° 33' 35" W., a distance of 572.36 feet to the beginning of a curve right;

Thence a distance of 37.10 feet along the arc of said curve right, having a radius of 200.00 feet, a central angle of 10° 37' 41", the long chord of which bears S. 05° 52' 26" W., a distance of 37.05 feet;

Thence S. 11° 11' 16" W., a distance of 112.50 feet to the beginning of a non tangent curve right;

Thence a distance of 65.99 feet along the arc of said curve right, having a radius of 250.00 feet, a central angle of 15° 07' 28", the long chord of which bears S. 64° 48' 19" E., a distance of 65.80 feet to the beginning of a reverse curve left;

Thence a distance of 139.36 feet along the arc of said curve right, having a radius of 250.00 feet, a central angle of 31° 56' 21", the long chord of which bears S. 73° 12' 45" E., a distance of 137.56 feet to the Southerly boundary line of the SE1/4 NE1/4 of said Section 26;

Thence along the Southerly Boundary of the SW1/4 NE 1/4 of said Section 26, N. 89° 10' 56" W., a distance of 352.72 feet to a found 5/8 inch Iron Pin with a plastic cap stamped "PLS 6901" marking the Southwest corner of the SW1/4 NE1/4 of said Section 26 (Center 1/4 of said Section 26);

Thence along the Westerly boundary line of the SW1/4 NE1/4 of said Section 26, N. 0° 33' 35" E., a distance of 860.78 feet to the POINT OF BEGINNING.

This parcel contains 3.64 acres more or less.





Client: Kimley Horn
Job No.: 9519

Date: January 24, 2024
Re: Jackson Ridge Estates

REZONE R-8
PROPERTY DESCRIPTION

A parcel of land being a portion of the NE 1/4 and a portion of Lot 1, 2 and 3 of Basslin Ridge Estates as on file in Book 64 of Plats at Page 6469 in the Office of the Recorder of Ada County, Idaho, all located in Section 26, Township 3 North, Range 1 West, Boise Meridian, Ada County Idaho, more particularly described as follows:

Commencing at a found Brass Cap marking the NW corner of said NE 1/4, (North 1/4 corner), from which a found Aluminum cap stamped "PLS 17665" marking the NE corner of said NE 1/4, (Section corner common to Sections 23, 24, 25 and 26) bears S. 89° 06' 38" E., a distance of 2655.71 feet;

Thence along the Northerly boundary of said NW 1/4 NE 1/4, S. 89° 06' 38" E., a distance of 1328.23 feet to the NE corner of said NW 1/4 NE 1/4, (East 1/16 corner common to Sections 23 and 26);

Thence along the Easterly boundary of said NW 1/4 NE 1/4, S. 00° 33' 37" W., a distance of 1323.58 feet to the POINT OF BEGINNING;

Thence continuing along said Easterly Boundary line S. 00° 33' 37" W., a distance of 2.96 feet to a found 5/8 inch diameter iron pin with illegible cap marking the Northwest corner of said Basslin Ridge Estates;

Thence along the Northerly boundary of said Basslin Ridge Estates, S. 89° 08' 36" E., a distance of 70.00 feet;

Thence leaving the Northerly boundary of said Basslin Ridge Estates, S. 00° 51' 24" W., a distance of 140.00 feet to the beginning of a non-tangent cure left;

Thence an arc length of 74.45 feet along the arc of said curve left, having a radius of 130.00 feet, a central angle of 32° 48' 53", the long chord of which bears S. 74° 14' 23" W., a distance of 73.44 feet;

Thence S. 57° 49' 56" W., a distance of 54.42 feet to the beginning of a non-tangent cure right;

Thence an arc length of 3.79 feet along the arc of said curve right, having a radius of 750.00 feet, a central angle of 00° 17' 24", the long chord of which bears S. 32° 18' 46" E., a distance of 3.79 feet;

Thence S. 32° 10' 04" E., a distance of 101.09 feet to the beginning of a tangent cure left;

Thence an arc length of 142.21 feet along the arc of said curve right, having a radius of 750.00 feet, a central angle of 10° 51' 50", the long chord of which bears S. 37° 35' 59" E., a distance of 142.00 feet;

Thence S. 43° 01' 54" E., a distance of 698.49 feet;

Thence N. 46° 58' 06" E., a distance of 37.44 feet to the beginning of a tangent cure right;

Thence an arc length of 76.62 feet along the arc of said curve right, having a radius of 100.00 feet, a central angle of 43° 54' 01", the long chord of which bears N. 68° 55' 06" E., a distance of 74.76 feet;

Thence S. 89° 07' 53" E., a distance of 272.61 feet;

Thence S. 00° 52' 07" W., a distance of 155.00 feet;

Thence N. 89° 07' 53" W., a distance of 230.00 feet;

Thence S. 41° 18' 40" W., a distance of 60.29 feet;

Thence S. 46° 58' 06" W., a distance of 122.00 feet;

Thence S. 63° 40' 01" W., a distance of 57.42 feet;

Thence S. 65° 34' 19" W., a distance of 156.36 feet;

Thence S. 69° 02' 20" W., a distance of 30.00 feet to the beginning of a non-tangent cure left;

Thence an arc length of 57.78 feet along the arc of said curve left, having a radius of 150.00 feet, a central angle of 22° 04' 14", the long chord of which bears N. 31° 59' 47" W., a distance of 57.42 feet;

Thence N. 43° 01' 54" W., a distance of 29.90 feet;

Thence S. 46° 58' 06" W., a distance of 166.00 feet;

Thence N. 43° 01' 54" W., a distance of 775.89 feet to the beginning of a tangent cure left;

Thence an arc length of 1.82 feet along the arc of said curve left, having a radius of 3.00 feet, a central angle of 34° 48' 07", the long chord of which bears N. 60° 25' 58" W., a distance of 1.79 feet;

Thence N. 77° 50' 01" W., a distance of 350.90 feet to the beginning of a non-tangent cure right;

Thence an arc length of 79.16 feet along the arc of said curve right, having a radius of 694.00 feet, a central angle of 06° 32' 08", the long chord of which bears N. 03° 08' 30" E., a distance of 79.12 feet;

Thence N. 83° 35' 26" W., a distance of 50.00 feet to the beginning of a non-tangent cure right;

Thence an arc length of 671.95 feet along the arc of said curve right, having a radius of 744.00 feet, a central angle of 51° 44' 51", the long chord of which bears N. 32° 17' 00" E., a distance of 649.35 feet to a point on a compound curve to the left;

Thence an arc length of 282.75 feet along the arc of said curve left, having a radius of 756.00 feet, a central angle of 21° 25' 45", the long chord of which bears N. 47° 26' 33" E., a distance of 281.10 feet;

Thence S. 53° 16' 20" E., a distance of 50.43 feet;

Thence S. 42° 06' 23" E., a distance of 209.48 feet to the POINT OF BEGINNING.

This parcel contains 21.82 acres more or less.

