



Open Space Zone

April 18, 2024





Agenda

- **Photo Tour**
 - Parking
 - Signs and Kiosks
 - Furnishings
 - Trails
- **Next Steps**



Parking Area Photos



Clise Park

- Right-of-way gravel edge
- Approx. 4 parking spots

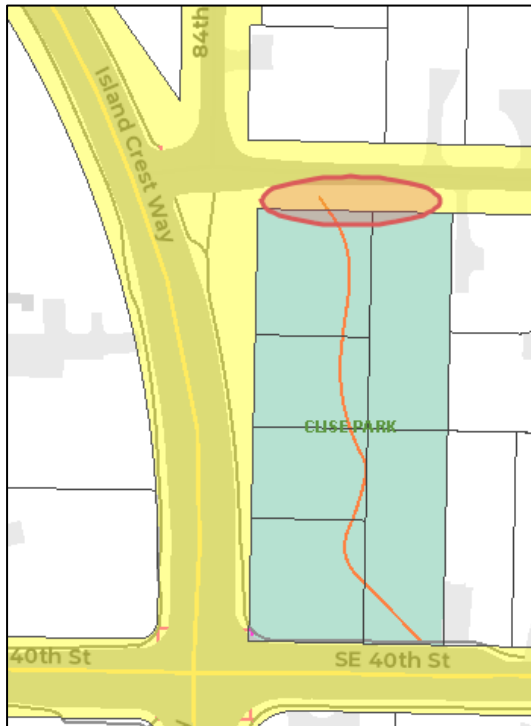

Gallagher Hill Open Space

- Gravel pull-out, right-of-way with some park encroachment
- Approx. 3 parking spots

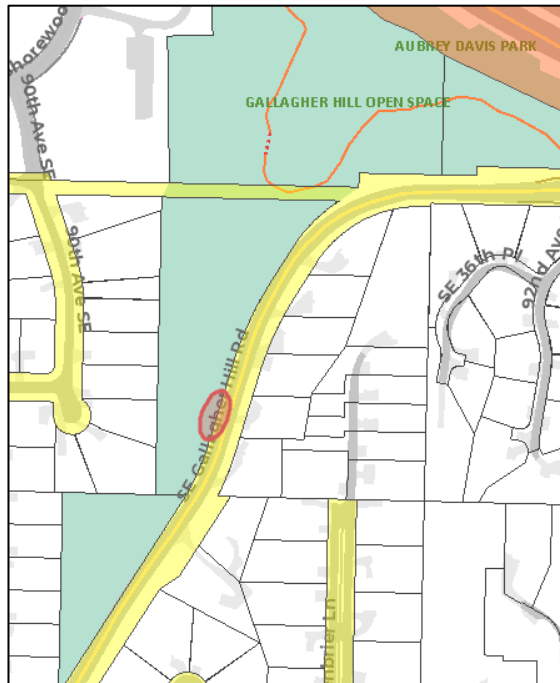

North Mercerdale Hillside

- Parking areas on Open Space property
- Approx. 5 parking spots
- No parking area on north side of SE 27th St

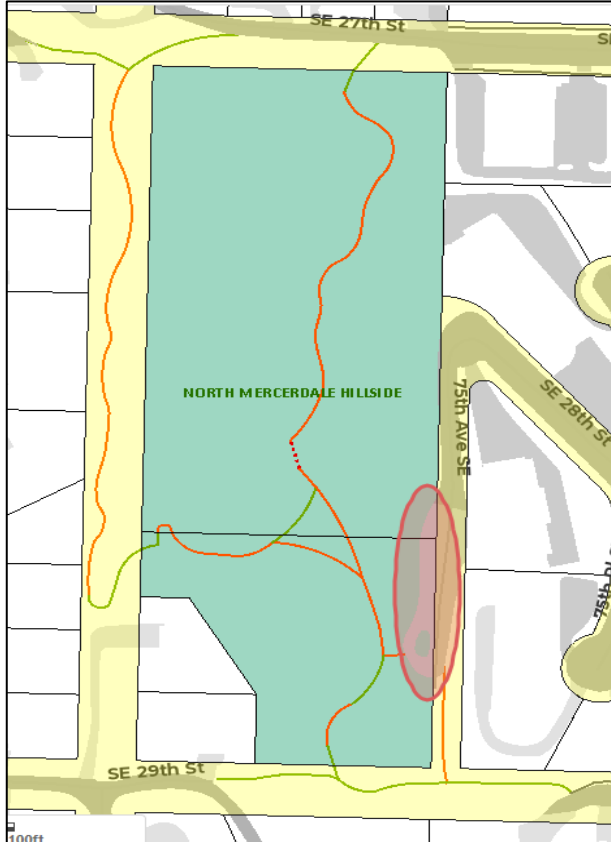

Pioneer Park – NE quadrant

- Right-of-way parking area
- Some encroachment on park property
- Approx. 13 parking spots

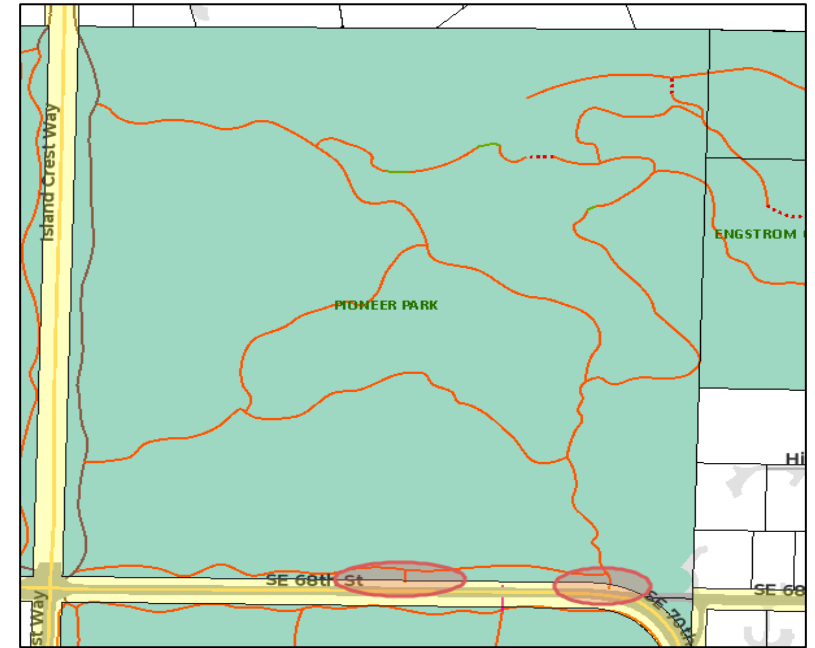

Pioneer Park – NW quadrant

- Park sign and fence along property line
- Parking area
- Approx. 9 parking spots (mix of street parking and gravel edge)
- Staff revegetated some gravel areas between 2021-2022



Pioneer Park – SE quadrant

- Right-of-way parking areas
- Approx. 12 parking spots

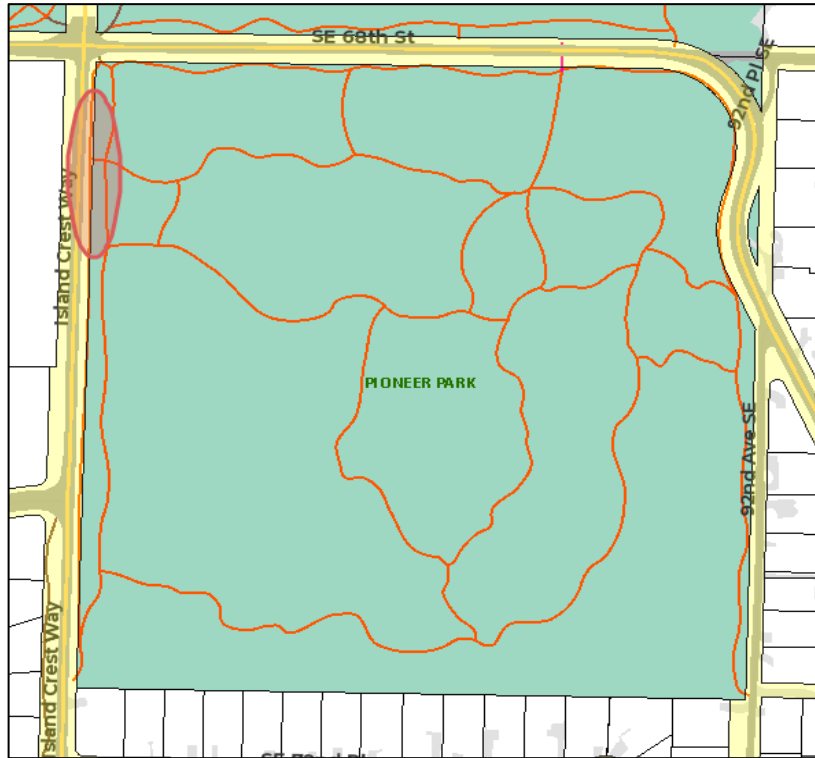

SE 53rd St. Open Space

- Right-of-way parking area
- Approx. 17 parking spots (long parking corridor along SE 53rd street)
- Mix of mud and gravel along edge of right-of-way and park property

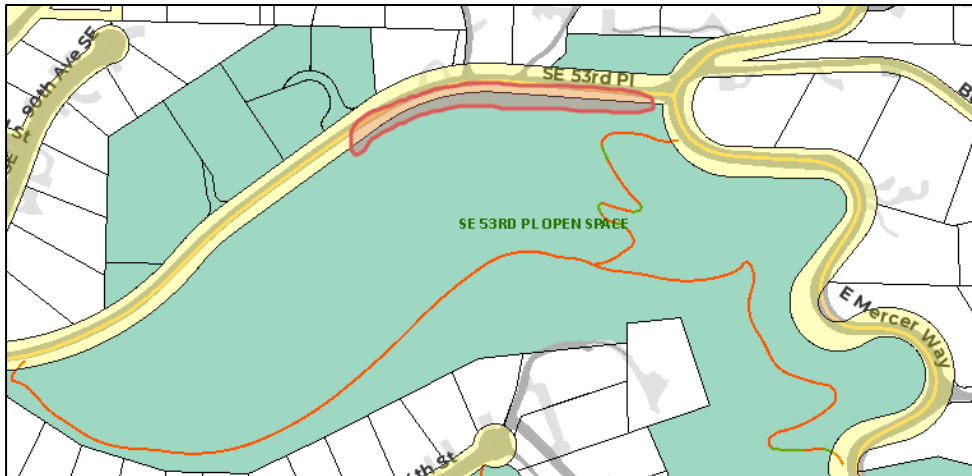



Sign and Kiosk Photos



Engstrom Open Space

- Sign with park map and rules
- Trail and manhole
- Trail crosses private property

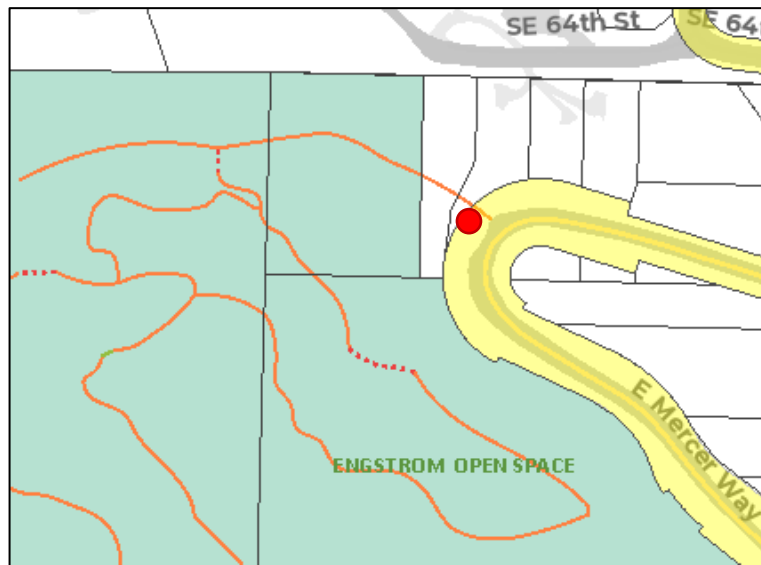

Parkwood Ridge Open Space

- Standard wood park sign - sandblasted and painted
- 4 feet wide



Pioneer Park

- Kiosk
- Includes park map, rules, and several signs
- 9.5 feet tall, 8 feet long, 6.5 feet wide



Pioneer Park

- Standard park sign
- Wayfinding sign



Pioneer Park

- Sign with park map and rules adjacent to donated bench
- 2.6 feet x 2.5 feet
- Might be undersized considering the amount of items on it



Standard Park Entry Signs

- Range from 3-5 feet wide, can include other park information

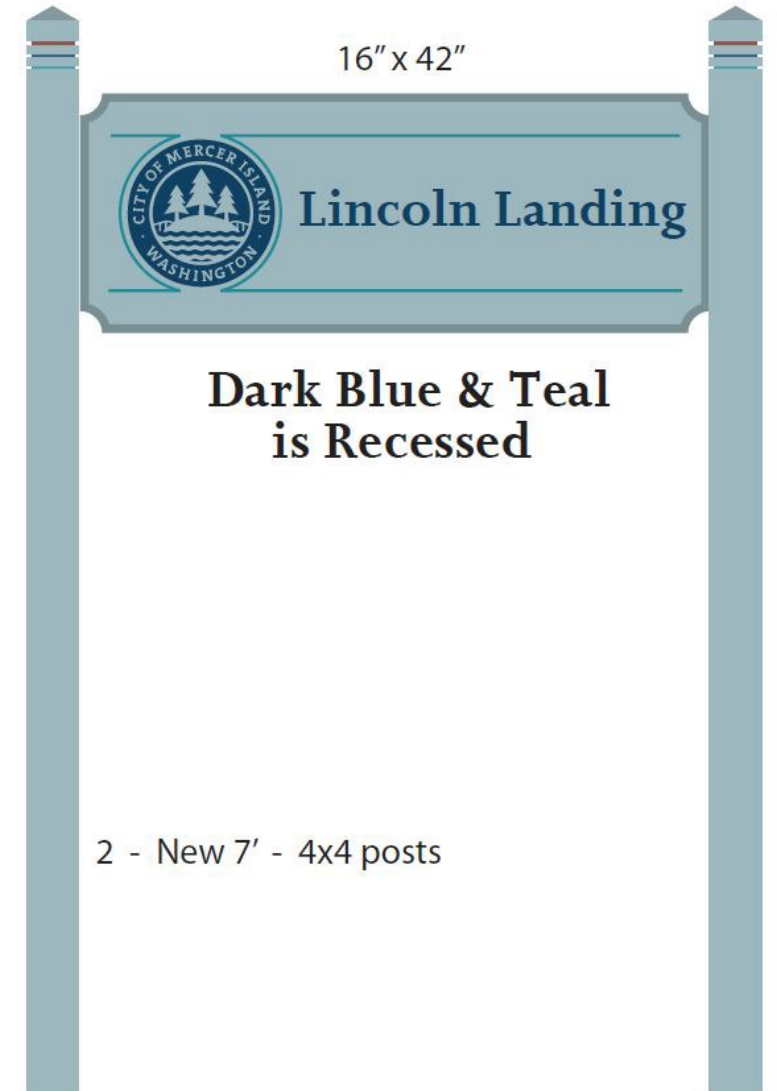

Sign Colors

Materials:

Vinyl

Brand: 3-M Scotch Cal

Color: Light navy

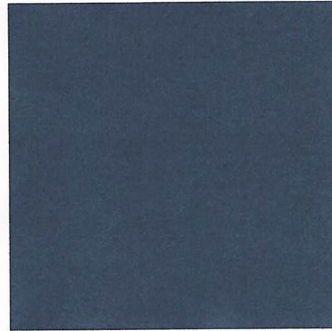

Color:

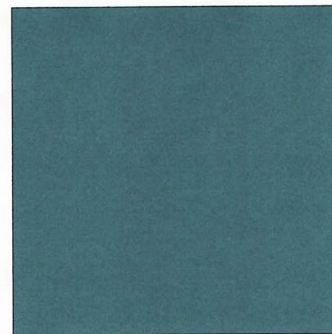

Color - Paint:

Six colors (with one color having both acrylic and enamel versions) are used in park signage. Following are names, formulas, uses and swatches of signage colors:

Colors #1 (acrylic version) and #7 (alkid version): Blue Gray
Formula: B0023029

Uses: Base color for all free standing signs (stain), some wall/fence mounted panels (enamel)

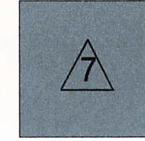
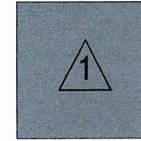

Color #2: Dark Blue (alkid)
Formula: B0023094

Uses: All type, some wall/fence mounted panel borders, vertical post accent grooves



Color #3: Rust (alkid)
Formula: B0023097

Uses: Some wall/fence mounted panels, some 2 x 4 rule bars, vertical post accent grooves

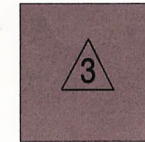

Color #4: Teal (alkid)
Formula: B0023096

Use: Borders of freestanding signs, some wall/fence mounted panels, some 2 x 4 rule bars, vertical post accent grooves



Color #5: Aqua (alkid)
Formula: B0023098

Uses: Some wall/fence mounted panels, some 2 x 4 rule bars



Color #6: Beige (alkid)
Formula: B0023095

Uses: Some wall/fence mounted panels, some 2 x 4 rule bars

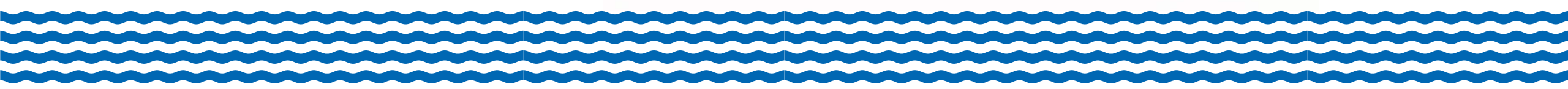

Bike Skills Area and Island Crest Park





Furnishing Photos



First Hill Park

- Picnic table
- Approx. 13 feet from property line



Pioneer Park

- Bench, picnic table, and trail near property line





Trails



Mercerdale Hillside

- Trail and stairs next to private property



Pioneer Park

- Gates and trail along property lines



Trail Standards

- The City does not have master plans for most open spaces and will likely not develop them.
- Master Plans are unnecessary given the lack of development on open space properties. Pioneer Park is the exception due to its size and heavy use.
- Comprehensive trail standards for interior trails currently only exist in the Pioneer Park Master Plan.
- The Citywide Pedestrian and Bicycle Facilities Plan will be updated soon for the years 2025-2030. The current plan (adopted in 2010) does not address interior trail standards but does cover other trails, stairs, etc.
- If the City desires to create trail standards for parks and open spaces, this is likely where they would live. The PRC/OSCT may wish to add this to the recommendations in the hand-off memo.

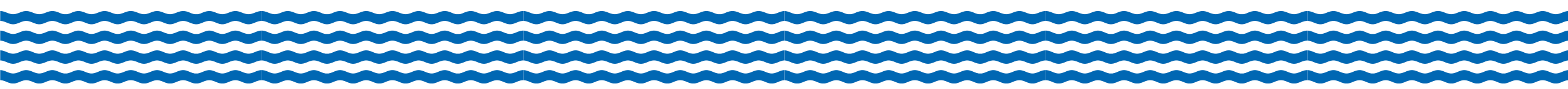



Next Steps



Next Steps

- PRC and OSCT approve the draft Open Space Zone and Hand-off Memo.
 - Chairs of PRC and OSCT will present the recommendation to the Planning Commission at the meeting on May 8, 2024.
 - Planning Commission will conduct the legislative review and present a recommendation to the City Council in Summer 2024.
 - The City Council will review the recommendation in Fall 2024.
 - Staff will return to the PRC later in 2024 with next steps on development of the Parks Zone.
- 