

2021 Parks Deferred Maintenance



Parks & Recreation Commission

February 3, 2022

Background

- Significant backlog of vegetation work in Parks in 2020 due to COVID restrictions and staff reductions.
- In July 2021, City Council allocated \$200,000 from American Rescue Plan Act (ARPA) funds to help restore planter beds in parks to manageable state.
- Staff assessed primary planter beds to develop full scope of needs.
- Starting in July of 2021, City crews began work, in addition to regular park maintenance duties. Two landscape contractors began supplemental work in fall 2021.



Work Areas

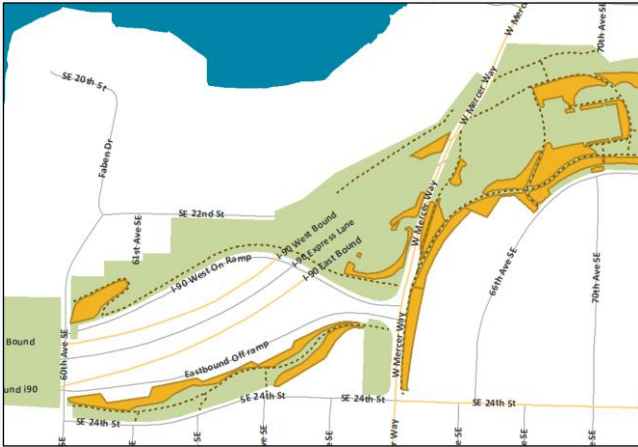

Aubrey Davis Lid West

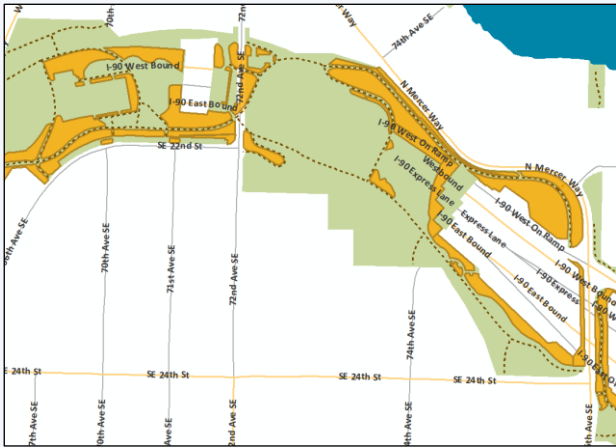

Aubrey Davis Lid East

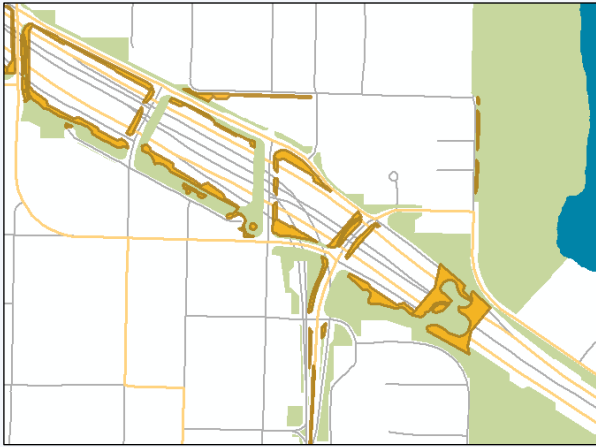

Aubrey Davis Town Center



Aubrey Davis East



North Island Parks

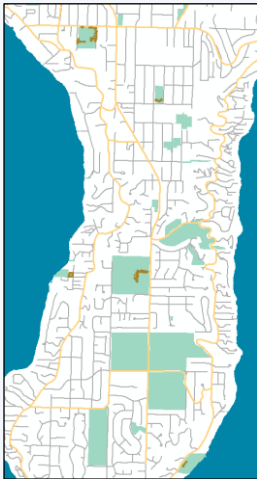

South Island Parks



Work Tasks



- Define bed edges
- Line trim grasses and ivy
- Mulch - ornamental mulch or arborist wood chips
- Planter box clean-up
- Prune shrubs
- Prune trees
- Prune to provide trail clearance
- Remove invasive species (e.g. blackberry and ivy)
- Remove dead shrubs / trees / deadwood
- Remove ivy from shrubs / trees
- Trim hedges
- Weed



Example of scoping

Bed ID	Area (sq ft)	Park	Define bed edge	Line trim grasses	Line trim ivy	Limb up trees	ornamental mulch	Mulch - wood chips	Planter box clean-up	Prune - shrubs	Prune - trees	Prune - trail clearance	Remove blackberry	Remove dead shrubs/ trees	Remove deadwood	Remove ground ivy	Remove ivy - shrubs/ trees	Trim hedge	Weed	
SCHEDULE F: South Island Parks																				
PA-PB-0110	4349.2	Clarke Beach Park						x		x						x			x	Monarch
		Clarke Beach Park														x	x			Entryway / Monarch
PA-PB-0105	3036.0	Groveland Beach								x			x			x			x	Monarch
PA-PB-0106	437.9	Groveland Beach											x			x			x	Monarch
PA-PB-0107	1080.1	Groveland Beach					x						x			x			x	Monarch
PA-PB-0111	1165.7	Groveland Beach						x		x									x	Monarch
		Groveland Beach								x	x		x	x		x	x			Park property
PA-PB-0086	11884.9	Homestead Park		x		x		x		x			x		x	x			x	Monarch
PA-PB-0087	2870.3	Homestead Park		x			x							x	x	x			x	Monarch
PA-PB-0088	734.9	Homestead Park						x								x			x	
PA-PB-0089	1734.2	Homestead Park						x											x	
PA-PB-0090	743.1	Homestead Park						x								x			x	
PA-PB-0091	2163.2	Homestead Park		x						x			x			x				
PA-PB-0092	416.4	Homestead Park						x											x	
PA-PB-0093	138.8	Homestead Park								x									x	
PA-PB-0094	443.6	Homestead Park								x			x			x				
PA-PB-0108	4215.7	Homestead Park						x					x			x			x	
PA-PB-0109	1491.6	Homestead Park						x	x				x	x		x			x	
PA-PB-0112	1439.9	Homestead Park						x	x				x	x		x			x	
PA-PB-0115	1147.1	Homestead Park	x					x								x			x	
PA-PB-0072	3283.5	Island Crest Park						x						x					x	
PA-PB-0073	2992.9	Island Crest Park		x				x						x		x			x	
PA-PB-0074	3081.1	Island Crest Park						x		x								x	x	
PA-PB-0075	1452.5	Island Crest Park						x		x			x					x	x	
PA-PB-0076	4998.1	Island Crest Park		x	x					x						x		x	x	
PA-PB-0077	48.1	Island Crest Park						x						x					x	
PA-PB-0104	5697.0	Rotary Park		x				x		x					x	x	x		x	Monarch

Legend	Future task
	In progress
	Finished



Aubrey Davis Planter Beds

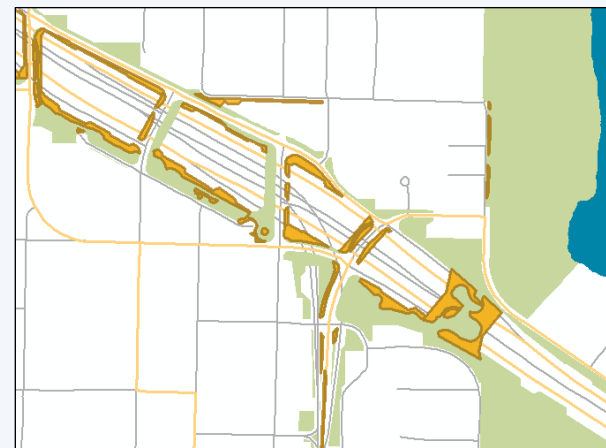
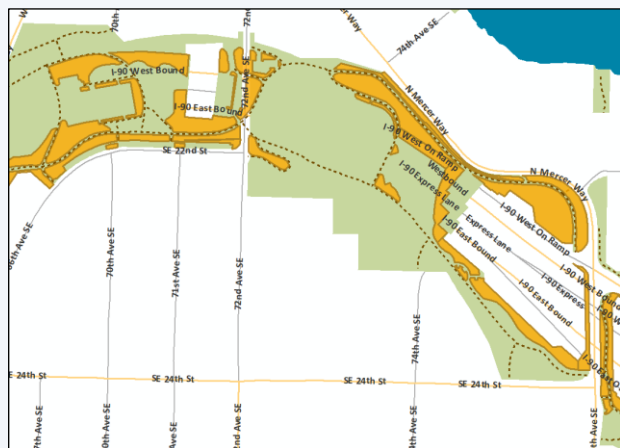
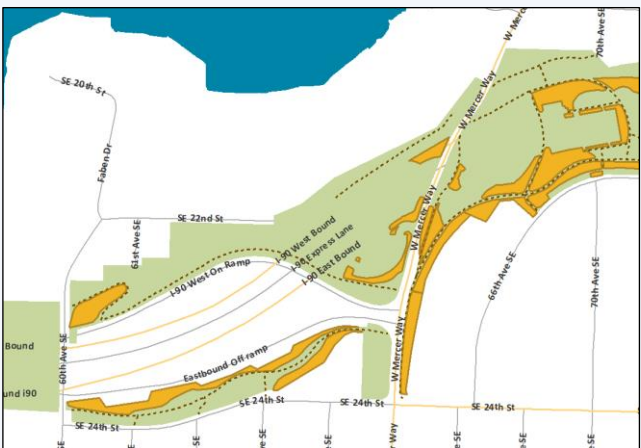

- Total scoped area: 16.2 acres
- Total completed area: 5.6 acres
- Remaining work in progress area: 10.6 acres



Aubrey Davis Park



Completed work includes:

- 76th Ave SE Overpass
- I - 90 trail, along Sunset Highway
- 77th Ave Overpass
- 80th Ave East Overpass
- Island Crest Way Overpass
- Luther Burbank Overlook
- Shorewood Overpass
- N Mercer Way Overpass
- E Mercer Way Overpass





Other Island Parks



Includes:

- Mercerdale Park
- Bicentennial Park
- Island Crest Park
- Homestead Park
- Luther Burbank Park
- Rotary Park
- Clarke Beach Park
- Groveland Beach Park

Progress:

- Total scoped area: 2.1 acres
- Total completed area: 1.27 acres
- Remaining work in progress: 0.83 acres





2021 Summary and Next Steps

- 6.83 acres completed, 37% of total area of identified scope
- \$121,340 spent on labor and materials (through 2021)
 - \$90,244 - contracted landscaping crews
 - \$31,096 - City crews
- Crews continuing work in 2022
- Identifying areas for further enhancements, such as replacement plantings and irrigation repairs

