



AB 6455: Project Update 80th Avenue Sidewalk Improvements

April 16, 2024



Tonight's Presentation

- Project Background
- Sidewalk Conditions
- Tree Replacements
- Street Lighting
- Project Budget/Timeline
- Questions

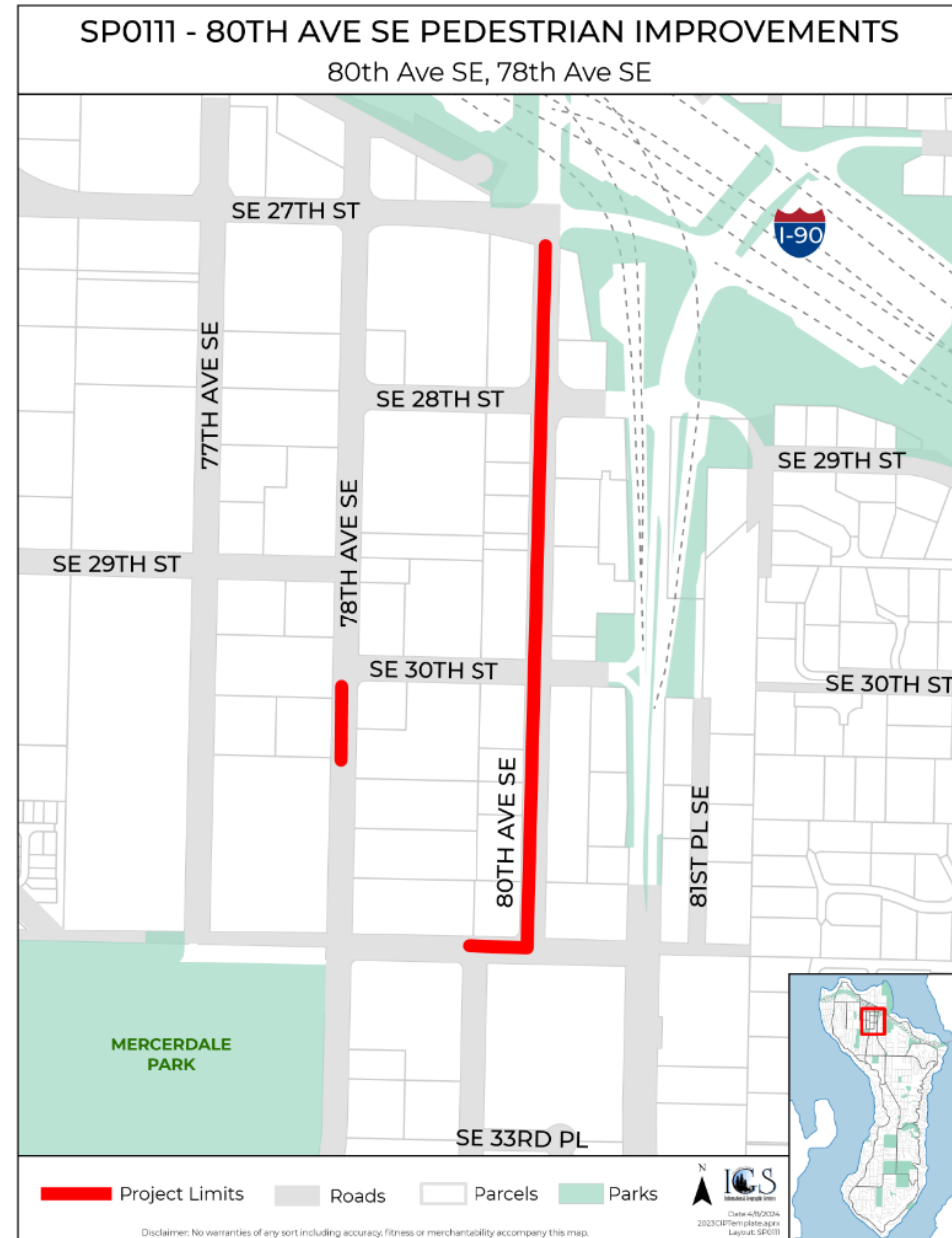

Project Limits

- **East side of 80th Ave. SE** from SE 27th to SE 32nd Streets
- **West side of 78th Ave SE** in 3000 block at Newell Court
- North end of project ties into Sound Transit Traffic Signal at SE 27th

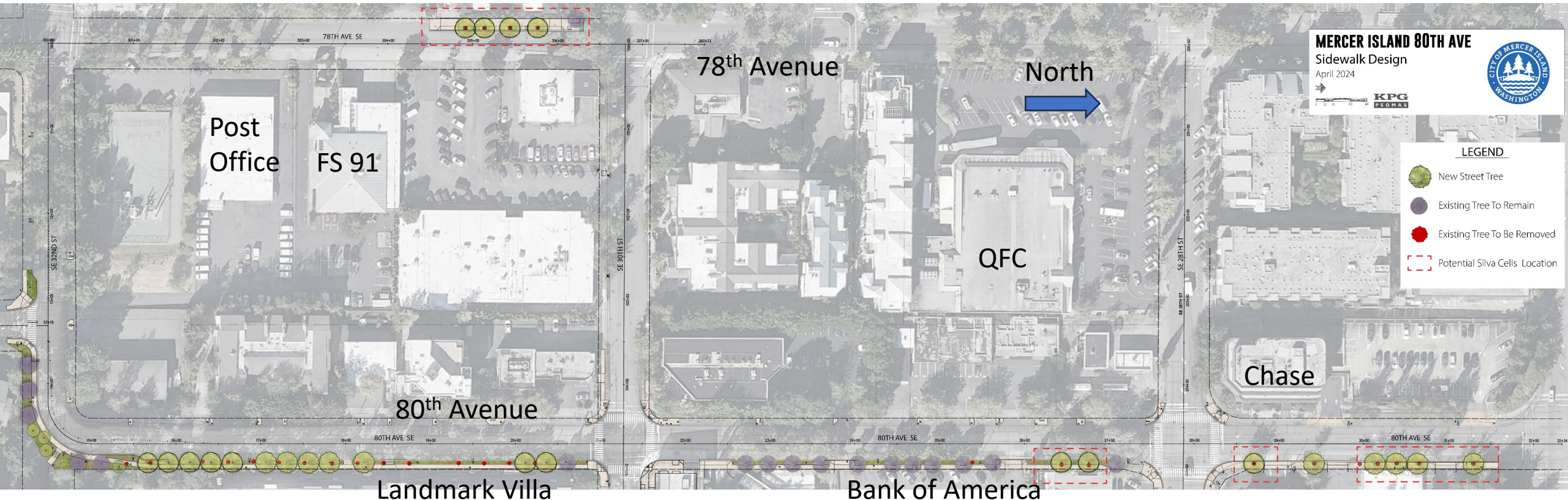

Background

- Existing curb, sidewalk, trees and street lighting constructed in the 1970's and 1980's
- West side of 80th Ave was improved in 1996, the East side was not
- East side has significant uneven and heaved sidewalk panels
- Multiple areas do not meet ADA accessibility standards
- Primarily a “replacement” project for sidewalks, trees, and lights



Existing Sidewalk Conditions SE 32nd



Heaved Sidewalk



Grade difference between sidewalk and 80th, new sidewalk to move onto street

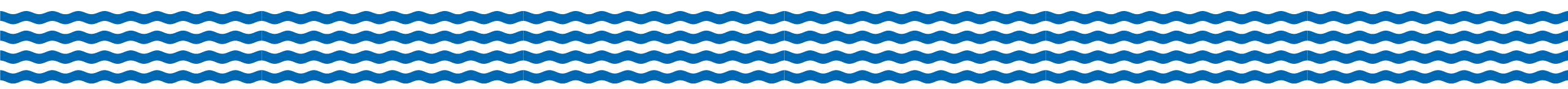

Existing Sidewalk Conditions SE 32nd – 30th



New sidewalk transition



Existing sidewalk is much higher than existing street



Does not meet ADA grade requirements

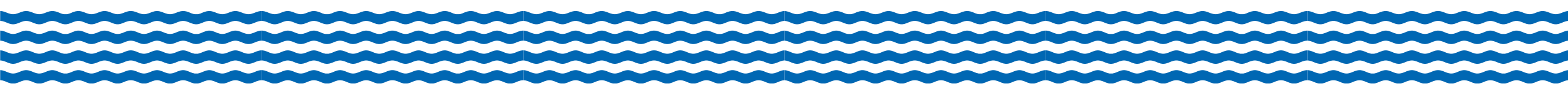

Existing Sidewalk Conditions SE 30th – 28th



Raise grade of new sidewalk to save trees along Bank of America



Existing sidewalk does not meet required ADA width

Existing Sidewalk Conditions SE 28th – 27th



Existing trees in poor health due to limited growing area



Poor ADA access at driveways

Existing Sidewalk Conditions 78th Ave SE



Uneven sidewalk panels,
high root masses



Curbs, sidewalks, and trees
to be removed and replaced



Proposed New Tree Layout

32ND ST TO 30TH ST

Typical Layout & Section



LEGEND

-  New Street Tree
-  Existing Tree to be Removed
-  Existing Tree To Remain

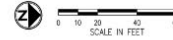

- Retain trees on SE 32nd Street
- New trees planted in existing median on 80th Ave





Proposed New Tree Layout

30ND ST TO 28TH ST

Typical Silva Cells Layout & Section



LEGEND

-  New Street Tree
-  Existing Tree to be Removed
-  Existing Tree To Remain
-  Potential Silva Cells Location

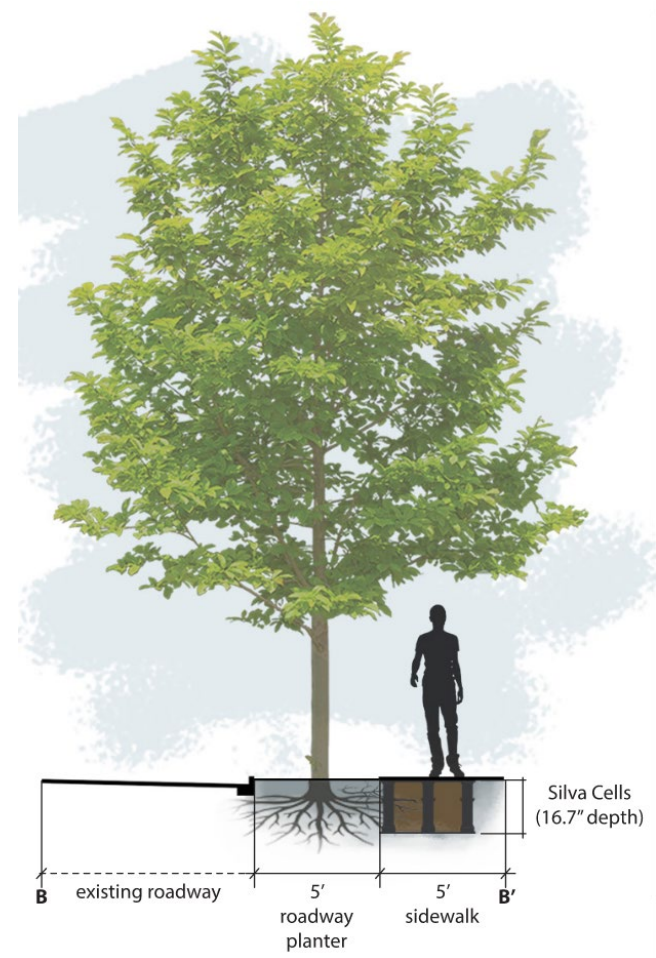

- Retain trees along Bank of America
- Two new trees planted in new modular planting cells



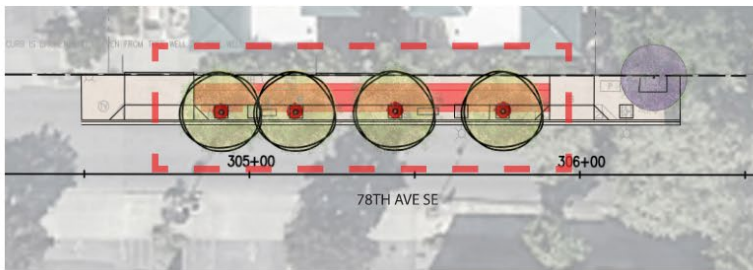
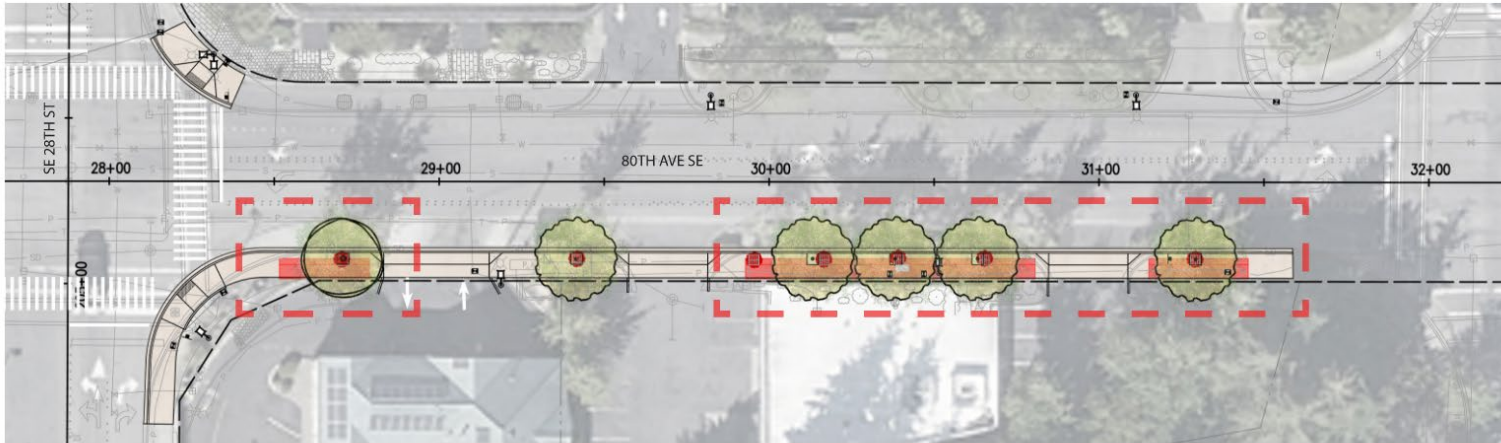

Proposed New Tree Layout

28TH TO 27TH & 78TH AVE

Typical Silva Cells Layout & Section



LEGEND

-  New Street Tree
-  Existing Tree to be Removed
-  Existing Tree To Remain
-  Potential Silva Cells Location



0 10 20 40 60
SCALE IN FEET

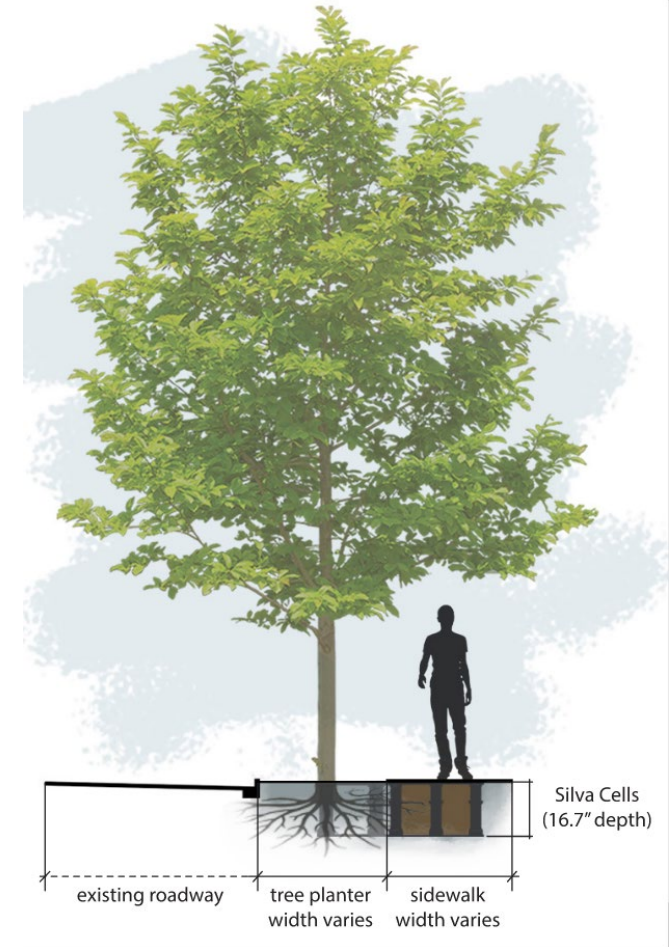

- New trees planted in new modular planting cells
 - On 80th Ave, north of SE 28th
 - On 78th Ave at Newell Court
- 47 existing trees. 29 trees to be removed and replaced. 18 trees retained.

Planting Cells & Tree Selections



Modular planting cell layout under new sidewalk



- 'Wildfire' Tupelo
- Planted at 12-14'
- Mature tree 40'+



- 'Emerald Sunshine' Elm
- Planted at 12-14'
- Mature tree 30'+

Street Lighting

- Remove over 20 wood poles from both sides of 80th Ave and SE 32nd
- Install 14 new concrete poles
- 14 existing concrete poles receive new LED fixtures
- Install new control cabinet, conduits, and wiring
- Utilize conduits along west side installed in 1996



Typical wood pole to be replaced



Typical concrete pole with LED light fixture

Project Cost & Budget

Description	Total
Estimated Sidewalk Construction Cost	\$1,065,000
Estimated Tree Replacement Const. Cost	\$ 225,000
Estimated Street Lighting Const. Cost	\$ 530,000
Total Estimated Construction Cost	\$1,820,000
Contingency/Design/Project Management Cost	\$ 613,000
Total Estimated Project Cost	\$2,433,000
2023-2024 CIP Budget Available	\$1,376,000

- Project will use Sound Transit Mitigation Funds

Project Timeline

- May - Complete final design work
- May - Advertise for contractor bids
- June - Award construction contract
- July to December 2024 - Construct project

Communications Moving Forward

- Contact affected properties and businesses
 - Engage with Chamber of Commerce
 - Let's Talk page
 - Project page on City's web site
- 



QUESTIONS

www.mercerisland.gov/SP0111

<https://letstalk.mercergov.org/>