

# AUBREY DAVIS PARK TRAIL SAFETY IMPROVEMENTS

ARTS COUNCIL MEETING  
PUBLIC ART OPPORTUNITIES



**KPG**  
PSOMAS

SEPTEMBER 2022

# City of Mercer Island

## Parks & Recreation Commission

<b>Craig Reynolds</b>	<b>Council Liaison</b>
<b>Jodi McCarthy</b>	<b>Commission Chair</b>
<b>Peter Struck</b>	<b>Commission Vice-Chair</b>
<b>Sara Berkenwald</b>	<b>Commission Member</b>
<b>Paul Burstein</b>	<b>Commission Member</b>
<b>Don Cohen</b>	<b>Commission Member</b>
<b>Sara Marxen</b>	<b>Commission Member</b>
<b>Rory Westberg</b>	<b>Commission Member</b>

## KPG Psomas

<b>Liz Gibson</b>	<b>Project Manager</b>
<b>Bryce Corrigan</b>	<b>Project Engineer</b>
<b>Phuong Nguyen</b>	<b>Public Engagement &amp; Urban Designer</b>
<b>Coreen Schmidt</b>	<b>Multi-Modal Trail Designer</b>

## Arts Council

<b>Mayor Salim Nice</b>	<b>Council Liaison</b>
<b>Elizabeth Mitchell</b>	<b>Chair</b>
<b>Suzanne Skone</b>	<b>Vice Chair</b>
<b>Daniel Becker</b>	<b>Board Member</b>
<b>Rachel Blum</b>	<b>Board Member</b>
<b>Jonathan Harrington</b>	<b>Board Member</b>
<b>Rosemary Moore</b>	<b>Board Member</b>



## Project Goals

The goal of this project is to **improve safety** and **create a more enjoyable experience** for **all trail and park users**, while maintaining the existing character of Aubrey Davis Park. The project improvements will focus primarily on **low-impact approaches** for improvements to a 0.8-mile trail section from 60th Ave SE to 76th Ave SE, along the Mountains to Sound Greenway Trail. One high-priority location for improvements and **placemaking and node definition** will be the area near the restrooms, adjacent to the Gary Ferrogia playfields.



# Priority Improvement Areas / Overview

- Trail improvements to make pedestrian and bicycle movements safer and more predictable at distinctive key node locations.
  - Bike traffic-calming measures
  - Removal of existing bollards
- Signage and pavement markings
- Restoring trail shoulders
- Wayfinding signage and markings
  - Signage for bypass routes for high-speed cyclists
- Channeling cross-trail traffic
- Vegetation management for sight distance
- Integrated public art and placemaking elements

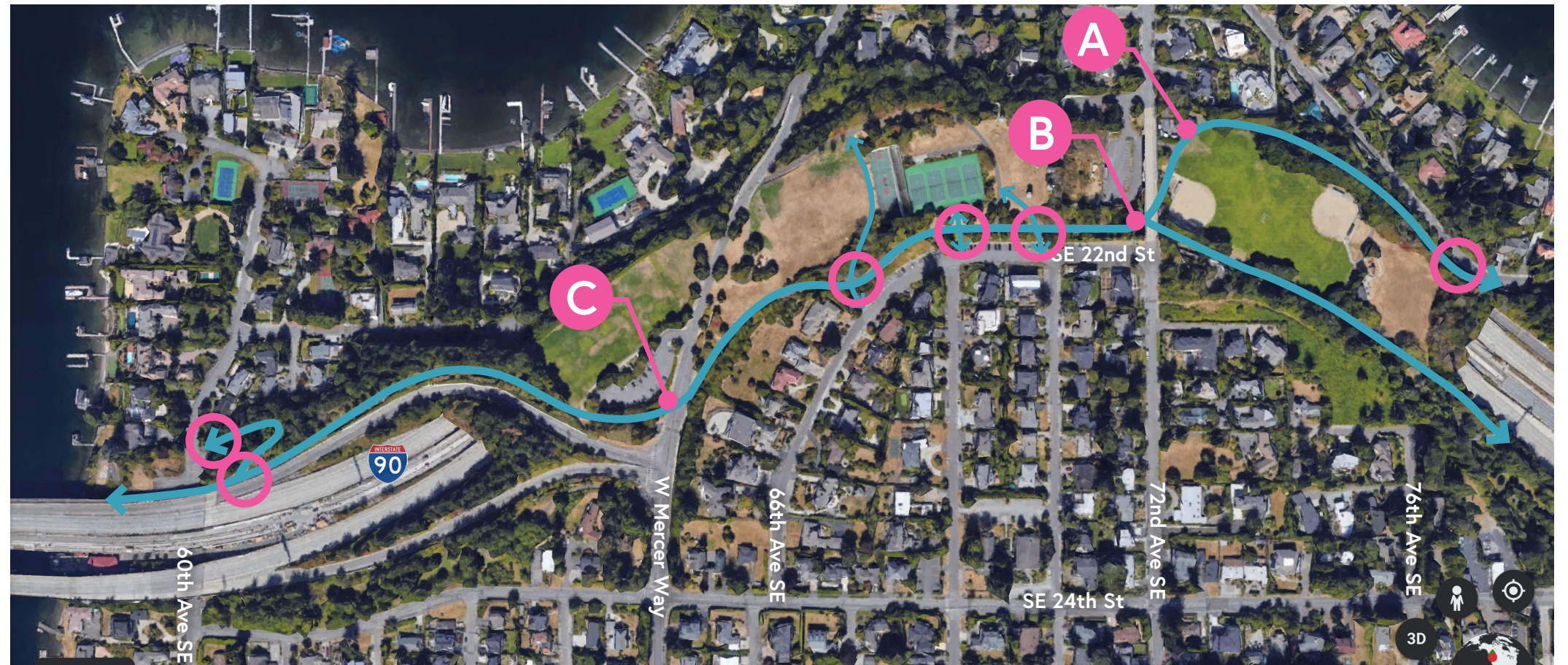

A \* Restroom Facilities & Playfields Node     
 B \* Trail Connection under 72nd Ave SE Overpass     
 C W. Mercer Way Trail Crossing

\* Focused areas for public art opportunities

# PUBLIC ART INSTALLATION CONSIDERATIONS

**Project Goals:** Providing integrated public art installations will support the goals of the project and safety for all user groups, while providing placemaking.

## EXAMPLES:

- Pop-up placemaking signage - eye catching signage to help change usage behaviors (i.e. slow bikes down, alert pedestrians to oncoming trail traffic)
- Lighted columns/pavement - providing accent lighting to under-lit areas
- Paint/accent lighting for overpass column - providing visual cues to slow users coming into a mixing zone
- Metal/tile inlay treatment - indicating pedestrian connections
- Artistic striping/colored pavement treatment - providing visual cues to slow users coming into a mixing zone
- Artistic node surface treatment - providing node definition in mixing zone areas

**Cost (\$):** Includes in-house/commissioned design, labor, materials and installation.

**Permanence (+):** Ranges from an installation material that is ephemeral and can be changed/replaced over time to an installation material that is of higher quality, durable and long-lasting.

# Public Art Installation Examples

Cost \$ Permanence +

## In-House



light columns  
\$\$ +++

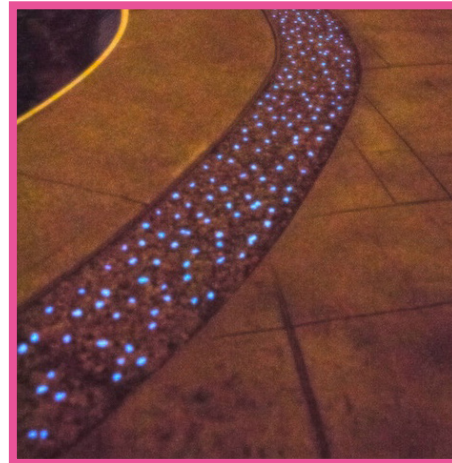

glow in the dark pavement  
\$\$ +++

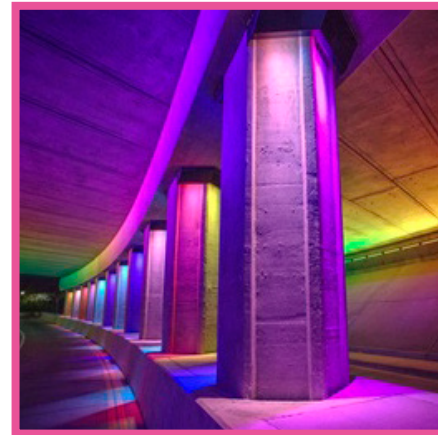

lighting accent to overpass column  
\$\$\$ +++



pop-up placemaking signage  
\$ +



water repellent treatment  
\$ +



paint accent to overpass column  
\$ +



metal inlay  
\$+++



colored surface pavement treatment  
\$ ++



projected lighting  
\$\$ +++



striping treatment  
\$ ++

## Commissioned

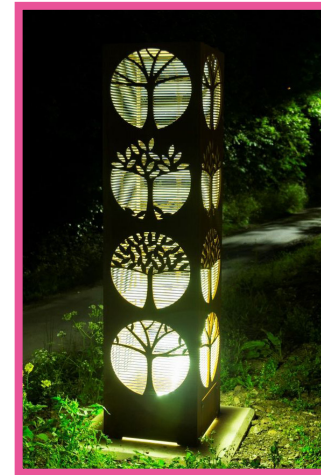

custom sculptural light columns  
\$\$\$ +++



glow in the dark pavement  
\$\$ +++



lighting accent to overpass  
\$\$\$ +++



pop-up placemaking signage  
\$ +



water repellent treatment  
\$ +

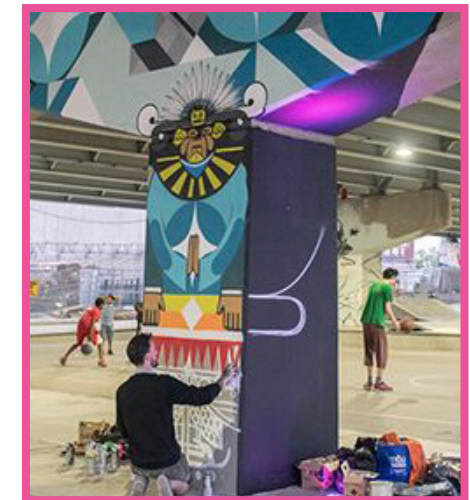

paint accent to overpass column  
\$ +



tile inlay  
\$+++



colored surface pavement treatment  
\$ ++



projected lighting  
\$\$\$ +++

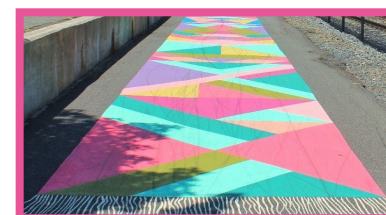

artistic striping treatment  
\$ ++

# Public Art Opportunities / Restroom Facilities & Playfields Node

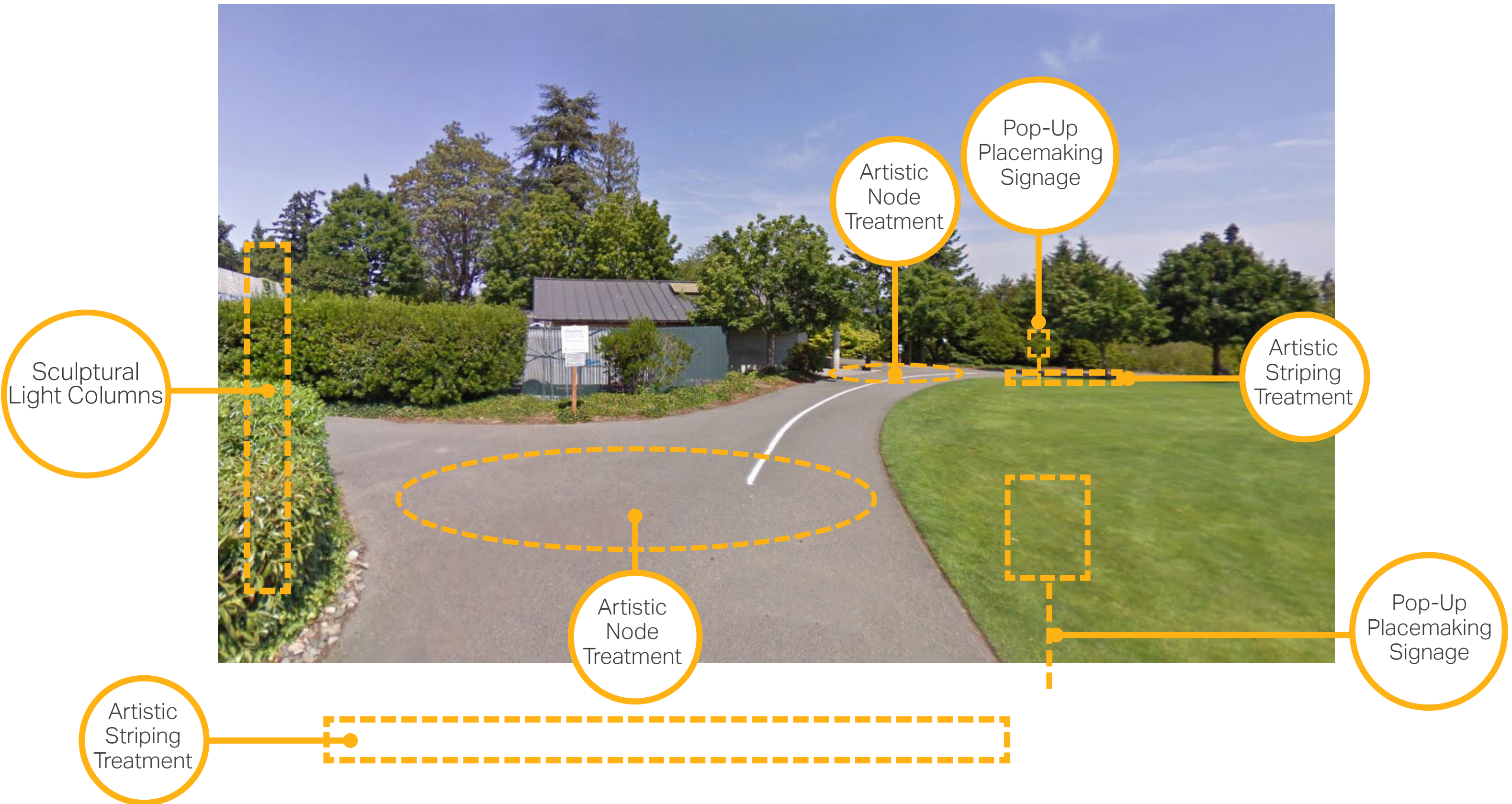

# Public Art Opportunities / Trail Connection under 72nd Ave SE Overpass

