

M:\Medina\24459\_2024 Storm Improvements\01 Design\PLAN\SET\CD\PLAN & PROFILE.dwg, 8/23/2024 11:29 AM, STEPHEN MOORE

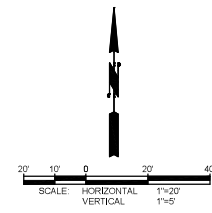

### CONSTRUCTION NOTES

1. CONTRACTOR TO FIELD VERIFY AND ADJUST RAMP LENGTH TO MEET RAMP SLOPE REQUIREMENTS PER DETAILS. THE CURB RAMP MAXIMUM RUNNING SLOPE AT THE BACK OF THE RAMP SHALL NOT EXCEED 2.0%, LONGITUDINAL SLOPE SHALL NOT EXCEED 0.33%.
2. CURB RAMP, CROSS SLOPE SHALL NOT EXCEED 2.0%, LONGITUDINAL SLOPE SHALL NOT EXCEED 0.33%.
3. LANDING, CROSS SLOPES SHALL NOT EXCEED 2.0%.
4. DETECTABLE WARNING SURFACE, 2\"/>

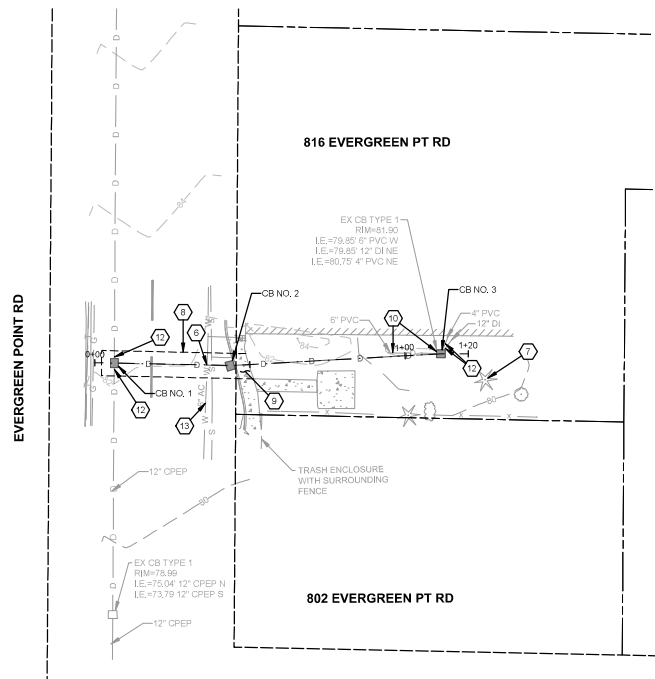
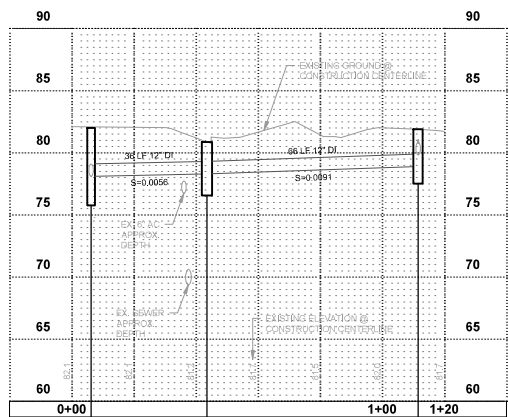

**CB TYPE 1, CB NO. 1**  
 RIM=81.50  
 I.E.=78.85' 6" PVC W  
 I.E.=78.85' 12" DI NE  
 I.E.=80.75' 4" PVC NE

**CB TYPE 1, CB NO. 2**  
 RIM=78.99  
 I.E.=72.04' 12" CPEP N  
 I.E.=73.78' 12" CPEP S

**CB TYPE 1, CB NO. 3**  
 RIM=81.50  
 I.E.=78.85' 12" DI NE  
 I.E.=80.75' 4" DI NE

**Gray & Odgers, Inc.**  
 CONSULTING ENGINEERS  
 3710 188TH STREET NORTHEAST,  
 BUILDING B, SUITE 210  
 ARLINGTON, WA 98223  
 (360) 454-6490



**CITY OF MEDINA**  
**2024 DRAINAGE IMPROVEMENTS**

No.	DATE	REVISION

ISSUED FOR:

ISSUE DATE: AUG 2024  
 APPROVED BY: RWK  
 CHECKED BY: LP  
 DRAWN BY: SEM

G & O JOB NO.: 24459  
 FILE: PLAN & PROFILE.DWG

0 1 2'  
 TWO INCHES AT FULL SCALE,  
 IF NOT, SCALE ACCORDINGLY

**CIVIL**

**PLAN & PROFILE POST OFFICE**

**BURIED UTILITIES IN AREA CALL BEFORE YOU DIG 1-811**  
 EXISTING UTILITIES SHOWN ARE FROM THE BEST AVAILABLE INFORMATION AND NO GUARANTEE IS MADE AS TO THE EXACT SIZE, TYPE, LOCATION OR DEPTH.

**RIGHT-OF-WAY DISCLAIMER**  
 THE RIGHT-OF-WAY AND/OR PROPERTY LINES SHOWN HEREON ARE BASED ON AVAILABLE INFORMATION, NOT ON A SURVEYED LOCATION AND ARE ONLY APPROXIMATE.

SHEET: **C-5** OF **13**

M:\Medina\24452\_2024 Storm Improvements\01 Design\PLAN\SET\CD\PLAN & PROFILE.dwg, 8/23/2024 11:29 AM, STEPHEN MOORE

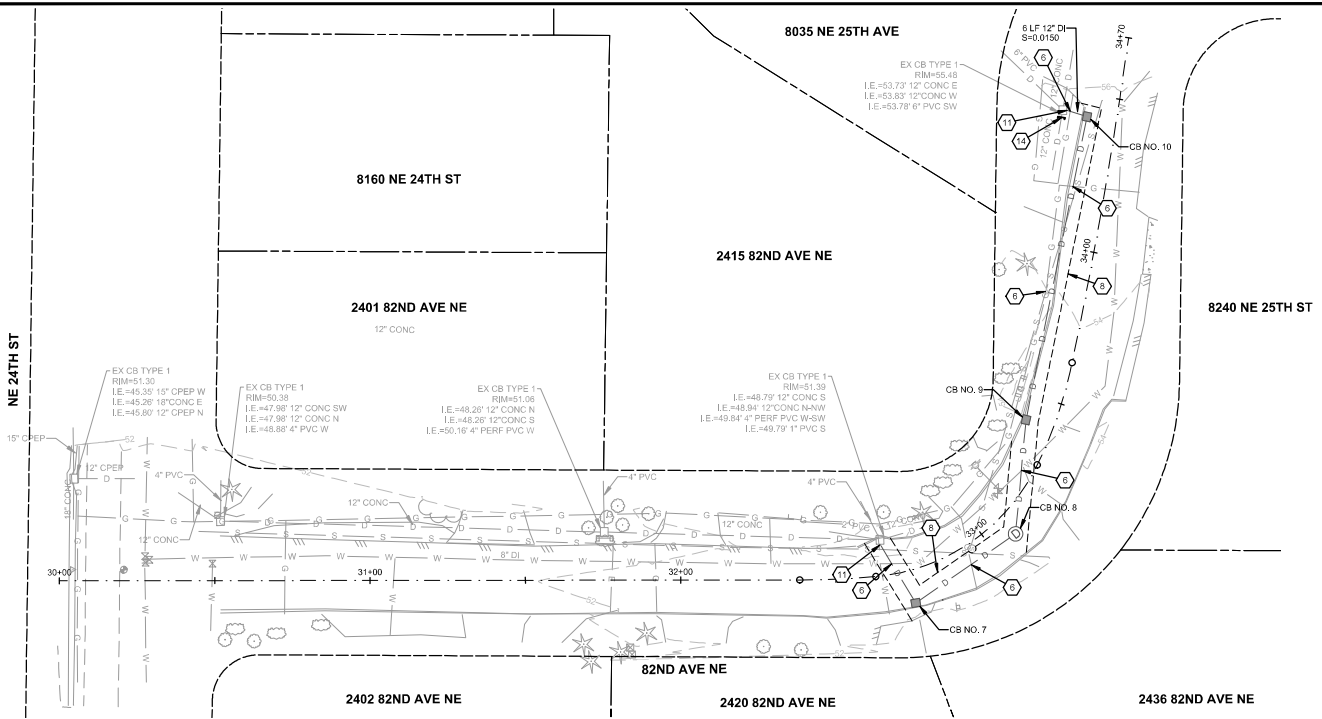

**CONSTRUCTION NOTES**

1. CONTRACTOR TO FIELD VERIFY AND ADJUST RAMP LENGTH TO MEET RAMP SLOPE REQUIREMENTS PER DETAILS. THE CURB RAMP MAXIMUM RUNNING SLOPE AT THE BACK OF THE RAMP SHALL NOT REQUIRE THE RAMP LENGTH TO EXCEED 15 FEET.
2. CURB RAMP, CROSS SLOPE SHALL NOT EXCEED 2.0%, LONGITUDINAL SLOPE SHALL NOT EXCEED 8.33%.
3. LANDING, CROSS SLOPES SHALL NOT EXCEED 2.0%.
4. DETECTABLE WARNING SURFACE, 2" MIN. ALONG DIRECTION OF TRAVEL, TYP. FOR ALL APPLICATIONS.
5. SAWCUT EXISTING CURB AND/OR SIDEWALK TO NEAREST FULL JOINT AND PROVIDE CLEAN EDGE.
6. CAUTION, POTENTIAL UTILITY CONFLICT, VERIFY (POTHOLE) EXACT LOCATION AND DEPTH OF EXISTING UTILITY.
7. PROTECT EXISTING (CURB, SIDEWALK, FENCE, MAILBOX, TREE, LANDSCAPING, AND IRRIGATION SYSTEM) DURING CONSTRUCTION.
8. SAWCUT, REMOVE, AND WASTEHAUL EXISTING PAVEMENT/CONCRETE PER SPECIFICATIONS. PATCH WITH 2 INCHES OF HMA OVER 4 INCHES OF CRUSHED SURFACING TOP COURSE AND SEAL JOINT (WHERE APPLICABLE) THEN APPLY SAND BLANKET TO THE SURFACE JOINT. COORDINATE WITH THE CITY AS REQUIRED.
9. SAWCUT EXISTING DRIVEWAY, CURB AND/OR SIDEWALK TO NEAREST FULL JOINT, OR AS SHOWN AND PROVIDE CLEAN EDGE.
10. REMOVE AND WASTEHAUL EXISTING STORM DRAINAGE STRUCTURES (PIPE (S)).
11. CONNECT NEW STORM PIPE TO EXISTING CATCH BASIN. CORE DRILL IF KNOCK OUT IS NOT PRESENT.
12. CONNECT EXISTING STORM PIPE TO NEW CATCH BASIN.
13. CAUTION, EXISTING ASBESTOS CEMENT WATER MAIN.
14. PLUG EXISTING STORM WATER PIPE.
15. POTHOLE TO DETERMINE PRESENCE AND CONDITION OF STORM PIPE(S).

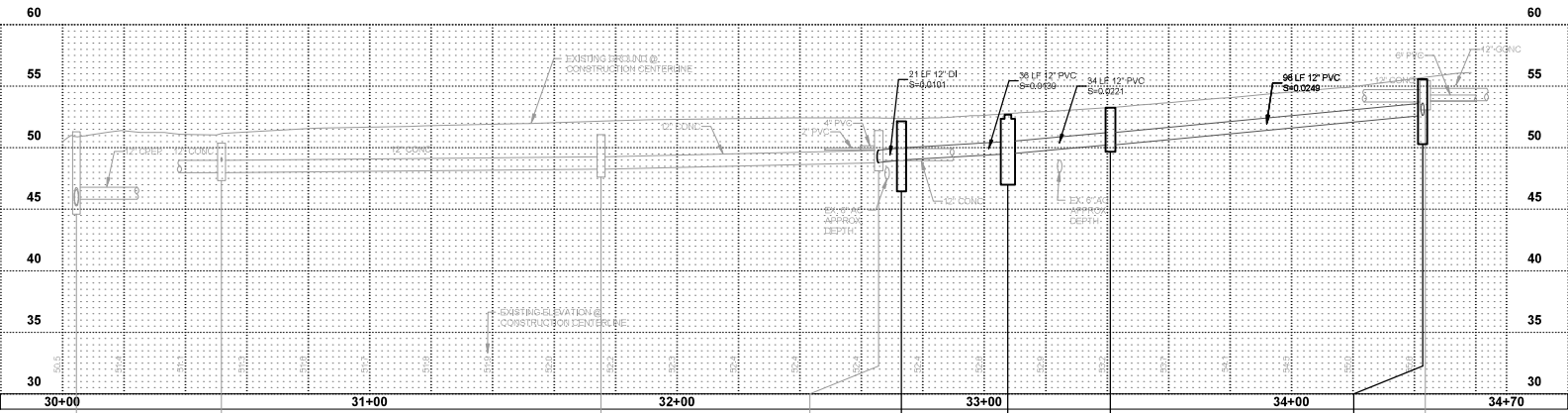
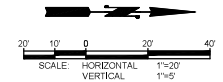

<p>EX CB TYPE 1 RIM=51.30 I.E.=45.35' 15\"/&gt; </p>	<p>EX CB TYPE 1 RIM=51.30 I.E.=45.26' 10\"/&gt; </p>	<p>EX CB TYPE 1 RIM=51.30 I.E.=47.98' 12\"/&gt; </p>	<p>EX CB TYPE 1 RIM=51.39 I.E.=48.79' 12\"/&gt; </p>	<p>EX CB TYPE 1 RIM=51.39 I.E.=48.94' 12\"/&gt; </p>	<p>EX CB TYPE 1 RIM=51.39 I.E.=49.79' 11\"/&gt; </p>	<p>EX CB TYPE 1 RIM=51.39 I.E.=49.81' 12\"/&gt; </p>	<p>EX CB TYPE 1 RIM=51.39 I.E.=49.81' 12\"/&gt; </p>	<p>EX CB TYPE 1 RIM=51.39 I.E.=49.81' 12\"/&gt; </p>	<p>EX CB TYPE 1 RIM=51.39 I.E.=49.81' 12\"/&gt; </p>
--	--	--	--	--	--	--	--	--	--

**BURIED UTILITIES IN AREA CALL BEFORE YOU DIG 1-811**  
EXISTING UTILITIES SHOWN ARE FROM THE BEST AVAILABLE INFORMATION AND NO GUARANTEE IS MADE AS TO THE EXACT SIZE, TYPE, LOCATION OR DEPTH.

**RIGHT-OF-WAY DISCLAIMER**  
THE RIGHT-OF-WAY AND/OR PROPERTY LINES SHOWN HEREON ARE BASED ON AVAILABLE INFORMATION. NOT ON A SURVEYED LOCATION AND ARE ONLY APPROXIMATE.

**Grass & Oshman, Inc.**  
CONSULTING ENGINEERS  
3710 188TH STREET NORTHEAST,  
BUILDING B, SUITE 210  
ARLINGTON, WA 98223  
(360) 454-6490



**CITY OF MEDINA**  
**2024 DRAINAGE IMPROVEMENTS**

No.	DATE	REVISION

ISSUED FOR:

ISSUE DATE: AUG 2024  
APPROVED BY: RWK  
CHECKED BY: LP  
DRAWN BY: SEM

G & O JOB NO.: 24458  
FILE: PLAN & PROFILE.DWG



TWO INCHES AT FULL SCALE, IF NOT, SCALE ACCORDINGLY

**CIVIL**

**PLAN & PROFILE**  
**82ND AVE NE**

SHEET: **C-6** OF: **13**

M:\Medina\24456\_2024 Storm Improvements\01 Design\PLAN\SET\CD\PLAN & PROFILE.dwg, 8/23/2024 11:29 AM, STEPHEN MOORE

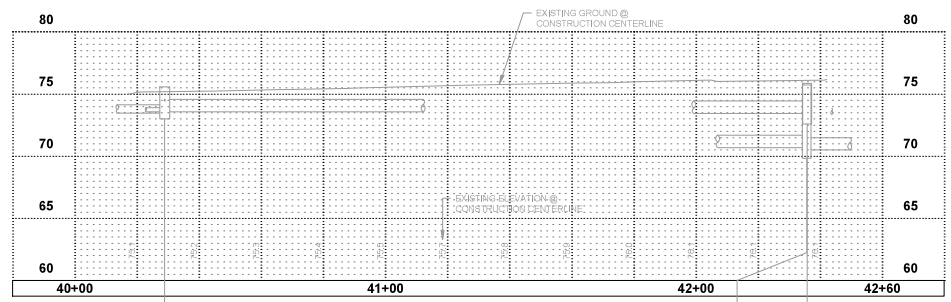
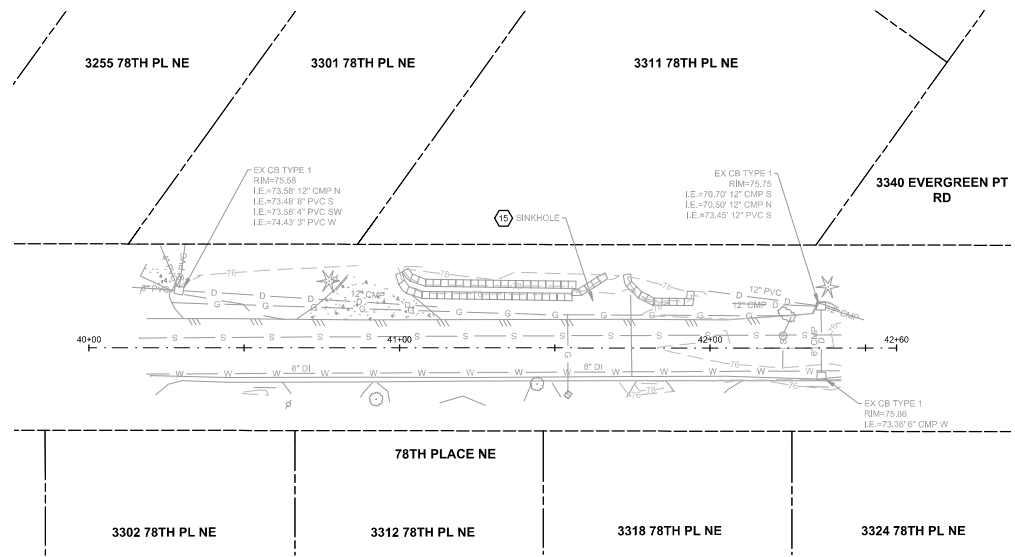

EX CB TYPE 1  
RIM=75.58  
I.E.=73.58' 12" CMP N  
I.E.=73.48' 8" PVC S  
I.E.=73.58' 4" PVC SW  
I.E.=74.43' 3" PVC W

EX CB TYPE 1  
RIM=75.75  
I.E.=70.70' 12" CMP S  
I.E.=70.50' 12" CMP N  
I.E.=73.45' 12" PVC S

EX CB TYPE 1  
RIM=75.36  
I.E.=73.30' 6" CMP W

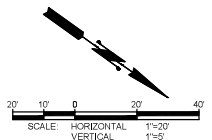

### CONSTRUCTION NOTES

- CONTRACTOR TO FIELD VERIFY AND ADJUST RAMP LENGTH TO MEET RAMP SLOPE REQUIREMENTS PER DETAILS. THE CURB RAMP MAXIMUM RUNNING SLOPE AT THE BACK OF THE RAMP SHALL NOT REQUIRE THE RAMP LENGTH TO EXCEED 15 FEET.
- CURB RAMP, CROSS SLOPE SHALL NOT EXCEED 2.0%. LONGITUDINAL SLOPE SHALL NOT EXCEED 8.33%.
- LANDING, CROSS SLOPES SHALL NOT EXCEED 2.0%.
- DETECTABLE WARNING SURFACE, 2" MIN. ALONG DIRECTION OF TRAVEL, TYP. FOR ALL APPLICATIONS.
- SAWCUT EXISTING CURB AND/OR SIDEWALK TO NEAREST FULL JOINT AND PROVIDE CLEAN EDGE.
- CAUTION:** POTENTIAL UTILITY CONFLICT. VERIFY (POTHOLE) EXACT LOCATION AND DEPTH OF EXISTING UTILITY.
- PROTECT EXISTING CURB, SIDEWALK, FENCE, MAILBOX, TREE, LANDSCAPING AND IRRIGATION SYSTEM DURING CONSTRUCTION.
- SAWCUT, REMOVE AND WASTEHAUL EXISTING PAVEMENT/CONCRETE PER SPECIFICATIONS. PATCH WITH 2 INCHES OF HMA OVER 4 INCHES OF CRUSHED SURFACING TOP COURSE AND SEAL JOINT (WHERE APPLICABLE) THEN APPLY SAND BLANKET TO THE SURFACE JOINT. COORDINATE WITH THE CITY AS REQUIRED.
- SAWCUT EXISTING DRIVEWAY, CURB AND/OR SIDEWALK TO NEAREST FULL JOINT, OR AS SHOWN AND PROVIDE CLEAN EDGE.
- REMOVE AND WASTEHAUL EXISTING STORM DRAINAGE STRUCTURE(S) / PIPE (S).
- CONNECT NEW STORM PIPE TO EXISTING CATCH BASIN. CORE DRILL IF KNOCK OUT IS NOT PRESENT.
- CONNECT EXISTING STORM PIPE TO NEW CATCH BASIN.
- CAUTION:** EXISTING ASBESTOS CEMENT WATER MAIN.
- PLUG EXISTING STORMWATER PIPE.
- POTHOLE TO DETERMINE PRESENCE AND CONDITION OF STORM PIPES.

**Gray & Oshman, Inc.**  
CONSULTING ENGINEERS  
3710 188TH STREET NORTHEAST,  
BUILDING B, SUITE 210  
ARLINGTON, WA 98223  
(360) 454-6490



**CITY OF MEDINA**  
**2024 DRAINAGE IMPROVEMENTS**

No.	DATE	REVISION

ISSUED FOR:

ISSUE DATE: AUG 2024  
APPROVED BY: RWK  
CHECKED BY: LP  
DRAWN BY: SEM  
G & O JOB NO.: 24456  
FILE: PLAN & PROFILE.DWG

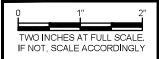

**CIVIL**

**PLAN & PROFILE**  
**78TH PLACE NE**

SHEET: **C-7** OF **13**

**BURIED UTILITIES IN AREA CALL BEFORE YOU DIG 1-811**  
EXISTING UTILITIES SHOWN ARE FROM THE BEST AVAILABLE INFORMATION AND NO GUARANTEE IS MADE AS TO THE EXACT SIZE, TYPE, LOCATION OR DEPTH.

**RIGHT-OF-WAY DISCLAIMER**  
THE RIGHT-OF-WAY AND/OR PROPERTY LINES SHOWN HEREON ARE BASED ON AVAILABLE INFORMATION. NOT ON A SURVEYED LOCATION AND ARE ONLY APPROXIMATE.

M:\Medina\24458\_2024 Storm Improvements\01 Design\PLAN\SETC\PLAN & PROFILE.dwg, 8/23/2024 11:29 AM, STEPHEN MOORE

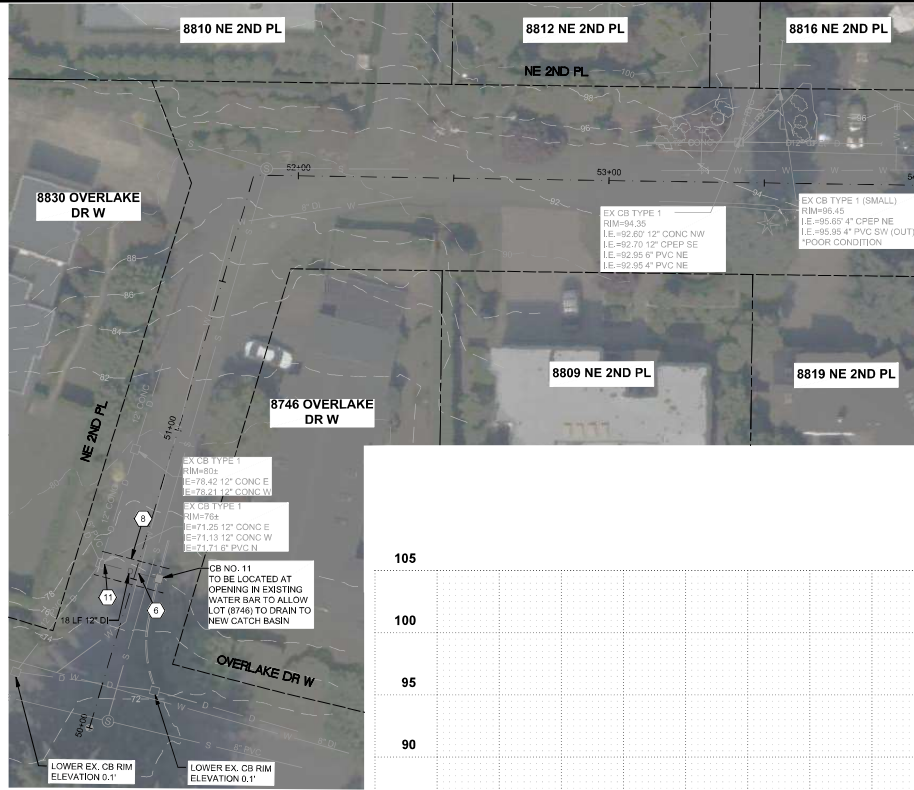

MATCHLINE - SEE SHEET 9

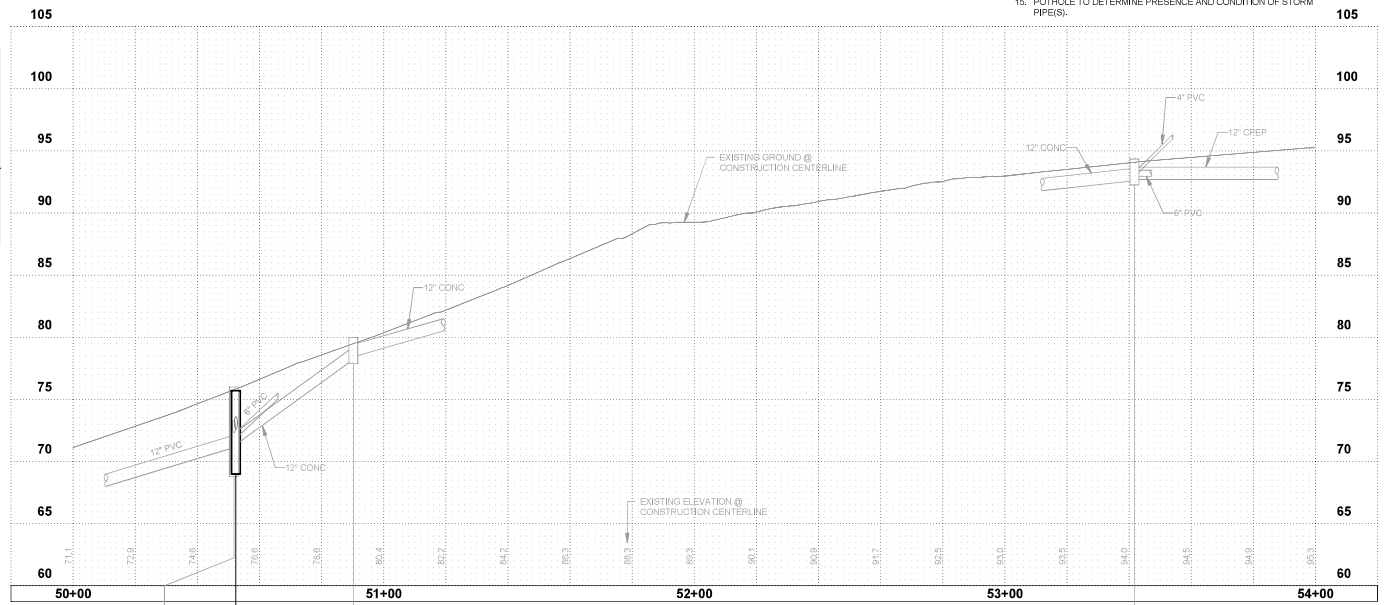

EX CB TYPE 1  
RIM=80.0  
E=78.42 12\"/>

EX CB TYPE 1 (SE NO. 11)  
RIM=76.8  
E=71.25 12\"/>

EX CB TYPE 1 (SMALL)  
RIM=66.45  
E=95.65 4\"/>

EX CB TYPE 1  
RIM=94.37  
E=92.10 12\"/>

**BURIED UTILITIES IN AREA CALL BEFORE YOU DIG 1-811**  
EXISTING UTILITIES SHOWN ARE FROM THE BEST AVAILABLE INFORMATION AND NO WARRANTY IS MADE AS TO THE EXACT SEE TYPE LOCATION OR DEPTH.

**RIGHT-OF-WAY DISCLAIMER**  
THE RIGHT-OF-WAY AND/OR PROPERTY LINES SHOWN HEREON ARE BASED ON AVAILABLE INFORMATION. NOT ON A SURVEYED LOCATION AND ARE ONLY APPROXIMATE.

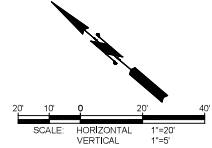

**CONSTRUCTION NOTES**

1. CONTRACTOR TO FIELD VERIFY AND ADJUST RAMP LENGTH TO MEET RAMP SLOPE REQUIREMENTS PER DETAILS. THE CURB RAMP MAXIMUM RUNNING SLOPE AT THE BACK OF THE RAMP SHALL NOT REQUIRE THE RAMP LENGTH TO EXCEED 15-FEET.
2. CURB RAMP: CROSS SLOPE SHALL NOT EXCEED 2.0%, LONGITUDINAL SLOPE SHALL NOT EXCEED 0.33%.
3. LANDING: CROSS SLOPES SHALL NOT EXCEED 2.0%.
4. DETECTABLE WARNING SURFACE: 2' MIN. ALONG DIRECTION OF TRAVEL. TYP. FOR ALL APPLICATIONS.
5. SAVOUCUT EXISTING CURB AND/OR SIDEWALK TO NEAREST FULL JOINT AND PROVIDE CLEAN EDGE.
6. CAUTION: POTENTIAL UTILITY CONFLICT. VERIFY (POTHOLE) EXACT LOCATION AND DEPTH OF EXISTING UTILITY.
7. PROTECT EXISTING CURB, SIDEWALK, FENCE, MAILBOX, TREE, LANDSCAPING, AND IRRIGATION SYSTEM DURING CONSTRUCTION.
8. SAVOUCUT, REMOVE AND WASTEHAUL EXISTING PAVEMENT/CONCRETE PER SPECIFICATIONS. PATCH WITH 2 INCHES OF HMA OVER 4 INCHES OF CRUSHED SURFACING TOP COURSE AND SEAL JOINT (WHERE APPLICABLE) THEN APPLY SAND BLANKET TO THE SURFACE JOINT. COORDINATE WITH THE CITY AS REQUIRED.
9. SAVOUCUT EXISTING DRIVEWAY, CURB AND/OR SIDEWALK TO NEAREST FULL JOINT. OR AS SHOWN AND PROVIDE CLEAN EDGE.
10. REMOVE AND WASTEHAUL EXISTING STORM DRAINAGE STRUCTURE(S) / PIPE (S).
11. CONNECT NEW STORM PIPE TO EXISTING CATCH BASIN. CORE DRILL IF KNOCK OUT IS NOT PRESENT.
12. CONNECT EXISTING STORM PIPE TO NEW CATCH BASIN.
13. CAUTION: EXISTING ASBESTOS CEMENT WATER MAIN.
14. PLUG EXISTING STORMWATER PIPE.
15. POTHOLE TO DETERMINE PRESENCE AND CONDITION OF STORM PIPE(S).

**Gray & Osborne, Inc.**  
CONSULTING ENGINEERS  
3710 188TH STREET NORTHEAST,  
BUILDING B, SUITE 210  
ARLINGTON, WA 98223  
(360) 454-6490



**CITY OF MEDINA**  
**2024 DRAINAGE IMPROVEMENTS**

No.	DATE	REVISION

ISSUED FOR:

ISSUE DATE: AUG 2024  
APPROVED BY: RWK  
CHECKED BY: LP  
DRAWN BY: SEM

G & O JOB NO.: 24458  
FILE: PLAN & PROFILE.DWG

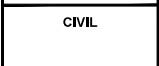

**CIVIL**  
**PLAN & PROFILE NE 2ND PLACE**

SHEET: **C-8** OF **13**