



COLOR SPECS

	PMS RED 485C
	BLACK
	WHITE
	BELDEN 461-463 VELOUR BRICK

FABRICATE AND INSTALL (1) DOUBLE FACE ILLUMINATE MONUMENT SIGN WITH:

- (1) 48" X 96" .090" ALUMINUM CABINET/PAINTED BLACK
16" WIDE BODY EXTRUSION /1-1/2" RETAINER
LED LIGHTING
- (2) 3/16" WHITE POLYCARBONATE FACES W/
UV LAMINATED DIGITAL PRINTED VINYL OVERLAYS
1-1/2" REVEAL/PAINTED BLACK
2" X 99" X 26" CONCRETE CAP
22.5" X 98" X 23.5" WIDE BRICK BASE
- (2) SETS OF .25" THICK ALUMINUM ADDRESS #'s /PAINTED BLACK
FLUSH STUD MOUNT TO BRICK
STEEL POST MOUNT BURIED IN NEW CONCRETE FOUNDATION

96" CABINET
99" CONCRETE CAP
98" BRICK BASE



PROPOSED

SIDE VIEW
16"
12"
26"
23.5"



NIGHT SIMULATION

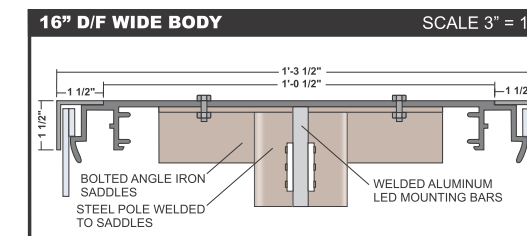

2240 Lansing Ave., Jackson, MI 49202
2900 Alpha Access St, Lansing, MI 48910
663 S Mansfield St., Ypsilanti, MI 48197
1965 Pine Creek Rd, Manistee, MI 49660
3750 Fortune Blvd, Saginaw, MI 48603
517-784-3720 | www.johnsonsign.com

JOB NAME:
Madison Heights United

Methodist Church

LOCATION:
246 E 11 Mile Rd
Madison Heights, MI 48071

ACCOUNT REP: WILL

DESIGNER: L EAGLE

REVISION: _____

NOTES:
FURNISH & INSTALL
THE FOLLOWING

FILE NAME:
243130-01A

SCALE:
3/4"=1'

This design and all material appearing hereon constitute the original unpublished work of Johnson Sign Co. may not be duplicated, used or disclosed without written consent.



THIS SIGN IS INTENDED TO BE MANUFACTURED IN ACCORDANCE WITH ARTICLE 600 OF THE NATIONAL ELECTRICAL CODE AND/OR OTHER APPLICABLE LOCAL CODES. THIS INCLUDES PROPER GROUNDING & BONDING OF THE SIGN. SIGN WILL BEAR UL LABEL(S).

JOHNSON SIGN CO
DOES NOT PROVIDE
PRIMARY ELECTRIC
TO SIGN LOCATION
RESPONSIBILITY OF OTHERS

CUSTOMER APPROVAL: _____

DATE: _____





COLOR SPECS



PMS RED 485C
BLACK



WHITE
BELDEN 461-463 VELOUR BRICK

FABRICATE AND INSTALL (1) DOUBLE FACE ILLUMINATE MONUMENT SIGN WITH:

- (1) 48" X 96" .090" ALUMINUM CABINET/PAINTED BLACK
- 16" WIDE BODY EXTRUSION /1-1/2" RETAINER
- LED LIGHTING
- TOP SIGN: (2) 23.5"VO X 93"VO X 3/16" WHITE POLYCARBONATE FACES W/ UV LAMINATED DIGITAL PRINTED VINYL OVERLAYS
- 1-1/2" DIVIDER BAR
- 20"X 93" CHANGEABLE COPY / 6" LETTERS & TRACK /LOCKING VANDAL COVER
- 2" REVEAL/PAINTED BLACK
- 2" X 99" X 26" CONCRETE CAP
- 22.5" X 98" X 23.5" WIDE BRICK BASE
- (2) SETS OF .25" THICK ALUMINUM ADDRESS #'s /PAINTED BLACK
- FLUSH STUD MOUNT TO BRICK
- STEEL POST MOUNT BURIED IN NEW CONCRETE FOUNDATION

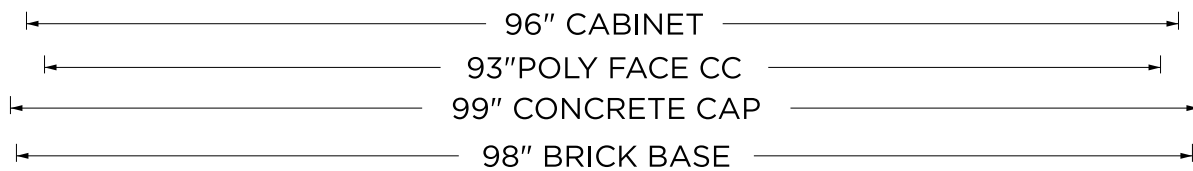

PROPOSED

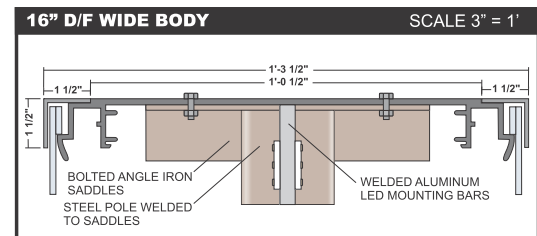
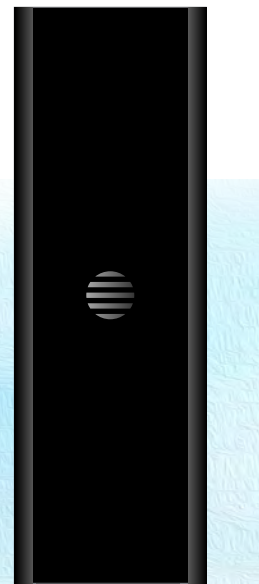
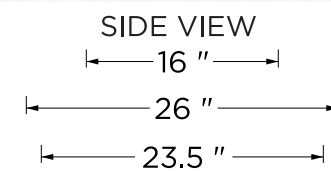

2240 Lansing Ave., Jackson, MI 49202
2900 Alpha Access St, Lansing, MI 48910
663 S Mansfield St., Ypsilanti, MI 48197
1965 Pine Creek Rd, Manistee, MI 49660
3750 Fortune Blvd, Saginaw, MI 48603
517-784-3720 | www.johnsonsign.com

JOB NAME:
Madison Heights United
Methodist Church

LOCATION:
246 E 11 Mile Rd
Madison Heights, MI 48071

ACCOUNT REP: WILL

DESIGNER: L EAGLE

REVISION: _____

NOTES:
FURNISH & INSTALL
THE FOLLOWING

FILE NAME:
243130-01B

SCALE:
3/4"=1'

This design and all material appearing hereon constitute the original unpublished work of Johnson Sign Co. may not be duplicated, used or disclosed without written consent.



THIS SIGN IS INTENDED TO BE MANUFACTURED IN ACCORDANCE WITH ARTICLE 600 OF THE NATIONAL ELECTRICAL CODE AND/OR OTHER APPLICABLE LOCAL CODES. THIS INCLUDES PROPER GROUNDING & BONDING OF THE SIGN. SIGN WILL BEAR UL LABEL(S).

JOHNSON SIGN CO
DOES NOT PROVIDE
PRIMARY ELECTRIC
TO SIGN LOCATION
RESPONSIBILITY OF OTHERS

CUSTOMER APPROVAL: _____

DATE: _____

