

NF
ENGINEERS
CIVIL ENGINEERS
LAND SURVEYORS
LAND PLANNERS

NOWAK & FRAUS ENGINEERS
46777 WOODWARD AVE.
PONTIAC, MI 48342-5032
TEL. (248) 332-7931
FAX. (248) 332-8257
WWW.NOWAKFRAUS.COM

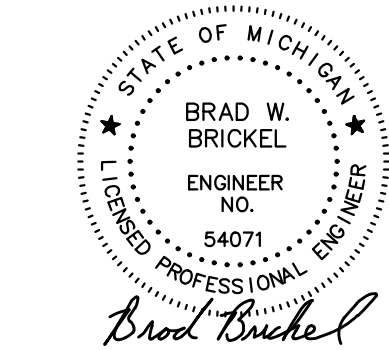

PROJECT
2024 Downtown Streetscape-
11 Mile Rd.
(John R. Rd.- Lorenz St.)

CLIENT
City of Madison Heights
300 W. 13 Mile Rd.
Madison Hts., MI 48071
Contact:
Mr. Giles Tucker
Ph: 248-583-0831
Fax: 248-583-4143

PROJECT LOCATION
Part of the SW $\frac{1}{4}$ of
Section 13, T. 1 N., R. 11 E.,
City of Madison Heights,
Oakland County, MI

SHEET
Conceptual Engineering
Plan (Option 3 -
3 Lane w/ Parking)



DATE ISSUED/REVISED
02-12-24 ISSUED FOR CITY REVIEW
04-04-24 REVISED PER CITY REVIEW
06-03-24 REVISED PER CITY REVIEW

DRAWN BY:
R. Johnson

DESIGNED BY:
B. Brickel

APPROVED BY:
B. Brickel

DATE:
January 24, 2024

SCALE: 1" = 20'

20 10 0 10 20 30

NFE JOB NO.

SHEET NO.

N753

C1

OPTION 3

CONVERT FOUR LANE ROADWAY INTO A ONE LANE IN EACH DIRECTION WITH A CETER LEFT TURN LANE AND ADJACENT PARALLEL PARKING SPACES ALONG THE ROADWAY FRONTAGE FROM GROVELAND AVENUE TO LORENZ AVENUE. INSTALL NEW STREETSCAPE PLANTINGS AND AMENITIES. THIS WILL ALSO CONSIST OF INSTALLING A 10 FOOT WIDE SHARED USE PATHWAY ON THE NORTH SIDE AND A 6 FOOT WIDE PEDESTRIAN PATHWAY ON THE SOUTH SIDE OF 11 MILE ROAD.

PAVING LEGEND

	PROPOSED CONCRETE PAVEMENT
	PROPOSED ASPHALT PAVEMENT

LEGEND

	MANHOLE		EXISTING SANITARY SEWER
	HYDRANT		SAN. CLEAN OUT
	GATE VALVE		EXISTING WATERMAIN
	MANHOLE CATCH BASIN		EXISTING STORM SEWER
	UTILITY POLE		EX. R. Y. CATCH BASIN
	GUY POLE		EXISTING BURIED CABLES
	GUY WIRE		OVERHEAD LINES
	SIGN		LIGHT POLE
	EXISTING GAS MAIN		PR. SANITARY SEWER
	PR. WATER MAIN		PR. STORM SEWER
	PR. R. Y. CATCH BASIN		PROPOSED LIGHT POLE
	PR. TOP OF CURB ELEVATION		PR. GUTTER ELEVATION
	PR. TOP OF WALK ELEVATION		PR. TOP OF PWMT. ELEVATION
	PR. FINISH GRADE ELEVATION		

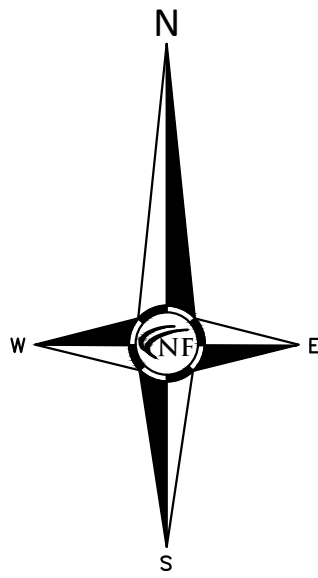
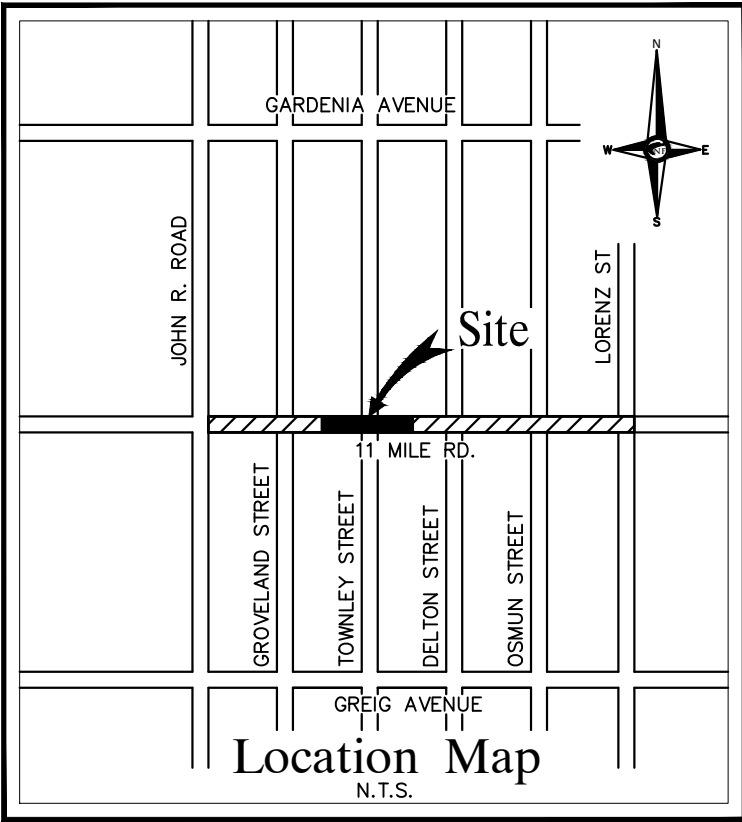
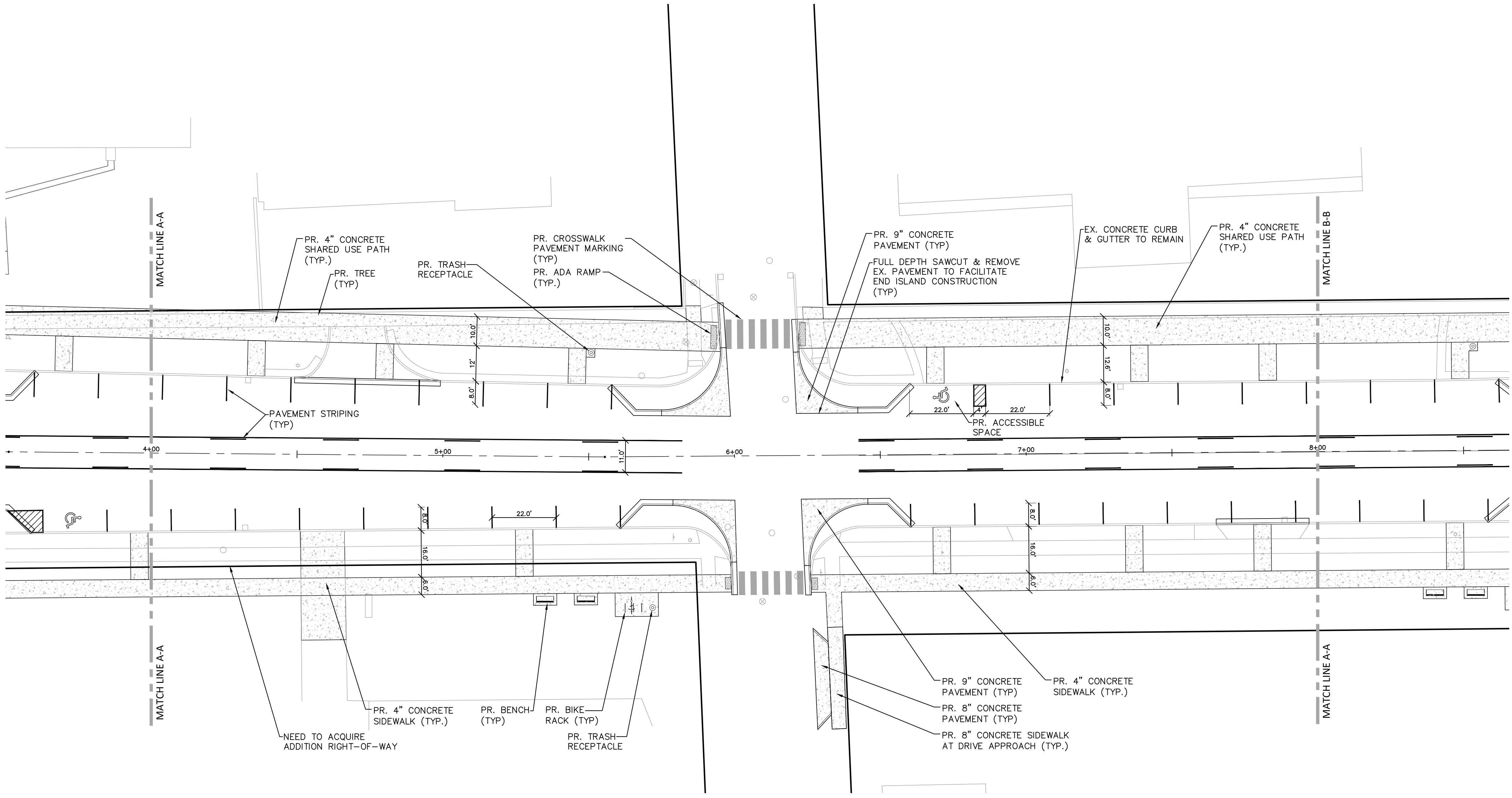

NF
ENGINEERS
CIVIL ENGINEERS
LAND SURVEYORS
LAND PLANNERS

NOWAK & FRAUS ENGINEERS
46777 WOODWARD AVE.
PONTIAC, MI 48342-5032
TEL. (248) 332-7931
FAX. (248) 332-8257
WWW.NOWAKFRAUS.COM

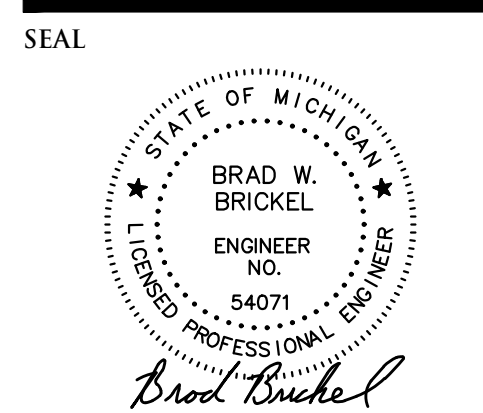

PROJECT
2024 Downtown Streetscape-
11 Mile Rd.
(John R. Rd.- Lorenz St.)

CLIENT
City of Madison Heights
300 W. 13 Mile Rd.
Madison Hts., MI 48071
Contact:
Mr. Giles Tucker
Ph: 248-583-0831
Fax: 248-583-4143

PROJECT LOCATION
Part of the SW $\frac{1}{4}$ of
Section 13, T. 1 N., R. 11 E.,
City of Madison Heights,
Oakland County, MI

SHEET
Conceptual Engineering
Plan (Option 3 -
3 Lane w/ Parking)



DATE ISSUED/REVISED
02-12-24 ISSUED FOR CITY REVIEW
04-04-24 REVISED PER CITY REVIEW
06-03-24 REVISED PER CITY REVIEW

DRAWN BY:
R. Johnson
DESIGNED BY:
B. Brickel
APPROVED BY:
B. Brickel
DATE:
January 24, 2024
SCALE: 1" = 20'
NFE JOB NO. SHEET NO.
N753 C2

OPTION 3
CONVERT FOUR LANE ROADWAY INTO A ONE LANE IN EACH DIRECTION WITH A CETER LEFT TURN LANE AND ADJACENT PARALLEL PARKING SPACES ALONG THE ROADWAY FRONTAGE FROM GROVELAND AVENUE TO LORENZ AVENUE. INSTALL NEW STREETSCAPE PLANTINGS AND AMENITIES. THIS WILL ALSO CONSIST OF INSTALLING A 10 FOOT WIDE SHARED USE PATHWAY ON THE NORTH SIDE AND A 6 FOOT WIDE PEDESTRIAN PATHWAY ON THE SOUTH SIDE OF 11 MILE ROAD.

PAVING LEGEND

	PROPOSED CONCRETE PAVEMENT
	PROPOSED ASPHALT PAVEMENT

LEGEND

MANHOLE	EXISTING SANITARY SEWER
HYDRANT	SAN. CLEAN OUT
GATE VALVE	EXISTING WATERMAIN
MANHOLE CATCH BASIN	EXISTING STORM SEWER
UTILITY POLE	EX. R. Y. CATCH BASIN
GUY POLE	EXISTING BURIED CABLES
GUY WIRE	OVERHEAD LINES
SIGN	LIGHT POLE
EXISTING GAS MAIN	
PR. SANITARY SEWER	
PR. WATER MAIN	
PR. STORM SEWER	
PR. R. Y. CATCH BASIN	
PROPOSED LIGHT POLE	
PR. TOP OF CURB ELEVATION	
PR. GUTTER ELEVATION	
PR. TOP OF WALK ELEVATION	
PR. TOP OF PWMT. ELEVATION	
FINISH GRADE ELEVATION	

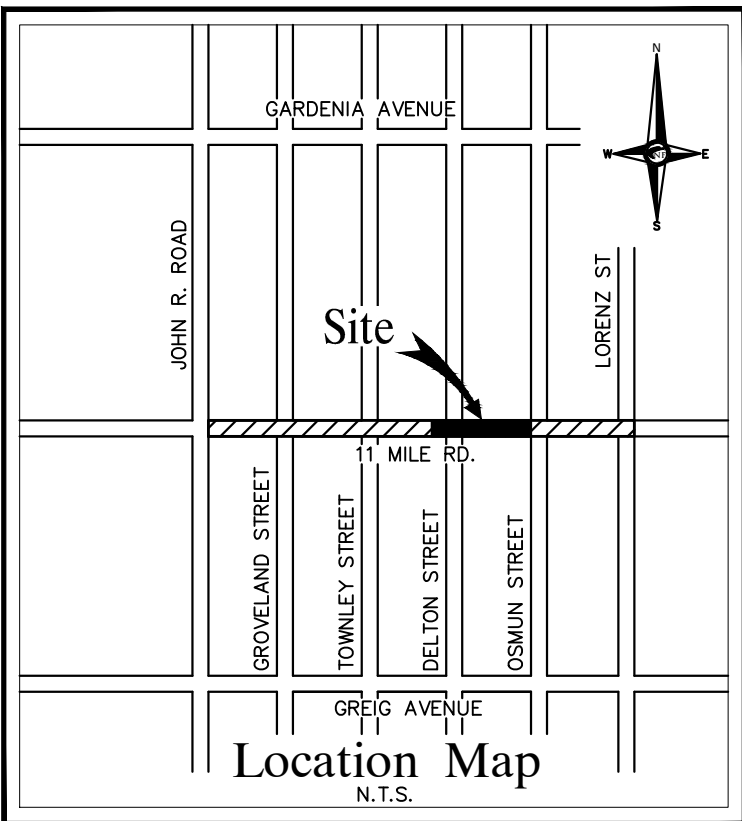

NF
ENGINEERS
CIVIL ENGINEERS
LAND SURVEYORS
LAND PLANNERS

NOWAK & FRAUS ENGINEERS
46777 WOODWARD AVE.
PONTIAC, MI 48342-5032
TEL. (248) 332-7931
FAX. (248) 332-8257
WWW.NOWAKFRAUS.COM

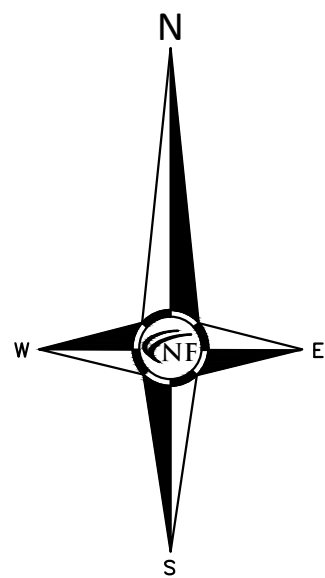

SEAL

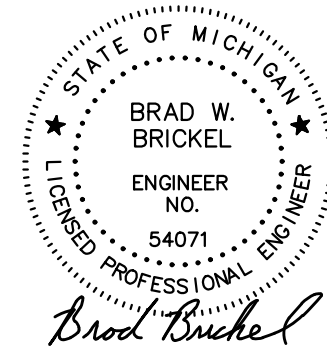

PROJECT
2024 Downtown Streetscape-
11 Mile Rd.
(John R. Rd.- Lorenz St.)

CLIENT
City of Madison Heights
300 W. 13 Mile Rd.
Madison Hts., MI 48071
Contact:
Mr. Giles Tucker
Ph: 248-583-0831
Fax: 248-583-4143

PROJECT LOCATION
Part of the SW $\frac{1}{4}$ of
Section 13, T. 1 N., R. 11 E.,
City of Madison Heights,
Oakland County, MI

SHEET
Conceptual Engineering
Plan (Option 3 -
3 Lane w/ Parking)



Know what's below
Call before you dig.

DATE ISSUED/REVISED
02-12-24 ISSUED FOR CITY REVIEW
04-04-24 REVISED PER CITY REVIEW
06-03-24 REVISED PER CITY REVIEW

DRAWN BY:
R. Johnson
DESIGNED BY:
B. Brickel
APPROVED BY:
B. Brickel

DATE:
January 24, 2024

SCALE: 1" = 20'

20 10 0 10 20 30

NFE JOB NO. SHEET NO.

N753 C3

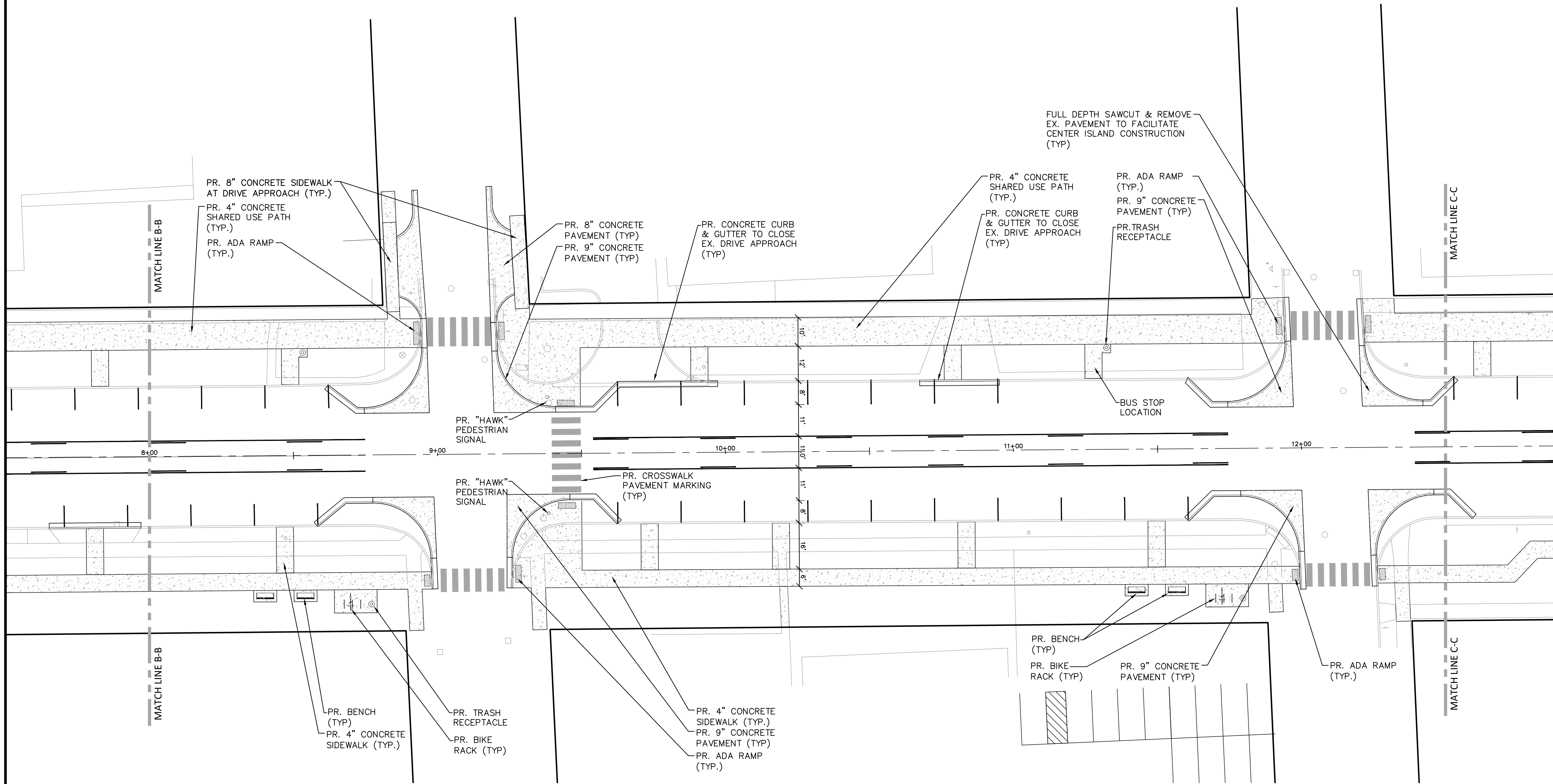

OPTION 3

CONVERT FOUR LANE ROADWAY INTO A ONE LANE IN EACH DIRECTION WITH A CETER LEFT TURN LANE AND ADJACENT PARALLEL PARKING SPACES ALONG THE ROADWAY FRONTAGE FROM GROVELAND AVENUE TO LORENZ AVENUE. INSTALL NEW STREETSCAPE PLANTINGS AND AMENITIES. THIS WILL ALSO CONSIST OF INSTALLING A 10 FOOT WIDE SHARED USE PATHWAY ON THE NORTH SIDE AND A 6 FOOT WIDE PEDESTRIAN PATHWAY ON THE SOUTH SIDE OF 11 MILE ROAD.

PAVING LEGEND

	PROPOSED CONCRETE PAVEMENT
	PROPOSED ASPHALT PAVEMENT

LEGEND

	MANHOLE		EXISTING SANITARY SEWER
	HYDRANT		SAN. CLEAN OUT
	GATE VALVE		EXISTING WATERMAIN
	MANHOLE CATCH BASIN		EXISTING STORM SEWER
	UTILITY POLE		EX. R. Y. CATCH BASIN
	GUY POLE		EXISTING BURIED CABLES
	GUY WIRE		OVERHEAD LINES
	SIGN		LIGHT POLE
	EXISTING GAS MAIN		PR. SANITARY SEWER
	C.O. MANHOLE		PR. WATER MAIN
	INLET		PR. STORM SEWER
	C.B. MANHOLE		PR. R. Y. CATCH BASIN
	PROPOSED LIGHT POLE		PR. TOP OF CURB ELEVATION
	TC 600.00		PR. GUTTER ELEVATION
	GU 600.00		PR. TOP OF WALK ELEVATION
	TW 600.00		PR. TOP OF PWMT. ELEVATION
	TP 600.00		FINISH GRADE ELEVATION
	FG 600.00		

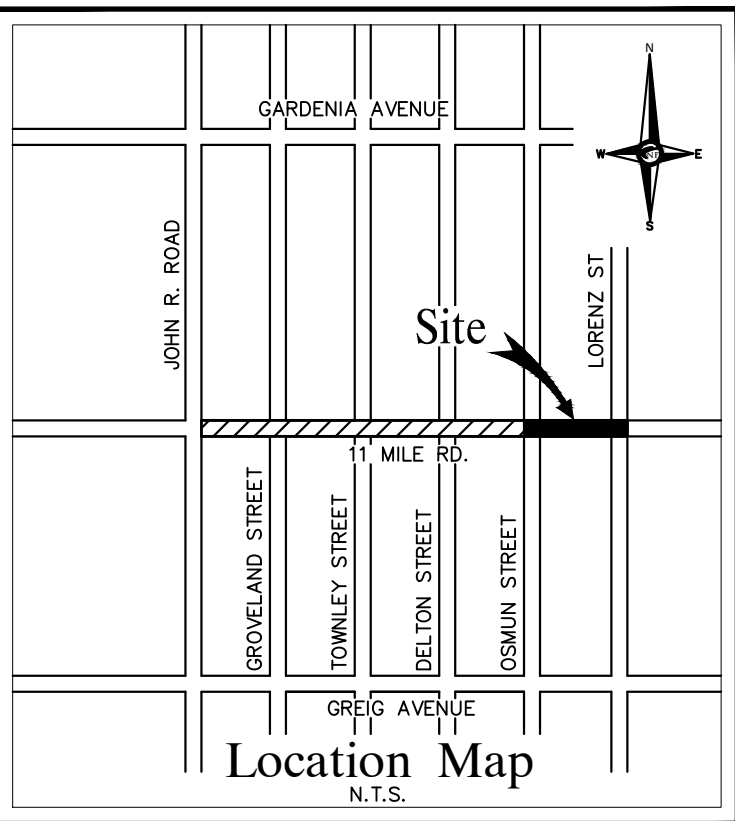
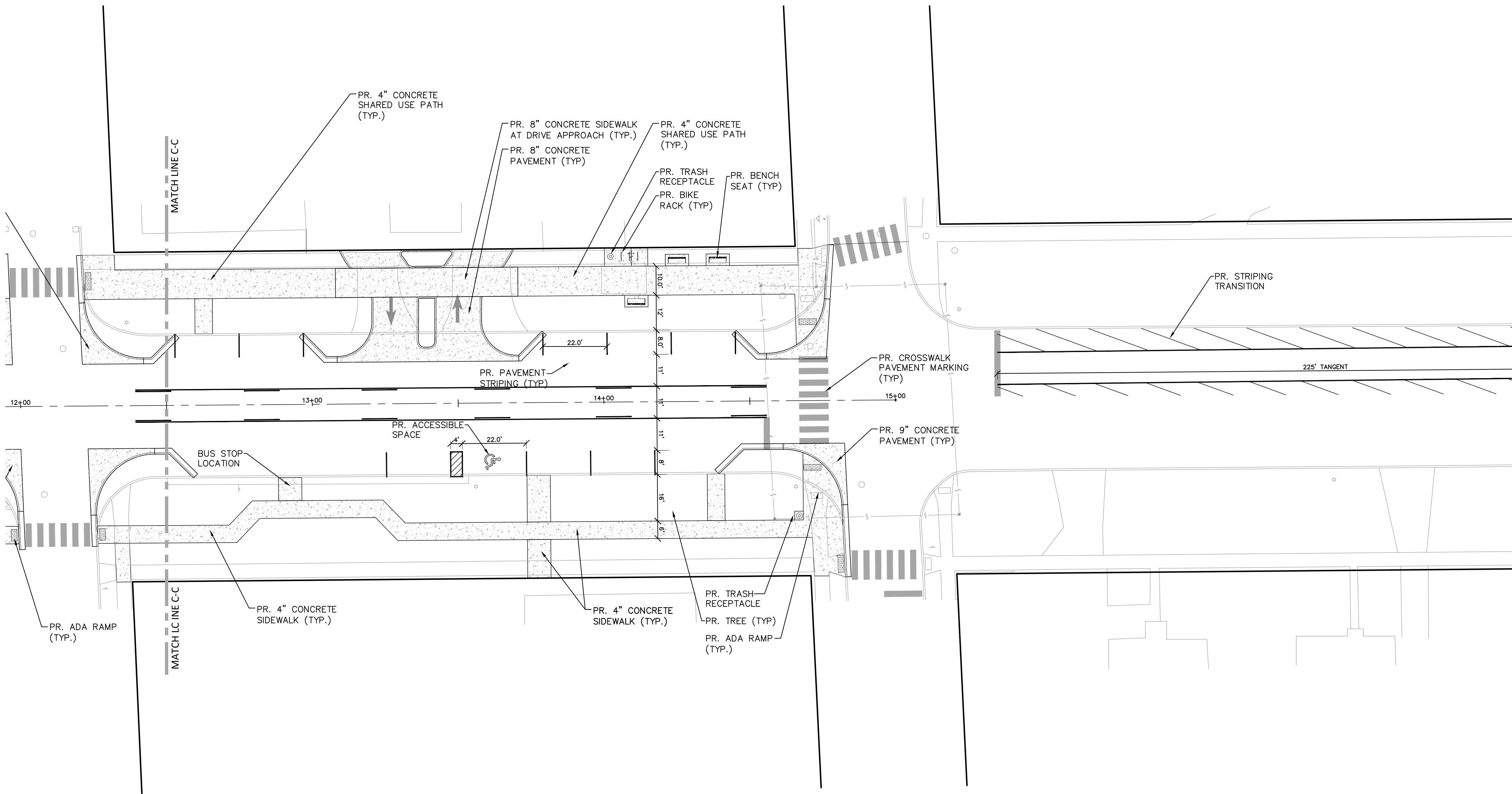

NF ENGINEERS
CIVIL ENGINEERS
LAND SURVEYORS
LAND PLANNERS

NOWAK & FRAUS ENGINEERS
46777 WOODWARD AVE.
PONTIAC, MI 48342-5032
TEL. (248) 332-7931
FAX. (248) 332-8257
WWW.NOWAKFRAUS.COM

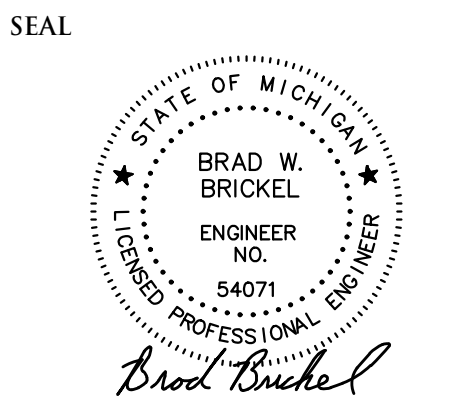
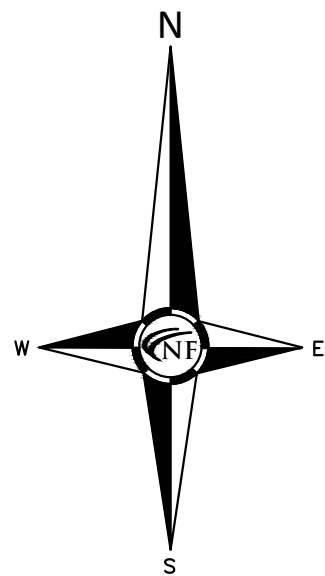

PROJECT
2024 Downtown Streetscape-
11 Mile Rd.
(John R. Rd.- Lorenz St.)

CLIENT
City of Madison Heights
300 W. 13 Mile Rd.
Madison Hts., MI 48071
Contact:
Mr. Giles Tucker
Ph: 248-583-0831
Fax: 248-583-4143

PROJECT LOCATION
Part of the SW $\frac{1}{4}$ of
Section 13, T. 1 N., R. 11 E.,
City of Madison Heights,
Oakland County, MI

SHEET
Conceptual Engineering
Plan (Option 3 -
3 Lane w/ Parking)

OPTION 3

CONVERT FOUR LANE ROADWAY INTO A ONE LANE IN EACH DIRECTION WITH A CETER LEFT TURN LANE AND ADJACENT PARALLEL PARKING SPACES ALONG THE ROADWAY FRONTAGE FROM GROVELAND AVENUE TO LORENZ AVENUE. INSTALL NEW STREETSCAPE PLANTINGS AND AMENITIES. THIS WILL ALSO CONSIST OF INSTALLING A 10 FOOT WIDE SHARED USE PATHWAY ON THE NORTH SIDE AND A 6 FOOT WIDE PEDESTRIAN PATHWAY ON THE SOUTH SIDE OF 11 MILE ROAD.

PAVING LEGEND

	PROPOSED CONCRETE PAVEMENT
	PROPOSED ASPHALT PAVEMENT

LEGEND

MANHOLE	EXISTING SANITARY SEWER
HYDRANT	SAN. CLEAN OUT
GATE VALVE	EXISTING WATERMAIN
MANHOLE CATCH BASIN	EXISTING STORM SEWER
UTILITY POLE	EX. R. Y. CATCH BASIN
GUY POLE	EXISTING BURIED CABLES
GUY WIRE	OVERHEAD LINES
SIGN	LIGHT POLE
EXISTING GAS MAIN	PR. SANITARY SEWER
PR. WATER MAIN	PR. STORM SEWER
PR. R. Y. CATCH BASIN	PROPOSED LIGHT POLE
PR. TOP OF CURB ELEVATION	PR. TOP OF WALK ELEVATION
PR. GUTTER ELEVATION	PR. TOP OF PWMT. ELEVATION
PR. FINISH GRADE ELEVATION	



DATE	ISSUED/REVISED
02-12-24	ISSUED FOR CITY REVIEW
04-04-24	REVISED PER CITY REVIEW
06-03-24	REVISED PER CITY REVIEW

DRAWN BY:
R. Johnson
DESIGNED BY:
B. Brickel
APPROVED BY:
B. Brickel

DATE:
January 24, 2024

SCALE: 1" = 20'

NFE JOB NO. SHEET NO.

N753 C4