



**CITY OF MADISON HEIGHTS
COMMUNITY DEVELOPMENT DEPARTMENT
PETITION FOR USE PERMITTED BY
SPECIAL APPROVAL**

| | |
|-----------------------------|--------------|
| FOR OFFICE USE ONLY | |
| Request <u>PSP 24-003</u> | No: _____ |
| Date <u>3/27/24</u> | Filed: _____ |
| Approved by _____ | CDD: _____ |
| Approved for Hearing: _____ | |

I (we) the under signed, do hereby apply and petition the City of Madison Heights for a Special Approval Use Permit and provide the following information.

(Application must be typed)

Building Address: 28245 John R Tax ID No.: 44 - 25 - - -

APPLICANT INFORMATION

Name: Steve Gunn
Phone No.: 586-292-0662 Fax No.: n/a
Mailing Address: 28245 John R. City, State, Zip: Madison Heights, MI 48071
(Notices will be mailed to this address)
Driver's License No.: G 500 777 603 564 Date of Birth: 7-17-1978
Interest in Property: Owner

BUILDING & BUSINESS INFORMATION

Zoning District: B-3 Use Requested Pursuant to Section _____ of the Zoning Ordinance
Explain Requested Use in Detail: Replace existing 4 widely spaced exterior vacuums with one new central indoor vac system able to run 8 exterior vacuum spots.

The above referenced parcel is known as: (Lots(s) Acreage Parcel (s)) lots 1-9 of kenmos park
Subdivision (if platted lot(s)) and is located on the N S E W (Circle One) side of _____ Street/Road between _____ Street/Road and _____ Street / Road.

Hours of Operation: 7:30-8:00
Property Frontage: 220 Width/Depth: 117 No. of Parking Spaces: 3 Private Lot _____ Shared Lot _____
No. of Floors: 1 Max. No. of Employees: 2 Male _____ Female _____ No. on Largest Single Shift: 2
No. of Seats for Restaurant or Assembly Uses: n/a Capacity of Waiting Area: n/a
Building: New _____ or Existing X Will Additions or Alterations to the Building be Required? no
Explain: no alterations to the building
Describe Any Other Site Improvements to be Made: n/a

Building Owner Name: Steve Gunn Phone No.: 586-292-0662 Fax No.: _____
Mailing Address: 28245 John R City: madison heights Zip: 48071
(Notices will be mailed to this address)

Note: All blanks and boxes above must be completed. Use N/A where appropriate.
CONTINUED ON REVERSE SIDE



**PETITION FOR USE PERMITTED BY
SPECIAL APPROVAL (Continued)**

Include one (1) copies of a site plan, no larger than 11 x 17 inches, which meets the requirements of Section 10.514 of the Zoning Ordinance of Madison Heights and the required seven hundred and fifty dollar fee (\$750.00) plus a site plan application.

This petition / application must be signed by both the Owner in Fee of the property and the Applicant prior to submittal. Applicant(s) and property owner(s) hereby consent to city staff, board and commission members, and contractors to access the property for purposes of evaluating the site for the requested action(s).

FOR THE OWNER:

Signature

Printed

Steve Gunn

Name

Date

3-27-24

FOR THE APPLICANT IF NOT THE OWNER:

Signature

Printed

Name

Date

NOTARY:

On this

27

day of

March

Before me personally appeared

Steven Gunn

to me known to be the

person who executed the forgoing instrument, and

acknowledged that he executed the same as his free act

and deed.

Notary's

Signature

Notary's

Printed Name

Jessica Prather

Notary public, State of Michigan,

County of

Macomb

My commission expires

3.14.26

Acting in the County of

Oakland

NOTARY:

On this

day of

Before me personally appeared

to me known to be the

person who executed the forgoing instrument, and

acknowledged that he executed the same as his free act

and deed.

Notary's

Signature

Notary's

Printed Name

Notary public, State of Michigan,

County of

My commission expires

Acting in the County of

OFFICE USE ONLY

\$750.00 Fee Paid

Receipt Number

By

Date:

One Site Plan Attached no larger than 11 x 17 inches

☐

Yes

☐

No

Site Plan Application:

Date:

Copies to C.D.D.

Notices Mailed to Properties Within 500 Feet

Council Action

Meeting Date

THIS DRAWING IS PRELIMINARY AND NOT TO BE USED FOR CONSTRUCTION

GENERAL NOTES

Preliminary Drawings:

Preliminary drawings may be provided with a quote to indicate the location of vacuum equipment, piping, and hoses. Drawings may be used in direct coordination with Architects' and Engineers' plans for city/AHJ/client approval. Accurate and complete site plans must be provided to ensure the quality of your vacuum area to coordinate issues such as vacuum parking space width/angle, traffic flow, and hose reach.

Drawings are preliminary until the final system order is signed by the client.

Changes made to a vacuum system without Vacutech's consultation voids all Vacutech responsibility as well as the system warranty.

INSTALLATION NOTES

Installation By Others:

Installation drawings are provided with each project. Most projects require 2 or more installers and a forklift. Buried pipe, footings and concrete equipment pad(s) should be completed before installing Vacutech systems. J-bolt template kits for footings for vacuum arches and stanchions are available for purchase from Vacutech. Refer to drawings for footing requirements. Changes to vacuum piping, vacuum equipment location, and vacuum equipment enclosure will effect the performance of your system. Changes made to a vacuum system without Vacutech's consultation voids all Vacutech responsibility and the system warranty.

Vacutech System Install:

Vacutech offers installation as an option when bidding a project.

Please note that the scope of Vacutech's installation only includes work above ground. Vacutech will install vacuum arches/stanchions to concrete footings, install vacuum piping and set vacuum equipment in place.

Vacutech does not dig trenches, auger footings, dig/backfill/bury pipe or conduit, or provide any work below grade.

Vacutech does not pour footings, install J-bolts, install concrete trenches with covers, pour concrete pads, pour grout or do concrete work of any kind. Vacutech does not do core drilling through walls or patch any type of wall coring.

Vacutech does not do any type of roof penetration sealing. I.e. rubber boots, flat room mating, or any other type of material.

Vacutech does not wire lights, turbines, disconnects, VFDs , starters or any other electrical component. Vacutech does not pull wire through conduits. These items must be done by a Licensed Electrician.

WARRANTY NOTES

CHANGES MADE TO VACUUM SYSTEM WITHOUT VACUTECH CONSULTATION
VOIDS ALL VACUTECH RESPONSIBILITY AND SYSTEM WARRANTY

Equipment warranty information:

(if applicable)
When vacuum equipment is installed in an enclosure with 4 walls and a roof it must be ventilated. Enclosure door must be louvered and an exhaust fan with thermostat set at 85°F must be installed to turn over air every 15 min. Vacuum turbine must be exhausted outside with metallic pipe no smaller than 6" with exhaust pipe opening protected from elements. Equipment pad must be flat and level.

Variable frequency drive (VFD) warranty information:

(if applicable)
VFDs must be wired from main distribution panel in separate conduit (sized per code; based on turbine H.P. and voltage) to each VFD and from each VFD to turbine motor.

A separate conduit, sized per code, must also be installed from VFD to vacuum pressure transducer installed on filter separator. If two (2) or more VFD's are installed in one (1) enclosure, a separate conduit must be installed for each VFD. Install separate conduit from enclosure to each turbine motor, and each filter separator if there is more than one (1).

PIPE NOTES

Piping systems above ground

Piping system shall be schedule 40 (or sch 80) solid core PVC or ABS plastic pipe, with plastic D.W.V. (drain, waste and vent) fittings. Zinc, aluminum, or galvanized tubing, with directional flow zinc fittings of no less than 16 gauge, designed specifically for central vacuum systems are also acceptable.

Buried piping systems cast iron no-hub

In-ground piping systems that are subject to ground freeze/thaw conditions or excessive movement shall be cast iron with no-hub fittings and no-hub couplings (w/ stainless steel band).

Buried piping systems PVC sch 40 (or sch 80)

In-ground piping systems using PVC pipe shall be sch 40 (or sch 80) solid core, with PVC D.W.V. (drain, waste, and vent) fittings. Plastic pipe installed in-ground have a potential of possible cracking and wear. All plastic pipe systems in-ground must be below freeze line.

System notes:

All interior surfaces shall be free of burrs and obstructions for a non-restrictive air flow.ABS and PVC piping shall be cut straight and removed of burrs. Piping shall be attached together using a primer, and a cement (clear PVC cement for PVC/ black abs cement for abs) for a 100% tight seal.

Overhead piping systems shall be supported by means of approved pipe hangers, and shall be installed at a maximum of six feet O.C. when using abs or PVC pipe and ten feet when using zinc or aluminum tubing. All fittings supporting vacuum drop/hose assemblies shall be supported with within one foot on each side of fitting connection.

Piping systems shall be tested to hold 10 psi for a minimum of 24 hours.

When vacuum system is installed in potentially explosive environment, the following may be required as a minimum: Explosion proof motor Class I - Group D & Class II - Group E, F & G. Aluminum piping with zinc fittings. Primary and filtered separators and hose assemblies require special grounding. Verify all conditions.

PVC and ABS plastic pipe are not U.V. rated and will discolor and soften/cause bowing when exposed to direct sunlight. It is recommended that all exposed plastic pipe and fittings be primed and painted to help prevent this. It is recommended to use zinc, or aluminum tubing and zinc fittings be used when exposed to sun.

Plastic pipe exposed to elements:

PVC pipe will become brittle at 40° f and can crack/split when moving debris collides with it, it is recommended to use cast iron, zinc, or aluminum tubing for colder conditions.

ADDITIONAL NOTES

VFD Systems:

Instructions for wiring VFD to Turbine and Filter Separator are available for your electrician. After wiring is complete, call our customer service to complete programming.

Arch Systems: How Awnings are ordered (Coolaroo/Weblon)

Step 1: Arches are to be completely installed on site.
Step 2: After installation, Vacutech will send an awning measurement form to be filled out with instructions on how and where to measure. The awning form must be filled out entirely, signed, dated, and faxed or emailed to Vacutech for production.
Step 3: Awnings are shipped to site w/ instructions.

Maintenance:

System longevity under continuous operation is extended by regular maintenance. Issues commonly result from failure to remove obstructions in the piping system, replace damaged or worn parts, or not regularly changing filter bags. Refer to Vacutech maintenance instructions

Assign a person to central vacuum maintenance:

To ensure continued trouble free central vacuum system operation and to avoid downtime during periods of heavy use, assign an employee to follow a strict maintenance schedule. Refer to Vacutech recommended maintenance schedule.

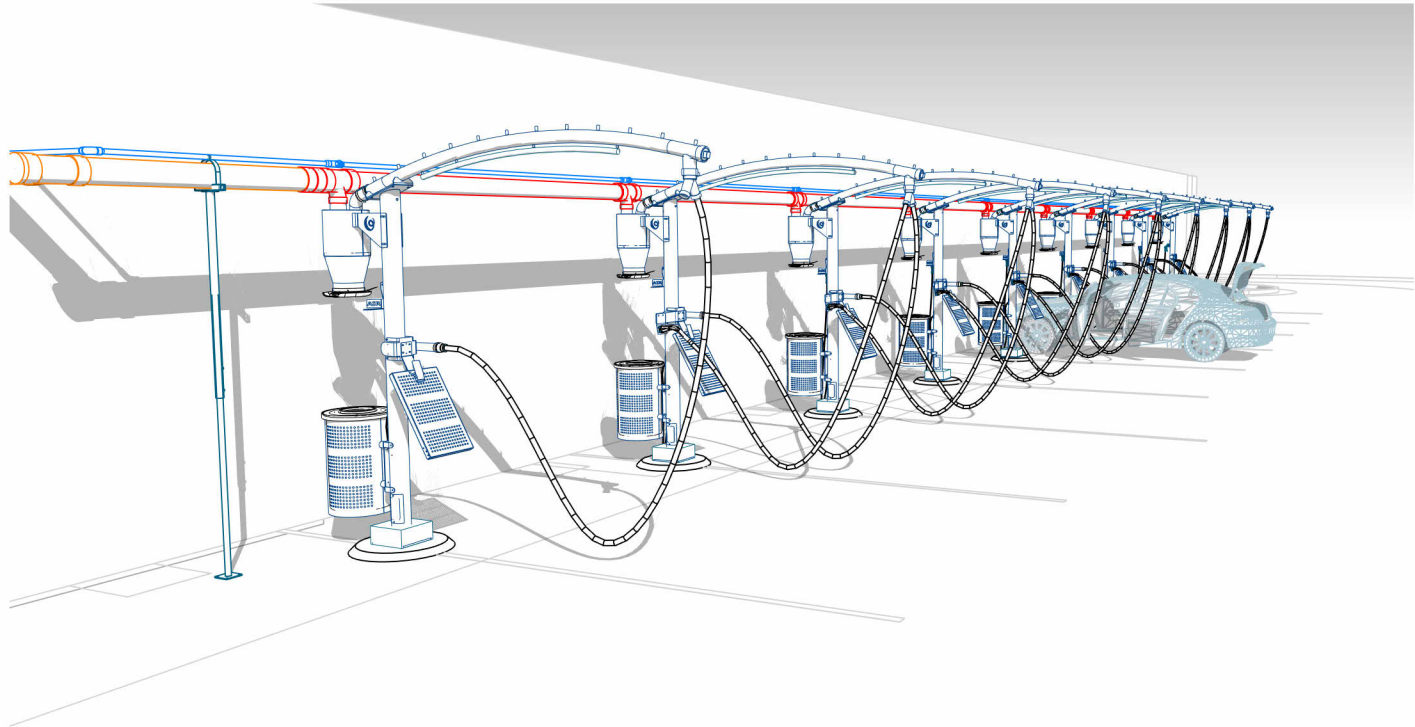

VACUTECH

Elevation: 500' ASL AN **NCS** COMPANY

SHEET INDEX

| NO. | NAME | REV. |
|------|-----------------------|------|
| V001 | COVER SHEET | 2 |
| V101 | OVERALL SITE PLAN | 2 |
| V111 | VACUUM SITE PLAN | 2 |
| V121 | VACUUM SITE ISOMETRIC | 2 |

THIS PRELIMINARY DRAWING IS THE PROPERTY OF VACUTECH AND IS NOT TO BE USED FOR CONSTRUCTION OR INSTALLATION WITHOUT WRITTEN CONSENT. WRITTEN CONSEN MAY NOT BE PROVIDED BY ANY PERSON, AGENCY, OR DEALER NOT AUTHORIZED BY VACUTECH.

VACUTECH
AN **NCS** COMPANY

1350 HI-TECH DRIVE
SHERIDAN, WY 82801
PHONE: (307) 675-1982
EMAIL: vacinfo@ncswash.com
WEB: www.vacutechllc.com

WASH POINTE CAR WASH

28245 JOHN R ROAD
MADISON HEIGHTS, MICHIGAN 48071

| # | Revision | By | Chk | Date |
|---|---|----|-----|---------|
| 1 | Added one vacuum space, rotated vacuum spaces to 90 degrees, decreased vacuum space width from 14 to 12 feet. | PK | RY | 5/30/24 |
| 2 | REMOVED VACUUM SPACE A9 | RY | TJ | 7/3/24 |
| | | | | |
| | | | | |
| | | | | |
| | | | | |
| | | | | |
| | | | | |

COVER SHEET

| | |
|----------------|---------|
| Project Number | 1510477 |
| Date | 5/20/24 |
| Drawn By | FM |
| Checked By | TJ |

V001

7/3/2024 12:43:14 PM

THIS DRAWING IS PRELIMINARY AND NOT TO BE USED FOR CONSTRUCTION

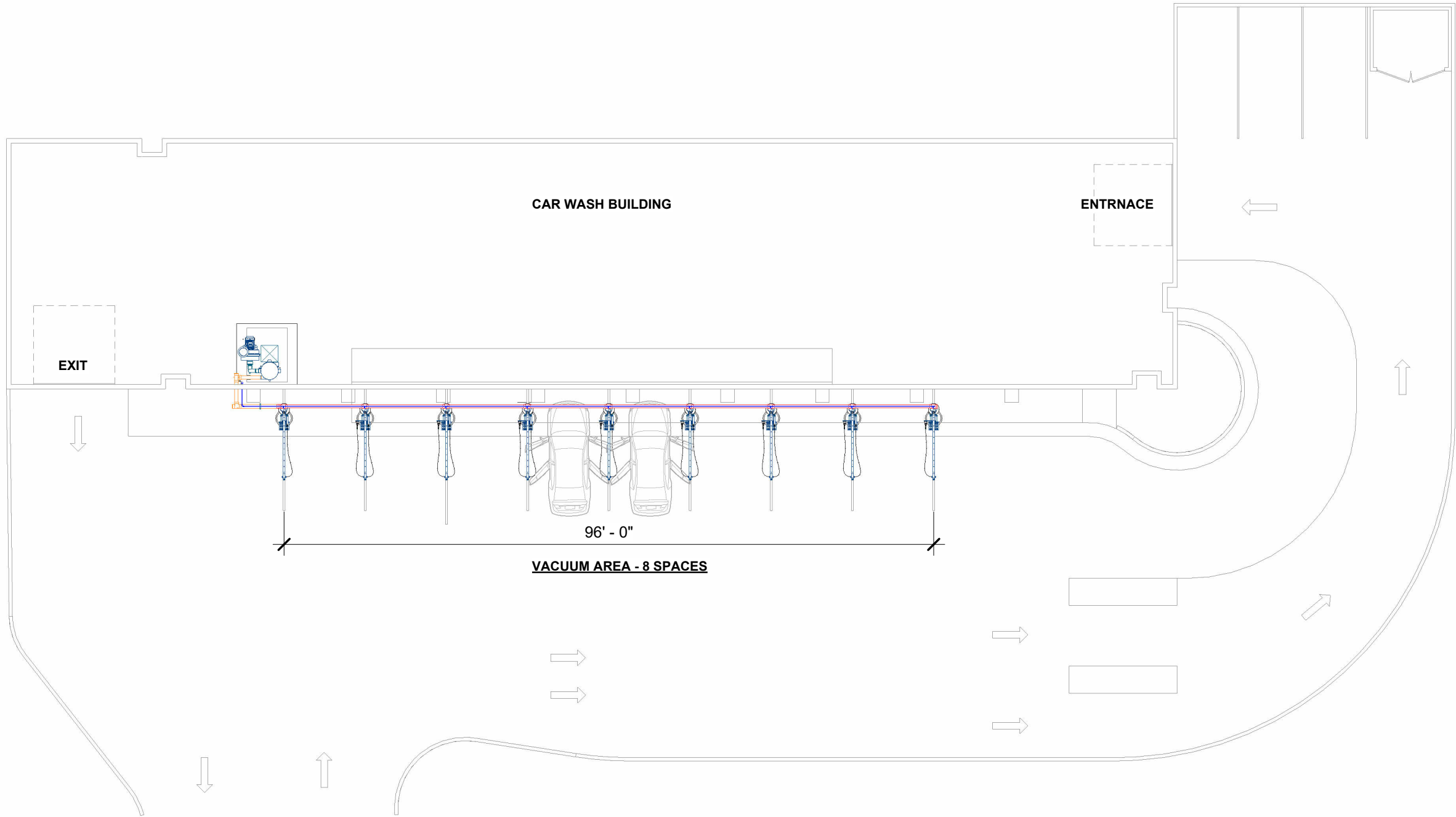

CONSTRUCTION NOTES

GENERAL NOTES:

- a. ALL DIMENSIONS TO BE FIELD VERIFIED BY OWNER
- b. IF VACUUM EQUIPMENT IS ENCLOSED WITH ROOF/CEILING, REFER TO VENTILATION REQUIREMENTS UNDER EQUIPMENT WARRANTY INFORMATION
- c. PIER DESIGN AND REINFORCEMENT FOR CONCEPTUAL USE ONLY. CONSULT STRUCTURAL ENGINEER IN YOUR AREA FOR SPECIFIC DESIGN CRITERIA.
- d. COMPLY WITH ALL STATE/ COUNTY BUILDING CODES IN YOUR AREA

EQUIPMENT & MATERIAL:

- a. RUN COMPRESSED AIR TO AIR COMPRESSOR LOCATION (BY OTHERS)
- b. WALL PENETRATION: CORE DRILLING MAY BE REQUIRED FIELD VERIFY HEIGHT
- c. 9'Lx9'Wx4"H MINIMUM FLAT AND LEVEL CONCRETE FLOOR SPACE REQUIRED FOR VACUUM EQUIPMENT VERIFY SEPARATOR WILL FIT THROUGH DOOR (48" CLEAR OPENING WIDTH RECOMMENDED)

VACUUM & PLUMBING:

- a. SUPPORT SCHEDULE 40 PVC OVERHEAD DRY/WET VACUUM PIPE EVERY 6' MAXIMUM; USE UNISTRUT & CLAMP OR OTHER SUPPORT (PROVIDED BY OTHERS)
- b. ALL FITTINGS TO BE 'DWV'

1 OVERALL SITE PLAN

THIS PRELIMINARY DRAWING IS THE PROPERTY OF VACUTECH AND IS NOT TO BE USED FOR CONSTRUCTION OR INSTALLATION WITHOUT WRITTEN CONSENT. WRITTEN CONSENT MAY NOT BE PROVIDED BY ANY PERSON, AGENCY, OR DEALER NOT AUTHORIZED BY VACUTECH.

VACUTECH
AN **NCS** COMPANY

1350 HI-TECH DRIVE
SHERIDAN, WY 82801
PHONE: (307) 675-1982
EMAIL: vacinfo@ncswash.com
WEB: www.vacutechllc.com

WASH POINTE CAR WASH

28245 JOHN R ROAD
MADISON HEIGHTS, MICHIGAN 48071

| # | Revision | By | Chk | Date |
|---|--|----|-----|---------|
| 1 | Added one vacuum space, rotated vacuum spaces to 90 degrees, decreased vacuum space width from 14 to 12 feet | PK | RY | 5/30/24 |
| 2 | REMOVED VACUUM SPACE A9 | RY | TJ | 7/3/24 |
| | | | | |
| | | | | |
| | | | | |
| | | | | |
| | | | | |

OVERALL SITE PLAN

| | |
|----------------|---------|
| Project Number | 1510477 |
| Date | 5/20/24 |
| Drawn By | FM |
| Checked By | TJ |

V101



7/3/2024 12:43:15 PM

THIS DRAWING IS PRELIMINARY AND NOT TO BE USED FOR CONSTRUCTION

VACUUM EQUIPMENT

| QTY | ITEM |
|-----|------------------------------|
| 1 | 40HP T4 DIRECT DRIVE TURBINE |
| 1 | 8" T4 INDOOR EXHAUST MUFFLER |
| 1 | 31x79 FILTER SEPARATOR |

VACUUM AREA

| QTY | ITEM |
|-----|---|
| 2 | SINGLE USER 'PROTEAN' ARCH |
| 7 | DUAL USER 'PROTEAN' ARCH |
| 8 | CREVICE VACUUM TOOL & HOLDER |
| 8 | DUO LOCK TOOL & HANGER |
| 8 | TOOL EXTENSION BRACKET |
| 16 | 1-1/2"x15' RAPIDLOCK HOSE |
| 9 | AIR NOZZLE & HOSE |
| 9 | AIR TOOL HANGER |
| 9 | 17" MAT RACK |
| 9 | 30 GALLON WASTE RECEPTACLE |
| 9 | 6' LED LIGHT |
| 1 | 96"-140" ADJUSTABLE OVERHEAD PIPE SUPPORT |

SITE PLAN

| ITEM | DESCRIPTION |
|------|--|
| 1 | 6" OVERHEAD SCH. 40 SOLID CORE PVC VACUUM PIPE |
| 2 | SINGLE USER PROTEAN ARCH REAR AT ENDS OF VACUUM SPACES |
| 3 | DUAL USER PROTEAN ARCH REAR BETWEEN VACUUM SPACES |
| 4 | 6" OVERHEAD ALUMINUM VACUUM TUBE |
| 5 | 15' HOSE REACH |
| 6 | 1" RAPID AIR COMPRESSED AIR LINE |

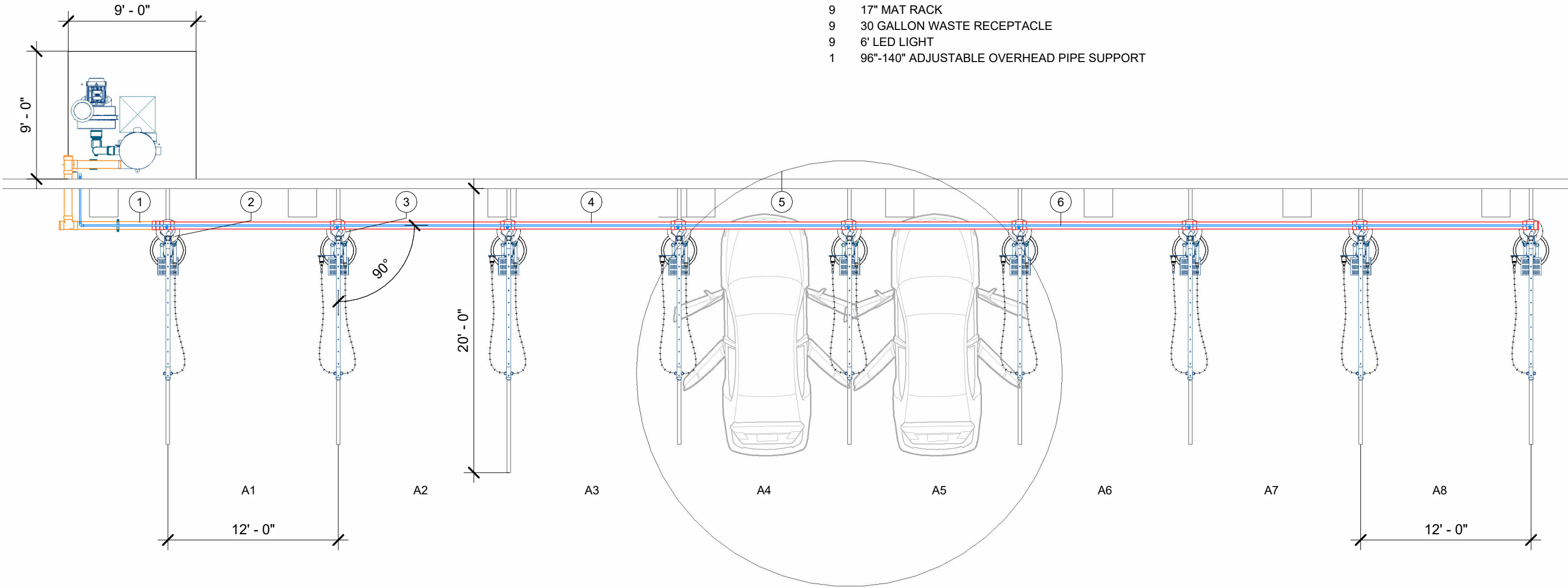

1 SITE PLAN

THIS PRELIMINARY DRAWING IS THE PROPERTY OF VACUTECH AND IS NOT TO BE USED FOR CONSTRUCTION OR INSTALLATION WITHOUT WRITTEN CONSENT. WRITTEN CONSENT MAY NOT BE PROVIDED BY ANY PERSON, AGENCY, OR DEALER NOT AUTHORIZED BY VACUTECH.

VACUTECH

AN **NCS** COMPANY

1350 HI-TECH DRIVE
SHERIDAN, WY 82801
PHONE: (307) 675-1982
EMAIL: vacinfo@ncswash.com
WEB: www.vacutechllc.com

WASH POINTE CAR WASH

28245 JOHN R ROAD
MADISON HEIGHTS, MICHIGAN 48071

| # | Revision | By | Chk | Date |
|---|---|----|-----|---------|
| 1 | Added one vacuum space, rotated vacuum spaces to 90 degrees, decreased vacuum space width from 14 to 12 feet. | PK | RY | 5/30/24 |
| 2 | REMOVED VACUUM SPACE A9 | RY | TJ | 7/3/24 |
| | | | | |
| | | | | |
| | | | | |
| | | | | |
| | | | | |

VACUUM SITE PLAN

| | |
|----------------|---------|
| Project Number | 1510477 |
| Date | 5/20/24 |
| Drawn By | FM |
| Checked By | TJ |

V111

THIS DRAWING IS PRELIMINARY AND NOT TO BE USED FOR CONSTRUCTION

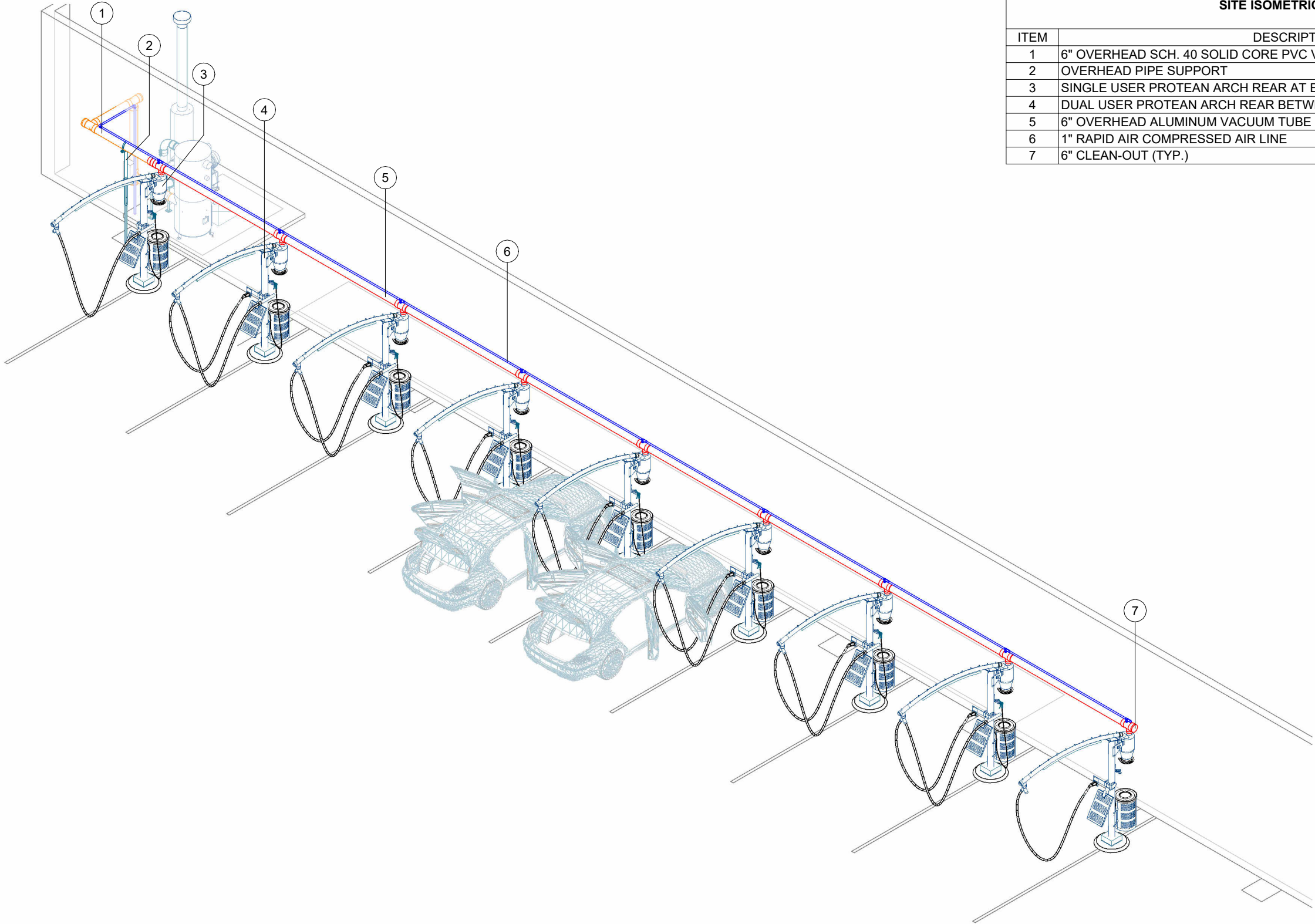

| SITE ISOMETRIC | |
|----------------|--|
| ITEM | DESCRIPTION |
| 1 | 6" OVERHEAD SCH. 40 SOLID CORE PVC VACUUM PIPE |
| 2 | OVERHEAD PIPE SUPPORT |
| 3 | SINGLE USER PROTEAN ARCH REAR AT ENDS OF VACUUM SPACES |
| 4 | DUAL USER PROTEAN ARCH REAR BETWEEN VACUUM SPACES |
| 5 | 6" OVERHEAD ALUMINUM VACUUM TUBE |
| 6 | 1" RAPID AIR COMPRESSED AIR LINE |
| 7 | 6" CLEAN-OUT (TYP.) |

1 SITE ISOMETRIC

THIS PRELIMINARY DRAWING IS THE PROPERTY OF VACUTECH AND IS NOT TO BE USED FOR CONSTRUCTION OR INSTALLATION WITHOUT WRITTEN CONSENT. WRITTEN CONSENT MAY NOT BE PROVIDED BY ANY PERSON, AGENCY, OR DEALER NOT AUTHORIZED BY VACUTECH.

VACUTECH

AN **NCS** COMPANY

1350 HI-TECH DRIVE
SHERIDAN, WY 82801
PHONE: (307) 675-1982
EMAIL: vacinfo@ncswash.com
WEB: www.vacutechllc.com

WASH POINTE CAR WASH

28245 JOHN R ROAD
MADISON HEIGHTS, MICHIGAN 48071

| # | Revision | By | Chk | Date |
|---|--|----|-----|---------|
| 1 | Added one vacuum space, rotated vacuum spaces to 90 degrees, decreased vacuum space width from 14 to 12 feet | PK | RY | 5/30/24 |
| 2 | REMOVED VACUUM SPACE A9 | RY | TJ | 7/3/24 |
| | | | | |
| | | | | |
| | | | | |
| | | | | |
| | | | | |

VACUUM SITE ISOMETRIC

Project Number1510477

Date5/20/24

Drawn ByFM

Checked ByTJ

V121

7/3/2024 12:43:17 PM



VACUTECH

SOUND LEVEL METER READINGS

MODEL: FT-DD-T440HP3 (40hp T4 VACSTAR TURBINE VACUUM PRODUCER)

READING ONE: 73 DB-A, 3 FEET FROM TURBINE @ 45° ANGLE
AND NO BACKGROUND NOISE OR OUTSIDE INTERFERENCE.

READING TWO: 69 DB-A, 10 FEET FROM TURBINE @ 45° ANGLE
AND NO BACKGROUND NOISE OR OUTSIDE INTERFERENCE.

READING THREE: 54 DB-A, 20 FEET FROM TURBINE @ 45° ANGLE
AND NO BACKGROUND NOISE OR OUTSIDE INTERFERENCE.

READING FOUR: 38 DB-A, 30 FEET FROM TURBINE @ 45° ANGLE
AND NO BACKGROUND NOISE OR OUTSIDE INTERFERENCE.

NOTE: THESE READINGS WERE TAKEN OUTSIDE OF 8'x10'x8' CINDER BLOCK ENCLOSURE WITH CONCRETE SLAB AND NO ROOF.

SOUND LEVEL METER USED:

SIMPSON MODEL #40003 – MSHA APPROVED.
MEETS OSHA & WALSH-HEALY REQUIREMENTS FOR NOISE CONTROL.
CONFORMS TO ANSI S1.4-1983, IEC 651 SPECS FOR METER TYPE.

Vacutech
1350 Hi-Tech Drive, Sheridan WY, 82801
PHONE: (800) 917-9444 FAX: (303) 675-1988
EMAIL: info@vacutechllc.com
WEB SITE: vacutechllc.com

SOUND INTENSITY VACUTECH T4, 40HP, DD TURBINE

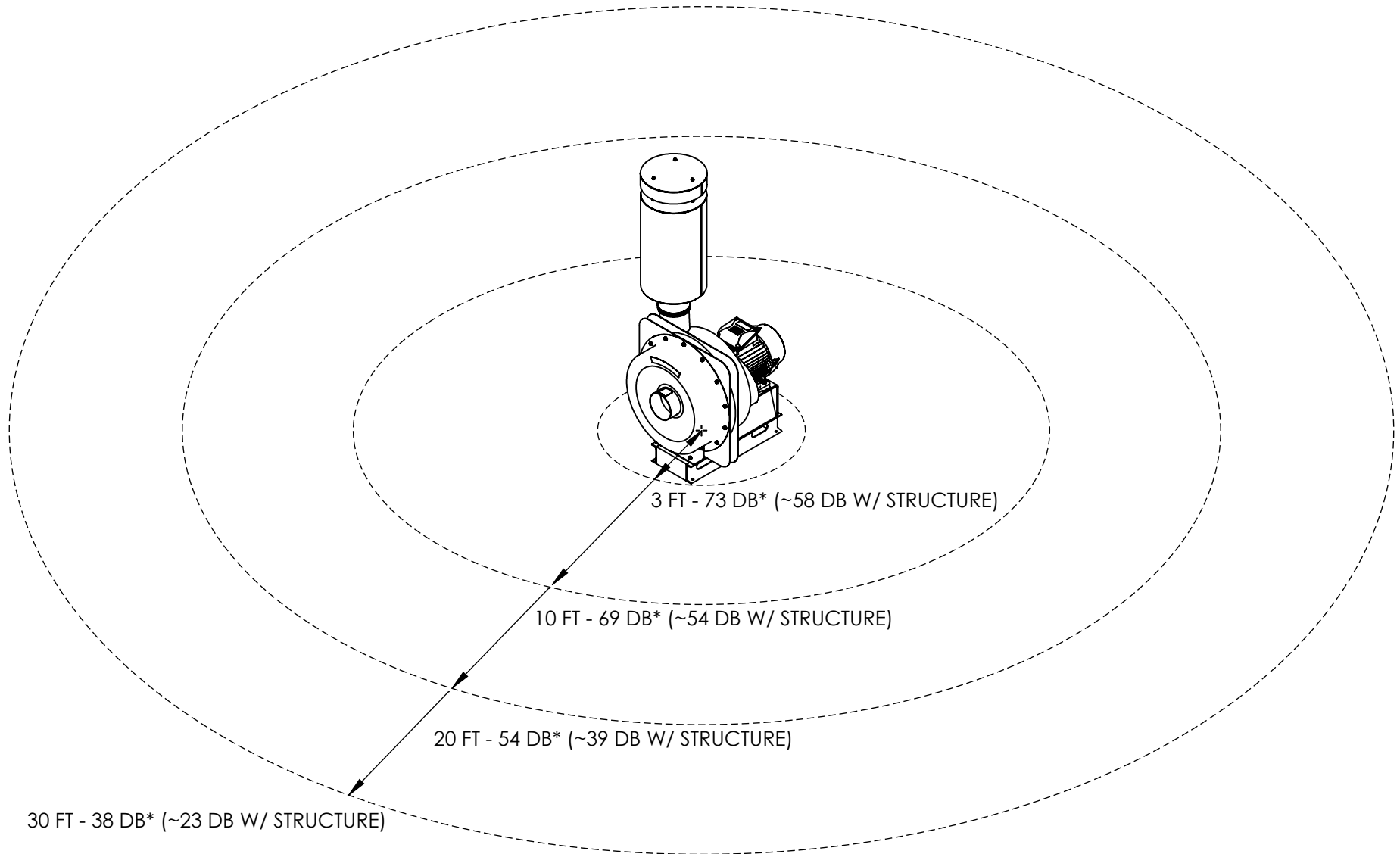

TYPICAL VEHICULAR TRAFFIC
MEASURES 60-75 DB ON MOST
CITY STREETS

*SOUND LEVELS REPORTED ARE FROM ACTUAL FIELD MEASUREMENTS
AND WILL VARY BASED ON ACTUAL CONDITIONS

THIS DRAWING IS PRELIMINARY AND NOT TO BE USED FOR CONSTRUCTION

X 60 DB with vacuums and blowers on.

X 60 DB with vacs and blowers on

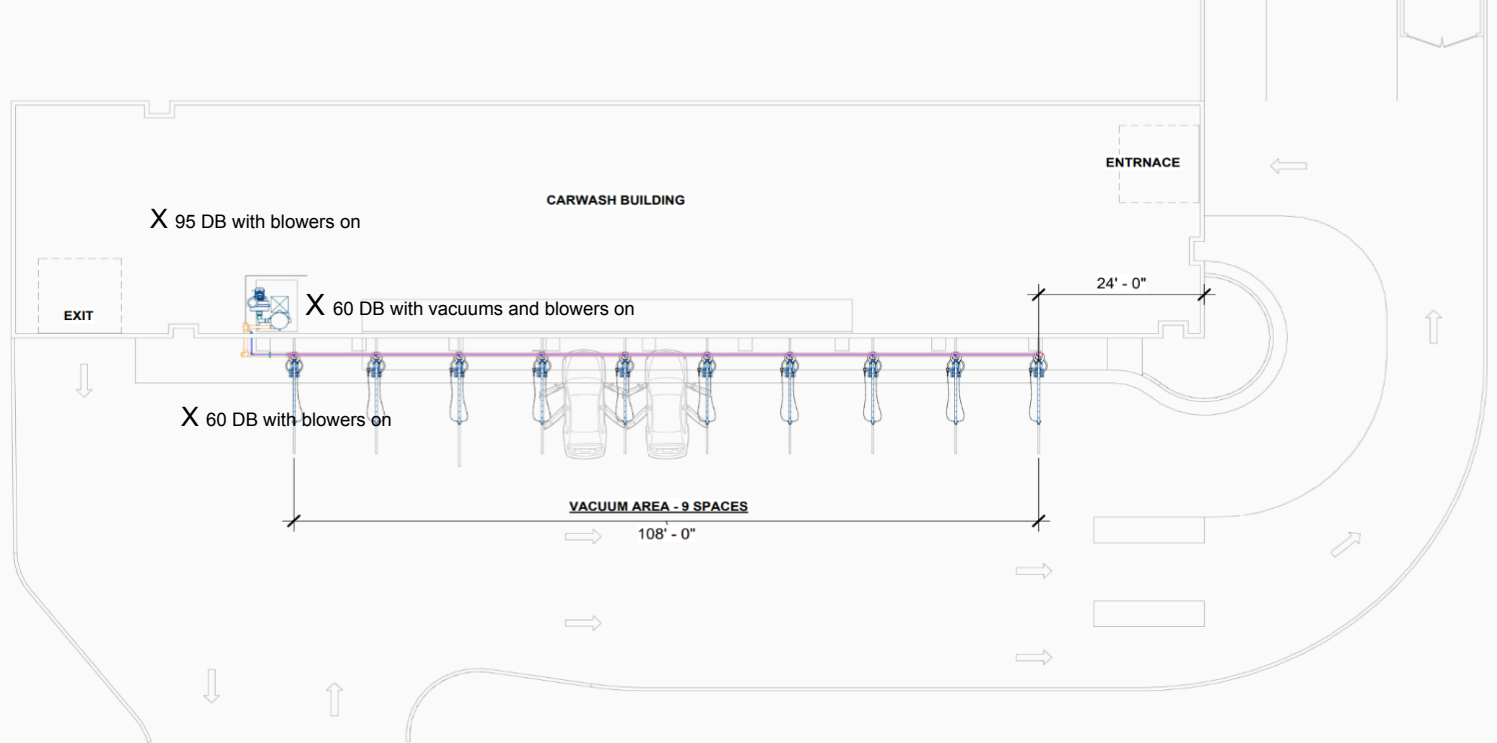

CONSTRUCTION NOTES

GENERAL NOTES:

- ALL DIMENSIONS TO BE FIELD VERIFIED BY OWNER
- IF VACUUM EQUIPMENT IS ENCLOSED WITH ROOF/CEILING, REFER TO VENTILATION REQUIREMENTS UNDER EQUIPMENT WARRANTY INFORMATION
- PIER DESIGN AND REINFORCEMENT FOR CONCEPTUAL USE ONLY. CONSULT STRUCTURAL ENGINEER IN YOUR AREA FOR SPECIFIC DESIGN CRITERIA.
- COMPLY WITH ALL STATE/ COUNTY BUILDING CODES IN YOUR AREA

EQUIPMENT & MATERIAL:

- RUN COMPRESSED AIR TO AIR COMPRESSOR LOCATION (BY OTHERS)
- WALL PENETRATION: CORE DRILLING MAY BE REQUIRED FIELD VERIFY HEIGHT
- 9'Lx9'Wx4"H MINIMUM FLAT AND LEVEL CONCRETE FLOOR SPACE REQUIRED FOR VACUUM EQUIPMENT VERIFY SEPARATOR WILL FIT THROUGH DOOR (48" CLEAR OPENING WIDTH RECOMMENDED)

VACUUM & PLUMBING:

- SUPPORT SCHEDULE 40 PVC OVERHEAD DRY/WET VACUUM PIPE EVERY 6' MAXIMUM; USE UNISTRUT & CLAMP OR OTHER SUPPORT (PROVIDED BY OTHERS)
- ALL FITTINGS TO BE "DWV"

1 OVERALL SITE PLAN

THIS PRELIMINARY DRAWING IS THE PROPERTY OF VACUTECH AND IS NOT TO BE USED FOR CONSTRUCTION OR INSTALLATION WITHOUT WRITTEN CONSENT. WRITTEN CONSENT MAY NOT BE PROVIDED BY ANY PERSON, AGENCY, OR DEALER NOT AUTHORIZED BY VACUTECH.

VACUTECH
AN **NCS** COMPANY
1350 HI-TECH DRIVE
SHERIDAN, WY 82801
PHONE: (307) 675-1962
EMAIL: vacinfo@ncswash.com
WEB: www.vacutec.com

WASH POINTE CAR WASH
28245 JOHN R ROAD
MADISON HEIGHTS, MICHIGAN 48071

| # | Revision | By | Chk | Date |
|---|--|----|-----|---------|
| 1 | Added one vacuum space, rotated vacuum spaces to 90 degrees, decreased vacuum space width from 14 to 12 feet | PK | RY | 5/30/24 |
| | | | | |
| | | | | |
| | | | | |
| | | | | |
| | | | | |

| OVERALL SITE PLAN | |
|-------------------|---------|
| Project Number | 1510477 |
| Date | 5/20/24 |
| Drawn By | FM |
| Checked By | TJ |
| V101 | |

Notes: In parking lot : 60 DB no vacuums and no traffic on John R
70 DB with traffic, no vacuums
70 DB with traffic and vacs

Vehicle music test notes: 92 decibels emitting from vehicle in parking lot spaces.
64 DB before property line wall behind Mcdonald's 28249
Groveland with all four vacuums running, blowers running, and music playing at 92 decibels in the parking lot.

Canister Vacuum Volume: 85 DB next to vacuum while on

POST/WALL MOUNT

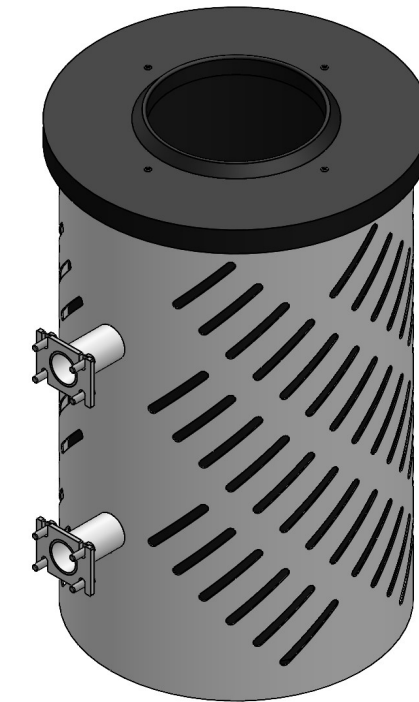
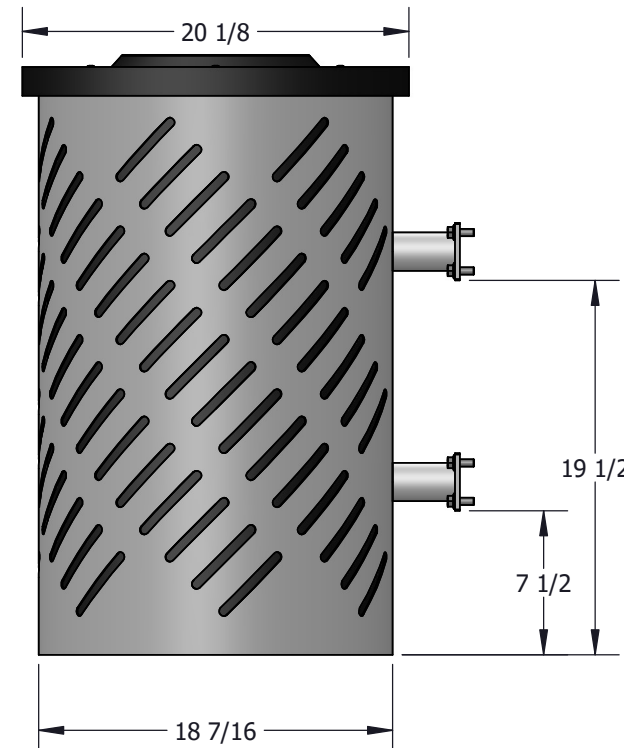
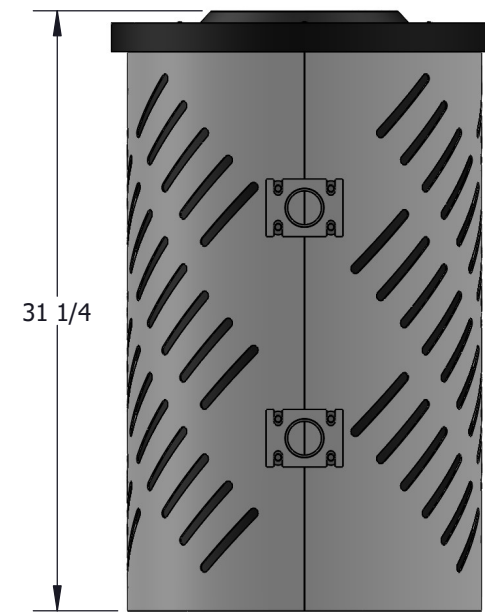

FLOOR MOUNT

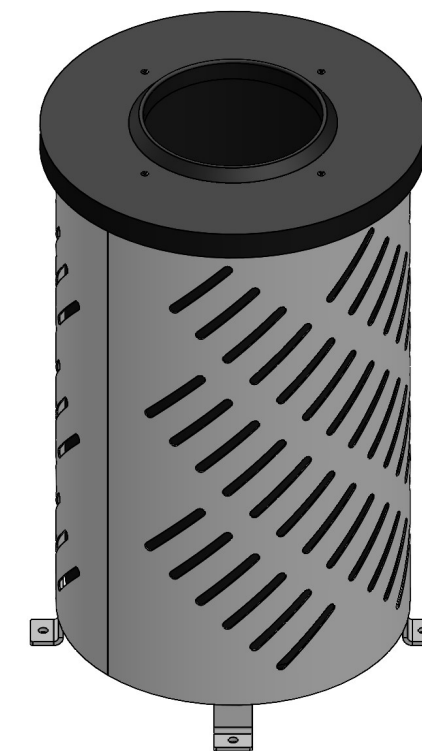
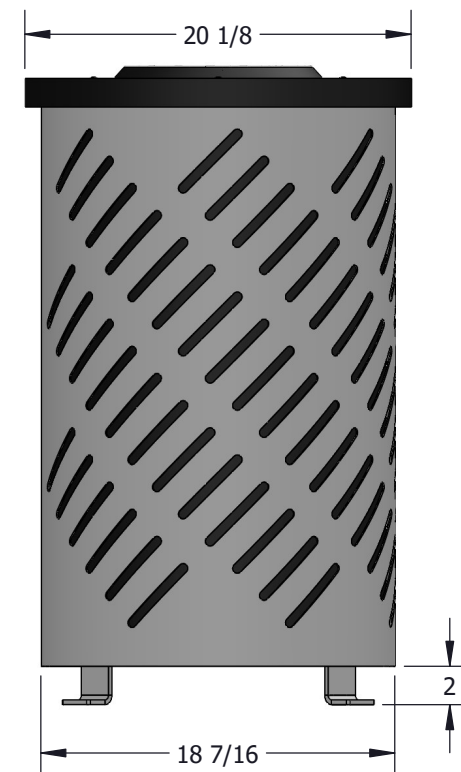
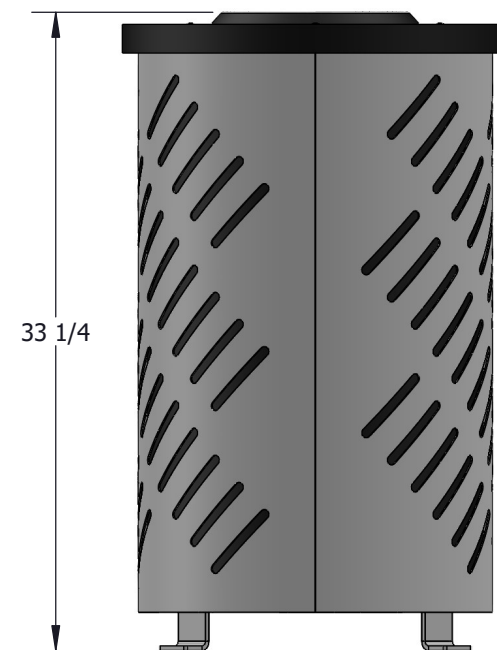

VACUTECH
AN **NCS** COMPANY

WASTE RECEPTACLE, 30 GALLON, ANGLED WRAPPED SLOTS