

East Marshall Street

East College Drive

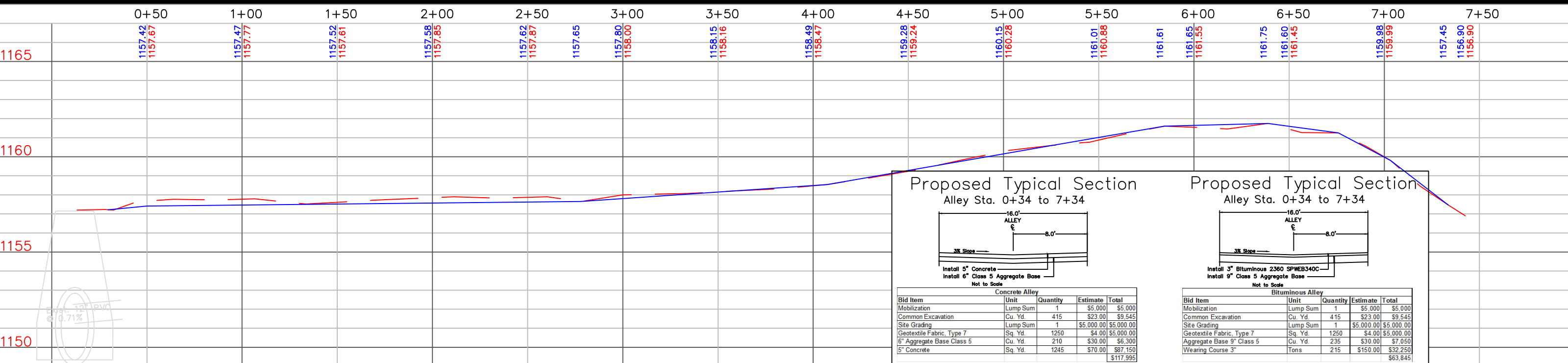

Proposed Typical Section
Alley Sta. 0+34 to 7+34

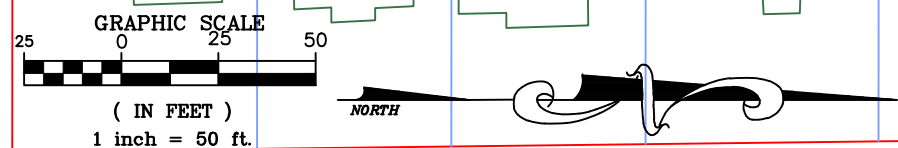
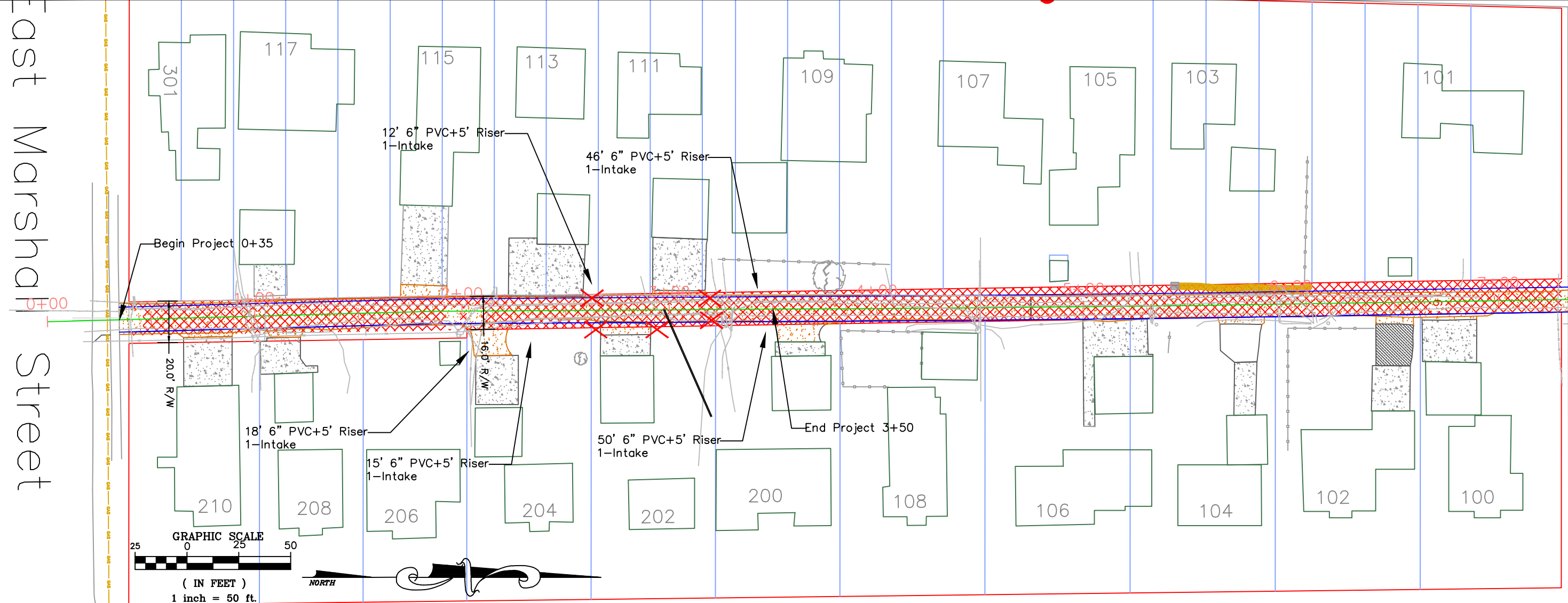
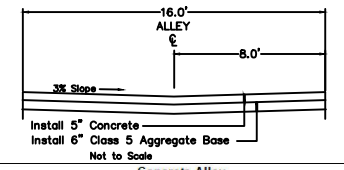

Concrete Alley				
Bid Item	Unit	Quantity	Estimate	Total
Mobilization	Lump Sum	1	\$5,000	\$5,000
Common Excavation	Cu. Yd.	415	\$23.00	\$9,545
Site Grading	Lump Sum	1	\$5,000.00	\$5,000.00
Geotextile Fabric, Type 7	Sq. Yd.	1250	\$4.00	\$5,000.00
6" Aggregate Base Class 5	Cu. Yd.	210	\$30.00	\$6,300
5" Concrete	Sq. Yd.	1245	\$70.00	\$87,150
				\$117,995

Proposed Typical Section
Alley Sta. 0+34 to 7+34

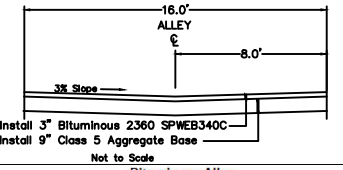

Bituminous Alley				
Bid Item	Unit	Quantity	Estimate	Total
Mobilization	Lump Sum	1	\$5,000	\$5,000
Common Excavation	Cu. Yd.	415	\$23.00	\$9,545
Site Grading	Lump Sum	1	\$5,000.00	\$5,000.00
Geotextile Fabric, Type 7	Sq. Yd.	1250	\$4.00	\$5,000.00
Aggregate Base 9" Class 5	Cu. Yd.	235	\$30.00	\$7,050
Wearing Course 3"	Tons	215	\$150.00	\$32,250
				\$63,845

MARSHALL
CITY ENGINEERS OFFICE
344 WEST MAIN STREET
MARSHALL, MINNESOTA
56258

Alley Bounded by Whitney & Park Ave.
Plan and Estimate Sheet

I HEREBY CERTIFY THAT THIS PLAN, SPECIFICATION OR REPORT WAS PREPARED BY ME OR UNDER MY DIRECT SUPERVISION AND THAT I AM A DULY LICENSED ENGINEER UNDER THE LAWS OF THE STATE OF MINNESOTA.
DATE _____ LICENSE NO. 41557

DATE 8/20/19
DESIGNED BY _____
DRAWN BY G.J.S.
CHECKED BY _____

PROJECT NO. Z70-2
SHEET NO. 6 OF 6