

Buetel Survey Points Request

SCHROEDER
09-007004-0

AHLERS
11-012010-0
2631 225TH AVE

SCHOOLMEESTER
11-012008-0
2627 225TH AVE

WENDEL
11-012006-0
2626 225TH AVE

FISCHER
11-012003-0

MARSHALL
11-012003-1

MARSHALL
27-602001-0

PARSONS
09-007024-0
2618 231ST AVE

EYE
11-012007-0
2643 RIVER RD

BERKENPAS
11-013010-0
2591 RIVER RD

- = Property Points
- = Easement(?) Points

All point locations are generally located. May be adjusted based on exact corners, fit, etc.

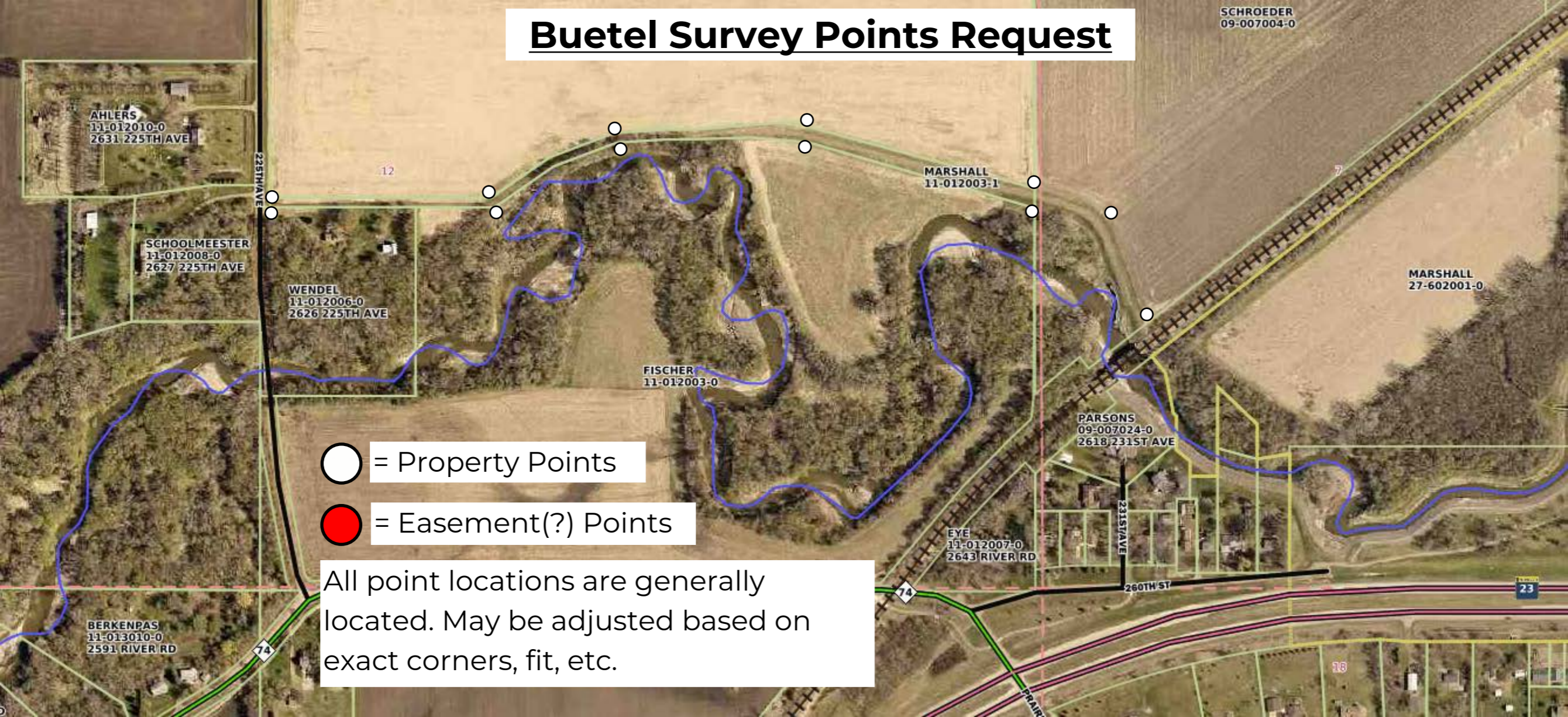

SCHROEDER
09-007004-0

MARSHALL
27-602001-0

PARSONS
09-007024-0
2618 231ST AVE

HOEFT
09-007027-0

GRUHOT
09-007023-0
2614 231ST AVE

Redwood River

Marshall

SPINNER
09-007022-0
2615 231ST AVE

HOEFT
09-007025-0
2322 260TH ST

BOFFERDING
09-007026-0
2326 260TH ST

GARRELS
09-007029-0
2318 260TH ST

KIRSH
09-007016-0
2300 260TH ST

ABEL
09-007019-0

AMESBURY
09-007021-0
2602 231ST AVE

231ST AVE

260TH ST

260TH ST

260TH ST

23

23

23



MARSHALL
27-602001-0

Redwood River

SCHROEDER
09-007033-0
2609 234TH AVE

SCHROEDER
09-007035-1

SANOW
09-007034-0
2608 234TH AVE

REGNIER
09-007035-0
2623 STATE HWY 23

SEQUOIA HOLDINGS LLC
09-007031-0
2621 STATE HWY 23

DEUTZ
09-007001-1

234TH AVE



MARSHALL
27-158001-0

MARSHALL
27-603031-0
DIVERSION CHANNEL

Redwood River

VANDENBROEKE
27-972010-0
1408 WESTWOOD DR

DELICH
27-972008-0
1500 WESTWOOD DR

JELN
27-972007-0
1502 WESTWOOD DR

RIESS
27-972038-0
1403 WESTWOOD DR

LOVE
27-972006-0
1504 WESTWOOD DR

ORTHAUS
27-972004-0
1508 WESTWOOD DR

GUENTHER
27-972036-0
1501 WESTWOOD DR

HTOO
27-972002-0
1512 WESTWOOD DR

ROKEH
27-972035-0
1503 WESTWOOD DR

WESTWOOD DR

NELSON
27-972033-0
1507 WESTWOOD DR

CARROW
27-973010-0
1500 DINEHURST DR

7

7

BAILEY

19

19

MARSHALL
27-603033-0
DIVERSION CHANNEL

HELENA CHEMICAL COMPANY
27-603019-0
1403 COLLEGE DR W

MARSHALL GOLF CLUB
27-603016-0
800 COUNTRY CLUB DR

Marshall

AIRPORT RD

BURLINGTON CIR

DOOM
27-190005-0

MARSHALL
27-603031-0
DIVERSION CHANNEL

LYON COUNTY-A MUNICIPAL
27-245010-2

MARSHALL
27-158001-0

LYO
27-



CLAPP PROPERTIES INC
06-032002-2
1384 CHANNEL RD W

TURKEY VALLEY FARMS LLC
06-032002-1
1400 CHANNEL RD W

TURKEY VALLEY FARMS LLC
06-032002-4

MARSHALL
27-805011-0

68

68

68

MARSHALL
27-625006-0
DIVERSION CHANNEL

MARSHALL
27-625005-0
DIVERSION CHANNEL

G & M BECKER PROPERTIES LLC
27-625002-0
1301 MAIN ST W

LOUWAGIE
27-625020-0

Marshall

MARSHALL
27-600150-0
DIVERSION CHANNEL

MARSHALL
27-600152-0
CHANNEL PARKWAY

MARSHALL
27-600151-0
LONDON RD

ANDERSON
27-105001-0
1005 CHANNEL P

W CHANNEL RD

W CHANNEL RD

W CHANNEL RD

CHANNEL PKWY

CHANNEL PKWY



LAKE RD

32

CATTOOR
27-804003-0

CATTOOR
27-804004-0
1304 MAIN ST W

MARSHALL
27-805011-0

27-805001-1

68

MARSHALL
27-805005-0
DIVERSION CHANNEL

CHANNEL PKWY
CHANNEL PKWY

Marshall

ELEVANTH STREET LLC
27-535002-0
211 11TH ST N

59



MARSHALL
27-547001-0
800 HWY 59 N

MARSHALL
27-626023-0
DIVERSION CHANNEL

MARSHALL
27-626024-0
DIVERSION CHANNEL

FLINT HILLS RESOUR
27-252002-0

Marshall

30

HALL
5011-0

CHANNEL PKWY

CHANNEL PKWY

ARMY #59 MN LTD PARTNERSHIP
27-626002-0
702 US HWY 59 N

REINHART FOODSERVICE LLC
27-626004-0
702 FAIRVIEW ST W

ARCHER DANIELS MIDLAND CO
27-626018-0

ARCHER DANIELS MIDLAND CO
27-626035-0
701 7TH ST N

59

59

59

FLINT HILLS RESOURCE PINE BEND
27-626037-0

27-534001-1
901 7TH ST N

HISKEN
06-033011-0
900 7TH ST N

FLINT HILLS RESOURCE PINE BEND
27-252002-0

Marshall

MARSHALL
27-626026-0
DIVERSION CHANNEL

Redwood River

MARSHALL
27-626015-2

DUININCK INC
27-626006-0
705 7TH ST N

BREWERS
27-626015-1
703 7TH ST N

ARCHER DANIELS MIDLAND CO
27-626035-0
701 7TH ST N

NORTH 7TH LLC
27-626016-0

KOSSUTH AVE

NEL



FLINT HILLS RESOURCE PINE BEND
27-534001-1
901 7TH ST N

BOERBOOM FAMILY TRUST AGREE
06-033004-1
904 7TH ST N

MINNESOTA CORN PROCESSORS
06-033004-0
1000 7TH ST N

HISKEN
06-033011-0
900 7TH ST N

MARSHALL
27-626025-0
DIVERSION CHANNEL

MARSHALL
27-626026-0
DIVERSION CHANNEL

Redwood River

WEST ST

KOSSUTH AVE



MARSHALL
27-626011-2

Marshall

SCHOTZKO
27-631001-0
522 HARRIETT DR

SKUYA
27-631003-0
518 HARRIETT DR

PENDER
27-630008-0
508 DARLENE DR

KRIZ
27-630009-0
506 DARLENE DR

NORTH RIVERVIEW PROPERTIES LLC
27-630014-0
1105 ESTHER CIR

SCIOTO PROPERTIES SP-16 LLC
27-631004-0
525 HARRIETT DR

MOONEY
27-639001-0
514 HUDSON AVE

BABCOCK
27-639002-0
512 HUDSON AVE

NAWROCKI
27-630023-0
517 HARRIETT DR

SCHAEFER
27-630037-0
508 HARRIETT DR

SCHAEFER
27-630028-0
509 DARLENE DR

MARKS
27-630013-0
1103 ESTHER CIR

N 6TH ST

HARRIETT DR

DARLENE DR

ESTHER CIR

MARSHALL
27-626011-2

Redwood River

MARSHALL
27-819023-1

Marshall

CARR FARMS PA
27-819023-0
SARATOGA ST S

GREAT PLAINS NATURAL GAS CO
27-626011-0
813 BRUCE N

LUPKES
27-128001-0
1001 EMERALD CT

LUPKES
27-128003-0
1005 EMERALD CT

LUPKES
27-128004-0
1006 EMERALD CT

NORTH RIVERVIEW PROPERTIES LLC
27-630014-0
1105 ESTHER CIR

GREAT PLAINS NATURAL GAS CO
27-162007-0
BRUCE ST N

EMERALD CT

HANSON

PU
27-
110



DEU
06-C
285

Redwood River

N BRUCE ST

CARR FARMS PARTNERSHIP
27-819024-0
FAIRVIEW ST E

34

CARR FARMS PARTNERSHIP
27-627001-0
CO RD 67

Marshall

CARR FARMS PARTNERSHIP
27-819023-0
SARATOGA ST S

EMERALD CT

WINCHESTER AVE

ST

CORNWALL AVE

AVALON AVE

KAYE PL

WINCHESTER AVE

CAMELOTIA

2866 CO RD 35

35

DEUTZ
06-034022-0

269TH AVE

23

34

DEUTZ
06-034017-0
2850 CO RD 35

MARSHALL
27-819023-1

SOUTHWEST STATE UNIVERSITY
27-627005-0
1501 STATE ST

23

PARTNERSHIP

E

IP

BREWERS
27-626015-1
703 7TH ST N

NORTH 7TH LLC
27-626016-0
700 7TH ST N

NORTH 7TH LLC
27-599113-0
500 7TH ST N

N 7TH ST

Peckwood River

KOSSUTH AVE

OAK ST

OAK ST

N 6TH ST

Marshall

N 6TH ST

RANCH AVE

FREMONT ST

PLEASANT ST

N 7TH ST

LC

