

GRANT OF UTILITY EASEMENT

THIS AGREEMENT, made and entered into this 16 day of July, 2019,

between Randy L. Serreyn and Roxanne L. Serreyn

husband and wife

As Grantor, and:

Marshall Municipal Utilities, a Municipal Corporation; CCVIII Operating LLC, dba Charter Communications; Vast Broadband; and Century Link as Grantees.

The above-named parties are collectively and individually, referred to as the Grantees.

WITNESSETH:

For and in consideration of One and no/100 (\$1.00) Dollar and other valuable consideration, the receipt of which is hereby acknowledged by the Grantor, the Grantor gives and grants to the Grantees, its successors and assigns, the right in perpetuity, to enter upon and occupy, the right of ingress and egress, the right to construct, install, repair, maintain, operate, use and replace utility facilities owned by the Grantees on the following described properties in Lyon County, Minnesota:

All that part of Lot 15, Block 1 of Westwood Acres Plat No. 1, City of Marshall, Lyon County, Minnesota, as filed and recorded in the office of the County Recorder in and for Lyon County, Minnesota, being more particularly described as follows:

Commencing at the southwest corner of said Lot 15; thence North 89 degrees 51 minutes 8 seconds , bearing based on Lyon County Coordinate System, along the south line of said Lot 15, a distance of 123.29 feet to the Point of Beginning; thence North 1 degrees 37 minutes 56 seconds East, a distance of 39.7 feet, thence North 10 degrees 41 minutes 57 seconds West, a distance of 100.54 feet, thence North 24 degrees 38 minutes 10 seconds West, a distance of 32.57 feet, to a point on the north line of Lot 15, thence North 41 degrees 46 minutes 3 seconds East, a distance of 13.32 feet, thence South 24 degrees 19 minutes 51 seconds East, a distance of 39.39 feet, thence South 10 degrees 41 minutes 57 seconds East, a distance of 103.29 feet, thence South 1 degrees 37 minutes 56 seconds West, a distance of 40.99 feet, to a point on the said south line of Lot 15 thence North 88 degrees 22 minutes 3 seconds West, a distance of 12 feet, ending there at the Point of Beginning.

As an essential part of the consideration herein and by the acceptance of the Grant of Easements, said Grantees, its successors and assigns, further takes said easements, subject to the conditions and thereby covenants that upon the initial construction, improvement or repair within the easement area given by the Grantor that Grantees will restore and return said premises to substantially the same condition as said premises were prior to said construction, improvement or repair.

The agreement herein set out shall be construed as a covenant running with the remainder of the lands owned by the Grantor and is binding on said party as the owner of said lands, and for themselves, their heirs, executors, administrators, and assigns, anyone claiming under them, or any of them, as owners or occupants thereof.

IN WITNESS WHEREOF, The Grantees have hereunto set their hands the day and year first above written.

By: Randy L. Serreyn
Randy L. Serreyn,
Husband

By: Roxanne L. Serreyn
Roxanne L. Serreyn,
Wife

STATE OF MINNESOTA)
)ss
COUNTY OF LYON)

The foregoing instrument was acknowledged before me this 16 day of July, 2019,
by Randy L. Serryn and Roxanne L. Serryn, husband and wife under the laws of Minnesota.

Greta Henning
Notary Public
My commission expires: 1-31-2020



Drafted by: Marshall Municipal Utilities
 113 4th Street South
 Marshall, Minnesota 56258-1223

Address Currently Known As:
1308 Westwood Drive



Marshall Municipal Utilities - Property Easements

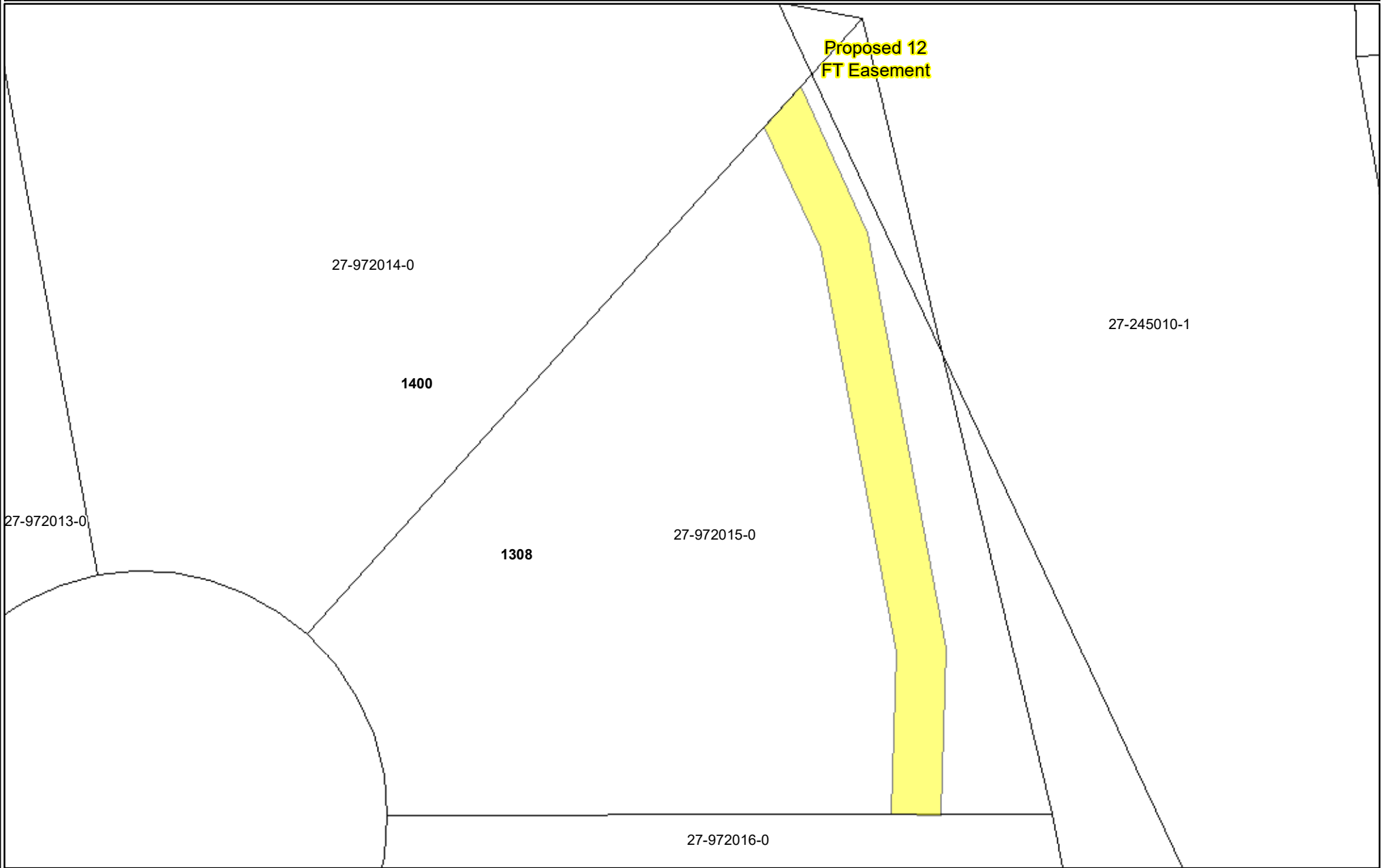

Proposed 12
FT Easement

27-972014-0

1400



27-245010-1

27-972013-0

1308

27-972015-0

27-972016-0

 Proposed Easements
 County Parcels

