

	LIGHT/FOUNDATION REMOVAL	7	EACH
	MANHOLE REMOVAL	2	EACH
	FENCE REMOVAL	1585	LF
	CONCRETE DECK REMOVAL	3177	SY
	POOL FLOOR REMOVAL	1289	SY
	POOL WALL REMOVAL	357	SY
	BUILDING REMOVAL	1	EACH
	BUSH/TREE REMOVAL	10	EACH
	SLIDE REMOVAL	1	EACH
	SLIDE FOUNDATION REMOVAL	7	EACH
	* FENCE WALL REMOVAL	1291	LF
	COMMON BORROW FILL	1	CY
	6" SCREENED TOPSOIL (CV)	2240	CY

Fence Removal	Unit
5' Chain Link Fence	36 LF
7' Chain Link Fence	75 LF
Gate	11 LF
7' Chain Link Fence	125 LF
7' Chain Link Fence W/ Slats	14 LF
7' Chain Link Fence W/ Slats	31 LF
7' Chain Link Fence W/ Slats	21 LF
7' Chain Link Fence W/ Slats	117 LF
7' Chain Link Fence W/ Slats	80 LF
7' Chain Link Fence W/ Slats	40 LF
8' Chain Link Fence	22 LF
8' Chain Link Fence	85 LF
7' Chain Link Fence	82 LF
5' Chain Link Fence	50 LF
5' Chain Link Fence	81 LF
7' Chain Link Fence	64 LF
7' Chain Link Fence	80 LF
7' Chain Link Fence	18 LF
7' Chain Link Fence	21 LF
7' Chain Link Fence	29 LF
7' Chain Link Fence	76 LF
Inside 7' Chain Link Fence	57 LF
Inside 7' Chain Link Fence	17 LF
Inside Wrought Iron Fence	50 LF
Inside Wrought Iron Fence	24 LF
Inside Wrought Iron Fence	37 LF
Inside Wrought Iron Fence	70 LF
Inside Wrought Iron Fence	25 LF
Inside Wrought Iron Fence	57 LF
Inside 7' Chain Link Fence	50 LF
Inside 7' Chain Link Fence	40 LF
<b>TOTAL</b>	<b>1585 LF</b>

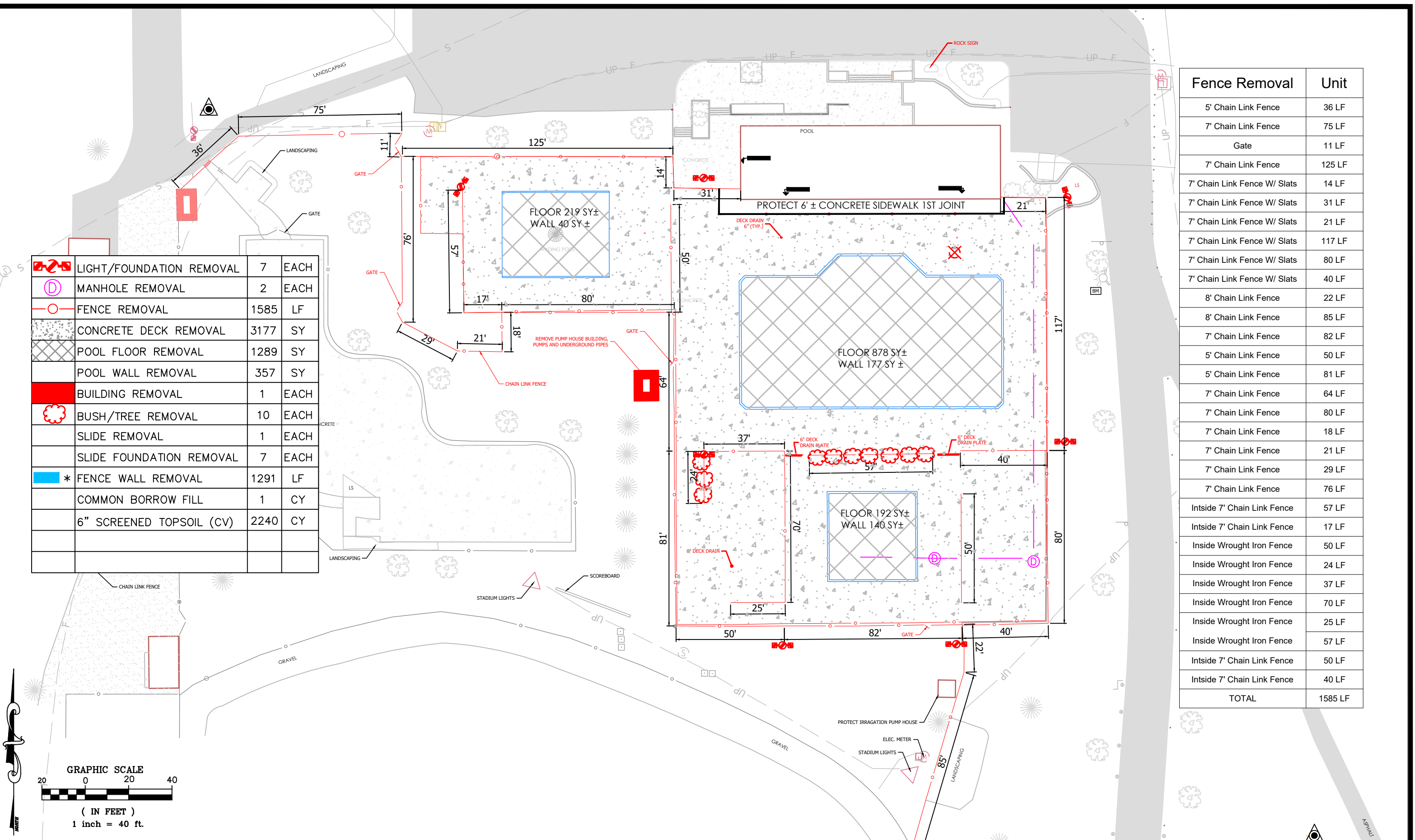

DESIGNED BY: G.J.S.	DATE	REVISIONS	INIT.
DRAWN BY: G.J.S.			
APPROVED BY: J.R.A.			
SCALE: 1"=40'			

**ENGINEERING DEPARTMENT**  
**344 WEST MAIN STREET**  
**MARSHALL, MINNESOTA**  
**56258**

**POOL REMOVAL**  
**FENCE REMOVAL**

I HEREBY CERTIFY THAT THIS PLAN, SPECIFICATION OR REPORT WAS PREPARED BY ME OR UNDER MY DIRECT SUPERVISION AND THAT I AM A DULY LICENSED ENGINEER UNDER THE LAWS OF THE STATE OF MINNESOTA.  
 DATE: \_\_\_\_\_ LICENSE NO. 53322

CITY PROJECT NO. NA	DATE 04/13/2026
STATE AID PROJECT NO. NA	SHEET NO. 2 OF 3