

CITY OF MARSHALL

CONSTRUCTION PLANS FOR

2023 - NORTH 3RD STREET & WEST LYON STREET IMPROVEMENTS

CITY PROJECT # ST-009

SANITARY SEWER, WATERMAIN, STORM SEWER, AGGREGATE BASE, CURB & GUTTER, CONCRETE SIDEWALK,
CONCRETE STREET PAVEMENT, STREETSCAPING AND TURF RESTORATION

FEBRUARY 2023

RESOURCE LIST

CITY OF MARSHALL
CITY HALL
344 W MAIN ST
MARSHALL, MN 56258
507-537-6760

CITY ADMINISTRATOR:
SHARON HANSON

DIRECTOR OF PUBLIC WORKS/CITY ENGINEER
JASON ANDERSON
507-537-6051

WASTEWATER SUPERINTENDENT
SCOTT TRUEDSON

WATER OPERATIONS MANAGER
JEFF LARSON

ELECTRICAL OPERATIONS MANAGER
TONY MEAD

PUBLIC WAYS SUPERINTENDENT
DEAN COUDRON

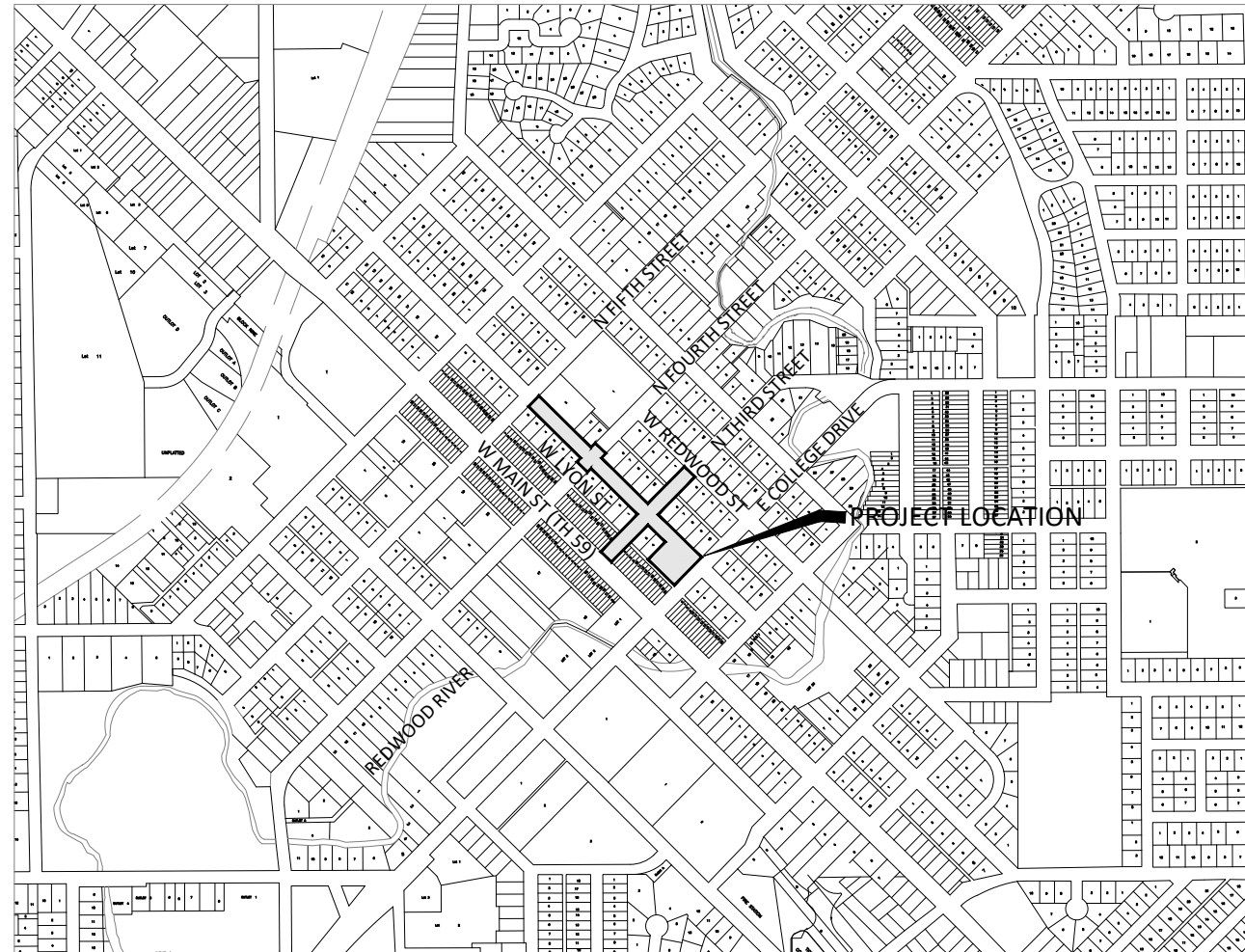

MAP OF THE
CITY OF MARSHALL
LYON COUNTY, MN

SPECIFICATION REFERENCE

THE 2020 EDITION OF THE MINNESOTA DEPARTMENT OF TRANSPORTATION "STANDARD SPECIFICATIONS FOR CONSTRUCTION" AND THE "SUPPLEMENTAL SPECIFICATIONS" DATED SEPTEMBER 2022 SHALL GOVERN.

ALL TRAFFIC CONTROL DEVICES SHALL CONFORM TO THE LATEST EDITION OF THE MINNESOTA MANUAL ON UNIFORM TRAFFIC CONTROL DEVICES, INCLUDING THE LATEST FIELD MANUAL FOR TEMPORARY TRAFFIC CONTROL ZONE LAYOUTS.

THE CITY OF MARSHALL STANDARD SPECIFICATIONS AND SPECIAL PROVISIONS.

NOTE: EXISTING UTILITY INFORMATION SHOWN ON THIS PLAN HAS BEEN PROVIDED BY THE UTILITY OWNER. THE CONTRACTOR SHALL FIELD VERIFY EXACT LOCATIONS PRIOR TO COMMENCING CONSTRUCTION AS REQUIRED BY STATE LAW. NOTIFY GOPHER STATE ONE CALL, 1-800-252-1166 OR 651-454-0002.

THE SUBSURFACE UTILITY INFORMATION IN THIS PLAN IS UTILITY QUALITY LEVEL D UNLESS OTHERWISE NOTED. THIS UTILITY LEVEL WAS DETERMINED ACCORDING TO THE GUIDELINES OF CI/ASCE 38-02, ENTITLED "STANDARD GUIDELINES FOR THE COLLECTION AND DEPICTION OF EXISTING SUBSURFACE UTILITY DATA."

SHEET NUMBER	SHEET TITLE
GENERAL	
G0.01 - G0.03	TITLE SHEET, LEGEND, CONSTRUCTION NOTES
G1.01	STATEMENT OF ESTIMATED QUANTITIES
CIVIL	
C0.01 - C0.02	EXISTING CONDITIONS
C0.03 - C0.04	REMOVALS
C1.01 - C1.02	TABLES
C1.03 - C1.10	TYPICAL SECTIONS AND DETAILS
C1.11 - C1.15	STANDARD PLANS - PEDESTRIAN RAMP DETAILS
C1.16 - C1.19	STANDARD PLANS - DRIVEWAY AND SIDEWALK DETAILS
C2.01 - C2.04	SWPPP AND EROSION CONTROL PLAN
C3.01	ADDISON PARKING LOT
C4.01 - C4.03	SANITARY & WATERMAIN PLAN & PROFILE
C5.01 - C5.04	STORM SEWER PLAN & PROFILE
C6.01 - C6.13	STREET PLAN & PROFILE, INTERSECTION DETAILS, JOINTING PLAN
C7.01 - C7.07	TRAFFIC CONTROL PLAN, STREET SIGNAGE, PAVEMENT MARKINGS
C8.01 - C8.05	SIGNAL REVISION PLAN
C9.01 - C9.08	CROSS SECTIONS
L1.01 - L3.04	STREETSCAPE PLAN
E1.01 - E2.02	ELECTRICAL, CONDUIT & FOOTING PLAN

MAP LEGEND

PROJECT LIMITS



REVIEWED & APPROVED _____ DATE: _____
MARSHALL MUNICIPAL UTILITIES

REVIEWED & APPROVED _____ DATE: _____
CITY ENGINEER

RECORD DRAWING INFORMATION

OBSERVER:
CONTRACTOR:
DATE:

PROJECT DATUM: LYON COUNTY
HORIZONTAL: NAD 83
VERTICAL: NAVD 88

© Bolton & Menk, Inc. 2023. All Rights Reserved. P:\MARSHALL\1127006\DWG\1127006.dwg 2/9/2023 8:00:20 PM

I HEREBY CERTIFY THAT THIS PLAN, SPECIFICATION, OR REPORT WAS PREPARED BY ME OR UNDER MY DIRECT SUPERVISION AND THAT I AM A DULY LICENSED PROFESSIONAL ENGINEER UNDER THE LAWS OF THE STATE OF MINNESOTA.

JOSHUA G. STIER
LIC. NO. 54171 DATE 02/09/2023



1960 PREMIER DRIVE
MANKATO, MINNESOTA 56001
Phone: (507) 625-4171
Email: Mankato@bolton-menk.com
www.bolton-menk.com



DESIGNED	NO.	ISSUED FOR	DATE
DRAWN			
CHECKED			
CLIENT PROJ. NO.	OW1.127006		

CITY OF MARSHALL, MINNESOTA
2023 N 3RD ST - W LYON ST IMPROVEMENTS

TITLE SHEET

SHEET
G0.01