

A photograph of the Marshall Community Pool, featuring a large swimming pool with people swimming, a water slide, and tall light towers in the background under a cloudy sky. The image is dimmed to allow text to be overlaid.

Marshall Community Pool

PRESENTATION TO CITY COUNCIL

JANUARY 26, 2021

COMMUNITY DEVELOPMENT



City Hall Renovation



SOUTHVIEW ELEMENTARY



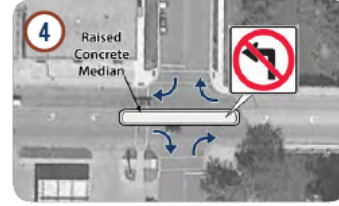
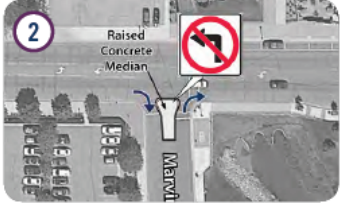

1
Hwy 19/College Dr. at Country Club Dr.

- A roundabout design will accommodate all types of traffic, including large trucks.
- A roundabout meets the community's priorities of:
- » Improving safety for people who walk, bike and drive
 - » Making it easier to get across town
 - » Reduces traffic delay
 - » Slows down traffic



Community feedback - construct roundabout

**Among those who expressed a preference, support for a roundabout was almost evenly split.*

**Please note information about how roundabouts accommodate all traffic, including trucks and how the intersection improves safety for people who walk were not communicated to the community when asking for their feedback on this intersection.*

2
Hwy 19/College Dr. at Marvin Schwan

- A right-in/right-out meets the community's priorities of:
- » Improving safety for people who walk, bike and drive
 - » Making it easier to get across town
 - » Reduces traffic delay
 - » Allows for longer turn lanes to be striped at Main St.



Community feedback - change to right-in/right-out

**Support for the right-in/right-out design was supported by the majority of those who expressed a preference.*

3
Hwy 19/College Dr. at Lyon St.

- Replacing the signal with stop signs on Lyon St. meets the community's priorities of:
- » Reduces traffic delay and improves traffic flow through both the Lyon St. and Main St. intersections
 - » Making it easier to get across town
- Bump-outs to shorten the distance pedestrians have to cross the road and a flashing pedestrian beacon are also included in the improvements recommended at Lyon St.



Community feedback - Remove traffic signal and place stop signs at Lyon St.

**Support for the recommended changes was almost evenly split among those who expressed a preference.*

**Please note that bump-outs and a flashing pedestrian beacon were not communicated to the community when asking for their feedback on this intersection as they were added later.*

4
Hwy 19/College Dr. at Marshall St.

- A right-in/right-out meets the community's priorities of:
- » Improving safety for people who walk, bike and drive
 - » Making it easier to get across town
 - » Addresses the difficulty of seeing over the bridge railing when making a left turn onto Hwy 19/College Dr.



Community feedback - change to right-in/right-out

**Support for the right-in/right-out design was supported by the majority of those who expressed a preference.*

HWY 19/College Drive Reconstruction

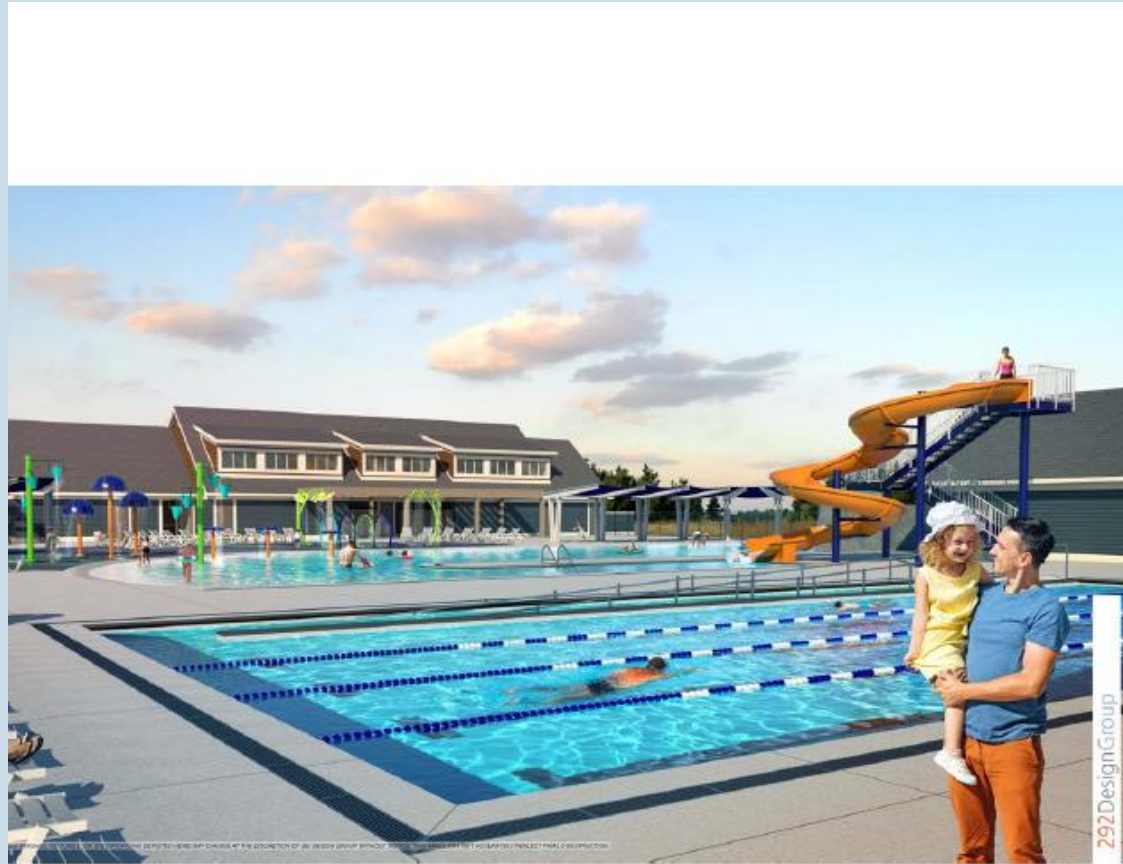

Community Pool Project

Marshall Aquatics Center Study
Marshall, Minnesota / July 2019

Prepared By



Existing Facility



EXISTING FACILITY IN
POOR CONDITION



REPAIR IS NOT COST
EFFECTIVE



NEW FACILITY
RECOMMENDED AS
BEST VALUE



CONSTRUCT NEW ON
EXISTING SITE



NEW DESIGN CREATES
LEISURE, RECREATION &
FITNESS FOR ALL AGES



PROJECT COST OF \$8M

Summary

2019 COMMUNITY SURVEY

MARSHALL AQUATIC CENTER

39%

RESPONSE RATE
OCTOBER 2019

98%

RESPONDENTS AGREED
THAT IT IS VALUABLE
TO THEIR FAMILY TO
HAVE AN AQUATIC
CENTER IN THE
COMMUNITY

86%

RESPONDENTS
INDICATED THEY WOULD
ACCESS A NEW FACILITY
AT LEAST ONCE A WEEK

HOUSEHOLDS
RESPONDING
INDICATED
HAVING 637
CHILDREN UNDER
THE AGE of 14

"SWIMMING IS A GREAT
EXERCISE FOR EVERYONE
REGARDLESS OF AGE. WE
REALLY NEED A MORE
INCLUSIVE FACILITY TO
NOT ONLY BENEFIT OUR
COMMUNITY, BUT THE
ENTIRE REGION."
Respondent Comment



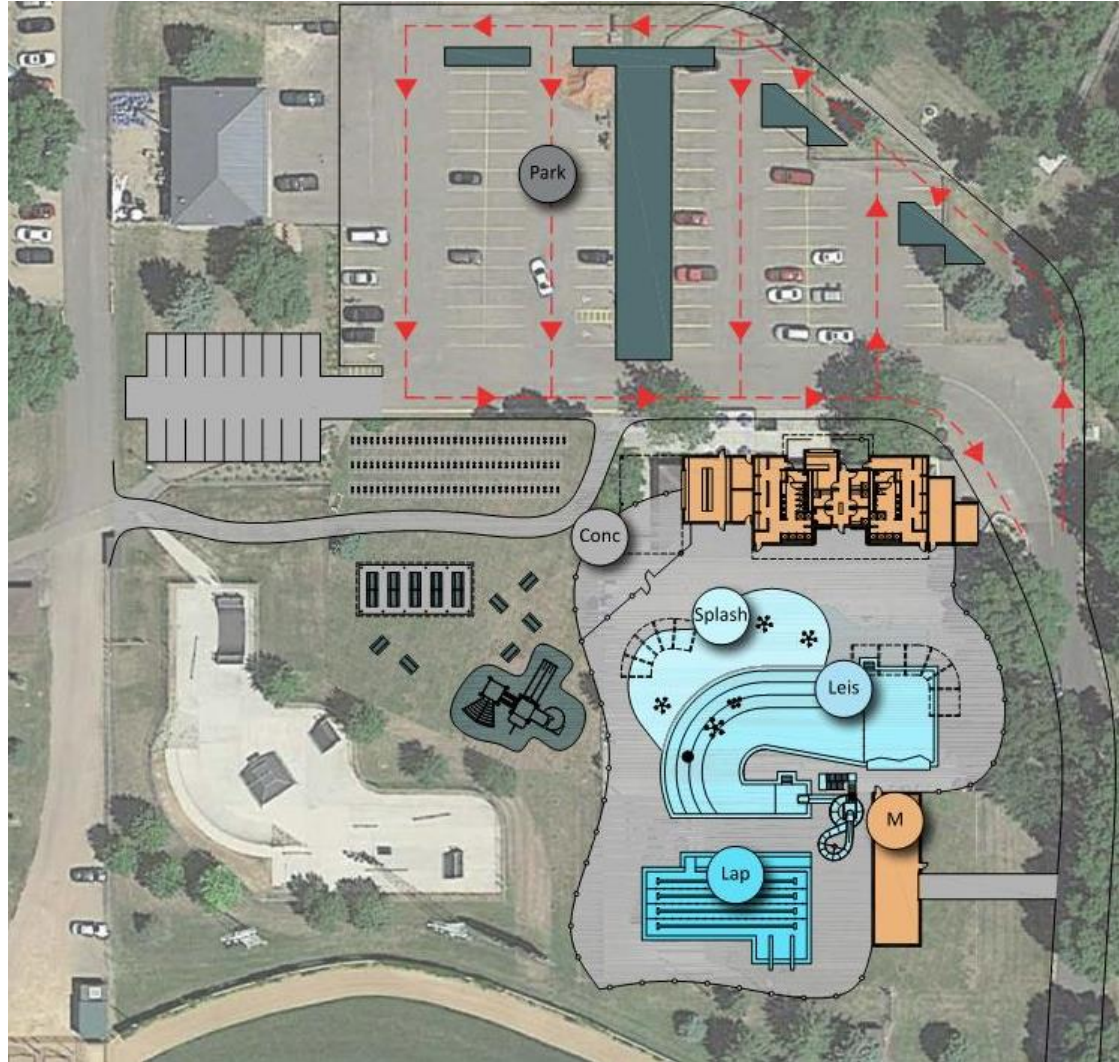

Site Plan

Lap Pool



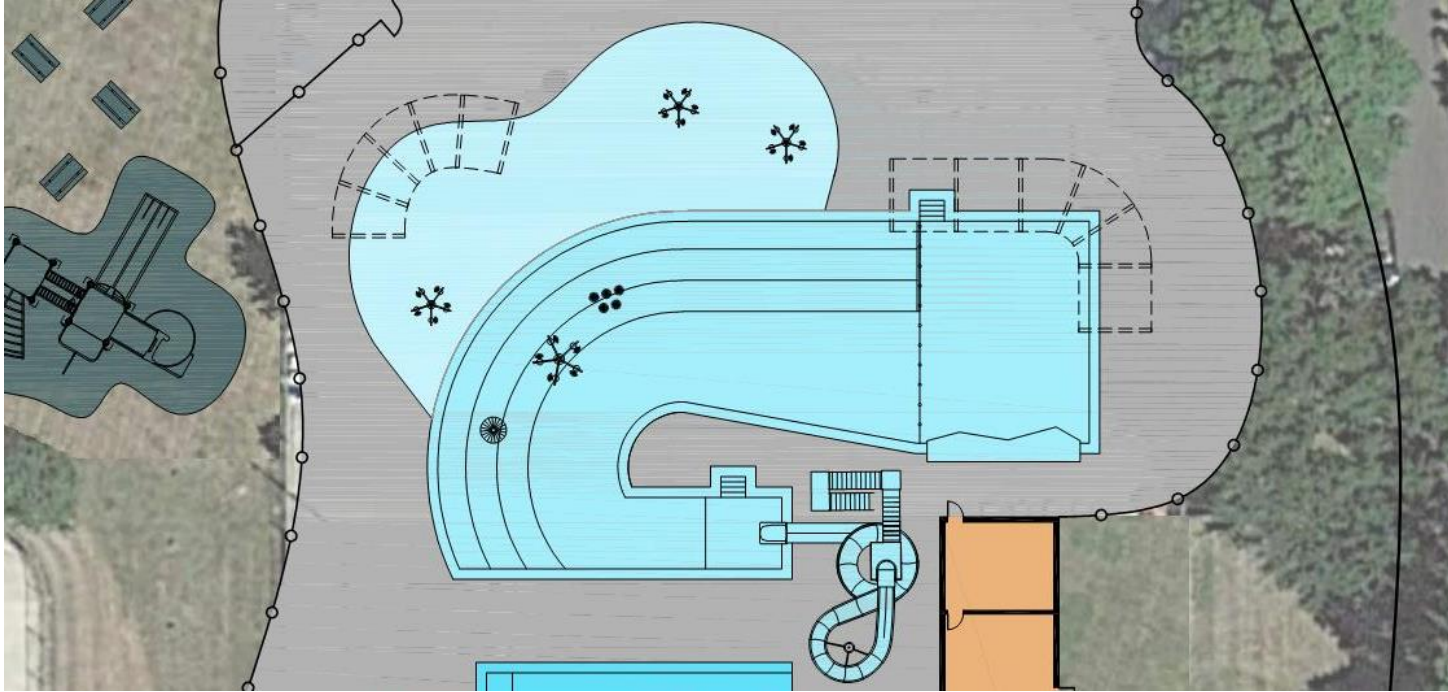

Leisure Pool



Leisure Pool

Splashpad



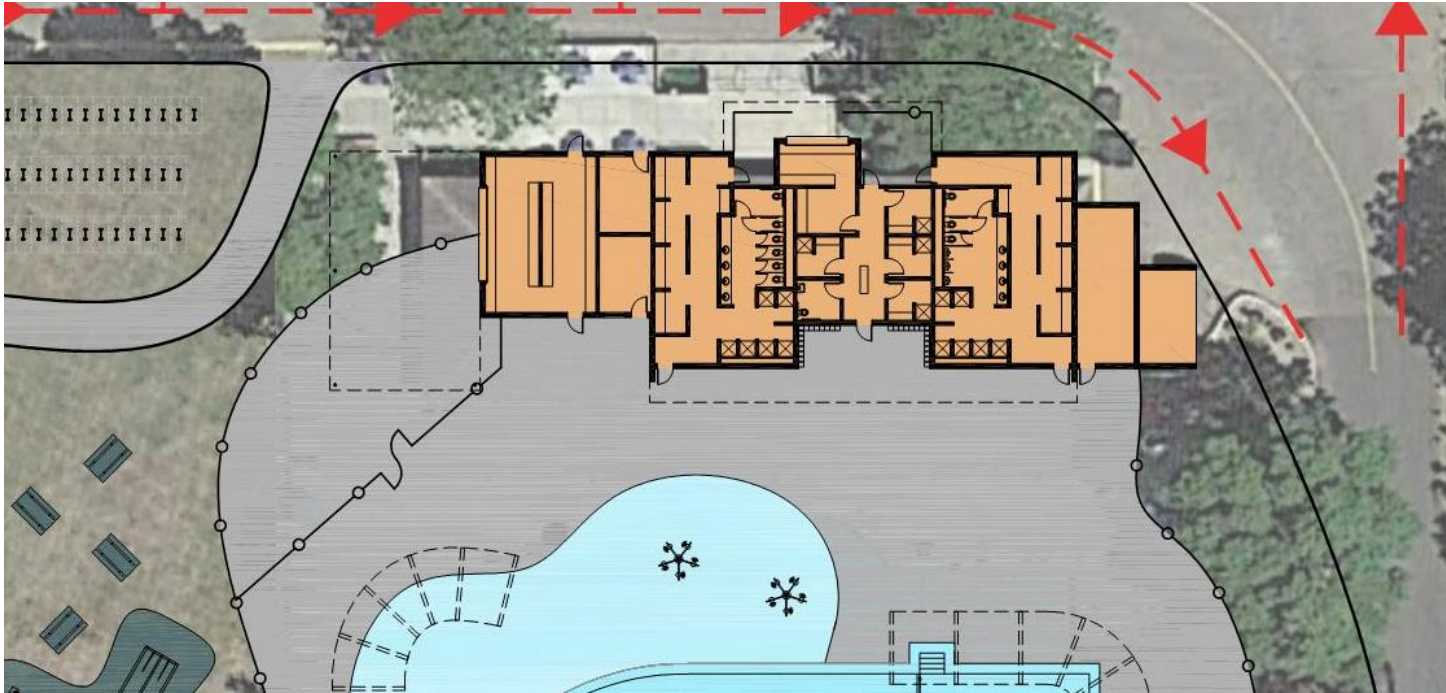

Bath House

DEMOLITION AND SITE PREPARATION **\$175,000**

Includes demolition of existing pools, concrete deck slab, bath house and pool slide and other structures

AQUATIC AREAS **\$3,300,000**

Includes leisure pool, lap pool, splash pad, play structures and slides

DRY AREAS **\$256,250**

Includes concrete deck slab walks concessions seating area deck area and drainage system

SITE IMPROVEMENTS **\$225,000**

Landscaping, irrigation, and fencing (\$150,000)
Shade Structures (\$75,000)

BUILDING AREA **\$1,788,625**

Bath House and Concessions Building (\$1,388,625)
Pool Mechanical Building (\$400,000)

Project Totals **\$5,744,875**

CONTINGENCY **20%** **\$1,148,975**

SOFT COSTS **20%** **\$1,148,975**

FF&E, Architectural and Engineering Fees, Testing, Survey

TOTAL PROJECT COSTS **\$8,042,825**

Cost Estimates



ARTIST'S CONCEPTUAL RENDERING. ANY FINISHES, FEATURES, OR SPECIFICATIONS DEPICTED HERE MAY CHANGE AT THE DISCRETION OF 292 DESIGN GROUP WITHOUT NOTICE. THIS IMAGE MAY NOT ACCURATELY REFLECT FINAL CONSTRUCTION.

CULTIVATING THE BEST IN US