

**ORDINANCE NO. \_\_\_\_\_**

**AN ORDINANCE OF THE CITY OF MANOR, TEXAS, AMENDING  
ORDINANCE 534 TO MODIFY THE PLANNED UNIT DEVELOPMENT  
LAND USE PLAN FOR THE MANOR HEIGHTS DEVELOPMENT;  
REZONING FROM PLANNED UNIT DEVELOPMENT (PUD) TO  
PLANNED UNIT DEVELOPMENT (PUD); MAKING FINDINGS OF FACT;  
AND PROVIDING FOR RELATED MATTERS.**

**Whereas**, the City of Manor, Texas (the “City”) has initiated that the property described hereinafter in Exhibit “A” attached hereto and incorporated herein as if fully set forth (the “Property”) be rezoned from zoning district Planned Unit Development (PUD) to zoning district Planned Unit Development (PUD);

**Whereas**, Ordinance No. 534 was adopted by the City of Manor, Texas City Council (the “City Council”) on November 14, 2018;

**Whereas**, the City has initiated an amendment to Ordinance No. 534 in order to modify the Planned Unit Development Land Use Plan for the Manor Heights Subdivision Planned Unit Development;

**Whereas**, after giving ten days written notice to the owners of land within three hundred feet of the Property, the Planning & Zoning Commission held a public hearing on the proposed rezoning and forwarded its recommendation on the rezoning to the City Council; and

**Whereas**, after publishing notice of the public at least fifteen days prior to the date of such hearing, the City Council at a public hearing has reviewed the request and the circumstances of the Property and finds that a substantial change in circumstances of the Property, sufficient to warrant a change in the zoning of the Property, has transpired.

**NOW, THEREFORE, BE IT ORDAINED BY THE CITY COUNCIL OF THE CITY OF MANOR, TEXAS, THAT:**

**Section 1. Findings.** The foregoing recitals are hereby found to be true and correct and are hereby adopted by the City Council and made a part hereof for all purposes as findings of fact.

**Section 2. Amendment of Ordinance.** Ordinance No. 534 is hereby modified and amended by replacing Exhibit “B” in its entirety and replacing with a new Exhibit “B” which is attached hereto and incorporated herein as if fully set forth as Exhibit “B” to include the modified Planned Unit Development Land Use Plan for the Manor Heights Planned Unit Development.

**Section 3. Amendment of Conflicting Ordinances.** Exhibit “B” of the City’s Ordinance No. 534 is hereby amended as provided in this Ordinance. All ordinances and parts of ordinances in conflict with this ordinance are amended to the extent of such conflict. In the event of a conflict or inconsistency between this ordinance and any code or ordinance of the city, the terms and provisions of this ordinance shall govern.

**Section 4. Open Meetings.** That it is hereby officially found and determined that the meeting at which this ordinance is passed was open to the public as required and that public notice of the time, place, and purpose of said meeting was given as required by the Open Meetings Act, Chapt. 551, Texas Gov’t. Code.

**ORDINANCE NO.**

**Page 2**

**PASSED AND APPROVED FIRST READING** on this the 20<sup>th</sup> day of September 2023.

**PASSED AND APPROVED SECOND AND FINAL READING** on this the \_\_\_\_ day of October 2023.

**THE CITY OF MANOR, TEXAS**

\_\_\_\_\_  
Dr. Christopher Harvey,  
Mayor

**ATTEST:**

\_\_\_\_\_  
Lluvia T. Almaraz,  
City Secretary

**EXHIBIT “A”**

Property Legal Description:

90.089 acres out of the A.C. Caldwell Survey, Abstract Number 154, Travis County, Texas and being the tracts of land conveyed to RHOF, LLC, a Texas Limited Liability Company, per deed recorded as document No.2017194263 of the official public records of Travis County, Texas

44.0347 acres of land located in the A.C. Caldwell Survey, Abstract Number 154, Travis County, Texas and being a portion of that certain called 180.83 acres of land conveyed to Alma Juanita Meier, as described in Volume 11376, Page 676, Official Public Records of Travis County, Texas

267.972 ACRES OF LAND LOCATED IN THE LEMUEL KIMBRO SURVEY, ABSTRACT NUMBER 456 AND THE A.C. CALDWELL SURVEY, ABSTRACT NUMBER 154, TRAVIS COUNTY, TEXAS AND BEING THE SAME 267.972 ACRE TRACT OF LAND CONVEYED TO SKY VILLAGE KIMBRO ESTATES, LLC, AS DESCRIBED IN DOCUMENT NUMBER 2016214460, OFFICIAL PUBLIC RECORDS OF TRAVIS COUNTY, TEXAS.

(35.626 AC) LOT 2, J.F. NAGLE ESTATES, A SUBDIVISION IN TRAVIS COUNTY, TEXAS, ACCORDING TO THE MAP OR PLAT THEREOF RECORDED IN DOCUMENT NO. 199900207, OFFICIAL PUBLIC RECORDS, TRAVIS COUNTY, TEXAS, TOGETHER WITH A NON-EXCLUSIVE 60 FOOT WIDE ACCESS AND PUBLIC UTILITY EASEMENT AS CREATED AND MORE PARTICULARLY DESCRIBED IN THAT DECLARATION OF ACCESS AND PUBLIC UTILITY EASEMENT RECORDED IN DOCUMENT NO. 1999058184, OFFICIAL PUBLIC RECORDS, TRAVIS COUNTY, TEXAS, BEING THE SAME 35.626 ACRES CONVED TO SKY VILLAGE KIMBRO ESTATES, LLC, OF THE OFFICIAL PUBLIC RECORDS OF TRAVIS COUNTY, TEXAS

Westernmost 20 feet of LOT 3, J.F. NAGLE ESTATES, A SUBDIVISION IN TRAVIS COUNTY, TEXAS, ACCORDING TO THE MAP OR PLAT THEREOF RECORDED IN DOCUMENT NO. 199900207, OFFICIAL PUBLIC RECORDS, TRAVIS COUNTY, TEXAS

3.469 acres of land located in the Lemuel Kimbro Survey, Abstract Number 456, Travis County, Texas and being a portion of that certain tract of land conveyed to Sky Village Kimbro Estates, LLC, as recorded in 2017157471 of the official Records of Travis County, Texas

157.9603 acres out of the A.C. Caldwell survey No.52, Abstract 154 and the Lemuel Kimbro Survey No.64, Abstract 456, and being the tracts of land conveyed to Kimbro Road Estates, LP per deed recorded as document No.201780865 of the official public records of Travis County, Texas

**EXHIBIT “B”**

Planned Unit Development Land Use Plan  
[attached]

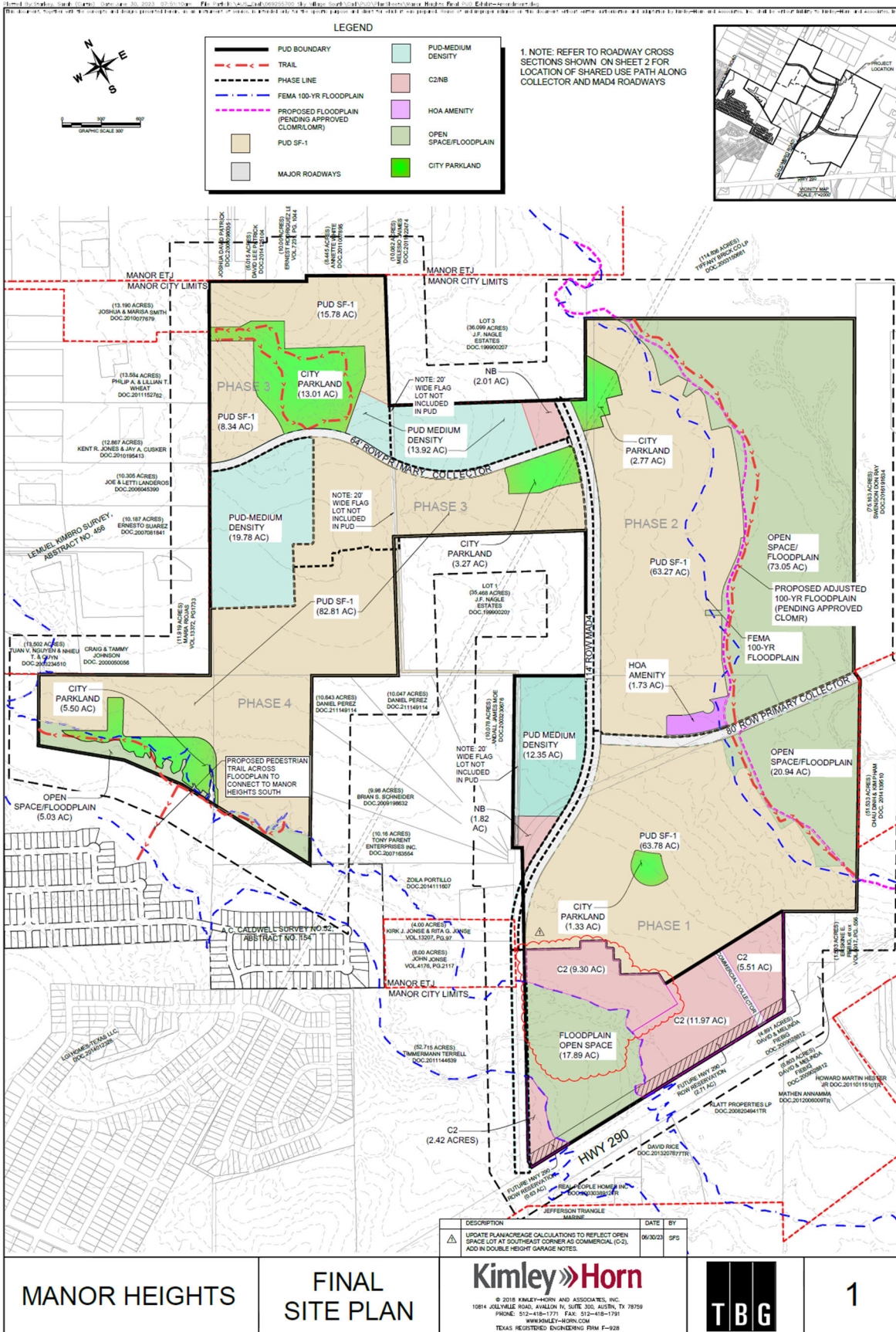

MANOR HEIGHTS

FINAL SITE PLAN

**Kimley»Horn**

© 2018 KIMLEY-HORN AND ASSOCIATES, INC.  
1014 JULLIEMORE ROAD, WILLOW N. SUITE 300, AUSTIN, TX 78759  
PHONE: 512-418-1771 FAX: 512-418-1791  
WWW.KIMLEY-HORN.COM  
TEXAS REGISTERED ENGINEERING FIRM E-1928



1







**Front Facades**

Front Facades are defined as residential elevations facing a street or park. Facades adjacent to a park with a wall or fence between the facade and park is not a front facade. Both street facing facades on corner lots are considered front facades and must be articulated, continue the siding material palette on both street facing facades and incorporate architectural elements. The percentage of design elements, materials and detailing are not required to be consistent on both facades.

**Strategical Variety.** The same elevation can be repeated no more than every fourth lot. The same elevation cannot be placed on a lot directly across the street or diagonal from any other plan with the same elevation. No elevations may be repeated on a cul-de-sac having less than six (6) lots. No color palette may be repeated more than seven times on any block of more than 21 lots.

**Variety of facade articulation.** Front elevations shall have at least two different design features to break the wall plane. The following are examples of the types of design features that meet this requirement:

- Horizontal offsets, recesses or projections, breezeways, porte-cocheres, sunshades, ornamental columns, ornamental and bay windows, vertical "elevation" offsets, peaked roof forms, arches, architectural details such as tile work or moldings integrated into the facade, integrated planters or wing walls, accent materials, varied roof heights, or similar design features.

Front Facades should create visual interest through horizontal and vertical articulation of the building elevation. A variety of textured surfaces and natural materials may be used, particularly at the pedestrian eye-level, with windows and entrances that face the street. Blank walls should be minimized.



**Front-loaded Garage - Flush with Facade**

Garage doors flush with the street-facing facade require design features on the facade that de-emphasizes the visual impact of the garage. At least one of the following is required on a flush garage:

- Integrated trim or banding around the garage door that matches the residential building
- Garage door relief detailing; windows are a preferred element
- An overhead eave or porte-cochere extended above the face of the garage door in front of the garage door face
- Decorative hardware such as hinges, handles, etc.



**Front Entries**

On lots less than 55' in frontage, entries must be one-story scaled entries and either recessed or covered with a porch, canopy, or other shading device. A variety of front door types is required.

Articulated use of details and accent materials should be used at building entries to emphasize human-scale. Building entrances may be marked by porch elements, trellises, canopies, awnings or special roof treatments. Oversized and grandiose archways are discouraged.



**Front-loaded Garage - Projecting**

Garages projecting in front of the street facing building facade may protrude in front of the building provided that design features are provided on all exposed garage facades to de-emphasize the visual impact of the garage. A projecting garage may be side loaded (garage doors perpendicular to the street). Some combination of the following is required on a projecting garage:

- Extend and integrate the building siding materials on the garage facades
- Integrated trim or banding around the garage door that matches the residential building
- Garage door windows
- Single garage doors
- An architectural roof above the garage, such as a gabled roof



**Exteriors of Residential Buildings**

**Materials.** Exterior surface area (all stories) may consist of ledge stone, fieldstone, cast stone, cementitious-fiber planking and board and batten (not panels), painted or tinted stucco and brick. Solid wood planking, decorative cementitious-fiber panels, galvanized metal and other durable materials may be used for accent features. The minimum front facade masonry is 30%, masonry must be stone, brick or stucco.

**Detailing.** Design elements and detailing, including the presence of windows and window treatments, trim detailing and exterior wall materials should be continued around the primary building; the percentage of design elements, materials and detailing may vary from facade to facade to encourage architectural variety and are not required to be consistent.

Residential buildings that back up to a collector street or higher street category shall be limited to one-story height to minimize the visual impact of rear facades being prominently viewed by the public.



**Garage Door Articulation**

Stain or paint colors for garage doors shall be compatible with the color palette of the building facade siding or trim of the home to de-emphasize the garage door and emphasize the architectural building facade. Detailing and articulation of the garage doors is required.

General. Individual or two-car garage doors are permitted. The use of three garage doors is permitted provided at least one of the doors is offset two feet from the other doors. The driveway width at the curb line may be no wider than 17' or the width of a 2-door garage.



**Front-loaded Garage - Living Area Forward**

A garage door recessed from the face of the front facade that emphasizes the living area of the home from the street is a permitted garage type.



**Roofs and Overhead Structures**

Simple roof lines are encouraged and can be achieved by including hips, gables, projections (e.g. dormers) and roof form changes in keeping with a selected architectural style. On buildings with pitched roofs, the minimum main roof pitch is 5:12. Lower roof pitches are acceptable on porch elements, awnings or architectural feature elements.

Pitched roofs shall be clad in 25-year minimum composition shingles or low reflectivity coated metal roofing materials. The materials and colors of canopies, awnings and trellises should be compatible with the roof materials and complement and harmonize with the exterior design of the building.

An overhead eave or porte-cochere may extend above the face of the garage door in front of the garage door face. The overhead eave or the porte-cochere may extend five feet into the building setback line.

DESCRIPTION	DATE	BY
UPDATE PLANNING CALCULATIONS TO REFLECT OPEN SPACE LOT AT SOUTHEAST CORNER AS COMMERCIAL (O-2). ADD IN DOUBLE HEIGHT GARAGE NOTES.	06/30/21	SFS

MANOR HEIGHTS

EXHIBIT B  
PUD DESIGN  
STANDARDS

**Kimley»Horn**

© 2018 KIMLEY-HORN AND ASSOCIATES, INC.  
10814 GULLIBLE ROAD, KUILSON, TX, SUITE 300, AUSTIN, TX 78758  
PHONE: 512-418-1771 FAX: 512-418-1791  
WWW.KIMLEY-HORN.COM  
TEXAS REGISTERED ENGINEERING FIRM E-928



3



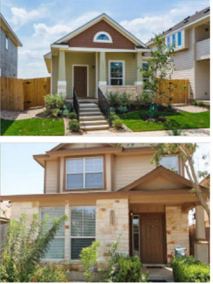

**MEDIUM DENSITY RESIDENTIAL**

All guidelines set forth in these Design Guidelines apply to this housing type. In addition, the following apply to Medium Density Residential buildings and site design:

**Architectural style**  
A variety of quality and durable residential buildings within a condominium lot or small lot site must include a variety of architectural features and colors to establish an appealing streetscape character.

**Form and mass**  
A single, large building mass should be avoided. Building designs should incorporate visually heavier and more massive elements, details or colors at the building base, and visually lighter elements, details or colors above the base. Groups of buildings must have variety of colors. Four-flat and Mansion Home buildings are permitted.

**Long walls and facades**  
Up to six attached dwellings may be attached in a single row as a group.

**Windows and transparency**  
All walls and elevations on all floors of attached residential buildings must include windows or doors with glass, except as appropriate to assure privacy for adjacent residents.

**Medium Density Residential**  
Page 13

The PUD shall provide for a collection of privately owned, common open space lots set within the PUD and made available for residential use. Common open space will be designed to (i) serve the recreational needs of the residents (ii) provide places and opportunities for interaction within the community and (iii) provide opportunities for interaction with the natural environment.

All private open space and structures thereon shall be conveyed to and permanently owned and maintained by a Home Owner Association (HOA) or other responsible entity. The HOA may adopt rules and regulations regarding access, permitted uses, security (policing) and maintenance responsibilities for the open spaces.

Any lot designated as common open space shall consist of at least six thousand (6,000) square feet. The area of the common open space lot shall be measured and calculated to the property line of the lot.

Parking for common open space uses within the PUD may be provided with adjacent on-street parking. Off-street parking may also be provided within a common open space lot, at the option of the Developer.

**Common Open Space**  
Page 13



**Building roofs**  
On buildings with pitched roofs, the minimum roof pitch is 6:12 on the main structure. On buildings where flat roofs are the predominant roof type, parapet walls should be provided.

**Mechanical equipment screening**  
Roof-top mechanical equipment must be hidden or screened with architecturally integral elements at least as high as the equipment to be screened. Make-shift equipment screens, such as wooden or plastic fences, are prohibited. Ground mounted mechanical equipment must be hidden or screened with architecturally integral wing walls and/or landscaping. Mechanical equipment must be located where their acoustics will minimize disruption to abutting residential dwelling units.

Solar panels and rain collection devices are exempt from mechanical equipment screening standards.

**Medium Density Residential**  
Page 13

A Master Homeowner Association shall be created and maintained for the community, empowered to govern and establish design guidelines, review architectural and landscape designs and enforce regulations and design guidelines. These regulations and guidelines will provide practical design direction which will create a special residential community environment that is consistent with these architectural design guidelines.

Each new residential unit in Manor Heights will be subject to design criteria that will be detailed in design guidelines as referenced in the Declaration of Covenants, Conditions, and Restrictions (CCRs) to be established by Owner and enforced by the Architectural Review Committee (ARC) which will be created pursuant to the CCRs.

House plans submitted to The City shall be stamped or indicated by letter of transmittal (or similar language) that architectural review committee (ARC) has reviewed and approved the house plans as complying with the PUD Design Requirements for City Review.

**Design Review and Enforcement**  
Page 14



**DOUBLE HEIGHT GARAGES (PHASE 2 ONLY) (SEE PUD NOTE 26)**



**DOUBLE HEIGHT GARAGES (PHASE 2 ONLY) (SEE PUD NOTE 26)**

DESCRIPTION	DATE	BY
UPDATE PLANNING CALCULATIONS TO REFLECT OPEN SPACE LOT AT SOUTHEAST CORNER AS COMMERCIAL (C-2) ADD IN DOUBLE HEIGHT GARAGE NOTES.	06/30/23	SFS