



June 8, 2022

City of Manor
105 E Eggleston St
Manor, TX 78653
512.272.5555

Re: Manor ISD Sr. High Athletic Complex

Dear Mr. Dunlop,

On behalf of Manor Independent School District, we would like to request from the City of Manor approval for the field lights of the new Manor Senior High School Athletic Complex that includes lighting for baseball, softball, and tennis.

In addition to meeting the requirements outlined in Sec.15.05.008 Lighting Requirements, please reference attached photometric plan, and attached manufacturer's cut sheets that includes information on the light shields.

Thank you for your consideration, and please reach out to me with any questions or comments.

Best regards,

A handwritten signature in black ink, appearing to read 'Cody Holt'.

Cody Holt
Claycomb Associates, Architects, Inc.

CC: Ryan Marcum, Director of Bonds and Construction – MISD

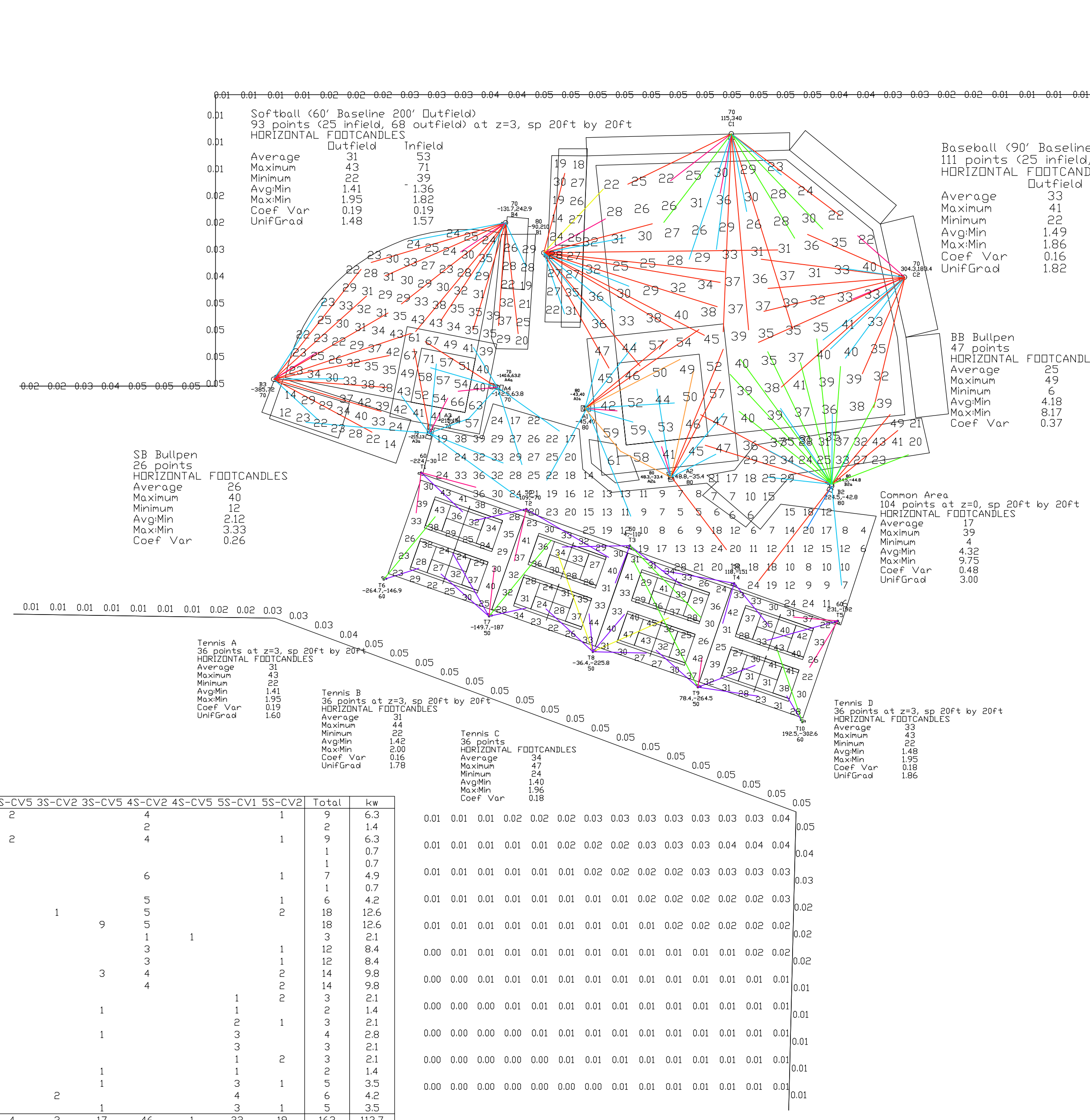

Property Line
 248 points
 HORIZONTAL FOOTCANDLES
 Average 0.02
 Maximum 0.05
 Minimum 0.00
 AvgMin N/A
 MaxMin N/A
 Coef Var 0.99

Softball (60' Baseline 200' Outfield)
 93 points (25 infield, 68 outfield) at z=3, sp 20ft by 20ft
 HORIZONTAL FOOTCANDLES

	Infield	Outfield
Average	31	71
Maximum	43	71
Minimum	22	39
AvgMin	1.41	1.36
MaxMin	1.95	1.82
Coef Var	0.19	0.19
UnifGrad	1.48	1.57

Baseball (90' Baseline 315'/360'/315')
 111 points (25 infield, 86 outfield) at z=3, sp 30ft by 30ft
 HORIZONTAL FOOTCANDLES

	Infield	Outfield
Average	33	50
Maximum	41	61
Minimum	22	41
AvgMin	1.49	1.22
MaxMin	1.86	1.49
Coef Var	0.16	0.12
UnifGrad	1.82	1.41

SB Bullpen
 26 points
 HORIZONTAL FOOTCANDLES
 Average 26
 Maximum 40
 Minimum 12
 AvgMin 2.12
 MaxMin 3.33
 Coef Var 0.26

BB Bullpen
 47 points
 HORIZONTAL FOOTCANDLES
 Average 25
 Maximum 49
 Minimum 6
 AvgMin 4.18
 MaxMin 8.17
 Coef Var 0.37

Common Area
 104 points at z=0, sp 20ft by 20ft
 HORIZONTAL FOOTCANDLES
 Average 17
 Maximum 29
 Minimum 4
 AvgMin 4.32
 MaxMin 9.75
 Coef Var 0.48
 UnifGrad 3.00

Tennis A
 36 points at z=3, sp 20ft by 20ft
 HORIZONTAL FOOTCANDLES
 Average 31
 Maximum 43
 Minimum 14
 AvgMin 1.41
 MaxMin 1.95
 Coef Var 0.19
 UnifGrad 1.60

Tennis B
 36 points at z=3, sp 20ft by 20ft
 HORIZONTAL FOOTCANDLES
 Average 31
 Maximum 44
 Minimum 14
 AvgMin 1.42
 MaxMin 2.00
 Coef Var 0.16
 UnifGrad 1.78

Tennis C
 36 points
 HORIZONTAL FOOTCANDLES
 Average 34
 Maximum 47
 Minimum 14
 AvgMin 1.40
 MaxMin 1.96
 Coef Var 0.18

Tennis D
 36 points at z=3, sp 20ft by 20ft
 HORIZONTAL FOOTCANDLES
 Average 33
 Maximum 43
 Minimum 14
 AvgMin 1.48
 MaxMin 1.95
 Coef Var 0.16
 UnifGrad 1.88

Pole	x-loc	y-loc	height	1S-CV5	2S-CV5	3S-CV2	3S-CV5	4S-CV2	4S-CV5	5S-CV1	5S-CV2	Total	kw
A1	-45	40	80ft	2	2			4			1	9	6.3
A1a	-43	40	80ft					2				2	1.4
A2	48.8	-35.4	80ft	2	2			4			1	9	6.3
A2a	48.3	-33.4	80ft	1				1				1	0.7
A3	-214.9	15	70ft	1				1				1	0.7
A3a	-215	12	70ft					6			1	7	4.9
A4	-142.5	63.8	70ft	1				1				1	0.7
A4a	-140.6	63.2	70ft					5			1	6	4.2
B1	-90	210	80ft	10		1		5			2	18	12.6
B2	224.5	-42.8	80ft	4			9	5				18	12.6
B2a	224.5	-44.8	80ft	1				1	1			3	2.1
B3	-385	72	70ft	9				3			1	12	8.4
B4	-131.7	242.9	70ft	8				3			1	12	8.4
C1	115	340	70ft	5			3	4			2	14	9.8
C2	304.3	183.4	70ft	8				4			2	14	9.8
T1	-224	-30	60ft							1	2	3	2.1
T10	192.5	-302.6	60ft				1				1	2	1.4
T2	-109	-70	50ft							2	1	3	2.1
T3	4	-110	50ft				1				3	4	2.8
T4	118	-151	50ft							3	3	3	2.1
T5	231	-192	60ft							1	2	3	2.1
T6	-264.7	-146.9	60ft							1	2	3	2.1
T7	-149.7	-187	50ft							3	1	5	3.5
T8	-36.4	-225.8	50ft				2				4	6	4.2
T9	78.4	-264.5	50ft					1			3	5	3.5
Total				51	4	3	17	46	1	22	19	163	113.7

4S-CV5
 COOPER LIGHTING SOLUTIONS - EPHEBUS EPH-LS-08-0640L-57-70-4S-CV5
 Initial Lumens per lamp = -1
 Light Loss Factor = 0.950
 Watts per luminaire = 697
 Candela file name: EPH-LS-08-0640L-57-70-4S-CV5.ies
 Number luminaires used = 1
 kw these luminaires = 0.7

5S-CV2
 COOPER LIGHTING SOLUTIONS - EPHEBUS EPH-LS-08-0640L-57-70-5S-CV2
 Initial Lumens per lamp = -1
 Light Loss Factor = 0.950
 Watts per luminaire = 697
 Candela file name: EPH-LS-08-0640L-57-70-5S-CV2.ies
 Number luminaires used = 19
 kw these luminaires = 13.2

5S-CV1
 COOPER LIGHTING SOLUTIONS - EPHEBUS EPH-LS-08-0640L-57-70-5S-CV1
 Initial Lumens per lamp = -1
 Light Loss Factor = 0.950
 Watts per luminaire = 697
 Candela file name: EPH-LS-08-0640L-57-70-5S-CV1.ies
 Number luminaires used = 22
 kw these luminaires = 15.3

4S-CV2
 COOPER LIGHTING SOLUTIONS - EPHEBUS EPH-LS-08-0640L-57-70-4S-CV2
 Initial Lumens per lamp = -1
 Light Loss Factor = 0.950
 Watts per luminaire = 697
 Candela file name: EPH-LS-08-0640L-57-70-4S-CV2.ies
 Number luminaires used = 46
 kw these luminaires = 32.1

3S-CV5
 COOPER LIGHTING SOLUTIONS - EPHEBUS EPH-LS-08-0640L-57-70-3S-CV5
 Initial Lumens per lamp = -1
 Light Loss Factor = 0.950
 Watts per luminaire = 697
 Candela file name: EPH-LS-08-0640L-57-70-3S-CV5.ies
 Number luminaires used = 17
 kw these luminaires = 11.8

3S-CV2
 COOPER LIGHTING SOLUTIONS - EPHEBUS EPH-LS-08-0640L-57-70-3S-CV2
 Initial Lumens per lamp = -1
 Light Loss Factor = 0.950
 Watts per luminaire = 697
 Candela file name: EPH-LS-08-0640L-57-70-3S-CV2.ies
 Number luminaires used = 3
 kw these luminaires = 2.1

2S-CV5
 COOPER LIGHTING SOLUTIONS - EPHEBUS EPH-LS-08-0640L-57-70-2S-CV5
 Initial Lumens per lamp = -1
 Light Loss Factor = 0.950
 Watts per luminaire = 683
 Candela file name: EPH-LS-08-0640L-57-70-2S-CV5.ies
 Number luminaires used = 4
 kw these luminaires = 2.7

1S-CV5
 COOPER LIGHTING SOLUTIONS - EPHEBUS EPH-LS-08-0640L-57-70-1S-CV5
 Initial Lumens per lamp = -1
 Light Loss Factor = 0.950
 Watts per luminaire = 700
 Candela file name: EPH-LS-08-0640L-57-70-1S-CV5.ies
 Number luminaires used = 51
 kw these luminaires = 35.7

SLP1.01 SITE PLAN - SITE SPORTS LIGHTING PHOTOMETRICS
 NOT TO SCALE

MARK

FINCHER
 ENGINEERING, LLC
 FINCHER ENGINEERING, LLC
 TX FIRM #F-16408
 5621 114TH ST. SUITE 100
 LUBBOCK, TX 79424
 PH: 806-701-5109
 WWW.FINCHERENG.COM



PROJECT NAME:
MANOR ATHLETIC COMPLEX
 SITE LIGHTING PHOTOMETRICS



PROJECT NO.
 SHEET TITLE
 SITE SPORTS LIGHTING
 PHOTOMETRICS
 DATE OF ISSUE
 JUNE 14 2022
 SHEET NO.

SLP1

Project		Catalog #		Type	
Prepared by		Notes		Date	



Ephesus

LUMASPORT 8

White LED Sports & Entertainment Luminaire

Typical Applications

Pro Arenas • University & Collegiate Arenas • University & Collegiate Stadiums • Multi-Event & Convention Centers • Gymnasiums & Field Houses

Interactive Menu

- Dimensional Details [page 1](#)
- Ordering Information [page 2](#)
- Dimensional and Mounting Details [page 3](#)
- Visor (VHE) Configuration [page 4](#)
- Performance Data [page 5](#)
- Optical Performance Data [page 6](#)
- Ordering Information for Accessories [page 8](#)
- Accessory Dimensions and Part Details [page 9](#)
- Example System Topology [page 12](#)

Product Certification



Top Product Features

- 55,000 or 90,000 lumen output options
- Glare and cutoff control via Hybrid Reflector and TIR Optical System
- Reduce install time with pre-aimable two-piece assembly
- Virtually eliminate maintenance with power redundancy
- Industry leading light source reliability with Chip-on-Board LEDs
- Greater than 92% lumen maintenance at 55,000 hours
- Wireless AirMesh, Wired DMX or sACN controls options to suit your needs
- Impact Resistant Glass option protects from vandalization and prevents down time in the event of impact to the glass.
- Options to meet Trade Agreements Act requirements

Dimensional Details

LIGHT HEAD

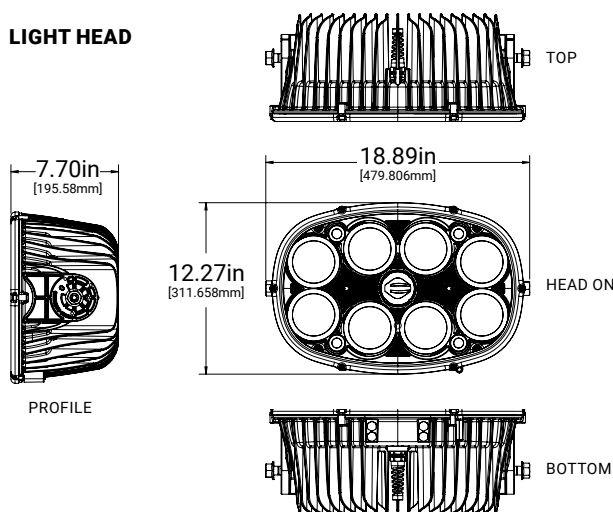

DRIVER BOX

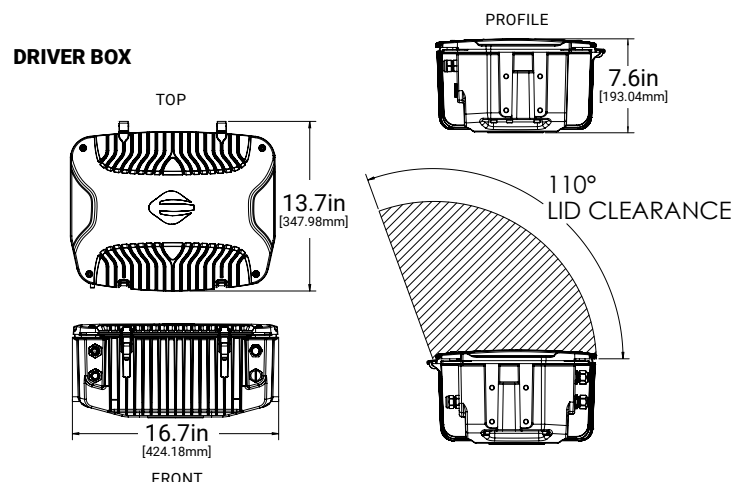

[Installation Instructions](#)

Order Information

NOTE: A complete fixture order requires a selection entry for **Brand, Family, Model, Power Configuration, Color, CCT, CRI, Optic, Light Head Cable (DC), Voltage, Control, Mount Configuration, Power Cable (AC), Options, Packaging, & International Option.**

SAMPLE ORDER NUMBER: EPH-LS-08-0320L-BLK-40-70-1S-C04-HV-LB-LY-A00-HEG-BP-ST

Brand	Family	Model	Power Configuration	Color	CCT	CRI	Optic	Light Head Cable (DC)
EPH = Ephesus, Standard TAA=Trade Agreements Act ¹	LS = Lumasport	08 = 8 Optics	0320L = 320W Local Power ² 0640L = 640W Local Power ²	BLK = Black WHT = White	40 = 4000K 50 = 5000K 57 = 5700K	70 = 70 CRI 80 = 80 CRI	1S = NEMA 3 17.5 33.3 2S = NEMA 3 21.9 40.2 3S = NEMA 3 25.4 45.7 4S = NEMA 4 36.0 64.4 5S = NEMA 5 46.6 82.6 7F ³ = NEMA 7 72.5 131.0	C04 = 4ft Cable, Standard C10 ⁷ = 10ft Cable, Catwalk Bracket
Notes: (1) Only product configurations with this designated prefix are built to be compliant with the Trade Agreements Act of 1979 (TAA). Please refer to DOMESTIC PREFERENCES website for more information. Components shipped separately may be separately analyzed under domestic preference requirements.			Notes: (2) Local Power means that the light head is attached to the driver box with the yoke or pendant mount.	Notes: (3) Not coastal rated. Contact Ephesus for coastal fixture options.			Notes: (4) Optic = NEMA TYPE; BEAM ANGLE; FIELD ANGLE. Additional optical performance data within spec sheet. (5) 7F = NEMA 7 Optic only available with 0320L = 320W Local Power configuration.	Notes: (6) DC Cable connecting the light head to the driver box. (7) C10 = 10ft Cable is intended to be used with the Ephesus Catwalk Bracket

Voltage	Control	Mount Configuration	Power Cable (AC)	Options	Packaging	International Option
LV = Low Voltage HV = High Voltage	NC = No Control AM = Wireless AirMesh LB = Wired DMX	LY = Local Yoke LP = Local Pendant	A00 = No Cable, Standard A04 = 4ft Cable A10 = 10ft Cable A15 = 15ft Cable	HEG = No Visor High Efficiency Glass Lens VHE = Visor High Efficiency Glass Lens IRG = No Visor Impact Resistant Glass Lens VIR = Visor Impact Resistant Glass Lens CV1 = 1 Louver Cutoff Visor CV2 = 2 Louver Cutoff Visor CV5 = 5 Louver Cutoff Visor	BP = Bulk Pack	ST = Standard
			Notes: (8) AC Cable connecting the Driver Box to the electrical power source.	Notes: (9) Accessories sold separately will be separately analyzed under domestic preference requirements. Consult factory for further information.		

DesignLights Consortium® Qualified. Refer to www.designlights.org Qualified Products List under Family Models for details

Dimensional and Mounting Details

MOUNTING: DRIVER BOX

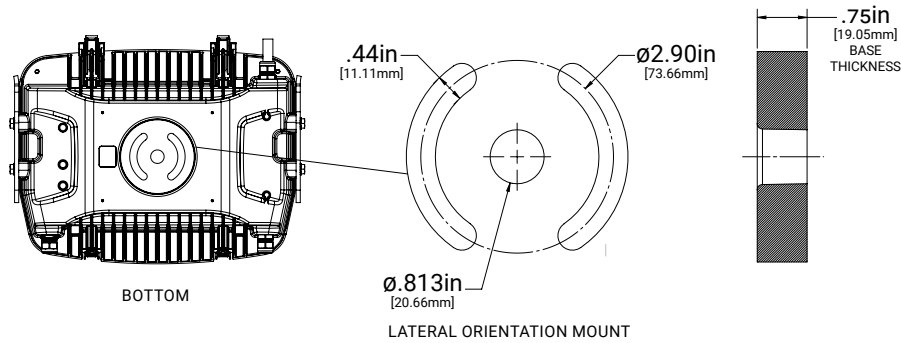

MOUNTING CONFIGURATION: LOCAL YOKE

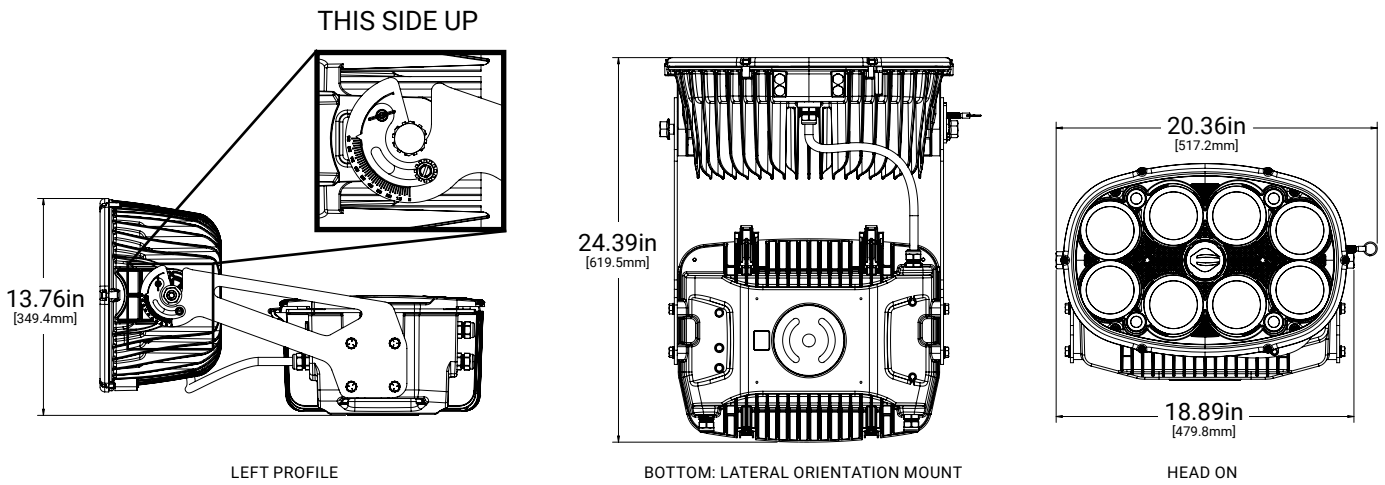

MOUNTING CONFIGURATION: LOCAL PENDANT

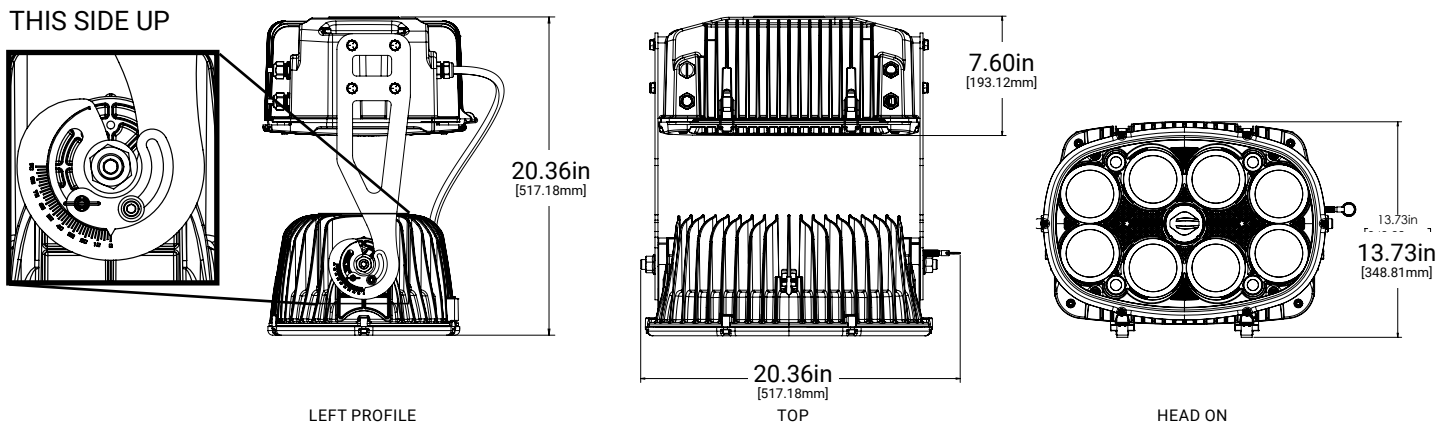

VHE & VIR Visor Option Dimensional Details

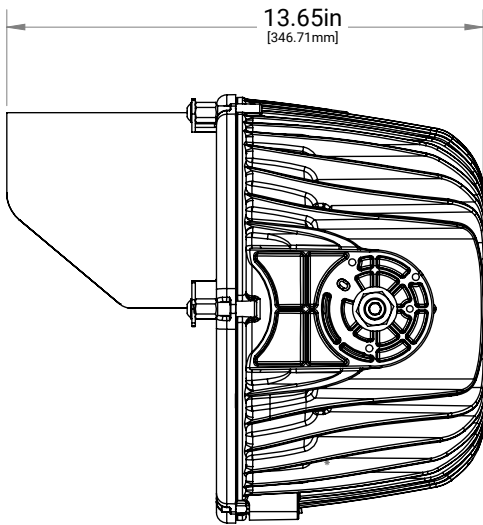

LEFT PROFILE: VISOR

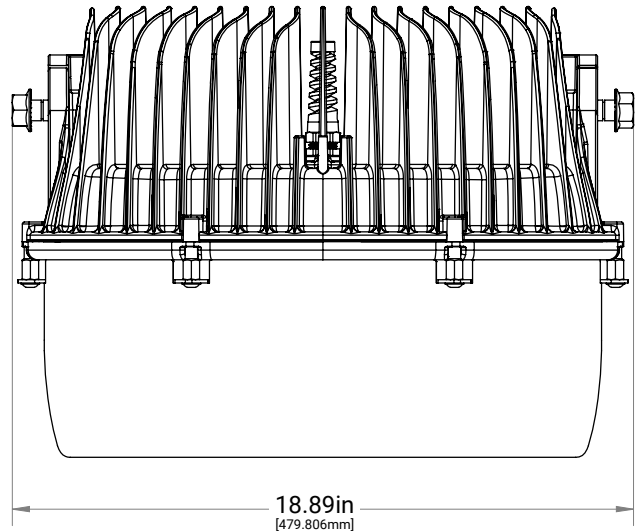

TOP: VISOR

NOTES:

The addition of a visor adds 1lb of material to the luminaire weight.

CV1, CV2, CV5 Cutoff Visor Options

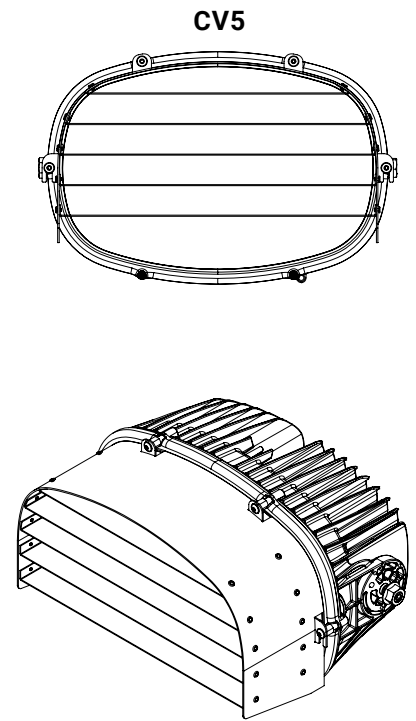
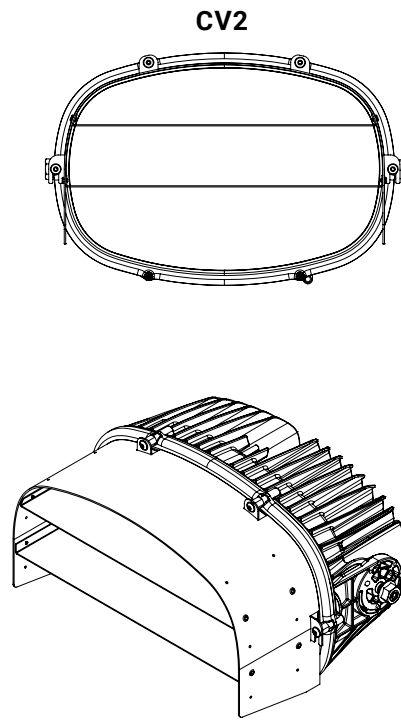
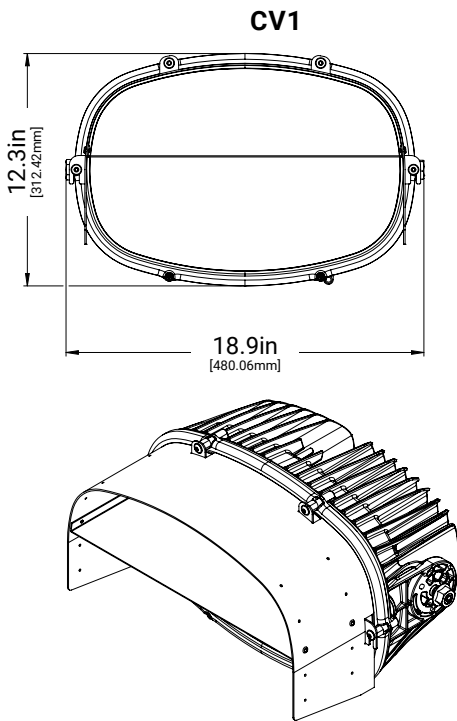

CV1, CV2, CV5 Cutoff Visor Option Dimensional Details

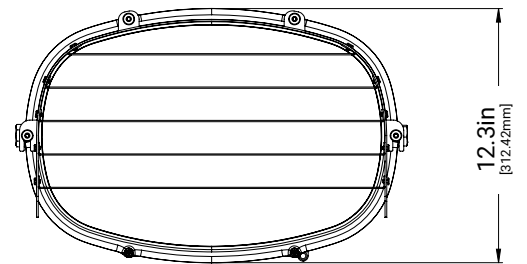
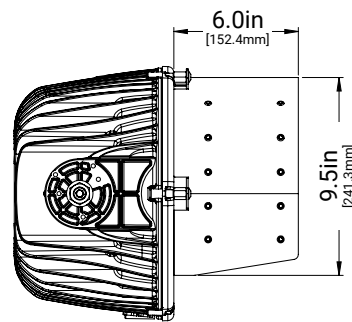
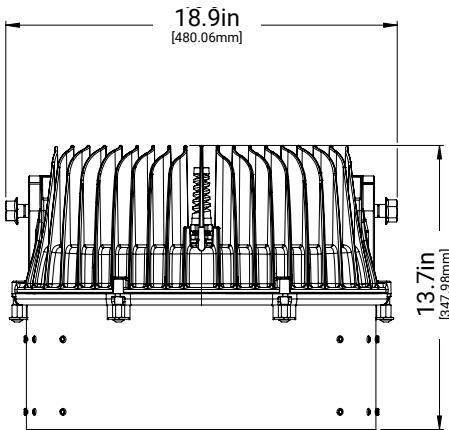

Performance Data¹

	LUMASPORT 8 (320W)	LUMASPORT 8 (640W)
Lumen Output Range²	48,303 - 55,419lm	80,572 - 92,929lm
Nominal Power³	340W	680W
Input Voltage (Low Voltage)	120-277VAC	120-277VAC
Input Voltage (High Voltage)	347-480VAC	347-480VAC
Efficacy Range²	140.4 - 163.5 lm/W	117.5 - 139.3 lm/W
CRI⁴	70, 80	70, 80
TLCI⁵	75	75
CCT Range	4000K, 5000K, 5700K	4000K, 5000K, 5700K
Distribution (NEMA)	3-5, 7	3-5
Dimming Range	DIM TO OFF, 10%-100%	DIM TO OFF, 10%-100%
Operating Temperature Range	-40°C to +40°C	-40°C to +40°C
Usage	INDOOR, OUTDOOR ⁶	INDOOR, OUTDOOR ⁶
Mounting Options (3G RATED)	LOCAL YOKE; LOCAL PENDANT	LOCAL YOKE; LOCAL PENDANT
Electrical Certifications	FCC, UL8750, UL1598, DLC Standard (NANQSV)	FCC, UL8750, UL1598, DLC Standard (NANQSV)
Environmental Certifications	IP66, NEMA4X ⁷	IP66, NEMA4X ⁷
Vibration	ANSI C136.31-2010 3G ⁸	ANSI C136.31-2010 3G ⁸
Surge	10kV	10kV
Effective Projected Area (EPA)	1.8 (sq. ft.)	1.8 (sq. ft.)
Effective Projected Area (EPA) with Visor (VHE, CV1, CV2, CV5)⁹	1.8 - 2.5 (sq. ft.)	1.8 - 2.5 (sq. ft.)
Approximate Weight¹⁰	67.5 LBS	71.5 LBS
Approximate Weight with Visor (VHE, CV1, CV2, CV5)¹⁰	71.5 LBS	75.5 LBS

NOTES:

- (1) Specifications are subject to change without notice.
- (2) Refer to Optical Performance Data.
- (3) Values are +/- 4% when fixture is operated at 25°C ambient
- (4) Values are +/- 2%
- (5) Values are +/- 3 points.
- (6) When driver box is mounted in upright position.
- (7) Light head meets NEMA4X Certification
- (8) LumaSport 8 with Visors (VHE, CV1, CV2, CV5) qualifies for ANSI C136, 31-2010 1.5G
- (9) EPA may vary depending on the aiming angle of the fixture.
- (10) Weight may vary depending on mounting bracket, VHE Visor option, light head and driver box selection.

Electrical Performance Data

Product	Input Voltage Range (VAC)	Nominal Input Power (W)	Input Current (A)	Power Factor (>60% Load)	THD (>60% Load)	Inrush (A2s)	Inrush period (ms)	Peak Inrush (A)
LS-8-320	120-277	340 (365 Max)	1.3 - 3.0 (4.0 Max)	> 0.9	< 20%	1.9	3.52	150
	347-480	340 (365 Max)	0.7 - 1.0 (1.5 Max)	> 0.9	< 20%	3.87	1.77	70
LS-8-640	120-277	680 (740 Max)	2.5 - 5.9 (8.0 Max)	> 0.9	< 20%	3.8	3.52	300
	347-480	680 (740 Max)	1.5 - 2.0 (3.0 Max)	> 0.9	< 20%	7.74	1.77	140

Optical Performance Data (HEG Configuration Option)

LUMASPORT 8 (320W) Lumen Outputs								
Optic	NEMA TYPE	CRI	CCT	Lumens	Input Power (W)	Lm/W	Beam Angle	Field Angle
1S	NEMA 3	70	4000K	53987	346	156.0	17.5	33.3
			5000K	54903	346	158.7	17.5	33.3
			5700K	53943	346	155.9	17.5	33.3
		80	4000K	50877	346	147.0	17.5	33.3
			5000K	51822	346	149.8	17.5	33.3
			5700K	50916	346	147.2	17.5	33.3
2S	NEMA 3	70	4000K	54494	339	160.7	21.9	40.2
			5000K	55419	339	163.5	21.9	40.2
			5700K	54450	339	160.6	21.9	40.2
		80	4000K	51346	339	151.5	21.9	40.2
			5000K	52308	339	154.3	21.9	40.2
			5700K	51400	339	151.6	21.9	40.2
3S	NEMA 3	70	4000K	53275	344	154.9	25.4	45.7
			5000K	54179	344	157.5	25.4	45.7
			5700K	53232	344	154.7	25.4	45.7
		80	4000K	50200	344	145.9	25.4	45.7
			5000K	51137	344	148.7	25.4	45.7
			5700K	50209	344	146.0	25.4	45.7
4S	NEMA 4	70	4000K	53419	344	155.3	36.0	64.4
			5000K	54325	344	157.9	36.0	64.4
			5700K	53375	344	155.2	36.0	64.4
		80	4000K	50335	344	146.3	36.0	64.4
			5000K	51275	344	149.1	36.0	64.4
			5700K	50344	344	146.3	36.0	64.4
5S	NEMA 5	70	4000K	54338	344	158.0	46.6	82.6
			5000K	55260	344	160.6	46.6	82.6
			5700K	54294	344	157.8	46.6	82.6
		80	4000K	51202	344	148.8	46.6	82.6
			5000K	52158	344	151.6	46.6	82.6
			5700K	51211	344	148.9	46.6	82.6
7F	NEMA 7	70	4000K	51262	344	149.0	72.5	131.0
			5000K	52132	344	151.5	72.5	131.0
			5700K	51220	344	148.9	72.5	131.0
		80	4000K	48303	344	140.4	72.5	131.0
			5000K	49205	344	143.0	72.5	131.0
			5700K	48312	344	140.4	72.5	131.0

LUMASPORT 8 (640W) Lumen Outputs								
Optic	NEMA TYPE	CRI	CCT	Lumens	Input Power (W)	Lm/W	Beam Angle	Field Angle
1S	NEMA 3	70	4000K	85498	686	124.6	17.5	33.3
			5000K	88248	686	128.6	17.5	33.3
			5700K	86402	686	126.0	17.5	33.3
		80	4000K	80572	686	117.5	17.5	33.3
			5000K	83295	686	121.4	17.5	33.3
			5700K	81554	686	118.9	17.5	33.3
2S	NEMA 3	70	4000K	90033	667	135.0	21.9	40.2
			5000K	92929	667	139.3	21.9	40.2
			5700K	90985	667	136.4	21.9	40.2
		80	4000K	84832	667	127.2	21.9	40.2
			5000K	87713	667	131.5	21.9	40.2
			5700K	85888	667	128.8	21.9	40.2
3S	NEMA 3	70	4000K	88702	681	130.3	25.4	45.7
			5000K	91555	681	134.4	25.4	45.7
			5700K	89640	681	131.6	25.4	45.7
		80	4000K	83582	681	122.7	25.4	45.7
			5000K	86415	681	126.9	25.4	45.7
			5700K	84550	681	124.2	25.4	45.7
4S	NEMA 4	70	4000K	88659	681	130.2	36.0	64.4
			5000K	91510	681	134.4	36.0	64.4
			5700K	89596	681	131.6	36.0	64.4
		80	4000K	83541	681	122.7	36.0	64.4
			5000K	86372	681	126.8	36.0	64.4
			5700K	84508	681	124.1	36.0	64.4
5S	NEMA 5	70	4000K	89953	681	132.1	46.6	82.6
			5000K	92846	681	136.3	46.6	82.6
			5700K	90904	681	133.5	46.6	82.6
		80	4000K	84761	681	124.5	46.6	82.6
			5000K	87633	681	128.7	46.6	82.6
			5700K	85742	681	125.9	46.6	82.6

Optical Performance Data (VHE Visor Configuration Option)

LUMASPORT 8 (320W) Lumen Outputs								
Optic	NEMA TYPE	CRI	CCT	Lumens	Input Power (W)	Lm/W	Beam Angle	Field Angle
1S	NEMA 3	70	4000K	50557	346	146.1	18.3	33.0
			5000K	51415	346	148.6	18.3	33.0
			5700K	50516	346	146.0	18.3	33.0
		80	4000K	47645	346	137.7	18.3	33.0
			5000K	48530	346	140.3	18.3	33.0
			5700K	47681	346	137.8	18.3	33.0
2S	NEMA 3	70	4000K	51545	339	152.1	22.5	38.8
			5000K	52420	339	154.6	22.5	38.8
			5700K	51504	339	151.9	22.5	38.8
		80	4000K	48568	339	143.3	22.5	38.8
			5000K	49478	339	146.0	22.5	38.8
			5700K	48619	339	143.4	22.5	38.8
3S	NEMA 3	70	4000K	50127	344	145.7	25.7	44.3
			5000K	50977	344	148.2	25.7	44.3
			5700K	50086	344	145.6	25.7	44.3
		80	4000K	47234	344	137.3	25.7	44.3
			5000K	48115	344	139.9	25.7	44.3
			5700K	47242	344	137.3	25.7	44.3
4S	NEMA 4	70	4000K	50235	344	146.0	35.1	63.7
			5000K	51087	344	148.5	35.1	63.7
			5700K	50193	344	145.9	35.1	63.7
		80	4000K	47334	344	137.6	35.1	63.7
			5000K	48218	344	140.2	35.1	63.7
			5700K	47343	344	137.6	35.1	63.7
5S	NEMA 5	70	4000K	49723	344	144.5	44.5	80.5
			5000K	50567	344	147.0	44.5	80.5
			5700K	49683	344	144.4	44.5	80.5
		80	4000K	46854	344	136.2	44.5	80.5
			5000K	47728	344	138.7	44.5	80.5
			5700K	46862	344	136.2	44.5	80.5
7F	NEMA 7	70	4000K	43036	344	125.1	66.7	121.6
			5000K	43767	344	127.2	66.7	121.6
			5700K	43001	344	125.0	66.7	121.6
		80	4000K	40552	344	117.9	66.7	121.6
			5000K	41309	344	120.1	66.7	121.6
			5700K	40560	344	117.9	66.7	121.6

LUMASPORT 8 (640W) Lumen Outputs								
Optic	NEMA TYPE	CRI	CCT	Lumens	Input Power (W)	Lm/W	Beam Angle	Field Angle
1S	NEMA 3	70	4000K	80066	686	116.7	18.3	33.0
			5000K	82642	686	120.5	18.3	33.0
			5700K	80913	686	117.9	18.3	33.0
		80	4000K	75453	686	110.0	18.3	33.0
			5000K	78003	686	113.7	18.3	33.0
			5700K	76373	686	111.3	18.3	33.0
2S	NEMA 3	70	4000K	85162	667	127.7	22.5	38.8
			5000K	87901	667	131.8	22.5	38.8
			5700K	86062	667	129.0	22.5	38.8
		80	4000K	80242	667	120.3	22.5	38.8
			5000K	82967	667	124.4	22.5	38.8
			5700K	81241	667	121.8	22.5	38.8
3S	NEMA 3	70	4000K	83460	681	122.6	25.7	44.3
			5000K	86145	681	126.5	25.7	44.3
			5700K	84343	681	123.9	25.7	44.3
		80	4000K	78643	681	115.5	25.7	44.3
			5000K	81309	681	119.4	25.7	44.3
			5700K	79554	681	116.8	25.7	44.3
4S	NEMA 4	70	4000K	83374	681	122.4	35.1	63.7
			5000K	86055	681	126.4	35.1	63.7
			5700K	84255	681	123.7	35.1	63.7
		80	4000K	78561	681	115.4	35.1	63.7
			5000K	81223	681	119.3	35.1	63.7
			5700K	79470	681	116.7	35.1	63.7
5S	NEMA 5	70	4000K	82314	681	120.9	44.5	80.5
			5000K	84961	681	124.8	44.5	80.5
			5700K	83184	681	122.1	44.5	80.5
		80	4000K	77563	681	113.9	44.5	80.5
			5000K	80191	681	117.8	44.5	80.5
			5700K	78460	681	115.2	44.5	80.5

Optical Performance Data (IRG Configuration Option)

LUMASPORT 8 (320W) Lumen Outputs								
Optic	NEMA TYPE	CRI	CCT	Lumens	Input Power (W)	Lm/W	Beam Angle	Field Angle
1S	NEMA 3	70	4000K	49815	346	144.0	17.5	33.3
			5000K	50660	346	146.4	17.5	33.3
			5700K	49774	346	143.9	17.5	33.3
		80	4000K	46945	346	135.7	17.5	33.3
			5000K	47817	346	138.2	17.5	33.3
			5700K	46981	346	135.8	17.5	33.3
2S	NEMA 3	70	4000K	50283	339	148.3	21.9	40.2
			5000K	51136	339	150.8	21.9	40.2
			5700K	50242	339	148.2	21.9	40.2
		80	4000K	47378	339	139.8	21.9	40.2
			5000K	48266	339	142.4	21.9	40.2
			5700K	47428	339	139.9	21.9	40.2
3S	NEMA 3	70	4000K	49158	344	142.9	25.4	45.7
			5000K	49992	344	145.3	25.4	45.7
			5700K	49118	344	142.8	25.4	45.7
		80	4000K	46321	344	134.7	25.4	45.7
			5000K	47185	344	137.2	25.4	45.7
			5700K	46329	344	134.7	25.4	45.7
4S	NEMA 4	70	4000K	49291	344	143.3	36.0	64.4
			5000K	50127	344	145.7	36.0	64.4
			5700K	49250	344	143.2	36.0	64.4
		80	4000K	46445	344	135.0	36.0	64.4
			5000K	47313	344	137.5	36.0	64.4
			5700K	46454	344	135.0	36.0	64.4
5S	NEMA 5	70	4000K	50139	344	145.8	46.6	82.6
			5000K	50990	344	148.2	46.6	82.6
			5700K	50098	344	145.6	46.6	82.6
		80	4000K	47245	344	137.3	46.6	82.6
			5000K	48127	344	139.9	46.6	82.6
			5700K	47254	344	137.4	46.6	82.6
7F	NEMA 7	70	4000K	47301	344	137.5	72.5	131.0
			5000K	48103	344	139.8	72.5	131.0
			5700K	47262	344	137.4	72.5	131.0
		80	4000K	44570	344	129.6	72.5	131.0
			5000K	45403	344	132.0	72.5	131.0
			5700K	44579	344	129.6	72.5	131.0

LUMASPORT 8 (640W) Lumen Outputs								
Optic	NEMA TYPE	CRI	CCT	Lumens	Input Power (W)	Lm/W	Beam Angle	Field Angle
1S	NEMA 3	70	4000K	78891	686	115.0	17.5	33.3
			5000K	81428	686	118.7	17.5	33.3
			5700K	79725	686	116.2	17.5	33.3
		80	4000K	74346	686	108.4	17.5	33.3
			5000K	76858	686	112.0	17.5	33.3
			5700K	75252	686	109.7	17.5	33.3
2S	NEMA 3	70	4000K	83075	667	124.6	21.9	40.2
			5000K	85748	667	128.6	21.9	40.2
			5700K	83954	667	125.9	21.9	40.2
		80	4000K	78276	667	117.4	21.9	40.2
			5000K	80935	667	121.3	21.9	40.2
			5700K	79251	667	118.8	21.9	40.2
3S	NEMA 3	70	4000K	81847	681	120.2	25.4	45.7
			5000K	84480	681	124.1	25.4	45.7
			5700K	82713	681	121.5	25.4	45.7
		80	4000K	77123	681	113.2	25.4	45.7
			5000K	79737	681	117.1	25.4	45.7
			5700K	78016	681	114.6	25.4	45.7
4S	NEMA 4	70	4000K	81808	681	120.1	36.0	64.4
			5000K	84438	681	124.0	36.0	64.4
			5700K	82672	681	121.4	36.0	64.4
		80	4000K	77085	681	113.2	36.0	64.4
			5000K	79697	681	117.0	36.0	64.4
			5700K	77977	681	114.5	36.0	64.4
5S	NEMA 5	70	4000K	83002	681	121.9	46.6	82.6
			5000K	85671	681	125.8	46.6	82.6
			5700K	83879	681	123.2	46.6	82.6
		80	4000K	78211	681	114.8	46.6	82.6
			5000K	80861	681	118.7	46.6	82.6
			5700K	79116	681	116.2	46.6	82.6

Optical Performance Data (VIR Configuration Option)

LUMASPORT 8 (320W) Lumen Outputs								
Optic	NEMA TYPE	CRI	CCT	Lumens	Input Power (W)	Lm/W	Beam Angle	Field Angle
1S	NEMA 3	70	4000K	46650	346	134.8	18.3	33.0
			5000K	47442	346	137.1	18.3	33.0
			5700K	46612	346	134.7	18.3	33.0
		80	4000K	43963	346	127.1	18.3	33.0
			5000K	44780	346	129.4	18.3	33.0
			5700K	43997	346	127.2	18.3	33.0
2S	NEMA 3	70	4000K	47562	339	140.3	22.5	38.8
			5000K	48369	339	142.7	22.5	38.8
			5700K	47524	339	140.2	22.5	38.8
		80	4000K	44815	339	132.2	22.5	38.8
			5000K	45654	339	134.7	22.5	38.8
			5700K	44862	339	132.3	22.5	38.8
3S	NEMA 3	70	4000K	46253	344	134.5	25.7	44.3
			5000K	47038	344	136.7	25.7	44.3
			5700K	46216	344	134.3	25.7	44.3
		80	4000K	43583	344	126.7	25.7	44.3
			5000K	44397	344	129.1	25.7	44.3
			5700K	43591	344	126.7	25.7	44.3
4S	NEMA 4	70	4000K	46353	344	134.7	35.1	63.7
			5000K	47139	344	137.0	35.1	63.7
			5700K	46314	344	134.6	35.1	63.7
		80	4000K	43677	344	127.0	35.1	63.7
			5000K	44492	344	129.3	35.1	63.7
			5700K	43684	344	127.0	35.1	63.7
5S	NEMA 5	70	4000K	45881	344	133.4	44.5	80.5
			5000K	46659	344	135.6	44.5	80.5
			5700K	45844	344	133.3	44.5	80.5
		80	4000K	43233	344	125.7	44.5	80.5
			5000K	44040	344	128.0	44.5	80.5
			5700K	43241	344	125.7	44.5	80.5
7F	NEMA 7	70	4000K	39710	344	115.4	66.7	121.6
			5000K	40384	344	117.4	66.7	121.6
			5700K	39678	344	115.3	66.7	121.6
		80	4000K	37418	344	108.8	66.7	121.6
			5000K	38117	344	110.8	66.7	121.6
			5700K	37425	344	108.8	66.7	121.6

LUMASPORT 8 (640W) Lumen Outputs								
Optic	NEMA TYPE	CRI	CCT	Lumens	Input Power (W)	Lm/W	Beam Angle	Field Angle
1S	NEMA 3	70	4000K	73879	686	107.7	18.3	33.0
			5000K	76255	686	111.2	18.3	33.0
			5700K	74660	686	108.8	18.3	33.0
		80	4000K	69622	686	101.5	18.3	33.0
			5000K	71975	686	104.9	18.3	33.0
			5700K	70471	686	102.7	18.3	33.0
2S	NEMA 3	70	4000K	78580	667	117.8	22.5	38.8
			5000K	81108	667	121.6	22.5	38.8
			5700K	79411	667	119.1	22.5	38.8
		80	4000K	74041	667	111.0	22.5	38.8
			5000K	76555	667	114.8	22.5	38.8
			5700K	74963	667	112.4	22.5	38.8
3S	NEMA 3	70	4000K	77011	681	113.1	25.7	44.3
			5000K	79488	681	116.7	25.7	44.3
			5700K	77825	681	114.3	25.7	44.3
		80	4000K	72566	681	106.6	25.7	44.3
			5000K	75025	681	110.2	25.7	44.3
			5700K	73406	681	107.8	25.7	44.3
4S	NEMA 4	70	4000K	76931	681	113.0	35.1	63.7
			5000K	79405	681	116.6	35.1	63.7
			5700K	77744	681	114.2	35.1	63.7
		80	4000K	72490	681	106.4	35.1	63.7
			5000K	74946	681	110.1	35.1	63.7
			5700K	73329	681	107.7	35.1	63.7
5S	NEMA 5	70	4000K	75953	681	111.5	44.5	80.5
			5000K	78395	681	115.1	44.5	80.5
			5700K	76756	681	112.7	44.5	80.5
		80	4000K	71569	681	105.1	44.5	80.5
			5000K	73994	681	108.7	44.5	80.5
			5700K	72397	681	106.3	44.5	80.5

Optical Performance Data (CV1 Configuration Option)

LUMASPORT 8 (320W) Lumen Outputs								
Optic	NEMA TYPE	CRI	CCT	Lumens	Input Power (W)	Lm/W	Beam Angle	Field Angle
1S	NEMA 3	70	4000K	43530	354	123.0	17.3	32.0
			5000K	44268	354	125.1	17.3	32.0
			5700K	43494	354	122.9	17.3	32.0
		80	4000K	41022	354	115.9	17.3	32.0
			5000K	41784	354	118.0	17.3	32.0
			5700K	41053	354	116.0	17.3	32.0
2S	NEMA 3	70	4000K	43533	347	125.5	21.6	38.4
			5000K	44272	347	127.6	21.6	38.4
			5700K	43498	347	125.4	21.6	38.4
		80	4000K	41018	347	118.2	21.6	38.4
			5000K	41786	347	120.4	21.6	38.4
			5700K	41061	347	118.3	21.6	38.4
3S	NEMA 3	70	4000K	43468	352	123.5	24.3	43.9
			5000K	44206	352	125.6	24.3	43.9
			5700K	43433	352	123.4	24.3	43.9
		80	4000K	40959	352	116.4	24.3	43.9
			5000K	41724	352	118.5	24.3	43.9
			5700K	40966	352	116.4	24.3	43.9
4S	NEMA 4	70	4000K	42009	352	119.3	33.1	59.2
			5000K	42722	352	121.4	33.1	59.2
			5700K	41975	352	119.2	33.1	59.2
		80	4000K	39584	352	112.5	33.1	59.2
			5000K	40323	352	114.6	33.1	59.2
			5700K	39591	352	112.5	33.1	59.2
5S	NEMA 5	70	4000K	39742	352	112.9	39.9	74.0
			5000K	40416	352	114.8	39.9	74.0
			5700K	39709	352	112.8	39.9	74.0
		80	4000K	37448	352	106.4	39.9	74.0
			5000K	38147	352	108.4	39.9	74.0
			5700K	37455	352	106.4	39.9	74.0
7F	NEMA 7	70	4000K	30408	352	86.4	57.7	107.8
			5000K	30924	352	87.9	57.7	107.8
			5700K	30383	352	86.3	57.7	107.8
		80	4000K	28653	352	81.4	57.7	107.8
			5000K	29188	352	82.9	57.7	107.8
			5700K	28658	352	81.4	57.7	107.8

LUMASPORT 8 (640W) Lumen Outputs								
Optic	NEMA TYPE	CRI	CCT	Lumens	Input Power (W)	Lm/W	Beam Angle	Field Angle
1S	NEMA 3	70	4000K	68937	700	98.5	17.3	32.0
			5000K	71154	700	101.6	17.3	32.0
			5700K	69666	700	99.5	17.3	32.0
		80	4000K	64965	700	92.8	17.3	32.0
			5000K	67161	700	95.9	17.3	32.0
			5700K	65757	700	93.9	17.3	32.0
2S	NEMA 3	70	4000K	71923	683	105.3	21.6	38.4
			5000K	74237	683	108.7	21.6	38.4
			5700K	72684	683	106.4	21.6	38.4
		80	4000K	67768	683	99.2	21.6	38.4
			5000K	70070	683	102.6	21.6	38.4
			5700K	68612	683	100.5	21.6	38.4
3S	NEMA 3	70	4000K	72373	697	103.8	24.3	43.9
			5000K	74701	697	107.2	24.3	43.9
			5700K	73139	697	104.9	24.3	43.9
		80	4000K	68196	697	97.8	24.3	43.9
			5000K	70507	697	101.2	24.3	43.9
			5700K	68986	697	99.0	24.3	43.9
4S	NEMA 4	70	4000K	69722	697	100.0	33.1	59.2
			5000K	71964	697	103.2	33.1	59.2
			5700K	70459	697	101.1	33.1	59.2
		80	4000K	65698	697	94.3	33.1	59.2
			5000K	67924	697	97.5	33.1	59.2
			5700K	66458	697	95.3	33.1	59.2
5S	NEMA 5	70	4000K	65790	697	94.4	39.9	74.0
			5000K	67905	697	97.4	39.9	74.0
			5700K	66485	697	95.4	39.9	74.0
		80	4000K	61992	697	88.9	39.9	74.0
			5000K	64093	697	92.0	39.9	74.0
			5700K	62710	697	90.0	39.9	74.0

Optical Performance Data (CV2 Configuration Option)

LUMASPORT 8 (320W) Lumen Outputs								
Optic	NEMA TYPE	CRI	CCT	Lumens	Input Power (W)	Lm/W	Beam Angle	Field Angle
1S	NEMA 3	70	4000K	40742	354	115.1	17.2	32.2
			5000K	41433	354	117.0	17.2	32.2
			5700K	40709	354	115.0	17.2	32.2
		80	4000K	38395	354	108.5	17.2	32.2
			5000K	39108	354	110.5	17.2	32.2
			5700K	38424	354	108.5	17.2	32.2
2S	NEMA 3	70	4000K	40915	347	117.9	21.6	38.4
			5000K	41609	347	119.9	21.6	38.4
			5700K	40882	347	117.8	21.6	38.4
		80	4000K	38551	347	111.1	21.6	38.4
			5000K	39273	347	113.2	21.6	38.4
			5700K	38592	347	111.2	21.6	38.4
3S	NEMA 3	70	4000K	40894	352	116.2	24.1	43.9
			5000K	41588	352	118.1	24.1	43.9
			5700K	40861	352	116.1	24.1	43.9
		80	4000K	38534	352	109.5	24.1	43.9
			5000K	39253	352	111.5	24.1	43.9
			5700K	38541	352	109.5	24.1	43.9
4S	NEMA 4	70	4000K	38643	352	109.8	33.2	58.7
			5000K	39298	352	111.6	33.2	58.7
			5700K	38611	352	109.7	33.2	58.7
		80	4000K	36412	352	103.4	33.2	58.7
			5000K	37092	352	105.4	33.2	58.7
			5700K	36419	352	103.5	33.2	58.7
5S	NEMA 5	70	4000K	36037	352	102.4	41.7	74.9
			5000K	36648	352	104.1	41.7	74.9
			5700K	36008	352	102.3	41.7	74.9
		80	4000K	33957	352	96.5	41.7	74.9
			5000K	34591	352	98.3	41.7	74.9
			5700K	33963	352	96.5	41.7	74.9
7F	NEMA 7	70	4000K	26508	352	75.3	58.6	108.9
			5000K	26958	352	76.6	58.6	108.9
			5700K	26486	352	75.2	58.6	108.9
		80	4000K	24978	352	71.0	58.6	108.9
			5000K	25444	352	72.3	58.6	108.9
			5700K	24983	352	71.0	58.6	108.9

LUMASPORT 8 (640W) Lumen Outputs								
Optic	NEMA TYPE	CRI	CCT	Lumens	Input Power (W)	Lm/W	Beam Angle	Field Angle
1S	NEMA 3	70	4000K	64522	700	92.2	17.2	32.2
			5000K	66598	700	95.1	17.2	32.2
			5700K	65204	700	93.1	17.2	32.2
		80	4000K	60805	700	86.9	17.2	32.2
			5000K	62860	700	89.8	17.2	32.2
			5700K	61546	700	87.9	17.2	32.2
2S	NEMA 3	70	4000K	67598	683	99.0	21.6	38.4
			5000K	69772	683	102.2	21.6	38.4
			5700K	68312	683	100.0	21.6	38.4
		80	4000K	63693	683	93.3	21.6	38.4
			5000K	65856	683	96.4	21.6	38.4
			5700K	64485	683	94.4	21.6	38.4
3S	NEMA 3	70	4000K	68089	697	97.7	24.1	43.9
			5000K	70278	697	100.8	24.1	43.9
			5700K	68809	697	98.7	24.1	43.9
		80	4000K	64158	697	92.0	24.1	43.9
			5000K	66333	697	95.2	24.1	43.9
			5700K	64901	697	93.1	24.1	43.9
4S	NEMA 4	70	4000K	64135	697	92.0	33.2	58.7
			5000K	66198	697	95.0	33.2	58.7
			5700K	64813	697	93.0	33.2	58.7
		80	4000K	60433	697	86.7	33.2	58.7
			5000K	62481	697	89.6	33.2	58.7
			5700K	61133	697	87.7	33.2	58.7
5S	NEMA 5	70	4000K	59657	697	85.6	41.7	74.9
			5000K	61575	697	88.3	41.7	74.9
			5700K	60287	697	86.5	41.7	74.9
		80	4000K	56213	697	80.6	41.7	74.9
			5000K	58118	697	83.4	41.7	74.9
			5700K	56864	697	81.6	41.7	74.9

Optical Performance Data (CV5 Configuration Option)

LUMASPORT 8 (320W) Lumen Outputs								
Optic	NEMA TYPE	CRI	CCT	Lumens	Input Power (W)	Lm/W	Beam Angle	Field Angle
1S	NEMA 3	70	4000K	35182	354	99.4	17.1	32.0
			5000K	35779	354	101.1	17.1	32.0
			5700K	35153	354	99.3	17.1	32.0
		80	4000K	33155	354	93.7	17.1	32.0
			5000K	33771	354	95.4	17.1	32.0
			5700K	33180	354	93.7	17.1	32.0
2S	NEMA 3	70	4000K	34584	347	99.7	21.3	38.4
			5000K	35171	347	101.4	21.3	38.4
			5700K	34556	347	99.6	21.3	38.4
		80	4000K	32586	347	93.9	21.3	38.4
			5000K	33197	347	95.7	21.3	38.4
			5700K	32620	347	94.0	21.3	38.4
3S	NEMA 3	70	4000K	33745	352	95.9	24.0	43.8
			5000K	34317	352	97.5	24.0	43.8
			5700K	33717	352	95.8	24.0	43.8
		80	4000K	31797	352	90.3	24.0	43.8
			5000K	32391	352	92.0	24.0	43.8
			5700K	31803	352	90.3	24.0	43.8
4S	NEMA 4	70	4000K	30818	352	87.6	33.1	58.6
			5000K	31341	352	89.0	33.1	58.6
			5700K	30793	352	87.5	33.1	58.6
		80	4000K	29039	352	82.5	33.1	58.6
			5000K	29581	352	84.0	33.1	58.6
			5700K	29044	352	82.5	33.1	58.6
5S	NEMA 5	70	4000K	27810	352	79.0	41.9	74.8
			5000K	28282	352	80.3	41.9	74.8
			5700K	27787	352	78.9	41.9	74.8
		80	4000K	26205	352	74.4	41.9	74.8
			5000K	26694	352	75.8	41.9	74.8
			5700K	26210	352	74.5	41.9	74.8
7F	NEMA 7	70	4000K	19710	352	56.0	58.6	109.0
			5000K	20044	352	56.9	58.6	109.0
			5700K	19694	352	55.9	58.6	109.0
		80	4000K	18572	352	52.8	58.6	109.0
			5000K	18919	352	53.7	58.6	109.0
			5700K	18575	352	52.8	58.6	109.0

LUMASPORT 8 (640W) Lumen Outputs								
Optic	NEMA TYPE	CRI	CCT	Lumens	Input Power (W)	Lm/W	Beam Angle	Field Angle
1S	NEMA 3	70	4000K	55716	700	79.6	17.1	32.0
			5000K	57509	700	82.2	17.1	32.0
			5700K	56306	700	80.4	17.1	32.0
		80	4000K	52506	700	75.0	17.1	32.0
			5000K	54281	700	77.5	17.1	32.0
			5700K	53146	700	75.9	17.1	32.0
2S	NEMA 3	70	4000K	57138	683	83.7	21.3	38.4
			5000K	58976	683	86.3	21.3	38.4
			5700K	57742	683	84.5	21.3	38.4
		80	4000K	53837	683	78.8	21.3	38.4
			5000K	55666	683	81.5	21.3	38.4
			5700K	54508	683	79.8	21.3	38.4
3S	NEMA 3	70	4000K	56184	697	80.6	24.0	43.8
			5000K	57992	697	83.2	24.0	43.8
			5700K	56779	697	81.5	24.0	43.8
		80	4000K	52941	697	76.0	24.0	43.8
			5000K	54736	697	78.5	24.0	43.8
			5700K	53555	697	76.8	24.0	43.8
4S	NEMA 4	70	4000K	51149	697	73.4	33.1	58.6
			5000K	52793	697	75.7	33.1	58.6
			5700K	51689	697	74.2	33.1	58.6
		80	4000K	48196	697	69.1	33.1	58.6
			5000K	49829	697	71.5	33.1	58.6
			5700K	48754	697	69.9	33.1	58.6
5S	NEMA 5	70	4000K	46038	697	66.1	41.9	74.8
			5000K	47518	697	68.2	41.9	74.8
			5700K	46524	697	66.7	41.9	74.8
		80	4000K	43380	697	62.2	41.9	74.8
			5000K	44850	697	64.3	41.9	74.8
			5700K	43882	697	63.0	41.9	74.8

Ordering Information for Accessories

NOTE: A complete accessory order requires a selection entry for **Brand, Accessory, Option**.

SAMPLE ORDER NUMBER: **EPH-HRDM34-025**

Brand	Accessory	Option	Intended Use
EPH = Ephesus	EXTPLT = Extension Plate ¹	025 = .25in 050 = .5in 200 = 2.0in	Extension Plate Kit to mount to structures .25in, .5in, or 2.00in thick. Designed to be used with the LUMASPORT 8 , LUMADAPT 8 , PRISM RGBA & ALL FIELD luminaires only.
	DVGBRD = Diving Board ²		Diving Board to mount to 2in x 4in steel cross arms. Designed to be used with the LUMASPORT 8 , LUMASPORT 16 , LUMADAPT 8 & PRISM RGBA luminaires only.
	HRDM58 = Mounting Hardware 5/8in diameter	050 = .375in - .50in Range of Clamping Thickness ³ 200 = 2in Clamping Thickness ³	HRDM58-050 : .375-.500in clamping thickness, Use for Extension Plate (EXTPLT) or other flat surfaces drilled for 5/8in hardware HRDM58-200 : 2.00in clamping thickness, use for 2in x 4in Cross arms that are drilled for 5/8in hardware
	HRDM34 = Mounting Hardware 3/4in diameter	025 = .25in ⁴ 075 = .75in ⁴ 200 = 2in ⁴	HRDM34-025 : .25-.50in clamping thickness, use for diving board (DVGBRD) or other flat surfaces drilled for 3/4in hardware HRDM34-075 : .50-.75in clamping thickness, flat surfaces drilled for 3/4in hardware HRDM34-200 : 2.00in clamping thickness, use for 2in x 4in Cross arms that are drilled for 3/4in hardware
	Notes: (1) Additional mounting fastener hardware kit needed to attach a fixture to the EXTPLT = Extension Plate (2) Additional mounting fastener hardware kit needed to attach a fixture to the DVGBRD = Diving Board	Notes: (3) Option only available for use with HRDM58 (4) Option only available for use with HRDM34	

Extension Plate (EXTPLT) Dimension and Part Details:

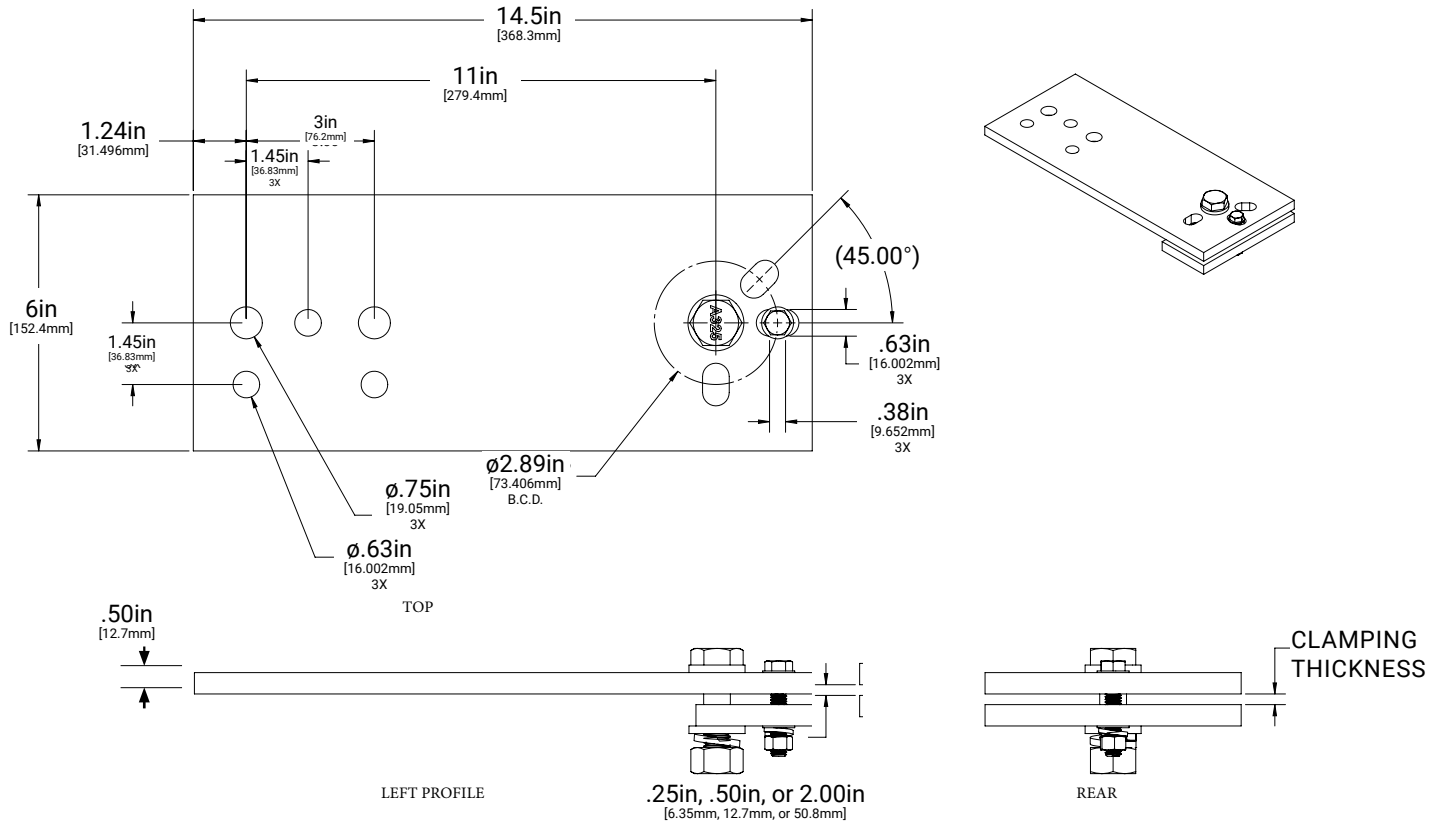

Extension Plate Data

MODEL #	WEIGHT (LBS)
EXTPLT	14.63
EXTPLT + HRDM58-050	15.28

Extension Plate Kit Parts

DESCRIPTION	QUANTITY
Extension Plate	1
Washer Plate	1
5/8in Hex Bolt	1
5/8in Washer	2
5/8in-11 Hex Nut	1
5/8in Split Washer	1
3/8in Washer	2
3/8in Hex Bolt	1
3/8in Split Washer	1
3/8in-16 Hex Nut	1

Diving Board (DVGBRD) Dimension and Part Details:

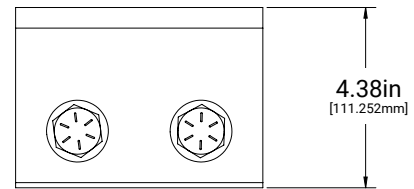
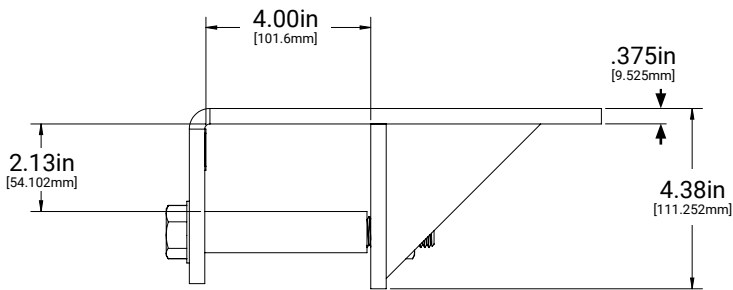
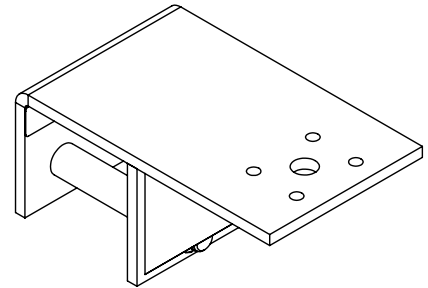
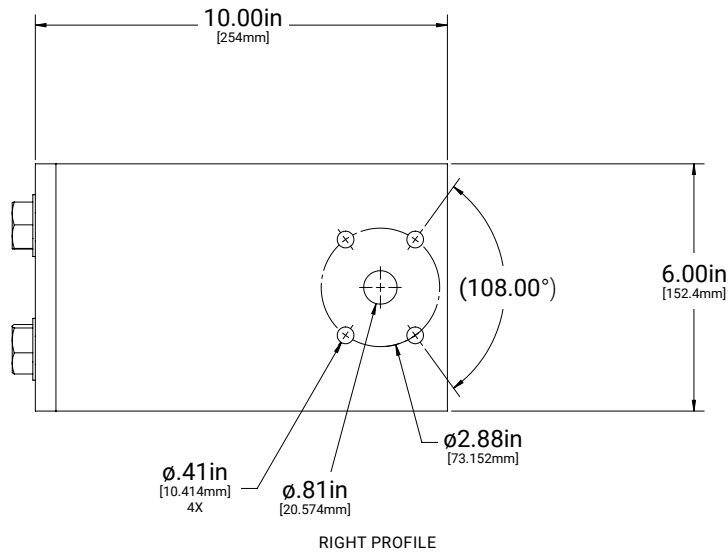

Diving Board Data

MODEL #	WEIGHT (LBS)
DVGBRD	15.1
DVGBRD + HRDM34-025	16.1

Diving Board Parts

DESCRIPTION	QUANTITY
Welded Bracket	1
Bolt Sleeve	2
3/4in-10 X 6in Structural Hex Bolt, Hot Dip Galvanized	2
3/4in Steel Flat Washer, Hot Dip Galvanized	2
3/4in Ext Tooth Washer, Steel, Magni-565 Grey Polycoat	2
3/4in-10 Structural Steel Hex Nut, Hot Dip Galvanized	2
Stainless Shim	1

HRDM58 Dimension and Part Details:

HRDM58-050:

.375-.500in clamping thickness, Use for Extension Plate (EXTPLT) or other flat surfaces drilled for 5/8in hardware

HRDM58-200:

2.00in clamping thickness, use for 2in x 4in Cross arms that are drilled for 5/8in hardware

HRDM58 Data

MODEL #	WEIGHT (LBS)
HRDM58-050	.65
HRDM58-200	.84

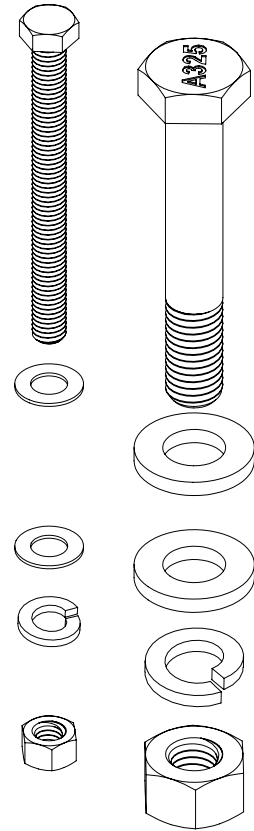
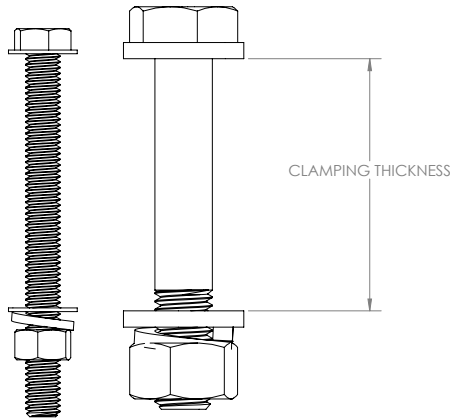

HRDM34 Dimension and Part Details:

HRDM34-025:

.25-.50in clamping thickness, use for diving board (DVGBRD) or other flat surfaces drilled for 3/4in hardware

HRDM34-075:

.50-.75in clamping thickness, flat surfaces drilled for 3/4in hardware

HRDM34-200:

2.00in clamping thickness, use for 2in x 4in Cross arms that are drilled for 3/4in hardware

HRDM34 Data

MODEL #	WEIGHT (LBS)
HRDM34-025	1
HRDM34-075	1.5
HRDM34-200	2

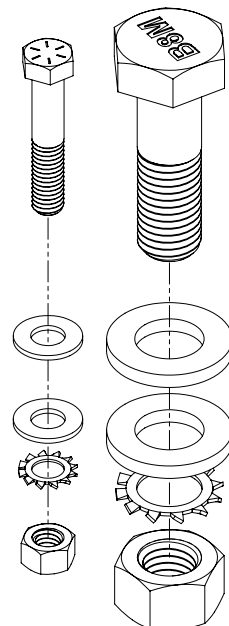
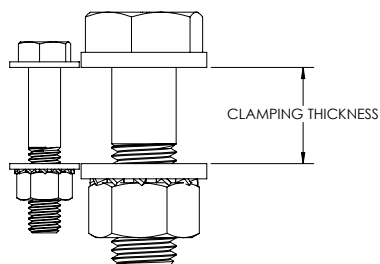

Example System Topology (Wired DMX Controls)

Example system topology showing the LUMASPORT 8 System in a commonly used wired DMX Control Installation. Refer to the specifications and limitations of your wired DMX control device before installing this configuration.

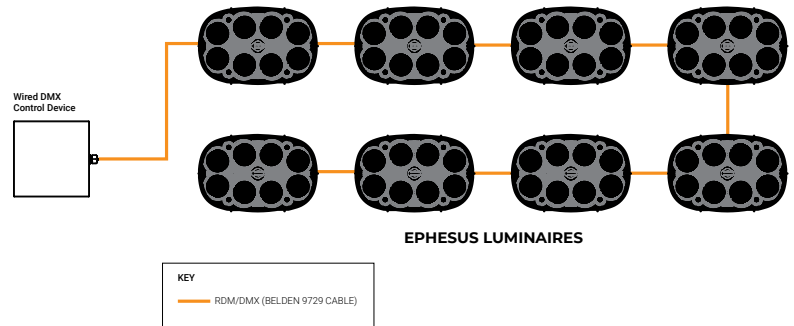

Example System Topology (Remote Access Point With Wired DMX Controls)

Example system topology showing the LUMASPORT 8 System in a commonly used remote access point with wired DMX Control Installation. Refer to the specifications and limitations of your wired DMX control device before installing this configuration. Note: Laptop and mobile device not included. A cellular network connection requires a cellular carrier network plan.

REMOTE ACCESS POINT TO DMX SYSTEM CONTROLS

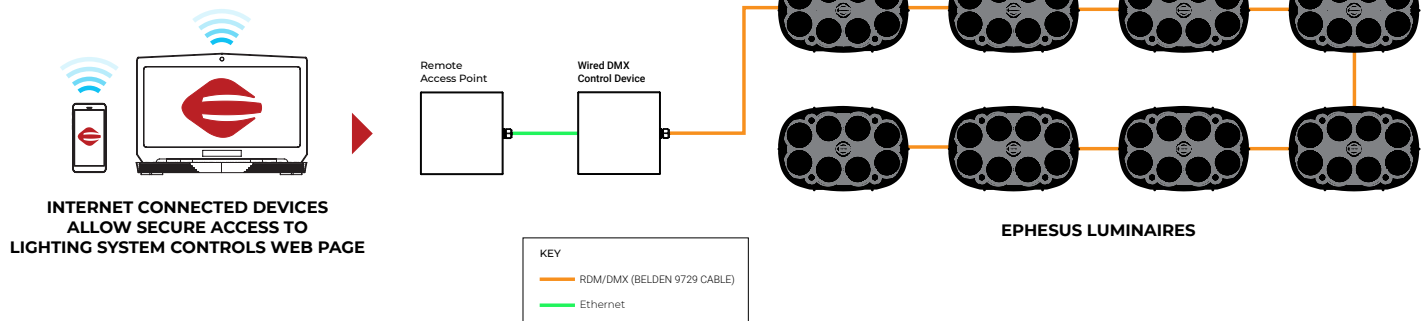

NOTES:

Remote Access Point requires either a wired Internet connection at the lighting system site or through a cellular carrier network connection plan.

Example System Topology (Contactor Controls)

Example system topology showing the LUMASPORT 8 System in a Wired Contactor Controls Installation.

Note: Laptop and mobile device not included. A cellular network connection requires a cellular carrier network plan.

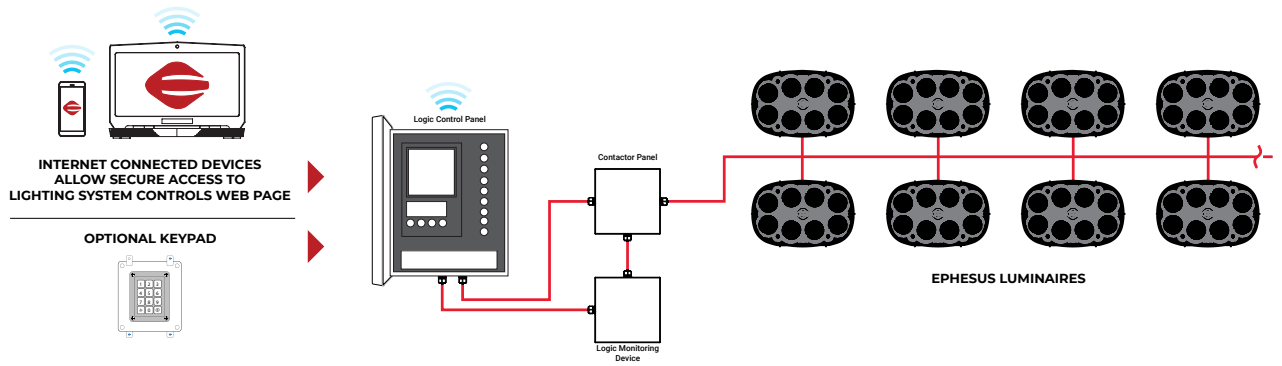

Example System Topology (Wireless AirMesh Controls)

Example system topology showing the LUMASPORT 8 System in a Wireless AirMesh Control Installation.

Note: Laptop and mobile device not included. A cellular network connection requires a cellular carrier network plan.

