

1

# SINGLE FAMILY HOMES MACKINAC ISLAND HOUSING CORP MARSHALL ST MACKINAC ISLAND, 49757

ISSUED:

9/26/2023

DESCRIPTION:

NEW SINGLE FAMILY HOMES SITE PLAN LOCATIONS.

SCALE: NTS

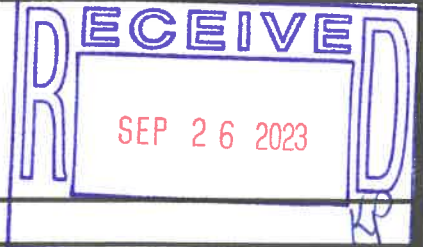

### PLAN NOTES

- ① EXISTING SINGLE FAMILY UNIT.
- ② EXISTING DUPLEX UNIT.
- ③ ~~EXISTING~~ SINGLE FAMILY UNIT AT UNIT #11.
- ④ ~~EXISTING~~ SINGLE FAMILY UNIT AT UNIT #12.
- ⑤ ~~EXISTING~~ / SINGLE FAMILY UNIT AT UNIT #15.
- ⑥ ~~EXISTING~~ / SINGLE FAMILY UNIT AT UNIT #16.
- ⑦ EXISTING ACCESSORY BUILDING.
- ⑧ PROPOSED NEW ACCESSORY BUILDING FOR NEW SINGLE FAMILY UNITS. BUILDING TO SERVE TWO SINGLE FAMILY UNITS.

### GENERAL NOTES

1. NEIGHBORHOOD IS EXITING AND HAS BEEN GRADED.
2. MINIMAL ALTERNATION TO EXISTING TOPOGRAPHY FOR GRADING AWAY FROM NEW SINGLE FAMILY UNITS.
3. NEW SINGLE FAMILY UNITS ELEVATIONS TO BE 1'-6" ABOVE EXTERIOR GRADE.
4. MAXIMUM HEIGHT OF SINGLE FAMILY UNITS AT 20' FROM FINISH FLOOR.

File No. R423-015-091

Exhibit B

Date 9-26-23

Initials RP



LIBER 501 PAGE 395

PREPARED BY:  
PORTER'S SURVEY P.C.  
21529 M-68 HWY.  
P. O. BOX 159  
ONAWAY, MICHIGAN 49755  
PH. (800) 733-8813

DEVELOPER:  
MACKINAC ISLAND HOUSING CORPORATION  
P.O. BOX 16  
MACKINAC ISLAND, MI 49757

### MACKINAC ISLAND HOUSING CORPORATION CONDOMINIUM (A SITE CONDOMINIUM)

A PART OF LOT 80 OF ASSESSOR'S PLAT OF HARRISONVILLE,  
CITY OF MACKINAC ISLAND, MACKINAC COUNTY, MICHIGAN.

TYPICAL SECTIONS UNITS 1-26  
VERTICAL MEASUREMENTS ARE TO  
BE MADE FROM EXISTING GRADE.  
(NO SCALE)



#### UNIT AREAS

UNIT	AREA	ACREAGE
1	5822.1 sq. ft.	(0.13 acres)
2	3890.6 sq. ft.	(0.09 acres)
3	3903.4 sq. ft.	(0.09 acres)
4	3365.2 sq. ft.	(0.08 acres)
5	4344.8 sq. ft.	(0.10 acres)
6	6573.5 sq. ft.	(0.15 acres)
7	4824.7 sq. ft.	(0.11 acres)
8	3444.0 sq. ft.	(0.08 acres)
9	3446.3 sq. ft.	(0.08 acres)
10	3449.0 sq. ft.	(0.08 acres)
11	3451.7 sq. ft.	(0.08 acres)
12	3179.7 sq. ft.	(0.07 acres)
13	5567.9 sq. ft.	(0.13 acres)
14	8794.6 sq. ft.	(0.20 acres)
15	4107.8 sq. ft.	(0.09 acres)
16	5921.9 sq. ft.	(0.14 acres)
17	3616.3 sq. ft.	(0.08 acres)
18	3081.2 sq. ft.	(0.07 acres)
19	3041.8 sq. ft.	(0.07 acres)
20	3313.7 sq. ft.	(0.08 acres)
21	2556.4 sq. ft.	(0.06 acres)
22	4154.0 sq. ft.	(0.10 acres)
23	3911.3 sq. ft.	(0.09 acres)
24	3083.9 sq. ft.	(0.07 acres)
25	3058.3 sq. ft.	(0.07 acres)
26	3650.3 sq. ft.	(0.08 acres)
TOTAL		2.46 ACRES

TOTAL PROJECT AREA = 3.01 ACRES  
GENERAL COMMON AREA = 0.55 ACRES  
LIMITED COMMON AREA = 0.00 ACRES  
TOTAL UNIT AREA = 2.46 ACRES

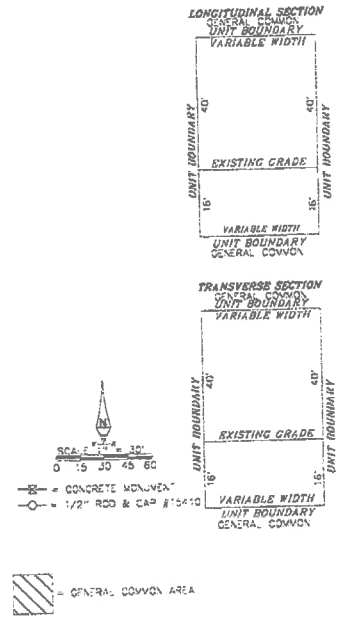

*Delmer E. Porter 12/03/01*  
DELMER E. PORTER P.S. # 15410 DATE

**SITE PLAN  
(CONTINUED)**

AS-BUILT 12/01/2001

SHEET 3 OF 4