

BERRYLAND ESTATES

PORTION OF THE NW 1/4, NW 1/4, SECTION 15, TOWNSHIP 40 NORTH, RANGE 3 EAST OF W.M.
WITHIN THE CITY OF LYNDEN, WHATCOM COUNTY, WASHINGTON

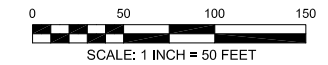

BASIS OF BEARINGS=
ARNESON'S AARON DRIVE
LOT LINE ADJUSTMENT
(CITY OF LYNDEN SURVEY
MONUMENT NETWORK)
A.F. No. 2140602230

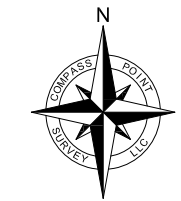
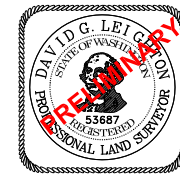

VEHICULAR ACCESS PROHIBITED AS SHOWN.

SHEET: 2 OF 2	DATE: 06/08/18	PLANS: G:\154003-06 D:\154003-06.CRD
DRAWN BY: RL	REVIEWED BY: RL & DL	DRAWING: ARNESON BASE 6 .DWG

**COMPASS POINT
SURVEY, LLC**
523 FRONT STREET, LYNDEN, WA 98264
PH. 360-354-8320 FAX. 360-354-8321