

CONTRACTOR AGREES THAT HE SHALL ASSUME SOLE AND COMPLETE RESPONSIBILITY FOR JOB SITE CONDITIONS DURING THE COURSE OF CONSTRUCTION OF THIS PROJECT, INCLUDING SAFETY OF ALL PERSONS AND PROPERTY, THAT THIS REQUIREMENT SHALL APPLY CONTINUOUSLY AND NOT BE LIMITED TO NORMAL WORKING HOURS, AND THAT THE CONTRACTOR SHALL DEFEND, INDEMNIFY AND HOLD THE OWNER AND THE ENGINEER HARMLESS FROM ANY AND ALL LIABILITY, REAL OR ALLEGED, IN CONNECTION WITH THE PERFORMANCE OF WORK ON THIS PROJECT, EXCEPTING LIABILITY ARISING FROM THE SOLE NEGLIGENCE OF THE OWNER OR THE ENGINEER.

TOWN OF LOS GATOS

OAK MEADOW BANDSTAND AREA IMPROVEMENT PROJECT

PROJECT NO. 21-831-4007

SHEET INDEX

SHEET NO.	SHEET TITLE	PAGE NO.
L0.0	COVER SHEET	1 of 8
L0.1	EXISTING SITE PLAN	2 of 8
L0.2	SITE DEMOLITION PLAN	3 of 8
L0.3	SITE GRADING PLAN	4 of 8
L0.4	SITE LAYOUT PLAN	5 of 8
L0.5	SITE MATERIAL PLAN	6 of 8
L1.1	PAVING DETAILS	7 of 8
L1.2	PAVING DETAILS	8 of 8

TOWN OF LOS GATOS STANDARD NOTES

- ALL WORK SHALL BE PERFORMED IN CONFORMANCE WITH THE THESE PLANS, THE PROJECT SPECIFICATIONS, AND THE TOWN OF LOS GATOS ENGINEERING DESIGN STANDARDS AND SPECIFICATIONS (UNLESS SPECIFICALLY STATED OTHERWISE ON THE PLANS).
- IT SHALL BE THE RESPONSIBILITY OF THE CONTRACTOR TO IDENTIFY, LOCATE AND PROTECT ALL UNDERGROUND FACILITIES. THE CONTRACTOR SHALL NOTIFY USA (UNDERGROUND SERVICE ALERT) AT 1-800-227-2600 A MINIMUM OF FORTY-EIGHT (48) HOURS BUT NOT MORE THAN FOURTEEN (14) DAYS PRIOR TO COMMENCING ALL WORK.
- THE CONTRACTOR SHALL COMPLY WITH ALL LOCAL, STATE AND FEDERAL LAWS, CODES, RULES AND REGULATIONS GOVERNING THE WORK IDENTIFIED ON THESE PLANS. THESE SHALL INCLUDE, WITHOUT LIMITATION, SAFETY AND HEALTH RULES AND REGULATIONS ESTABLISHED BY OR PURSUANT TO THE OCCUPATIONAL SAFETY AND HEALTH ACT OR ANY OTHER APPLICABLE PUBLIC AUTHORITY.
- THE GENERAL CONTRACTOR SHALL PROVIDE QUALIFIED SUPERVISION ON THE JOB SITE AT ALL TIMES DURING CONSTRUCTION.
- THE CONTRACTOR SHALL EXERCISE ALL NECESSARY CAUTION TO AVOID DAMAGE TO ANY EXISTING TREES, IRRIGATION, SURFACE IMPROVEMENTS, DRAINAGE, WATER, SEWER, LIGHTING, ELECTRICAL, OR TELECOMMUNICATION FACILITIES WHETHER ABOVE GROUND OR UNDERGROUND. THE CONTRACTOR SHALL BEAR FULL RESPONSIBILITY FOR ANY DAMAGE THERETO.
- THE CONTRACTOR SHALL COORDINATE ALL UTILITY INFORMATION SHOWN ON THE PLANS WITH UTILITY OWNERS FOR LAYOUT AND DETAILS OF INSTALLATION, RELOCATION, ADJUSTMENT, AND ABANDONMENT.
- LOCATIONS OF EXISTING UNDERGROUND UTILITIES SHOWN ARE BASED ON FIELD SURVEY AND/OR AVAILABLE UTILITY AS-BUILTS. IT IS THE CONTRACTOR'S RESPONSIBILITY TO VERIFY THE LOCATION OF ALL EXISTING UTILITIES PRIOR TO THE COMMENCEMENT OF WORK.
- THE CONTRACTOR TO PROTECT ALL EXISTING UTILITIES AND SERVICE LATERALS FROM DAMAGE DUE TO THE CONTRACTOR'S OPERATIONS. ANY AND ALL UTILITY SERVICES THAT ARE DAMAGED DURING CONSTRUCTION SHALL BE REPAIRED OR REPLACED TO THE SATISFACTION OF THE UTILITY OWNER. THE CONTRACTOR TO CONTACT UTILITY COMPANIES TO RELOCATE UTILITIES THEM IF NECESSARY TO COMPLETE THE PROJECT AT NO ADDITIONAL COST TO THE TOWN.
- HORIZONTAL AND VERTICAL CONTROLS SHALL BE SET AND CERTIFIED BY A LICENSED SURVEYOR OR REGISTERED CIVIL ENGINEER QUALIFIED TO PRACTICE LAND SURVEYING.
- THE CONTRACTOR SHALL INSTALL AND MAINTAIN TEMPORARY CONSTRUCTION FENCING, BARRICADES, LIGHTS, FLAGGERS, AND SIGNS THAT ARE NECESSARY TO GIVE ADEQUATE WARNING AND PROTECTION TO THE PUBLIC AT ALL TIMES.
- SURVEY MONUMENT PRESERVATION AND RESTORATION: ALL MONUMENTS, LOT CORNER PIPES, AND OTHER PERMANENT MONUMENTS DISTURBED DURING THE PROCESS OF CONSTRUCTION SHALL BE REPLACED AND A RECORD OF SURVEY OR CORNER RECORD PER SECTION 8771 OF THE PROFESSIONAL LAND SURVEYOR'S ACT FILED BEFORE ACCEPTANCE OF THE IMPROVEMENTS BY THE TOWN. COPIES OF ANY RECORD OF SURVEY OR CORNER RECORDS SHALL BE SUBMITTED TO THE TOWN.
- THE CONTRACTOR SHALL KEEP UP-TO-DATE A COMPLETE RECORD OF PRINTS OF THE CONTRACT DRAWINGS SHOWING EVERY CHANGE FROM THE ORIGINAL DRAWINGS MADE DURING THE COURSE OF CONSTRUCTION, INCLUDING EXACT LOCATIONS, SIZES, MATERIALS, AND EQUIPMENT. A COMPLETE SET OF CORRECTED AND COMPLETED RECORD DRAWINGS (AS-BUILTS) SHALL BE SUBMITTED TO THE TOWN PUBLIC WORKS INSPECTOR PRIOR TO FINAL ACCEPTANCE.
- THE CONTRACTOR TO CUT AND CAP ABANDONED OR RETIRED UTILITIES AS SHOWN ON THE PLANS PER TOWN STANDARDS.
- THE CONTRACTOR SHALL PROVIDE AND MAINTAIN PEDESTRIAN ACCESS AND SAFETY AT ALL TIMES.
- GOOD HOUSEKEEPING PRACTICES SHALL BE OBSERVED AT ALL TIMES DURING THE COURSE OF CONSTRUCTION. SUPERINTENDENCE OF CONSTRUCTION SHALL BE DILIGENTLY PERFORMED BY A PERSON OR PERSONS AUTHORIZED TO DO SO AT ALL TIMES DURING WORKING HOURS. THE STORING OF GOODS AND/OR MATERIALS IN THE TOWN RIGHT-OF-WAY WILL NOT BE ALLOWED UNLESS APPROVED BY THE TOWN.
- ALL WORK SHALL BE PERFORMED IN SUCH A MANNER AS TO COMPLY WITH THE STANDARDS ESTABLISHED BY THE AIR QUALITY MANAGEMENT DISTRICT FOR AIRBORNE
 - PLEASE SEE GENERAL NOTES BELOW.
 - All trenching within the dripline of existing trees to remain shall be by hand, with care taken not to cut or damage roots over 1-inch diameter. trees to remain shall be fenced with temporary fencing, such as steel stakes (max. 5 feet o.c.) with wire mesh fabric (6x6 open), chainlink, or similar, height to be 5 feet minimum.
 - Keep all planting, paving and curb areas free from weeds, debris and trash during the entire duration of the contract. weed control herbicides shall be applied if the engineer deems it necessary. Type of herbicide to be used and method of application shall be approved by the arborist.
 - Care should be taken with existing trees to remain. Grades within the drip line of the tree shall not be changed unless otherwise specified on the plans. Any compaction of the area within the drip line shall be avoided.
 - Any areas damaged or disturbed during the process of construction including grass, plantings, trees shall be replaced and restored in kind.
 - Contractor shall escort all construction vehicles entering and exiting the park. Personnel shall walk in front of the vehicle to ensure there are no conflicts with pedestrians.
 - Contractor shall be responsible for any damage caused by construction vehicles or equipment to park features, including but not limited to: lawns/turf, pathways, irrigation, trees, site furnishings, and other park amenities.
 - Contractor shall be responsible for restoring all lawn/turf areas disturbed by any construction operations including but not limited to trenching.
 - Repair any existing irrigation lines interrupted during demolition. Field-verify all repairs and restore the affected lawn areas.
 - Existing soil/planting areas to remain. Remove debris to prepare the area for future planting.

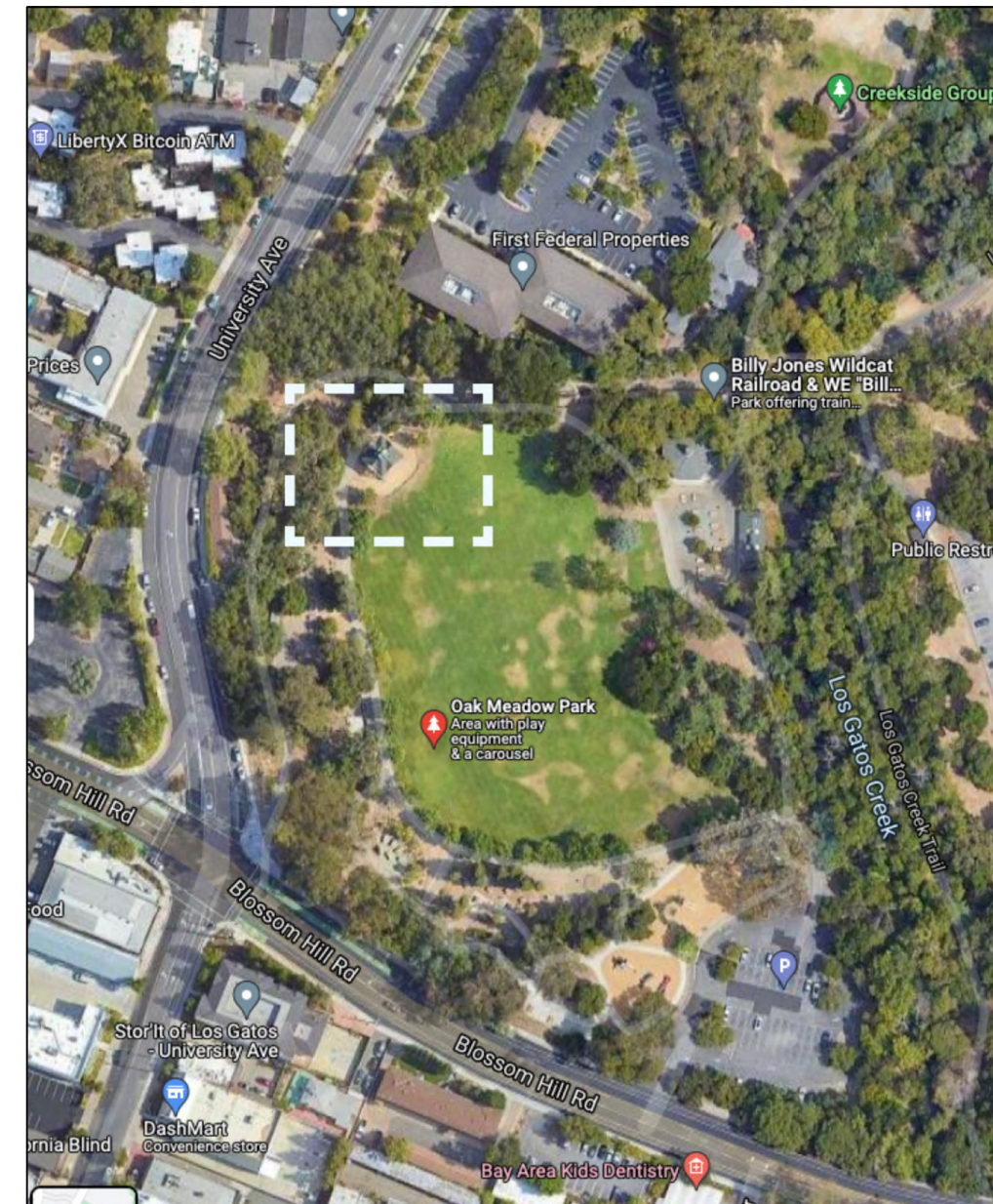

VICINITY MAP
SCALE NONE

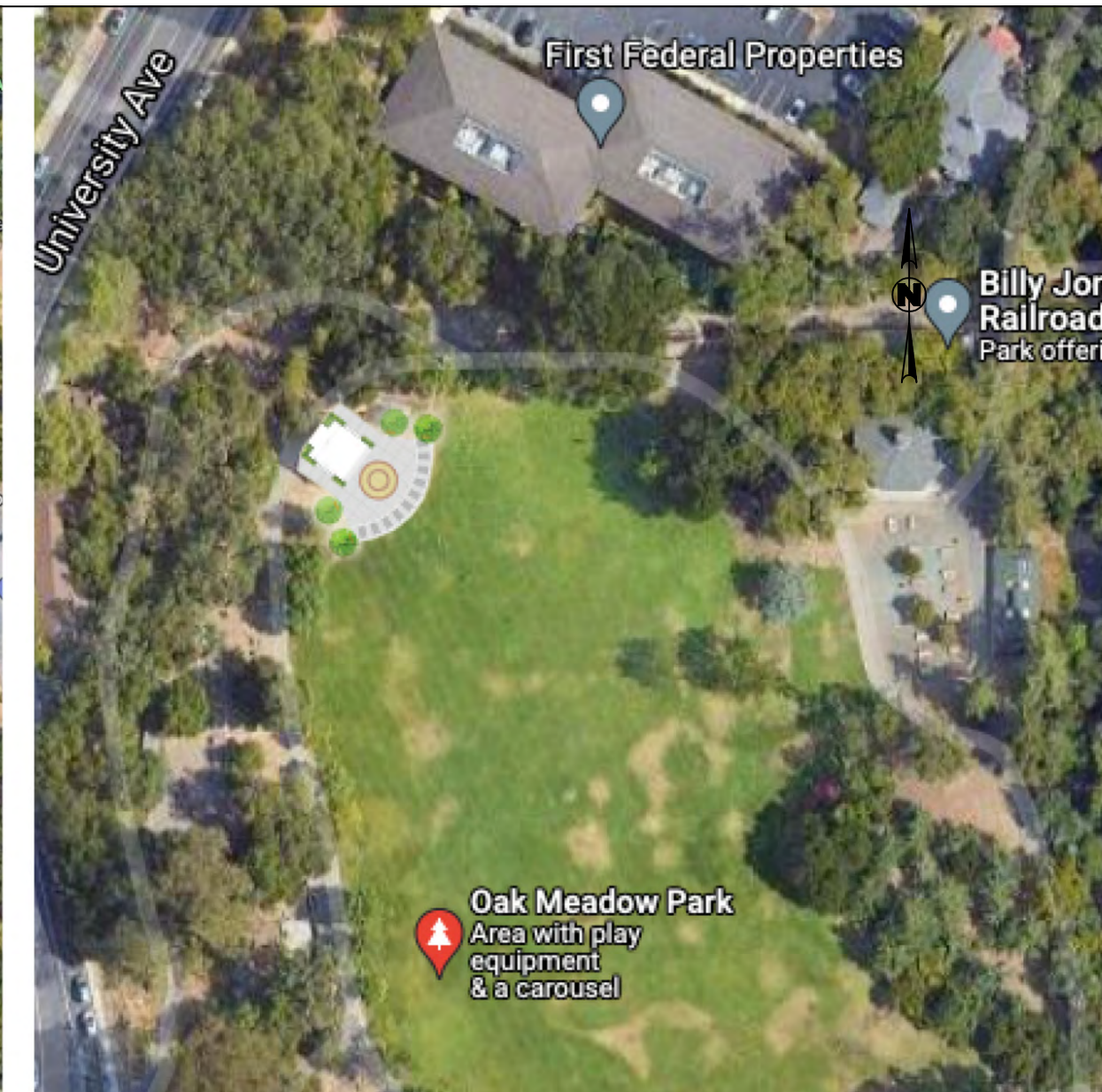

PROPOSED SITE PLAN
SCALE NONE

ABBREVIATIONS

AB	AGGREGATE BASE	G	GAS	RCP	REINFORCED CONCRETE PIPE
AC	ASPHALT CONCRETE	GA	GAUGE	RIM	RIM ELEVATION
AD	AREA DRAIN	GB	GRADE BREAK	R/W	RIGHT-OF-WAY
ARV	AIR RELEASE VALVE	GM	GAS METER	(S)	SOUTH
BC	BACK OF CURB	GS	GAS SERVICE	S	SLOPE
BFP	BACKFLOW PREVENTER	HDPE	HIGH-DENSITY POLYETHYLENE	SCC	SANTA CLARA COUNTY
BW	BOTTOM OF WALL	HP	HIGH POINT	SCCFD	SANTA CLARA COUNTY FIRE DEPARTMENT
CATV	CABLE TELEVISION	IEE	INGRESS/EGRESS EASEMENT	SD	STORM DRAIN
CB	CATCH BASIN	IN	INCH	SDCO	STORM DRAIN CLEANOUT
CFS	CUBIC FEET PER SECOND	INV	INVERT ELEVATION	SDE	STORM DRAIN EASEMENT
C/L	CENTERLINE	LAT	LATERAL	SDMH	STORM DRAIN MANHOLE
CMP	CORRUGATED METAL PIPE	LG	LIP OF GUTTER	SDR	STANDARD DIMENSION RATIO
CO	CLEANOUT	LP	LOW POINT	SF	SQUARE FEET
CY	CUBIC YARD	MAX	MAXIMUM	SIWC	SAN JOSE WATER COMPANY
DCVA	DOUBLE CHECK VALVE ASSEMBLY	MH	MANHOLE	SS	SANITARY SEWER
DI	DROP INLET	MIN	MINIMUM	SSCO	SANITARY SEWER CLEANOUT
DIA	DIAMETER	MPH	MILES PER HOUR	SSE	SANITARY SEWER EASEMENT
DIP	DUCTILE IRON PIPE	(N)	NORTH	SSMH	SANITARY SEWER MANHOLE
DWV	DRIVEWAY	N.T.S.	NOT TO SCALE	STD	STANDARD
(E)	EAST	O.C.	ON CENTER	S/W	SIDEWALK
EG	EXISTING GRADE	O.D.	OUTSIDE DIAMETER	TC	TOP OF CURB
ELEC	ELECTRICAL	PAD	PAD ELEVATION	TELE	TELEPHONE
EP	EDGE OF PATH	PCC	PORTLAND CEMENT CONCRETE	TLG	TOWN OF LOS GATOS
EVAE	EMERGENCY VEHICLE ACCESS EASEMENT	PERF	PERFORATED	TW	TOP OF WALL
EX	EXISTING	PG&E	PACIFIC GAS & ELECTRIC COMPANY	TYP	TYPICAL
FC	FACE OF CURB	PIEE	PRIVATE INGRESS/EGRESS EASEMENT	VCP	VITRIFIED CLAY PIPE
FDC	FIRE DEPARTMENT CONNECTION	PL	PROPERTY LINE	VIF	VERIFY IN FIELD
FF	FINISHED FLOOR ELEVATION	PR	PROPOSED	(W)	WEST
FG	FINISHED GRADE	PSDE	PRIVATE STORM DRAIN EASEMENT	W	WATER
FH	FIRE HYDRANT	PSE	PUBLIC SERVICE EASEMENT	WM	WATER METER
FL	FLOW LINE	PSSE	PRIVATE SANITARY SEWER EASEMENT	WS	WATER SERVICE
FM	FORCED MAIN	PUE	PUBLIC UTILITY EASEMENT	WV	WATER VALVE
FS	FIRE SERVICE	PVC	POLYVINYL CHLORIDE	WVSD	WEST VALLEY SANITATION DISTRICT
FT	FEET	R	RADIUS	XING	CROSSING
CL	CENTER LINE	HYD	HYDRANT		
CONC	CONCRETE	IRR	IRRIGATION		
D	DECIDUOUS	L	LIGHTING CONDUIT		
DEP	DEPRESSED	RR	RAILROAD		
E	ELECTRIC	SD	STORM DRAIN		
EOC	EDGE OF CONCRETE	SL	STREET LIGHT		
EP	EDGE OF PAVEMENT	SS	SANITARY SEWER		
ELEC	ELECTRICAL	TC	TOP OF CURB		
FDC	FIRE DEPARTMENT CONNECTION	TELE	TELEPHONE		
FH	FIRE HYDRANT	TYP	TYPICAL		
FL	FLOW LINE	TW	TOP OF WALL		
G	GAS	W	WATER		
GV	GAS VALVE	WV	WATER VALVE		
HV	HIGH VOLTAGE				

LEGENDS

DEMOLITION LEGEND	GENERAL LEGEND
--- LIMIT OF WORK WITH CONSTRUCTION FENCING	--- POINT OF START (NEW FIELD)
--- DEMOLITION AND RECONSTRUCTION AREA	--- EXPANSION JOINT
--- TREE PROTECTION FENCE	--- CONTROL JOINT
	--- ENLARGED DETAIL AREA
	--- COLD JOINT

NOTES:
1. REFER TO CIVIL GRADING AND UTILITY PLANS FOR OUTSIDE OF LANDSCAPE LIMIT OF WORK.
2. PROJECT IN PLACE FOR VARIOUS EXISTING IMPROVEMENTS FOR EXISTING TREES, WALKWAYS, UTILITY BOXES ETC.

GRADING LEGEND
--- PROPOSED FINISHED SURFACE ELEVATION
--- PROPOSED FINISHED GROUND ELEVATION
--- PROPOSED TOP OF CURB ELEVATION
--- PROPOSED TOP OF STAIR ELEVATION
--- PROPOSED TOPO LINE
--- PROPOSED FINISHED SURFACE SLOPE DIRECTION
--- PROPOSED GRADE BREAK
--- EXISTING SPOT ELEVATION
--- EXISTING TOPO LINE
--- AREA DRAIN CONNECT TO MEP SYSTEM

NOTE: REFER TO CIVIL GRADING AND UTILITY PLANS FOR OUTSIDE OF LANDSCAPE LIMIT OF WORK.

MATERIAL LEGEND
--- CONCRETE TYPE 1 - NATURAL COLOR, SAND BLAST FINISH
--- CONCRETE TYPE 2 - DARK GREY COLORED CONCRETE, SAND BLAST FINISH
--- CONCRETE TYPE 3 - NATURAL COLOR, BROOM FINISH
--- STAMPED CONCRETE TYPE 1 - BRICK PATTERN, DARK COLOR
--- STAMPED CONCRETE TYPE 2 - BRICK PATTERN, RED COLOR
--- CONCRETE CURB - NATURAL COLOR
--- AREA DRAIN

NOTE: REFER TO CIVIL GRADING AND UTILITY PLANS FOR OUTSIDE OF LANDSCAPE LIMIT OF WORK.

SURVEY LEGEND
--- BRICK
--- CONTOUR MAJOR (5' INTERVAL)
--- CONTOUR MINOR (1' INTERVAL)
--- FENCE
--- GRADE BREAK LINE
--- TOE OF BANK
--- TOP OF BANK
--- RETAINING WALL

SURVEY NOTES:
1. DISTANCES SHOWN ARE IN FEET AND DECIMALS THEREOF.
2. HORIZONTAL DATUM IS NORTH AMERICAN DATUM OF 1983 (NAD 83) PER CALIFORNIA REAL TIME NETWORK (CRN), EPOCH 2017.5.
3. VERTICAL DATUM IS NORTH AMERICAN DATUM OF 1988 (NAD88) PER CALIFORNIA REAL TIME NETWORK (CRN), EPOCH 2017.5.
4. TOPOGRAPHY SHOWN WAS PERFORMED BY FIELD SURVEY ON APRIL 25, 2022.



DATE:	DEC. 2, 2025
SCALE:	AS SHOWN
DESIGN:	FIELDSCAPE
DRAWN:	SK
CHECK:	JS
ENGR:	NA

OAK MEADOW BANDSTAND AREA
IMPROVEMENT PROJECT
80% CONSTRUCTION DOCUMENTATION SUBMISSION



REVISIONS	DATE	BY
95% Construction Document	1/20/25	Team
100% Construction Document	1/22/25	Team

SHEET L0.0

CONTRACTOR AGREES THAT HE SHALL ASSUME SOLE AND COMPLETE RESPONSIBILITY FOR ALL SITE CONDITIONS DURING THE COURSE OF CONSTRUCTION OF THIS PROJECT, INCLUDING SAFETY OF ALL PERSONS AND PROPERTY, THAT THIS REQUIREMENT SHALL APPLY CONTINUOUSLY AND NOT BE LIMITED TO NORMAL WORKING HOURS AND THAT THE CONTRACTOR SHALL DEFEND, INDEMNIFY AND HOLD THE OWNER AND THE ENGINEER HARMLESS FROM ANY AND ALL LIABILITY, REAL OR ALLEGED, IN CONNECTION WITH THE PERFORMANCE OF WORK ON THIS PROJECT, EXCEPTING LIABILITY ARISING FROM THE SOLE NEGLIGENCE OF THE ENGINEER.

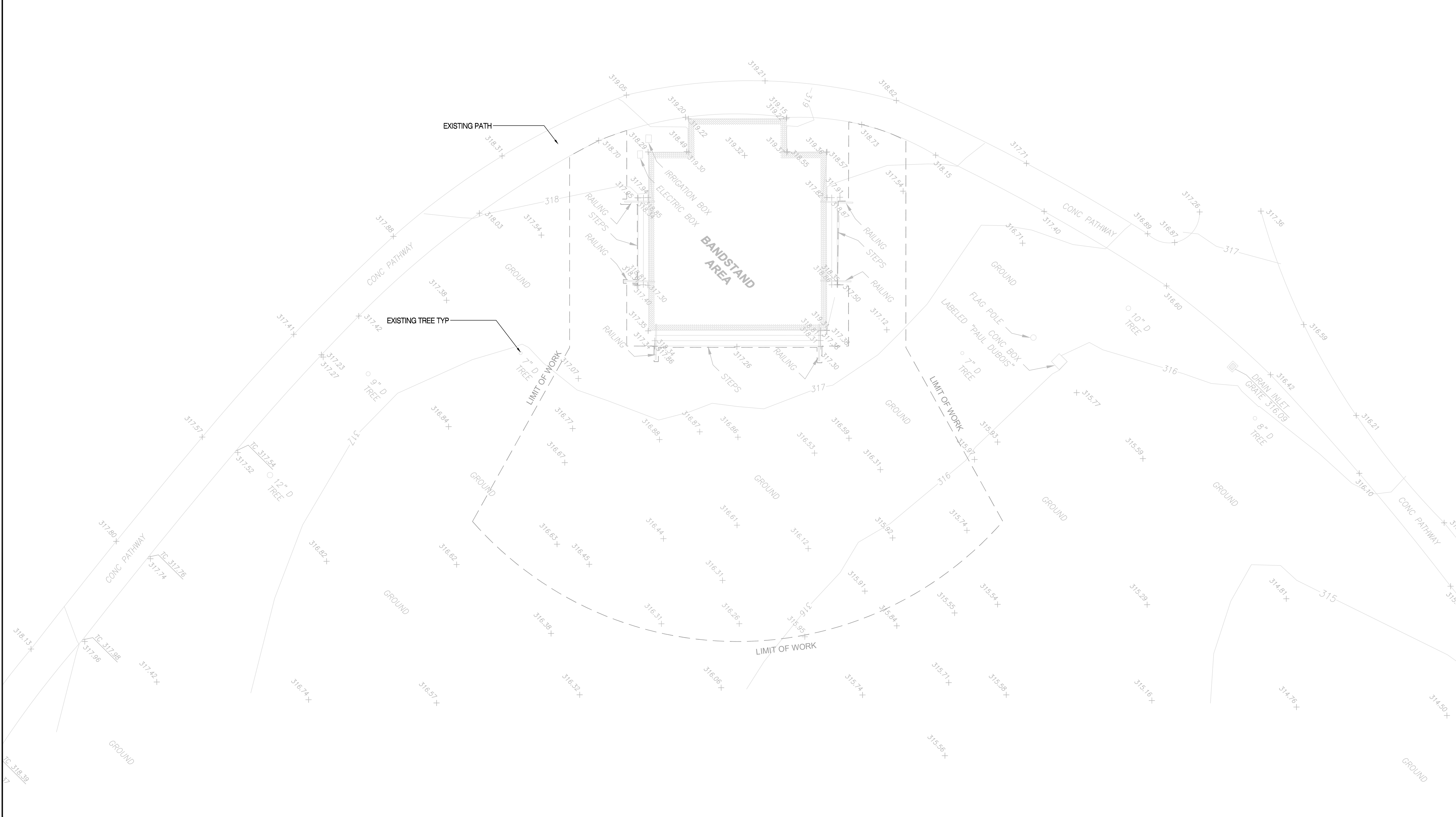

ABBREVIATIONS

AC	ASPHALTIC CONCRETE	G	GAS
BFP	BACK FLOW PREVENTER	GV	GAS VALVE
C	CONIFEROUS	HV	HIGH VOLTAGE
CL	CENTER LINE	HYD	HYDRANT
CONC	CONCRETE	IRR	IRRIGATION
D	DECIDUOUS	L	LIGHTING CONDUIT
DEP	DEPRESSED	RR	RAILROAD
E	ELECTRIC	SD	STORM DRAIN
EOC	EDGE OF CONCRETE	SL	STREET LIGHT
EP	EDGE OF PAVEMENT	SS	SANITARY SEWER
ELEC	ELECTRICAL	TC	TOP OF CURB
FDC	FIRE DEPARTMENT CONNECTION	TELE	TELEPHONE
FH	FIRE HYDRANT	TYP	TYPICAL
FL	FLOW LINE	TW	TOP OF WALL
		W	WATER
		WV	WATER VALVE

NOTES

- DISTANCES SHOWN ARE IN FEET AND DECIMALS THEREOF.
- HORIZONTAL DATUM IS NORTH AMERICAN DATUM OF 1983 (NAD 83) PER CALIFORNIA REAL TIME NETWORK (CRTN), EPOCH 2017.5.
- VERTICAL DATUM IS NORTH AMERICAN DATUM OF 1988 (NAVD88) PER CALIFORNIA REAL TIME NETWORK (CRTN), EPOCH 2017.5.
- TOPOGRAPHY SHOWN WAS PERFORMED BY FIELD SURVEY ON APRIL 25, 2022.

LEGEND

	BRICK
	CONTOUR MAJOR (5' INTERVAL)
	CONTOUR MINOR (1' INTERVAL)
	FENCE
	GRADE BREAK LINE
	TOE OF BANK
	TOP OF BANK
	RETAINING WALL

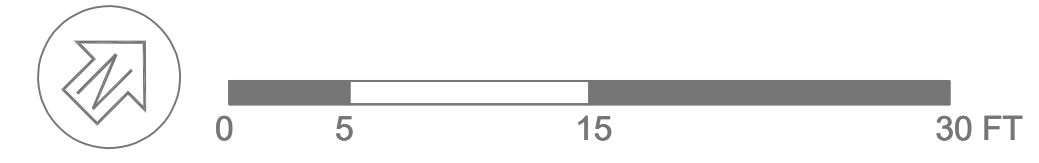

SCALE: 1/8"=1'-0" **EXISTING SITE PLAN 01**



DATE:	DEC. 2, 2025
SCALE:	AS SHOWN
DESIGN:	FIELDSCAPE
DRAWN:	SK
CHECK:	JS
ENGR:	NA

**OAK MEADOW BANDSTAND AREA
IMPROVEMENT PROJECT**
80% CONSTRUCTION DOCUMENTATION SUBMISSION



REVISIONS	DATE	BY
95% Construction Document	1/20/25	Team
100% Construction Document	12/2/25	Team

SHEET L0.1

CONTRACTOR AGREES THAT HE SHALL ASSUME SOLE AND COMPLETE RESPONSIBILITY FOR JOB SITE CONDITIONS DURING THE COURSE OF CONSTRUCTION OF THIS PROJECT, INCLUDING SAFETY OF ALL PERSONS AND PROPERTY, THAT THIS REQUIREMENT SHALL APPLY CONTINUOUSLY AND NOT BE LIMITED TO NORMAL WORKING HOURS, AND THAT THE CONTRACTOR SHALL DEFEND, INDEMNIFY AND HOLD THE OWNER AND THE ENGINEER HARMLESS FROM ANY AND ALL LIABILITY, REAL OR ALLEGED, IN CONNECTION WITH THE PERFORMANCE OF WORK ON THE PROJECT, EXCEPTING LIABILITY ARISING FROM THE SOLE NEGLIGENCE OF THE OWNER OR THE ENGINEER.

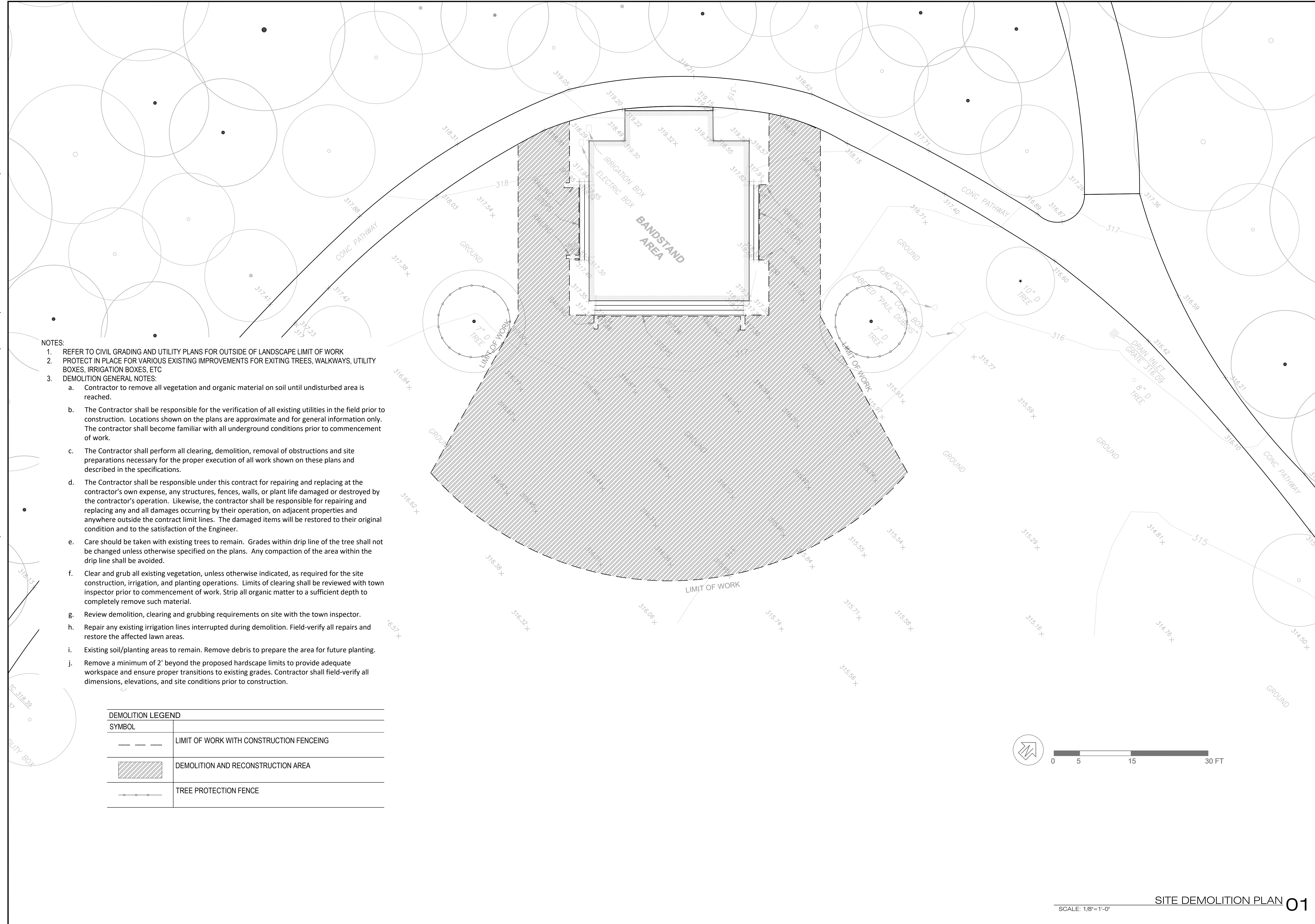

- NOTES:
1. REFER TO CIVIL GRADING AND UTILITY PLANS FOR OUTSIDE OF LANDSCAPE LIMIT OF WORK
 2. PROTECT IN PLACE FOR VARIOUS EXISTING IMPROVEMENTS FOR EXISTING TREES, WALKWAYS, UTILITY BOXES, IRRIGATION BOXES, ETC
 3. DEMOLITION GENERAL NOTES:
 - a. Contractor to remove all vegetation and organic material on soil until undisturbed area is reached.
 - b. The Contractor shall be responsible for the verification of all existing utilities in the field prior to construction. Locations shown on the plans are approximate and for general information only. The contractor shall become familiar with all underground conditions prior to commencement of work.
 - c. The Contractor shall perform all clearing, demolition, removal of obstructions and site preparations necessary for the proper execution of all work shown on these plans and described in the specifications.
 - d. The Contractor shall be responsible under this contract for repairing and replacing at the contractor's own expense, any structures, fences, walls, or plant life damaged or destroyed by the contractor's operation. Likewise, the contractor shall be responsible for repairing and replacing any and all damages occurring by their operation, on adjacent properties and anywhere outside the contract limit lines. The damaged items will be restored to their original condition and to the satisfaction of the Engineer.
 - e. Care should be taken with existing trees to remain. Grades within drip line of the tree shall not be changed unless otherwise specified on the plans. Any compaction of the area within the drip line shall be avoided.
 - f. Clear and grub all existing vegetation, unless otherwise indicated, as required for the site construction, irrigation, and planting operations. Limits of clearing shall be reviewed with town inspector prior to commencement of work. Strip all organic matter to a sufficient depth to completely remove such material.
 - g. Review demolition, clearing and grubbing requirements on site with the town inspector.
 - h. Repair any existing irrigation lines interrupted during demolition. Field-verify all repairs and restore the affected lawn areas.
 - i. Existing soil/planting areas to remain. Remove debris to prepare the area for future planting.
 - j. Remove a minimum of 2' beyond the proposed hardscape limits to provide adequate workspace and ensure proper transitions to existing grades. Contractor shall field-verify all dimensions, elevations, and site conditions prior to construction.

DEMOLITION LEGEND	
SYMBOL	
	LIMIT OF WORK WITH CONSTRUCTION FENCEING
	DEMOLITION AND RECONSTRUCTION AREA
	TREE PROTECTION FENCE

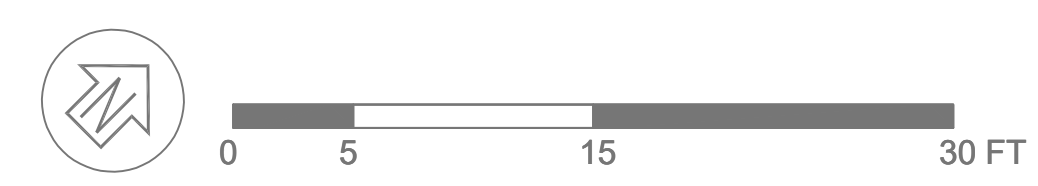

DATE: DEC. 2, 2025
 SCALE: AS SHOWN
 DESIGN: FIELDSCAPE
 DRAWN: SK
 CHECK: JS
 ENGR: NA
 PROJECT NO.: 21-831-4007

**OAK MEADOW BANDSTAND AREA
 IMPROVEMENT PROJECT**
 80% CONSTRUCTION DOCUMENTATION SUBMISSION



REVISIONS	DATE	BY
95% Construction Document	1/20/25	Team
100% Construction Document	12/2/25	Team

C:\Users\vaq\OneDrive\Fieldscape\Projects\201 LOS GATOS\4- Documents\CAD\B\est\LU.2_Site Demo Plan.dwg 12/02/2025 - 11:54 AM user: 11

CONTRACTOR AGREES THAT HE SHALL ASSUME SOLE AND COMPLETE RESPONSIBILITY FOR ALL SITE CONDITIONS DURING THE COURSE OF CONSTRUCTION OF THIS PROJECT, INCLUDING SAFETY OF ALL PERSONS AND PROPERTY, THAT THIS REQUIREMENT SHALL APPLY CONTINUOUSLY AND NOT BE LIMITED TO NORMAL WORKING HOURS AND THAT THE CONTRACTOR SHALL DEFEND, INDEMNIFY AND HOLD THE OWNER AND THE ENGINEER HARMLESS FROM ANY AND ALL LIABILITY, REAL OR ALLEGED, IN CONNECTION WITH THE PERFORMANCE OF WORK ON THE PROJECT, EXCEPTING FOR LIABILITY ARISING FROM THE SOLE NEGLIGENCE OF THE ENGINEER.

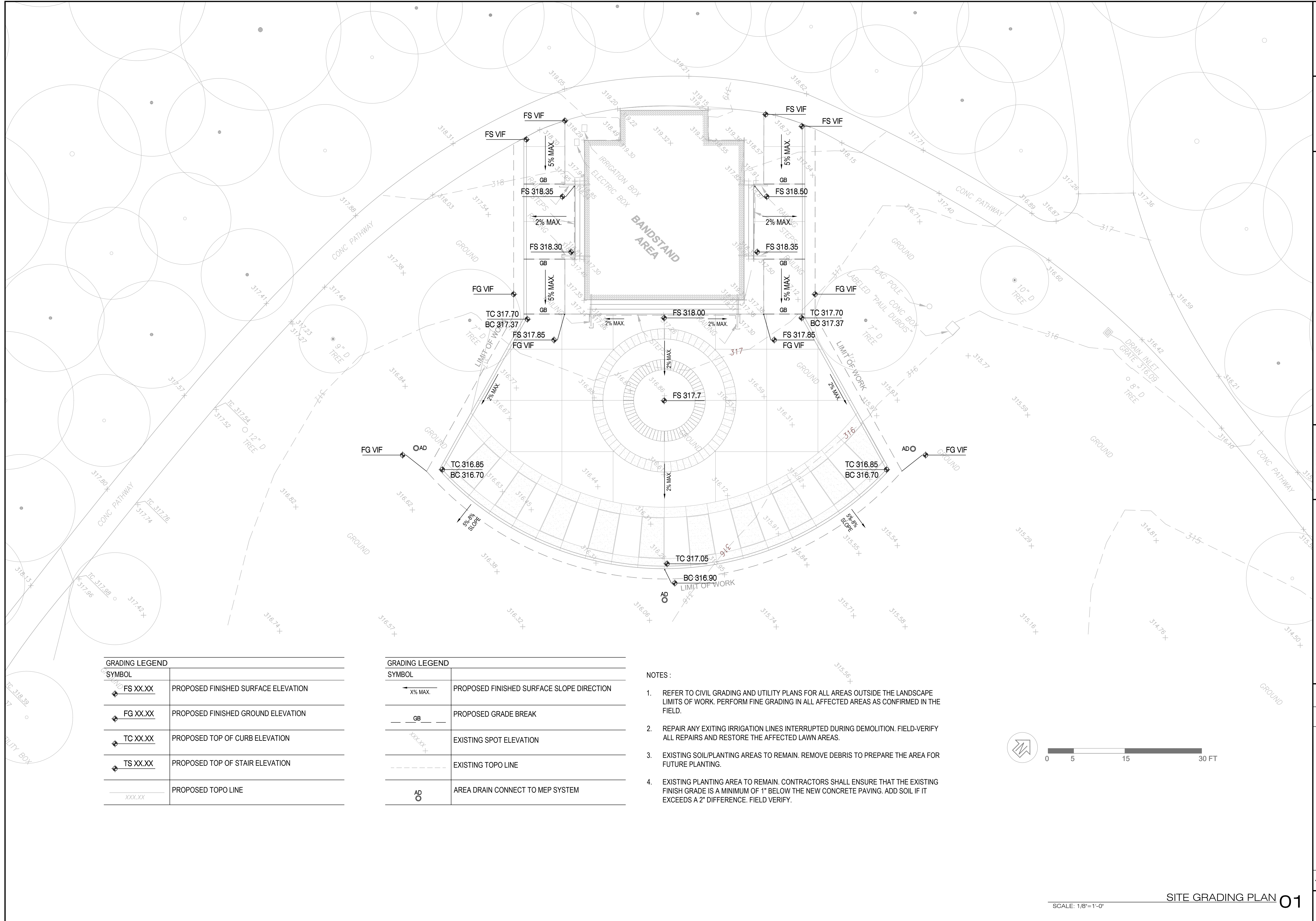

GRADING LEGEND	
SYMBOL	DESCRIPTION
◆ FS XX.XX	PROPOSED FINISHED SURFACE ELEVATION
◆ FG XX.XX	PROPOSED FINISHED GROUND ELEVATION
◆ TC XX.XX	PROPOSED TOP OF CURB ELEVATION
◆ TS XX.XX	PROPOSED TOP OF STAIR ELEVATION
— XXX.XX	PROPOSED TOPO LINE

GRADING LEGEND	
SYMBOL	DESCRIPTION
← X% MAX.	PROPOSED FINISHED SURFACE SLOPE DIRECTION
— GB —	PROPOSED GRADE BREAK
XXX.XX	EXISTING SPOT ELEVATION
---	EXISTING TOPO LINE
AD ○	AREA DRAIN CONNECT TO MEP SYSTEM

- NOTES:
- REFER TO CIVIL GRADING AND UTILITY PLANS FOR ALL AREAS OUTSIDE THE LANDSCAPE LIMITS OF WORK. PERFORM FINE GRADING IN ALL AFFECTED AREAS AS CONFIRMED IN THE FIELD.
 - REPAIR ANY EXISTING IRRIGATION LINES INTERRUPTED DURING DEMOLITION. FIELD-VERIFY ALL REPAIRS AND RESTORE THE AFFECTED LAWN AREAS.
 - EXISTING SOIL/PLANTING AREAS TO REMAIN. REMOVE DEBRIS TO PREPARE THE AREA FOR FUTURE PLANTING.
 - EXISTING PLANTING AREA TO REMAIN. CONTRACTORS SHALL ENSURE THAT THE EXISTING FINISH GRADE IS A MINIMUM OF 1" BELOW THE NEW CONCRETE PAVING. ADD SOIL IF IT EXCEEDS A 2" DIFFERENCE. FIELD VERIFY.

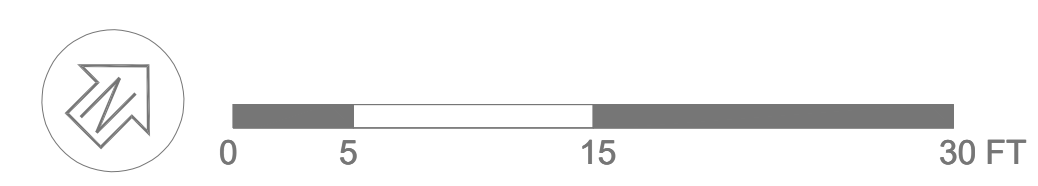

SCALE: 1/8"=1'-0" SITE GRADING PLAN 01



DATE:	DEC. 2, 2025
SCALE:	AS SHOWN
DESIGN:	LANDSCAPE
DRAWN:	SK
CHECK:	JS
ENGR:	NA

**OAK MEADOW BANDSTAND AREA
IMPROVEMENT PROJECT**
80% CONSTRUCTION DOCUMENTATION SUBMISSION



REVISIONS	DATE	BY
95% Construction Document	1/20/25	Team
100% Construction Document	12/2/25	Team

SHEET L0.3

TOWN OF LOS GATOS PARKS AND PUBLIC WORKS DEPARTMENT PROJECT NO.: 21-831-4007

CONTRACTOR AGREES THAT HE SHALL ASSUME SOLE AND COMPLETE RESPONSIBILITY FOR SITE CONDITIONS DURING THE COURSE OF CONSTRUCTION OF THIS PROJECT, INCLUDING SAFETY OF ALL PERSONS AND PROPERTY, THAT THIS REQUIREMENT SHALL APPLY CONTINUOUSLY AND NOT BE LIMITED TO NORMAL WORKING HOURS, AND THAT THE CONTRACTOR SHALL DEFEND, INDEMNIFY AND HOLD THE OWNER AND THE ENGINEER HARMLESS FROM ANY AND ALL LIABILITY, REAL OR ALLEGED, IN CONNECTION WITH THE PERFORMANCE OF WORK ON THIS PROJECT, EXCEPTING LIABILITY ARISING FROM THE SOLE NEGLIGENCE OF THE OWNER OR THE ENGINEER.

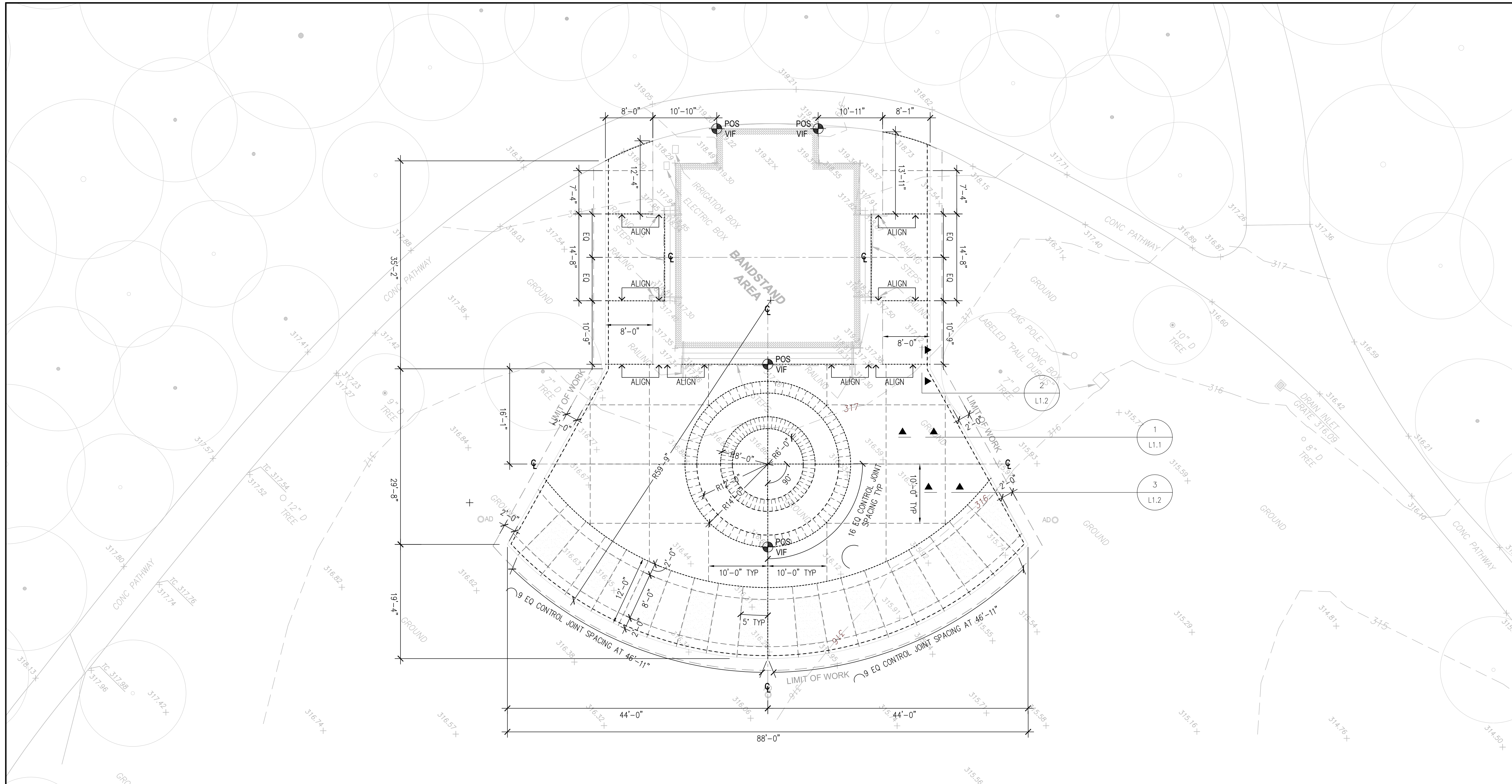

GENERAL LEGEND					
SYMBOL		SYMBOL		SYMBOL	
	POINT OF START VERIFY IN FIELD		EXPANSION JOINT		ALIGN
	CENTER LINE		CONTROL JOINT		DIMENSION
			COLD JOINT		

NOTE : REFER TO CIVIL GRADING AND UTILITY PLANS FOR OUTSIDE OF LANDSCAPE LIMIT OF WORK



DATE: DEC. 2, 2025
 SCALE: AS SHOWN
 DESIGN: FIELDSCAPE
 DRAWN: SK
 CHECK: JS
 ENGR: NA
 PROJECT NO.: 21-831-4007

**OAK MEADOW BANDSTAND AREA
 IMPROVEMENT PROJECT**
 80% CONSTRUCTION DOCUMENTATION SUBMISSION



REVISIONS	DATE	BY
95% Construction Document	11/20/25	Team
100% Construction Document	12/2/25	Team

C:\Users\ajg\OneDrive\Fieldscape\Projects\2021 LOS GATOS\4- Documents\CAD\B\es\LU.4_Site Layout Plan.dwg 12/02/2025 - 12:24 PM esajg 1/1

CONTRACTOR AGREES TO ASSUME SOLE AND COMPLETE RESPONSIBILITY FOR JOB SITE CONDITIONS DURING THE COURSE OF CONSTRUCTION OF THIS PROJECT, INCLUDING SAFETY OF ALL PERSONS AND PROPERTY, THAT THIS REQUIREMENT SHALL APPLY CONTINUOUSLY AND NOT BE LIMITED TO NORMAL WORKING HOURS AND THAT THE CONTRACTOR SHALL DEFEND, INDEMNIFY AND HOLD THE OWNER AND THE ENGINEER HARMLESS FROM ANY AND ALL LIABILITY, REAL OR ALLEGED, IN CONNECTION WITH THE PERFORMANCE OF WORK ON THE PROJECT, EXCEPTING LIABILITY ARISING FROM THE SOLE NEGLIGENCE OF THE OWNER OR THE ENGINEER.

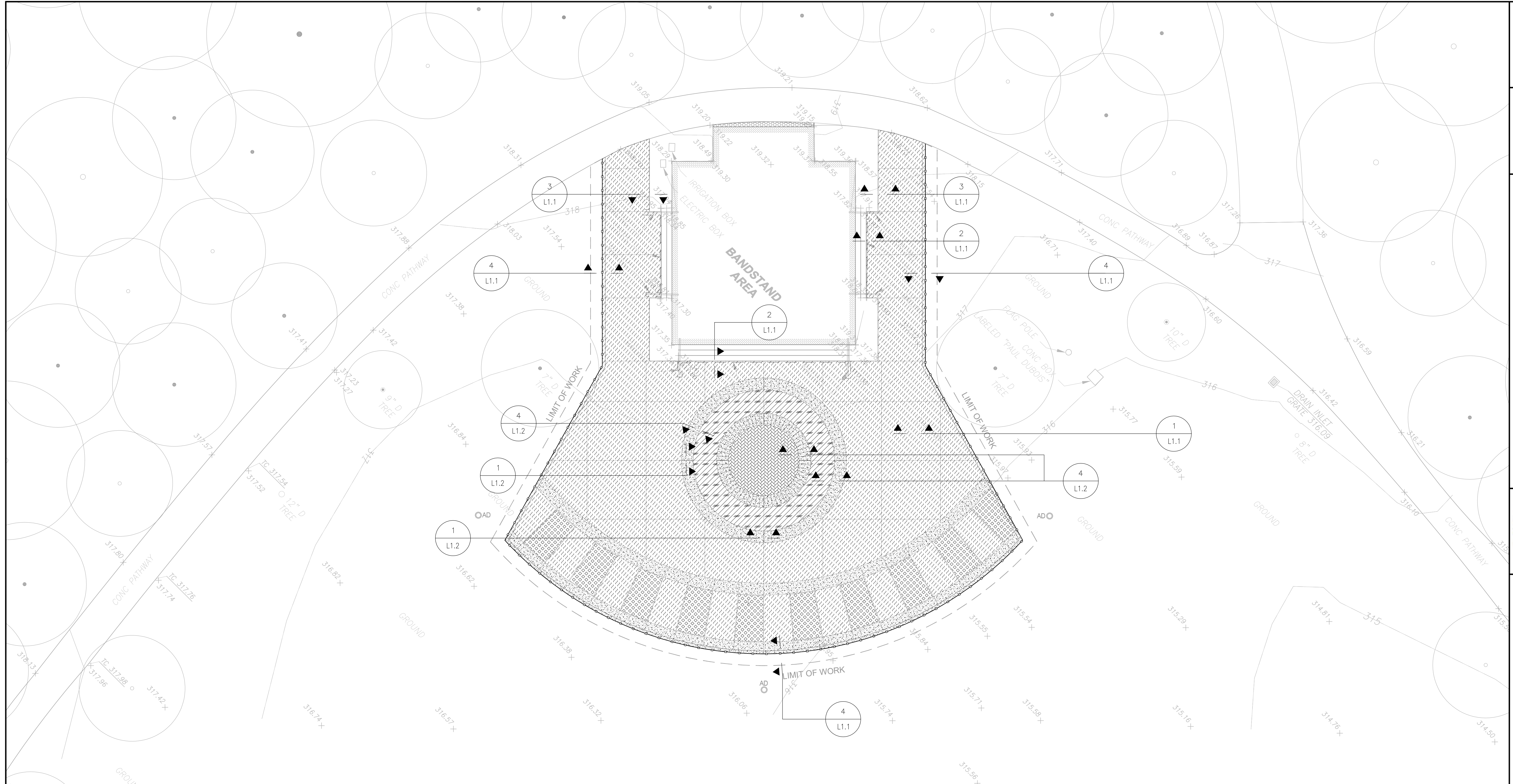

MATERIAL LEGEND	
SYMBOL	
	CONCRETE TYPE 1 - NATURAL COLOR, SAND BLAST FINISH
	CONCRETE TYPE 2 - DARK GREY COLORED CONCRETE, SAND BLAST FINISH
	CONCRETE TYPE 3 - NATURAL COLOR, BROOM FINISH

MATERIAL LEGEND	
SYMBOL	
	STAMPED CONCRETE TYPE 1 - BRICK PATTERN TAN COLOR
	STAMPED CONCRETE TYPE 2 - BRICK PATTERN RED COLOR
	CONCRETE CURB - NATURAL COLOR
	AREA DRAIN

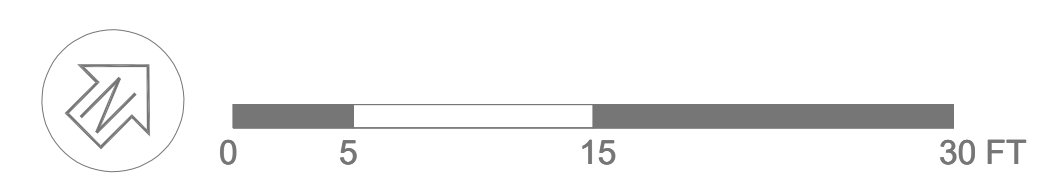

- NOTES:
- REFER TO EXISTING SITE PLAN, CIVIL GRADING AND UTILITY PLANS FOR OUTSIDE OF LANDSCAPE LIMIT OF WORK.
 - CONTRACTOR SHALL BE RESPONSIBLE FOR THE VERIFICATION OF ALL EXISTING UTILITIES AND MODIFY OR RECONNECT PER TOWN ENGINEERS DIRECTION IN THE FIELD.

SCALE: 1/8"=1'-0" SITE MATERIAL PLAN 01



DATE: DEC. 2, 2025
 SCALE: AS SHOWN
 DESIGN: FIELDSCAPE
 DRAWN: SK
 CHECK: JS
 ENGR: NA
 PROJECT NO.: 21-831-4007

**OAK MEADOW BANDSTAND AREA
 IMPROVEMENT PROJECT**
 80% CONSTRUCTION DOCUMENTATION SUBMISSION



REVISIONS	DATE	BY
95% Construction Document	1/20/25	Team
100% Construction Document	12/2/25	Team

SHEET L0.5

CONTRACTOR AGREES THAT HE SHALL ASSUME SOLE AND COMPLETE RESPONSIBILITY FOR JOB SITE CONDITIONS DURING THE COURSE OF CONSTRUCTION OF THIS PROJECT, INCLUDING SAFETY OF ALL PERSONS AND PROPERTY, THAT THIS REQUIREMENT SHALL APPLY CONTINUOUSLY AND NOT BE LIMITED TO NORMAL WORKING HOURS AND THAT THE CONTRACTOR SHALL DEFEND, INDEMNIFY AND HOLD THE OWNER AND THE ENGINEER HARMLESS FROM ANY AND ALL LIABILITY, REAL OR ALLEGED, IN CONNECTION WITH THE PERFORMANCE OF WORK ON THIS PROJECT, EXCEPTING FOR LIABILITY ARISING FROM THE SOLE NEGLIGENCE OF THE OWNER OR THE ENGINEER.

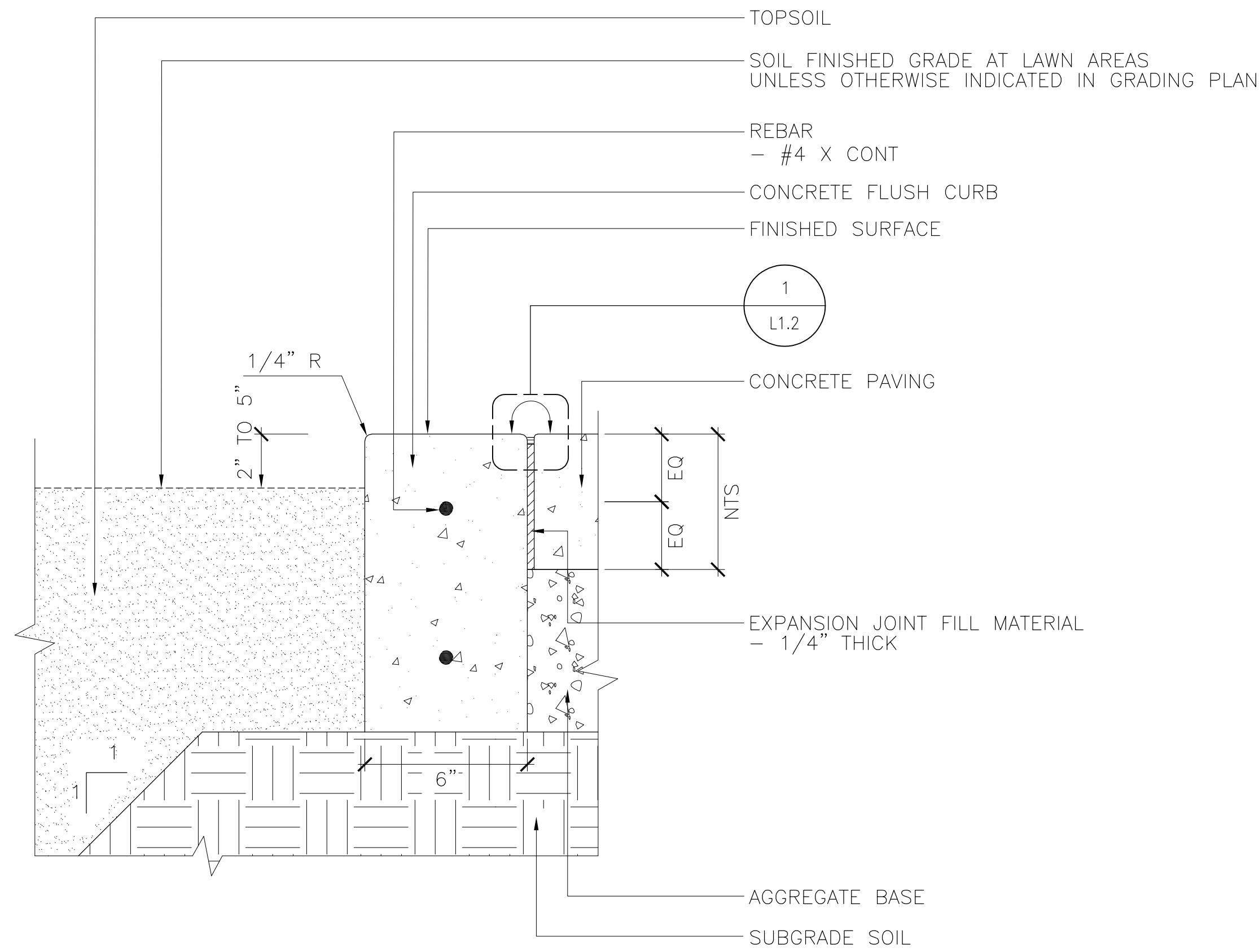

CONCRETE FLUSH CURB PAVING EDGE ALONG NEW TURF AREA 04
SCALE: 3"=1'-0"

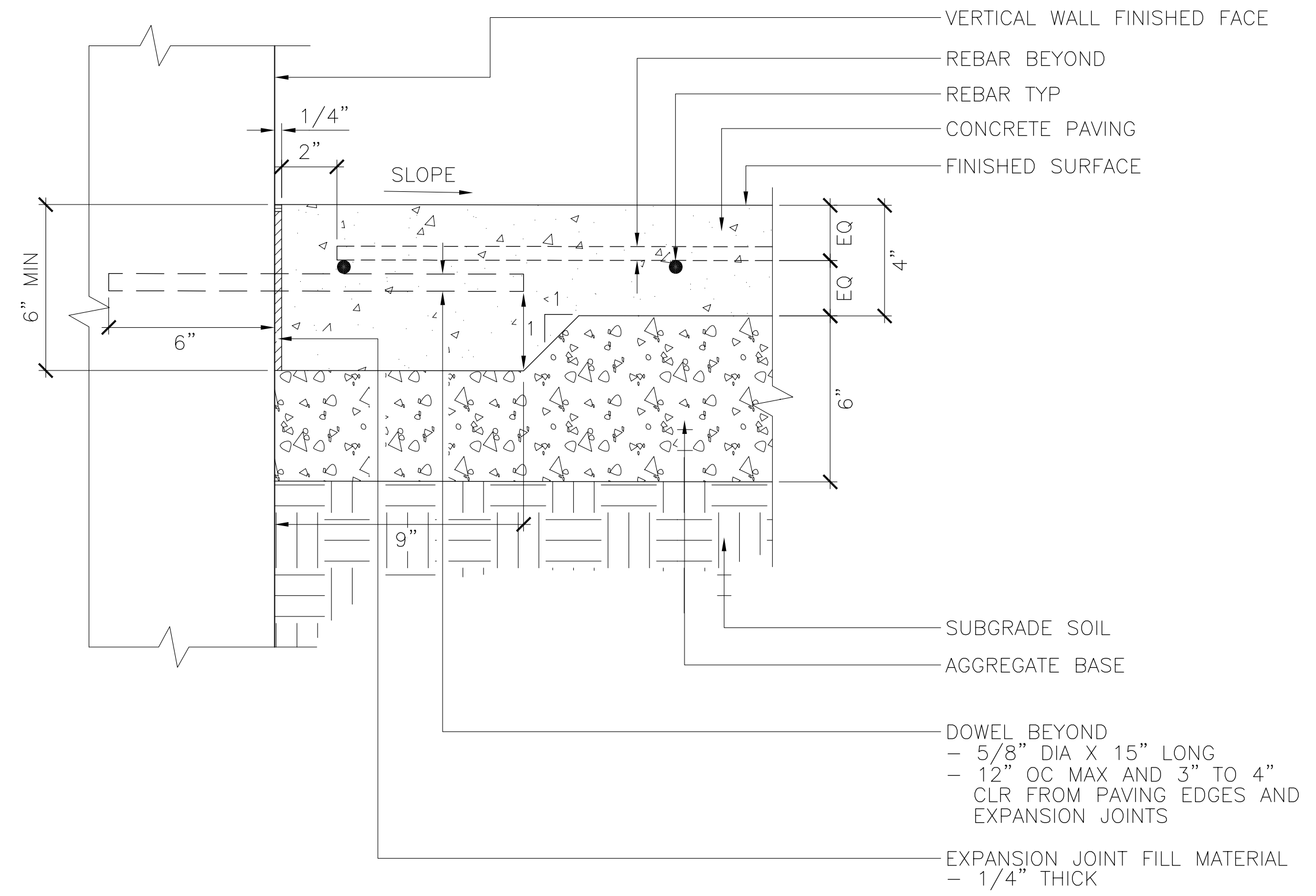

PEDESTRIAN CONCRETE PAVING EDGE ALONG VERTICAL SURFACE 02
SCALE: 3"=1'-0"

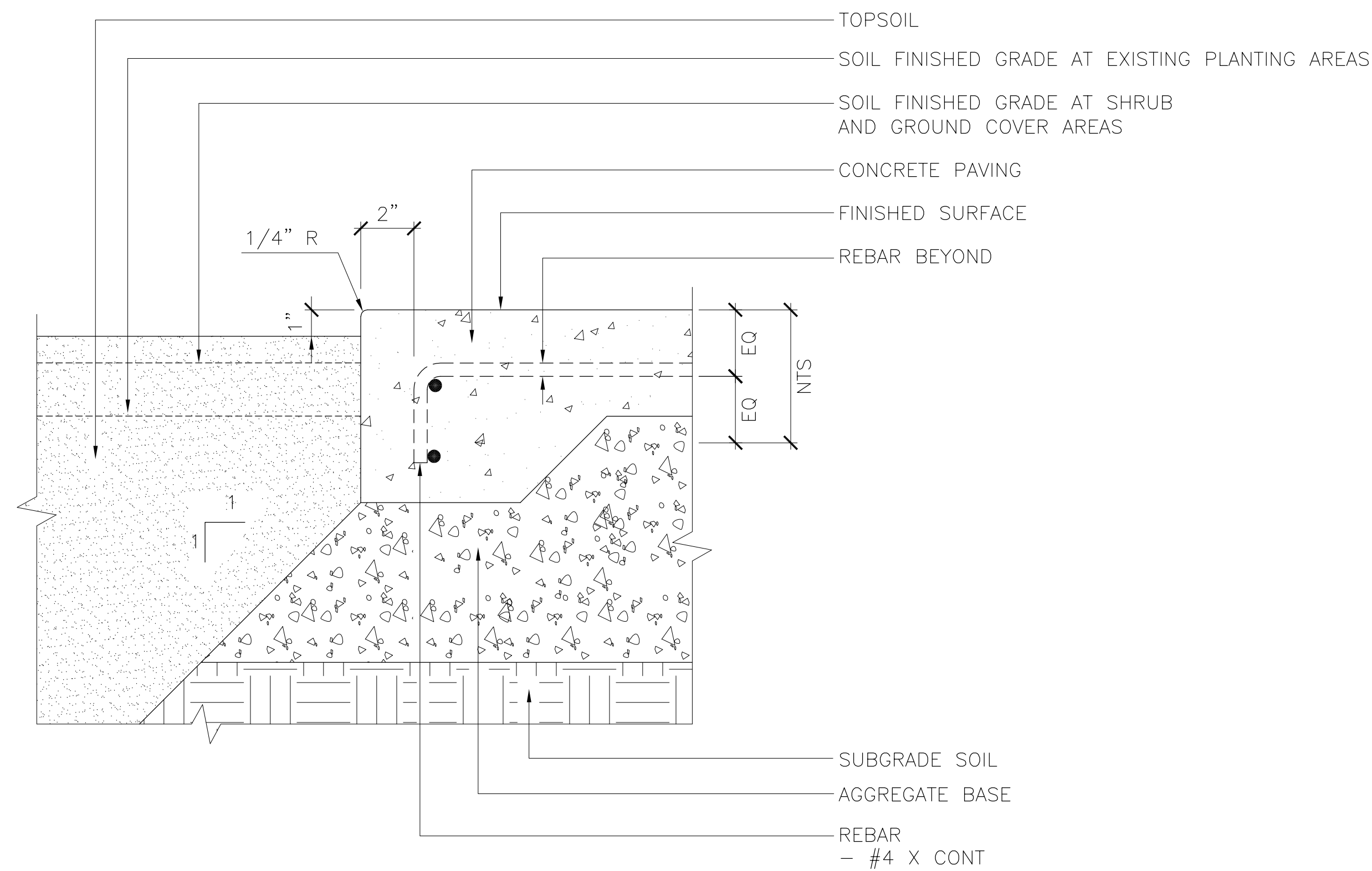

CONCRETE PAVING EDGE ALONG EXISTING PLANTING AREA 03
SCALE: 3"=1'-0"

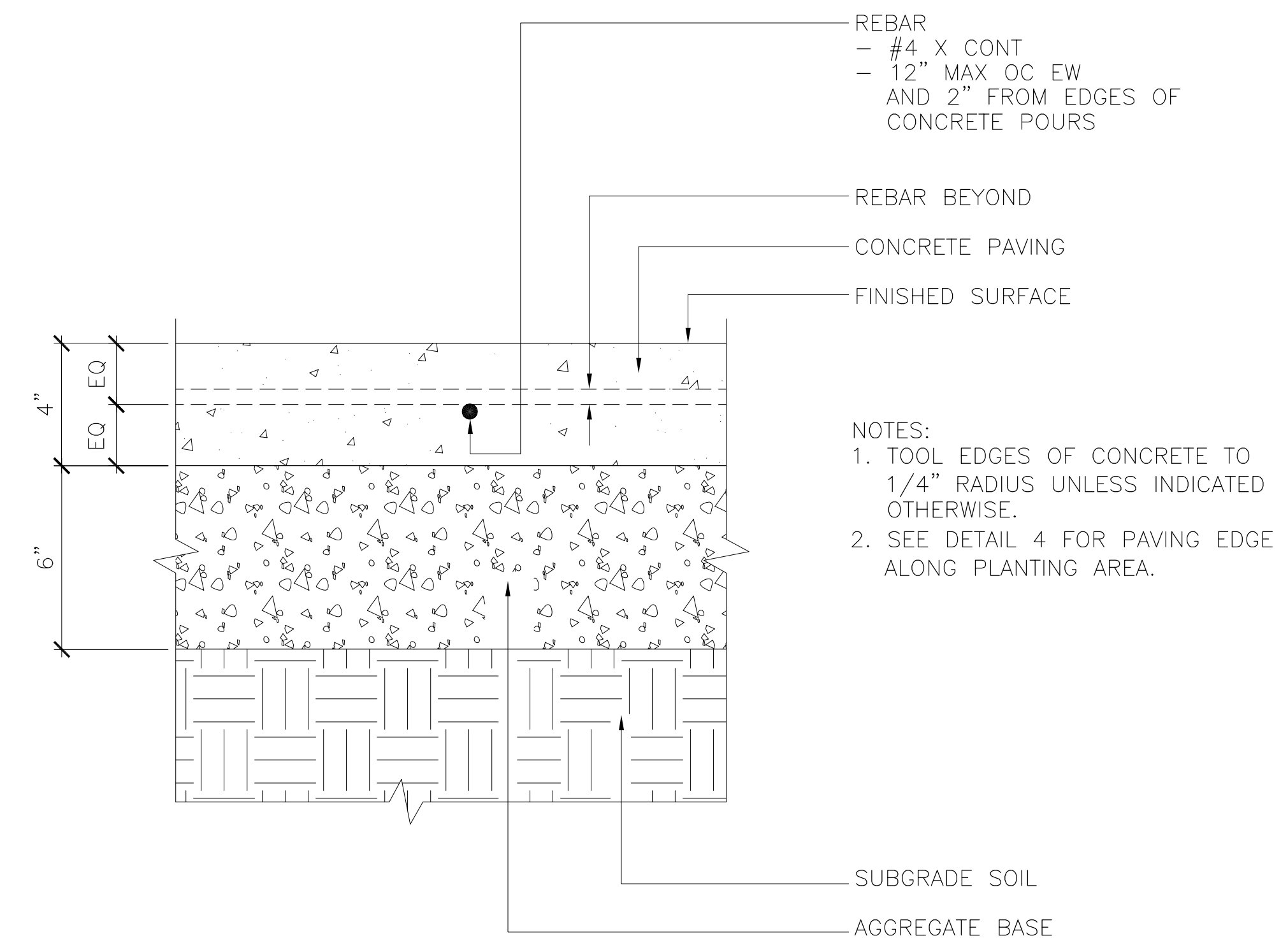

PEDESTRIAN CONCRETE PAVING TYPICAL SECTION 01
SCALE: 3"=1'-0"

- NOTES:
- TOOL EDGES OF CONCRETE TO 1/4" RADIUS UNLESS INDICATED OTHERWISE.
 - SEE DETAIL 4 FOR PAVING EDGE ALONG PLANTING AREA.



DATE:	DEC. 2, 2025
SCALE:	AS SHOWN
DESIGN:	FIELDSCAPE
DRAWN:	SK
CHECK:	JS
ENGR:	NA

**OAK MEADOW BANDSTAND AREA
IMPROVEMENT PROJECT**
80% CONSTRUCTION DOCUMENTATION SUBMISSION



REVISIONS	BY	DATE
95% Construction Document	Team	1/20/25
100% Construction Document	Team	12/2/25

SHEET L1.1

PROJECT NO.: 21-831-4007 TOWN OF LOS GATOS PARKS AND PUBLIC WORKS DEPARTMENT

CONTRACTOR AGREES THAT HE SHALL ASSUME SOLE AND COMPLETE RESPONSIBILITY FOR JOB SITE CONDITIONS DURING THE COURSE OF CONSTRUCTION OF THIS PROJECT, INCLUDING SAFETY OF ALL PERSONS AND PROPERTY, THAT THIS REQUIREMENT SHALL APPLY CONTINUOUSLY AND NOT BE LIMITED TO NORMAL WORKING HOURS, AND THAT THE CONTRACTOR SHALL DEFEND, INDEMNIFY AND HOLD THE OWNER AND THE ENGINEER HARMLESS FROM ANY AND ALL LIABILITY, REAL OR ALLEGED, IN CONNECTION WITH THE PERFORMANCE OF WORK ON THIS PROJECT, EXCEPTING LIABILITY ARISING FROM THE SOLE NEGLIGENCE OF THE OWNER OR THE ENGINEER.



DATE: DEC 2, 2025
 SCALE: AS SHOWN
 DESIGN: FIELDSCAPE
 DRAWN: SK
 CHECK: JS
 ENGR: NA
 PROJECT NO.: 21-831-4007

**OAK MEADOW BANDSTAND AREA
 IMPROVEMENT PROJECT**
 80% CONSTRUCTION DOCUMENTATION SUBMISSION
 TOWN OF LOS GATOS
 PARKS AND PUBLIC WORKS DEPARTMENT



REVISIONS	BY	DATE
95% Construction Document	Team	1/20/25
100% Construction Document	Team	12/2/25

SHEET L1.2

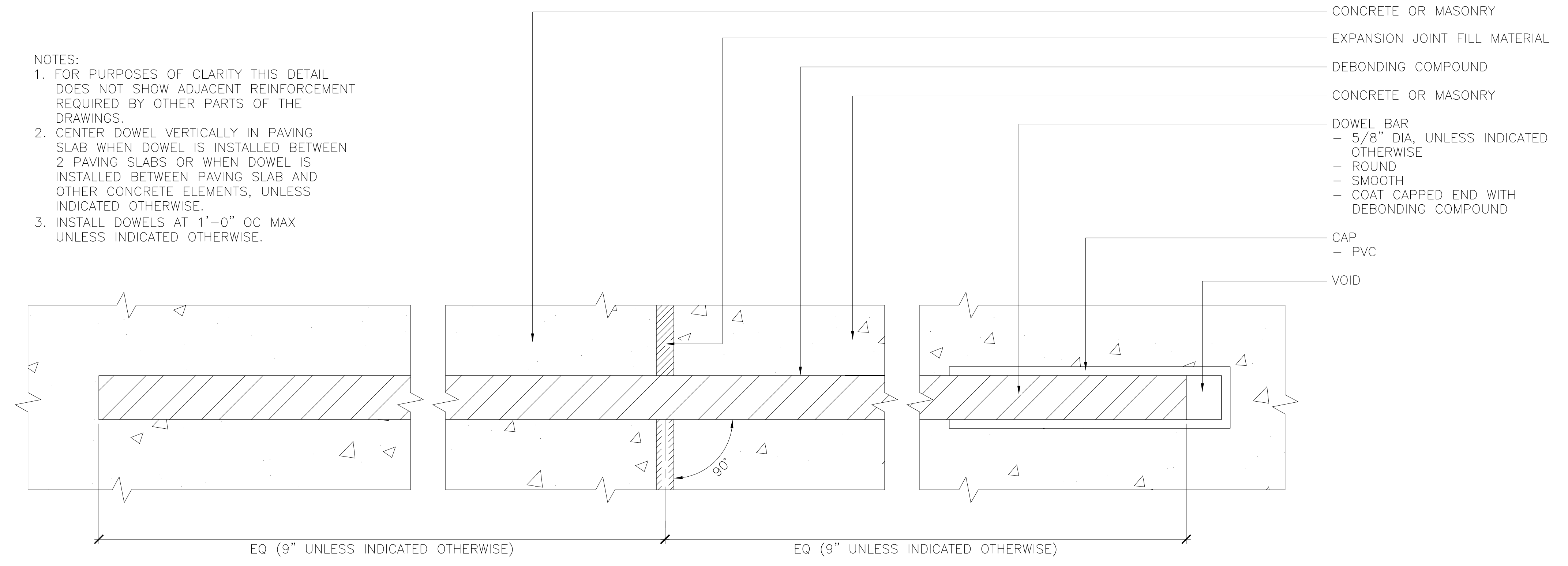

CONCRETE EXPANSION JOINT DOWEL 02
 SCALE: 1"=1'-0"

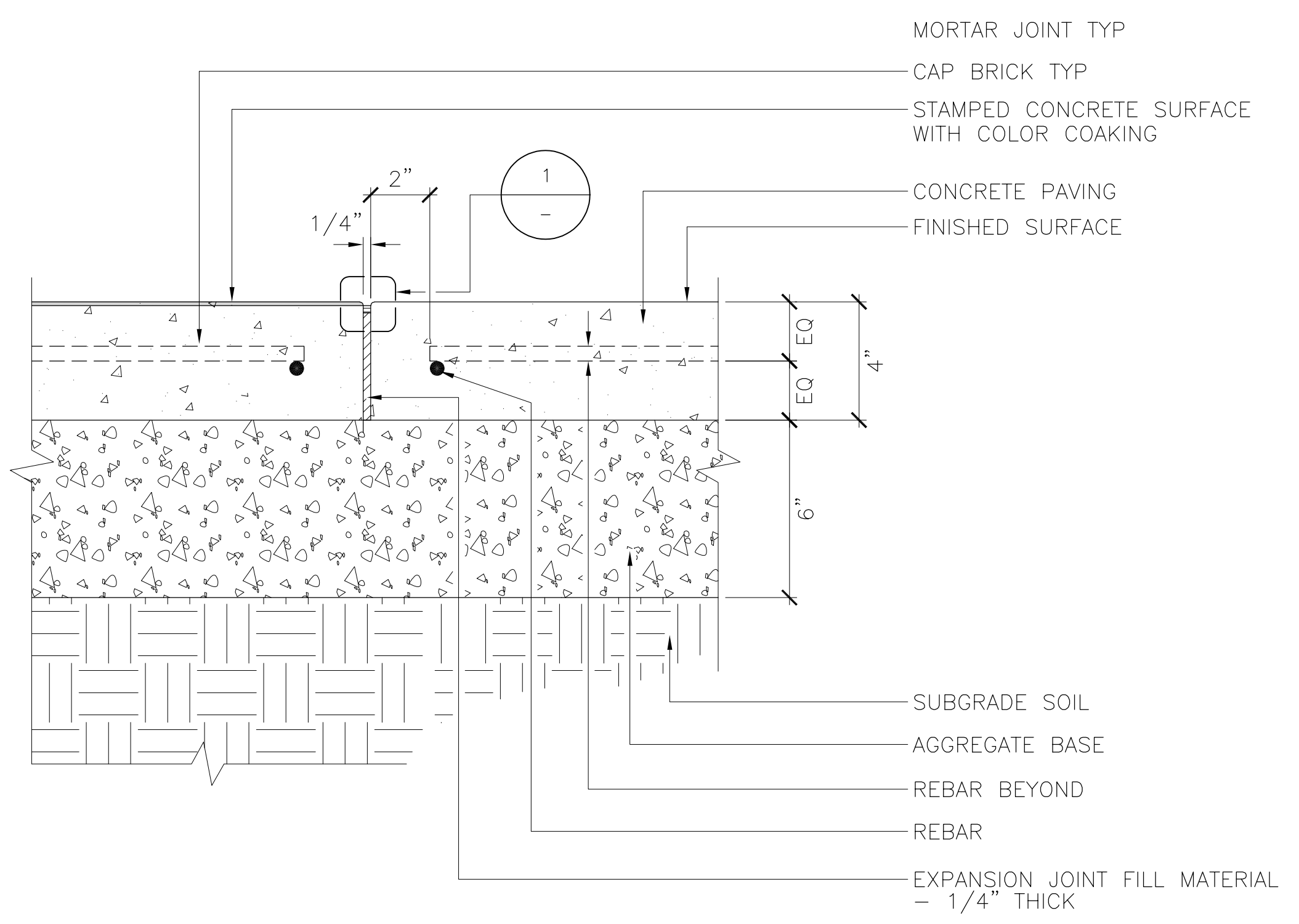

PEDESTRIAN STAMPED CONCRETE PAVING 04
 SCALE: 3"=1'-0"

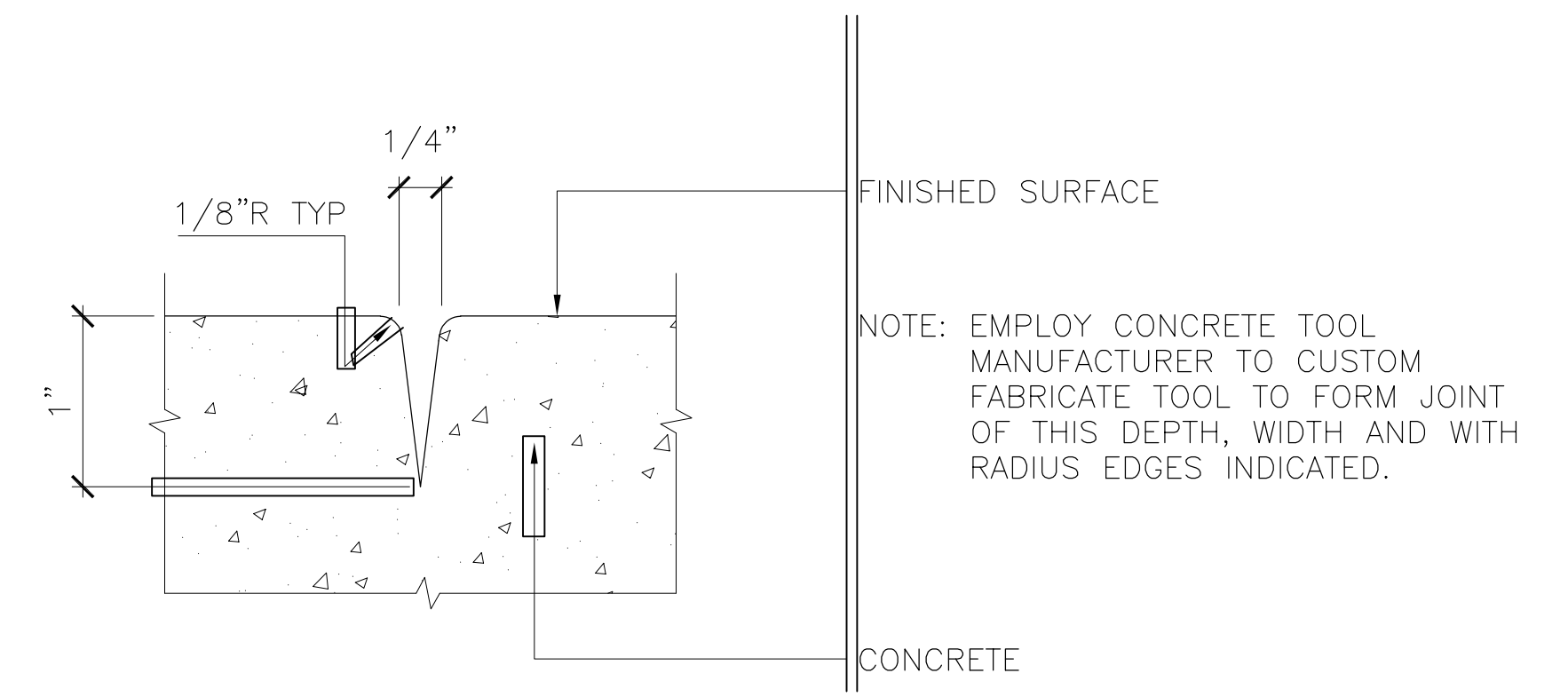

TOOLED CONTROL JOINT IN CONCRETE PAVING 03
 SCALE: 1"=1'-0"

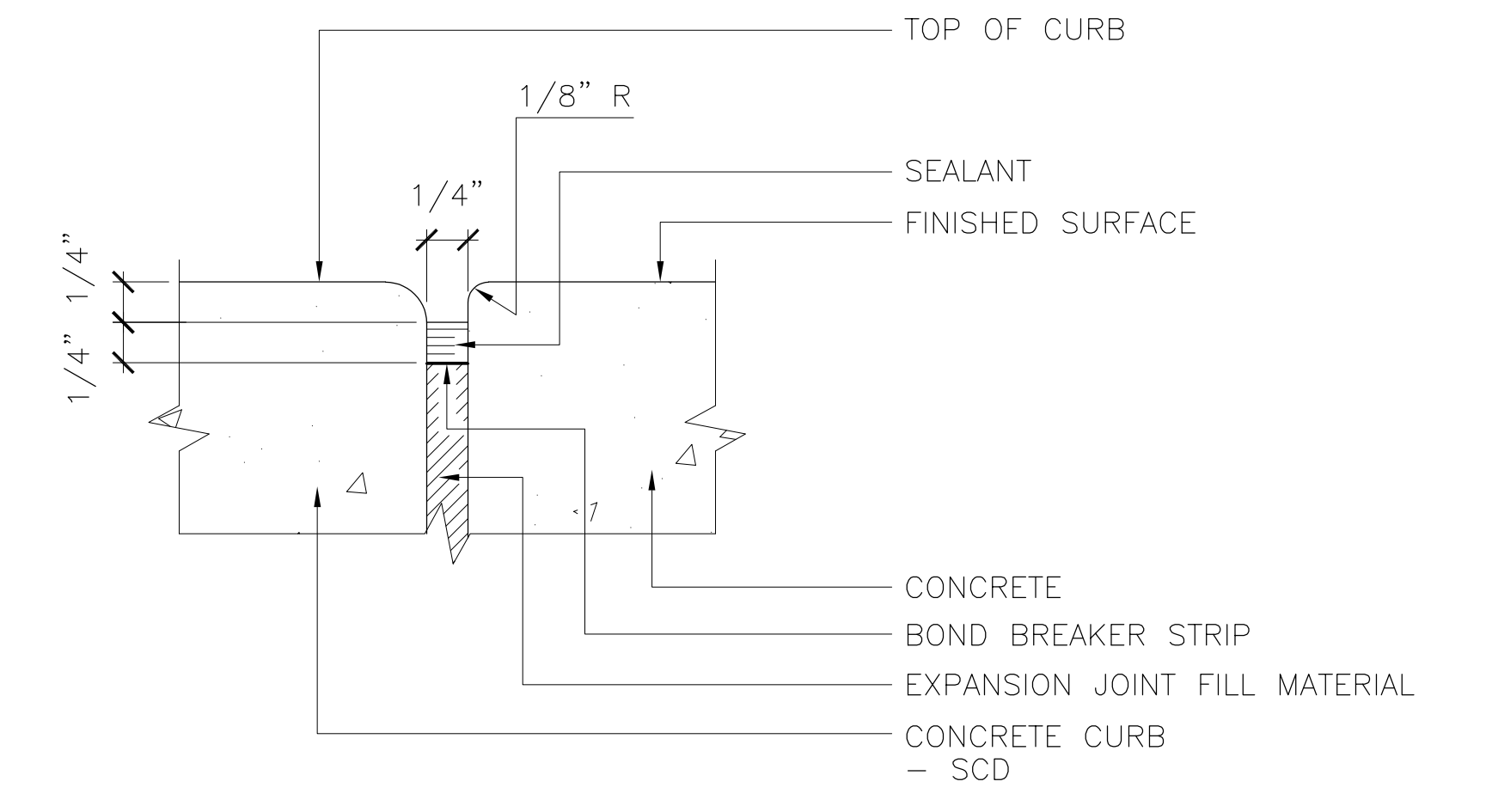

EXPANSION JOINT 01
 SCALE: 1"=1'-0"