

TREE REMOVAL AND/OR PRUNING PERMIT

Application Number: T23-089 Approved: _____ Denied: 10/2 Permit Number: T23-089 Expires: 9/12/23

Permit for (check all that apply):

☒ Protected Tree Removal ☐ Protected Tree Pruning (more than 25% in a 3 year period)
☐ Heritage or Large Protected Tree Removal ☐ Heritage or Large Protected Tree Pruning

Property Owner Name:	Nico Hailey	Phone:	831-345-3715
Property Location/Address	16496 Hilow Road, Los Gatos, CA 95032	E-Mail:	ndhailey@gmail.com
Mailing Address (if different from above)			
Applicant Name (if different from above)		Phone:	

Tree #	Approved	Required Finding(s)	Denied	Reason for Denial	Replacement Requirement	In Lieu Fee
1			la z	Both trees are healthy.		
2				Structural Prune only.		
				Root damage minor.		
					Total In-Lieu Fees	

☐ All or some of the required replacement trees cannot be reasonably replanted on site and payment of the in-lieu fee as indicated above has been approved. Permit will not be issued until all in-lieu fees are paid in full.

General Permit Conditions

1. Notify the Town of Los Gatos Parks and Public Works Department at 408-399-5770 48 hours before work begins.
2. All underground utilities shall be located and protected from damage due to removal, stump grinding, or root pruning activities. **Contact Underground Service Alert (USA) by dialing 811 or 800-227-2600 or online at www.usanorth.org at least 48 hours before tree removal activities.**
3. Inspect trees prior to removal or major pruning to confirm the absence of active bird nests, particularly during the spring/summer nesting season (February 1 through August 31).
4. The use of gas-powered leaf blowers is prohibited in the Town of Los Gatos. Use of electric powered leaf blowers is permitted.
5. Approved pedestrian and vehicular traffic control shall be used and maintained at all times. Depending on the location of the work, time of day, and the required equipment, an encroachment permit may be required.
6. All contractors performing tree work in the Town of Los Gatos are required to have a Town Business License. Contractors performing work valued at more than \$500 must also hold a current, valid license from the Contractors State License Board (CSLB).
7. The permit must be posted on site at all times while tree removal or pruning is taking place.
8. **Permit holder is required to submit photographs of replacement trees along with replanting date to the Town of Los Gatos Parks and Public Works Department prior to permit expiration date.**

Special Permit Conditions

Rob Moulden
Rob Moulden, Town Arborist

6-12-23
Date

Revised April 17, 2020



TOWN OF LOS GATOS

PARKS & PUBLIC WORKS
SERVICE CENTER
41 MILES AVENUE
LOS GATOS, CA 95030
(408) 399-5770

APPLICATION FOR TREE REMOVAL AND/OR PRUNING PERMIT

Purpose of Application (check all that apply): ☐ Protected Tree Removal ☐ Protected Tree Pruning (more than 25% in a 3 year period)
☐ Heritage or Large Protected Tree Removal ☐ Heritage or Large Protected Tree Pruning

☐ Check here if removal or pruning is in compliance with an approved development application. Photos and site plan required.

Name of CDD Planner: _____ Project Application #: _____ Date of Approval: _____

☐ Check here if removal or pruning deviates in some way from an approved development application (describe on separate sheet if needed)

☐ Check here if property is located within the designated Town of Los Gatos Hillside Area (See FAQ sheet for additional provisions)

Property Owner Name: Nico Hailey 45032 Phone: 831 345 3715
Property Location/Address: 16496 Hilow Rd Email: ndhailey@gmail.com
Mailing Address (if different from above) _____
Applicant Name (if different from above) _____ Phone: _____

I hereby certify that I am the owner of record of the property described above, and that I approve of the action(s) requested herein. I also hereby grant the Town or the Town's agent permission to visit the property to inspect the tree(s) that are covered by this application.

Property Owner's Signature (required): Nico Hailey Date: May, 17th 2023

Tree #	List of species of all trees. Show corresponding # on Site Plan	Diameter Inches	Canopy Feet	List birds living in tree if any	Remove or Prune	DESCRIBE REASON FOR REMOVAL AND/OR PRUNING
1	Redwood	36	20	NO	Remove	Too tall + breaking foundation
2	Redwood	38	20	NO	Remove	Too tall + too close to each other

Copy to another sheet if more than 10 trees.

Notes:

- Tree numbers should match those in arborist report where applicable.
- Diameter is measured at a height of 4.5' above the average grade.
- Canopy measurement is the widest dimension of the canopy spread.
- Inspect trees prior to removal or major pruning to confirm the absence of active bird nests, particularly during the spring/summer nesting season (February 1 through August 31).
- Replacement Trees are not required if the tree being removed is dead or has a Tree Risk Rating of Extreme or High, as determined by the Town Arborist.
- Fee is \$250 for first tree, and \$125 for each additional tree.

For Office Use Only

Application Number: T23-089
Total Number Tree(s): 2
Payment Amount Received: \$384 [TREEREM]
Check Number: _____
Credit Card Auth.: _____
Inspection Date _____ Approved ☐ Denied ☐ Initials _____

☐ Check here if replacement trees cannot be reasonably replanted on site and payment of an in-lieu fee is requested. Town arborist approval is required for all in-lieu fee payment options. See reverse for more information on replacement requirements.

IMPORTANT: Be sure to provide the following required documents when submitting the application:

- ☒ Photos and site plan of tree(s) proposed for removal or pruning. For pruning, proposed cuts should be indicated on photo.
- ☐ Completed Tree Replacement Worksheet. See reverse for replacement tree requirements and worksheet.
- ☒ Fee payment made using cash, check or credit card (VISA/MasterCard only).
- ☐ Notification required for Heritage and Large Protected Tree Permits only. See attached FAQs for guidelines.

T23-089

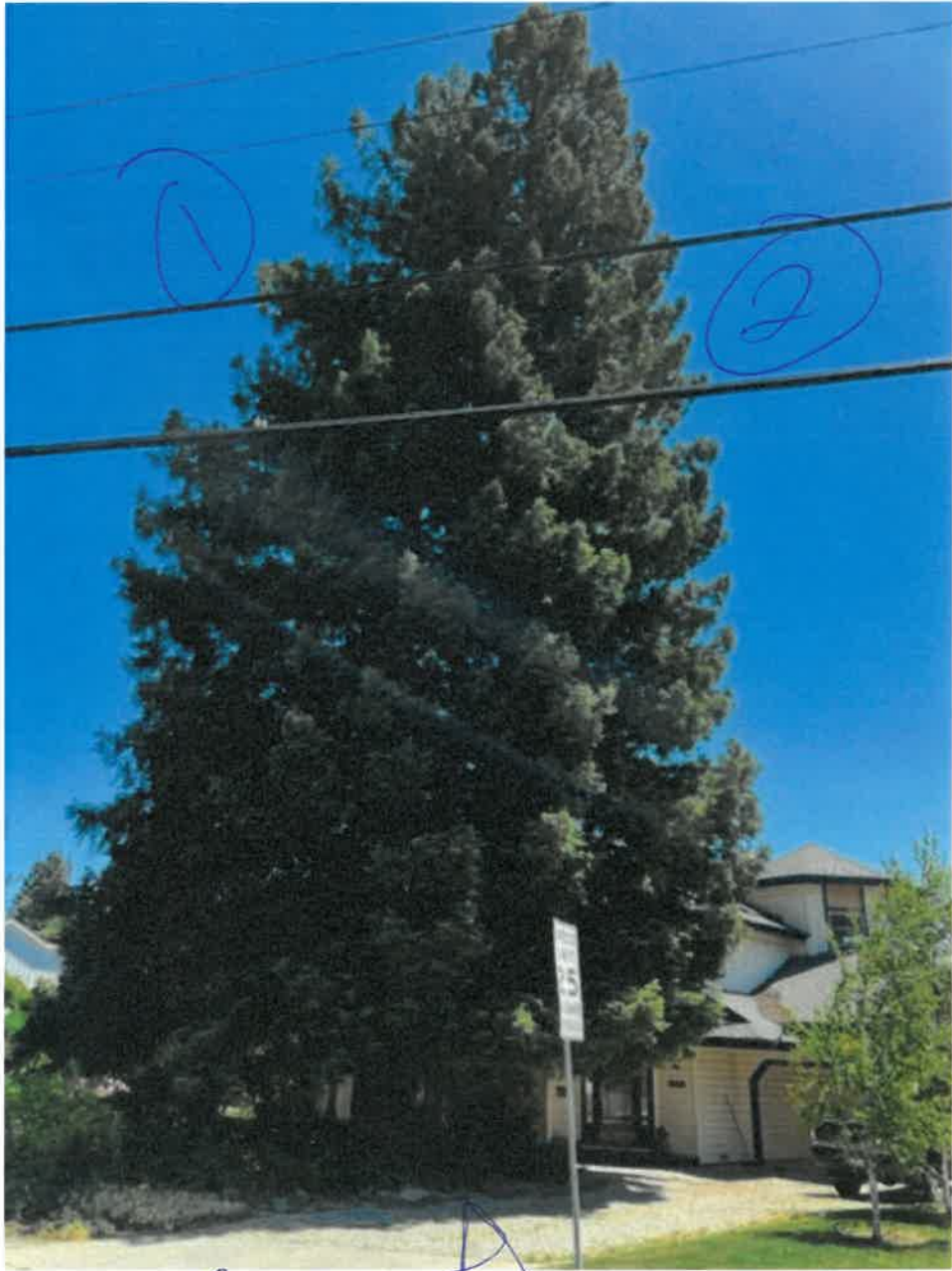

CENTER LINE OF
HILLOW ROAD

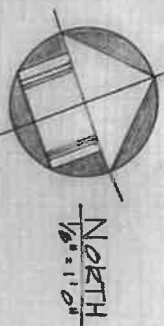

16496 HILLOW ROAD

50' 0"

EDGE OF PAVEMENT

CURB

PARKWAY

70.77'

FRONT YARD

(E) TREES

25' 0" EXIST. FRONT SET BACK

EXIST. SINGLE STORY BUILDING DELETED BY

6' 0" REAR YARD

SIDE YARD

170' 32"

(E) TREE

(E) TREE

9' 0" SET BACK

7' 0" ALLEY DRIVE

(E) TREES

EXIST. REAR SET BACK

PORCH

ENTRY

12' 0"

12' 0"

22' 0"

12' 0"

35' 0"

131' 8"

PROPERTY LINES

PROPOSED ADDITION 1/2

BETWEEN STRUCTURES