

Chapter 14.50 CT COMMERCIAL THOROUGHFARE DISTRICT*

Sections:

14.50.010 CT District.

The regulations, general provisions, and exceptions set forth in this chapter and in Chapter 14.66 of this title shall apply in the CT District.

(Ord. 04-259 § 1 (part))

14.50.020 Specific purposes (CT).

Specific purposes for CT Districts are as follows:

- A. To encourage a variety of residential developments, including affordable housing development;
- B. To promote the economic and commercial success of Los Altos;
- C. To encourage aggregation of parcels;
- D. To buffer the impacts of commercial and multi-family land uses on neighboring residential properties;
- E. To emphasize a healthy proportion of retail uses as opposed to office and service uses; and
- F. To allow for mixed uses of commercial and residential

(Ord. 04-259 § 1 (part))

Ord. No. 2017-436 , § 1, 10-10-2017)

14.50.030 Permitted uses (CT).

The following uses shall be permitted in the CT District:

- A. Professional and office-administrative services;
- B. Restaurants, excluding drive-through facilities;
- C. Retail and personal services;
- ~~D.~~ D. Residential Only Development(s);
- ~~E.~~ E. Mixed Use Development(s);
- ~~F.~~ F. Single Room Occupancy (SRO) Housing;
- ~~D-G.~~ Emergency shelters; and
- ~~E-H.~~ E-H. Uses which are determined by the city planner Zoning Administrator to be of the same general character.

(Ord. 05-280 § 8 (part): Ord. 04-259 § 1 (part))

(Ord. No. 2015-406 , § 2, 2-10-2015; Ord. No. 2015-408 , § 2, 6-9-2015)

14.50.040 Conditional uses (CT).

Upon the granting of a use permit in accordance with the provisions of Chapter 14.80 of this title, the following uses shall be permitted in the CT District:

- A. Animal clinics, hospitals, and kennels;
- B. Business, professional, and trade schools;
- ~~C. Cocktail lounges;~~
- ~~D.C.~~ Commercial recreation;
- ~~E.D.~~ Day care centers;
- ~~F.E.~~ Hotels and motels;
- ~~G.F.~~ Medical and dental clinics;
- ~~H. Medical and dental offices that are five thousand (5,000) gross square feet or more;~~
- ~~I. Mixed-use projects, including a combination of multiple family dwelling units and nonresidential uses;~~
- ~~J.G.~~ Mortuaries;
- ~~K. Multiple family housing;~~
- ~~L.H.~~ Pet shops;
- ~~M.I.~~ Printing shops;
- ~~N. Single-room occupancy housing;~~
- ~~O.J.~~ Upholstery shops; and
- ~~P.K.~~ Uses which are determined by the planning commission ~~and the city council~~ to be of the same general character.

(Ord. 05-280 § 8 (part): Ord. 04-259 § 1 (part))

(Ord. No. 2015-406 , §§ 3, 4, 2-10-2015; Ord. No. 2015-409 , § 2, 6-9-2015)

14.50.050 Limited conditional uses (CT).

Upon the granting of a use permit in accordance with the provisions of Chapter 14.80 of this title, the following uses shall be permitted except on parcels within fifty (50) feet of an R District:

- A. Automotive display or salesrooms, servicing and repair;
- B. Cabinet and carpenter shops;
- C. Drive-through facilities, including car washes;
- D. Service stations provided the site has at least one hundred (100) feet of frontage on a street with a minimum site area of twenty thousand (20,000) square feet;
- E. Sheet metal shops;
- F. Sign painting shops; and
- G. Theaters and auditoriums.

(Ord. 04-259 § 1 (part))

(Ord. No. 10-348, § 6, 4-13-2010)

14.50.060 Required conditions (CT).

The following conditions shall be required of all uses in the CT District:

- A. All businesses, services, and processes shall be conducted within a completely enclosed structure, except for recycling facilities, parking and loading areas, outdoor dining areas, nurseries, the sale of gasoline and oil at service stations, bus depots, or as permitted under the terms of a permit issued pursuant to Chapter 14.80 of this title.
- B. No use shall be permitted and no process, equipment, or materials shall be employed which are found by the commission to be objectionable by reason of odor, dust, noise, vibration, illumination, glare, unsightliness, or electrical disturbances which are manifested beyond the premises in which the permitted use is located.
- C. No property owner, business owner, or tenant shall permit or allow activities, which violate the requirements of this chapter, including the following general criteria:
 1. General screening standard. Every development shall provide sufficient screening to reasonably protect the privacy, safety, and environment of neighboring residential properties and shield them from adverse external effects of that development.

Walls up to twelve (12) feet in height shall be required for the purpose of attenuating noise, odor, air pollution, artificial light, mitigation for grade differential between properties, and providing privacy and safety.
 2. Access and screening of refuse collection. Every development will be required to provide suitable space on-site for solid waste separation, collection, storage, and pick up and shall site these in locations that facilitate access, collection, and minimize any negative impact on persons occupying the development site, neighboring properties, or public rights-of-way.
 3. Lighting. Lighting within any lot that unnecessarily illuminates any other lot or substantially interferes with the use or enjoyment of such other lot is prohibited. Lighting shall be designed to minimize the glare and intensity of external illumination, and to respect the privacy of neighbors by avoiding direct and reflected illumination onto adjacent properties.
 4. Air pollution. Any use that emits any "air contaminant" as defined by the Bay Area Air Quality Management District shall comply with applicable state standards concerning air pollution.
 5. Maintenance of common areas, improvements, and facilities. Maintenance of all common areas, improvements, or facilities required by this chapter or any permit issued in accordance with its provisions shall be required except those areas, improvements, or facilities with respect to which an offer of dedication to the public has been accepted by the appropriate public authority.
 6. Odors. No use may generate any odor that reasonably may be found objectionable as determined by an appropriate agency such as the Santa Clara County health department and the Bay Area Air Quality Management District beyond the boundary occupied by the enterprise generating the odor. All mechanical, venting, and/or exhausting equipment that generates odors shall be located away from residential properties.
 7. Noise. No person shall operate, or cause to be operated, any source of sound at any location within the city or allow the creation of any noise on property owned, leased, occupied or otherwise controlled by such person, which causes the noise level, when measured on any other

Created: 2023-06-28 07:56:37 [EST]

(Supp. No. 40, Update 2)

property, either incorporated or unincorporated, to exceed standards as set forth in Chapter 6.16 of the Los Altos Municipal Code. All mechanical, venting, and/or exhausting equipment that generates noise shall be located away from residential properties. Exterior heating, venting, and air-conditioning facilities shall be muffled.

In order to attenuate noise associated with commercial development, walls up to twelve (12) feet in height shall be required at a commercial or residential interface.

(Ord. 04-259 § 1 (part))

(Ord. No. 2017-436 , § 1, 10-10-2017)

14.50.070 Site area (CT).

The minimum site area shall be twenty thousand (20,000) square feet. The minimum site frontage shall be seventy-five (75) feet.

(Ord. 04-259 § 1 (part))

14.50.080 Residential density (CT).

~~The maximum permitted residential density shall be thirty-eight (38) dwelling units per net acre of land.~~

No residential density shall be applicable within the Commercial Thoroughfare Zoning District.

(Ord. 04-259 § 1 (part))

14.50.090 Front yard (CT).

The minimum front yard depth shall be twenty-five (25) feet, with a minimum of fifty (50) percent of which shall be landscaped.

(Ord. 04-259 § 1 (part))

14.50.100 Side yards (CT).

~~Side yard width shall average seven feet six inches with a minimum setback of four feet over the length of the wall of the structure at the side yard, except that on a corner lot, the width of the side yard adjoining the street shall average fifteen (15) feet with a minimum setback of four feet. For a property that abuts an R-District (excluding access corridors), the following requirements shall apply:~~

- ~~A. — When the side property line of the site is across a street or alley from property in an R-District, in which instance the minimum width of that side yard shall be thirty (30) feet;~~
- ~~B. — When the side property line of the site abuts on property in an R-District, in which instance the minimum width of that side yard shall be forty (40) feet for any portion of a structure thirty (30) feet or less in height and one hundred (100) feet for any portion of a structure over thirty (30) feet in height;~~
- ~~C. — A minimum twenty (20) foot landscape buffer of evergreen trees and shrubs to provide screening shall be provided, all of which shall be permanently maintained by the property owner. No below grade garage construction or excavation is permitted within this landscape buffer.~~

(Ord. 04-259 § 1 (part))

-
- a. The minimum interior side yard depth shall be ten (10) feet, with a minimum of fifty (50) percent of which shall be landscaped.
 - b. The minimum exterior side yard depth shall be fifteen (15) feet, with a minimum of fifty (50) percent of which shall be landscaped.

(Ord. No. 2017-436 , § 1, 10-10-2017)

14.50.110 Rear yard (CT).

~~No rear yard shall be required, unless the property abuts an R district (excluding access corridors) in which case the following requirements shall apply:~~

- ~~A. —When the rear property line of the site is across a street or alley from property in an R-District, the rear yard setback shall be thirty (30) feet for all structures thirty (30) feet or less in height and seventy (70) feet for all structures over thirty (30) feet in height;~~
- ~~B. —When the rear property line of the site abuts on property in an R-District, the rear yard setback shall be forty (40) feet for all structures thirty (30) feet or less in height and one hundred (100) feet for all structures over thirty (30) feet in height;~~
- ~~C. —A minimum twenty (20) foot landscape buffer of evergreen trees and shrubs to provide screening shall be provided, all of which shall be permanently maintained by the property owner. No below grade garage construction or excavation is permitted within this landscape buffer.~~

The minimum rear yard depth shall be twenty-five (25) feet, with a minimum of fifty (50) percent of which shall be landscaped.

(Ord. 04-259 § 1 (part))

(Ord. No. 10-351, § 1, 5-25-2010)

14.50.120 Off-street parking (CT).

As provided in Chapter 14.74 of this title.

(Ord. 04-259 § 1 (part))

14.50.130 Off-street loading (CT).

As provided in Chapter 14.74 of this title.

(Ord. 04-259 § 1 (part))

14.50.140 Height of structures (CT).

~~No structure shall exceed forty five (45) feet in height. Commercial and mixed use projects that include ground floor commercial floor area shall provide a ground floor with a minimum interior ceiling height of twelve (12) feet.~~

- a. Residential Only Development(s) building height shall be a maximum of fifty-five (55) feet and five (5) stories.
- b. Mixed Use Development(s) building height shall be a maximum of sixty (60) feet and five (5) stories.

(Supp. No. 40, Update 2)

Created: 2023-06-28 07:56:37 [EST]

-
- c. Non-Residential Use Only Development(s) building height shall be a maximum of forty-five (45) feet and four (4) stories.

(Ord. 08-323 § 1: Ord. 04-259 § 1 (part))

(Ord. No. 10-351, § 2, 5-25-2010)

14.50.150 Open space (CT).

All multiple-family residential projects, including mixed-use projects with multiple-family dwelling units, except duplexes, shall provide permanently maintained outdoor open space, subject to the following requirements:

- A. Although not required for each dwelling unit, an average of fifty (50) square feet of private open space shall be provided for the total number of dwelling units within a project.
- B. Any private open space provided shall be at the same level and immediately accessible from the unit it serves. The provision of private open space shall not reduce the common open space requirements of this section.
- C. Depending on the number of dwelling units in a multiple-family project, common open space shall be provided to meet the following criteria:
 - 1. Two to ten (10) units: a minimum of eight hundred (800) square feet of common open space shall be provided.
 - 2. Eleven (11) to twenty-five (25) units: a minimum of one thousand six hundred (1,600) square feet of common open space shall be provided.
 - 3. Twenty-six (26) to fifty (50) units: a minimum of two thousand four hundred (2,400) square feet of common open space shall be provided.
 - 4. Fifty-one (51) or more units: a minimum of three thousand two hundred (3,200) square feet of common open space shall be provided.
- D. Common open space areas:
 - 1. Shall be designed to be easily accessible and shall be available for passive and active outdoor recreational purposes for the enjoyment of all residents of the project;
 - 2. Shall be provided as continuous, usable site elements of sufficient size to be usable by residents that may be within the rear yard setback;
 - 3. Shall not include driveways, public or private streets, or utility easements where the ground surface cannot be used appropriately for open space.
 - 4. Common open space areas shall be surfaced with any practical combination of landscaping, paving, decking, concrete, or other serviceable material with no more than fifty (50) percent of the area at grade level covered with a non-permeable surface.
- E. Required common open space shall be controlled and permanently maintained by the owner of the property or by a homeowners' association. Provisions for control and maintenance shall be included in any property covenants of common interest developments.

(Ord. No. 2017-436 , § 1, 10-10-2017)

Editor's note(s)—Ord. No. 2017-436 § 1, adopted October 10, 2017, enacted new provisions set out as §§ 14.50.150, 14.50.160, and 14.50.180, and subsequently renumbered former §§ 14.50.150 through 14.50.180

Created: 2023-06-28 07:56:37 [EST]

(Supp. No. 40, Update 2)

as 14.50.170 and 14.50.190 through 14.50.210. Historical notation to the former sections have been retained for reference purposes.

14.50.160 Rooftop uses (CT).

Rooftop activities or uses are permitted within the perimeter walls of a structure that meet all setback standards provided also that any such activities or uses are accessory to the principal use or uses of the development, and provided further, activities shall comply with the following performance standards:

- A. No use shall be established or activity conducted that violates the noise standards and limits identified in Chapter 6.16, Noise Control, of the Municipal Code.
- B. No activity shall be conducted which causes ground vibrations perceptible at the property line.
- C. No lighting or illuminated device shall be operated so as to create glare which creates a hazard or nuisance on other properties.
- D. No use or activity shall be conducted without first obtaining any required permit from the county air pollution control district. Uses shall be conducted to prevent dust or other airborne material from crossing property lines.
- E. Solid wastes shall be handled and stored so as to prevent nuisances, health and fire hazards, and to facilitate recycling. Suitable containers shall be provided to prevent blowing or scattering of trash and screened by an enclosure. Suitable concealed space and containers shall be provided at the roof top to encourage the appropriate sorting and collection of discarded materials.
- F. No use may generate any odor that reasonably may be found objectionable as determined by an appropriate agency such as the Santa Clara County Health Department and the Bay Area Air Quality Management District beyond the boundary occupied by the enterprise generating the odor. All mechanical, venting, and/or exhausting equipment that generates odors shall be located away from residential properties.
- G. The use of conventional energy sources for space heating and cooling, water heating, and illumination shall be minimized by means of proper design and orientation, including provision and protection of solar exposure.
- H. These performance standards are general requirements and shall not be construed to prevent the council, boards or commission with review authority or staff from imposing, as part of project approval, specific conditions which may be more restrictive, in order to meet the intent of these regulations.

(Ord. No. 2017-436 , § 1, 10-10-2017)

Editor's note(s)—See Editor's Note § 14.50.150.

14.50.170 Design control (CT).

- A. Building Placement. A minimum seventy-five (75) percent of ground-floor building frontages facing El Camino Real must be built at the minimum setback line. This standard applies to the building frontage only (exclusive of side setbacks).
- B. Building Massing and Articulation.
 - 1. Upper-story Step-backs.

- a. Front: Minimum ten (10) feet from ground floor façade for stories above forty-five (45) feet in height.
 - b. Street Side: Minimum ten (10) feet from ground floor façade for stories above forty-five (45) feet in height.
2. Vertical Articulation.
- a. When a building façade exceeds one hundred (100) feet in length along a right-of-way, it must be separated into primary façade bays no greater than fifty (50) feet and secondary façade bays defined by a recess a minimum three feet deep and ten (10) feet wide.
 - b. A minimum one entrance shall be provided per one hundred fifty (150) linear feet along El Camino Real and per primary façade bay along all other rights-of-way.
 - c. The eave/roof of a secondary façade bay shall be no higher than the corresponding elements of the primary façade bay.



3. Horizontal Articulation. New façades and façade modifications along a street or civic space shall be designed to visually express a base, middle, and top.
- a. One or more of the following patterns shall be used to define the base:
 - i. Watertable: Base material extends from grade to between eight and fifty-four (54) inches above grade.
 - ii. Podium: The base material encompasses the lowest story (or stories) of the building, with or without mezzanine(s), and terminates in a sill, string course, or cornice at its upper bound (multi-story buildings only).
 - iii. Watertable and Cornice/String Course: A watertable using the base material is combined with a cornice or string course at the lowest story's upper bound, including any mezzanine (multi-story buildings only).
 - b. The top of each building mass/bay shall be defined by elements spanning the full length of the façade of the mass/bay. Such elements may include a cornice, eave and/or gable(s), or other elements listed under Section 17.50.170.B.6. These elements shall be consistent with the overall architectural style of the building mass/bay.

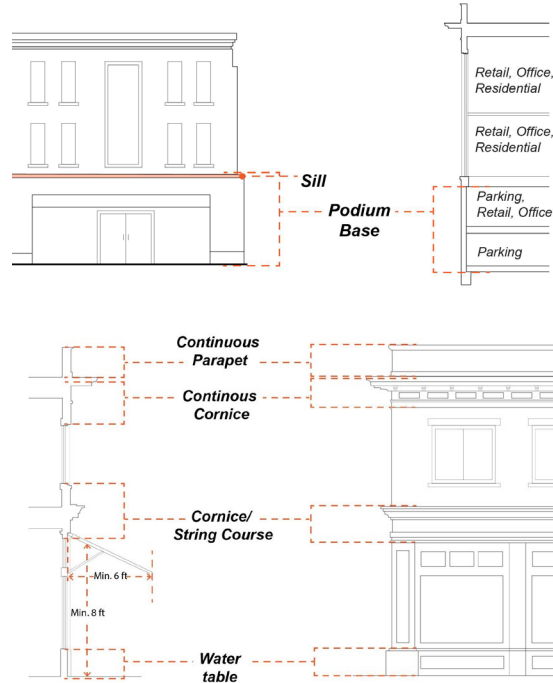

4. Adjacencies.

a. Façades Adjacent to an R-1 District.

- i. Building façade planes abutting an R-1 district may not exceed forty-eight (48) feet in width.
- ii. When a building façade abutting an R-1 district exceeds forty-eight (48) feet in width, it must be separated into façade bays no greater than forty-eight (48) feet by a recess ten (10) feet wide and fifteen (15) feet deep.
- iii. Balconies, roof decks and other habitable outdoor space are not allowed on upper-story façades abutting R-1 zones.
- iv. Sliding glass doors, French doors, and floor-to-ceiling windows are not allowed on upper-story façades abutting R-1 zones.

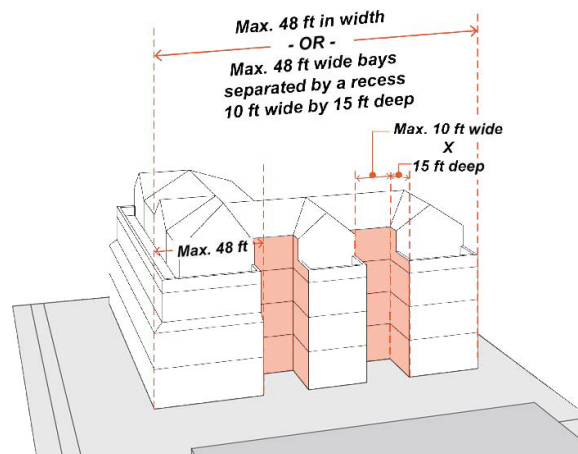

b. Storefront Façades Adjacent to Storefront Façades.

- i. The height of a storefront shall not differ from the height of any adjacent storefront by more than two feet.
- ii. The height of ground story shall not differ from height of any adjacent ground story by more than two feet.
- iii. Storefronts may transition in height using a module of twenty-five (25) feet in length along a right-of-way.

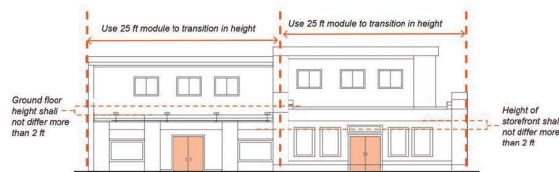

c. Compatibility with Adjacent Shorter Buildings with Height Difference of One Story or More. When adjacent to an existing shorter building with a height difference of one story or more, a proposed building must utilize two or more of the following strategies:

- i. Incorporate the uppermost floor into the roof form.
- ii. Break the mass of the building into smaller modules through changes in wall plane, setbacks, and/or height.
- iii. Match window heights and/or proportions.
- iv. Relate roof cornices and moldings at floor lines.

5. Privacy and Line of Sight.

- a. Primary living spaces and balconies located along a side setback shall orient principal windows and balconies toward the front and rear of the building.
- b. Where windows are within ten (10) feet of and oriented toward an interior side setback, glazing shall either be a minimum thirty (30) degree angle measured perpendicular to the adjacent side setback line, have minimum sill height of forty-two (42) inches, or be opaque.
- c. The maximum sill height for an ingress/egress window is forty-four (44) inches from finished floor.

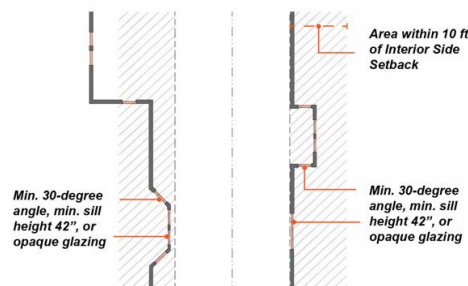

6. Roofline and Roof Design.

- a. Roof designs shall be limited to:
 - i. Hipped.

- ii. Gable.
- iii. Shed.
- iv. Dormer.
- v. Parapet.
 - (a) When used on the first or second floor, a parapet longer than twenty-five (25) feet in length must include at least one but not more than two of the following design elements to break up the length of the parapet:
 - (1) Steps.
 - (2) Curves.
 - (3) Angled surfaces.
 - (b) The length of a parapet segment on the third floor and above may not exceed twenty-five (25) feet.

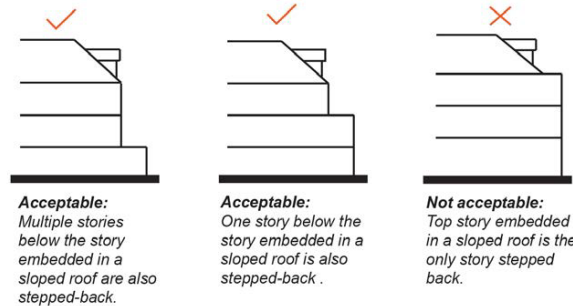

- b. When the top story is stepped back and embedded in a sloped roof form, the floor below must (and other floors may) be stepped back to meet the slope of the top story.
- c. Building façades facing an R-1 district must have a hipped or gable roof and may incorporate dormers.
- d. Roofline/parapet at corners shall not exceed roofline/parapet of adjacent wallplanes by more than twenty-four (24) inches.

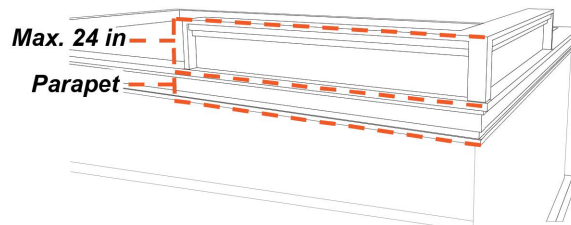

C. Building Design.

1. Façade Design.

- a. Building façades shall be arranged in an orderly composition of bays, defined by vertically aligned openings alternating horizontally with solid walls or columns. The pattern shall be visually expressed through the spacing of openings, recesses, eaves, inset panels, cornices, overhangs, trellises, exposed rafters, columns, or bay windows.

- b. The pattern may be shared between the ground floor and upper stories provided the ground floor exhibits enhanced detail or modulation.
 - c. Residential façades shall incorporate at least one element that signals habitation, such as bay windows, or balconies.
 - d. Non-glazed wall areas (blank walls) must be enhanced with architectural details, landscaping, and/or landscaped trellises or lattices.
2. Ground Level Transparency. A minimum sixty (60) percent of commercial ground floor street-facing façades between two and seven feet in height shall be transparent window surface. Opaque, reflective, or dark tinted glass is not allowed.

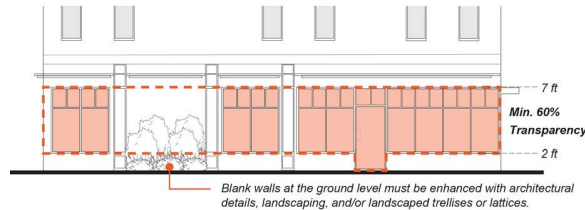

3. Pedestrian-Scaled Entrances.
- a. Buildings more than seventy (70) feet in length along a right-of-way must incorporate at least one forecourt frontage on the right-of-way-facing façade. Required forecourts must also comply with the standards of Section 14.50.170.C.3.b.v. below.
 - b. Each street-facing building façade must incorporate at one of the following entry features. See Section 14.66.275 (Entrance Type Standards) for design standards applicable to each entrance type listed.
 - i. Stoop.
 - ii. Shopfront.
 - (a) Shopfronts more than twenty-five (25) feet in width must incorporate variations in bulkhead, awnings, materials and/or color to visually articulate the shopfront into modules not to exceed twenty-five (25) continuous feet.
 - iii. Gallery.
 - iv. Arcade.
 - v. Forecourt.
 - (a) Forecourts must feature at least one entry to a shop and/or second floor use.
 - (b) The size of the forecourt must be appropriate relative to the size of the building. The maximum ratio of building height to forecourt is 2:1 (height < 2 x width).
 - (c) Forecourt must be minimum fifteen (15) feet in width.
 - (d) Forecourt must be enclosed on at least three sides by buildings.
 - (e) Forecourt must remain open to the sky (arbors and trellises are allowed).

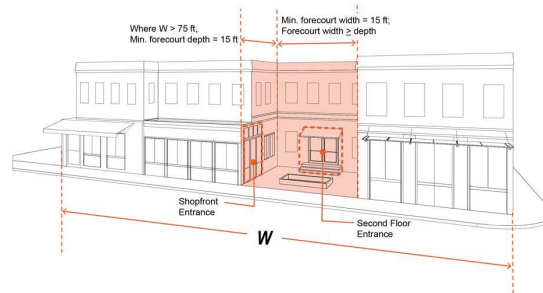

- vi. Terrace.
- c. Primary Entrance Location(s). Locate primary entrance on the front right-of-way.
- d. Individual Entries. Ground floor residential units facing a street must provide individual entries along the street frontage.
- e. Corner Entrances. Chamfered corners must incorporate a building entrance. Any required entrances may be provided on the corner of the building assuming one of the intersecting sides is a primary frontage.
- f. Street-facing Entries to Upper Floors. Street-facing entries to upper floors shall be equal in quality and detail to storefronts. This standard may be satisfied through two or more of the following:
 - i. Dedicated awning, canopy, or other roof element.
 - ii. Stairs with a single color applied to treads and a contrasting color or pattern applied to risers.
 - iii. Dedicated light fixture(s).
 - iv. Decorative street address numbers or tiles.
 - v. Plaque signs for upper-floor business tenants.
- g. Entry Protection. Primary street-facing entrances shall be protected by a recess in the building frontage at least three feet deep or by a projection extending outward at least three feet measured horizontally from the entrance, and wide enough to clear the building entryway on both sides.
 - i. Protection may be coterminous with an accent element.
 - ii. Protection may take the form of an extended eave, overhang, awning, door canopy, gallery, arcade frontage, or other element that provides shade and shelter from the elements.
 - iii. The lowest edge of a projecting awning or door canopy shall have a vertical clearance of no more than eight feet.
 - iv. Recessed entries shall differentiate pavement within the recess through the use of a dedicated paving material or pattern.

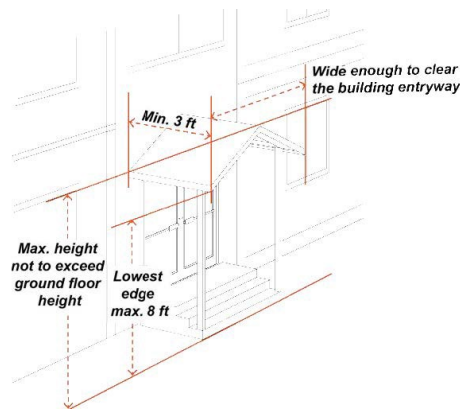

- h. Accent elements demarcating building frontage, entrance, and common open space areas shall not exceed the height of the ground floor story. Roof elements are excepted.
4. Ground Floor Floor-to-Ceiling Height.
- a. Minimum twenty-four (24) inches taller than typical upper floor floor-to-ceiling height where ground floor is non-residential.
 - b. Minimum twelve (12) inches taller than typical upper floor floor-to-ceiling height where ground floor is residential.



5. Interior Courtyard. Interior courtyards must be:
- a. Partially visible from the street and linked to the street by a clear accessible path of travel.
 - b. Enclosed on at least two sides by buildings.
 - c. Open to the sky (arbors and trellises are allowed).
 - d. A minimum width of twenty (20) feet and a minimum area of four hundred (400) square feet.
6. Paseos. Paseos must be:
- a. A minimum width of ten (10) feet for through-block paseos.
 - b. A minimum width of four feet for entries to courtyards or individual single businesses.
- D. Window Design. Vinyl windows are prohibited on façades visible from a right-of-way.
- E. Building Materials.
1. Primary shall mean fifty (50) percent or more of a façade surface area excluding transparent surfaces. Permitted primary cladding materials are limited to:
 - a. Stucco (minimum two-coat stucco; synthetic stucco or EIFS not allowed).
 - b. Siding (lap, vertical, panelized, or shingle).
 - i. All siding shall be wood, composite wood, or cement fiberboard.

- ii. Wood siding shall be painted or stained.
 - iii. Vinyl and aluminum siding are not permitted.
 - c. Stone.
 - d. Brick.
 - e. Concrete (board-form only).
 - 2. Secondary shall mean less than fifty (50) percent of a façade surface area excluding transparent surfaces. Permitted secondary cladding materials are limited to:
 - a. Stucco (minimum two-coat stucco; synthetic stucco not allowed, EIFS not allowed).
 - b. Siding (lap, vertical, panelized, or shingle).
 - i. All siding shall be wood, composite wood, or cement fiberboard.
 - ii. Wood siding shall be painted or stained.
 - iii. Vinyl and aluminum siding are not permitted.
 - c. Stone (building base only).
 - d. Brick (building base only).
 - e. Tile.
 - f. Metal (matte finish or Cor-ten).
 - i. Ribbed metal, titanium, and mirrored finishes are not permitted.
 - g. Concrete Masonry Units (watertable and building base only, and not allowed on any façade facing a right-of-way or a single-family zone).
 - h. Concrete (building base only, board-form only, cast concrete not permitted).
 - 3. On attached elements, such as bay windows, orioles, and balconies.
- F. Ground Level Open Space. Where any required front, rear, or side yard setback is ten (10) feet or greater, on-site ground-level open space shall be provided within the setback.
- 1. The ground level open space shall be usable and accessible.
 - 2. The minimum dimension for ground level open space shall be eight feet.

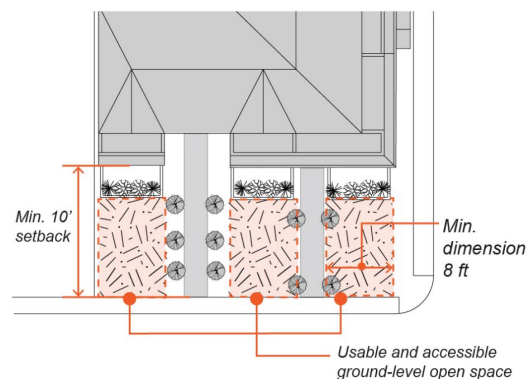

G. Landscaping and Paving.

1. Landscaping must be placed on each side of a driveway at grade or in raised planters.
2. Landscape elements shall be integrated with the building architecture, parking, and streetscape. Recommended patterns shall include, but are not limited to:
 - a. Planters for flowers and shrubs within street frontage.
 - b. Landscape buffers between parking spaces and building façades.
 - c. Landscaping within and/or on walls adjacent to courtyards, open spaces, and setbacks.
3. See Sections 14.66.180 (Maintenance of Landscaped Areas) and 14.70.070 (Landscaped Strips) for additional landscaping standards.

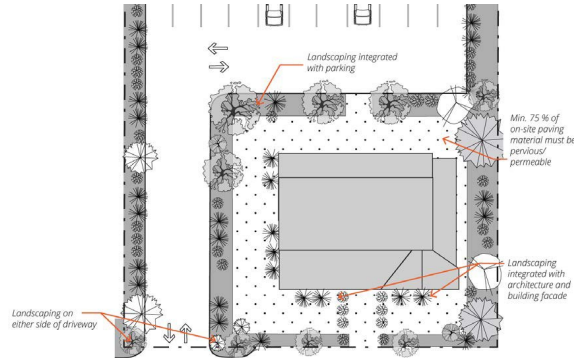

H. Parking Design and Access.

1. Where structured parking is provided, the parking area must be either:
 - a. "Lined" with ground-floor non-residential uses at least thirty (30) feet deep as measured from the front façade; or

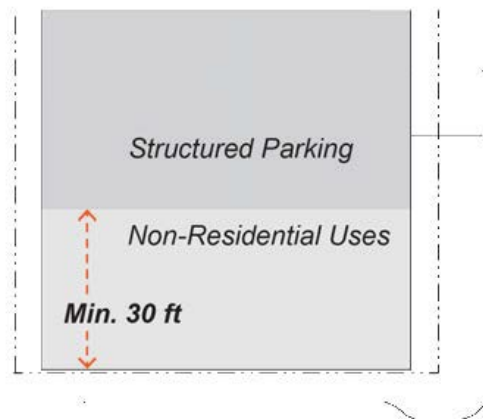

- b. Designed such that the floor elevation is a minimum four vertical feet below the elevation of the adjacent sidewalk.

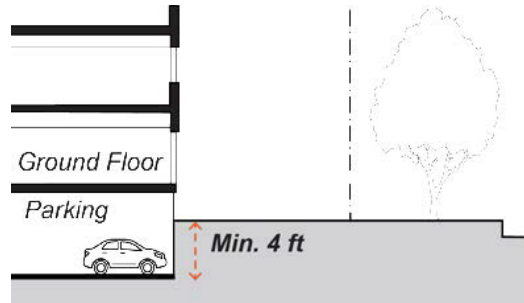

2. Visible structured parking must be screened from view from the right-of-way by at least one of the following features:
 - a. Regular punched openings designed to resemble windows of habitable spaces.
 - b. Trellis/living wall.
 - c. Custom textured or decorative screening.
 3. Entrances to Parking Facilities.
 - a. A maximum of two curb cuts for one-way traffic and one curb cut for two-way traffic may be permitted per street frontage per lot.
 - b. Controlled entrances to parking facilities (gates, doors, etc.) shall be located a minimum ten (10) feet from the back of sidewalk.
 - c. Entrances to parking facilities along a street frontage shall be separated by a minimum of sixty (60) feet.
 - d. Where possible, curb cuts serving adjacent parking facilities shall be shared.
- I. Site Circulation and Access.
1. New development on abutting lots shall be designed to allow cross-access for internal pedestrian, bicycle, and vehicular circulation systems.
 2. Bicycle racks shall be provided:
 - a. In or within fifty (50) feet of every parking area; and
 - b. Within twenty (20) feet of at least one building entrance.
- J. Service Areas and Screening.
1. Service areas must be located at the rear of lot.
 2. Service areas must be enclosed in enclosures that are architecturally consistent with primary building in terms of materials, colors, and style.
- K. Additional Design Standards. See Section 14.66.280 for additional design standards applicable to all residential mixed-use development in the CT District.

(Ord. 04-259 § 1 (part))

(Ord. No. 2017-436 , § 1, 10-10-2017; Ord. No. 2021-478 , § 1, 9-14-2021)

Editor's note(s)—See Editor's Note § 14.50.150.

14.50.180 Off-street loading for residential (CT).

In order to accommodate the delivery or shipping of goods at a multiple-family residential project, on-site loading/unloading space shall be provided:

- A. There shall be at least one loading/unloading space provided, which shall have minimum dimensions of at least ten (10) feet by twenty-five (25) feet, with fourteen (14) feet of vertical clearance;
- B. Loading and unloading spaces shall be located and designed so that the vehicles intended to use them can maneuver safely and conveniently to and from a public right-of-way without interfering with the orderly movement of traffic and pedestrians on any public way and complete the loading and unloading operations without obstructing or interfering with any parking space or parking lot aisle;
- C. No area allocated to loading and unloading facilities may be used to satisfy the area requirements for off-street parking, nor shall any portion of any of off-street parking area be used to satisfy the area requirements for loading and unloading facilities;
- D. A loading/unloading space may be located in the front yard setback, but shall comply with other required setbacks;
- F. All loading spaces shall be designed and maintained so that vehicles do not back in from, or onto, a public street;
- G. Loading spaces shall be striped indicating the loading spaces and identifying the spaces for "loading only." The striping shall be permanently maintained by the property owner/tenant in a clear and visible manner at all times; and
- H. Adequate signage shall be provided that directs delivery vehicles to the loading space.

(Ord. No. 2017-436 , § 1, 10-10-2017)

Editor's note(s)—See Editor's Note § 14.50.150.

14.50.190 Signs (CT).

As provided in Chapter 14.68 of this code.

(Ord. 04-259 § 1 (part); Ord. No. 2015-414, § 12, 9-8-2015; Ord. No. 2017-436 , § 1, 10-10-2017)

Editor's note(s)—See Editor's Note § 14.50.150.

14.50.200 Fences (CT).

As provided in Chapter 14.72 of this title.

(Ord. 04-259 § 1 (part))

(Ord. No. 2017-436 , § 1, 10-10-2017)

Editor's note(s)—See Editor's Note § 14.50.150.

14.50.210 Nonconforming use regulations (CT).

As provided in Chapter 14.66 of this title.

(Ord. 04-259 § 1 (part))

(Ord. No. 2017-436 , § 1, 10-10-2017)

Editor's note(s)—See Editor's Note § 14.50.150.