



June 30, 2021

Mr. Matt Cribbs, Captain
Levy County Department of Public Safety
Public Safety Complex 1251 NE CR343
Bronson, FL 32621

We are pleased to provide you with the following pricing, up fit list, shop order, and drawings for the purchase of two (2) new 2022 Ford F-550 Custom AEV Type I ambulances. Pricing is based on purchasing these units off the Florida Sherriff's Contract Bid# FSA20-VEF14.01 Specification #01- Type I Ambulance.

TOTAL PRICE:

- FSA base unit bid price F550 AEV Type I \$168,358.00
- Required options to meet the needs of Levy County Public Safety .. \$ 50,101.00
- Total price per unit \$218,459.00
- Total price for two (2) units \$436,918.00
- Included in above price – air fare, lodging, and meals for 2 people to go to factory for midline, final inspection, and see attached upfit list of additional items to be provided and or installed by ETR, AEV, and Customer.
- Note: above price is good to July 23, 2021
- Terms: Payment in full is due upon the delivery of each completed vehicle. Upon payment, ETR,L.L.C. shall furnish the purchaser a "Statement of Origin" or the necessary validated documents required for title application.

Sincerely,

Fred Joseph
Regional Sales Manager
ETR, L.L.C.

Corporate Office: 212 Hickman Drive Sanford, FL 32771 | T 407-339-6737 Toll Free 1-884-612-8148
Georgia Office: Juliette, GA. 31046 | Toll Free 1-884-612-8148

"17 YEARS OF RESPONDING TO YOUR NEEDS"

www.ETRVEHICLES.com

UPFIT List LEVY COUNTY UNITS

| UPFIT List LEVY COUNTY UNITS | | | |
|-------------------------------------|---|--------------------|---------------------|
| Customer | EST # | Date: | 6/29/2021 |
| Levy Co (FL) | | | |
| Upfit Item | Description | Supplied By | Installed By |
| 1 Graphics | Graphics installation as per approved proof | ETR | ETR |
| 2 Stryker Power Load | Install Used Stryker Power Load | Customer | ETR |
| 3 Window Tinting | Install Tint on Cab/Chassis windows and front strip for windshield. | ETR | ETR |
| 4 EMS Stat Pack | EMS Statpacks G3 Back up. SKU:G35006RE | ETR | Shipped Loose |
| 5 Pactools holders | Install tool holder (Does not include tools) bolt cutter, tool brackets | ETR | ETR |
| 6 KATZKIN Brand Seat Covers | Install Seat Covers. Color to match interior. | ETR | ETR |
| 7 Fire extinguisher & SCBA brackets | install 2 extinguishers and 2 SCBA brackets | ETR | ETR |
| | | | |
| | | | |



Shop Order

ETR
Fred Joseph

Levy County BOCC
355 South Court Street
Bronson, FL 32621

Exp. Date: 07/14/2021
 Quote No: 98-0052
 GENERAL: Gen Info *****BID STANDARDS*****
 CHASSIS: F-4/550LB *****F-Series 108ca CHASSIS*****
 CONVERSION: 172T1LWBF 172 x 95 T-1 LWB Ford Mod Body, Conversion
 BASE: 172T1LWBF 172 x 95 T-1 LWB Ford Base Price

| 06/23/2021 | | Job/Order No: Proposal | | Page 1 |
|-------------------|---------------|--|----------|--------|
| PART NO | S | DESCRIPTION | QTY | |
| 00-00-0107 | | -- Order Date: Post July 1, 2019 | 1 | |
| 00-00-0113 | < | -- Ambulance Built to Star Of Life KKK-A-1882-F Certification, Latest Revision Exceptions to be noted on final sticker. | 1 | |
| 00-10-0015 | S | Vehicle Quantity (2 Vehicles) | 1 | |
| 00-91-0002 | | BODY NUMBER: | 1 | |
| 00-91-0005 | | -- MICKEY BODY DUE DATE : | 1 | |
| 00-91-0003 | | CHASSIS VIN NUMBER: | 1 | |
| 00-91-0024 | | ACCOUNT MANAGER: Mikael Blevins | 1 | |
| 00-91-0027 | S | REFERENCE UNIT #: 19OF 24888-90G | 1 | |
| 00-91-0028 | S | RE-WRITE DATE : 6-14-21 | 1 | |
| 00-91-0040 | | SEAT BELT POSITIONS MODS | 1 | |
| 00-91-0042 | | -- CAB SEAT BELT MOD: | 1 | |
| 00-91-0044 | | -- Total: 2 Positions | 1 | |
| 00-91-0050 | | -- REAR SEAT BELT MOD: | 1 | |
| 00-91-0052 | | -- Total: 3 Positions | 1 | |
| 00-99-9000 | | Revision Level: 0 - Zero - ORIGINAL VERSION | 1 | |
| 00-99-9030 | | Change Order Level: 0 - Zero - ORIGINAL VERSION | 1 | |
| 01-1F-0000 | | Type I AEV Traumahawk Modular Ambulance | 1 | |
| 01-AR-2F48 | | 2022 Ford, F-550 4 x 2 DRW Reg Cab F5G 193" WB, XLT V8 Gasoline | 1 | |
| 01-1F-0091 | < | -- Engine: 7.3L Gasoline V-8 - F-series Ambulance approved Engine hour meter display through message center | 1 | |
| 01-1F-0092 | | -- Chassis Front engine hood Insulation Not included by OEM Ford on all XLT | 1 | |
| 01-1F-TORQ | S < | -- Transmission: Ford Torque shift, 10 Speed Automatic (F-series) 2020+ NOTE: Set Top Speed to 80 MPH | 1 | |
| 01-1F-0100 | | -- OEM Installed Engine Block Heater: Included on Chassis Not connected | 1 | |
| 01-1F-02CM | | -- Cab Interior Color: Medium Earth Gray F-series | 1 | |
| 01-1F-02T5 | | -- F-Series 193" wheelbase reg cab LWB | 1 | |
| 01-1F-03PU | | -- GVWR: 18,000 pounds, FAWR: 7,000, RAWR: 13,660 (4x2) | 1 | |
| 01-1F-047A | | -- 47A - Ambulance Prep Package - F-Series | 1 | |

| PART NO | S | DESCRIPTION | QTY |
|------------|------|---|-----|
| 01-OE-47A4 | | -- Throttle: Ford High Idle | 1 |
| 01-1F-0502 | | -- Alternator: Dual Extra heavy duty Alternator OEM Total 397Amp | 1 |
| 01-1F-0507 | | -- Battery; OEM Dual 750 CCA, 78 Amp Hours | 1 |
| 01-FL-TI06 | | -- Tire, SPARE: Matching, Random Make | 1 |
| 01-FM-TI01 | | -- Location: Shipped Loose | 1 |
| 01-TU-0112 | | -- Jack and Tire Tools: Install behind Passenger's seat | 1 |
| 01-FM-4WH3 | | -- Wheel Finish: Polished SS Wheel Simulators (F-550) | 1 |
| 01-FM-DL01 | | -- Cab Door Locks: Power XLT- Auto Lock,Auto Unlock Standard | 1 |
| 01-FM-DTRL | | -- Daytime Running Lights: Ford OEM | 1 |
| 01-FM-DTRQ | | -- Ford F series High center mount brake light ordered with chassis | 1 |
| 01-FM-TIR3 | | -- Tires: F-4/550, All season, Random Mk 225/70 R19.5, LR F | 1 |
| 01-RR-05B6 | | -- Radio, F-series: OEM AM/FM/Satellite w/ 5 cab speakers 8" Display 2020 + | 1 |
| 01-SY-0005 | | -- Ford SYNC 3 Voice Activated, in vehicle connectivity 913 2020 XLT std- all | 1 |
| 01-SZ-0006 | < | -- , Backup Camera fixed system 872 Ford OEM install on module OEM camera with no weather shield, adjustable position, Displays into OEM Radio | 1 |
| 03-EA-47PR | | -- Side Mirrors, OEM (F-Series), Pwr Glass, Heated, manual Telescopic | 1 |
| 04-SU-1101 | | -- Ford OEM Front Suspension Coil Spring Std F-450/550 | 1 |
| 04-SU-1729 | < | -- Rear Suspension: F-550 Liquid Spring, 2017+ *NOTE: If Oxygen Lift is installed, then if the O2 Cmpt Door is open, the kneeling suspension will not dump until door is closed* Part: SUSP-DS147FS3 Rated for 13,660 GAWR | 1 |
| 01-TT-0208 | < | -- "DETAIL" Liquid Rear Suspension Decal Install Prior to delivery, detail department is to install a Black Decal on the dash: | 1 |
| 04-SU-0601 | | -- Kneeling Feature: Enable Switch Located in CAB console | 1 |
| 04-SU-0610 | | -- Kneeling Feature: Activated by TRAILING rear access door | 1 |
| 04-SU-0651 | | -- Exhaust system termination point: OEM Location, Rt Rear | 1 |
| 04-SU-2025 | | -- Liquid spring controller installed on dash, left of steering column on ford F | 1 |
| 04-SU-03F6 | | -- Rear Stabilize (Anti-Sway) Bar: OEM, Ford F-450/550 | 1 |
| ZZ-ZZ-ZZZZ | | | 1 |
| | | BODY Generation 9 | 1 |
| 01-X0-0001 | < | -- Body Certification Provided to Specification The Body Manufacturing group certifies that this Ambulance Modular body has been constructed of materials and methods that meet or exceed the standards as required by the AEV Generation 9 Body Specification of December 11th, 2018 as published. The body shall be built and constructed to the submitted work order and the AEV Generation 9 build standards without exception. Any Deviations to the work order or Generation 9 build standards must have written authorization prior to body delivery to AEV by the AEV Body Engineer on file. | 1 |
| 02-00-0002 | XS < | -- Body Build Information Body Number; Account Manager; Mikael Blevins Chassis Type : 2022 Ford, F-550 4 x 2 DRW Reg Cab F5G 193" WB, XLT V8 Gasoline Mickey Body Due Date; Rear Suspension: F-550 Liquid Spring, 2017+ | 1 |
| 02-00-0003 | < | -- ALL DIMENSIONS ON ORDER WILL HAVE A VARIABLE OF + OR - 1/4" Unless specified as a minimum dimension. | 1 |
| 02-B2-1096 | | Body, Mod: Type 1 LWB, 172" x 95" x 72" Interior HR - 6" Body Drop F | 1 |
| 02-00-0006 | | -- Headroom: 74/72" Finished Interior - Ducted A/C | 1 |
| 02-00-0060 | | -- Compartment and Entry door Full length Stainless Steel Hinges std | 1 |
| 02-B0-CC01 | < | -- Compartment Construction: STANDARD, Unless Specified Otherwise Sides and Back: .100 Polished Aluminum Diamond Plate Compartment Ceiling: .090 Aluminum Sheet | 1 |

| PART NO | S | DESCRIPTION | QTY |
|------------|-----|---|-----|
| 02-B0-SFL0 | < | -- Compt Floors: Sweep-out, even with bottom door jamb Unless Specified Otherwise. | 1 |
| 02-B0-CC41 | | -- Compartment floor thickness .125" standard | 1 |
| 02-B0-CC18 | | -- Compartment Ventilation - Flap style #VT-2495-A01, STD | 1 |
| 02-BC-0604 | | -- Talk through, Cab to Mod Window (T1) With Sliding Window 2020+ F | 1 |
| 02-BD-0100 | | -- Body Drop: 6" Curbside, Ahead of Rear Wheels | 1 |
| 02-M1-CE05 | | -- Curb side Entry Door (CSE): 82.812 High x 31 Wide T1 LWB | 1 |
| 02-B0-09B0 | | -- Compt Door Check: Double Action Gas Shock | 1 |
| 04-EA-09B1 | | -- Door Swing Angle: Set to 90-100 degrees | 1 |
| 02-B0-CESL | | -- Curbside Entry Door (CSE) Location: Standard, Rearward of M-7 Compt if Optioned | 1 |
| ZZ-ZZ-ZZZZ | | -- | 1 |
| 02-B1-SW8E | S < | -- Step Well, CURBSIDE Entry, T1 LWB 2-Step w 6" Drop DP, Elongated for Portable O2 This stepwell for Type 1 Long Wheelbase chassis cab with 6inch forward drop skirt on the curbside. 2 step entry, elongated with chamfer edge 2nd step. recess will fit up to (2) QR-D-2 bracket in height. Reference Drawing 02-B1-SW83 | 1 |
| 05-IL-09SN | S < | -- ILOS Light, Step Well: Kinequip #KML-W-SC, White LED, Chrome Bezel Light shall come on with CS door and timer Mount on upper step on right hand side | 1 |
| 05-IL-09XE | S < | -- IATS Light, Step Well: Kinequip #KML-W-SC, LED, Chrome Bezel Light shall come on with CS door and timer Mount on upper step on left hand side | 1 |
| ZZ-ZZ-ZZZZ | | -- | 1 |
| 02-M1-M169 | < | -- M-1 Compt (LF): 72 HR, 61.5" H x 22.125" W x 19.5" D w/M1a compartment Splash Shield: Add a deflector plate between M-1 and M-2 to shield water splash from the compartment louvers. | 1 |
| 02-B0-CC02 | < | -- Compartment Construction: STANDARD Diamond Plate Sides and Back: .100 Polished Aluminum Diamond Plate Compartment Ceiling: .090 Aluminum Sheet | 1 |
| 02-B0-CC08 | | -- Compartment Door Panel: Diamond Plate | 1 |
| 12-DC-GA10 | | -- Compartment Finish: Diamond Plate Standard | 1 |
| 02-B0-CC16 | | -- Compartment Door Ventilation - small punched half-moon Louvered Door | 1 |
| 02-B0-SWFL | | -- Compt Floor: Sweep-out, even with bottom door jamb. | 1 |
| 02-B0-CC41 | | -- Compartment floor thickness .125" standard | 1 |
| 02-BC-10A5 | | -- Compartment Door: SINGLE DOOR, Forward hinged 2-point Latch | 1 |
| 02-B0-09B0 | | -- Compt Door Check: Double Action Gas Shock | 1 |
| 04-EA-09B1 | | -- Door Swing Angle: Set to 90-100 degrees | 1 |
| 05-EL-4M36 | S < | -- Light, Compartment: (2) Maxxima LED 36" , EA, ILOS MTB Note: No light hole required Mount one on wall #1 near door jamb centered top to bottom Mount one on wall #3 near door jamb centered top to bottom | 2 |
| 08-B1-02LI | | -- Prep for 02 Lift: NONE | 1 |
| 09-ZZ-ZZZZ | | -- | 1 |
| 02-B1-M1BB | | -- M-1a Compt (LF Upper): 72 HR, 17.56" H x 22.125" W x 19.5" D | 1 |
| 02-B0-CC02 | < | -- Compartment Construction: STANDARD Diamond Plate Sides and Back: .100 Polished Aluminum Diamond Plate Compartment Ceiling: .090 Aluminum Sheet | 1 |
| 02-B0-CC08 | | -- Compartment Door Panel: Diamond Plate | 1 |
| 12-DC-GA10 | | -- Compartment Finish: Diamond Plate Standard | 1 |
| 02-B0-CC1B | S < | -- Compartment Ventilation - M-1A Pancake Fan & 1-Column of Louvers NOTE: Pancake Fan to be Wired Ignition Hot | 1 |

| PART NO | S | DESCRIPTION | QTY |
|------------|-----|---|-----|
| 02-B0-SWFL | | -- Compt Floor: Sweep-out, even with bottom door jamb. | 1 |
| 02-B0-CC41 | | -- Compartment floor thickness .125" standard | 1 |
| 02-BC-10A0 | | -- Compartment Door: SINGLE DOOR, 1-point Latch | 1 |
| 02-B0-09B0 | | -- Compt Door Check: Double Action Gas Shock | 1 |
| 04-EA-09B1 | | -- Door Swing Angle: Set to 90-100 degrees | 1 |
| 05-EL-40NB | < | -- Light, Compt, LED, M-1A (LF Upper): Intertek Model No ZY-156-LEDC, | 1 |
| | | ILOS | |
| | | MTB Note: 1" Hole, Centered in Compartment ceiling | |
| 12-ZZ-ZZZZ | | -- | 1 |
| 02-M1-M275 | S | -- M-2 Compt (LFM): 35" H x 49.75"W X 19.5" D | 1 |
| 02-B0-CC02 | < | -- Compartment Construction: STANDARD Diamond Plate | 1 |
| | | Sides and Back: .100 Polished Aluminum Diamond Plate | |
| | | Compartment Ceiling: .090 Aluminum Sheet | |
| 02-B0-CC08 | | -- Compartment Door Panel: Diamond Plate | 1 |
| 12-DC-GA10 | | -- Compartment Finish: Diamond Plate Standard | 1 |
| 12-DC-GA10 | X < | -- MTB: Reinforce Wall #2 for SCBA Brackets to be Installed | 1 |
| | | MTB NOTE: Reinforce Wall #2 for SCBA Brackets to be Installed | |
| 02-B0-SWFL | | -- Compt Floor: Sweep-out, even with bottom door jamb. | 1 |
| 02-B0-CC41 | | -- Compartment floor thickness .125" standard | 1 |
| 02-BC-10D0 | | -- Doors, Compartment, DOUBLE DOORS (std) | 1 |
| 02-B0-09B0 | | -- Compt Door Check: Double Action Gas Shock | 1 |
| 04-EA-09B1 | S < | -- Door Swing Angle: Set to Open As Far As Possible | 1 |
| | | NOTE: Set Doors to Open As Far As Possible Even if M1 and M2.5 Door Will Not Open. | |
| 04-TS-2100 | S < | -- Tray, Roll-out: Std Duty .125 Thick tray, Fixed position | 1 |
| | | three inch up-turned sides with stam-pro installed on upper edge | |
| | | NOTE: Install Pull Out Tray ___" Above Floor to Bottom of Tray. | |
| 04-TS-21A2 | < | -- Slides: Pair of Accuride AH760 250 lb 18" Full Extension with Right-side locking | 1 |
| | | One locking slide with yellow thumb catch release | |
| | | (1) SLID-9301 Non-locking | |
| | | (1) SLID-9308 Right side locking Right side typical 18" | |
| 05-EL-4M24 | S < | -- Light, Compartment: (2) Maxxima LED 24", EA, ILOS | 2 |
| | | MTB Note: No light hole required | |
| | | Mount one on wall #1 near door jamb centered top to bottom | |
| | | Mount one on wall #3 near door jamb centered top to bottom | |
| 05-HB-1310 | < | -- Condenser, 12V: Pro -Air Dual Fan, FRKG 126 Front of Body over Cab | 1 |
| | | 70,000 BTU | |
| 04-HA-1310 | < | -- ARCTIC WEDGE Front of Body | 1 |
| | | part #WEDGE-HVAC | |
| | | >>> No Pre-drilled light holes. | |
| | | Use of the wedge is subject to engineering review and approval for Light duty Type III models. A reduction in light sizing above the wedge may be required. | |
| 04-HA-1360 | | -- No warning lights installed on Artic Wedge, Brand Sticker Not Required | 1 |
| 12-B0-0002 | | -- Painted Part- Painted White YZ Std | 1 |
| 05-IL-09XE | S < | -- Additional Lights: (2) Kinequip #KML-W-SC, LED, Chrome Bezel | 2 |
| | | Light shall come on with M2 Doors Open | |
| | | Mount (1) Light on Wall #1 Up High and (1) on Wall #3 Up High | |
| 06-RR-1320 | S < | -- Standard Conduit: 2", with pull wire | 1 |
| | | NOTE: Cut Access Hole From Back Wall of M2A to go Behind A/A. | |

| PART NO | S | DESCRIPTION | QTY |
|------------|-----|---|-----|
| 06-RR-1304 | S | -- CONDUIT ORIGINATION POINT: M-1A compartment | 1 |
| 06-RR-13T3 | | -- CONDUIT TERMINATION POINT: Behind A/A Board (Panel) | 1 |
| 06-RR-13Z1 | S | -- Conduit #2 2" diameter, with pull wire, Type 1 units Std | 1 |
| 06-RR-13O1 | S | -- CONDUIT ORIGINATION POINT: M2A Electrical Circuit board | 1 |
| 06-RR-13T2 | S | Compartment -- CONDUIT TERMINATION POINT: Behind Passenger seat | 1 |
| 09-ZZ-ZZZZ | | -- | 1 |
| 02-M1-M296 | S < | -- M-2A Compt (LWW): 22.3" H x 37" W x 6" D Exterior Electrical To Have Yellow Strap Installed on Door Panel Inside to Assist With Closing. | 1 |
| 02-B0-CC02 | < | -- Compartment Construction: STANDARD Diamond Plate Sides and Back: .100 Polished Aluminum Diamond Plate Compartment Ceiling: .090 Aluminum Sheet | 1 |
| 02-B0-CC08 | | -- Compartment Door Panel: Diamond Plate | 1 |
| 12-DC-GA10 | | -- Compartment Finish: Diamond Plate Standard | 1 |
| 02-B0-CC16 | | -- Compartment Door Ventilation - small punched half-moon Louvered Door | 1 |
| 02-B0-SWFL | | -- Compt Floor: Sweep-out, even with bottom door jamb. | 1 |
| 02-B0-CC41 | | -- Compartment floor thickness .125" standard | 1 |
| 02-BC-10C1 | < | -- Door, Compartment, SINGLE DOOR, 2-point Latch ILOS Top Hinged Gas strut hold opens on both sides to lift door. Nylon strap installed on foot man loop to aid in closing door after opened. | 1 |
| 02-B0-09B0 | | -- Compt Door Check: Double Action Gas Shock | 1 |
| 04-EA-09B1 | | -- Door Swing Angle: Set to 90-100 degrees | 1 |
| 05-EL-4M18 | S < | -- Light, Compartment: Maxxima LED 18" , EA, ILOS MTB Note: No light hole required Mount on Ceiling near door jamb centered side to side | 1 |
| 06-RR-NFAN | S < | -- Cooling Fan : Mounted inside Electrical Compartment, for cooling purposes FANS-19 & #GUAR-19) Installed to Push/Pull Hot Air Out of Compartment to Prevent Overheating. Wire Fan Ignition Hot | 1 |
| ZZ-ZZ-ZZZZ | | -- | 1 |
| 09-ZZ-ZZZZ | | -- | 1 |
| 02-M1-M294 | S < | -- M-2.5 Compt (LWW): 10.5" H x 30.25" W x 19.5" D Cannot have a flip down CPR seat. Fixed pad only. Deletes interior Cab F. | 1 |
| 02-B0-0005 | S < | -- Door Strap & Foot man loops Kit per module body door (2) STRA-DOOR Door strap kit for Seat belt style door strap, installed with Footman loops. (2) foot man loops in each end of the strap mounted to the door and the module to hold door at 90 degrees. | 2 |
| 02-B0-CC02 | < | -- Compartment Construction: STANDARD Diamond Plate Sides and Back: .100 Polished Aluminum Diamond Plate Compartment Ceiling: .090 Aluminum Sheet | 1 |
| 02-B0-CC08 | | -- Compartment Door Panel: Diamond Plate | 1 |
| 12-DC-GA10 | | -- Compartment Finish: Diamond Plate Standard | 1 |
| 02-B0-SWFL | | -- Compt Floor: Sweep-out, even with bottom door jamb. | 1 |
| 02-B0-CC41 | | -- Compartment floor thickness .125" standard | 1 |
| 02-BC-10F0 | | -- Door, Compt, SINGLE DOOR, 1-pt Latch, Hinge Bottom | 1 |
| 05-EL-4M18 | S < | -- Light, Compartment: Maxxima LED 18" , EA, ILOS MTB Note: No light hole required Mount on Ceiling Near Door Jamb | 1 |

| PART NO | S | DESCRIPTION | QTY |
|------------|-----|---|-----|
| 09-ZZ-ZZZZ | | -- | 1 |
| 02-M1-M379 | S | -- M-3 Compt (LR): 61.5" H x 32" W x 19.5" D | 1 |
| 02-B0-CC02 | < | -- Compartment Construction: STANDARD Diamond Plate Sides and Back: .100 Polished Aluminum Diamond Plate Compartment Ceiling: .090 Aluminum Sheet | 1 |
| 02-B0-CC08 | | -- Compartment Door Panel: Diamond Plate | 1 |
| 12-DC-GA10 | | -- Compartment Finish: Diamond Plate Standard | 1 |
| 02-B0-CC16 | | -- Compartment Door Ventilation - small punched half-moon Louvered Door | 1 |
| 02-B0-SWFL | | -- Compt Floor: Sweep-out, even with bottom door jamb. | 1 |
| 02-B0-CC41 | | -- Compartment floor thickness .125" standard | 1 |
| 02-BC-10A5 | | -- Compartment Door: SINGLE DOOR, Forward hinged 2-point Latch | 1 |
| 02-B0-09B0 | | -- Compt Door Check: Double Action Gas Shock | 1 |
| 04-EA-09B1 | | -- Door Swing Angle: Set to 90-100 degrees | 1 |
| 04-TS-11B4 | S < | -- (2) Shelves, Adjustable, Ext: .125 Aluminum, 2" Upward Lips IATS NOTE: Mount Adj. Shelves Evenly Spaced in Compartment | 1 |
| 04-TS-4010 | | -- Shelf Bracket: CPI 90 Deg with Slotted Holes | 2 |
| 05-EL-4M36 | S < | -- Light, Compartment: (2) Maxxima LED 36" , EA, ILOS MTB Note: No light hole required Mount one on wall #1 near door jamb centered top to bottom Mount one on wall #3 near door jamb centered top to bottom | 2 |
| 09-ZZ-ZZZZ | | -- | 1 |
| 02-M1-M575 | S < | -- M-5 Compt (RR): 72 HR, 82.8" H x 21" W x 21.0"D NOTE: Box Off in Upper Right Corner for 125 Heater | 1 |
| 02-B0-CC02 | < | -- Compartment Construction: STANDARD Diamond Plate Sides and Back: .100 Polished Aluminum Diamond Plate Compartment Ceiling: .090 Aluminum Sheet | 1 |
| 02-B0-CC08 | | -- Compartment Door Panel: Diamond Plate | 1 |
| 12-DC-GA10 | | -- Compartment Finish: Diamond Plate Standard | 1 |
| 02-B0-CC12 | < | -- Compartment Ventilation - Compartment Ceiling O O O O MTB NOTE: hat channel with three (4") holes above the hat at the ceiling level. | 1 |
| 02-B0-CC16 | | -- Compartment Door Ventilation - small punched half-moon Louvered Door | 1 |
| 02-B0-SWFL | | -- Compt Floor: Sweep-out, even with bottom door jamb. | 1 |
| 02-B0-CC41 | | -- Compartment floor thickness .125" standard | 1 |
| 02-B1-BIOX | S < | -- Diamond Plate Closeout for Interior 125 Heater Dogleg for interior 125 Heater in Upper Right Corner of M5 Compartment. | 1 |
| 02-BC-10A5 | | -- Compartment Door: SINGLE DOOR, Forward hinged 2-point Latch | 1 |
| 02-B0-09B0 | | -- Compt Door Check: Double Action Gas Shock | 1 |
| 04-EA-09B1 | S < | -- Door Swing Angle: Set to Open As Far As Possible NOTE: Set Door to Open As Far As Possible Even if M6 Door Will Not Open. | 1 |
| 04-TS-20M5 | S < | -- M-5 Divider, Fixed, (1) 14x60 H, (1) Fixed Shelf, Option #5 Mount Divider 10" From Wall #1 With Bottom of Fixed shelf to be 42" from the compartment floor. Backboards & Scoop Stretcher to the Left of Divider & Stair Chair to the Right of Divider. | 1 |
| 04-TS-1001 | | -- Divider Material: .125 Aluminum Sheet | 1 |
| 04-TS-1200 | S < | -- M-5 Shelf, Adjustable, Ext: .125 Aluminum, Partial Width 2" lips upward Adj. Shelf From Divider to Wall #3 Above Fixed Shelf | 1 |
| 04-TS-4010 | | -- Shelf Bracket: CPI 90 Deg with Slotted Holes | 1 |
| 04-TS-20RB | S < | -- Retainer Bar: Installed In Exterior Compartment Each Install Retainer Bar From Wall #1 to Divider 69" Up From Compartment Floor to Top of Retainer Bar. | 1 |
| 05-EL-4M36 | S < | -- Light, Compartment: (2) Maxxima LED 36" , EA, ILOS MTB Note: No light hole required Mount one on wall #1 near door jamb centered top to bottom | 2 |

| PART NO | S | DESCRIPTION | QTY |
|------------|-----|--|-----|
| | | Mount one on wall #3 near door jamb centered top to bottom | |
| 09-ZZ-ZZZZ | | -- | 1 |
| 02-M1-M675 | S | -- M-6 Compt (RRFwd): 19" H x 11.5" W x 19.5" D | 1 |
| 02-B0-CC02 | < | -- Compartment Construction: STANDARD Diamond Plate Sides and Back: .100 Polished Aluminum Diamond Plate Compartment Ceiling: .090 Aluminum Sheet | 1 |
| 02-B0-CC08 | | -- Compartment Door Panel: Diamond Plate | 1 |
| 12-DC-GA10 | | -- Compartment Finish: Diamond Plate Standard | 1 |
| 02-B0-SWFL | | -- Compt Floor: Sweep-out, even with bottom door jamb. | 1 |
| 02-B0-CC41 | | -- Compartment floor thickness .125" standard | 1 |
| 02-BC-10A0 | | -- Compartment Door: SINGLE DOOR, 1-point Latch | 1 |
| 02-B0-09B0 | | -- Compt Door Check: Double Action Gas Shock | 1 |
| 04-EA-09B1 | | -- Door Swing Angle: Set to 90-100 degrees | 1 |
| 05-EL-4M18 | S < | -- Light, Compartment: Maxxima LED 18" , EA, ILOS MTB Note: No light hole required | 1 |
| | | Mount Light on Wall #3 Near Door Jamb | |
| 09-ZZ-ZZZZ | | -- | 1 |
| 02-M1-M775 | S | -- M-7 Compt (RF): 72" H x 25.25" W x 21.0" (Below FL), I/O | 1 |
| 02-BC-10A5 | | -- Compartment Door: SINGLE DOOR, Forward hinged 2-point Latch | 1 |
| 02-B0-09B0 | | -- Compt Door Check: Double Action Gas Shock | 1 |
| 04-EA-09B1 | | -- Door Swing Angle: Set to 90-100 degrees | 1 |
| 05-EL-40M7 | | -- Light, Compt, M-7 (RF): NONE | 1 |
| 05-EL-4M36 | S < | -- Light, Compartment: (2) Maxxima LED 36" , EA, ILOS MTB Note: No light hole required | 2 |
| | | Mount one on wall #1 near door jamb centered top to bottom | |
| | | Mount one on wall #3 near door jamb centered top to bottom | |
| ZZ-ZZ-ZZZZ | | -- | 1 |
| 02-M1-M888 | | -- M-8 Drawer (RF): None - Batteries Under Hood | 1 |
| 02-M1-RA03 | | -- Rear Access Doors: 46 3/4" Wide x 60 5/8" High | 1 |
| ZZ-ZZ-ZZZZ | | -- | 1 |
| ZZ-ZZ-ZZZZ | | -- | 1 |
| | | WELDING - CELL 1 | 1 |
| 04-TS-CYL1 | S < | -- SCBA Storage, (2) Curbside, w/ Hinged Access Doors-SAE J3043 compliant Hinged door on exterior of module, to access SCBA cylinders. (2)HOUS-AD0005 CPI #AD0005-1 (1) TUBE-SCBA-L ABS inner tube (1) TUBE-SCBA-R SAE Testing received July 30, 2018 from vendor. NOTE: Rear Hinged Left, Forward Hinged Right. Glue Piece of 1" Black Foam to Back of Back Wall Inside of SCBA Tubes. | 1 |
| 04-AS-0600 | S < | -- Fuel Fill: CPI C10442-5, W/ door, Break-a-way Custom fuel fill cutout for CPI C10442-5. | 1 |
| | | Label Gasoline | |
| 04-AS-080N | | Urea fill DELETED GASOLINE ENGINE CHASSIS NO HOLE CUT | 1 |
| 04-AS-0370 | | -- Wire/Hose Cover : Diamond Plate, Between Cab & Module | 1 |
| ZZ-ZZ-ZZZZ | | -- | 1 |
| 04-AS-0382 | < | -- Pass-Thru cab mounted wind deflector - Aluminum Diamond Plate AEV Weld shop builds and installs, Attaches to Cab side of bellows mount. Same width as bellows mount with short down turned sides. Secured on sides to bracket. Small up-turned lip at back of wind deflector. non-Painted | 1 |
| 04-BW-7A95 | < | -- Bumper, Rear: HD Alum Framed w/DP pontoon covers Type 1 PURCHASED WITH BODY | 1 |

| PART NO | S | DESCRIPTION | QTY |
|--|-----|---|-----|
| 04-BW-FLIM | < | -- Step, Center: 2" x 7" Grip strut, flip-up PURCHASED WITH BODY | 1 |
| 04-BW-RF20 | < | -- Fenders, Rear: Rubber Extruded, Black MTB #7215439 | 1 |
| 04-BW-DP01 | | -- Skirt Rails: Polished Aluminum Diamond Plate, Box style std | 1 |
| 04-BW-DP04 | S < | -- Rear Kick Plate: Polished Aluminum Diamond Plate 14" High | 1 |
| 04-EA-2505 | < | -- Rear Recovery Eyes: CUSTOM Black EYES-TOW1 BRKT-TOWEYE | 1 |
| 04-EA-2501 | S < | -- Eye Access Holes: (2) 6 inch Dia....., Align w/ eyes NOTE: Make Tow Eye Opening 1" Bigger Than Standard | 1 |
| 04-BW-TA03 | | -- Recessed Tag Area: Polished Aluminum Diamond Plate | 1 |
| 04-BW-TA04 | | -- Location: Centered in the kick plate | 1 |
| 05-EL-44TN | | -- Tag Light: Kinequip LED #132703C | 1 |
| 04-BW-DP92 | S < | -- Corner Caps: 14.0" High, Alum Diamond Plate If there is a body drop, add the appropriate height to Corner Caps. | 1 |
| 04-BW-DP93 | S < | -- Front Stone Guards: 14.0" High, Alum Diamond Plate If there is a body drop, add the appropriate height to Stone Guards. | 1 |
| 04-EA-1470 | | -- Running Boards, DP, w/ full Grip strut edge Ford (T1-2Door) 2017+ | 1 |
| 04-EA-1119 | | -- Mud Deflection Front: OEM ABS Fender Extension | 1 |
| 04-EA-1132 | | -- Mud Flaps Rear: Modular, Rubber AEV LOGO | 1 |
| 05-EL-3901 | < | -- Lights, Cab Step: 4" White LED, Chrome flange mounted in box front, (20C0CDCR) Surface Mount, In Chrome Flange. Wide body Units Only Activate by Cab Doors. Constant Hot. | 1 |
| ZZ-ZZ-ZZZZ | | -- | 1 |
| 04-EA-1734 | | -- Grille Guard, Ranch Hand Legend Black 2020+ F series no camera cutout | 1 |
| ZZ-ZZ-ZZZY | | -- | 1 |
| 04-EA-09A0 | | (2) Rear Door Hold Opens: Grabber Style, 1 on each door | 1 |
| EXTERIOR LIGHTING / HEAT/AC / INSULATION - CELL 2 | | | |
| 05-EL-1800 | | CORNER CAP LED ICC/WARNING LIGHTS | 1 |
| 05-EL-18F0 | | -- Front Corner Cap LED ICC/Warning Lights: Warnings RED/WHITE | 1 |
| 05-EL-18F1 | < | -- Front Center ICC Lts: (3) AMBER Kinequip LED No 112401A, Switch w/ Headlights. | 1 |
| ZZ-ZZ-ZZZZ | | -- | 1 |
| 05-EL-18R5 | | -- Rear Corner Cap LED ICC/Warning Lights: Warnings RED/AMBER | 1 |
| 05-EL-18R1 | < | -- Rear Center ICC Lts: (3) RED Kinequip LED No 112401R Switch w/ Headlights | 1 |
| ZZ-ZZ-ZZZZ | | -- | 1 |
| 06-SW-CC01 | | -- ICC Warning Lights Switched: Primary Only | 1 |
| ZZ-ZZ-ZZZZ | | -- | 1 |
| 05-EL-2310 | | Tail Lights, Whelen LED Combinations , ILOS, | 1 |
| 05-EL-19MO | < | -- Side Marker Lights: (2) RED Kinequip LED No 112401RD Switch w/ Headlights. | 1 |
| 05-EL-2414 | | -- Whelen M6 Series, Tail Lights | 1 |
| 05-EL-2420 | | -- Stop/Tail, Whelen M6 Series, LED, Pair | 1 |
| 05-EL-2426 | | -- Turn, Whelen M6 Series, LED, Pair | 1 |
| 05-EL-2432 | | -- Back up, Whelen M6 Series, LED, Pair | 1 |
| 05-PH-LF24 | | -- M6 Series Flange, Chrome Plated, Std: Three Pair | 1 |
| 06-EC-4326 | | -- Note: Standard Back-up Alarm Installed | 1 |
| 06-EC-4331 | | -- Access Panel: NONE Required | 1 |
| ZZ-ZZ-ZZZZ | | -- | 1 |

| PART NO | S | DESCRIPTION | QTY |
|------------|----|---|-----|
| 05-EL-4301 | | < Patient Area Turn/Stop Strip Light Indicator: Kinequip #KSLRA8 LOCATION: Inside, Over Rear Doors on Rear Header Pad | 1 |
| 05-EL-43DL | | Third (3rd) Brake Light: NONE | 1 |
| 05-EL-4584 | | SCENE/FLOOD LIGHTS (LED-M9 Series) | 1 |
| 05-EL-45L4 | | < -- Left Scene Lights: (2) LED-M9, Chrome Flange Whelen Chrome Flange provided with purchase of Light. | 1 |
| 05-EL-0224 | | -- Flanges: Above M9 Scene lights, Incorporated into lights | 1 |
| 06-EL-18LF | | -- Left Flood Activate: Left Flood Switch | 1 |
| 05-EL-45T4 | | < -- Right Scene Lights: (2) LED-M9, Chrome flange Whelen Chrome Flange provided with purchase of Light. | 1 |
| 05-EL-0224 | | -- Flanges: Above M9 Scene lights, Incorporated into lights | 1 |
| 06-EL-18RT | | -- Right Flood Activate: Right Flood Switch and open CSE Door | 1 |
| 05-EL-46C4 | S | < -- Front Load Lights: (2) LED-M9, chrome flange Whelen Will make a total of (5) warning and (2) scene lights across front of module. (R/S/R/C/R/S/R) Front Flood Activate: Front Flood Switch Front Scenes to cancel in Drive | 1 |
| 05-PH-LF12 | | -- M9 Series Flange Chrome Plated, Std: Pair | 1 |
| 05-EL-46R4 | | < -- Rear Load Lights: (2) LED-M9, Chrome flange Whelen Chrome Flange provided with purchase of Light. | 1 |
| 05-EL-0224 | | -- Flanges: Above M9 Scene lights, Incorporated into lights | 1 |
| 06-EL-18RE | | -- Activate: Rear Flood Switch, Reverse and Lead RA Door | 1 |
| 06-EL-1799 | S | < -- Add Activation: All Scene & Load Lights in Reverse Scene lights to come on with compartment doors as well as entry doors | 1 |
| 05-HB-00F6 | XS | < AC (HVAC): Pro-AIR Ducted in Ceiling - Vert.on floor behind attend seat -T1 Ford With Electric heater valve Mounted Behind the Attendant Seat Base NOTE: HVAC to be Ignition Hot ILO Module Master So HVAC Controls Will Work Without Having to Turn Module Master Switch On. | 1 |
| 05-HA-0406 | | -- Water Pump: Installed required | 1 |
| 05-HA-0800 | | < -- Activ Tek induct 500-12V UV light ozone free System is to be installed in return airt Cabinet. Must be servicable, but not visible to EMT. >> Annual replacement of the UV bulb is required > | 1 |
| 05-HA-1306 | | -- A/C Condenser: See M2 Cmpt for Condenser Information | 1 |
| 05-HA-13X6 | | -- Intermotive Module BCVC502A :Installed 2020 + | 1 |
| 05-HA-14C0 | | -- AC COMPRESSOR: Tee into OEM | 1 |
| 05-HB-14PA | | -- AC Evaporator: Pro-Air (AC/Heat unit) w/ dual fans - | 1 |
| 05-HA-1404 | | -- Heater Hoses: EPDM - Nomex Rubber (per Ford QVM) | 1 |
| 05-HA-14A0 | | -- Side Plenum Grille, Return Air: Stamped Powder Coated Steel | 1 |
| 05-HA-14B1 | | -- Filter, Washable Carbon Pre-Filter | 1 |
| 05-HA-15A0 | | -- Ducted AC Delivery: insulated & foil wrapped, 10 registers | 1 |
| 10-HA-0205 | | < -- Thermostat, Rear A/C, Analog, Pro-Air Thermostat located in A/A. See Drawing. | 1 |
| 05-IL-0051 | | CEILING PANELS: ACM Gloss White | 1 |
| 05-IL-0261 | | -- Dome Lts, LED K-EDGE (4) Streetside, (4) Curbside std | 1 |
| ZZ-ZZ-ZZZZ | | -- | 1 |
| 06-EC-0900 | | < -- Timer, Spring wound Constant Hot, Check out, 15 Minute Located on curbside wall at head of squad bench. | 1 |
| 06-EC-09P2 | S | < -- Timer to Power: All DOMES, Low intensity NOTE: Timer will activate all eight (8) ceiling mounted LED dome lights, M7 Lights and curbside stepwell LED lighting (even with side entry door closed). | 1 |

| PART NO | S | DESCRIPTION | QTY |
|------------|-----|--|-----|
| ZZ-ZZ-ZZZZ | | -- | 1 |
| 06-RR-0700 | | -- (2) Speakers: Stereo, patient compartment, in center pad | 1 |
| 10-RR-0600 | | -- Volume Control, Stereo: in A/A, For Rear speakers | 1 |
| ZZ-ZZ-ZZZZ | | -- | 1 |
| 09-MH-0801 | | -- IV Hook No 1: CPI Rubber IV 2008-1(Recessed Mount), ILOS | 1 |
| 29-MH-1000 | | -- LOCATION: Over head/chest area, primary patient on COT | 1 |
| 09-MH-0802 | | -- IV Hook No 2: CPI Rubber IV 2008-1(Recessed Mount), ILOS | 1 |
| 09-MH-08P2 | | -- LOCATION: Over head/chest area, secondary patient on S/B | 1 |
| ZZ-ZZ-ZZZZ | | -- | 1 |
| 09-MH-0803 | | -- IV Hook No 3: CPI Rubber IV 2008-1(Recessed Mount), IATS | 1 |
| 09-MH-08P3 | S | -- LOCATION: Over Waist area, primary patient on COT | 1 |
| 09-MH-0804 | | -- IV Hook No 4: CPI Rubber IV 2008-1(Recessed Mount), IATS | 1 |
| 09-MH-08P4 | S | -- LOCATION: Over Kneet area, primary patient on COT | 1 |
| 09-MH-2AC6 | < | -- Recessed C/S Grab Rail, ceiling: 1.25 Dia..... 3 pt, 72in, Yellow Antimicrobial Grab Rail will be recessed in a ABS pan. | 1 |
| 09-MH-2ASS | | -- Streetside Grab Rail: None | 1 |
| 05-IN-0STX | | Insulation PKG: X-Series Package, ILOS | 1 |
| 05-IN-1STD | | -- Insulation: Circumferential PKG, Single Layer Reflective w/ Air cell core | 1 |
| 05-IN-3SDX | | -- Insulation: All Module Entry Doors, 2" Black Foam, ILOS | 1 |
| 05-IN-4ST9 | | -- Insulation Sound Deadening: Generation 9 Floor | 1 |
| 05-IN-5STY | < | -- Insulation: Walls/Ceiling, 1" Black Foam, IATS Reflective #INSU-ARM1 | 1 |
| 05-IN-6SDX | < | -- Insulation: Black Sound Proofing, Patient side of Compartment walls IATS INSU-KSU Install on available vertical compartment walls facing the patient area | 1 |
| 05-IN-6STF | < | -- Stepwell Insulation: Urethane Froth Insulation, IATS MTB to spray urethane froth insulation, underside of step well area. MTB option #7208738 | 1 |
| 05-LB-6000 | S < | -- Light Bar Alternative, (2) Across Front Will make a total of (5) warning and (2) scene lights across front of module. (R/S/R/C/R/S/R) | 1 |
| 05-LB-6230 | | -- Front of Module M Series LED System - All Bodies | 1 |
| 05-LB-6614 | | -- Whelen, M9 Series LED Pair | 1 |
| 05-LB-6897 | | -- Flasher for LED front of module: None | 1 |
| 05-PM-LT05 | | -- Light: Whelen M9, LED, RED LED/CLEAR Lens, Programmable iats | 2 |
| 05-PH-LF10 | | -- M9 Series Flange, Chrome Plated, Std. Each | 2 |
| 05-PL-LY54 | | -- LED Color for Above M9 LED : RED | 2 |
| 05-PM-LV10 | | -- Lens Color: Clear | 2 |
| 25-PH-LT84 | | -- LED Lights: Programmable, Single Light | 2 |
| 05-LB-6900 | | -- Alternative Lightbar Switching, Prim/Sec | 1 |
| 05-PA-LB0B | | -- Rear Light Bar: NONE | 1 |
| 05-SY-LTMF | | M SERIES LED WARNING LT SYSTEM - F-series LTD | 1 |
| 05-FS-0712 | | -- Flasher: None, All M Series LED's Are Programmable | 1 |
| 05-FS-10P4 | | -- Flash Pattern: None, Internal Light Head Flasher | 1 |
| 06-SW-PS01 | | -- Warning Light SWITCH: center console, Primary / Secondary | 1 |
| ZZ-ZZ-ZZZZ | S | -- Flash Pattern #1: Signal Alert Except Rear Center Amber Light | 1 |
| ZZ-ZZ-ZZZZ | | -- | 1 |
| ZZ-ZZ-ZZZZ | | -- | 1 |
| 05-PH-LSY5 | S < | -- (2) Grille Lights: Whelen M7, LED, Mounted on Brush Guard NOTE:Lights to be wired with waterproof quick disconnect fittings to allow easy removal of brush guard | 1 |
| 05-PH-LF22 | | -- M7 Series Flange, Chrome Plated, Std: Each | 2 |
| 05-PM-LRA3 | | -- Light, Whelen LED M7 Red LED/Clear Lens - Programmable | 2 |
| 05-PL-LY04 | | -- LED Color for Above M7 LED : RED | 2 |
| 05-PM-LV10 | | -- Lens Color: Clear | 2 |
| 25-PH-LT84 | | -- LED Lights: Programmable, Single Light | 2 |
| 05-PM-LE09 | S | -- (4) Intersection Lights: Whelen ION , LED | 1 |
| 05-PL-LZ01 | < | -- (2) RED ION Series, Wide Angle LED, Surface Mount, ILOS Whelen # WIONSMCR | 1 |

| PART NO | S | DESCRIPTION | QTY |
|--|-----|---|-----|
| 05-PL-LX00 | | -- Lens color for Above LED Light to be: Clear | 1 |
| 05-PL-LY71 | | -- LED Color for Above ION Series LED : RED | 1 |
| 05-PL-LZ02 | S < | -- (2) RED ION Series, Wide Angle LED, Surface Mount, Additional Whelen # WIONSMCR | 1 |
| Mounted on Sides of Brushguard (Reference 19OF 24888-90G) | | | |
| NOTE:Lights to be wired with waterproof quick disconnect fittings to allow easy removal of brush guard | | | |
| 05-PL-LX00 | | -- Lens color for Above LED Light to be: Clear | 1 |
| 05-PL-LY71 | | -- LED Color for Above ION Series LED : RED | 1 |
| ZZ-ZZ-ZZZZ | | -- | 1 |
| 05-PM-LF70 | | -- (1) Center Front Body Light: Whelen M9 Series, LED | 1 |
| 05-PH-LF10 | | -- M9 Series Flange, Chrome Plated, Std. Each | 1 |
| 05-PM-LS02 | | -- LED M9 White - Each | 1 |
| 05-PM-LRK1 | | -- Light: Whelen M9, LED, WHITE LED/CLEAR Lens, Programmable ea ilos | 1 |
| 05-PL-LY52 | | -- LED Color for Above M9 LED : WHITE | 1 |
| 05-PM-LV10 | | -- Lens Color: Clear | 1 |
| 25-PH-LT84 | | -- LED Lights: Programmable, Single Light | 1 |
| 05-PM-LG70 | | -- (2) Outer Front Body Lights: Whelen M9 Series, LED | 1 |
| 05-PH-LF12 | | -- M9 Series Flange Chrome Plated, Std: Pair | 1 |
| 05-PM-LS24 | | -- LED M9 Red - Pair | 1 |
| 05-PM-LRK3 | | -- Light: Whelen M9, LED, RED LED/CLEAR Lens, Programmable ILOS | 2 |
| 05-PL-LY54 | | -- LED Color for Above M9 LED : RED | 2 |
| 05-PM-LV10 | | -- Lens Color: Clear | 2 |
| 25-PH-LT84 | | -- LED Lights: Programmable, Single Light | 2 |
| ZZ-ZZ-ZZZZ | | -- | 1 |
| 05-PM-LH70 | | -- (4) Upper Side Body Lights: Whelen M9 Series, LED | 1 |
| 05-PH-LF14 | | -- M9 Series Flange, Chrome Plated, Std: Two Pair | 1 |
| 05-PM-LS44 | | -- LED M9 Red - Two Pair | 1 |
| 05-PM-LRK3 | | -- Light: Whelen M9, LED, RED LED/CLEAR Lens, Programmable ILOS | 4 |
| 05-PL-LY54 | | -- LED Color for Above M9 LED : RED | 4 |
| 05-PM-LV10 | | -- Lens Color: Clear | 4 |
| 25-PH-LT84 | | -- LED Lights: Programmable, Single Light | 4 |
| 05-PM-LI50 | | -- (2) Rear Intersection Lights: Whelen M7 Series, LED | 1 |
| 05-PH-LF22 | | -- M7 Series Flange, Chrome Plated, Std: Each | 2 |
| 05-PM-LR24 | | -- LED M7 Red - Pair | 1 |
| 05-PM-LRA3 | | -- Light, Whelen LED M7 Red LED/Clear Lens - Programmable | 2 |
| 05-PL-LY04 | | -- LED Color for Above M7 LED : RED | 2 |
| 05-PM-LV10 | | -- Lens Color: Clear | 2 |
| 25-PH-LT84 | | -- LED Lights: Programmable, Single Light | 2 |
| 05-PM-LJ70 | | -- (2) Outer Rear Body Lights: Whelen M9 Series, LED | 1 |
| 05-PH-LF12 | | -- M9 Series Flange Chrome Plated, Std: Pair | 1 |
| 05-PM-LS24 | | -- LED M9 Red - Pair | 1 |
| 05-PM-LRK3 | | -- Light: Whelen M9, LED, RED LED/CLEAR Lens, Programmable ILOS | 2 |
| 05-PL-LY54 | | -- LED Color for Above M9 LED : RED | 2 |
| 05-PM-LV10 | | -- Lens Color: Clear | 2 |
| 25-PH-LT84 | | -- LED Lights: Programmable, Single Light | 2 |
| ZZ-ZZ-ZZZZ | | -- | 1 |
| 05-PM-LK70 | | -- (2) Additional Rear Body Lights: Whelen M9 Series, LED | 1 |
| 05-PH-LT6B | | -- Location: REAR, (1) aligned w/ EACH upper window in RA doors. | 1 |
| 05-PM-LT04 | | -- Light: Whelen M9, LED, RED LED/CLEAR Lens, Non-Programmable IATS | 2 |
| 05-PH-LF10 | | -- M9 Series Flange, Chrome Plated, Std. Each | 2 |
| 05-PL-LY54 | | -- LED Color for Above M9 LED : RED | 2 |
| 05-PM-LV10 | | -- Lens Color: Clear | 2 |
| 06-EL-2499 | < | -- Brake Light Override: Wire into rear warning lights above Includes FLAS-ULF44 (1) Flasher unit to flash lights during warning cycle. | 1 |
| 06-EL-2501 | | -- Override Function: During ALL modes of operation | 1 |
| ZZ-ZZ-ZZZZ | | -- | 1 |
| 05-PM-LL70 | | -- (1) Center Rear Body Light: Whelen M9 Series, LED | 1 |
| 05-PH-LF10 | | -- M9 Series Flange, Chrome Plated, Std. Each | 1 |
| 05-PM-LS06 | | -- LED M9 Amber - Each | 1 |

| PART NO | S | DESCRIPTION | QTY |
|----------------------------|-----|--|-----|
| 05-PM-LRK7 | S < | -- Light: Whelen M9, LED, AMBER LED/CLEAR Lens, Programmable ILOS Program # 150 Cylon Medium w/ solid | 1 |
| 05-PL-LY56 | | -- LED Color for Above M9 LED : AMBER | 1 |
| 05-PM-LV10 | | -- Lens Color: Clear | 1 |
| 25-PH-LT84 | | -- LED Lights: Programmable, Single Light | 1 |
| ZZ-ZZ-ZZZY | -- | | 1 |
| ZZ-ZZ-ZZZZ | -- | | 1 |
| 05-ZZ-ZZZZ | | | 1 |
| ELECTRICAL - CELL 3 | | | |
| 05-IL-12ML | | -- Cab Ovhd Lights: Pair, Klinequip 4409, 4" Red/White LED | 1 |
| 06-00-0005 | S < | -- Customer Supplied Part(s) : Yes See account 1) Customer Supplied Computer Mount | 1 |
| 07-00-0181 | < | -- Aluminum Cab Consoles contained in the Electrical System Section Duplicate Notification location. Please pick the appropriate code at the Electrical console section for the upcharge. | 1 |
| 06-RR-S500 | < | -- Aluminum Console Drawing request AEV Engineering to develop drawing for console and send to Account manager for approval prior to release. Console to include standard items. Removable top panel, inset Front location for Switch panel. all other items at special cost. | 1 |
| 11-ZZ-090D | < | -- CAAS GVS 2.0 Exception C.8.5.5 Lack of Anti-Theft device for Idling By declining to select an appropriate anti-theft device for this chassis, The Agency is non-compliant to CAAS GVS 2.0 for the likely event of required idling of the chassis while unattended. This applies only to agencies selecting CAAS Compliance. CAAS GVS 2.0 requires; The chassis shall be equipped with an anti-theft device to prevent the vehicle from being driven by an unauthorized operator." | 1 |
| 05-IL-2004 | S < | Rechargeable Flash Lts: (2) Streamlight, Survivor LED-90513, Yellow, 12 Volt Ste 12Volt steady charge with holder | 2 |
| 05-IL-10L0 | S < | -- Location: in Cab on rear of console Reference 19OF 24888-90G | 2 |
| 05-IL-10P0 | | -- Powered: 12v Constant Hot | 2 |
| 06-AL-47SU | | Hand Held Spot Light: None | 1 |
| 06-AL-4900 | < | -- Cab Spot Light: None Not Require by KKK-F | 1 |
| 06-AM-SAHN | | -- AEV Traumahawk Telematics Declined, Not required | 1 |
| 06-BA-3F42 | S | Batteries: 3 - Battery System - Type I | 1 |
| 06-BA-3F57 | S | -- Batteries: (3) Batteries, ILOS Type I | 1 |
| 02-B0-B002 | < | -- Noco Heavy duty large battery box with snap top lid each (1) BATT-BOXLG Accommodates Group 24 through Group31 batteries Snap top Removable lid with nylon strap retainer | 1 |
| 06-BA-3F61 | S < | -- Batteries: (2) Under hood, (1) in M7 Cmpt (2) Batteries Under Hood and (1) Battery in M7 in Noco Box. Battery in M7 for Emergency Start with 5 Minute Timer With a Momentary Switch on the Front Console Would Allow All Batteries to be Tied Together in the Event of the Cranking Battery Failure. | 1 |
| 06-BA-3FF3 | S < | -- Battery Make: (3) Total, (2) Min OEM CCA/Ahr & (1) Interstate MTP 24 ILOS retain the minimum OEM battery under the hood Install BATT-MTP24 (1) in M-7 | 1 |
| 06-BA-3FW0 | < | -- Emergency Start Circuit - (3) Battery System, Switch in console 2 batteries on slide out to be primary starting batteries. One remaining battery on slide out to be emergency start. | 1 |

| PART NO | S | DESCRIPTION | QTY |
|--|------|---|-----|
| 06-BA-3FWA | | -- Batteries Wired: (2) / (1) Through charge relay system | 1 |
| 06-EC-08A0 | XS < | -- Battery Switch & Auto-Shut-down (Circuit): 5 Minute ILOS MDUL-ss32 Non adjustable timer set for 5 minutes. This will include Cole Hersee 2484-16 Paddle Timer Activated by ignition. Location: Front of Console on Driver Side Top Corner (Reference 19OF 24888-89G) | 1 |
| ZZ-ZZ-ZZZZ | | -- | 1 |
| 06-EC-056B | | PWR Door Locks: Module Doors - Full Mod T1 Ford | 1 |
| 06-EC-050A | < | -- Door Locks, Tied into OEM System Type 1 Ford Module power locks are tied to the Chassis power lock system | 1 |
| 06-EC-0512 | < | -- OEM Key Fob: Included w/Chassis Unlock Mod Doors Must also operate the Module Power Door Locks Optional. | 1 |
| 06-EC-05C9 | | -- Door Lock Switches : Integrated in Interior Entry door Handles | 1 |
| 06-EC-05K0 | | -- ONLY the following doors shall have power door locks: | 1 |
| 06-EC-05M1 | | -- Electric Door Lock: (M-1) Left Front Compartment | 1 |
| 06-EC-05M2 | | -- Electric Door Lock: (M-2) Left Middle Compartment | 1 |
| 06-EC-05M3 | | -- Electric Door Lock: (M-2.5) Left Wheel Well Compt. | 1 |
| 06-EC-05M4 | | -- Electric Door Lock: (M-3) Left Rear Compartment | 1 |
| 06-EC-05M6 | | -- Electric Door Lock: Rear Access Doors | 1 |
| 06-EC-05M7 | | -- Electric Door Lock: (M-5) Right Rear Compartment | 1 |
| 06-EC-05M9 | | -- Electric Door Lock: (M-6) Right Rear, Forward Compt | 1 |
| 06-EC-05N0 | | -- Electric Door Lock: Curbside Access Door | 1 |
| 06-EC-05N1 | | -- Electric Door Lock: (M-7) Right Front Compt | 1 |
| 06-EC-2800 | < | -- Door Unlock Switch, Momentary, Exterior, hidden NOTE: Installation of Remote Door Lock Switch feature may increase likelihood of unauthorized entry into vehicle. By checking this option, purchaser further agrees to hold REV or chassis manufacturer harmless for any loss of vehicle or contents caused by unlawful access. | 1 |
| 06-EC-0802 | | -- Location: Front Grille/Bumper Area | 1 |
| ZZ-ZZ-ZZZZ | | -- | 1 |
| 06-EC-3015 | < | Ford OEM backup Camera installed, Cable, Displays into OEM Radio Ordered with Chassis. This product has no BRAKE light capability. | 1 |
| 06-EC-3509 | | Circuit Board: RMR Rail System, W/ LED Diagram - Type I | 1 |
| 06-EC-CB03 | | -- Circuit Protection, 12V: Blade Breaker - Manual-reset | 1 |
| 06-RR-23F1 | | -- Ind Light Flasher: Thru 14S Flasher Unit | 1 |
| 06-RR-F20F | XS < | -- Console, Engine Cover: CUSTOM - Aluminum - Speed Lined F Series Battery Switch to be located on left side of Console. Speedliner color-Gray | 1 |
| NOTE: Make Front Top Section Flat for Computer Mount Then Angle For Switch Panel | | | |
| 06-RR-2315 | | -- Type 1 LED Rocker Switches Front and Rear Switch Panels Standard | 1 |
| 06-EC-3572 | | -- Master Switch: Front and Action Area | 1 |
| 06-MC-0812 | | -- Amp meter No 1: Digital Smart LED 0-300 AMP with auto intensity control | 1 |
| 06-MC-0810 | | -- Smart Volt Meter: (1) Kinequip 8.0 thru 16.0 Volts, Digital w Low voltage | 1 |
| 06-RR-23A1 | | buzze -- Engraved LOGO: AEV TraumaHawk | 1 |
| 06-RR-23I1 | | -- Indicator Light: Halogen AMBER "Compt Open" light | 1 |
| 06-RR-23I2 | | -- Flashing light: Activate w/ ANY compartment door switch. | 1 |
| 06-RR-23I3 | | -- Indicator Light: halogen GREEN "AMB PWR" light | 1 |
| 06-RR-23I4 | | -- Steady burn light: Activate with Conversion power switch | 1 |
| 06-RR-23I5 | | -- Indicator Light: Halogen RED "Door Ajar" light | 1 |
| 06-RR-23I6 | | -- Flashing light: Activate w/ ANY Mod entry door switch. | 1 |
| 06-RR-23J3 | | -- Door/Compartment Ajar Buzzer: None | 1 |
| 06-RR-23L0 | | -- Illumination strip LED for Front and rear switch panels 12v | 1 |
| ZZ-ZZ-ZZZY | | -- | 1 |

| PART NO | S | DESCRIPTION | QTY |
|------------|------|--|-----|
| 06-RR-S500 | < | -- Aluminum Console Drawing request AEV Engineering to develop drawing for console and send to Account manager for approval prior to release. Console to include standard items. Removable top panel, inset Front location for Switch panel. all other items at special cost. | 1 |
| 07-RR-150A | S < | -- Console, Add On - ALUMINUM - Speed Lined Speedliner Color: Gray | 1 |
| 07-RR-0512 | S < | -- Armrests, Padded: Adjustable Height Pair, Black NOTE: Use Bolts With Wing Nuts on Armrest so Height Can Be Adjusted Easier | 1 |
| ZZ-ZZ-ZZZZ | S < | -- Customer Supplied Computer Mount Installed in Front Console Mount on Passenger Side of Console Towards Front in Flat Section | 1 |
| 27-RR-02A0 | S < | -- Drink Holders for Additional Console, Big Gulp Size NOTE: Drink Holders to be 3 1/2" Deep and to be Flush with Console | 2 |
| 07-RR-02A5 | | -- Drink Holder Location: Front | 2 |
| ZZ-ZZ-ZZZZ | S < | -- Note Book Slot: Custom Diamond Plate Mount on backwall of Cab Custom notebook holder and glove storage (Reference 19OF 24888-90G) | 1 |
| 27-RR-2355 | S < | -- Glove Storage: (2) Glove Box Storage Custom Diamond Plate Mount on backwall of Cab (Reference 19OF 24888-90G for Mounting Height) Custom notebook holder and glove storage (Reference 19OF 24888-90G) | 1 |
| 07-RR-2301 | | -- Customer Radio: Space for Customer installed Radio Heads | 1 |
| 07-ZZ-ZZZZ | | -- | 1 |
| 06-EC-4300 | | Back-up Alarm: Standard 102DB | 1 |
| 06-EC-43B0 | | -- Cut Off Switch: Auto reset ,momentary style | 1 |
| 11-ZZ-0933 | < | -- CAAS GVS V2.0 Exception C.16.1 Reset of Back-up Alarm Installation of a reset of a back-up alarm shall cause an exception to the GVS 2.0 Standard for C.16.1 for this instance when a vehicle is shifted into reverse. | 1 |
| 06-EC-GR01 | | Ground Straps, Module to Frame: (Qty 4) Braided | 1 |
| 06-IA-0001 | | Converter , 125V to 12V: NONE | 1 |
| 06-IG-0250 | XS < | Inverter : Vanner LIFESINE 1100 Pure Sine Wave, w 55watt 3 stage charger NOTE: Inverter to Default to On With Ignition, Delete Inverter Switch in Action Area. | 1 |
| 06-EC-03AS | | -- Portable Equip Charging Circuits: Included in Inverter | 1 |
| 06-EC-03AA | | -- PREWIRE LOCATION: (1)Cab Console, (1) Behind A/A | 1 |
| 06-EC-03C9 | | -- Portable Equip Pwr Source: Ignition and/or Shoreline | 1 |
| 06-IG-03A0 | S < | -- Battery Charger/Conditioner: 55A - Built into Inverter NOTE: Set Battery Charger to 15 AMP ILO 55 AMP | 1 |
| 06-IG-0003 | | -- Built-in Battery Charger: Enable - Wire to Batteries | 1 |
| 06-IG-04L7 | | -- Inverter Location: M-1A (ULF) Compartment | 1 |
| 06-MC-0900 | | Low Voltage Indicator: Amber with Buzzer | 1 |
| | | COMMUNICATION RADIO(S) RELATED | 1 |
| | | RADIO POWER | 1 |
| 06-EC-0301 | | -- Radio Power No 1: 30A with Buss bar | 1 |
| 06-EC-03C0 | | -- Radio Power Source: Battery (Constant) Hot | 1 |
| 06-EC-03D0 | | -- LOCATION: Behind Passenger's Seat | 1 |
| 06-EC-0302 | | -- Radio Power No 2: 30A with Buss bar | 1 |
| 06-EC-03C0 | | -- Radio Power Source: Battery (Constant) Hot | 1 |
| 06-EC-03D0 | | -- LOCATION: Behind Passenger's Seat | 1 |
| 06-EC-0303 | S < | -- Radio Power No 3: 30A with Buss bar For Wireless Router and Radio Power | 1 |
| 06-EC-03C0 | | -- Radio Power Source: Battery (Constant) Hot | 1 |

| PART NO | S | DESCRIPTION | QTY |
|------------|-----|---|-----|
| 06-EC-03E0 | S | <i> -- LOCATION: Cabinet "H" Mounted on Wall #3 of Cabinet Up High</i> | 1 |
| | | ANTENNA LEADS | 1 |
| 06-RR-0100 | | <i> -- Coaxial Cable, No 1: Type RG-58U, No connectors</i> | 1 |
| 06-RR-0101 | < | <i> -- ORIGINATION POINT: Roof Port No 1</i> Roof Port No 1 is lined up with the edge of the curbside entry door, and centered side to side as possible | 1 |
| 06-RR-01P0 | | <i> -- Port Plate: None - Access thru center upholstery panel</i> | 1 |
| 06-RR-01T1 | | <i> -- TERMINATION POINT: Behind Passenger's seat w/ 36" Tail</i> | 1 |
| 06-RR-1300 | S | <i> -- Conduit No 3: 2", with pull wire</i> | 1 |
| 06-RR-1301 | S | <i> -- CONDUIT ORIGINATION POINT: Cabinet "H" Behind Attendant Seat</i> | 1 |
| 06-RR-13T6 | | <i> -- CONDUIT TERMINATION POINT: In Cab Console</i> | 1 |
| 06-RR-1809 | | <i> -- Patient Area Radio : None</i> | 1 |
| 06-SO-0000 | | 125V SHORE LINE AND OUTLETS | 1 |
| 06-SO-0900 | < | <i> -- Shore Line Inlet: 30A, Auto Eject, 3-PIN ILOS</i> Requires additional space behind interior cabinets for installation. Install Shore Line operation label. | 1 |
| 06-SO-00L1 | S | <i> -- Inlet location: Front of Module Box on Driver Side Recessed in Body</i> | 1 |
| 06-SO-0801 | S < | <i> -- Indicator Light, Shore line: Weather proof, power by SL, Green</i> Indicator light located above shore line inlet. | 1 |
| | | (1) Light showing power coming in | |
| | | Each light to be labeled | |
| 06-SO-0811 | S < | <i> -- Additional Ind Light, Shore line: Weather proof, power by SL, Green</i> (1) Light showing power on outlets/inverter | 1 |
| | | Each light to be labeled | |
| 06-SO-1080 | | <i> -- Cover, Gray, Shore Line Inlet : 30A Super Auto Eject, ILOS</i> | 1 |
| ZZ-ZZ-ZZZZ | | <i> --</i> | 1 |
| 06-SO-10TT | < | <i> -- Inpower Timer: VCM-05-01SF, Installed</i> NOTE: This allows the auto eject to be wired to the ignition switch In lieu of splicing into the OEM starter circuit and is required any this vehicle | 1 |
| ZZ-ZZ-ZZZZ | | <i> --</i> | 1 |
| 06-SO-1400 | | <i> -- **125 Volt OUTLETS**</i> | 1 |
| 06-HA-010F | S < | <i> -- Heater 110 VAC, Pro Air: Intake Vent 5,000 BTU</i> Located: Recessed in M5 Filler in Upper Section Facing Aisle | 1 |
| 06-HA-0120 | | <i> -- Dissipation Plate: On Ceiling above Heater (heater mounted within 12" of ceiling</i> | 1 |
| 06-SO-1401 | < | <i> -- 125 VAC Outlet, No 1: 15A, Hospital Grade, IVORY</i> All 125 VAC outlets shall be back lighted when power is applied to the outlet. | 1 |
| 06-SO-14L1 | | <i> -- LOCATION: Action Area, standard location</i> | 1 |
| 06-SO-14O2 | | <i> -- Outlet mounting ORIENTATION: Vertical</i> | 1 |
| ZZ-ZZ-ZZZZ | | <i> --</i> | 1 |
| 06-SO-14O2 | | <i> -- 125 VAC Outlet, No 2: 15A, Hospital Grade, IVORY</i> | 1 |
| 06-SO-14L3 | | <i> -- LOCATION: RF ALS, (See Drawing)</i> | 1 |
| 06-SO-14O2 | | <i> -- Outlet mounting ORIENTATION: Vertical</i> | 1 |
| ZZ-ZZ-ZZZZ | | <i> --</i> | 1 |
| 06-SO-14O3 | | <i> -- 125 VAC Outlet, No 3: 15A, Hospital Grade, IVORY</i> | 1 |
| 06-SO-14L3 | | <i> -- LOCATION: RF ALS, (See Drawing)</i> | 1 |
| 06-SO-14O2 | | <i> -- Outlet mounting ORIENTATION: Vertical</i> | 1 |
| ZZ-ZZ-ZZZZ | | <i> --</i> | 1 |
| 06-SO-14O4 | | <i> -- 125 VAC Outlet, No 4: 15A, Hospital Grade, IVORY</i> | 1 |
| 06-SO-14L9 | S | <i> -- LOCATION: In Cab Console on Passenger Side</i> | 1 |
| 06-SO-14O2 | | <i> -- Outlet mounting ORIENTATION: Vertical</i> | 1 |
| ZZ-ZZ-ZZZZ | | <i> --</i> | 1 |
| 06-SO-14O5 | | <i> -- 125 VAC Outlet, No 5: 15A, Hospital Grade, IVORY</i> | 1 |

| PART NO | S | DESCRIPTION | QTY |
|------------|-----|---|-----|
| 06-SO-14L7 | S < | -- LOCATION: Special Location - (See Drawing) Hidden Inside Cab Console | 1 |
| 06-SO-14O2 | | -- Outlet mounting ORIENTATION: Vertical | 1 |
| ZZ-ZZ-ZZZZ | | -- | 1 |
| 06-SO-14O6 | | -- 125 VAC Outlet, No 6: 15A, Hospital Grade, IVORY | 1 |
| 06-SO-14L7 | S < | -- LOCATION: Special Location - (See Drawing) Hidden Behind Action Area Board in A/A Cabinet | 1 |
| 06-SO-14O2 | | -- Outlet mounting ORIENTATION: Vertical | 1 |
| ZZ-ZZ-ZZZZ | | -- | 1 |
| 06-SO-14O7 | | -- 125 VAC Outlet, No 7: 15A, Hospital Grade, IVORY | 1 |
| 06-SO-14L7 | S | -- LOCATION: Cabinet B Right Side- (See Drawing) | 1 |
| 06-SO-14O2 | | -- Outlet mounting ORIENTATION: Vertical | 1 |
| ZZ-ZZ-ZZZZ | | -- | 1 |
| 06-SO-14O8 | | -- 125 VAC Outlet, No 8: 15A, Hospital Grade, IVORY | 1 |
| 06-SO-14L7 | S | -- LOCATION: Cabinet D Right Side - (See Drawing) | 1 |
| 06-SO-14O2 | | -- Outlet mounting ORIENTATION: Vertical | 1 |
| ZZ-ZZ-ZZZZ | | -- | 1 |
| 06-SO-1100 | | **INTERIOR 12 Volt OUTLETS** | 1 |
| 06-SO-1101 | | -- 12V Outlet, No 1: Power Point Double Outlet- Wire thru Med Isolator | 1 |
| 06-SO-11L1 | | -- LOCATION: Action Area, standard location | 1 |
| 06-SO-14O2 | | -- Outlet mounting ORIENTATION: Vertical | 1 |
| 06-SO-1912 | | -- Power Source: Medical Isolator , Battery (CONSTANT) Hot | 1 |
| ZZ-ZZ-ZZZZ | | -- | 1 |
| 06-SO-1103 | | -- 12V Outlet, No 3: Power Point - Wire thru Med Isolator | 1 |
| 06-SO-11L3 | S | -- LOCATION: Hidden Behind A/A Board in A/A Cabinet | 1 |
| 06-SO-14O2 | | -- Outlet mounting ORIENTATION: Vertical | 1 |
| 06-SO-1913 | | -- Power Source: The SAME as outlet No 1 | 1 |
| ZZ-ZZ-ZZZZ | | -- | 1 |
| 06-SO-1124 | | -- 12V Outlets, Double Receptacle (SOCK-04C), IATS | 3 |
| 06-SO-1910 | | -- Power Source: Medical Isolator , Batt Sw Hot | 3 |
| 06-SO-11LB | S < | -- LOCATION: RF ALS, (See Drawing) Three Double 12V Outlets Installed in RF ALS | 3 |
| ZZ-ZZ-ZZZZ | | -- | 3 |
| 06-SO-1123 | | -- 12V Outlets, Triple Receptacle (SOCK-04D) | 1 |
| 06-SO-1912 | | -- Power Source: Medical Isolator , Battery (CONSTANT) Hot | 1 |
| 26-SO-11L5 | S < | -- LOCATION: In Cab Console on Front in Separate Box (3) 12V Outlets and (1) Dual USB in Box Reference 19OF 24888-90G | 1 |
| ZZ-ZZ-ZZZZ | | -- | 1 |
| 06-SO-1161 | < | -- 12V Outlet, DUAL USB Fast 4.8A,, 2.4 A per slot Round IATS EACH Includes waterproof cover. | 3 |
| 26-SO-11L1 | S < | -- LOCATION: (2) in Action Area & (1) in Cab Console Beside Triple 12V Outlets (3) 12V Outlets and (1) Dual USB in Box in Cab Console Reference 19OF 24888-90G | 3 |
| ZZ-ZZ-ZZZZ | | -- | 3 |
| 06-SS-060J | | Siren: Whelen, 295SLSA1, F-Series, ILOS | 1 |
| 06-SS-DF00 | < | -- Siren Speakers: Federal # ES100-ESMFT-EF, Ford F-350/450/550 2017 ILOS These speakers require a recessed mount requiring a hole in the outer end of the front bumper. | 1 |
| 06-SS-SW01 | | -- Siren / OEM Horn Switch: In Cab Console | 1 |
| 06-SS-SW04 | S < | -- microphone clip not installed Tie to Siren Microphone cord. CABINET SHOP - Modular NOTE: All Cabinet Shelving to be Through Bolted to Shelf Brackets With Acorn Nuts on Bottom | 1 |

| PART NO | S | DESCRIPTION | QTY |
|------------|-----|--|-----|
| 07-00-0181 | < | Aluminum Cab Consoles contained in the Electrical System Section Duplicate Notification location. Please pick the appropriate code at the Electrical console section for the upcharge. | 1 |
| 06-RR-S500 | < | Aluminum Console Drawing request AEV Engineering to develop drawing for console and send to Account manager for approval prior to release. Console to include standard items. Removable top panel, inset Front location for Switch panel. all other items at special cost. | 1 |
| ZZ-ZZ-ZZZZ | - | | 1 |
| 07-00-0001 | < | ALL DIMENSIONS ON ORDER WILL HAVE A VARIABLE OF + OR - 1/4" Unless specified as a minimum dimension. | 1 |
| ZZ-ZZ-ZZZZ | - | | 1 |
| | | Cabinet Configuration | 1 |
| 07-00-MC83 | < | Mica Colors: Gloss White over Stainless Steel Parting Line: C/S: Top of squad bench including rear filler. S/S: To CPR side seat. Stainless Steel on above areas only. No other cabinet gets stainless, unless specified otherwise below. | 1 |
| 07-AS-1200 | < | Stainless Steel - FACE of Squad Bench including rear filler End of squad bench shall be MICA. | 1 |
| 07-AS-1400 | - | Stainless Steel - Lower Face of Wall Cabinet - Included | 1 |
| ZZ-ZZ-ZZZZ | - | | 1 |
| 07-00-PC0N | | Polycarbonate Type/Color: Lexan - CLEAR Secure Latch | 1 |
| 07-01-SEL6 | < | Att. Seat: EVS Comfort 1880P4B 10deg Child Safety Seat ,Dove Gray Per4max Black Seamless, Dove Gray Comfort series foam, Per4max Black 4-pt Belt | 1 |
| 07-SE-0901 | < | BASE: Swivel base for EVS Child Seat Option Handle on RIGHT std (2) Position Swivel, Forward or Rearward, Only | 1 |
| 11-SE-04A0 | - | Attendant Seat, Armrest: None | 1 |
| 07-AC-4401 | | AC CABINET: Evaporator, Std Location Behind Att Seat | 1 |
| 07-ZZ-ZZZZ | - | | 1 |
| 07-BH-4801 | XS | LF Cabinet, Behind Att Seat: Cabinet "H" Radio Cabinet | 1 |
| 07-CA-VEN7 | | -- Plastic Vent: (2) Total, 1 column x 8 row, Vent 01 | 1 |
| 07-DR-WD0E | S < | Door, Single Solid Flush Fitted Removable Door NOTE: No Hinge Installed on Door, This Will be a Removable Door | 1 |
| 07-CA-2100 | | -- TRIM: U-shaped Door, J-trim opening | 1 |
| 07-HW-SO12 | | -- Round Pull Latch: Locking - Chrome Finish | 1 |
| 11-X0-0010 | | -- Stowage rating label - Southco round latch 10 pounds applied each | 1 |
| 07-ZZ-ZZZZ | - | | 1 |
| 07-ZZ-ZZZZ | - | | 1 |
| 07-CA-03C0 | S < | CURBSIDE UPPER: Over S/B, Mods, 4-glove dispenser at front Gloves Horizontal and Cabinet Will Only Have (1) Center Divider in Glove Cabinet ILOS. | 1 |
| 07-CU-K102 | S | -- Cabinet K: (1) Opening | 1 |
| 07-DR-LX24 | | -- Door: Single Flip Up 3/8" Lexan | 1 |
| 07-DR-LZ20 | | -- Hinges: Reel Torque | 1 |
| 07-HW-SO11 | | -- Round Pull Latch: Non-locking - Chrome Finish | 1 |
| 11-X0-0010 | | -- Stowage rating label - Southco round latch 10 pounds applied each | 1 |
| 07-CU-L201 | < | -- Cabinet L: 4-Glove dispenser cabinet 3/8" Lexan door hinged top. (4) adjacent slats in Lexan to access gloves. | 1 |

| PART NO | S | DESCRIPTION | QTY |
|------------|-----|--|-----|
| 07-DR-LX06 | S | -- Door: , 3/8" Lexan W/Reel Torque Hinges ILOS- 4-glove dispense thru | 1 |
| 07-DR-LZ20 | | -- Hinges: Reel Torque | 1 |
| 07-HW-SX11 | S | -- Round Pull Latch: Non-locking - Chrome Finish | 1 |
| 11-X0-0010 | | -- Stowage rating label - Southco round latch 10 pounds applied each | 1 |
| 07-ZZ-ZZZZ | | -- | 1 |
| 07-ZZ-ZZZZ | | -- | 1 |
| 07-CA-04B0 | | CURBSIDE REAR STORAGE CABINET: NONE | 1 |
| 07-ZZ-ZZZZ | | -- | 1 |
| 07-RF-4404 | | RF ALS Cabinet: Std T-1 | 1 |
| 07-RF-CADR | | -- Check the specified Walk through Door type (Station 5) | 1 |
| 07-RF-I148 | S | -- Cabinet I-1: Mermaide Cabinet Location | 1 |
| 07-ZZ-ZZZZ | | -- | 1 |
| 07-RF-I248 | | -- Cabinet I-2: Standard | 1 |
| 07-DR-WD13 | S < | -- Doors: Dual Flush Fitted | 1 |
| | | NOTE: Install Magnet Catches on Bottom of RF ALS Doors IATS South Co Latches at Top | |
| 07-CA-21A0 | | -- TRIM: U-shaped Door, J-trim opening, DBL DRS | 1 |
| 07-DR-OR05 | | -- Hinge Orientation: (1) RIGHT and (1) LEFT | 1 |
| 07-HW-SX15 | S | -- Dual Round Pull Latches: Non-locking - Chrome | 1 |
| 11-X0-0010 | | -- Stowage rating label - Southco round latch 10 pounds applied each | 2 |
| 07-HW-HIN1 | | -- Hinge: 1 1/2" Stainless Steel Piano Hinge | 2 |
| 07-RA-IOA1 | | -- Outside Access: Thru M-7 (RF) Compartment door. | 1 |
| 07-RF-0001 | | -- Interior MICA Color: White cabinet liner | 1 |
| 07-TS-1200 | S < | -- Shelf Track: Small alum Unistrut type | 1 |
| | | NOTE: All Cabinet Shelving to be Through Bolted to Shelf Brackets With Acorn Nuts on Bottom | |
| 07-CA-0608 | S < | -- (3) Shelves: Adjustable mica over substrate with Alum Trim | 1 |
| | | The compartment will have three adjustable shelves capable of supporting a minimum of 25 pounds each. Also, each shelf shall be notched in the left hand side corner 1.5" to allow for the passing of department supplied cables and 110 plugs | |
| ZZ-ZZ-ZZZZ | | -- | 1 |
| 07-RF-I30D | | -- Cabinet I-3: DELETE, Combine with I2 Cabinet | 1 |
| 07-ZZ-ZZZZ | | -- | 1 |
| 07-ZZ-ZZZZ | | -- | 1 |
| 07-RR-0048 | | Right Rear Cabinet: Cover over M-5compartment | 1 |
| 07-ZZ-ZZZZ | | -- | 1 |
| 07-SA-0000 | | | 1 |
| 07-SB-4401 | | SQUAD BENCH: Standard | 1 |
| 07-SB-0001 | | -- See Upholstery Section for Post and Wheel Cup info | 1 |
| 07-SB-1000 | S < | -- Receptacle, Trash Recess Only at Head of Bench | 1 |
| | | NOTE: Custom Trash Recess at Head of Bench for Customer to Install Container. Trim Opening and Opening to be 16" Long x 10.25" Wide x 10.5" Deep | |
| 07-SB-1001 | | -- Storage Under Lid - Configure to M-6 Compartment Size | 1 |
| 07-SB-LID2 | | -- Squad Bench Lids: Split - 2-section | 1 |
| 07-SB-LH00 | | -- Hinge, Squad Bench Lid(s): Butt Style Hinges | 1 |
| 07-SB-LH03 | | -- Lid Checks: Gas shock, Dual Action | 2 |
| 07-SB-LH07 | | -- Latch, Squad Bench Lid: Slam Action Paddle, W keeper | 2 |
| 11-X0-0030 | | -- Stowage rating label - Squad bench interior, entire area 80 lbs | 2 |
| 07-TR-SB01 | | -- Edge Trim, Lids: Band w/ Laminate and J-Trim Protection | 1 |
| ZZ-ZZ-ZZZZ | | -- | 1 |
| 08-MH-1600 | | -- Restraint Net, Removable, at head of S/B, Black Webbing | 1 |
| 08-ZZ-ZZZZ | | -- | 1 |
| 07-TC-0000 | | | 1 |
| 07-TC-6403 | S < | TOP CABINETS, - Standard, 72" Headroom | 1 |
| | | NOTE: Cabinet A, B & D to be Three Equal Sized Cabinets | |
| 07-TC-A643 | | -- Cabinet A: Standard (72" HR) | 1 |
| 07-TS-1200 | S < | -- Shelf Track: Small alum Unistrut type | 1 |
| | | NOTE: All Cabinet Shelving to be Through Bolted to Shelf Brackets With Acorn Nuts on Bottom | |

| PART NO | S | DESCRIPTION | QTY |
|------------|-----|--|-----|
| 07-CA-0608 | < | -- (2) Shelves: Adjustable mica over substrate with Alum Trim (1) Each side of Divider | 1 |
| 07-CB-DR50 | | -- Doors; Cabinet Secure Latch Restocking Sliding Window Top hinged | 1 |
| 11-X0-0016 | | -- Stowage rating label Secure Latch Restocking Sliding Window 30 pounds applied | 1 |
| 07-TC-B643 | S | -- Cabinet B: (72"HR) | 1 |
| 07-CB-DR31 | | -- Doors; Cabinet B Secure Latch Restocking Sliding Window Top hinged | 1 |
| 11-X0-0016 | | -- Stowage rating label Secure Latch Restocking Sliding Window 30 pounds applied | 1 |
| 07-TS-1200 | S < | -- Shelf Track: Small alum Unistrut type NOTE: All Cabinet Shelving to be Through Bolted to Shelf Brackets With Acorn Nuts on Bottom | 1 |
| 07-CA-0608 | < | -- (2) Shelves: Adjustable mica over substrate with Alum Trim (1) Each side of Divider | 1 |
| 07-ZZ-ZZZZ | | -- | 1 |
| 07-ZZ-ZZZZ | | -- | 1 |
| 07-WC-0000 | | | 1 |
| 07-WC-4420 | S < | WALL CABINET: NO CPR seat - Full Cabinets NOTE: Make Action Area Full Width to Eliminate Dead Space From Previous Units That Was Rear of the Action Area. Leave Fold Down Action Area Board the Same Size as Previous With Suction All the Way to Rear in Lower Section and The Space Above Suction will be for Customer to Install a Radio Speaker. ENGINEERING NOTE: Customer Will Need a Drawing of the A/A Area for Approval Before Being Built. | 1 |
| 07-WC-A441 | | -- Action Area: Standard | 1 |
| 07-CA-4800 | < | -- 1/2" Solid Surface A/A Tray The tray shall have a lip. The tray lip shall come up to the front and overlay the face. | 1 |
| 07-CA-4820 | | -- Gibraltar (Solid Surface) Material COLOR: Steel Gray Tempest 9194TM | 1 |
| 07-WC-AABD | | -- Action Area Board: Black Grip See Station No 6 for content | 1 |
| 07-ZZ-ZZZZ | | -- | 1 |
| 07-WC-C441 | | -- Cabinet C: Standard | 1 |
| 07-CB-DR37 | S | -- Doors; Cabinet C Secure Latch Restocking Sliding Window Top hinged | 1 |
| 11-X0-0016 | | -- Stowage rating label Secure Latch Restocking Sliding Window 30 pounds applied | 1 |
| 07-RF-0007 | | -- No Inside Access to Exterior Compartment | 1 |
| 07-TS-1200 | S < | -- Shelf Track: Small alum Unistrut type NOTE: All Cabinet Shelving to be Through Bolted to Shelf Brackets With Acorn Nuts on Bottom | 1 |
| 07-CA-0600 | | -- (1) Shelf: Adjustable with Alum Trim | 1 |
| 07-ZZ-ZZZZ | | -- | 1 |
| 07-WC-D014 | S | -- Cabinet D: No CPR seat | 1 |
| 07-CB-DR37 | | -- Doors; Cabinet D Secure Latch Restocking Sliding Window Top hinged | 1 |
| 11-X0-0016 | | -- Stowage rating label Secure Latch Restocking Sliding Window 30 pounds applied | 1 |
| 07-TS-1200 | S < | -- Shelf Track: Small alum Unistrut type NOTE: All Cabinet Shelving to be Through Bolted to Shelf Brackets With Acorn Nuts on Bottom | 1 |
| 07-CA-0608 | < | -- (2) Shelves: Adjustable mica over substrate with Alum Trim (1) Each side of Divider | 1 |
| 07-ZZ-ZZZZ | | -- | 1 |
| 07-WC-E003 | | -- Cabinet E: DELETE | 1 |
| 07-ZZ-ZZZZ | | -- | 1 |
| 07-WC-F000 | | -- Cabinet F: DELETE | 1 |
| 07-ZZ-ZZZZ | | -- | 1 |

| PART NO | S | DESCRIPTION | QTY |
|------------|------|--|-----|
| 08-SE-1704 | | -- P4 - 4-Point PER4MAX Restraint System - with replacement indicator WO/CPR | 1 |
| 08-SE-1719 | XS < | -- (2) Squad bench Above Per4max, (0) CPR Seat Below Per4max Black Belt Belt retractors must mount below the top of the seat. BELT-F151390 2 | 1 |
| | | NOTE: Seating Positions to be Located the Same Distance From the Head of the Bench as 19OF 24888-90G Even With M5 Compartment Being Narrower. | |
| | | NOTE: Seating Positions to Have At Least 9" Between Seating Positions on Bench | |
| 08-SE-SB70 | | -- S/B: (3) Sec patient restraints - 9" Sleeves Face of Bench | 1 |
| 08-SE-SB76 | | -- S/B: (3) Sec patient restraints - 5" Sleeves By Hinge | 1 |
| 00-20-0072 | | -- Per4Max Four-Point Seatbelts: Accept and Install Full Feature | 1 |
| ZZ-ZZ-ZZZZ | | -- | 1 |
| ZZ-ZZ-ZZZZ | | -- | 1 |
| 07-ZZ-ZZZZ | | | 1 |
| | | CABINET SET - CELL 4 - MOD | 1 |
| 08-00-00CP | | Sub Floor, 3/4" Composite, ILOS | 1 |
| ZZ-ZZ-ZZZZ | | -- | 1 |
| 08-00-FL31 | | Flooring: Lonplate II - #424TX (Textured) Gun Powder | 1 |
| 08-00-FL01 | | -- Flooring Main Edge: 3" Recessed (1/2" deep) roll-up | 1 |
| 08-AS-0001 | < | -- Rear Threshold, Stainless, 6" Wide x Full Width at rear doors Install safety yellow with diagonal stripes nonskid tape over threshold. | 1 |
| 08-AS-0006 | S < | -- C/S Stepwell Threshold, Smooth Aluminum ILOS NOTE: Install Smooth Aluminum Angle on Mid Step IATS and Install Install safety yellow with diagonal stripes nonskid tape on Both Aluminum Thresholds and Along Bottom Stainless Door Sill | 1 |
| ZZ-ZZ-ZZZZ | | -- | 1 |
| 08-ZZ-ZZZZ | | -- | 1 |
| 08-CS-0001 | | COT MOUNT HARDWARE: (Full Size Mod) | 1 |
| 08-CR-09PP | < | -- Cot Mount: Stryker, No 6390, Power Load, Prep ONLY >>NON COMPLIANT << | 1 |
| | | This will have everything need for Customer/Dealer to install the Stryker Power Load system at a later date. Constant hot and ground service power provided, Prep will include, installation of Floor Plate Kit THIS DOES NOT INCLUDE ANY COT MOUNT >>>>> EXCEPTION TO 3.11.6 >> THIS is an incomplete installation, an exception is required, NON COMPLIANT installation. | |
| 08-CR-0420 | | -- Non-Compliant to SAE J3027, J3102 3.11.6 Patient Cot Mount Notice | 1 |
| 08-CR-0421 | | -- Non-Compliant to SAE J3027, AMD 004 CAAS GV 1.0 C.11.6 | 1 |
| 08-CR-09PN | | -- mass casualty kit not requested | 1 |
| 08-CR-1001 | S < | -- 12v power for cot mount provided up through floor 12volt power for power load to be brought through floor, with Heat shrink connectors installed | 1 |
| | | NOTE: Run Wire for Power Load Through the Floor Like We Did In 2017 Per Customer Request. | |
| 08-CS-00PM | S < | -- Cot Position No 1: PRIMARY SIDE POSITION ONLY Maintain 12" between Cot and S/B. | 1 |
| | | NOTE: Mount As Close to Street Side Wall But Have Enough Room for Wheel to Turn Without Hitting the Wall. | |
| 08-CS-2000 | < | -- Primary Cot position under floor reinforcement Install 8 inch wide by 5 long 1/2" aluminum reinforcement at primary cot position. (Primary cot position only - REV Std) **If custom location is desired, must be specified below. | 1 |

| PART NO | S | DESCRIPTION | QTY |
|------------|-----|---|-----|
| 08-CS-3009 | | -- Cot mount set up for: Stryker Power-Pro 6506 | 1 |
| ZZ-ZZ-ZZZZ | | -- | 1 |
| 08-CS-19U1 | | -- Q Straint System: NONE | 1 |
| 08-OS-04ST | | OXYGEN / AIR / VACUUM System: | 1 |
| 07-DR-LX03 | S | -- Oxygen Viewing Window ILOS With South Co. Latch | 1 |
| 07-HW-SO11 | | -- Round Pull Latch: Non-locking - Chrome Finish | 1 |
| 11-X0-0010 | | -- Stowage rating label - Southco round latch 10 pounds applied each | 1 |
| 08-OS-0401 | | -- Oxygen Outlet No 1: Amico Console - Ohmeda/Ohio Diamond Style | 1 |
| 08-OS-040A | | -- LOCATION: Action Area | 1 |
| 08-OS-0402 | | -- Oxygen Outlet No 2: Amico Console - Ohmeda/Ohio Diamond Style | 1 |
| 08-OS-040A | | -- LOCATION: Action Area | 1 |
| 08-OS-0403 | | -- Oxygen Outlet No 3: Amico Console - Ohmeda/Ohio Diamond Style | 1 |
| 08-OS-040D | | -- LOCATION: Curbside Wall, over the head of the S/B | 1 |
| 08-OS-0404 | | -- Oxygen Outlet No 4: Amico Console - Ohmeda/Ohio Diamond Style | 1 |
| 08-OS-040F | S < | -- Location;ABS recess housing installed in Center Ceiling Pad Over Head/Chest Area Recessed pocket for Oxygen outlet to protect flow meter Gray vacuum formed ABS installed | 1 |
| 08-OS-0904 | < | -- Port Cyl Rack No 1: Zico QR-D-2 - D or Jumbo D - No Strap Req Through bolt the rack to metal. | 1 |
| ZZ-ZZ-ZZ01 | S | -- Location: Recessed in C/S Step Well | 1 |
| ZZ-ZZ-ZZZZ | | -- | 1 |
| 08-OS-0905 | < | -- Port Cyl Rack No 2: Zico QR-D-2 - D or Jumbo D - No Strap Req Through bolt the rack to metal. | 1 |
| ZZ-ZZ-ZZ01 | S | -- Location: Recessed in C/S Step Well | 1 |
| ZZ-ZZ-ZZZZ | | -- | 1 |
| 08-OS-1331 | < | -- Rack No 1: Adjustable AEV O2 Rack Green with 4 Ratchet Straps M/H Fits cylinders 7" diameter or more. | 1 |
| 08-OS-11G1 | < | -- Cylinder Type: OXYGEN - Green Colored Hose Regulator connection Nut: 9/16" RH thread. | 1 |
| 08-OS-1301 | S | -- Rack Location: M1 Compartment Centered on Wall #2 | 1 |
| 08-OS-132M | | -- Set up For M cylinder | 1 |
| 08-OS-1710 | < | -- Regulator, Oxygen, Fixed output @ 50 psi +/-5 , CGA 540, Installed STD Installed on O2 line for pressure test, Tagged with Inspector signature/Date | 1 |
| 08-OS-1902 | | -- Regulator Wrench: Cast aluminum, OXYGEN w/ cable lanyard | 1 |
| 08-OS-3605 | S < | -- O2 Regulator Extension 5' Stainless Steel Braided Line Mounted on Wall #2 Above O2 Rack With Regulator and Sensor Wires | 1 |
| ZZ-ZZ-ZZZZ | | -- | 1 |
| 08-OS-35ST | | -- Vacuum System: SSCOR regulator/gauge panel in A/A | 1 |
| 08-OS-3501 | S < | -- Collection Canister w Clip: Bemis, 1200 CC Capacity -J3043 retention compliant LOCATION: In Action Area, to the left of A/A console box and mounted to A/A console box so canister faces the rear of the truck. with SSCOR canister retention clip | 1 |
| 08-OS-3502 | | -- VAC Plumbing: Direct from panel to canister - NO Outlet | 1 |
| 08-OS-3503 | | -- Vacuum Pump: 49 State | 1 |
| 08-OS-35L4 | | -- Location: M-2 Compartment | 1 |
| ZZ-ZZ-ZZZZ | | -- | 1 |
| 08-OS-3600 | S < | -- (2) Oxygen Regulator CGA 540,3000 PSI, Sensor with LED Amico Alarm Display ILOS Install Display at action area and on Driver Side of Console Down Low. NOTE: No Excess Wiring Hanging Down in M1 Compartment | 2 |
| ZZ-ZZ-ZZ01 | S | -- Location: (1) in Action Area & (1) on Driver Side of Console Down Low | 2 |

| PART NO | S | DESCRIPTION | QTY |
|------------|-----|--|-----|
| 08-ZZ-ZZZZ | | TRIM / DOOR ASSEMBLY - CELL 5 | 1 |
| 04-TS-HOOZ | S | -- (2) Hooks, Equipment, Fastenal Rope Hook , Installed | 2 |
| ZZ-ZZ-ZZ01 | S | -- Location: Mounted in Cab at Mid Line or Final Inspection | 2 |
| 09-00-002S | | -- Interior window and aluminum trim with standard satin finish- std | 1 |
| 09-GL-0002 | S < | -- Binder Holder Diamond Plate Custom Diamond Plate Binder Holder to be 12" Wide x 9 1/2" Tall x 5" Deep | 1 |
| | | Mount on Cabinet "H" Behind Attendant Seat and Through Bolted to Cabinet. | |
| 09-00-0001 | | | 1 |
| 09-00-0002 | | *****DOOR DEPARTMENT - Full Mod***** | 1 |
| 02-BT-C853 | | -- Handles, Ext: Tri-mark 030-1875, Free Float, Polished CNNC finish | 1 |
| 02-BT-C85A | | -- Interior Release: All Entry Doors, with bezel Emergency Access | 1 |
| 09-MH-2531 | < | -- Grab Rail, (1), 18" Yellow Antimicrobial Rear Entry Assist std. Located : Module interior at the rear entry, mounted to the M5 compartment filler. Rail is to be through bolted into M5. | 1 |
| 09-MH-2702 | | -- Grab Rail, C/S wall, curve out over C/S Entry, NONE | 1 |
| ZZ-ZZ-ZZZZ | | -- | 1 |
| 09-B1-ED00 | | Entry Door Panels, Windows and Hardware | 1 |
| 08-MH-0020 | | -- Interior Grab Handle Color: Yellow Antimicrobial | 1 |
| 08-MH-03B6 | | -- Grab Handle, CS Entry: 1 1/4" Dia..... S/S, 2-pt 18"L, Yellow Antimicrobial | 1 |
| 08-MH-03D6 | | -- Grab Handles, Rear Access: (2) 12"L X 1 1/4" Dia..... S/S, 2-pt, Yellow Antimicr | 1 |
| 09-MH-2520 | S < | -- Grab Rail, (1), 18" IATS, Yellow Antimicrobial Located : On RF ALS Inside C/S Entry Door | 1 |
| 09-MH-2706 | | -- Grab Rail, C/S wall, curve out over C/S Entry, Yellow Antimicrobial | 1 |
| 09-AS-2401 | S < | -- Door Panels: Diamond Plate / Upholstery / Smooth Aluminum Dealer to Install Chevrons on Lower Door Panels | 1 |
| 09-AS-2535 | | -- Curbside Lower Door Panel: Smooth Aluminum | 1 |
| 09-WI-02A0 | < | -- UPPER Windows: RA Doors, Fixed Tinted Glass 17.3"W x 19.3"H WIND-H0161 | 1 |
| 09-WI-0600 | | -- UPPER Window: CS Access, Fixed Glass, std tint | 1 |
| 09-DR-WT00 | | Talk Through Window: Sliding Lexan Window - CLEAR | 1 |
| 09-DR-WT20 | | -- Sliding Window Locking Pin: 1/4" with Lanyard | 1 |
| 09-FM-1093 | | -- Dri-Dek Compt Floors and shelves, Black | 1 |
| 09-FM-11F0 | | -- Dri-Dek EDGES: Black, Beveled frontal edges | 1 |
| ZZ-ZZ-ZZZZ | | -- | 1 |
| 07-ZZ-ZZZZ | | -- | 1 |
| 09-ZZ-ZZZZ | | | 1 |
| | S < | ELECTRICAL Point to Point - CELL 6 ENGINEERING NOTE: Send A/A Layout for Approval | 1 |
| 10-EC-275D | S < | -- Temp Controlled Cabinet, Mermaid MK Dual Temp- Horizontal, Micro depth Stainless Steel Part No: REFR-MKDUALSSM, dual temp, Dual Compressors, >> NO drain outlet installed by the factory, per factory design of Mermaid. 02/14/2017 >>>Unit has DUAL Compressors, Compressors mounted on Rear NOTE: To Have Two Separate Power Wires and Control Panels Mounted on the Side of Cabinet I-1 at Top. Pan Cake Fan to be Tied to Mermaid Compressors if Possible so Fan Only Works When Needed and Not Running All the Time. | 1 |
| 10-EC-2905 | < | -- Mermaid Standard Medeco Cam key Lock Installed Includes TWO Medeco coded barrel keys. | 2 |
| 10-EC-3200 | S | -- Location: Cabinet I-1 | 1 |
| 10-EC-A100 | | -- Accessory Load Manager: For Cooling Cabinet or Fridge | 1 |
| 11-YZ-0907 | < | -- Non-Compliant to 3.11.3 J3058, cabinets Not Tested, to SAE J3058 No Rating Item is not tested to J3058, or not rated. | 1 |

| PART NO | S | DESCRIPTION | QTY |
|------------|-----|---|-----|
| 11-ZZ-0903 | < | CAAS Exception to C.11.3 Storage Compartments and Cabinets Design An Exception has been taken to one of the following conditions; C.11.3. subpart 4 Doors shall have positively locked latches that are designed to remain closed during transports. | 1 |
| 10-IL-02ST | | Action Area Light: 12V, LED, Surface Mount | 1 |
| 10-IL-02L7 | | -- Light Location: Action Area | 1 |
| 10-IL-03SK | S < | Cabinet "H Light: 12V, Kinequip, 12", LED Light Wired Constant Hot and Mounted on Ceiling Centered in Cabinet | 1 |
| 10-IL-02L2 | S | -- Light Location: Inside Cabinet "H" on Ceiling | 1 |
| | | UPHOLSTERY - CELL 7 | 1 |
| 11-00-UC04 | | Upholstery Color: Light Gray(Dove) Vac form | 1 |
| 11-00-UC11 | | -- Center Trough Upholstery Color: Color Key to Rest of Truck | 1 |
| ZZ-ZZ-ZZZZ | | -- | 1 |
| 11-00-UT05 | | Uph Joint Type: Vacuum Formed - Seamless | 1 |
| 11-SB-0005 | | Squad Bench seat cushion cut-outs: None | 1 |
| 11-SB-0003 | | -- Post And Wheel Cups: NONE | 1 |
| 11-SE-CSPD | | Head Protection: Pad over CS Entry Door | 1 |
| 11-SE-REPD | | Head Protection: 2" Pad over Rear Access Doors, Full Width | 1 |
| | | PAINT - STRIPES - DECALS | 1 |
| 12-PT-UNCT | | -- Undercoating : Per QVM Guidelines, STD | 1 |
| 12-DC-0001 | | Reflective Tape: White Reflective On Painted edges of Exterior Door Frame | 1 |
| 12-DC-GA10 | | Compartment Finish: Diamond Plate Standard | 1 |
| 12-PT-0100 | S < | Primary (Over All) Color: White (YZ) and Red 501D4 in 650 Red to be 1 1/2" below warning lights up on box Rear skin to be white Red on hood and top of cab Red to follow fender line on front to come approx. 1" above door handle Roof Skin to be white Paint Code 501D4 in 650 Reference 19OD 24888-90G | 1 |
| 12-DC-0002 | | -- Flip Step Reflective/Prismatic Tape: Red/White/R/W/R/W/R | 1 |
| 12-PT-0112 | | -- Tape Stripe: NONE (KKK-F Deviation) | 1 |
| 11-YZ-0962 | | -- Non-Compliant to KKK-F 3.16.2 ;Exterior Safety stripe to be Orange | 1 |
| 12-PT-0600 | | -- Paint Belt: NONE | 1 |
| 12-PT-1000 | | -- Pin Stripe: NONE | 1 |
| 12-ZZ-ZZZZ | | -- | 1 |
| 12-PT-RF01 | S < | Roof Paint: White Color and finish quality to be GLOSSY White Picture Frame Roof Not Seen From Ground | 1 |
| ZZ-ZZ-ZZZZ | | -- | 1 |
| 12-PT-1301 | | Special Striping: Chevron Items: NONE | 1 |
| 12-PT-2000 | | Lettering: NONE | 1 |
| 12-ZZ-ZZZZ | | -- | 1 |
| 12-PT-DRIS | < | Drip Rails: Bright Alum, De-burred & rounded corners (SHIPPED LOOSE) Include a drip rail over the C/S Entry Door shipped loose. Add Shop Note to Shipped Loose Section of W/O | 1 |
| 12-ZZ-ZZZZ | | | 1 |
| | | DETAIL - SHIP LOOSE ITEMS | 1 |
| 12-PT-DRIZ | < | -- Drip Rails: Detail-Refer to Paint Section for Drip Rail Information Include a drip rail over the C/S Entry Door. | 1 |
| 13-00-0200 | | -- *Check front of W/O under chassis section for Add' items* | 1 |
| ZZ-ZZ-ZZZZ | | -- | 1 |
| 13-10-XM00 | | -- Owner's Manual USB Flash Drive ship loose | 1 |
| 13-10-XMA0 | | -- Printed Owner's Manual Not Required | 1 |
| 34-OS-1402 | | -- Amico O2 Minder, Transducer, ship loose | 1 |

| PART NO | S | DESCRIPTION | QTY |
|---------------------------|-----|---|-----|
| 13-00-0001 | | | 1 |
| 13-GL-0000 | | Glove Holder, Ship Loose: NONE | 1 |
| ZZ-ZZ-ZZZZ | | -- | 1 |
| 13-KK-KDEC | | Decals: KKK / DOT Pkg, Blue/White reflective - Ship Loose | 1 |
| 13-RF-STAS | | -- Decals: 32" Star of Life - Ship Loose | 1 |
| ZZ-ZZ-ZZZZ | | -- | 1 |
| 13-KK-NSSB | | Decals: NO SMOKING & SEATBELT, installed, cab & pt. area. | 1 |
| ZZ-ZZ-ZZZZ | | -- | 1 |
| 13-KL-0010 | | AEV Logos: Installed on unit per AEV standard locations | 1 |
| 13-MH-05ST | | Fire Extinguisher, 5 pound, shipped loose, Std | 1 |
| 11-YZ-0932 | < | -- Exception to 3.15.2 Required Two fire extinguishers installed by FSAM Fire extinguishers were not installed with one in the driver's cab, one in the patient compartment at the time of departure from the final stage Ambulance Manufacturer. The customer/FSAM has shipped them loose for the dealer to complete the final install. | 1 |
| 11-ZZ-0932 | < | -- Exception to C.16.1 1 Required Two fire extinguishers installed by FSAM Fire extinguishers were not installed iwth one in the driver's cab, one in the patient compartment at the time of departure from the final stage Ambulance Manufacturer. | 1 |
| 13-MH-10A0 | | Reflector Pkg: Body - 2ea, Side Fr Amber, Side Rear Red, Rear Red | 1 |
| ZZ-ZZ-ZZZZ | | -- | 1 |
| 13-SB-0003 | | Post And Wheel Cups: NONE | 1 |
| 13-SP-TIRE | | Spare Tire: Refer To Chassis Section to See if it gets one. | 1 |
| 34-OS-1500 | S < | <i>(4) Flow Meter Thorpe-Tube style 0-15 LPM Oxygen, Ohmeda/Ohio latch, ship loose</i> 0-15 LPM Thorpe vertical Tube style Oxygen green flow meter Ohmeda/ Ohio latch connection | 4 |
| 34-SO-0034 | S | <i>Ship loose 30 amp Auto Eject connecting plug only, EACH Additional</i> | 2 |
| 34-XX-0001 | | Primary Cot: NONE included | 1 |
| ZZ-ZZ-ZZZZ | | -- | 1 |
| 34-XX-0002 | | Secondary Stretcher: NONE included | 1 |
| ZZ-ZZ-ZZZZ | | -- | 1 |
| 34-XX-5000 | < | Indemnification Statement The purchaser agrees to defend, indemnify and hold REV harmless from any claims, costs (including actual attorneys' fees), damages and liabilities caused in whole or in part by any alteration or modification of, or changes or additions to the Purchased Products OR use of product for purposes it was not designed or intended for. | 1 |
| GENERAL CONVERSION | | | 1 |
| 03-09-2032 | S | <i>2022 **172*** F-550 4 x 2 Regular Cab Gasoline Conv PKG - 21-1</i> | 1 |
| 36-AA-0001 | | WORK ORDER STATUS: | 1 |
| 00-90-0301 | | -- For Confirmation | 1 |
| 36-CO-0001 | | -- CHANGE ORDER POLICY | 1 |
| 36-CO-0010 | < | -- After Confirmation, Prior to Engineering Change Fee is \$50 Per Item, Plus Option Cost | 1 |
| 36-CO-0020 | < | -- After Confirmation, After Engineering Start Change Fee is \$100 Per Item, Plus 150% Option Cost > Special order or non-stocking parts that are purchased for any ordered option that is subsequently deleted will be charged for and shipped loose. | 1 |
| 36-CO-0030 | < | -- After Confirmation, After Production Start Change Fee is \$100 Per Item, Plus 200% Option Cost Additional labor charges above option costs may apply depending upon level of installation of affected part. Special order or non-stocking parts that are purchased for any ordered option that is subsequently deleted will be charged for and shipped loose. >> Changes after production starts are the most disruptive. | 1 |
| ZZ-ZZ-ZZZZ | | -- | 1 |

CONCEPTUAL DRAWINGS ONLY: DRAWINGS ARE NOT TO SCALE, ALL MEASURES ARE APPROXIMATE & SUBJECT TO ENGINEERING CHANGE

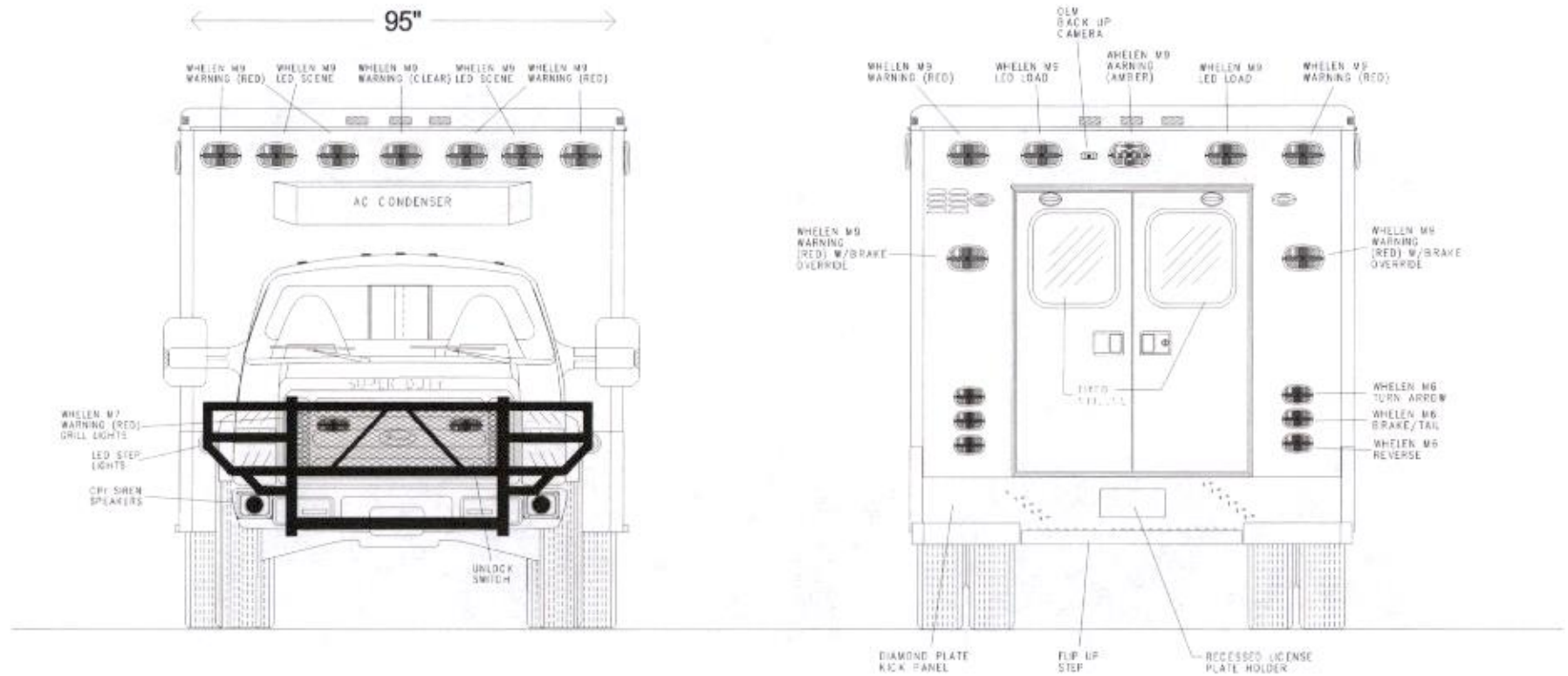

*CONCEPTUAL DRAWINGS
 * Some shown are optional
 * Due to AEV's ongoing improvements, drawings can change.



| | |
|-----------------------------|-----------------------|
| AMERICAN EMERGENCY VEHICLES | |
| TITLE | Type 1, 172, Exterior |
| DWG.# | REV# |
| BY:MDB | DATE:6-16-21 |
| Customer: | Levy Co. |



CONCEPTUAL DRAWINGS ONLY: DRAWINGS ARE NOT TO SCALE, ALL MEASURES ARE APPROXIMATE & SUBJECT TO ENGINEERING CHANGE

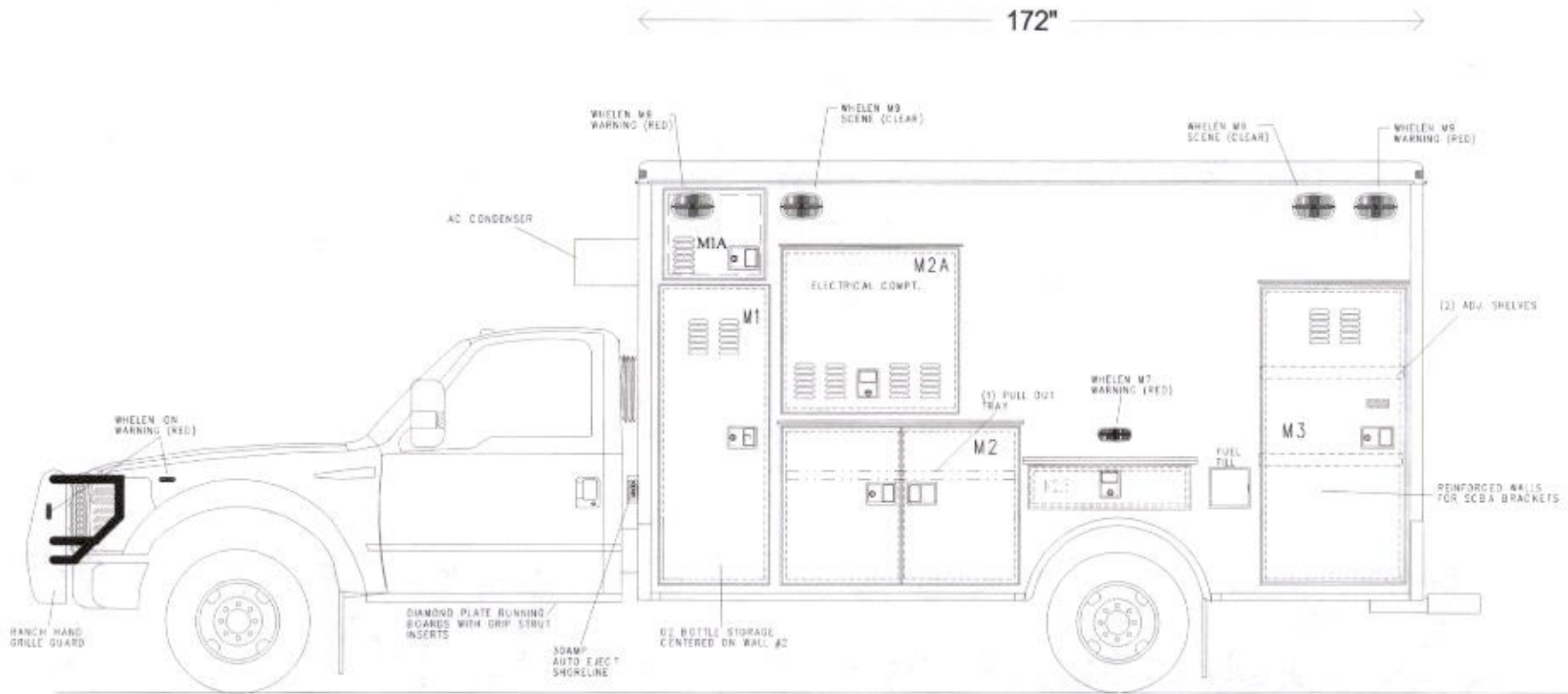

| Compartment Dimensions | | | |
|------------------------|--------|--------|-------|
| Cmpt | Height | Width | Depth |
| M1 | 61.5" | 22.1" | 19.5" |
| M1A | 17.5" | 22.1" | 19.5" |
| M2 | 35" | 49.75" | 19.5" |
| M2A | 22.3" | 37" | 6" |
| M2.5 | 10.5" | 30.25" | 19.5" |
| M3 | 61.5" | 32" | 19.5" |

*CONCEPTUAL DRAWINGS
 * Some shown are optional
 * Due to AEV's ongoing improvements, drawings can change.

AEVE

AMERICAN EMERGENCY VEHICLES

| | |
|-----------|----------------------|
| TITLE | Type L 172, Exterior |
| DWG# | REV# |
| BY/MB | DATE: 6-16-21 |
| Customer: | Levy Co. |



CONCEPTUAL DRAWINGS ONLY: DRAWINGS ARE NOT TO SCALE, ALL MEASURES ARE APPROXIMATE & SUBJECT TO ENGINEERING CHANGE

← 172" →

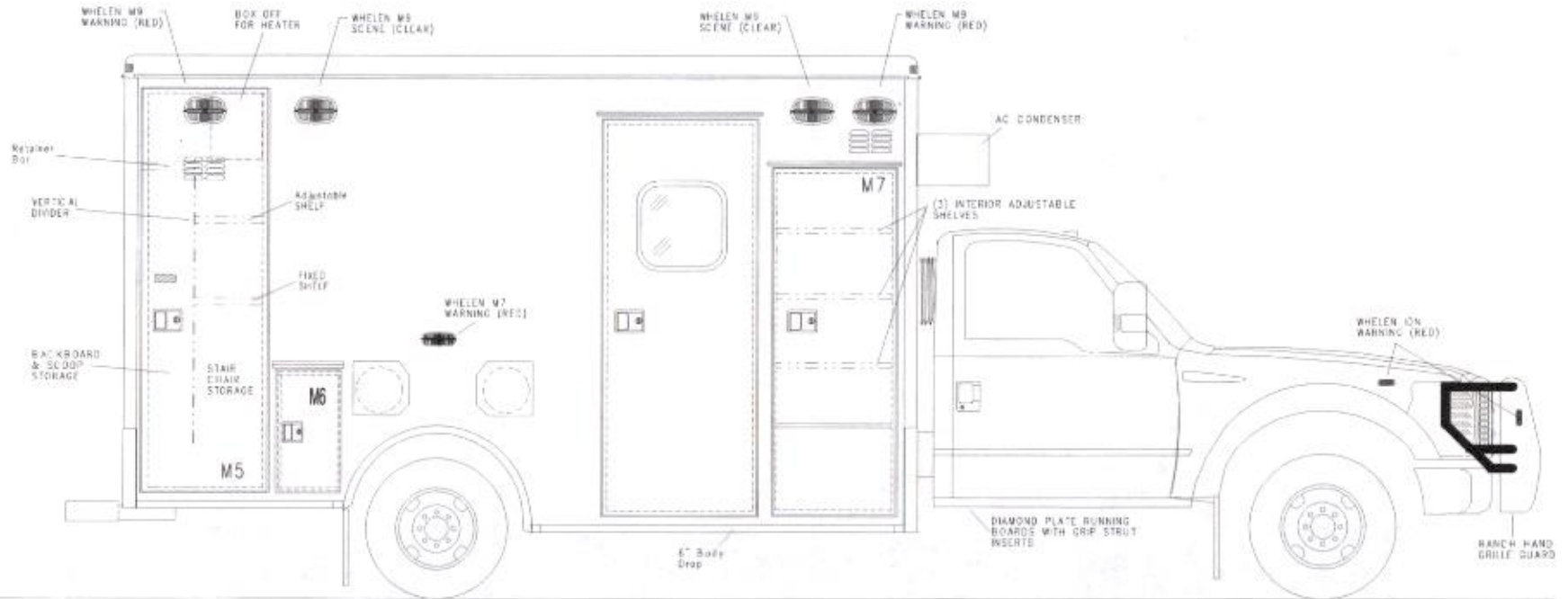

| Compartment Dimensions | | | |
|------------------------|---------|---------|-------|
| Comp | Height | Width | Depth |
| M5 | 82.8" | 21" | 21" |
| M6 | 19" | 11.5" | 19.5" |
| M7 | 72" | 25.25" | 1/0 |
| C/S Access | 82.8" | 31" | |
| Rear Access | 60 5/8" | 46 3/4" | |
| | | | |
| | | | |

*CONCEPTUAL DRAWINGS
 * Some shown are optional
 * Due to AEV's ongoing improvements, drawings can change.

AEVE

AMERICAN EMERGENCY VEHICLES

| | |
|-----------|-----------------------|
| TITLE | Type 1, 172, Exterior |
| DWG # | REV # |
| BY:MDB | DATE 6-16-21 |
| Customer: | Levy Co. |

CONCEPTUAL DRAWINGS ONLY: DRAWINGS ARE NOT TO SCALE, ALL MEASURES ARE APPROXIMATE & SUBJECT TO ENGINEERING CHANGE

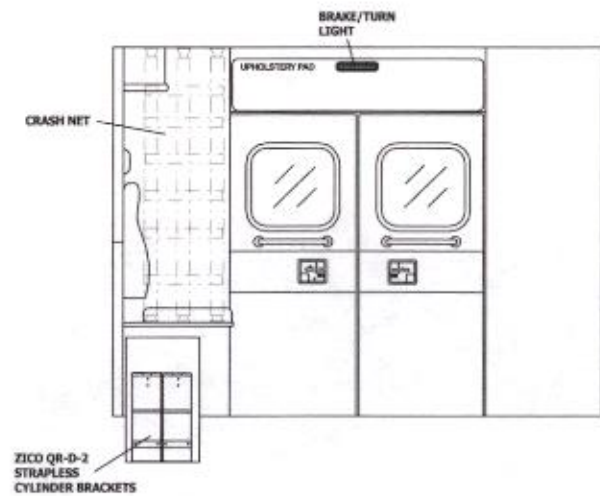
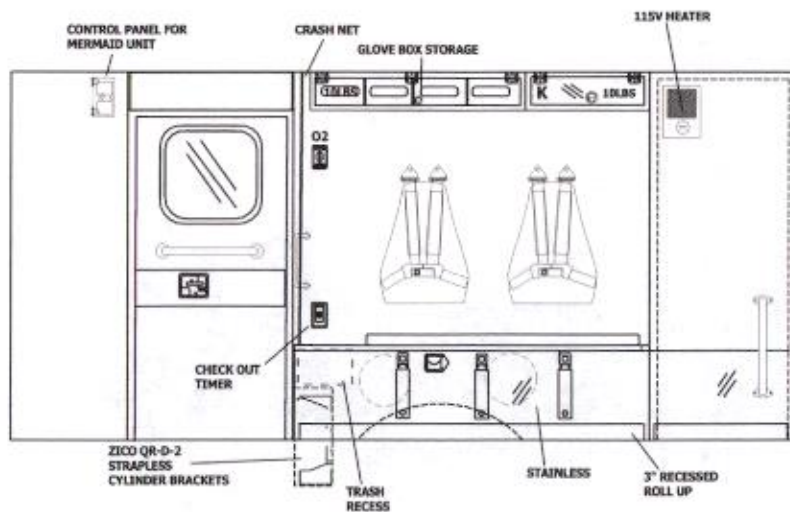
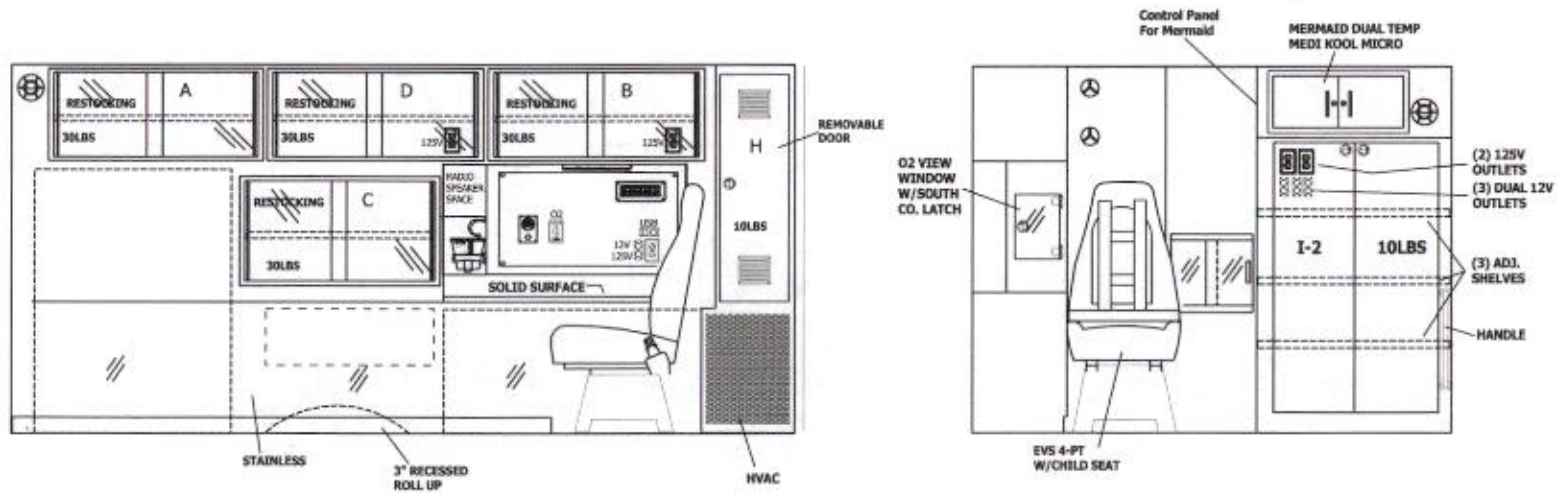

| | | |
|--|--|--|
| | | |
| | | |
| | | |
| | | |
| | | |
| | | |
| | | |
| | | |
| | | |
| | | |

*CONCEPTUAL DRAWINGS
 * Some shown are optional
 * Due to AEV's ongoing improvements, drawings can change.

AEV

| | |
|-----------------------------|-----------------------|
| AMERICAN EMERGENCY VEHICLES | |
| TITLE | Type 1, 172, Interior |
| DWG.# | REV |
| BYNDB | DATE: 6-16-21 |
| Customer: | Levy Co. |