

C326 FROM US19 TO POWERLINE AT CRYSTAL WATER

11/24/2025

ENGINEER'S ESTIMATE OF CONSTRUCTION COSTS

<u>ITEM NO</u>	<u>ITEM DESCRIPTION</u>	<u>UNIT</u>	<u>QUANTITY</u>	<u>UNIT PRICE</u>	<u>EXTENDED</u>
101-1	MOBILIZATION	LS	0.1	4,377,753.05	\$437,775.31
102-1	MAINTENANCE OF TRAFFIC	LS	0.1	4,377,753.05	\$437,775.31
104-13	STAKED SILT FENCE	LF	5000	4.00	\$20,000.00
110-1	CLEARING AND GRUBBING	ACRES	23	14,000.00	\$322,000.00
120-6	EMBANKMENT	CY	2275	35.00	\$79,625.00
160-4	SHOULDER STABILIZATION	SY	36031	6.65	\$239,606.15
285-7-1	OPTION BASE GROUP 4 (SHOULDER PAVING BASE	SY	15013	55.00	\$825,715.00
286-1	TURN OUT CONSTRUCTION	SY	2236	61.00	\$136,396.00
327-70	MILL EXISTING SURFACE	SY	66056	\$4.50	\$297,252.00
334-1	SUPERPAVE ASPHALTIC CONCRETE	TON	9617	170.00	\$1,634,890.00
339-1	MISCELLANEOUS ASPHALT	TON	24	500.00	\$12,000.00
430-17-2-1	CROSS DRAIN REPLACEMENT	LF	238	550.00	\$130,900.00
430-17-2-2	SIDE DRAIN REPLACEMENT	LF	400	300.00	\$120,000.00
430-982-1	MITERED END SECTION - CROSS DRAINS	EA	14	4,000.00	\$56,000.00
430-982-2	MITERED END SECTION - SIDE DRAINS	EA	20	3,000.00	\$60,000.00
536-1-1	GUARDRAIL	LF	1000	30.00	\$30,000.00
536-7	SPECIAL GUARDRAIL POST	EA	16	500.00	\$8,000.00
536-73	GUARDRAIL REMOVAL	LF	400	10.00	\$4,000.00
536-85-22	GUARDRAIL END ANCHORAGE ASSEMBLY	EA	8	4,300.00	\$34,400.00
546-71	RUMBLE STRIPS (RAISED)	SET	4	1,400.00	\$5,600.00
575-1	PERFORMANCE TURF - SODDING	SY	21018	4.00	\$84,072.00
575-2	PERFORMANCE TURF - SEED AND MULCH	SY	99084	1.30	\$128,809.20
700-1-11	SINGLE POST SIGN (NEW)	EA	60	730.00	\$43,800.00
706-3	RETRO REFLECTIVE PAVEMENT MARKER	EA	1183	7.90	\$9,345.70
711-16-101	THERMOPLASTIC, STANDARD, WHITE, SOLID, 6"	NET MI	10.2	6,800.00	\$69,632.00
711-16-201	THERMOPLASTIC, STANDARD, YELLOW, SOLID, 6"	NET MI	5.1	7,100.00	\$36,210.00
711-16-231	THERMOPLASTIC, STANDARD, YELLOW, SKIP, 6"	GROSS MI	3.8	2,500.00	\$9,500.00

BASE = \$5,273,303.66

Engineering	\$5,273,303.66	0.08	\$421,864.29
CEI	\$5,273,303.66	0.05	\$263,665.18

TOTAL 2025 COST ESTIMATE	\$5,958,833.14
TOTAL 2025 COST ESTIMATE WITH INFLATIONARY FACTOR =1.5% FOR 3 YEARS (2028)	\$6,231,022.95

PRELIMINARY COST ESTIMATE

1. Based on FDOT Historical Costs for September 2025 and recent County Bids
2. Existing pavement = 22'
3. Mill 1.5" existing, add 2' paved shoulders and resurface with 2".
4. Length = 5.118 miles

Prepared By: D. Andrew Carswell PE#45831
 Project Engineer-Levy County BOCC
 310 School Street, Suite 112
 Bronson, FL 32621
 Phone: 352-529-7832
 Email: carswell-andrew@levycounty.org

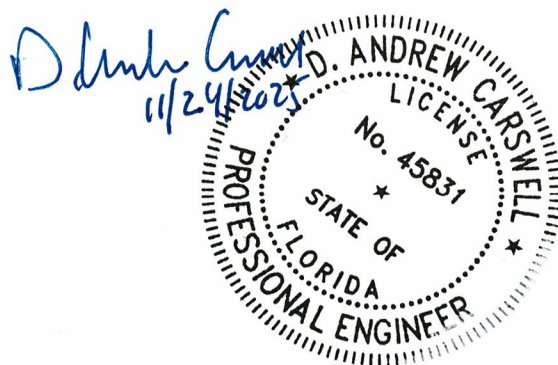

END PROJECT
MP 5.118
POWER LINE AT WEKIVA SPRINGS

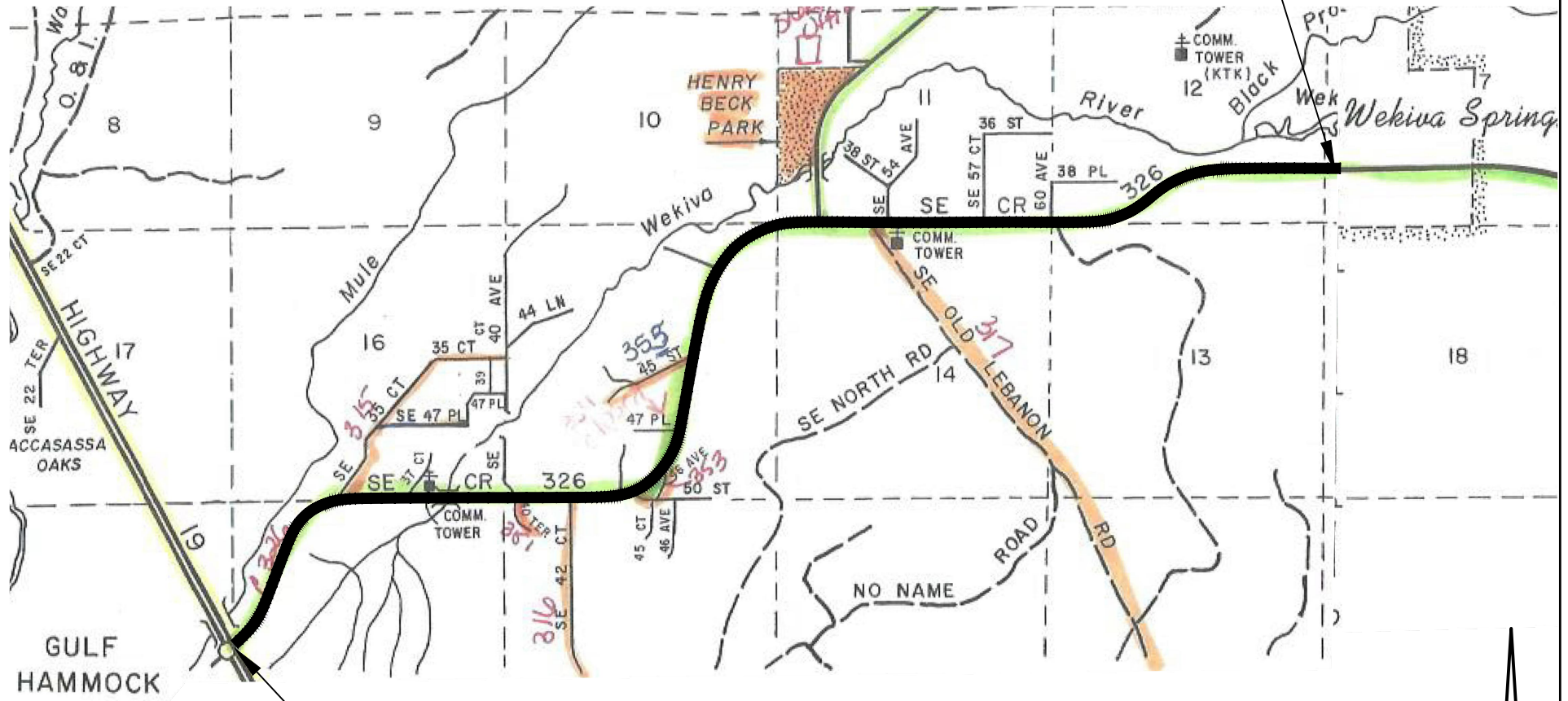

BEGIN PROJECT
MP 0.000
INTERSECTION WITH US19

EXISTING WIDTH = 22'
PROPOSED ADD 2' PAVED SHOULDER
LENGTH = 5.118 MILES±



D. ANDREW CARSWELL, PE
LEVY COUNTY BOARD OF COUNTY COMMISSIONERS
310 SCHOOL STREET, SUITE 112-BRONSON, FLORIDA 32621
PHONE: (352) 529-7832
Email: carswell-andrew@levycounty.org

C-326 - WEST
LEVY COUNTY, FLORIDA

DATE: 11/2025	PROJECT NO.: 2025025
DRAWN BY: AC	SHEET 1 OF 1

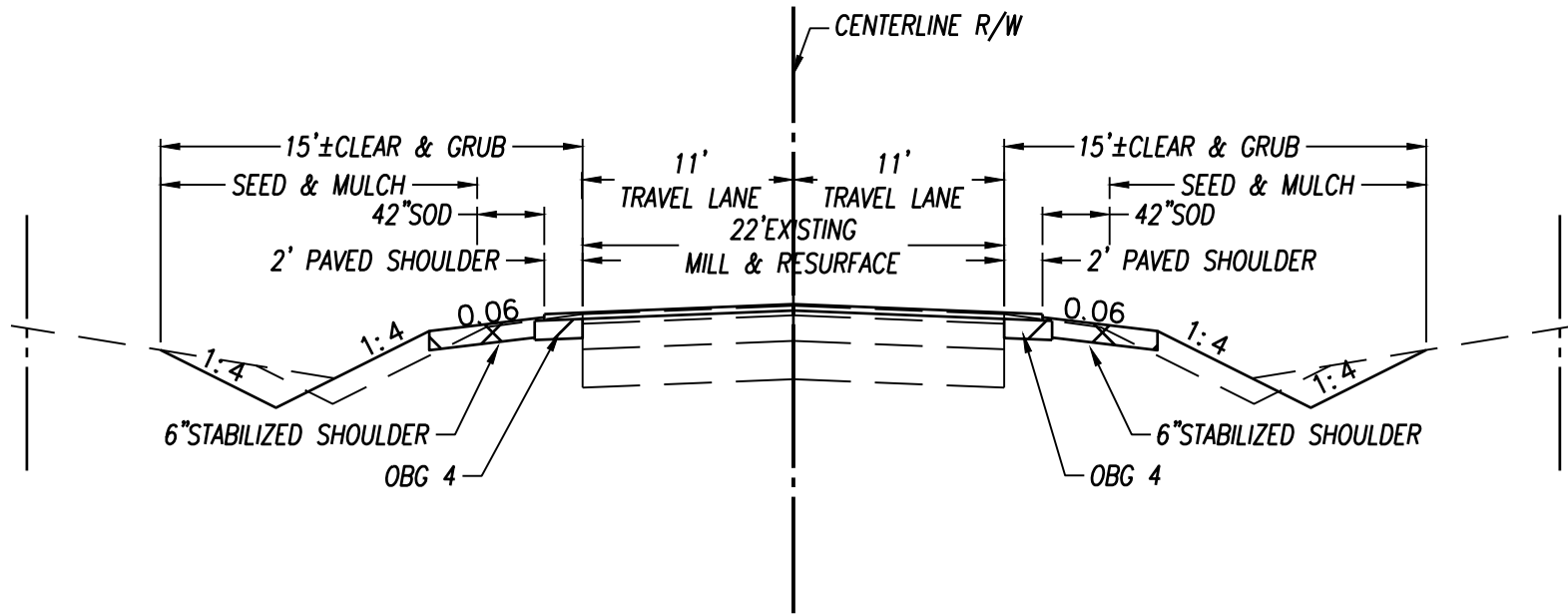

TYPICAL SECTION
MP 0.00 TO MP 5.118

MILLING

MILL 1.5" DEPTH AT EXISTING CROSS SLOPE

RESURFACING

TYPE SP12.5 STRUCTURAL COURSE (TL-C)(2")

PAVED SHOULDER

OPTIONAL BASE GROUP 4 WITH
TYPE SP12.5 STRUCTURAL COURSE (TL-C)(2")

TYPICAL SECTION 1

D. ANDREW CARSWELL, PE
LEVY COUNTY BOARD OF COUNTY COMMISSIONERS
310 SCHOOL STREET, SUITE 112-BRONSON, FLORIDA 32621
PHONE: (352) 529-7832
Email: carswell-andrew@levycounty.org

C-326 - WEST
LEVY COUNTY, FLORIDA

DATE: 11/2025	PROJECT NO.: 2025025
DRAWN BY: AC	SHEET 1 OF 1