

ENGINEER'S ESTIMATE OF CONSTRUCTION COSTS

ITEM NO	ITEM DESCRIPTION	UNIT	QUANTITY	UNIT PRICE	EXTENDED
101-1	MOBILIZATION	LS	0.1	5,695,136.85	\$569,513.69
102-1	MAINTENANCE OF TRAFFIC	LS	0.1	5,695,136.85	\$569,513.69
104-13	STAKED SILT FENCE	LF	3000	4.00	\$12,000.00
110-1	CLEARING AND GRUBBING	Acres	27.98	14,000.00	\$391,720.00
120-6	EMBANKMENT	CY	11376	35.00	\$398,160.00
160-4	SHOULDER STABILIZATION	SY	54173	6.65	\$360,250.45
285-7-11	WIDENING	SY	22572	40.00	\$902,880.00
286-1	TURN OUT CONSTRUCTION	SY	637	61.00	\$38,857.00
327-70	MILL EXISTING SURFACE	SY	81259	\$4.50	\$365,665.50
334-1	SUPERPAVE ASPHALTIC CONCRETE	TON	14039	170.00	\$2,386,630.00
339-1	MISCELLANEOUS ASPHALT	TON	73	500.00	\$36,500.00
430-17-5	CROSS DRAIN REPLACEMENT	LF	200	550.00	\$110,000.00
430-98-2	CROSS DRAIN REPLACEMENT END TREATMENT	EA	10	4,000.00	\$40,000.00
536-1-1	GUARDRAIL	LF	2000	45.00	\$90,000.00
536-7	SPECIAL GUARDRAIL POST	EA	50	500.00	\$25,000.00
536-73	GUARDRAIL REMOVAL	LF	1000	10.00	\$10,000.00
536-85-22	GUARDRAIL END ANCHORAGE ASSEMBLY	EA	20	4,300.00	\$86,000.00
575-1	PERFORMANCE TURF- SOD	SY	31911	4.00	\$127,644.00
575-2	PERFORMANCE TURF- SEED	sy	103521	1.30	\$134,577.30
700-11-1	SINGLE POST SIGN (NEW)	EA	46	730.00	\$33,580.00
706-3	RETRO REFLECTIVE PAVEMENT MARKER	EA	1494	7.90	\$11,802.60
711-16-101	THERMOPLASTIC, STANDARD, WHITE, SOLID, 6"	NET MI	12.9	6,800.00	\$87,720.00
711-16-201	THERMOPLASTIC, STANDARD, YELLOW, SOLID, 6"	NET MI	6.5	7,100.00	\$46,150.00
711-16-231	THERMOPLASTIC, STANDARD, YELLOW, SKIP, 6"	GROSS MI	4.8	2,500.00	\$12,000.00

BASE = \$6,846,164.22

Engineering	\$6,846,164.22	0.10	\$684,616.42
CEI	\$6,846,164.22	0.06	\$410,769.85

TOTAL 2025 COST ESTIMATE \$7,941,550.50
 TOTAL 2025 COST ESTIMATE WITH INFLATIONARY FACTOR =1.5% FOR 3 YEARS (2028) \$8,304,307.62

- PRELIMINARY COST ESTIMATE
1. Based on FDOT Historical Costs for 2024
 2. Existing pavement = 18'
 3. Widen to 22'
 4. 42" sod strip along edge of pavement
 5. Length = 6.466 miles
 6. Mill 1.5" existing, add widening, resurface with 2.5"
 7. Does not include extension of box culverts

Prepared By: D. Andrew Carswell PE#45831
 Project Engineer - Levy County BOCC
 310 School Street, Suite 112
 Bronson, FL 32621
 Phone: 352-529-7832

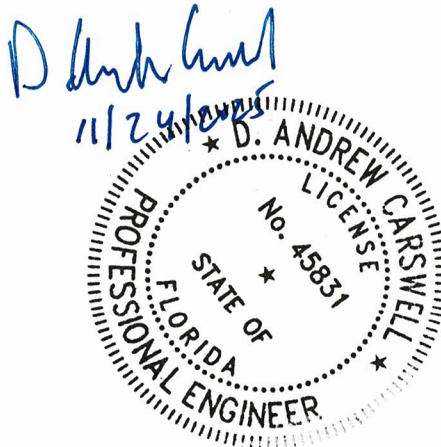

END PROJECT
INTERSECTION WITH C-330

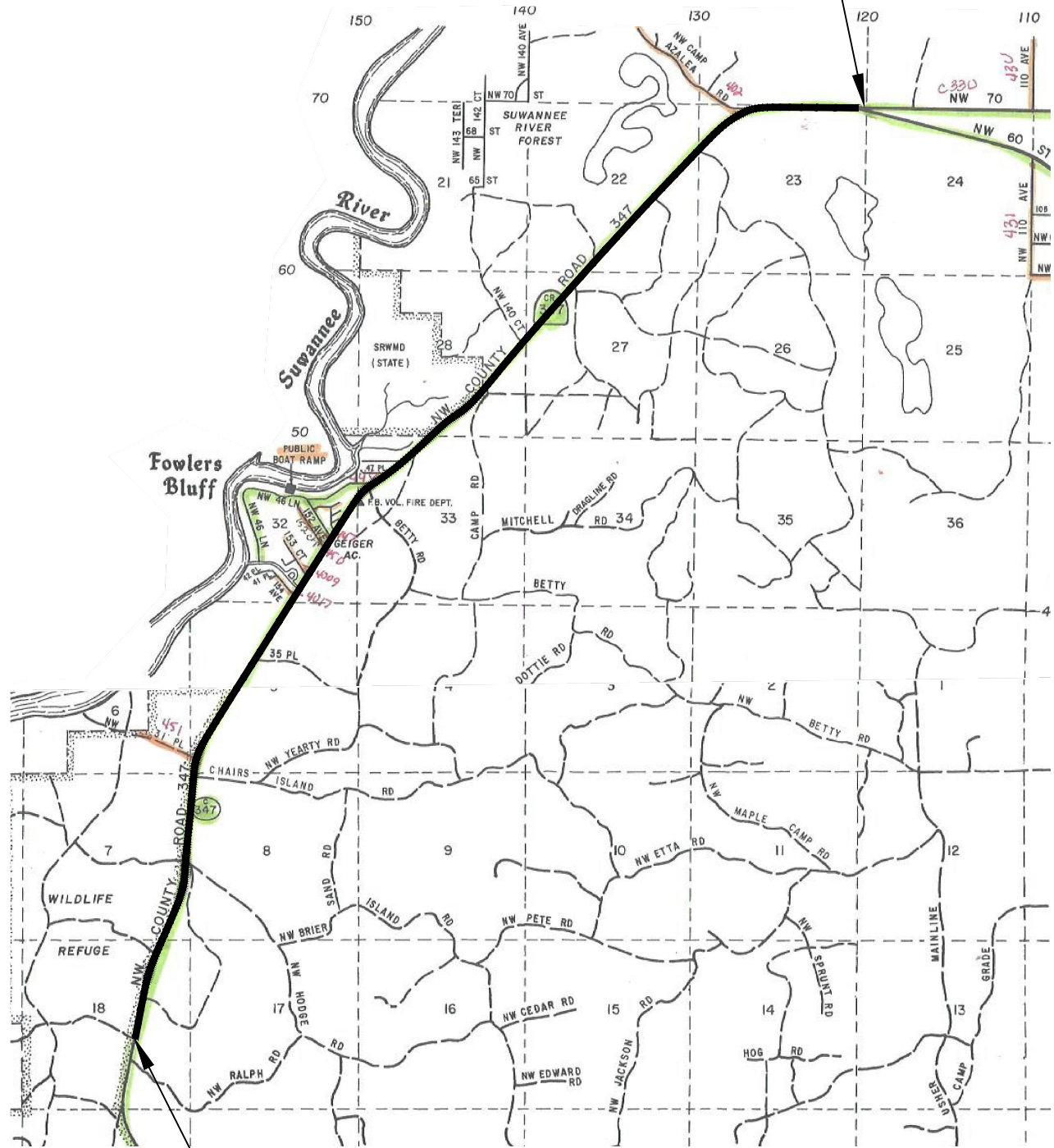

BEGIN PROJECT
MP 12.500

EXISTING WIDTH = 18'
PROPOSED WIDTH = 22'
LENGTH = 7.695 MILES±

D. ANDREW CARSWELL, PE
LEVY COUNTY BOARD OF COUNTY COMMISSIONERS
310 SCHOOL STREET, SUITE 112
BRONSON, FLORIDA 32621
PHONE: 352-529-7832 EMAIL: CARSWELL-ANDREW@LEVYCOUNTY.ORG

C-347 - NORTH
LEVY COUNTY, FLORIDA

DATE: 11/2025	PROJECT NO.: 2025025
DRAWN BY: AC	SHEET 1 OF 1

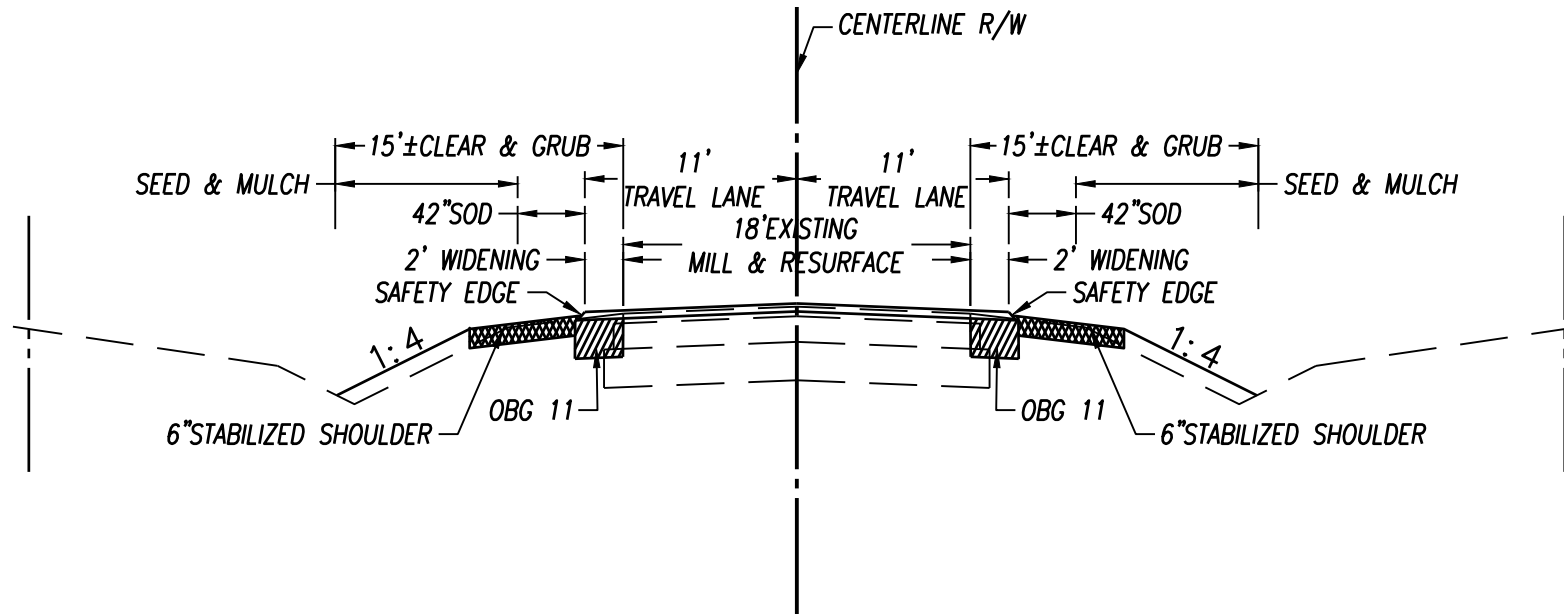

TYPICAL SECTION
 MP 12.500 TO MP 20.195

MILLING

MILL 1.5" DEPTH AT EXISTING CROSS SLOPE

RESURFACING

TYPE SP12.5 STRUCTURAL COURSE (TL-C)(1.5")
 TYPE SP9.5 SURFACE COURSE (TL-C)(1.0")

WIDENING

OPTIONAL BASE GROUP 11 WITH
 TYPE SP12.5 STRUCTURAL COURSE (TL-C)(1.5")
 TYPE SP9.5 SURFACE COURSE (TL-C)(1.0")

TYPICAL SECTION 1

D. ANDREW CARSWELL, PE
 LEVY COUNTY BOARD OF COUNTY COMMISSIONERS
 310 SCHOOL STREET, SUITE 112-BRONSON, FLORIDA 32621
 PHONE: (352) 529-7832
 Email: carswell-andrew@levycounty.org

C-347 - NORTH
 LEVY COUNTY, FLORIDA

DATE: 11/2025	PROJECT NO.: 2025025
DRAWN BY: AC	SHEET 1 OF 1