

# SPECIFIC PURPOSE SURVEY

IN SECTION 14  
TOWNSHIP 17 SOUTH, RANGE 15 EAST  
LEVY COUNTY, FLORIDA



EXISTING EASEMENT ACCORDING TO SECTION NO. 3461-150, ROAD NO. 40, LEVY COUNTY  
203.32'

CALCULATED NORTH R/W LINE ACCORDING TO SECTION NO. 3461-150, ROAD NO. 40, LEVY COUNTY  
100.00'

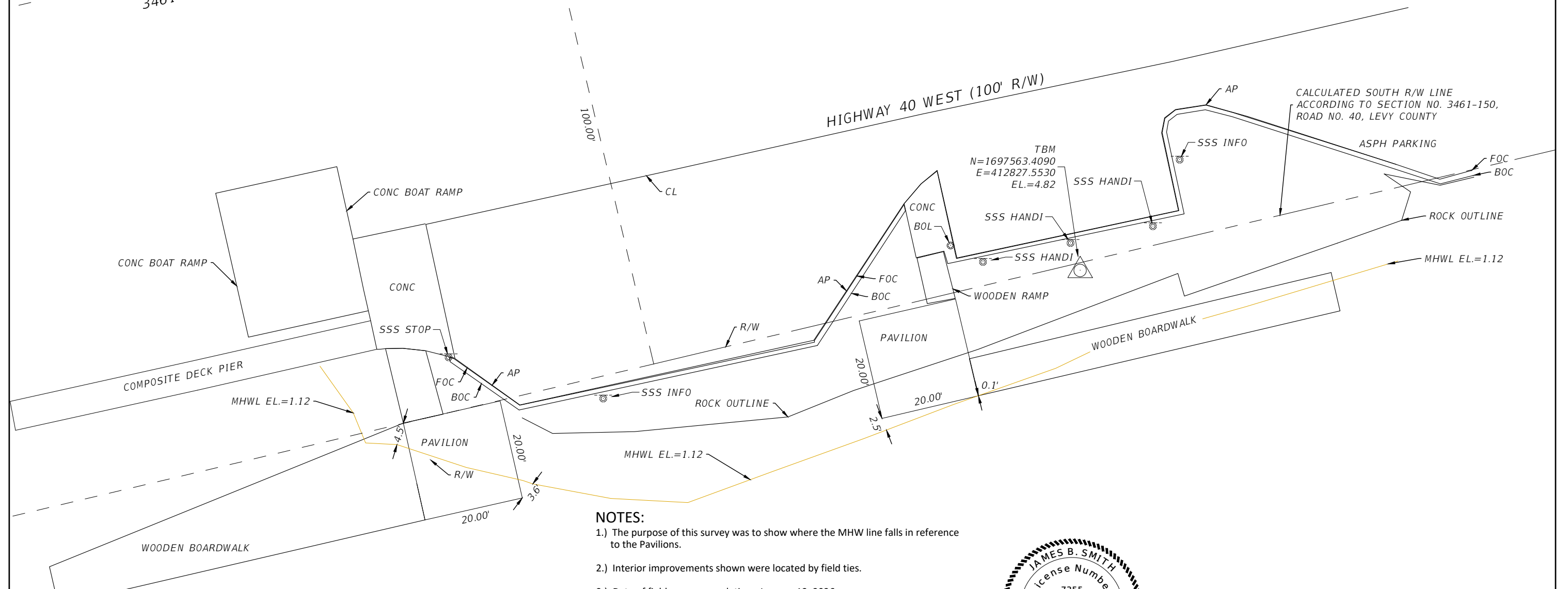

- NOTES:**
- 1.) The purpose of this survey was to show where the MHW line falls in reference to the Pavilions.
  - 2.) Interior improvements shown were located by field ties.
  - 3.) Date of field survey completion: January 12, 2026
  - 4.) Elevations based on NAVD 88 Datum and published FDOT control point AR1946 EL.=5.01
  - 5.) Underground encroachments, if present, were not located with this survey.
  - 6.) The mean high water elevation was located using trigonometric leveling and horizontal positions were gathered through data collection.
  - 7.) Mean High Water elevation of 1.12 feet, NAVD 88, NTDE 1983-2001, was extended from Tide station 872-7395 as shown in the Florida Department of Environmental Protection, Bureau of Survey and Mapping, Tidal Water Survey Procedural Approval for this site, approved 11/25/2025.

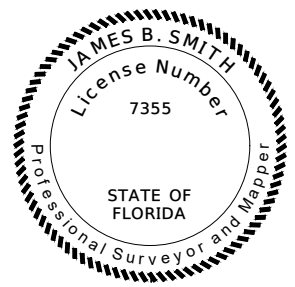

THIS ITEM HAS BEEN DIGITALLY SIGNED AND SEALED BY JAMES B. SMITH ON THE DATE ADJACENT TO THE SEAL.  
PRINTED COPIES OF THIS DOCUMENT ARE NOT CONSIDERED SIGNED AND SEALED AND THE SIGNATURE MUST BE VERIFIED ON ANY ELECTRONIC COPIES.

NORTH FLORIDA PROFESSIONAL SERVICES INC.  
P.O. BOX 3823  
LAKE CITY, FL 32056  
CERTIFICATE OF AUTHORIZATION: 29011  
JAMES B. SMITH, P.S.M. NO. 7355

THE ABOVE NAMED PROFESSIONAL SURVEYOR AND MAPPER SHALL BE RESPONSIBLE FOR THE FOLLOWING SHEETS IN ACCORDANCE WITH RULE 5J-17.062, F.A.C.

LEGEND	
SEC.=SECTION	AP=ASPHALT/PAVEMENT
P.S.M.=PROFESSIONAL SURVEYOR & MAPPER	CONC=CONCRETE
R/W=RIGHT-OF-WAY	TBM=TEMPORARY BENCHMARK
CL=CENTER LINE	SSS=SINGLE SUPPORT SIGN
LB=LICENSED BUSINESS	MHWL=MEAN HIGH WATER LINE
CL=CENTERLINE	FOC=FACE OF CURB
EL.=ELEVATION	BOC=BACK OF CURB
ASPH=ASPHALT	HANDI=HANDICAP
	BOL=BOLLARD

REVISIONS			
DATE	DESCRIPTION	DATE	DESCRIPTION



**NORTH FLORIDA PROFESSIONAL SERVICES, INC.**  
P.O. BOX 3823 LAKE CITY, FL 32056  
PH. 386-752-4675 LIC NO. LB8356  
2551 BLAIRSTONE PINES DR. TALLAHASSEE, FL 32301  
WWW.NFPS.NET

JOB NO. L260112LEV  
CA# 29011

LEVY COUNTY

SHEET NO.

1