

CR 337
SR 121 South to CR 336

OASIS Application

Describe existing right-of-way ownerships along the project (Check all that apply if ownership is by more than one instrument)

Former DOT Right of Way(Right of Way was conveyed to County prior to June 10, 1995):

Plat (Ownership is documented via plat of a city or subdivision):

Deed (Ownership is documented via one or more deeds, frequently shown on a right of way map):

Maintenance Map (Maintenance Map is already filed):

Maintenance Map in Progress(Maintenance map in works):

Prescriptive Use (Roadway presumed dedicated in accordance with FS 95.361):

Additional Right of way is needed:

Provide any additional project information that should be considered or enter NA if not applicable:

Forestry Division utilizes this roadway and with

Public Involvement

Have any public information, or community meetings been held outside of regular commission meetings? (Check if Yes):

Describe any public or private support for the project. (Examples: Letters of support, public meetings, County Commission meetings, petitions, written endorsements, resolutions, etc. Include dates of meetings):

BOCC 11/2/21

Matching Funds

Is the County eligible for and requesting waiver of any required match? (Check if Yes):

Back

Reset

Next

PDF Export

OASIS Application

Edit Application

<p>Road Jurisdiction:* <input type="text" value="County Road"/></p> <p>Work Type:* <input type="text" value="Reconstruction"/></p> <p>Is the project located within 5 miles of a State Highway? <input checked="" type="checkbox"/></p> <p>Are matching funds proposed and committed for this project? (Check if Yes): <input type="checkbox"/></p> <p>Route Name* <input type="text" value="CR 337"/></p> <p>Project Description* <input type="text" value="ReSurface"/></p> <p>From* <input type="text" value="SR 121"/></p> <p>To* <input type="text" value="C336"/></p> <p>Length (miles):* <input type="text" value="6"/></p> <p>Existing Number of Lanes(0-99): <input type="text" value="2"/></p> <p>Existing Lane Width (0 - 99): <input type="text" value="12"/></p> <p>Existing Paved Shoulder Width (0 - 99): <input type="text" value="0"/></p> <p>Proposed Number of Lanes(0-99): <input type="text" value="2"/></p> <p>Proposed Lane Width (0 - 99): <input type="text" value="12"/></p> <p>Proposed Paved Shoulder Width (0 - 99): <input type="text" value="2"/></p> <p>Proposed Safety Edge: <input type="checkbox"/></p> <p>Select Project Location on the Map:</p>	<div style="border: 1px solid #ccc; padding: 5px; margin-bottom: 5px;"><p>Document</p><p><input type="checkbox"/> 2021-2022 Capital Improvement Plan</p></div> <div style="border: 1px solid #ccc; padding: 5px; margin-bottom: 5px;"><p>Choose files (maximum of 3) Browse</p><p><input type="button" value="Upload"/></p></div> <p>Board Priority Number:* <input type="text" value="1"/></p> <p>Board Approved Date:* <input type="text" value="2021-11-02"/></p> <p>Are there any plans for new development in the area? <input type="checkbox"/></p> <p>Percentage agricultural land use within 5 miles of this proposed project <input type="text" value="85"/></p> <p>Is this road listed by Florida Division of Emergency Management as an evacuation route: <input type="checkbox"/></p> <p>Is a school,shopping center(with grocery store), or large neighborhood (>500 lots) within the limits of this proposed project? <input type="checkbox"/></p> <p>Does your agency have an established pavement management plan? <input checked="" type="checkbox"/></p> <p>What is the total budget? <input type="text" value="500000"/></p> <p>Where does this project rank on the plan? <input type="text" value="1"/></p>
---	---

OASIS Application

Project Cost Estimate and Funding

Provide a summary of the estimated cost for the work being proposed.
(Use whole numbers, a detailed project cost estimate must be attached to the application.)

Design Engineering & Plans Preparation:(Default = 0) *	180488.27
Construction:(Default = 0) *	1640802.45
Construction Engineering & Inspection Activities:(Default = 0) *	147672.22
Total Estimated Cost:	1968962.94

Project Funding: For the Total Estimated Cost, how much is requested from

FDOT Funds:(Default = 0) *	1968962.94
Local Funds:(Default = 0) *	0
Total Estimated Cost (Must match estimate above):	1968962.94
Engineer's Estimate File: *	<input type="checkbox"/> Document Created By c337-costestimate-2023.pdf levyrd@levycounty.cr
<input type="button" value="Choose files (maximum of 3)"/> <input type="button" value="Browse"/>	
<input type="button" value="Upload"/>	

Certification of Project Sponsor

I hereby certify that the proposed herein described is supported by (sponsoring entity) and that said entity:

1. Provide any required matching funds
2. Shall enter into a Grant Disbursement Agreement (GDA) with the Florida Department of Transportation to perform the work
3. Shall certify that no additional right of way is required to perform the work other than what is identified on page 3 of this application
4. Has the legal right to construct the project within the identified right of way
5. Shall acquire necessary permits required to construct the project
6. Shall support other actions necessary to fully implement the proposed project

I further certify that the estimated costs included herein are reasonable and that (sponsoring entity) will follow through on the project once programmed in the Florida Department of Transportation's Work Program.

Print Name: Title: Date:

Signature: 

C337 FROM SR121 SOUTH TO C336 RESURFACE

ENGINEER'S ESTIMATE OF CONSTRUCTION COSTS

1/31/2023

<u>ITEM NO</u>	<u>ITEM DESCRIPTION</u>	<u>UNIT</u>	<u>QUANTITY</u>	<u>UNIT PRICE</u>	<u>EXTENDED</u>
101-1	MOBILIZATION	LS	0.1	1,242,236.71	\$124,223.67
102-1	MAINTENANCE OF TRAFFIC	LS	0.1	1,242,236.71	\$124,223.67
110-1	CLEARING AND GRUBBING	MILE	6.4	8,000.00	\$51,200.00
120-6	EMBANKMENT	CY	2560	38.64	\$98,918.40
334-1	SUPERPAVE ASPHALTIC CONCRETE	TON	8522	125.11	\$1,066,187.42
546-71	RUMBLE STRIPS (RAISED)	SET	8	550.00	\$4,400.00
	DESILT PIPE	LF	480	50.00	\$24,000.00
575-1	SODDING-BERMUDA	SY	26213	3.18	\$83,357.34
700-11-1	SINGLE POST SIGN (NEW)	EA	33	537.54	\$17,738.82
705-11-1	TUBULAR DELINEATOR (FLEXIBLE) - CULVERT	EA	24	101.93	\$2,446.32
706-3	RETRO REFLECTIVE PAVEMENT MARKER	EA	1428	4.54	\$6,483.12
710-11-111	PAINTED PAVEMENT MARKING, STANDARD, WHITE, SOLID, 6"	NET MI	12.7	1,411.65	\$17,984.42
710-11-211	PAINTED PAVEMENT MARKING, STANDARD, YELLOW, SOLID, 6"	NET MI	5.2	1,390.09	\$7,228.47
710-11-231	PAINTED PAVEMENT MARKING, STANDARD, YELLOW, SKIP 6"	GROSS MI	5	656.56	\$3,282.80
711-11-121	THERMOPLASTIC, STANDARD, WHITE, SOLID, 6"	LF	200	2.00	\$400.00
711-11-125	THERMOPLASTIC, STANDARD, WHITE, SOLID 24"	LF	200	7.96	\$1,592.00
711-11-221	THERMOPLASTIC, STANDARD, YELLOW, SOLID, 6"	LF	3568	2.00	\$7,136.00

BASE = \$1,640,802.45

Engineering	\$1,640,802.45	0.11	\$180,488.27
CEI	\$1,640,802.45	0.09	\$147,672.22

TOTAL \$1,968,962.94

PRELIMINARY COST ESTIMATE

1. Based on FDOT Historical Costs for 2022.
2. Overlay 200# Asphalt
3. Pavement width = 22 feet (Two -11' Lanes)

Prepared By: D. Andrew Carswell PE#45831
 Levy County Engineer
 310 School Street
 Bronson, FL 32621
 Phone: 352-529-7832
 Email: countyengineer@levycounty.org

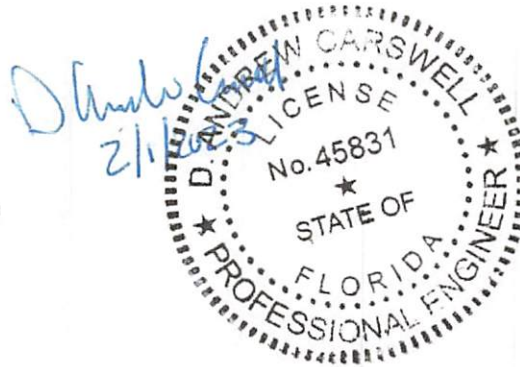

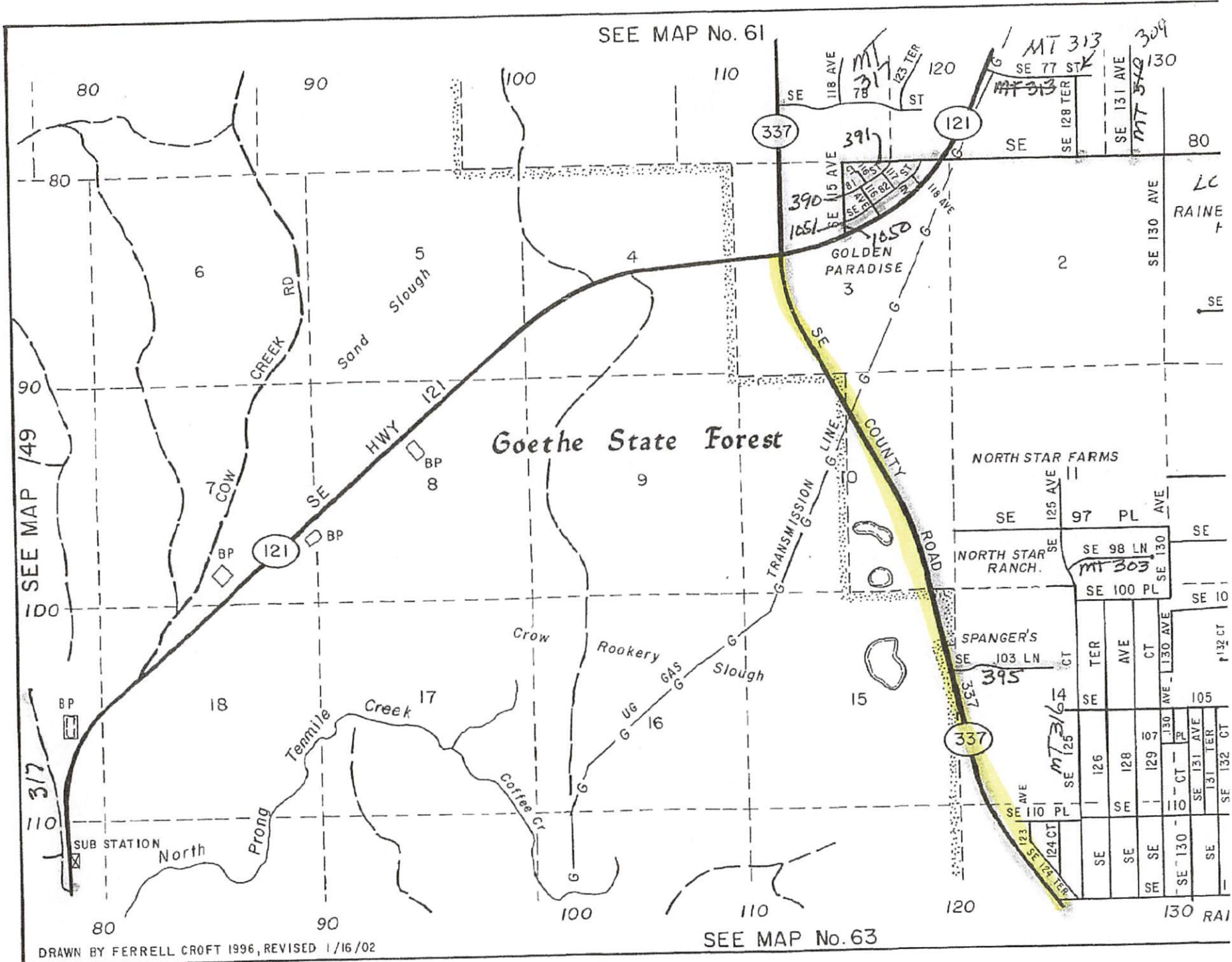

DRAWN BY FERRELL CROFT 1996, REVISED 1/16/02

SEE MAP No. 63

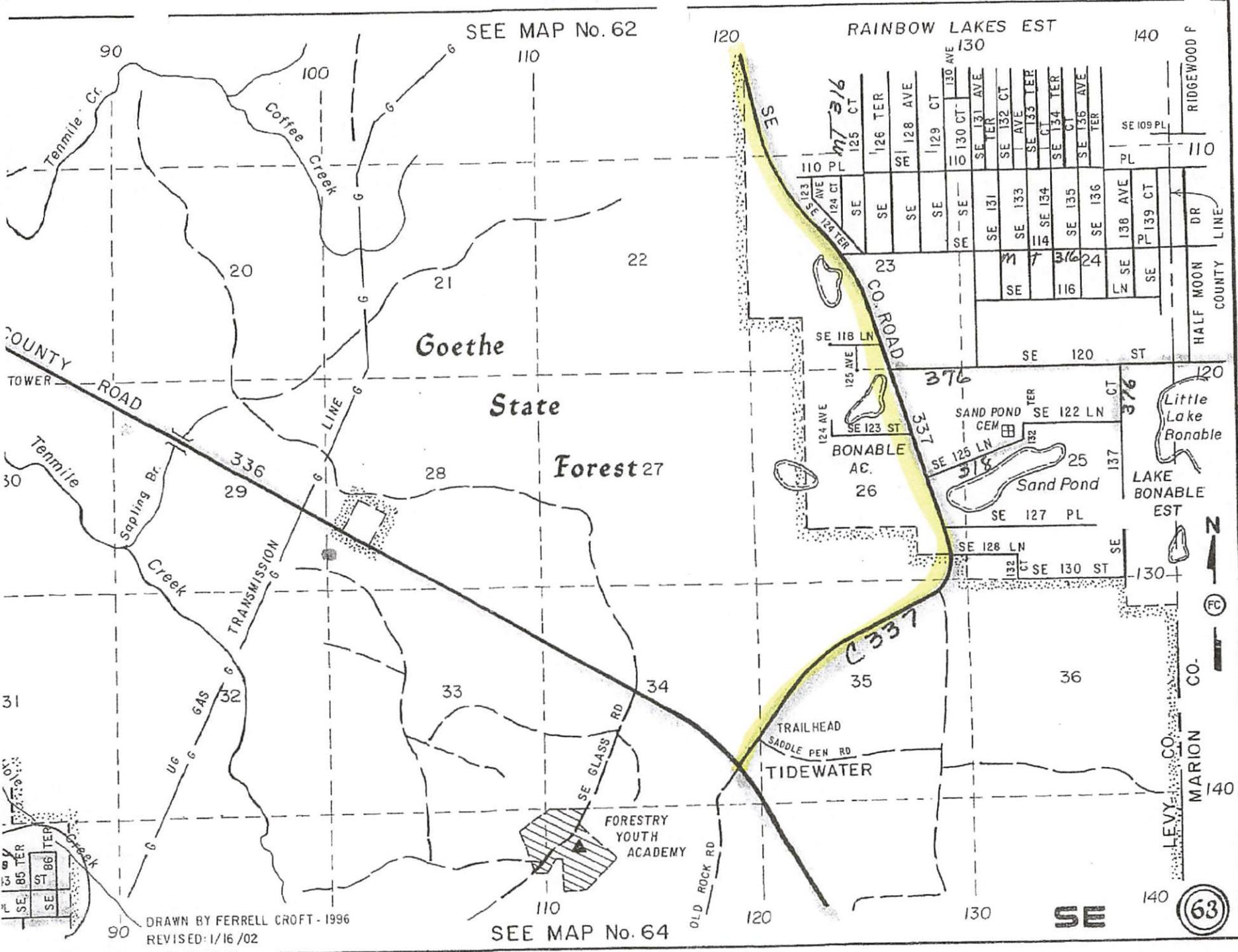

DRAWN BY FERRELL CROFT · 1996
 REVISED: 1/16/02

SEE MAP No. 64