

C326 FROM US19 TO POWERLINE AT CRYSTAL WATER

12/18/2024

ENGINEER'S ESTIMATE OF CONSTRUCTION COSTS

ITEM NO	ITEM DESCRIPTION	UNIT	QUANTITY	UNIT PRICE	EXTENDED
101-1	MOBILIZATION	LS	0.1	3,974,321.60	\$397,432.16
102-1	MAINTENANCE OF TRAFFIC	LS	0.1	3,974,321.60	\$397,432.16
104-13	STAKED SILT FENCE	LF	5000	4.59	\$22,950.00
110-1	CLEARING AND GRUBBING	ACRES	23	6,700.00	\$154,100.00
120-6	EMBANKMENT	CY	2275	30.00	\$68,250.00
160-4	SHOULDER STABILIZATION	SY	36031	4.00	\$144,124.00
285-7-1	OPTION BASE GROUP 4 (SHOULDER PAVING BASE)	SY	15013	65.00	\$975,845.00
286-1	TURN OUT CONSTRUCTION	SY	2236	35.00	\$78,260.00
327-70	MILL EXISTING SURFACE	SY	66056	\$3.00	\$198,168.00
334-1	SUPERPAVE ASPHALTIC CONCRETE	TON	9617	165.00	\$1,586,805.00
339-1	MISCELLANEOUS ASPHALT	TON	24	520.00	\$12,480.00
430-17-2-1	CROSS DRAIN REPLACEMENT	LF	238	400.00	\$95,200.00
430-17-2-2	SIDE DRAIN REPLACEMENT	LF	400	250.00	\$100,000.00
430-982-1	MITERED END SECTION - CROSS DRAINS	EA	14	6,200.00	\$86,800.00
430-982-2	MITERED END SECTION - SIDE DRAINS	EA	20	2,500.00	\$50,000.00
536-1-1	GUARDRAIL	LF	1000	45.00	\$45,000.00
536-7	SPECIAL GUARDRAIL POST	EA	16	375.00	\$6,000.00
536-73	GUARDRAIL REMOVAL	LF	400	4.00	\$1,600.00
536-85-22	GUARDRAIL END ANCHORAGE ASSEMBLY	EA	8	4,300.00	\$34,400.00
546-71	RUMBLE STRIPS (RAISED)	SET	4	1,000.00	\$4,000.00
575-1	PERFORMANCE TURF - SODDING	SY	21018	3.50	\$73,563.00
575-2	PERFORMANCE TURF - SEED AND MULCH	SY	99084	1.65	\$163,488.60
700-1-11	SINGLE POST SIGN (NEW)	EA	60	600.00	\$36,000.00
706-3	RETRO REFLECTIVE PAVEMENT MARKER	EA	1183	6.00	\$7,098.00
710-11-111	PAINTED PAVEMENT MARKING, STANDARD, WHITE, SOLID, 6"	NET MI	10.2	3,000.00	\$30,720.00
710-11-211	PAINTED PAVEMENT MARKING, STANDARD, YELLOW, SOLID, 6"	NET MI	5.1	3,000.00	\$15,300.00
710-11-231	PAINTED PAVEMENT MARKING, STANDARD, YELLOW, SKIP 6"	GROSS MI	3.8	1,400.00	\$5,320.00
711-11-121	THERMOPLASTIC, STANDARD, WHITE, SOLID, 6"	LF	400	2.00	\$800.00
711-11-125	THERMOPLASTIC, STANDARD, WHITE, SOLID 24"	LF	25	8.00	\$200.00
711-11-221	THERMOPLASTIC, STANDARD, YELLOW, SOLID, 6"	LF	400	2.00	\$800.00
BASE =					\$4,792,135.92
Engineering			\$4,792,135.92	0.20	\$958,427.18
CEI			\$4,792,135.92	0.15	\$718,820.39
TOTAL 2024 COST ESTIMATE					\$6,469,383.49
TOTAL 2024 COST ESTIMATE WITH INFLATIONARY FACTOR =1.5% FOR 3 YEARS (2027)					\$6,764,894.42

PRELIMINARY COST ESTIMATE

1. Based on FDOT Historical Costs for 2024 and recent County Bids
2. Existing pavement = 22'
3. Mill 1.5" existing, add 2' paved shoulders and resurface with 2".
4. Length = 5.118 miles

Prepared By: D. Andrew Carswell PE#45831
 County Engineer-Levy County BOCC
 PO Box 310
 Bronson, FL 32621
 Phone: 352-529-7832
 Email: countyengineer@levycounty.org

END PROJECT
 MP 5.118
 POWER LINE AT WEKIVA SPRINGS

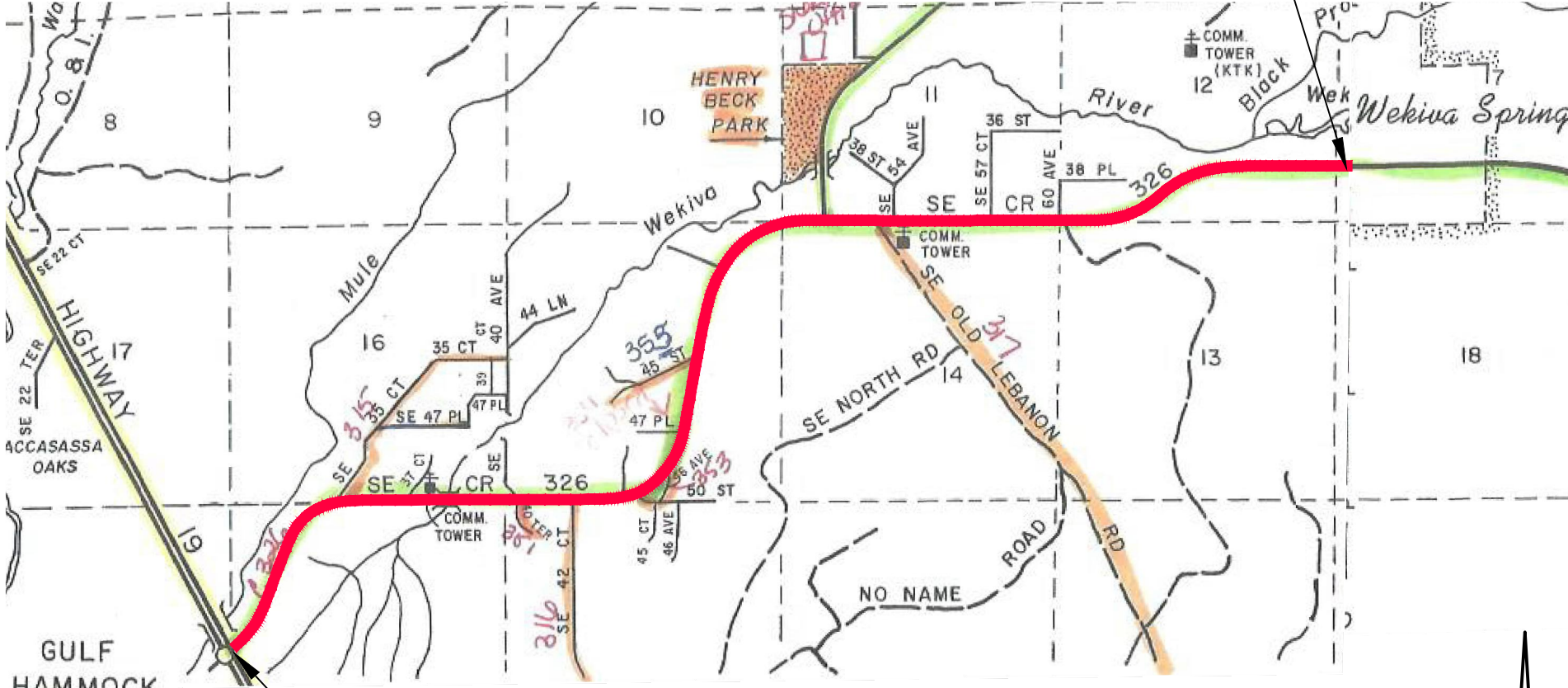

BEGIN PROJECT
 MP 0.000
 INTERSECTION WITH US19

EXISTING WIDTH = 22'
 PROPOSED ADD 2' PAVED SHOULDER
 LENGTH = 5.118 MILES±



D. ANDREW CARSWELL, PE
 COUNTY ENGINEER-LEVY COUNTY
 P.O. BOX 310-310 SCHOOL STREET-BRONSON, FLORIDA 32621
 PHONE: (352) 529-7832
 Email: countyengineer@levycounty.org

C-326 - WEST
 LEVY COUNTY, FLORIDA

DATE: 12/2024	PROJECT NO.: 2024034
DRAWN BY: AC	SHEET 1 OF 1

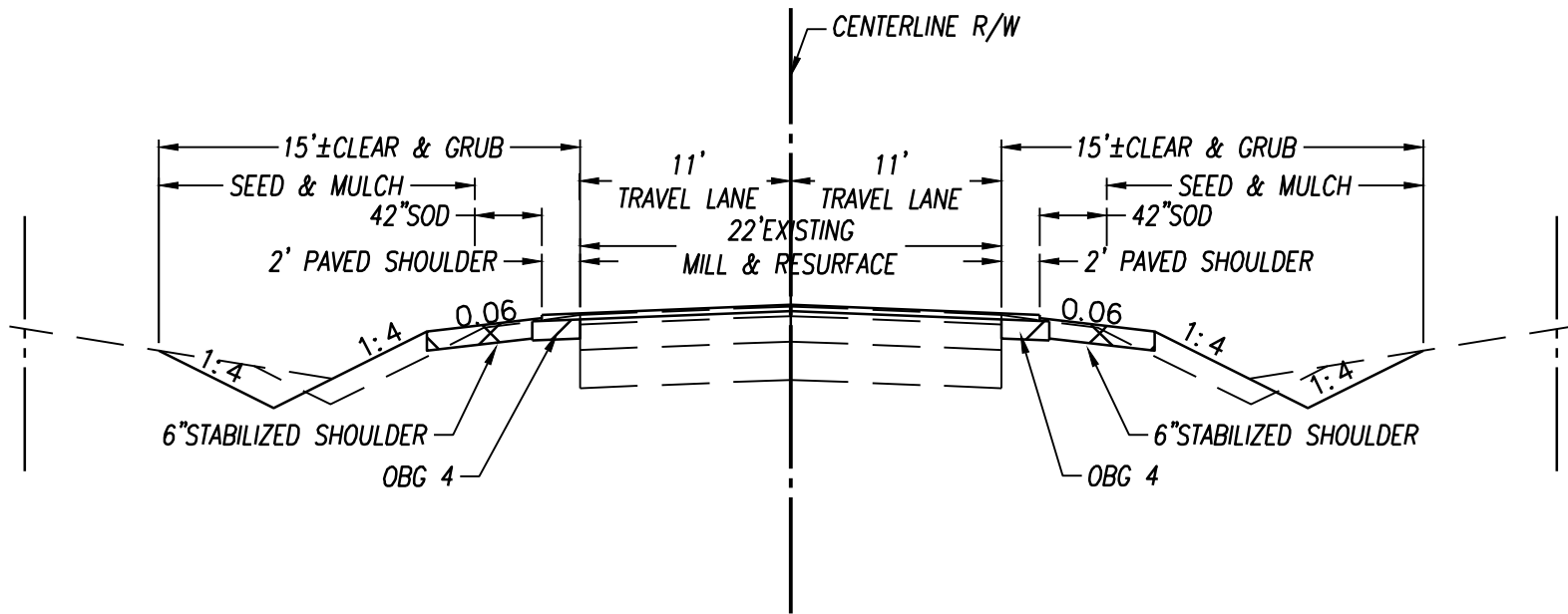

TYPICAL SECTION
MP 0.00 TO MP 5.118

MILLING

MILL 1.5" DEPTH AT EXISTING CROSS SLOPE

RESURFACING

TYPE SP12.5 STRUCTURAL COURSE (TL-C)(2")

PAVED SHOULDER

OPTIONAL BASE GROUP 4 WITH
TYPE SP12.5 STRUCTURAL COURSE (TL-C)(2")

TYPICAL SECTION 1

D. ANDREW CARSWELL, PE
COUNTY ENGINEER-LEVY COUNTY
P.O. BOX 310-310 SCHOOL STREET-BRONSON, FLORIDA 32621
PHONE: (352) 529-7832
Email: countyengineer@levycounty.org

C-326 - WEST
LEVY COUNTY, FLORIDA

DATE: 12/2024	PROJECT NO.: 2024032
DRAWN BY: AC	SHEET 1 OF 1