



FLORIDA DEPARTMENT OF TRANSPORTATION
District 2

Consolidated Application Form for FDOT-Delivered State Grants

APPLICANT INFORMATION

Date: 01/13/2020
use date when apply

County Name: Levy

Contact Person: Alice LaLonde
Title: Administrative Manager

Address: 620 North Hathaway Ave

Phone: 3524863358
Email: levyrd@levycounty.org

PROJECT OVERVIEW INFORMATION

Agency's Project Priority: 3 x2

Board Ranking Approval Date: 01/21/2020
x27/2021

Route Name: CR 337

Jurisdiction: County Road

Project Description: Widen/Resurface CR 337

From: SR 121

To: CR 336

Project Length(miles):6.3

Work Type: Resurfacing x widen/resurface

Existing Number of Lanes: 2

Proposed Number of Lanes:2

Existing Lane Width: 9x18'

Proposed Lane Width:12x24'

Existing Paved Shoulder Width:0

Proposed Paved Shoulder Width: 0 x8'

Proposed Safety Edge:Yes

The road is used as an evacuation route: Yes

The project relieves congestion ON the State Highway System: No

The road has high levels of agricultural travel: Yes

The project improves a transportation facility ON the State Highway System: No

The road is considered a major arterial route: No

The project is consistent with the Agency's Comprehensive Plan: Yes

The road is considered a feeder road: No

The project is consistent with local MPO plans: N/A

Additional project-specific information to be considered:

N/A

xRoad is in need of widening due to increase of agriculture infrastructure in this area along with our Florida Forestry operating along this same stretch of roadway. The large vehicles and narrow lanes make it very difficult to navigate the roadway and under certain weather conditions it can be dangerous.

ADDITIONAL PROJECT INFORMATION

Additional Right-of-Way is needed: No

Description of proposed acquisition including funding source, limitations, and entity acquiring and owning proposed right-of-way:

[Empty box for description of proposed acquisition]

Existing Right-of-Way Ownership

Former FDOT Right-of-Way: Yes
Plat: No
Deed: No
Maintenance Map: No
Maintenance Map in Progress: No
Prescriptive Use: No

Public Involvement

Any public meetings been held outside of regular commission meetings: No
if Yes, Date of Meeting:
Describe any public or private support:

County Commission Meetings 1/21/2020 and 2/4/2021

The County is eligible for and requests a waiver of match: Yes

PROJECT COST ESTIMATE AND FUNDING

Design Engineering & Plans Preparation: \$177000 x\$196,262.53
Construction: \$3278900 x\$3,271,042.13
Construction Engineering & Inspection Activities: \$206500 x\$228,972.95
Total Estimated Cost: \$3662400 x\$3,696,277.60
Proposed FDOT Contribution: \$3662400 x\$3,696,277.60
Proposed Local Contribution: \$0
Total Distribution (must match estimated cost): \$3662400 x\$3,696,277.60

CERTIFICATION OF PROJECT SPONSOR

I hereby certify that the proposed herein described is supported by Levy County Commission and that said entity:

- 1. Shall provide any required matching fund;
2. Shall enter into a Grant Disbursement Agreement (GDA) with FDOT to perform the work;
3. Shall certify that no additional right of way is required to perform the work other than what is identified within this application;
4. Has the legal right to construct the project;
5. Shall acquire necessary permits required to construct the project;
6. Shall support other actions necessary to fully implement the proposed project;

I further certify that the estimated costs included herein are reasonable and that Levy County Commission will follow through on the project once programmed in Florida Department of Transportation's Work Program.

Print Name: Alice LaLonde

Date: 01/22/2020 x(new date when approved)

Title: Administrative Manager
x Administrative Coordinator

Signature: Alice LaLonde

SEE MAP No. 61

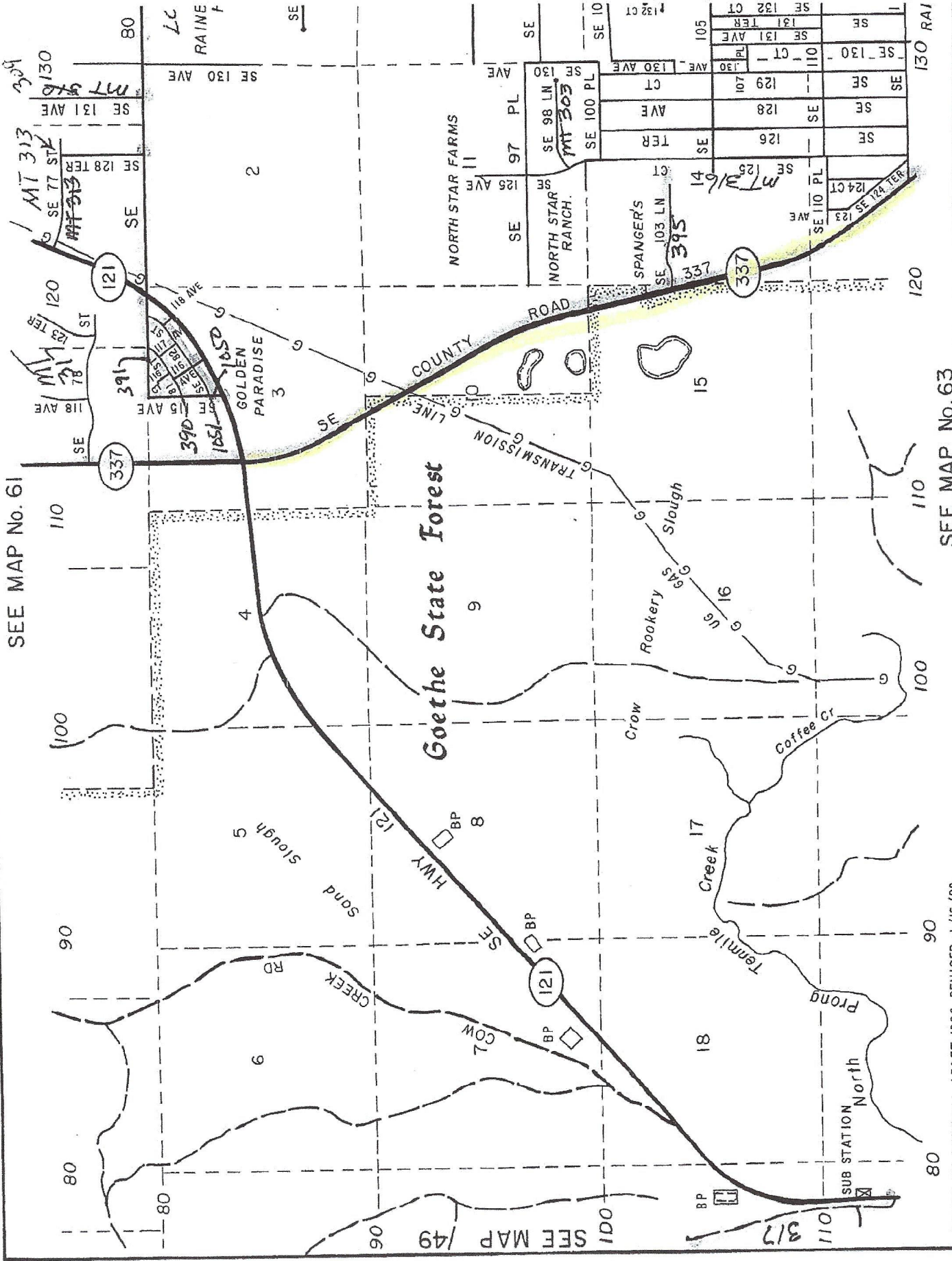

SEE MAP No. 63

DRAWN BY FERRELL CROFT 1996, REVISED 1/16/02

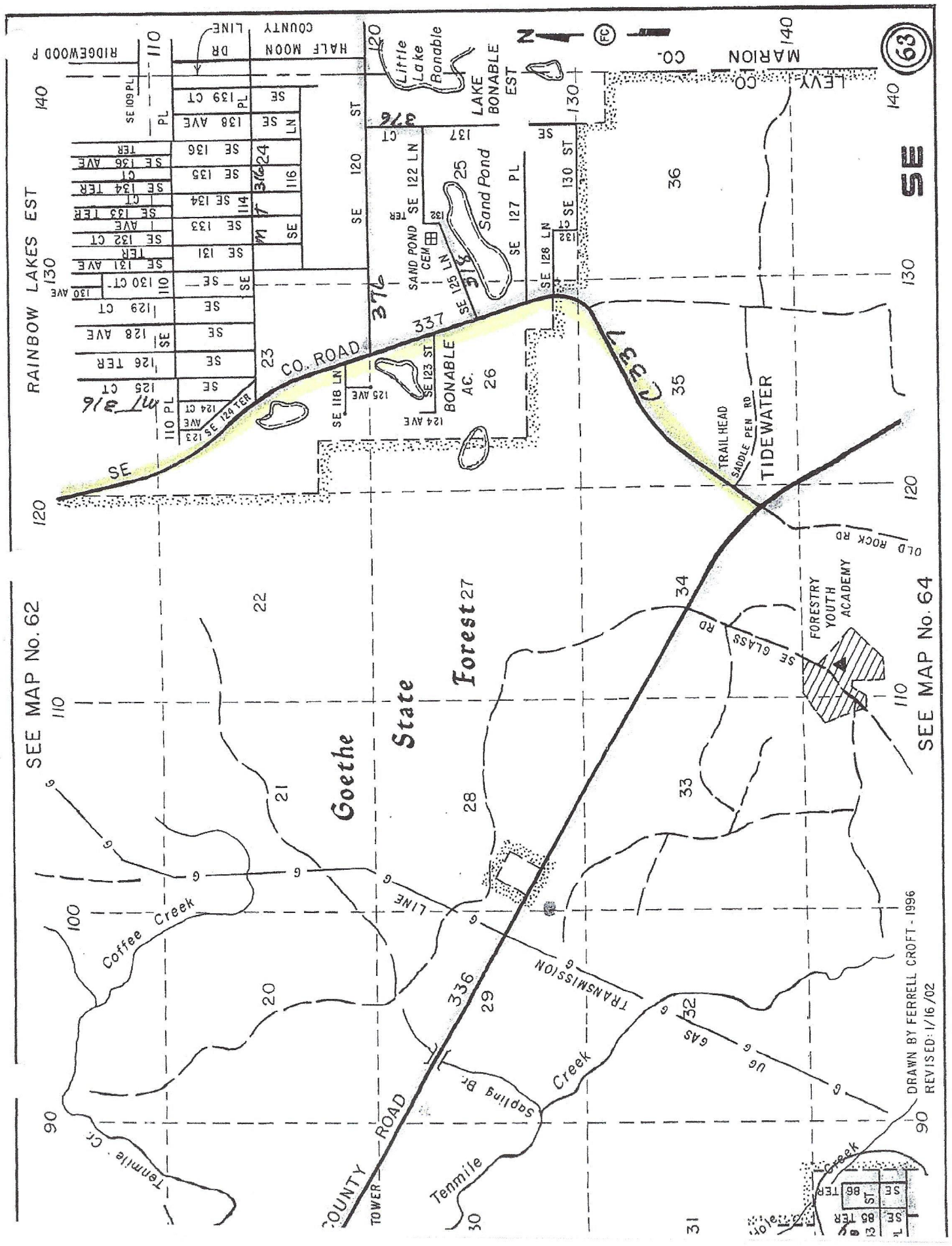

SEE MAP No. 62

RAINBOW LAKES EST

140

130

120

90

63

SE

130

120

110

90

SEE MAP No. 64

DRAWN BY FERRELL CROFT - 1996
 REVISED: 1/16/02

Goethe State Forest

Forest 27

FORESTRY YOUTH ACADEMY

SE 109 PL	PL	SE 139 CT	SE 110
SE 136 AVE	SE 138 AVE	SE 137 LN	SE 116
SE 134 TER	SE 135 CT	SE 134	SE 114
SE 133 TER	SE 134	SE 133	SE 114
SE 132 CT	SE 131	SE 131	SE 114
SE 131 AVE	SE 130 CT	SE 130 CT	SE 110
SE 129 CT	SE 128 AVE	SE 128 AVE	SE 110
SE 126 TER	SE 125 CT	SE 125 CT	SE 110
SE 124 TER	SE 124 CT	SE 124 CT	SE 110
SE 123	SE 123	SE 123	SE 110
SE 124	SE 124	SE 124	SE 110
SE 125	SE 125	SE 125	SE 110
SE 126	SE 126	SE 126	SE 110
SE 127	SE 127	SE 127	SE 110
SE 128	SE 128	SE 128	SE 110
SE 129	SE 129	SE 129	SE 110
SE 130	SE 130	SE 130	SE 110
SE 131	SE 131	SE 131	SE 110
SE 132	SE 132	SE 132	SE 110
SE 133	SE 133	SE 133	SE 110
SE 134	SE 134	SE 134	SE 110
SE 135	SE 135	SE 135	SE 110
SE 136	SE 136	SE 136	SE 110
SE 137	SE 137	SE 137	SE 110
SE 138	SE 138	SE 138	SE 110
SE 139	SE 139	SE 139	SE 110

RAINBOW LAKES EST
 CO. ROAD
 SAND POND SE 122 LN
 SAND POND SE 127 PL
 SAND POND SE 128 LN
 SAND POND SE 130 ST
 SAND POND SE 131 LN
 SAND POND SE 132 LN
 SAND POND SE 133 LN
 SAND POND SE 134 LN
 SAND POND SE 135 LN
 SAND POND SE 136 LN
 SAND POND SE 137 LN
 SAND POND SE 138 LN
 SAND POND SE 139 LN
 SAND POND SE 140 LN
 SAND POND SE 141 LN
 SAND POND SE 142 LN
 SAND POND SE 143 LN
 SAND POND SE 144 LN
 SAND POND SE 145 LN
 SAND POND SE 146 LN
 SAND POND SE 147 LN
 SAND POND SE 148 LN
 SAND POND SE 149 LN
 SAND POND SE 150 LN
 SAND POND SE 151 LN
 SAND POND SE 152 LN
 SAND POND SE 153 LN
 SAND POND SE 154 LN
 SAND POND SE 155 LN
 SAND POND SE 156 LN
 SAND POND SE 157 LN
 SAND POND SE 158 LN
 SAND POND SE 159 LN
 SAND POND SE 160 LN
 SAND POND SE 161 LN
 SAND POND SE 162 LN
 SAND POND SE 163 LN
 SAND POND SE 164 LN
 SAND POND SE 165 LN
 SAND POND SE 166 LN
 SAND POND SE 167 LN
 SAND POND SE 168 LN
 SAND POND SE 169 LN
 SAND POND SE 170 LN
 SAND POND SE 171 LN
 SAND POND SE 172 LN
 SAND POND SE 173 LN
 SAND POND SE 174 LN
 SAND POND SE 175 LN
 SAND POND SE 176 LN
 SAND POND SE 177 LN
 SAND POND SE 178 LN
 SAND POND SE 179 LN
 SAND POND SE 180 LN
 SAND POND SE 181 LN
 SAND POND SE 182 LN
 SAND POND SE 183 LN
 SAND POND SE 184 LN
 SAND POND SE 185 LN
 SAND POND SE 186 LN
 SAND POND SE 187 LN
 SAND POND SE 188 LN
 SAND POND SE 189 LN
 SAND POND SE 190 LN
 SAND POND SE 191 LN
 SAND POND SE 192 LN
 SAND POND SE 193 LN
 SAND POND SE 194 LN
 SAND POND SE 195 LN
 SAND POND SE 196 LN
 SAND POND SE 197 LN
 SAND POND SE 198 LN
 SAND POND SE 199 LN
 SAND POND SE 200 LN

CO. ROAD
 TRAIL HEAD
 SADDLE PEN RD
 TIDEWATER
 OLD ROCK RD
 SE GLASS RD
 TRANSMISSION
 Sapping Br.
 Tenmile Creek
 Coffee Creek
 Tenmile Cr.

RAINBOW LAKES EST
 CO. ROAD
 SAND POND SE 122 LN
 SAND POND SE 127 PL
 SAND POND SE 128 LN
 SAND POND SE 130 ST
 SAND POND SE 131 LN
 SAND POND SE 132 LN
 SAND POND SE 133 LN
 SAND POND SE 134 LN
 SAND POND SE 135 LN
 SAND POND SE 136 LN
 SAND POND SE 137 LN
 SAND POND SE 138 LN
 SAND POND SE 139 LN
 SAND POND SE 140 LN
 SAND POND SE 141 LN
 SAND POND SE 142 LN
 SAND POND SE 143 LN
 SAND POND SE 144 LN
 SAND POND SE 145 LN
 SAND POND SE 146 LN
 SAND POND SE 147 LN
 SAND POND SE 148 LN
 SAND POND SE 149 LN
 SAND POND SE 150 LN
 SAND POND SE 151 LN
 SAND POND SE 152 LN
 SAND POND SE 153 LN
 SAND POND SE 154 LN
 SAND POND SE 155 LN
 SAND POND SE 156 LN
 SAND POND SE 157 LN
 SAND POND SE 158 LN
 SAND POND SE 159 LN
 SAND POND SE 160 LN
 SAND POND SE 161 LN
 SAND POND SE 162 LN
 SAND POND SE 163 LN
 SAND POND SE 164 LN
 SAND POND SE 165 LN
 SAND POND SE 166 LN
 SAND POND SE 167 LN
 SAND POND SE 168 LN
 SAND POND SE 169 LN
 SAND POND SE 170 LN
 SAND POND SE 171 LN
 SAND POND SE 172 LN
 SAND POND SE 173 LN
 SAND POND SE 174 LN
 SAND POND SE 175 LN
 SAND POND SE 176 LN
 SAND POND SE 177 LN
 SAND POND SE 178 LN
 SAND POND SE 179 LN
 SAND POND SE 180 LN
 SAND POND SE 181 LN
 SAND POND SE 182 LN
 SAND POND SE 183 LN
 SAND POND SE 184 LN
 SAND POND SE 185 LN
 SAND POND SE 186 LN
 SAND POND SE 187 LN
 SAND POND SE 188 LN
 SAND POND SE 189 LN
 SAND POND SE 190 LN
 SAND POND SE 191 LN
 SAND POND SE 192 LN
 SAND POND SE 193 LN
 SAND POND SE 194 LN
 SAND POND SE 195 LN
 SAND POND SE 196 LN
 SAND POND SE 197 LN
 SAND POND SE 198 LN
 SAND POND SE 199 LN
 SAND POND SE 200 LN

CO. ROAD
 TRAIL HEAD
 SADDLE PEN RD
 TIDEWATER
 OLD ROCK RD
 SE GLASS RD
 TRANSMISSION
 Sapping Br.
 Tenmile Creek
 Coffee Creek
 Tenmile Cr.

ENGINEER'S ESTIMATE OF CONSTRUCTION COSTS

ITEM NO	ITEM DESCRIPTION	UNIT	QUANTITY	UNIT PRICE	EXTENDED
101-1	MOBILIZATION	LS	0.1	2,795,762.50	\$279,576.25
102-1	MAINTENANCE OF TRAFFIC	LS	0.07	2,795,762.50	\$195,703.38
104-13	STAKED SILT FENCE	LF	31680	2.24	\$70,963.20
110-1	CLEARING AND GRUBBING	MILE	6.3	8,000.00	\$50,400.00
110-7	MAILBOXES	EA	75	250.00	\$18,750.00
120-6	EMBANKMENT	CY	21861.84	\$10.00	\$218,618.40
160-4	SHOULDER STABILIZATION 6" TYPE B LBR 40	SY	59793	\$4.05	\$242,161.65
327-70	MILL EXISTING SURFACE	SY	67267	\$2.40	\$161,440.80
285-7-11	WIDENING LIMEROCK BASE (12"-LBR100)	SY	26159	16.50	\$431,623.50
286-1	TURN OUT CONSTRUCTION (6")	SY	732	32.30	\$23,643.60
334-1	SUPERPAVE ASPHALTIC CONCRETE	TON	9269	105.00	\$973,245.00
400-1-1	CLASS I CONCRETE (ENDWALLS)	CY	78.24	1,900.00	\$148,656.00
430-17-4-18	BITUMINOUS COATED STEEL PIPE (18")	LF	600	100.00	\$60,000.00
430-98-4-24	MITERED END SECTION (INDEX 273)(≤24")	EA	24	2,000.00	\$48,000.00
546-71	RUMBLE STRIPS (RAISED)	SET	8	425.00	\$3,400.00
570-2	SEEDING AND MULCHING	SY	104749	1.65	\$172,835.85
	Desilt Pipe	LF	480	15.00	\$7,200.00
575-1	SODDING-BERMUDA	SY	44733	2.50	\$111,832.50
700-11-1	SINGLE POST SIGN (NEW)	EA	33	400.00	\$13,200.00
705-71	TUBULAR DELINEATOR (FLEXIBLE) - CULVERT	EA	24	87.00	\$2,088.00
706-3	RETRO REFLECTIVE PAVEMENT MARKER	EA	1428	4.50	\$6,426.00
710-11-111	PAINTED PAVEMENT MARKING, STANDARD, WHITE, SOLID, 6"	NET MI	12.7	1,100.00	\$14,014.00
710-11-211	PAINTED PAVEMENT MARKING, STANDARD, YELLOW, SOLID, 6"	NET MI	5.2	1,100.00	\$5,720.00
710-11-231	PAINTED PAVEMENT MARKING, STANDARD, YELLOW, SKIP 6"	GROSS MI	5	550.00	\$2,750.00
711-11-121	THERMOPLASTIC, STANDARD, WHITE, SOLID, 6"	LF	200	1.75	\$350.00
711-11-125	THERMOPLASTIC, STANDARD, WHITE, SOLID 24"	LF	200	11.00	\$2,200.00
711-11-221	THERMOPLASTIC, STANDARD, YELLOW, SOLID, 6"	LF	3568	1.75	\$6,244.00

BASE = \$3,271,042.13

Engineering	\$3,271,042.13	0.06	\$196,262.53
CEI	\$3,271,042.13	0.07	\$228,972.95
TOTAL			\$3,696,277.60

PRELIMINARY COST ESTIMATE

1. Based on FDOT Historical Costs for 2020.
2. Existing Asphalt to be milled. Depth to be determined.
3. New pavement to extend full width of roadway.
4. Emabankment considers 0.65 cy fill per linear foot for 8' shoulder
5. Road widened from 18' to 24'

Prepared By: D. Andrew Carswell PE#45831
 Mills Engineering Company EB#2583
 PO Box 778
 Bronson, FL 32621
 Phone: 352-486-2872
 Email: millseng@bellsouth.net

