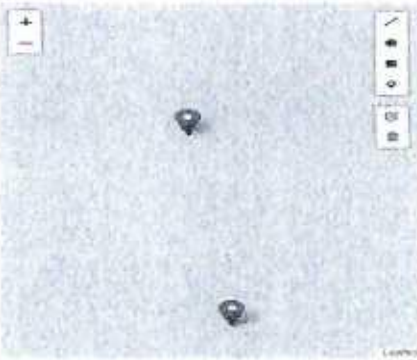

CR 337  
SR 121 South to CR 336

# OASIS Application

## Edit Application

Road Jurisdiction*	County Road
Work Type*	Reconstruction
Is the project located within 5 miles of a State Highway? Are matching funds proposed and committed for this project? (Check if Yes)	<input checked="" type="checkbox"/>
Route Name*	CR 337
Project Description*	ReSurface / Widen Roadway
From*	SR 121
To*	CR 36
Length (miles)*	0
Existing Number of Lanes(0-99)	2
Existing Lane Width (0 - 99)	9
Existing Paved Shoulder Width (0 - 99)	0
Proposed Number of Lanes(0-99)	2
Proposed Lane Width (0 - 99)	12
Proposed Paved Shoulder Width (0 - 99)	2
Proposed Safety Edge Select Project Location on the Map	
Upload verification of the project in Capital Improvement Plan (CIP):	<input type="checkbox"/> Document 2021-2022 Capital Improvement Plan.docx
	Choose files (maximum of 3) <input type="button" value="Browse"/>
Board Priority Number*	1
Board Approved Date*	2021-11-02
Are there any plans for new development in the area?	<input type="checkbox"/>
Percentage agricultural land use within 5 miles of this proposed project	85
Is this road listed by Florida Division of Emergency Management as an evacuation route?	<input type="checkbox"/>
Is a school, shopping center (with grocery store), or large neighborhood (>500 units) within the limits of this proposed project?	<input type="checkbox"/>
Does your agency have an established pavement management plan?	<input type="checkbox"/>

# OASIS Application

Describe existing right-of-way ownerships along the project (Check all that apply if ownership is by more than one instrument)

Former DOT Right of Way(Right of Way was conveyed to County prior to June 10, 1995):

Plat (Ownership is documented via plat of a city or subdivision):

Deed (Ownership is documented via one or more deeds,frequently shown on a right of way map):

Maintenance Map (Maintenance Map is already filed):

Maintenance Map in Progress(Maintenance map in works):

Prescriptive Use (Roadway presumed dedicated in accordance with FS 95.361):

Additional Right of way is needed:

Provide any additional project information that should be considered or enter NA if not applicable:

Road is extremely narrow and there is the Forestry C

## Public Involvement

Have any public information, or community meetings been held outside of regular commission meetings? (Check if Yes):

Describe any public or private support for the project. (Examples:Letters of support,public meetings,County Commission meetings,petitions,written endorsements,resolutions etc. Include dates of meetings):

BOCC 11/2/21

## Matching Funds

Is the County eligible for and requesting waiver of any required match? (Check if Yes):

Back

Reset

Next

PDF Export

# OASIS Application

## Project Cost Estimate and Funding

Provide a summary of the estimated cost for the work being proposed.  
(Use whole numbers, a detailed project cost estimate must be attached to the application.)

Design Engineering & Plans Preparation:(Default = 0) *	<input type="text" value="225794.00"/>
Construction:(Default = 0) *	<input type="text" value="3783233.75"/>
Construction Engineering & Inspection Activities:(Default = 0) *	<input type="text" value="263426.06"/>
Total Estimated Cost:	<input type="text" value="4252454.13"/>

Project Funding: For the Total Estimated Cost, how much is requested from

FDOT Funds:(Default = 0) *	<input type="text" value="4252454.13"/>
Local Funds:(Default = 0) *	<input type="text" value="0"/>
Total Estimated Cost (Must match estimate above):	<input type="text" value="4252454.13"/>
Engineer's Estimate File: *	<input type="checkbox"/> <small>Document</small> Levy-C337-ar121toC338-10212021.pdf <small>Created By: levy@levy.com</small>
<input type="button" value="Choose files (maximum of 3)"/> <input type="button" value="Browse"/>	
<input type="button" value="Upload"/>	

## Certification of Project Sponsor

I hereby certify that the proposed herein described is supported by  (sponsoring entity) and that said entity

1. Provide any required matching funds
2. Shall enter into a Grant Disbursement Agreement (GDA) with the Florida Department of Transportation to perform the work
3. Shall certify that no additional right of way is required to perform the work other than what is identified on page 3 of this application
4. Has the legal right to construct the project within the identified right of way
5. Shall acquire necessary permits required to construct the project
6. Shall support other actions necessary to fully implement the proposed project

I further certify that the estimated costs included herein are reasonable and that  (sponsoring entity) will follow through on the project once programmed in the Florida Department of Transportation's Work Program.

Print Name:  Title:  Date:

Please Sign Here:

*Alice LaLonde*

Create your own signature using the pad below.

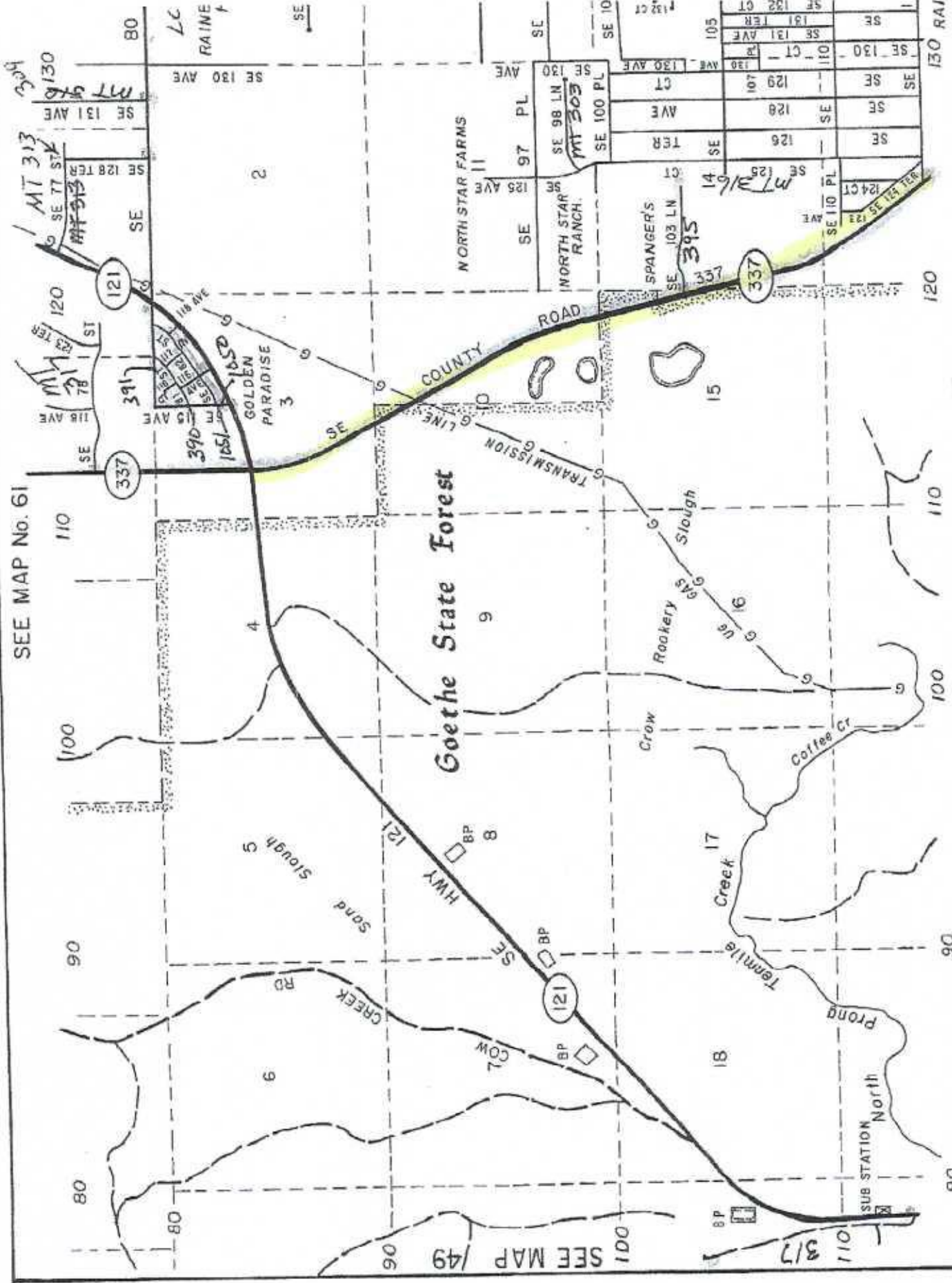

SEE MAP No. 61

SEE MAP /49

SEE MAP No. 63

DRAWN BY FERRELL CROFT 1996, REVISED 1/16/02

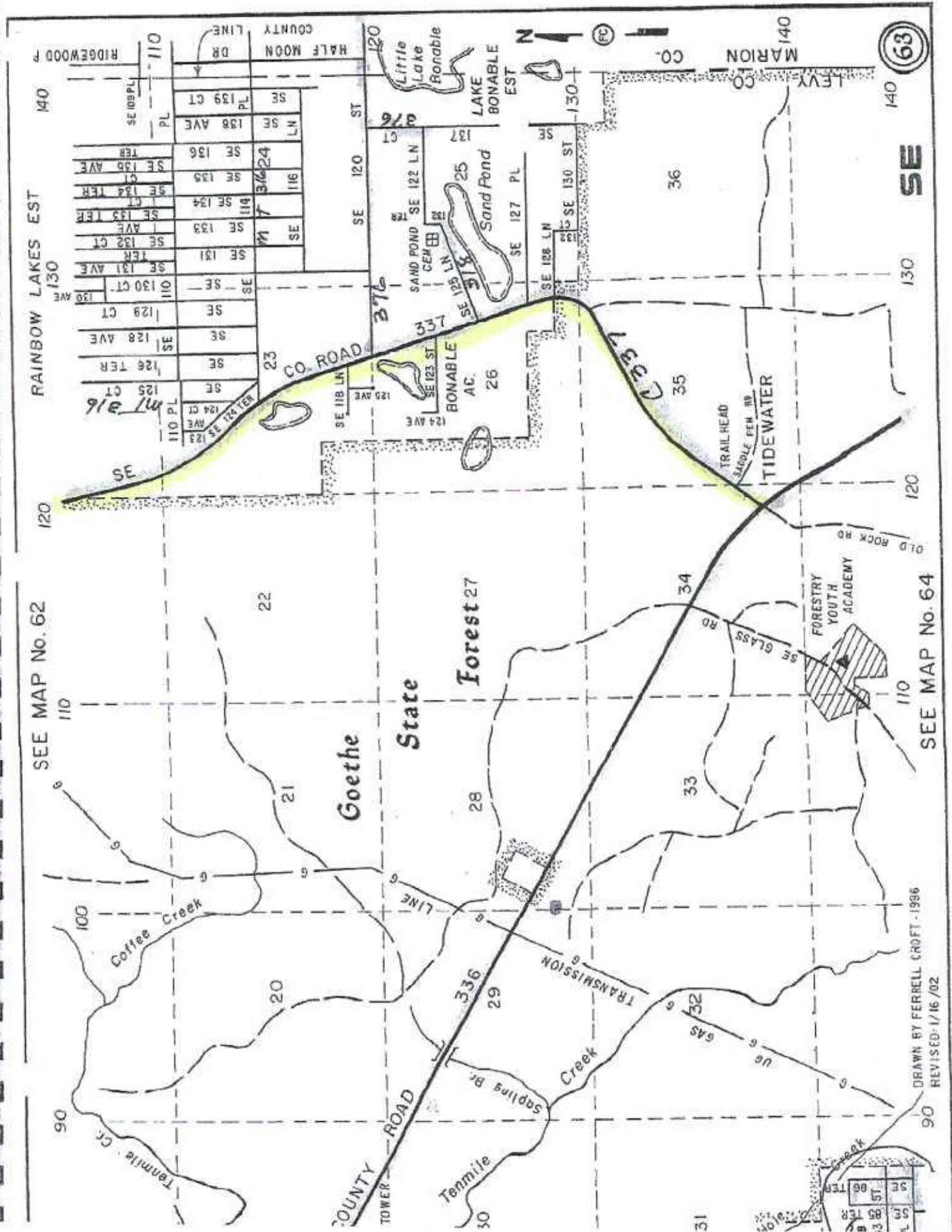

SEE MAP No. 62

SEE MAP No. 64

DRAWN BY FERRELL CROFT - 1996  
REVISED: 1/16/02

63

SE

31

SE 85 TER	SE 86 TER
SE 87 TER	SE 88 TER

**ENGINEER'S ESTIMATE OF CONSTRUCTION COSTS**

10/21/2021

ITEM NO	ITEM DESCRIPTION	UNIT	QUANTITY	UNIT PRICE	EXTENDED
101-1	MOBILIZATION	LS	0.1	3,216,439.10	\$321,643.91
102-1	MAINTENANCE OF TRAFFIC	LS	0.07	3,216,439.10	\$225,150.74
104-13	STAKED SILT FENCE	LF	31680	2.52	\$79,833.60
110-1	CLEARING AND GRUBBING	MILE	8.3	8,000.00	\$50,400.00
110-7	MAILBOXES	EA	75	325.00	\$24,375.00
120-6	EMBANKMENT	CY	21861.84	\$12.00	\$262,342.08
160-4	SHOULDER STABILIZATION 6" TYPE B LBR 40	SY	59793	\$7.09	\$423,932.37
327-70	MILL EXISTING SURFACE	SY	67267	\$2.50	\$168,167.50
285-7-11	WIDENING LIMEROCK BASE (12"-LBR100)	SY	26159	20.00	\$523,180.00
286-1	TURN OUT CONSTRUCTION (6")	SY	732	32.30	\$23,643.60
334-1	SUPERPAVE ASPHALTIC CONCRETE	TON	9269	105.00	\$973,245.00
400-1-1	CLASS I CONCRETE (ENDWALLS)	CY	78.24	1,900.00	\$148,656.00
430-17-4-18	BITUMINOUS COATED STEEL PIPE (18")	LF	600	100.00	\$60,000.00
430-17-4-30	REINFORCED CONCRETE PIPE (30")	LF	96	225.00	\$21,600.00
430-98-4-24	MITERED END SECTION (INDEX 273)(<=24")	EA	24	2,300.00	\$55,200.00
546-71	RUMBLE STRIPS (RAISED)	SET	8	425.00	\$3,400.00
570-2	SEEDING AND MULCHING	SY	104749	2.00	\$209,498.00
	Desilt Pipe	LF	480	15.00	\$7,200.00
575-1	SODDING-BERMUDA	SY	44733	2.75	\$123,015.75
700-11-1	SINGLE POST SIGN (NEW)	EA	33	425.00	\$14,025.00
705-71	TUBULAR DELINEATOR (FLEXIBLE) - CULVERT	EA	24	125.00	\$3,000.00
706-3	RETRO REFLECTIVE PAVEMENT MARKER	EA	1428	5.40	\$7,711.20
710-11-111	PAINTED PAVEMENT MARKING, STANDARD, WHITE, SOLID, 6"	NET MI	12.7	1,200.00	\$15,288.00
710-11-211	PAINTED PAVEMENT MARKING, STANDARD, YELLOW, SOLID, 6"	NET MI	5.2	1,200.00	\$6,240.00
710-11-231	PAINTED PAVEMENT MARKING, STANDARD, YELLOW, SKIP 6"	GROSS MI	5	550.00	\$2,750.00
711-11-121	THERMOPLASTIC, STANDARD, WHITE, SOLID, 6"	LF	200	2.00	\$400.00
711-11-125	THERMOPLASTIC, STANDARD, WHITE, SOLID 24"	LF	200	11.00	\$2,200.00
711-11-221	THERMOPLASTIC, STANDARD, YELLOW, SOLID, 6"	LF	3568	2.00	\$7,136.00
				BASE =	\$3,763,233.75
Engineering			\$3,763,233.75	0.06	\$225,794.02
CEI			\$3,763,233.75	0.07	\$263,426.36
<b>TOTAL</b>					<b>\$4,252,454.13</b>

**PRELIMINARY COST ESTIMATE**

1. Based on FDOT Historical Costs for 2020.
2. Existing Asphalt to be milled. Depth to be determined.
3. New pavement to extend full width of roadway.
4. Embankment considers 0.65 cy fill per linear foot for 8' shoulder
5. Road widened from 18' to 24'

Prepared By: D. Andrew Carswell PE#45831  
 Mills Engineering Company EB#2583  
 PO Box 778  
 Bronson, FL 32621  
 Phone: 352-486-2872  
 Email: millseng@bellsouth.net

*D. Andrew Carswell*  
 10/21/2021

