

CLIENT:
CITY OF LEBANON
925 MAIN STREET
LEBANON, OREGON 97355

UDELL ENGINEERING
AND
LAND SURVEYING, LLC
63 EAST ASH ST.
LEBANON, OREGON 97355
(541) 451-5125 PH.
(541) 451-1366 FAX

PRELIMINARY PHASE 1 SITE PLAN
CITY OF LEBANON
CHEADLE LAKE MASTER PLAN
LEBANON, OREGON

DATE: NOVEMBER 5, 2024
PROJECT: 22-287 CHEADLE LAKE WATERLINE
DRAWN BY: INDI, MLM
CHECKED BY: BSV

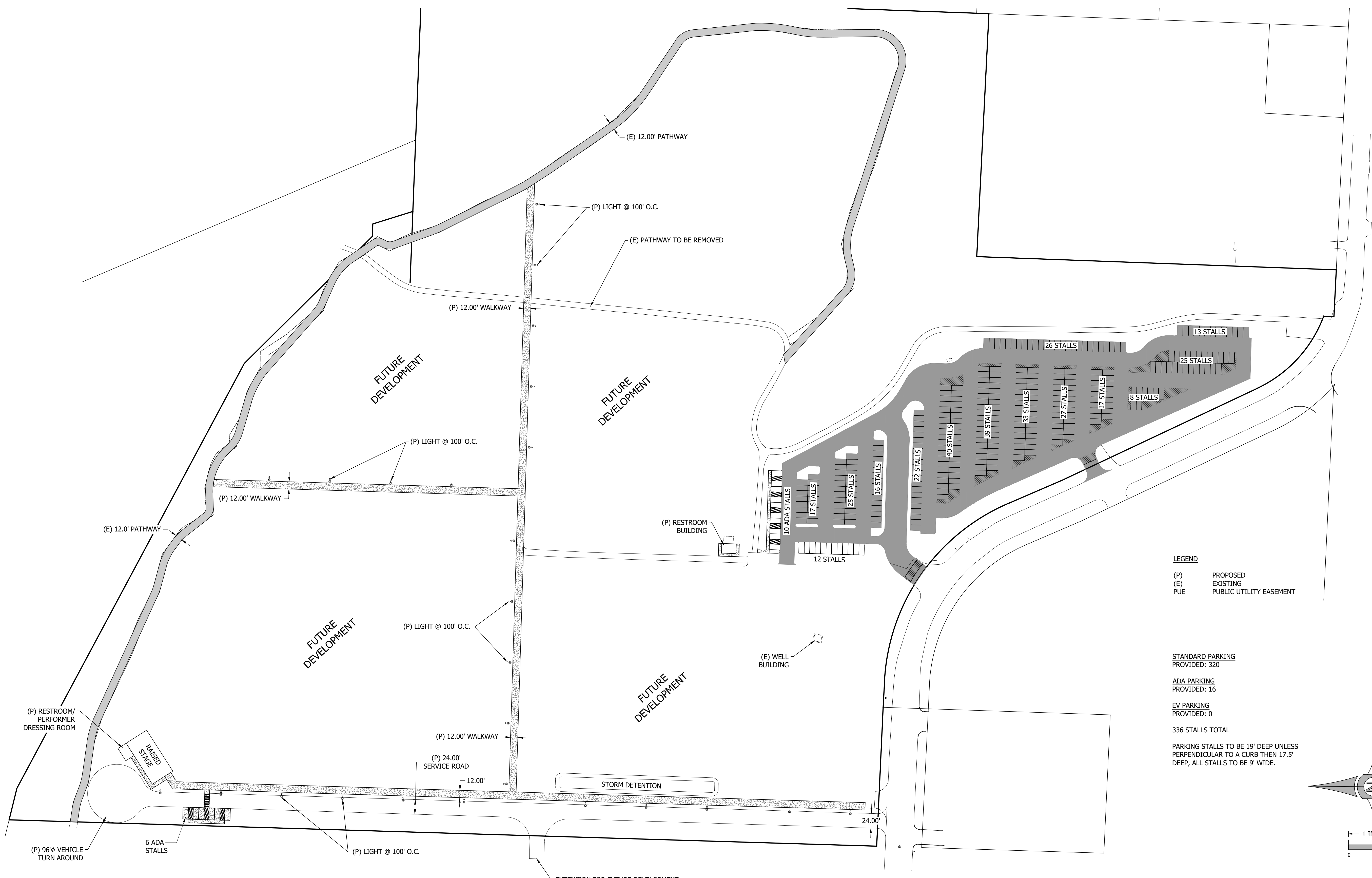

LEGEND
(P) PROPOSED
(E) EXISTING
PUE PUBLIC UTILITY EASEMENT

STANDARD PARKING PROVIDED: 320
ADA PARKING PROVIDED: 16
EV PARKING PROVIDED: 0
336 STALLS TOTAL

PARKING STALLS TO BE 19' DEEP UNLESS PERPENDICULAR TO A CURB THEN 17.5' DEEP, ALL STALLS TO BE 9' WIDE.

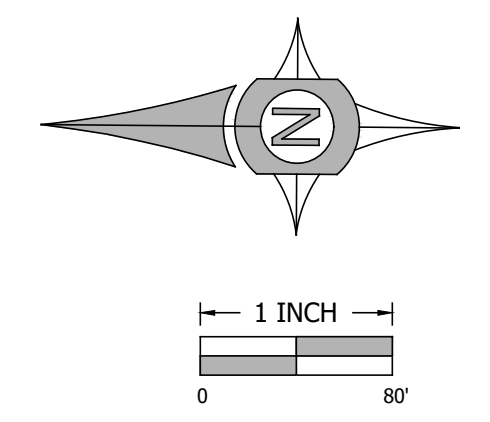

PLAN REVISIONS	DATE

Sheet **C1.2**
SCALE: SEE BARSCALE